

DeSaye, Cara G.

From: DeSaye, Cara G.
Sent: Friday, June 24, 2011 4:12 PM
To: 'gberg@nodakelectric.com'
Subject: Temporary Authority Permit Request
Attachments: 4710_001.pdf

Please find attached a request from Otter Tail Power Company for temporary authority to extend electric services to Clifford Farmers Cooperative Elevator in Traill County, North Dakota.

Please review this request as soon as possible and let me know whether the Cooperative will protest the application.

Thank you for your attention in this matter.

Cara DeSaye
ND Public Service Commission
600 E. Boulevard Ave., Dept. 408
Bismarck, ND 58505-0480
701-328-4076
cdesaye@nd.gov

2 **PU-11-302** Filed: 6/24/2011 Pages: 4
Email to cooperative re temporary authority request



TEMPORARY AUTHORITY PERMIT
NORTH DAKOTA PUBLIC SERVICE COMMISSION
PUBLIC UTILITIES
 SFN 50560 (8-96)

Date 6/24/11	Time 8:00	<input type="checkbox"/> a.m. <input type="checkbox"/> p.m.	Name of Utility OTTER TAIL POWER COMPANY	Telephone Number 800-257-4044
Name of Person Calling CHARLES KREBS			Name of Coop Serving NODAK ELECTRIC COOPERATIVE INC	
Name of Customer CLIFFORD FARMERS COOPERATIVE ELEVATOR		Location Sec NW 1/4 OF NW 1/4-27 Twp 145-N R 53-W		
Address PO BOX 68			County TRAILL	
City CLIFFORD		State ND	Zip Code 58016-0068	
Name of Nearest City CLIFFORD			Distance to the City APPROX 350 FT	
When will service be extended? JULY 2011		Type of Service <input type="checkbox"/> Residence <input type="checkbox"/> Storage <input type="checkbox"/> Grain Bin <input checked="" type="checkbox"/> Other <u>COMMERCIAL</u>		
Extension Length to Most Economical Point of Service Utility: 600 FT Coop: UNKNOWN		Extension <input checked="" type="checkbox"/> Overhead <input type="checkbox"/> Underground		
Has customer signed request for service? <input checked="" type="checkbox"/> Yes <input type="checkbox"/> No		Will cooperative protest application? <input type="checkbox"/> Yes <input checked="" type="checkbox"/> No		
Name of Person Contacted (PSC Use)		Date of Contact (PSC Use)	Time (PSC Use) <input type="checkbox"/> a.m. <input type="checkbox"/> p.m.	
Estimated Cost of Extension \$13,000		Estimated Revenue \$4,000 PER YEAR		
Under what rate filed with the Public Service Commission will customer be served? ND SECTION 10.02, RATE 50-401				
Will extension cross over coop lines? <input type="checkbox"/> Yes <input checked="" type="checkbox"/> No		Will extension cross over railroad tracks? <input type="checkbox"/> Yes <input checked="" type="checkbox"/> No		
Temporary Authority Authorized By <input type="checkbox"/> Telephone <input type="checkbox"/> Letter		Date Authorized		
Authorized By (Name of Commissioner)				

Extension must be made from most economical point of service.

Comments:
 OTTER TAIL POWER COMPANY EXTENSION IS APPROXIMATELY 600 FT FROM OUR NEAREST THREE-PHASE LINE WITHIN THE CITY LIMITS AND APPROXIMATELY 300 FT NORTH OF THE CITY LIMITS.

 AGREEMENT REACHED WITH NODAK ELECTRIC COOPERATIVE INC (GEORGE BERG, GENERAL MANAGER) ON JUNE 24, 2011, FOR OTTER TAIL POWER COMPANY TO PROVIDE SERVICE DUE TO THE DISTANCE INVOLVED FOR THEM TO PROVIDE THREE-PHASE SERVICE.

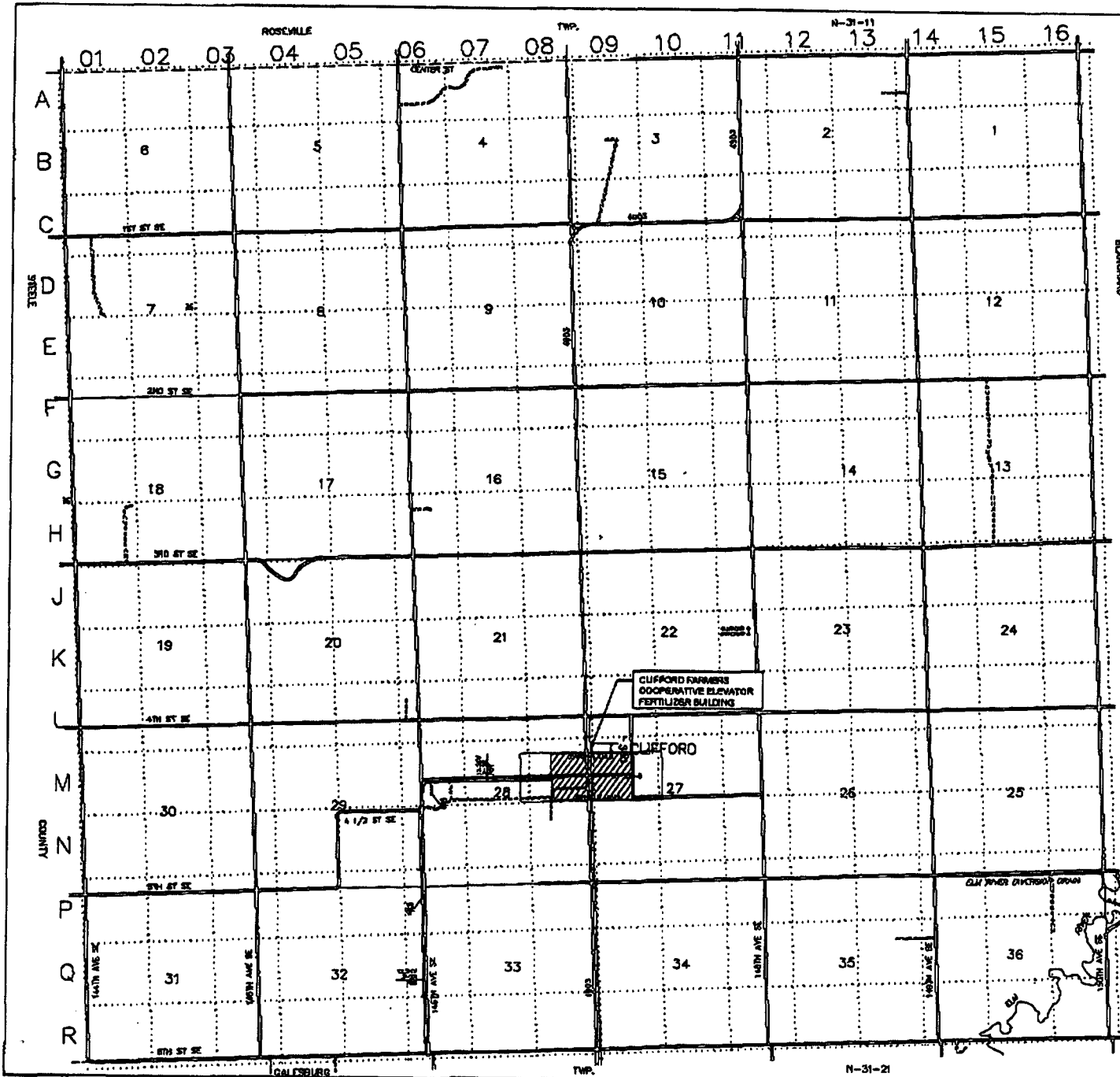

NORMAN TOWNSHIP

T-145-N : R-53-W
TRAIL COUNTY, NORTH DAKOTA

Scale: 1" = 2000' 3-7-2001
BY : S. SANDERSON

Reference USGS 7.5 minute series
quadrangle maps:
Odesburg NW, ND 1968
Odesburg SE, ND 1968
Odesburg, ND 1968

LEGEND

1	COUNTY	1	RAILROAD	1	STATE ROAD
2	SECTION	2	RAILROAD	2	STATE ROAD
3	SECTION	3	RAILROAD	3	STATE ROAD
4	SECTION	4	RAILROAD	4	STATE ROAD
5	SECTION	5	RAILROAD	5	STATE ROAD
6	SECTION	6	RAILROAD	6	STATE ROAD
7	SECTION	7	RAILROAD	7	STATE ROAD
8	SECTION	8	RAILROAD	8	STATE ROAD
9	SECTION	9	RAILROAD	9	STATE ROAD
10	SECTION	10	RAILROAD	10	STATE ROAD
11	SECTION	11	RAILROAD	11	STATE ROAD
12	SECTION	12	RAILROAD	12	STATE ROAD
13	SECTION	13	RAILROAD	13	STATE ROAD
14	SECTION	14	RAILROAD	14	STATE ROAD
15	SECTION	15	RAILROAD	15	STATE ROAD
16	SECTION	16	RAILROAD	16	STATE ROAD
17	SECTION	17	RAILROAD	17	STATE ROAD
18	SECTION	18	RAILROAD	18	STATE ROAD
19	SECTION	19	RAILROAD	19	STATE ROAD
20	SECTION	20	RAILROAD	20	STATE ROAD
21	SECTION	21	RAILROAD	21	STATE ROAD
22	SECTION	22	RAILROAD	22	STATE ROAD
23	SECTION	23	RAILROAD	23	STATE ROAD
24	SECTION	24	RAILROAD	24	STATE ROAD
25	SECTION	25	RAILROAD	25	STATE ROAD
26	SECTION	26	RAILROAD	26	STATE ROAD
27	SECTION	27	RAILROAD	27	STATE ROAD
28	SECTION	28	RAILROAD	28	STATE ROAD
29	SECTION	29	RAILROAD	29	STATE ROAD
30	SECTION	30	RAILROAD	30	STATE ROAD
31	SECTION	31	RAILROAD	31	STATE ROAD
32	SECTION	32	RAILROAD	32	STATE ROAD
33	SECTION	33	RAILROAD	33	STATE ROAD
34	SECTION	34	RAILROAD	34	STATE ROAD
35	SECTION	35	RAILROAD	35	STATE ROAD
36	SECTION	36	RAILROAD	36	STATE ROAD

OTTER TAIL
Map Makers
N-31-16
TRAIL COUNTY

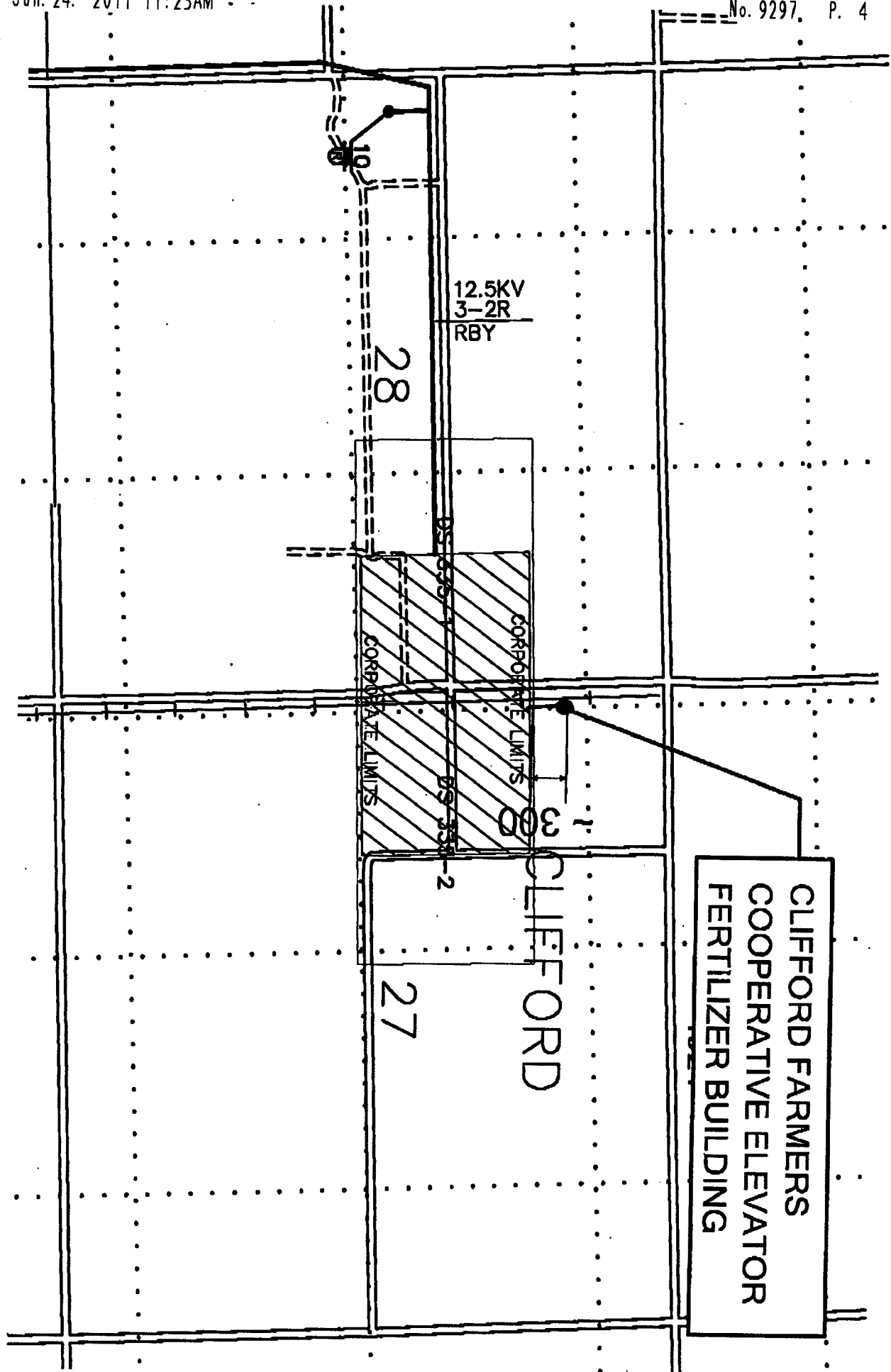

12.5KV
3-2R
RBY

28

CORPORATE LIMITS

CORPORATE LIMITS

DS 533-2

CLIFFORD

27

CLIFFORD FARMERS
COOPERATIVE ELEVATOR
FERTILIZER BUILDING