



**TEMPORARY AUTHORITY PERMIT**  
 NORTH DAKOTA PUBLIC SERVICE COMMISSION  
 PUBLIC UTILITIES  
 SFN 50560 (6-96)

Date <b>JUNE 29, 2011</b>	Time <b>8:00</b>	<input checked="" type="checkbox"/> a.m. <input type="checkbox"/> p.m.	Name of Utility <b>OTTER TAIL POWER COMPANY</b>	Telephone Number <b>800-257-4044</b>
Name of Person Calling <b>CHARLES KREBS, OPERATIONS MANAGER</b>			Name of Coop Serving <b>NORTHERN PLAINS ELECTRIC COOPERATIVE</b>	
Name of Customer <b>KEITH DRAKE</b>		Location Sec <b>NW 1/4-9</b> Twp <b>150-N</b> R <b>66-W</b>		
Address <b>7660 34TH ST NE</b>			County <b>EDDY</b>	
City <b>SHEYENNE</b>			State <b>ND</b>	Zip Code <b>58374-9645</b>
Name of Nearest City <b>SHEYENNE</b>			Distance to the City <b>500 FT</b>	
When will service be extended? <b>AUGUST 2011</b>		Type of Service <input type="checkbox"/> Residence <input type="checkbox"/> Storage <input type="checkbox"/> Grain Bin <input checked="" type="checkbox"/> Other <b>FARM</b>		
Extension Length to Most Economical Point of Service Utility: <b>500 FT</b> Coop: <b>1/2 MILE</b>		Extension <input type="checkbox"/> Overhead <input checked="" type="checkbox"/> Underground		
Has customer signed request for service? <input checked="" type="checkbox"/> Yes <input type="checkbox"/> No		Will cooperative protest application? <input type="checkbox"/> Yes <input checked="" type="checkbox"/> No		
Name of Person Contacted (PSC Use)		Date of Contact (PSC Use)	Time (PSC Use) <input type="checkbox"/> a.m. <input type="checkbox"/> p.m.	
Estimated Cost of Extension <b>\$21,000</b>		Estimated Revenue <b>\$4,000 PER YEAR</b>		
Under what rate filed with the Public Service Commission will customer be served? <b>ND SECTION 9.03, RATE CODE 50-361</b>				
Will extension cross over coop lines? <input type="checkbox"/> Yes <input checked="" type="checkbox"/> No		Will extension cross over railroad tracks? <input type="checkbox"/> Yes <input checked="" type="checkbox"/> No		
Temporary Authority Authorized By <input type="checkbox"/> Telephone <input type="checkbox"/> Letter		Date Authorized		
Authorized By (Name of Commissioner)				

Extension must be made from most economical point of service.

**Comments:**  
 THE NORTHERLY CITY LIMITS OF SHEYENNE ARE APPROXIMATELY 500 FT FROM THIS NEW FARM SITE. THREE-PHASE SERVICE IS REQUESTED. OTTER TAIL POWER COMPANY HAS THREE-PHASE 500 FT FROM THE PROPOSED SERVICE.

AGREEMENT REACHED WITH JAY JACOBSON (ALLIANCE MANAGER-NORTHERN PLAINS ELECTRIC COOPERATIVE), TO HAVE OTTER TAIL POWER COMPANY SERVE THIS CUSTOMER.

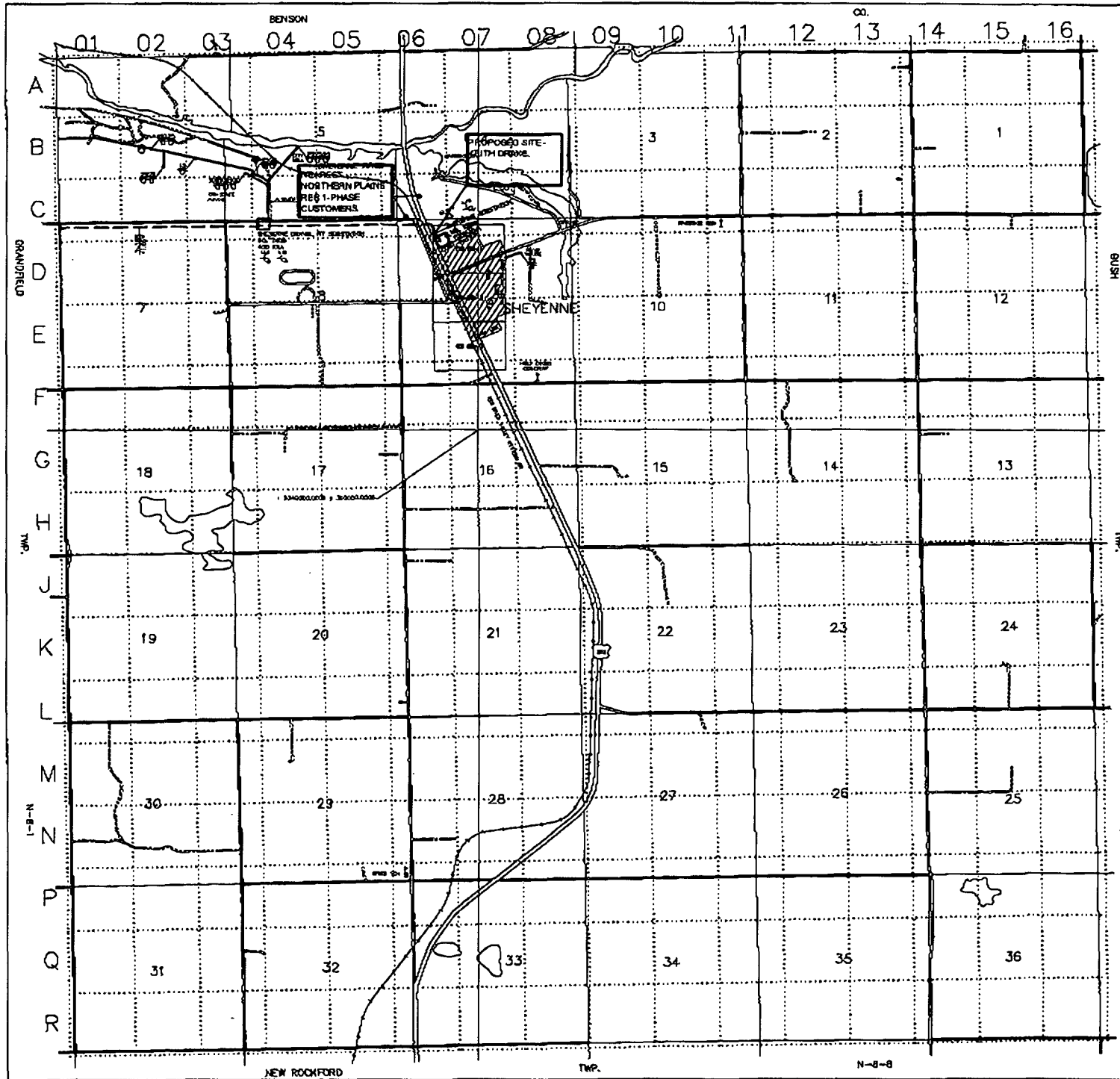

# GATES TOWNSHIP

## T-150-N : R-86-W EDDY COUNTY, NORTH DAKOTA

Scale: 1" = 2000'      9-25-2009  
BY: L. FETTER

North Dakota coordinate system, north zone  
(Lambert conformal conic)

Reference USGS 7.5 minute series  
quadrangle maps:  
Dorav SW, ND 1985  
Sheyenne, ND 1985

### LEGEND

**N-8-2**  
 EDDY COUNTY

REV: 5/20/08  
BY: L.F.

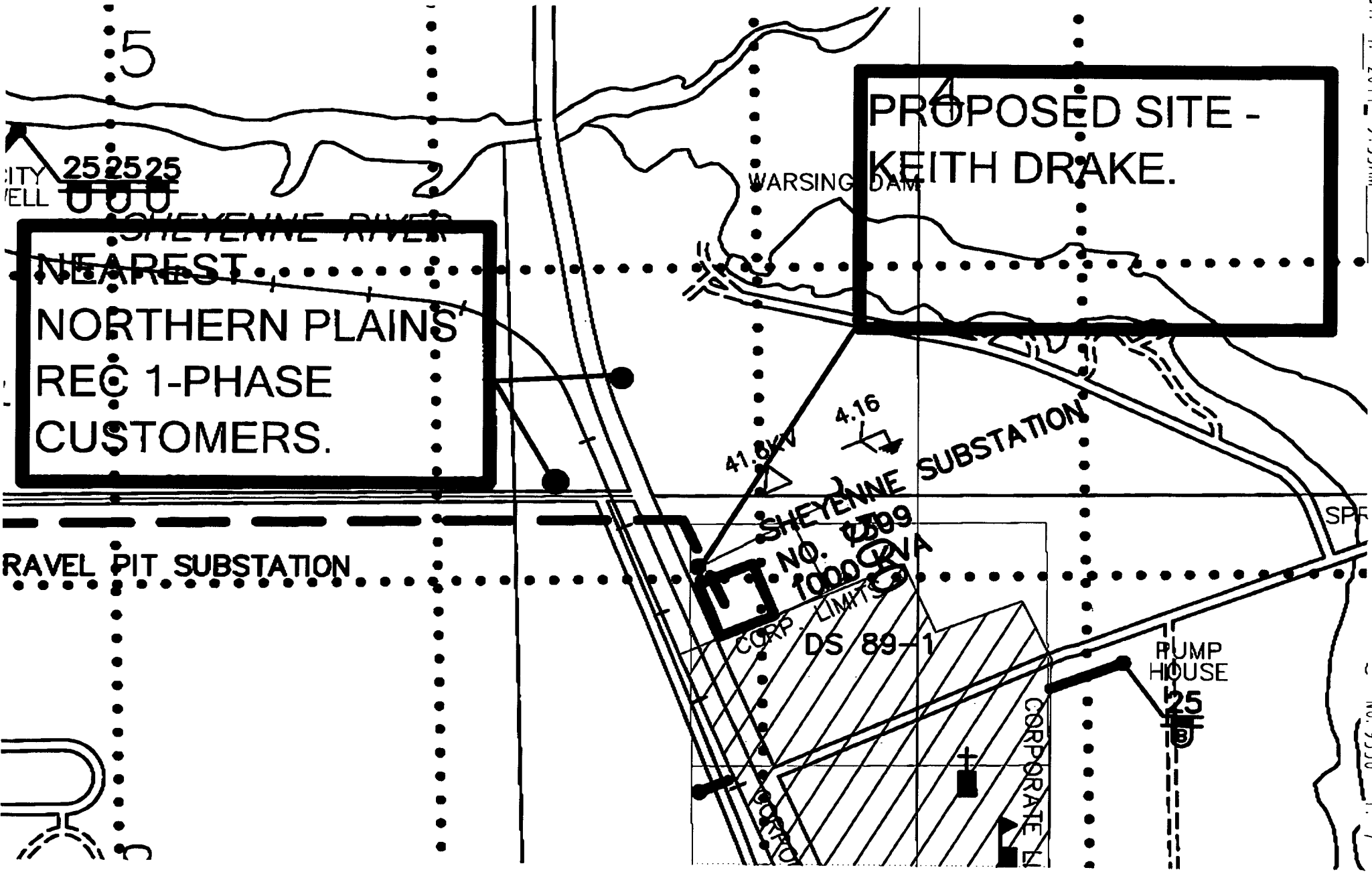

25 25 25  
CITY WELL

SHEYENNE RIVER  
NEAREST  
NORTHERN PLAINS  
REC 1-PHASE  
CUSTOMERS.

RAVEL PIT SUBSTATION

PROPOSED SITE -  
KEITH DRAKE.

WARSING DAM

41.8KV  
4.16  
SHEYENNE SUBSTATION

NO. 2399  
1000 CVA  
CORP. LIMITS

DS 89-1

CORPORATE LI

PUMP HOUSE  
25

