

STATE OF NORTH DAKOTA
PUBLIC SERVICE COMMISSION
 Enbridge Pipelines (North Dakota) LLC
 Beaver Lodge Loop Project - Williams, Mountrail & Ward Counties
 Siting Application

Case No. PU-10-613

NOTICE OF FILINGS, NOTICE OF INFORMAL HEARING, AND NOTICE OF OPPORTUNITY FOR HEARING
 May 17, 2012

The North Dakota Public Service Commission's (Commission) May 18, 2011 Findings of Fact, Conclusions of Law and Order issued to Enbridge Pipelines (North Dakota) LLC (Enbridge) a Certificate of Corridor Compatibility and a Route Permit for the construction of the Beaver Lodge Loop Project (Project) located in Williams, Mountrail, and Ward Counties, North Dakota. The Project consists of approximately 56 miles of 16-inch diameter pipeline and additional pump station facilities and tankage at Enbridge's existing Beaver Lodge, Stanley, and Berthold Stations.

In the May 18, 2011 Order the Commission granted Certificate of Corridor Compatibility No. 119 and Route Permit No. 129, providing in part: Construction along 61st Street NW between State Highway 8 and 82nd Avenue NW will not begin until Enbridge has submitted an Application for a route deviation in this area with sufficient materials showing that any modification of the corridor meets the requirements of the North Dakota Energy Conversion and Transmission Facility Siting Act and has received approval from the Commission to proceed.

On April 30, 2012, Enbridge submitted an Application for a route deviation for construction along 61st Street NW between State Highway 8 and 82nd Avenue NW in Section 33, Township 156 North, Range 91 West, in Mountrail County, North Dakota. On May 10, 2012, Enbridge filed an application for an amended certificate of corridor compatibility, an application for an amended route permit, and an application for waivers of procedures and time schedules. On May 14, 2012 Enbridge filed a revised route deviation application. The corridor and route changes are shown on the attached map.

In its application for waivers of procedures and time schedules, Enbridge requests that the Commission waive the following:

- Procedures that require separate filings of applications for a certificate of corridor compatibility and a route permit,
- Procedures that require separate notices of such applications,
- Procedures that require separate hearings on such applications,

- such applications,
 - Procedures that require a public hearing on an application for a certificate of corridor compatibility,
 - Procedures that require a public hearing on an application for a route permit.
- The issues to be considered in Enbridge's application for waiver of procedures and time schedules are:

1. Are the proposed facilities of such length, design, location, or purpose that they will produce minimal adverse effects and that adherence to applicable procedures and time schedules may be waived?
2. Is it appropriate for the Commission to waive any procedures and time schedules as requested in the application?

The issues to be considered in Enbridge's applications for amended certificate of corridor compatibility and amended route permit are:

1. Will the location, construction, and operation of the proposed facilities produce minimal adverse effects on the environment and upon the welfare of the citizens of North Dakota?
2. Are the proposed facilities compatible with the environmental preservation and the efficient use of resources?
3. Will the proposed facility locations minimize adverse human and environmental impact while ensuring continuing system reliability and integrity and ensuring that energy needs are met and fulfilled in an orderly and timely fashion?

Those interested are invited to comment on the applications in writing. Persons desiring a hearing must file a written request identifying their interest in the proceeding and the reasons for requesting a hearing. Comments and requests for hearing must be received by June 15, 2012. If deemed appropriate, the Commission can determine the matter without a hearing.

An Informal Hearing of this matter is scheduled to begin on June 20, 2012 at 1:45 p.m. CDT in the Commission Hearing Room on the 12th floor of the State Capitol. At the informal hearing, the Commission will discuss this matter with the parties and interested members of the public. For more information contact the Public Service Commission, State Capitol, Bismarck, North Dakota 58505, 701-328-2400; or Relay North Dakota, 1-800-366-6888 TTY. If you require any auxiliary aids or services, such as readers, signers, or Braille materials, please notify the Commission at least 24 hours in advance.

PUBLIC SERVICE COMMISSION
 Kevin Cramer, Commissioner
 Tony Clark, Chairman
 Brian P. Kalk, Commissioner
 (May 24, 2012)

Enbridge Pipelines (North Dakota) LLC
 Beaver Lodge Loop Project - Stanley Route Deviation

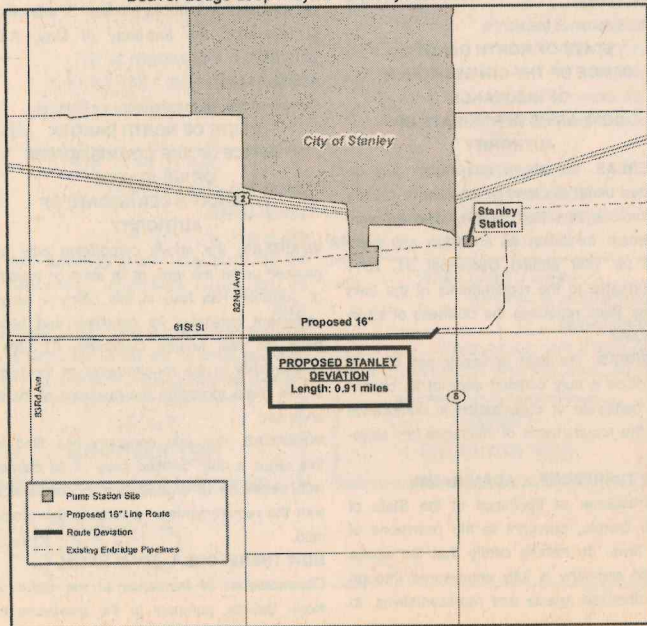

5/24 Williston

CARRIED: 5-0
 H. Economic Development
 1. STAR FUND
 a. Williston Basin Speedway - Community Build

STATE OF NORTH DAKOTA
PUBLIC SERVICE COMMISSION
 Enbridge Pipelines (North Dakota) LLC
 Little Muddy Station Connection Project - Williams County
 Siting Application

Case No. PU-11-606

NOTICE OF FILINGS, NOTICE OF INFORMAL HEARING, AND NOTICE OF OPPORTUNITY FOR HEARING
 May 17, 2012

The North Dakota Public Service Commission's (Commission) March 21, 2012 Findings of Fact, Conclusions of Law and Order issued to Enbridge Pipelines (North Dakota) LLC (Enbridge) a Certificate of Corridor Compatibility and a Route Permit for the construction of the Little Muddy Station Connection Project (Project) located in Williams County, North Dakota. The Project consists of a new pump station, terminal facility, and approximately 6 miles of 10-inch diameter crude oil pipeline.

On May 2, 2012, Enbridge filed a request for a route deviation in Section 35, Township 156 North, Range 100 West and in Section 36, Township 156 North, Range 100 West, in Williams County, North Dakota. On May 2, 2012, Enbridge filed an application for an amended certificate of corridor compatibility, an application for an amended route permit, and an application for waivers of procedures and time schedules. On May 14, 2012 Enbridge filed a revised route deviation application. The corridor and route changes are requested to avoid affecting a landowner. The corridor and route changes are shown on the attached map.

In its application for waivers of procedures and time schedules, Enbridge requests that the Commission waive the following:

- Procedures that require separate filings of applications for a certificate of corridor compatibility and a route permit,
- Procedures that require separate notices of such applications,
- Procedures that require separate hearings on such applications,
- Procedures that require a public hearing on an application for a certificate of corridor compatibility,
- Procedures that require a public hearing on an application for a route permit.

ENBRIDGE PIPELINES (NORTH DAKOTA) LLC
 LITTLE MUDDY STATION CONNECTION PROJECT ROUTE DEVIATION

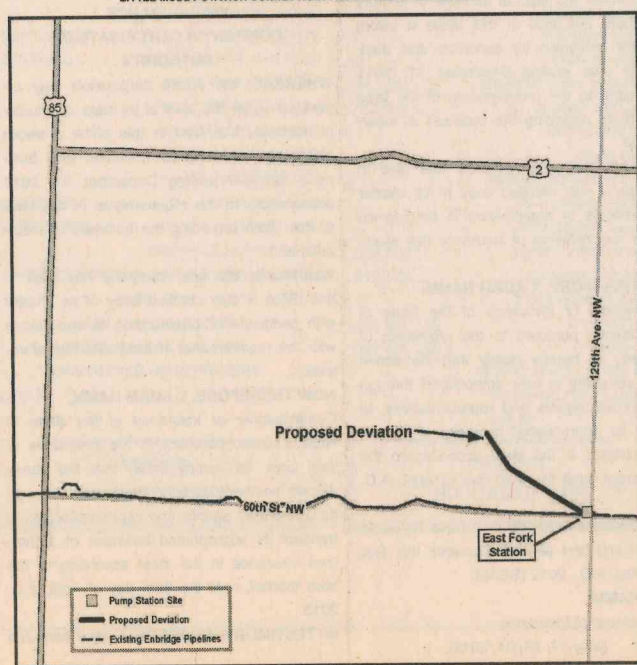

A. Nomination for Chuck Wilder - Cemetery Board
 Koester asked about the term, Klug replied this is a two-year term.
 MOTION BY CYMBALUK, 2ND BY KLUG, to

The issues to be considered in Enbridge's application for waiver of procedures and time schedules are:

1. Are the proposed facilities of such length, design, location, or purpose that they will produce minimal adverse effects and that adherence to applicable procedures and time schedules may be waived?
2. Is it appropriate for the Commission to waive any procedures and time schedules as requested in the application?

The issues to be considered in Enbridge's applications for amended certificate of corridor compatibility and amended route permit are:

1. Will the location, construction, and operation of the proposed facilities produce minimal adverse effects on the environment and upon the welfare of the citizens of North Dakota?
2. Are the proposed facilities compatible with the environmental preservation and the efficient use of resources?
3. Will the proposed facility locations minimize adverse human and environmental impact while ensuring continuing system reliability and integrity and ensuring that energy needs are met and fulfilled in an orderly and timely fashion?

Those interested are invited to comment on the applications in writing. Persons desiring a hearing must file a written request identifying their interest in the proceeding and the reasons for requesting a hearing. Comments and requests for hearing must be received by June 15, 2012. If deemed appropriate, the Commission can determine the matter without a hearing.

An Informal Hearing of this matter is scheduled to begin on June 20, 2012 at 2:00 p.m. CDT in the Commission Hearing Room on the 12th floor of the State Capitol. At the informal hearing, the Commission will discuss this matter with the parties and interested members of the public.

For more information contact the Public Service Commission, State Capitol, Bismarck, North Dakota 58505, 701-328-2400; or Relay North Dakota, 1-800-366-6888 TTY. If you require any auxiliary aids or services, such as readers, signers, or Braille materials, please notify the Commission at least 24 hours in advance.

PUBLIC SERVICE COMMISSION
 Kevin Cramer, Commissioner
 Tony Clark, Chairman
 Brian P. Kalk, Commissioner
 (May 24, 2012)

SU-7-993(042)043
 Length: 1.165
 : 2" MILL AN
 ACCIDENTALS
 County(s): WILLI
 Location: WILLI
 GATE AVENUE T
 TON 2ND ST W
 MAIN STREET
 Job No.: 29
 Project No(s): SS
 Length: 0.964
 Type: WIDENING
 LANES & TURN
 County(s): WILLI
 Location: ND 40
 TIOGA
 Bids will be rec
 2012, IN THE F
 FLOOR, OUTS
 NDDOT BUIL
 GROUNDS, IN
 KOTA. Bids will
 the bid result w
 online at http://
 proximately 30 m
 All bidders are
 least seven (7)
 bid opening.
 The proposal fo

99

ABSTR
 FOR
 DE

Stonington Insu
 In the state of T
 Total Assets
 Total Liabilities
 Aggregate write
 special surplus
 Common Capit
 Preferred Capit
 Aggregate write
 other than spec
 Surplus notes
 Gross paid in a
 Contributed sur
 Unassigned fur
 # shares comm
 # shares prefer
 Surplus as Reg
 Policyholders
 Total Liabilities
 and Surplus
NORTH D
FC
 Total Direct Pr
 Earned
 Total Direct Lo
 Incurred
 Total Accident
 Earned
 Total Accident
 Incurred

STAT
 OFFICE

I, Adam Ham
 of the State c
 tify that the
 Statement, as
 in this office.
 IN TESTIMON
 set my hand
 at Bismarck,
 2012(SEAL).
ADAM HAMM
 Commissioner
 STAT