

## Hamre, John G.

---

**From:** Lein, Jerry R.  
**Sent:** Wednesday, December 11, 2013 3:34 PM  
**To:** Daniel McCourtney (ALLETE) (dmccourtney@allete.com)  
**Cc:** David Moeller (ALLETE) (dmoeller@allete.com); Hamre, John G.  
**Subject:** FW: Minnesota Powers SW Oliver (PU-11-620)- Structure Changes (2)  
**Attachments:** SW Oliver (PU-11-620) structure move summary.pdf; bison\_103line\_structure39\_40.pdf

Dan – Please consider this email as staff approval of the structure location changes requested below and described in the attachments. Thanks.

Jerry Lein  
701 328-1035

---

**From:** Daniel McCourtney (ALLETE) [<mailto:dmccourtney@allete.com>]  
**Sent:** Friday, November 22, 2013 2:55 PM  
**To:** Lein, Jerry R.  
**Cc:** David Moeller (ALLETE)  
**Subject:** Minnesota Powers SW Oliver (PU-11-620)- Structure Changes (2)

Hello Jerry,

This is a follow-up on our conversation on Thursday November 21, 2013 about Minnesota Power's SW Oliver 230 kV Transmission Line (PU-11-620). Minnesota Power is proposing to move the locations of 2 structures (structures #39 & #40) on its SW Oliver Transmission Line. The changes in structure location are 35 & 25 feet respectively. In each case, the new location is along the existing transmission line centerline and within the 250 foot-wide project/survey corridor. The two structures were moved in order maintain a safe distance from project infrastructure and comply with Minnesota Power's internal line clearance standards. Attached is a table showing the structure numbers their old and new coordinates and the distance each structure will need to be moved.

Also, attached is a map depicting:

- The entire transmission line route.
- The 2 structure locations (both new and old)
- The project corridor, all moves are located within the project/survey corridor.

Please let me know if you need anything else or would like to discuss further. Thanks Jerry.

Regards,

Dan

### Daniel McCourtney

Siting and Permitting  
ALLETE/Minnesota Power  
30 West Superior St.  
Duluth, MN 55802

Phone: (218) 355-3515  
Cell: (218) 428-5089  
Fax: (218) 723-3916

55 PU-11-620 Filed: 12/11/2013 Pages: 3  
E-mail staff approval of structure location changes

Structure Number	Original coordinates		new coordinates		Distance Moved, (ft)
	Easting	Northing	Easting	Northing	
39	1,681,841.73	481,591.61	1681806.729	481592.089	35.00
40	1,682,631.65	481,580.69	1682606.652	481581.031	25.00

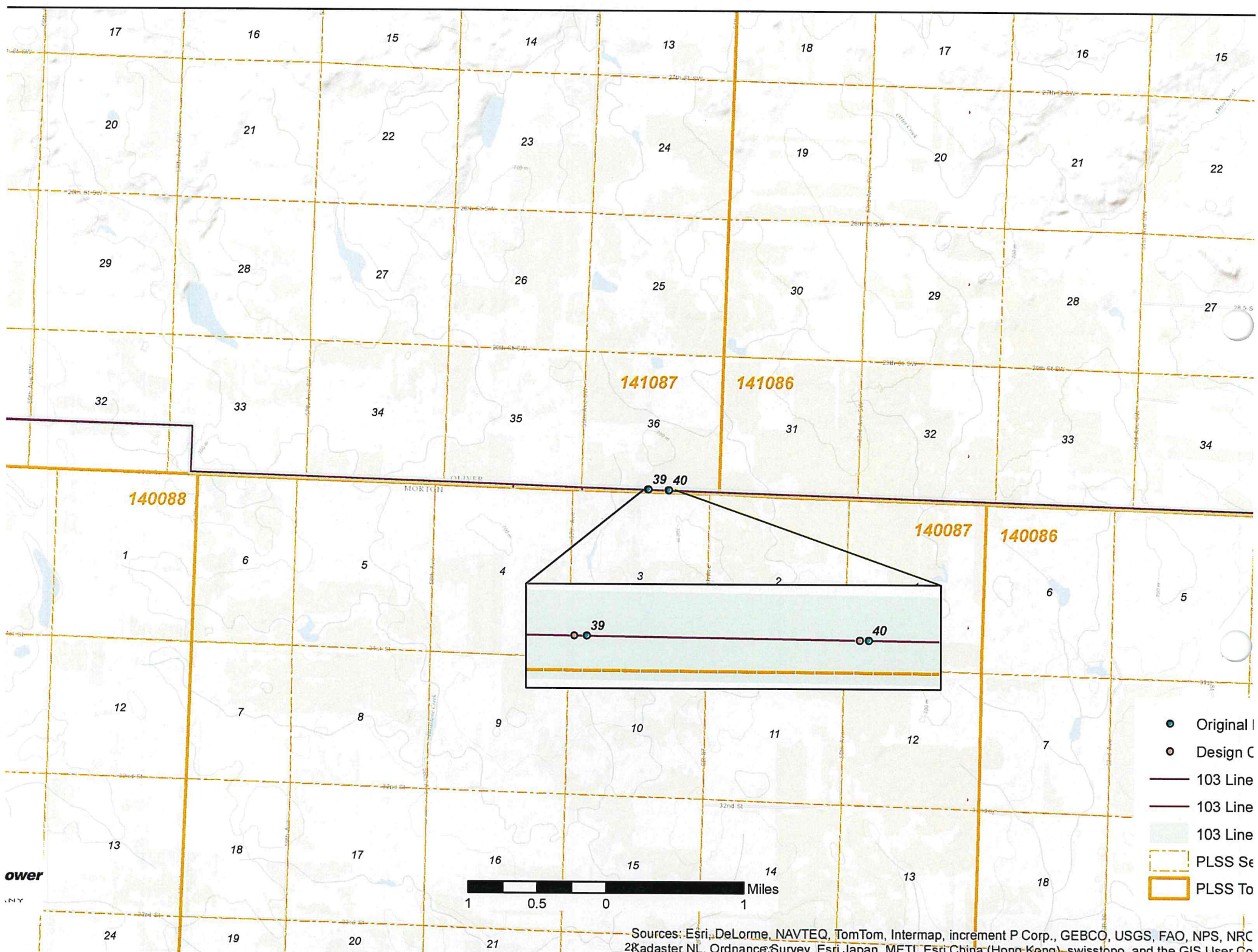

141087

141086

140088

140087

140086

- Original I
- Design C
- 103 Line
- 103 Line
- 103 Line
- - - PLSS Se
- ▭ PLSS To

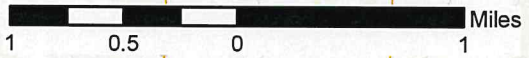

Sources: Esri, DeLorme, NAVTEQ, TomTom, Intermap, increment P Corp., GEBCO, USGS, FAO, NPS, NRC, Kadaster NL, Ordnance Survey, Esri Japan, METI, Esri China (Hong Kong), swisstopo, and the GIS User Co