

V:\PENNDATA\TBL\12500\12500.dwg  
 V:\PENNDATA\TBL\12500\12500.dwg  
 D-22434  
 12/5/2011 9:41:05 AM  
 DAW: D:\1110232\CADD\1110232 OVERALL SITE PLAN.dwg

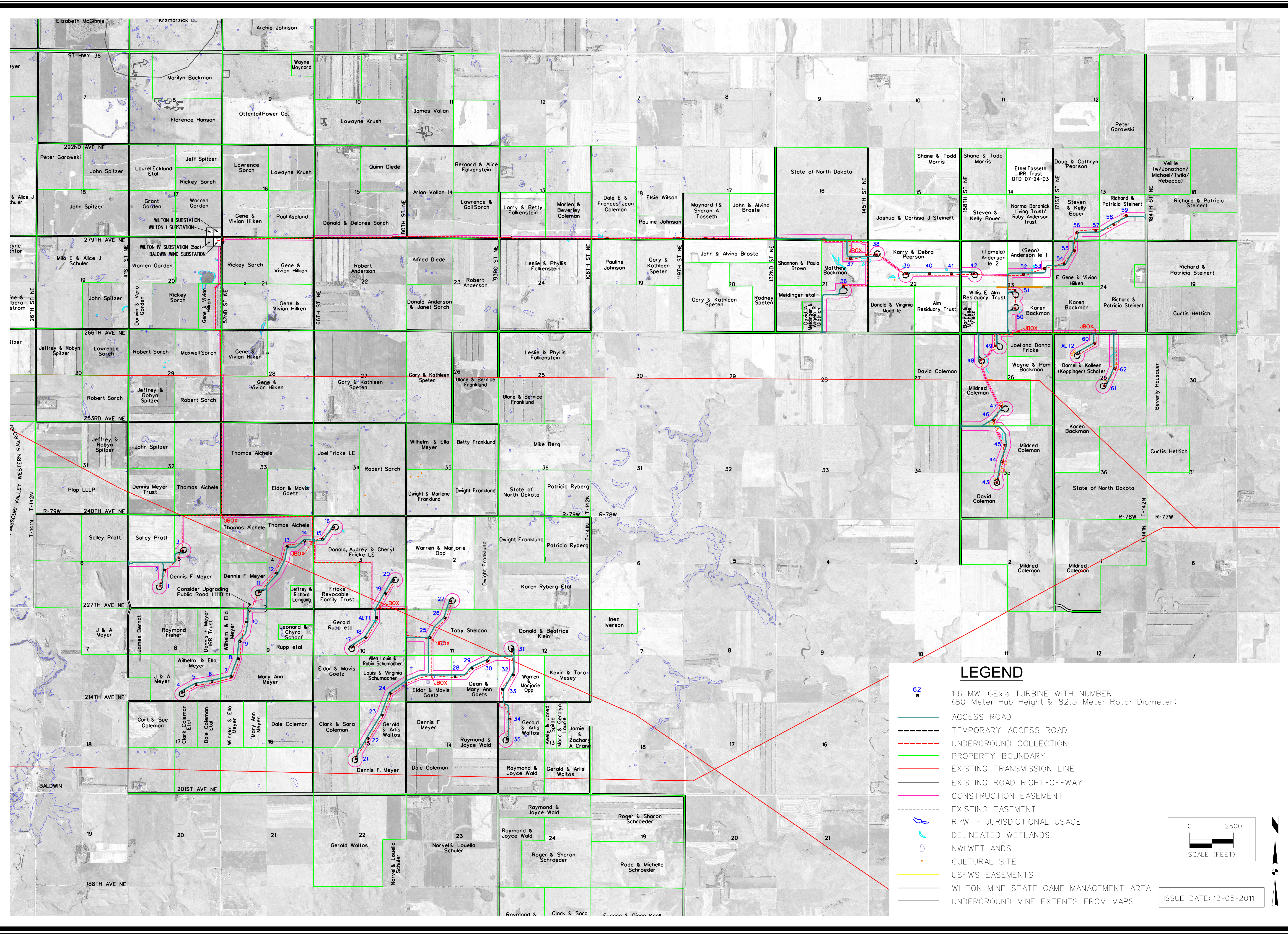

**LEGEND**

- 1.6 MW GxLE TURBINE WITH NUMBER (80 Meter Hub Height & 82.5 Meter Rotor Diameter)
- ACCESS ROAD
- TEMPORARY ACCESS ROAD
- UNDERGROUND COLLECTION
- PROPERTY BOUNDARY
- EXISTING TRANSMISSION LINE
- EXISTING ROAD RIGHT-OF-WAY
- CONSTRUCTION EASEMENT
- EXISTING EASEMENT
- RPW - JURISDICTIONAL USACE
- DELINEATED WETLANDS
- NWI WETLANDS
- CULTURAL SITE
- USFWS EASEMENTS
- WILTON MINE STATE GAME MANAGEMENT AREA
- UNDERGROUND MINE EXTENTS FROM MAPS

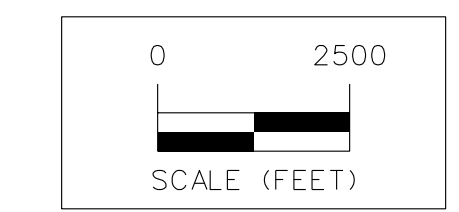

ISSUE DATE: 12-05-2011

17	ROAD SERVICE ROAD ALONG S SIDE OF STATE OF NORTH DAKOTA	12/25/11	DW
16	UPDATED WITH ARRAY DATED 11-17-11	11/18/11	DW
15	REMOVED TEMP RD AT PUBLIC RD ACCESS W OF 2 S S OF 36 & 50	11/18/11	DW
14	CHANGED COLLECTION ROUTE FROM NE 174 TO THE SE 174 - 20/19/23	11/16/11	DW
MARK REVISION			
Engineer:	JWK	Checked By:	MGG
Technician:	DW	Date:	08-04-11
Project No.:	1110232	Field Bk.:	
File No.:			

**NEXTERA ENERGY - WILTON IV**

**PRELIMINARY OVERALL SITE PLAN**

**SNYDER & ASSOCIATES**

BURLIEGH COUNTY, NORTH DAKOTA

1751 MADISON AVENUE  
COUNCIL BLUFFS, IOWA 51603  
712-322-3202

MARYVILLE, MO 660-882-8888  
ATLANTA, GA 770-243-8655  
ANNEKY, IA 515-564-2029  
ST. JOSEPH, MO 816-364-5222

1110232

Sheet 1 of 1