

315 Second Street Southeast
PO Box 2220
Jamestown, North Dakota 58402-2220
701 252-0540
800 257-4044
www.otpc.com

October 5, 2011



Darrell Nitschke, Secretary
North Dakota Public Service Commission
State Capitol – 12th Floor
Bismarck ND 58505-0480

Dear Mr.Nitschke:

Enclosed is an application in duplicate for a Certificate of Public Convenience and Necessity for Mike Whitmore.

Please address all correspondence regarding this application to Mr. Bruce Gerhardson, Associate General Counsel, Fergus Falls with a copy to me.

Yours very truly,

A handwritten signature in black ink, appearing to read "Charles Krebs", is written over the typed name.

Charles Krebs
Operations Manager
Otter Tail Power Company
PO Box 2220
Jamestown ND 58402 2220

Enclosure



TEMPORARY AUTHORITY PERMIT
NORTH DAKOTA PUBLIC SERVICE COMMISSION
PUBLIC UTILITIES
 SFN 50580 (8-96)

Date 9/26/11	Time 8:00	<input checked="" type="checkbox"/> a.m. <input type="checkbox"/> p.m.	Name of Utility OTTER TAIL POWER COMPANY	Telephone Number 800-257-4044
Name of Person Calling CHARLES KREBS			Name of Coop Serving CASS COUNTY ELECTRIC COOPERATIVE	
Name of Customer MIKE WHITMORE		Location Sec NE1/4-4 Twp 144-N R 55-W		
Address 13498 12TH ST SE			County CASS	
City HOPE			State ND	Zip Code 58046-9305
Name of Nearest City COLGATE			Distance to the City 1/4 MILE	
When will service be extended? OCTOBER 1, 2011		Type of Service <input type="checkbox"/> Residence <input type="checkbox"/> Storage <input checked="" type="checkbox"/> Grain Bin <input type="checkbox"/> Other _____		
Extension Length to Most Economical Point of Service Utility: 800 FT Coop: UNKNOWN		Extension <input type="checkbox"/> Overhead <input checked="" type="checkbox"/> Underground		
Has customer signed request for service? <input checked="" type="checkbox"/> Yes <input type="checkbox"/> No		Will cooperative protest application? <input type="checkbox"/> Yes <input checked="" type="checkbox"/> No		
Name of Person Contacted (PSC Use)		Date of Contact (PSC Use)	Time (PSC Use) <input type="checkbox"/> a.m. <input type="checkbox"/> p.m.	
Estimated Cost of Extension \$22,000		Estimated Revenue \$11,000		
Under what rate filed with the Public Service Commission will customer be served? 50-361				
Will extension cross over coop lines? <input type="checkbox"/> Yes <input checked="" type="checkbox"/> No		Will extension cross over railroad tracks? <input type="checkbox"/> Yes <input checked="" type="checkbox"/> No		
Temporary Authority Authorized By <input type="checkbox"/> Telephone <input type="checkbox"/> Letter		Date Authorized		
Authorized By (Name of Commissioner)				

Extension must be made from most economical point of service.

Comments:
 CASS COUNTY ELECTRIC COOPERATIVE CURRENTLY SERVES THE CUSTOMER WITH SINGLE PHASE SERVICE. CUSTOMER HAS REQUESTED THREE PHASE SERVICE FOR A BIN SYSTEM. AGREEMENT REACHED WITH DARYL BRANDT, CASS COUNTY ELECTRIC COOPERATIVE LINE SUPERINTENDENT, THAT OTTER TAIL POWER COMPANY CAN SERVE THE THREE PHASE LOAD TO THE BIN SITE BECAUSE THEY DO NOT HAVE THREE PHASE SERVICE AVAILABLE, BUT THEY WILL RETAIN THE SINGLE PHASE SERVICE.

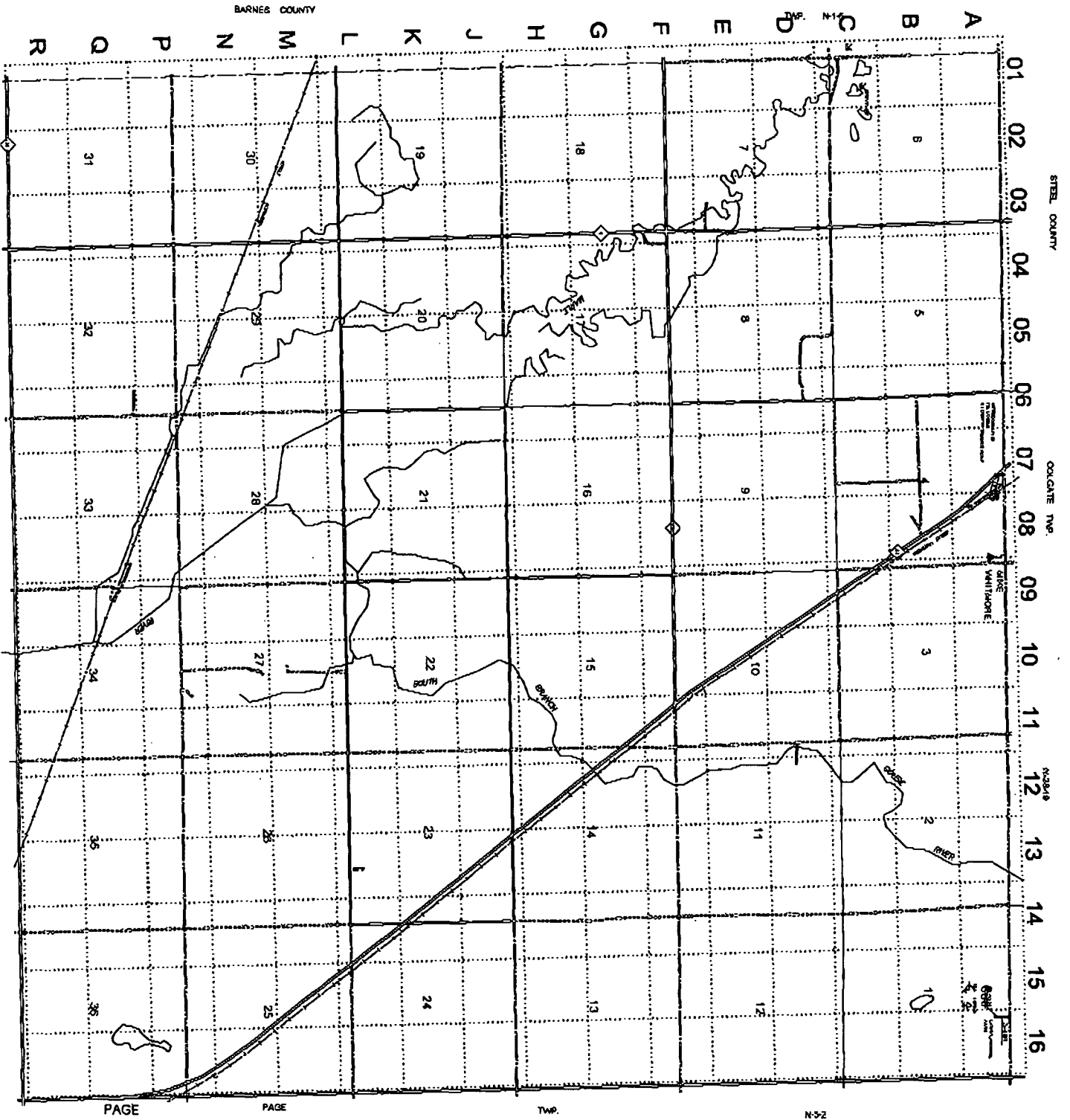

**ROCHESTER
TOWNSHIP**

**T-143-N : R-55-W
CASS COUNTY, NORTH DAKOTA**

Scale: 1" = 2000' 2-1/2" x 3-1/2"

BY: [Signature]

Reference: USGS 7.5 minute series
PAGE NO 1887
COR. GATE NO 1887

LEGEND

[Symbol]	1. Section	[Symbol]	10. Township Boundary
[Symbol]	2. Township	[Symbol]	11. Section Boundary
[Symbol]	3. Range	[Symbol]	12. Township Center
[Symbol]	4. County	[Symbol]	13. Section Center
[Symbol]	5. Township Center	[Symbol]	14. Township Corner
[Symbol]	6. Range Center	[Symbol]	15. Section Corner
[Symbol]	7. County Center	[Symbol]	16. Township Boundary
[Symbol]	8. Township Boundary	[Symbol]	17. Section Boundary
[Symbol]	9. Section Boundary	[Symbol]	18. Township Center

REV. 4/2009
BY: TMS

OTTER TAIL
N-5-1
CASS COUNTY