

**Plan View**  
Scale: 1"=30'

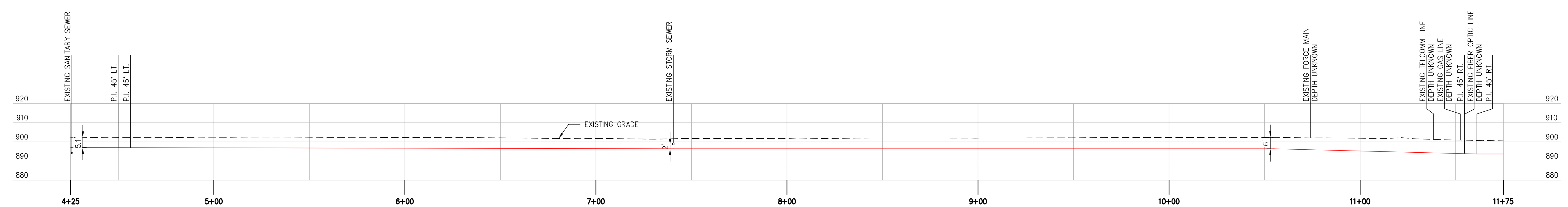

**Profile 6" Pipeline**  
Scale: 1"=30'

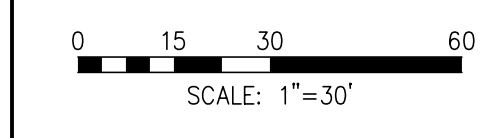
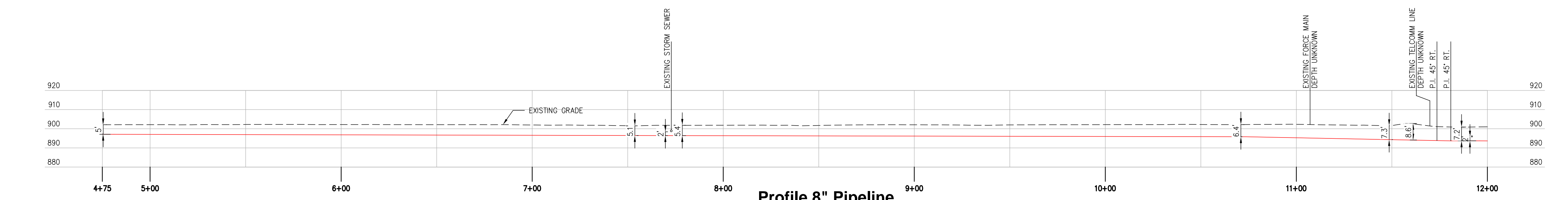

**Profile 8" Pipeline**  
Scale: 1"=30'

**FOR CLIENT REVIEW & APPROVAL**  
 DATE: 04-03-2012

1-800-795-0555 or 811

**It's the Law!**



DESIGN DATA	
DESIGN CODE:	ASME B31.4 D0T 195
MEASURED LENGTH:	TRENCH : TOTAL : RECLAIM :
DESIGN PRESSURES=	

PIPE SPECIFICATIONS	
EXISTING PIPE:	
REROUTED PIPE:	

LEGEND	
	EXISTING PIPELINE
	PROPOSED PIPELINE
	PIPELINE EASEMENT

- NOTES:**
1. THE MAGELLAN PIPELINE COMPANY, LP DOES NOT GUARANTEE THE ACCURACY OF THE INFORMATION SHOWN ON THIS DRAWING NOR DOES IT ACCEPT ANY RESPONSIBILITY FOR ERRORS IN LOCATION OR FOR FAILURE TO INDICATE ANY SUCH FACILITIES.
  2. CONTRACTOR TO LOCATE AND VERIFY ELEVATIONS OF ALL UNDERGROUND UTILITIES PRIOR TO BEGINNING CONSTRUCTION.
  3. A MINIMUM CLEARANCE OF 2 FEET BETWEEN THE PROPOSED PIPELINE AND ANY EXISTING FACILITIES SHALL BE MAINTAINED.
  4. CONTRACTOR TO INSTALL WARNING TAPE 2' ABOVE PIPELINE IN TRENCHES.
  5. ALL EXISTING PIPE BETWEEN TIE-IN POINTS SHALL BE RECLAIMED.

**ENGINEERS**  
**ARCHITECTS**  
**SURVEYORS**  
**SCIENTISTS**

**Farnsworth GROUP**  
 20 ALLEN AVENUE, SUITE 200  
 ST LOUIS, MISSOURI 63119  
 (314) 962-7900 / (314) 962-1253 Fax

REVISION NUMBER	DRAWN BY	DATE REVISED	CHECKED BY	PROJECT ENGINEER	APPROVED BY

**MAGELLAN**  
 MIDSTREAM PARTNERS, L.P.  
**MAGELLAN PIPELINE COMPANY, L.P.**

**RELOCATIONS OF THE 8" LINE AND 6" LINE FOR ROUTE 10 EXPANSION**

CASS COUNTY	NORTH DAKOTA
DRAWN BY: FGI/RCD	SCALE: 1" = 30'
DATE DRAWN: 03-27-12	A.F.E. ?
CHECKED BY: FGI/RMD	DRAWING NO.
PROJECT ENGINEER: CRD	<b>P&amp;P2</b>
APPROVED BY: ??	0