

400 North Fourth Street
Bismarck, ND 58501
(701) 222-7900

April 6, 2012

RECEIVED

APR 06 2012

Executive Secretary
North Dakota Public Service Commission
State Capitol – Department 408
600 East Boulevard Avenue
Bismarck, ND 58505-0480

PUBLIC SERVICE COMMISSION

RE: Case No. PU-12-____
Application for Permanent Authority to
Extend Service to Wayne Hepper at
Mandan, North Dakota

Montana-Dakota Utilities Co. (Montana-Dakota), a Division of MDU Resources Group, Inc., herewith respectfully submits an original and one copy of an Application for Permanent Authority to extend electric service to Wayne Hepper of Mandan, North Dakota at a location in the Section 2, Township 138N, Range 81W, Morton County, North Dakota.

Please acknowledge receipt by stamping or initialing the duplicate copy of this letter attached hereto and returning the same in the enclosed self-addressed, stamped envelope.

Sincerely,



Tamie A. Aberle
Regulatory Affairs Manager

Enclosures
cc/enc.

Mor-Gran-Sou Cooperative
Craig Lohstreter – MDU Bismarck Office

**BEFORE THE PUBLIC SERVICE COMMISSION
OF THE STATE OF NORTH DAKOTA**

In the Matter of the Application)
of MONTANA-DAKOTA UTILITIES CO.,)
a Division of MDU Resources Group,)
Inc., for an Order and Certificate to)
Extend Service to Wayne Hepper at)
Mandan, North Dakota)

Case No. PU-12-____

APPLICATION FOR PERMANENT AUTHORITY

MONTANA-DAKOTA UTILITIES CO., for its Application to the Public Service Commission of North Dakota, respectfully alleges:

I.

The full name of Applicant is Montana-Dakota Utilities Co., a Division of MDU Resources Group, Inc., and the post office address of its principal office is 400 North Fourth Street, Bismarck, North Dakota 58501. Applicant is a public utility subject to the jurisdiction of and regulation by the Public Service Commission of North Dakota, under Title 49, N.D.C.C., as amended. MDU Resources Group, Inc.'s Certificate of Incorporation is incorporated herein by reference, and the Commission is requested to take official notice of the same.

II.

This Application is made pursuant to the provisions of Chapter 49-03, N.D.C.C., as amended, and the Rules of Practice and Procedure promulgated by the Commission.

III.

Application has been requested by Wayne Hepper, hereinafter referred to as "Customer," to provide electric service to him at a point located in Section 2, Township

138N, Range 81W, Morton County, North Dakota as shown on the map attached hereto, marked Exhibit A, and made a part hereof by reference. Customer will need electric service by April 23, 2012.

IV.

The service required by Customer at said location is single phase service, and the length of the extension will be approximately 5 feet. The location of the proposed service is within the economic service area of Applicant and service will be extended under the provisions of the rules and regulations applicable thereto. It is Applicant's public utility obligation to furnish the requested service, and the public convenience and necessity requires, and will be served by, Applicant furnishing the requested service to this Customer at said location. The Temporary Authority Permit is attached as Exhibit B.

V.

Submitted as Exhibit C with this Application is an Appearance by Customer herein, in which Customer states to the Commission that he desires electric service from Applicant as a public utility subject to the jurisdiction of, and regulation by, this Commission. In said Appearance, Customer also waives Notice of Opportunity for Hearing and Notice of Hearing upon this Application, or a hearing thereon, and requests the Commission to issue an Order and Certificate of Public Convenience and Necessity authorizing this requested and needed service.

VI.

The extension will not cross any railroad tracks.

WHEREFORE, Applicant requests the entry of an Order and Certificate of Public Convenience and Necessity authorizing Applicant to extend the requested and needed service to Customer.

MONTANA-DAKOTA UTILITIES CO.
a Division of MDU Resources Group, Inc.

By: Tamie A. Aberle
Tamie A. Aberle
Regulatory Affairs Manager

STATE OF NORTH DAKOTA)
)ss.
COUNTY OF BURLEIGH)

Tamie A. Aberle, being first duly sworn, on oath deposes and says that she is the Regulatory Affairs Manager of Montana-Dakota Utilities Co., a Division of MDU Resources Group, Inc., the Applicant herein, and makes this verification on its behalf; that she has read the foregoing Application and knows the contents thereof, and that the statements made and contained therein are true and correct to the best of her information, knowledge, and belief.

Tamie A. Aberle
Tamie A. Aberle

SUBSCRIBED AND SWORN to before me this 6th day of April 2012.

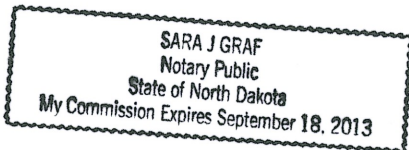

(S E A L)

Sara J. Graf
Sara J. Graf, Notary Public
Burleigh County, North Dakota
My Commission Expires: 9/18/2013

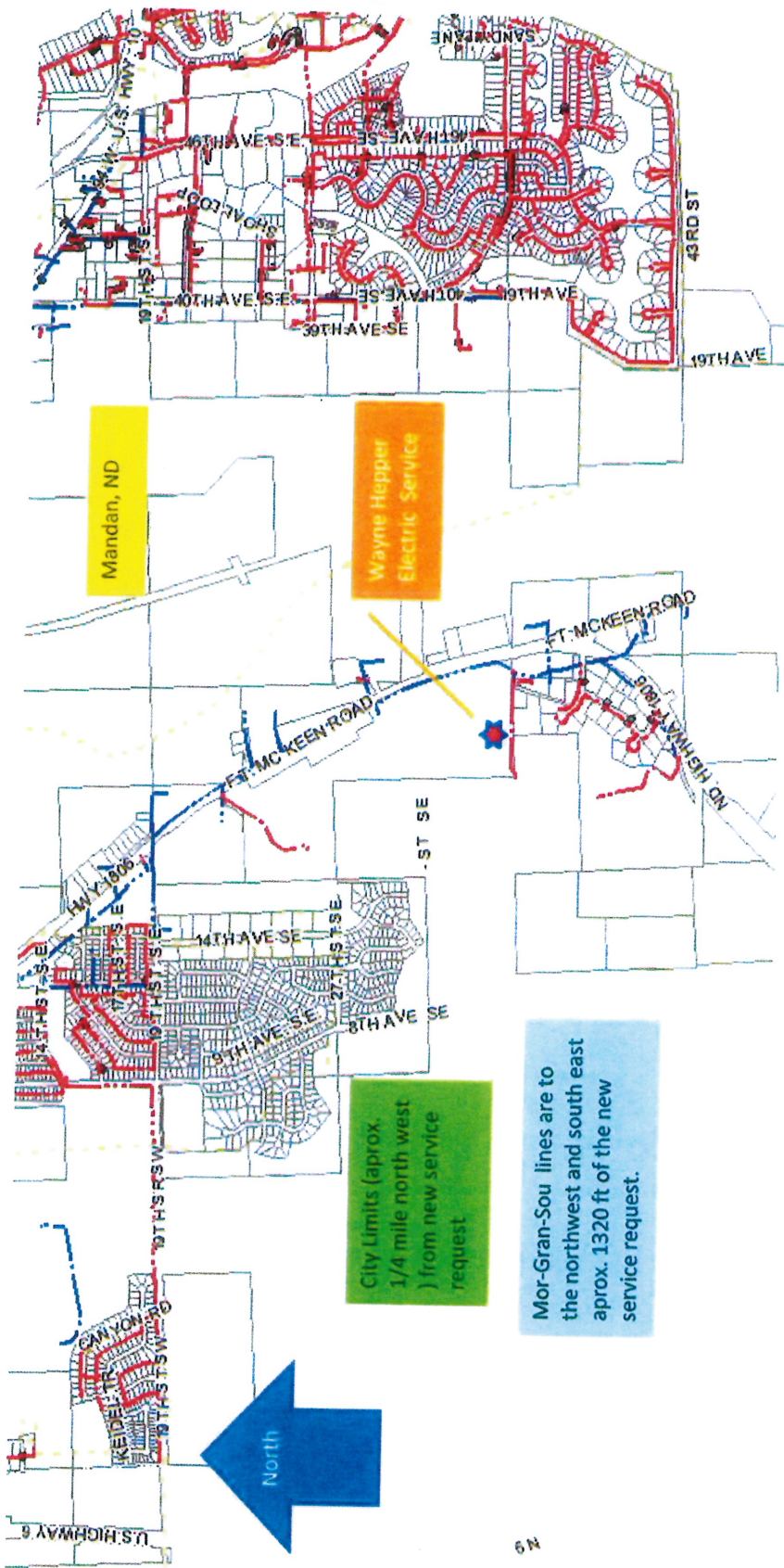



TEMPORARY AUTHORITY PERMIT
NORTH DAKOTA PUBLIC SERVICE COMMISSION
PUBLIC UTILITIES
 SFN 50560 (6-96)

EXHIBIT B

Date 03/30/12	Time 10:00	<input checked="" type="checkbox"/> a.m. <input type="checkbox"/> p.m.	Name of Utility Montana-Dakota Utilities	Telephone Number 1-701-224-5815
Name of Person Calling Craig Lohstreter			Name of Coop Serving Mor-Gran-Sou	
Name of Customer Wayne Hepper		Location Sec 2 Twp 138N R 81W		
Address South Hwy 1806			County Morton	
City Mandan			State ND	Zip Code 58563
Name of Nearest City Mandan			Distance to the City 1 1/4 Mile to the Northwest	
When will service be extended? April 23, 2012		Type of Service <input type="checkbox"/> Residence <input type="checkbox"/> Storage <input type="checkbox"/> Grain Bin <input checked="" type="checkbox"/> Other riding arena		
Extension Length to Most Economical Point of Service Utility: 5 ft Coop: 1,320 ft		Extension <input type="checkbox"/> Overhead <input checked="" type="checkbox"/> Underground		
Has customer signed request for service? <input checked="" type="checkbox"/> Yes <input type="checkbox"/> No		Will cooperative protest application? <input type="checkbox"/> Yes <input type="checkbox"/> No		
Name of Person Contacted (PSC Use)		Date of Contact (PSC Use)	Time (PSC Use) <input type="checkbox"/> a.m. <input type="checkbox"/> p.m.	
Estimated Cost of Extension \$2,500		Estimated Revenue \$300 annual		
Under what rate filed with the Public Service Commission will customer be served? 20				
Will extension cross over coop lines? <input type="checkbox"/> Yes <input checked="" type="checkbox"/> No		Will extension cross over railroad tracks? <input type="checkbox"/> Yes <input checked="" type="checkbox"/> No		
Temporary Authority Authorized By <input type="checkbox"/> Telephone <input type="checkbox"/> Letter		Date Authorized 2 Apr 2012		
Authorized By (Name of Commissioner) 				

Extension must be made from most economical point of service.

Comments:
 Will cut into an existing electric underground primary line and set a padmount transformer. The customer will then be setting his own electric meter pedestal by the transformer which he will take it from there going to the riding arena.

BEFORE THE PUBLIC SERVICE COMMISSION
OF THE STATE OF NORTH DAKOTA

In the Matter of the Application
of Montana-Dakota Utilities Co.,
a Division of MDU Resources Group, Inc.

CASE NO. _____

APPEARANCE BY CUSTOMER

Wayne Hepper

hereinafter referred to as "Customer", hereby makes a voluntary appearance in this matter and states the following to the Commission:

I.

That he (it) desires electric service from Montana-Dakota Utilities Co. As a public utility subject to the jurisdiction of, and regulation by, this Commission, and has requested said public utility to provide him (it) with immediate electric service at the point located as stated in the Application herein.

That customer further states that he (it) is in need of and has demanded immediate service at said location for the reasons set forth in the Application herein. Customer waives notice of opportunity for hearing and notice of hearing upon said Application, or a hearing thereon, and requests the Commission to issue an Order and Certificate of Public Convenience and Necessity authorizing this requested and needed service, and that provisions be made therein authorizing extension of immediate service.

II.

That all the allegations of the Application herein are true and correct.

WHEREFORE, the undersigned, being the Customer involved herein, prays for the entry of an Order and Certificate of Public Convenience and Necessity by the Commission, authorizing the Applicant to immediately extend the requested and needed service to Customer at said location, subject to such appropriate and proper conditions to be appended to and made a part of such Temporary Order and Certificate as the Commission may determine, said Temporary Order and Certificate to become final as may be set forth in the conditions appended thereto; and for such other and further relief as may be proper in the premises.

Dated:

3/29/12

Wayne Hopper
(Customer)