



TEMPORARY AUTHORITY PERMIT
NORTH DAKOTA PUBLIC SERVICE COMMISSION
PUBLIC UTILITIES
 SFN 50560 (6-96)

Date 3-30-2012	Time 8:00	<input checked="" type="checkbox"/> a.m. <input type="checkbox"/> p.m.	Name of Utility Montana-Dakota Utilities Co.	Telephone Number 701-224-5815
Name of Person Calling Craig Lohstreter			Name of Coop Serving Rough Rider Electric	
Name of Customer Basin Transload LLC		Location Sec 19 Twp 144N R 88W		
Address 6550 County Road 20			County Mercer	
City Beulah			State ND	Zip Code 58523
Name of Nearest City Zap, ND			Distance to the City Approximately 1.25 Miles	
When will service be extended? May, 2012		Type of Service <input type="checkbox"/> Residence <input type="checkbox"/> Storage <input type="checkbox"/> Grain Bin <input checked="" type="checkbox"/> Other <u>Commercial</u>		
Extension Length to Most Economical Point of Service Utility: 5,500' Coop: 7,900'		Extension <input type="checkbox"/> Overhead <input checked="" type="checkbox"/> Underground		
Has customer signed request for service? <input checked="" type="checkbox"/> Yes <input type="checkbox"/> No		Will cooperative protest application? <input type="checkbox"/> Yes <input type="checkbox"/> No		
Name of Person Contacted (PSC Use)		Date of Contact (PSC Use)	Time (PSC Use) <input type="checkbox"/> a.m. <input type="checkbox"/> p.m.	
Estimated Cost of Extension \$78,000		Estimated Revenue \$18,000 Annually		
Under what rate filed with the Public Service Commission will customer be served? General Electric Service Rate 30				
Will extension cross over coop lines? <input type="checkbox"/> Yes <input checked="" type="checkbox"/> No		Will extension cross over railroad tracks? <input type="checkbox"/> Yes <input checked="" type="checkbox"/> No		
Temporary Authority Authorized By <input type="checkbox"/> Telephone <input type="checkbox"/> Letter		Date Authorized		
Authorized By (Name of Commissioner)				

Extension must be made from most economical point of service.

Comments:
 MDU serves Basin Transload's first facility and to serve the new facility there will be a three phase extension to Basin Transload's 2nd facility. This new facility is approximately one mile east of their existing facility located at 6550 East County Road. The underground circuit will cross under BNSF railroad spur. The 7,900' distance to the REC is only an estimate as exact location of REC line is uncertain.

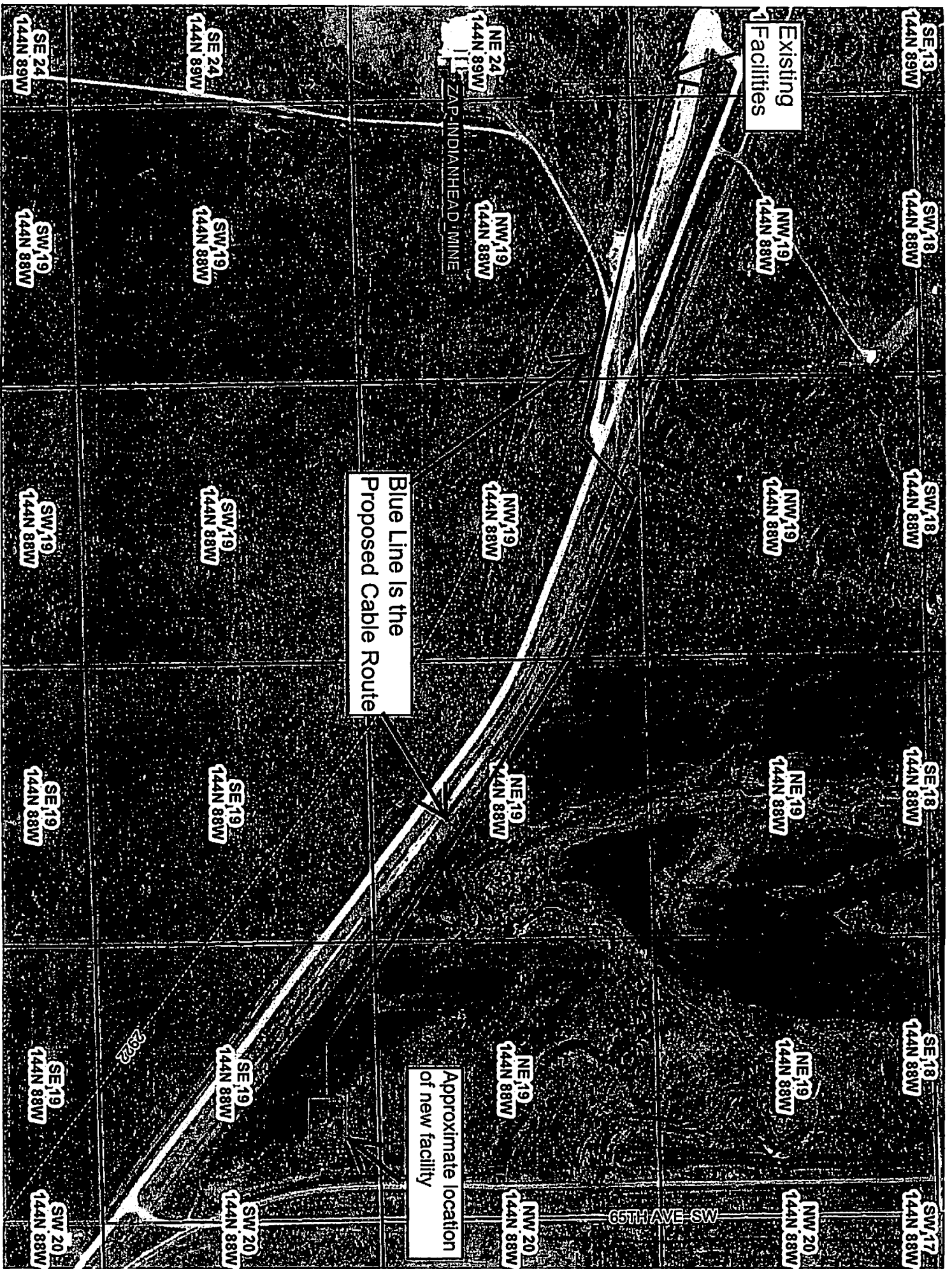

Existing Facilities

Blue Line Is the Proposed Cable Route

Approximate location of new facility

65TH AVE SW

ZAP INDIAN HEAD ENGINE

SE 13
144N 89W

SW 18
144N 88W

SW 18
144N 88W

SE 18
144N 88W

SE 18
144N 88W

SW 17
144N 88W

NW 19
144N 88W

NW 19
144N 88W

NE 19
144N 88W

NE 19
144N 88W

NW 20
144N 88W

NE 24
144N 89W

NW 19
144N 88W

NW 19
144N 88W

NE 19
144N 88W

NE 19
144N 88W

NW 20
144N 88W

SE 24
144N 89W

SW 19
144N 88W

SW 19
144N 88W

SE 19
144N 88W

SE 19
144N 88W

SW 20
144N 88W

SE 24
144N 89W

SW 19
144N 88W

SW 19
144N 88W

SE 19
144N 88W

SE 19
144N 88W

SW 20
144N 88W

2322

BEFORE THE PUBLIC SERVICE COMMISSION
OF THE STATE OF NORTH DAKOTA

In the Matter of the Application of
Montana-Dakota Utilities Co.,
a Division of MDU Resources Group, Inc.

Case No. _____

APPEARANCE BY CUSTOMER

Basin Transload LLC

hereinafter referred to as "Customer", hereby makes a voluntary appearance in this matter and states the following to the Commission:

I.

That he (it) desires electric service from Montana-Dakota Utilities Co. as a public utility subject to the jurisdiction of, and regulation by, this Commission, and has requested said public utility to provide him (it) with immediate electric service at the point located as stated in the Application herein.

That customer further states that he (it) is in need of and has demanded immediate service at said location for the reasons set forth in the Application herein. Customer waives notice of opportunity for hearing and notice of hearing upon said Application, or a hearing thereon, and requests the Commission to issue an Order and Certificate of Public Convenience and Necessity authorizing this requested and needed service, and that provisions be made therein authorizing extension of immediate service.

II.

That all the allegations of the Application herein are true and correct.

WHEREFORE, the undersigned, being the Customer involved herein, prays for the entry of an Order and Certificate of Public Convenience and Necessity by the Commission, authorizing the Applicant to immediately extend the requested and needed service to Customer at said location, subject to such appropriate and proper conditions to be appended to and made a part of such Temporary Order and Certificate as the Commission may determine, said Temporary Order and Certificate to become final as may be set forth in the conditions appended thereto; and for such other and further relief as may be proper in the premises.

Dated: 3/29/2012

Ray W. Sheldon
(Customer)