

Hamre, John G.

From: -Info-Public Service Commission
Sent: Wednesday, June 20, 2012 11:07 AM
To: Hamre, John G.
Subject: FW: Map Attachment for Case No. PU-12-196
Attachments: Attachment A - MEC and MWEK Territory Boundaries (2).pdf

From: Martin Dahl [<mailto:martindd@mcleanelectric.com>]
Sent: Wednesday, June 20, 2012 10:00 AM
To: -Info-Public Service Commission; Lein, Jerry R.
Cc: Leah Johnson Ellis; Dale Haugen; david@lindellawoffice.com
Subject: Map Attachment for Case No. PU-12-196

Attached is the territorial boundary map needed to complete the filing.
Thanks Everyone,

Martin D. Dahl P.E.
General Manager/ CEO
McLean Electric Cooperative, Inc.
(701) 463-2291 Work
(701) 340-5637 Cell

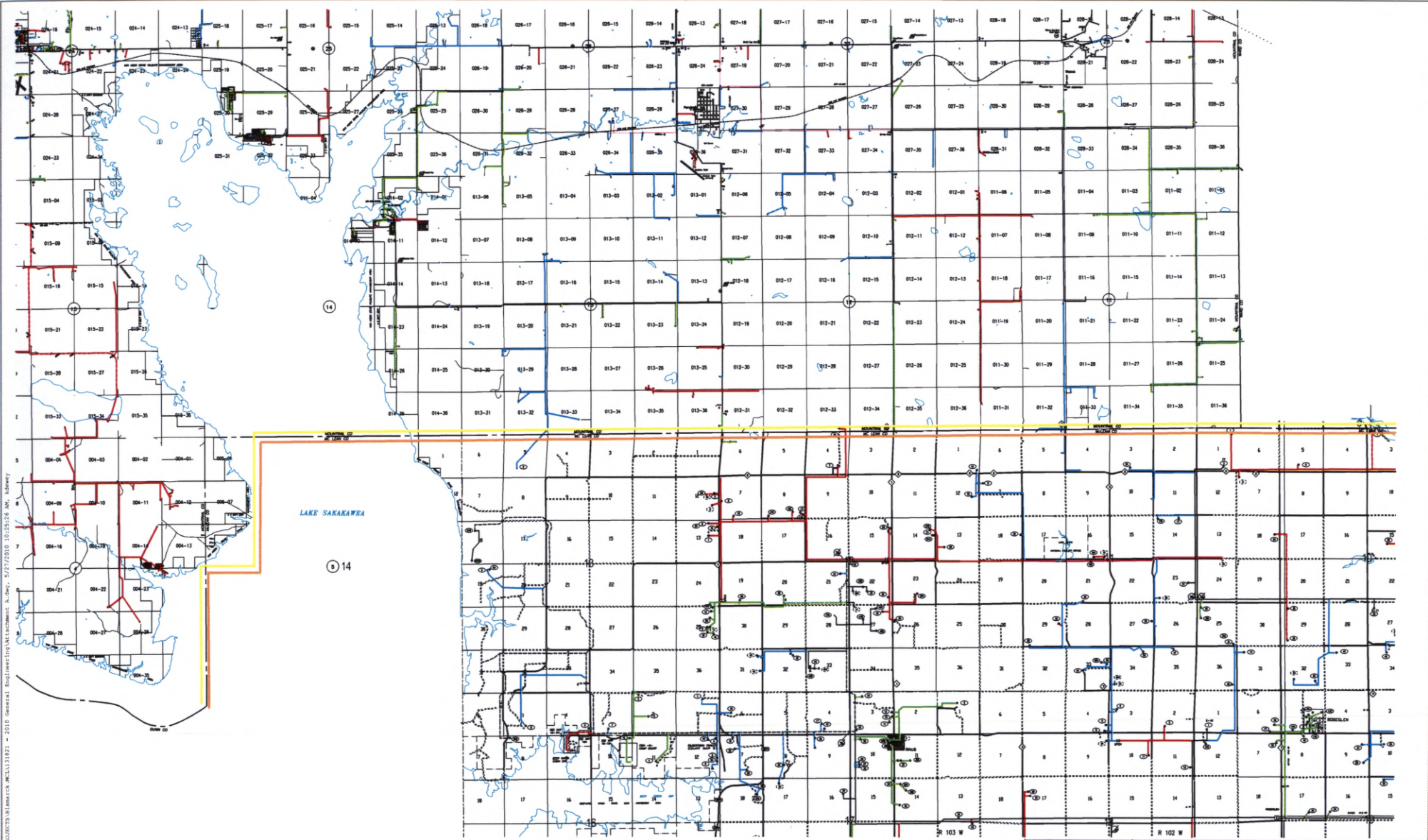

\Users\p41418\Documents\GIS\Projects\GIS\Projects\MCL131821 - 2010\050613 - 050613\Attachment A.dwg, 4/27/2010 10:23:26 AM, Ldwby

LEGEND

- MCLEAN ELECTRIC SERVICE BOUNDARY
- MOUNTRAIL-WILLIAMS ELECTRIC BOUNDARY

Scale: NONE
Proj. No.: MCL131821.001
File: ATTACHMENT A
Revised: 05/26/10
Plotted: 05/26/10 17:43

ATTACHMENT A
TERRITORY BOUNDARIES