

Exam Date: 06/27/2012

Co-op Elevator of McClusky

Page: 1

Examiner: 1

PO Box 469

McClusky, ND

County:

Phone: 701-363-2529

CCC Number:

Location/Container Numbers/Comments	Section	Capacity	
<b>PART A - ADDITIONAL SPACE TO BE INCLUDED UNDER LICENSE</b>			
201	B	3,129	
202	B	3,129	
203	B	3,129	
204	B	3,129	
205	B	3,522	
206	B	3,522	
	<b>Total:</b>	<b>19,560</b>	
<b>PART B - SPACE TO BE DELETED UNDER LICENSE</b>			
018	A	1,518	
023 T	A	3,816	
023 B	A	1,174	
024 T	A	3,816	
024 B	A	1,174	
025 T	A	3,816	
025 B	A	1,387	
026 T	A	3,816	
026 B	A	1,387	
101	A	37,081	
102	A	37,081	
	<b>Total:</b>	<b>96,066</b>	
<b>PART C - ALL SPACE TO BE INCLUDED UNDER LICENSE</b>			
	A	269,000	
	B	80,000	
	C	50,000	
	<b>Total:</b>	<b>399,000</b>	
<b>PART D - TOTAL CAPACITY BY FUNCTIONAL UNIT</b>			
McClusky	12	A B C	399,000
		<b>Total:</b>	<b>399,000</b>

Exam Date:06/27/2012

Co-op Elevator of McClusky

Page: 1

Examiner: 1

PO Box 469  
McClusky, ND  
County:

Status	Section	Bin Number	Bin Type	Base Point	Diameter or Bu/Ft (Irreg).		Side wall	Add for Hopper	Ded. for Obst.	Effective Depth	Add for Peak	Depth for Capac.	Bushels per Foot	Base Pack%	Bushel Capacity with Pack	
					Length	Width										
	<b>A</b>	001	Peaked		36.000	0.000	0.000	39.00	0.00	0.00	39.000	2.200	41.2	818.2	10.0	37,081
	A	002	Square		0.000	11.50	11.50	41.75	1.70	0.00	43.450	0.000	43.5	106.3	6.20	4,911
	A	003	Square	work floor	0.000	11.50	11.50	41.75	1.70	0.00	43.450	0.000	43.5	106.3	6.20	4,911
	A	004	Square	work floor	0.000	11.50	5.250	41.75	2.40	0.00	44.150	0.000	44.2	48.5	4.20	2,234
	A	005	Square	work floor	0.000	11.50	11.50	41.75	1.70	0.00	43.450	0.000	43.5	106.3	6.20	4,911
	A	007	Square	work floor	0.000	11.50	11.50	41.75	1.70	0.00	43.450	0.000	43.5	106.3	6.20	4,911
	A	008	Square	work floor	0.000	11.50	11.50	41.75	1.70	0.00	43.450	0.000	43.5	106.3	6.20	4,911
	A	009	Square	work floor	0.000	11.50	11.50	41.75	1.70	0.00	43.450	0.000	43.5	106.3	6.20	4,911
	A	010	Square	work floor	0.000	11.50	5.250	41.75	2.40	0.00	44.150	0.000	44.2	48.5	4.20	2,234
	A	011	Square	work floor	0.000	11.50	11.50	41.75	1.70	0.00	43.450	0.000	43.5	106.3	6.20	4,911
	A	012	Square	work floor	0.000	11.50	11.50	41.75	1.70	0.00	43.450	0.000	43.5	106.3	6.20	4,911
	A	013	Square	work floor	0.000	11.50	11.50	41.75	1.70	0.00	43.450	0.000	43.5	106.3	6.20	4,911
	A	014	Peaked		47.850	9.900	9.300	43.00	0.00	0.00	43.000	2.900	45.9	1445.6	10.0	72,988
	A	015	Peaked		36.000	0.000	0.000	39.00	0.00	0.00	39.000	2.200	41.2	818.2	10.0	37,081
	A	016	Peaked		47.850	9.900	4.700	43.00	0.00	0.00	43.000	2.900	45.9	1445.6	10.0	72,988

Bin count: 15

Facility: McClusky Section: A Total: 268,805

To Even: 269,000

**Section: B**

B	001	Square	work floor		0.000	11.30	7.600	44.50	0.00	0.00	44.500	0.000	44.5	69.0	5.20	3,231
B	002	Square	work floor		0.000	6.000	4.700	28.00	0.00	0.00	28.000	0.000	28.0	22.7	2.00	649
B	003 T	Square	work floor		0.000	2.700	1.500	16.00	0.00	0.00	16.000	0.000	16.0	3.3	2.00	54
B	003 B	Square	work floor - top 16'		0.000	7.600	2.700	15.50	0.00	0.00	15.500	0.000	15.5	16.5	2.00	261

Exam Date:06/27/2012

Co-op Elevator of McClusky

Page: 2

Examiner: 1

PO Box 469  
McClusky, ND  
County:

Status	Section	Bin Number	Bin Type	Base Point	Diameter or Bu/Ft (Irreg).		Side wall	Add for Hopper	Ded. for Obst.	Effective Depth	Add for Peak	Depth for Capac.	Bushels per Foot	Base Pack%	Bushel Capacity with Pack	
					Length	Width										
	B	004	Square	work floor	0.000	5.800	2.700	16.00	0.00	0.00	16.000	0.000	16.0	12.6	2.00	206
	B	005	Square	work floor	0.000	11.30	4.600	28.00	0.00	0.00	28.000	0.000	28.0	41.8	3.50	1,211
	B	006	Square	work floor	0.000	10.30	5.400	26.00	0.00	0.00	26.000	0.000	26.0	44.7	3.50	1,203
	B	007	Square	work floor	0.000	11.30	5.300	44.50	0.00	0.00	44.500	0.000	44.5	48.1	4.20	2,230
	B	009	Square	work floor	0.000	11.30	5.300	44.50	0.00	0.00	44.500	0.000	44.5	48.1	4.20	2,230
	B	010 T	Irregular	work floor 10.3 x 5.4 less	16.500	0.000	0.000	9.000	0.00	0.00	9.000	0.000	9.0	16.5	2.00	152
	B	010 B	Square	work floor - top 9'	0.000	10.30	5.400	17.00	0.00	0.00	17.000	0.000	17.0	44.7	3.50	787
	B	011	Square	work floor	0.000	11.30	4.600	44.50	0.00	0.00	44.500	0.000	44.5	41.8	3.50	1,925
	B	012	Square	work floor	0.000	5.400	4.700	31.50	0.00	0.00	31.500	0.000	31.5	20.4	2.00	656
	B	013	Square	work floor	0.000	5.400	4.700	31.50	0.00	0.00	31.500	0.000	31.5	20.4	2.00	656
	B	014	Square	work floor	0.000	11.30	4.700	44.50	0.00	0.00	44.500	0.000	44.5	42.7	3.50	1,967
	B	015	Square	work floor	0.000	11.30	7.600	44.50	0.00	0.00	44.500	0.000	44.5	69.0	5.20	3,231
	B	ORB	Square	work floor	0.000	5.000	4.700	28.00	0.00	0.00	28.000	0.000	28.0	18.9	2.00	540
	B	101 T	Square	work floor belw dst floor	0.000	11.50	11.40	36.00	0.00	0.00	36.000	0.000	36.0	105.4	6.20	4,029
	B	101 B	Square	work floor belw dst floor -	0.000	11.30	8.600	9.500	0.00	0.00	9.500	0.000	9.5	78.1	5.50	783
	B	102 T	Square	work floor belw dst floor -	0.000	11.60	11.50	36.00	0.00	0.00	36.000	0.000	36.0	107.2	6.20	4,098
	B	102 B	Square	work floor belw dst floor -	0.000	11.60	8.600	9.500	0.00	0.00	9.500	0.000	9.5	80.2	5.50	804
	B	103 T	Square	work floor belw dst floor -	0.000	11.60	11.50	36.00	0.00	0.00	36.000	0.000	36.0	107.2	6.20	4,098
	B	103 B	Square	work floor belw dst floor -	0.000	11.60	8.600	9.500	0.00	0.00	9.500	0.000	9.5	80.2	5.50	804
	B	104 T	Square	work floor belw dst floor	0.000	11.50	11.40	36.00	0.00	0.00	36.000	0.000	36.0	105.4	6.20	4,029
	B	104 B	Square	work floor belw dst floor -	0.000	11.40	8.600	9.500	0.00	0.00	9.500	0.000	9.5	78.8	5.50	790
	B	105 T	Square	work floor belw dst floor	0.000	11.50	11.40	36.00	0.00	0.00	36.000	0.000	36.0	105.4	6.20	4,029
	B	105 B	Square	work floor belw dst floor -	0.000	11.40	8.600	9.500	0.00	0.00	9.500	0.000	9.5	78.8	5.50	790

**Section: B**

Exam Date:06/27/2012

Co-op Elevator of McClusky

Page: 3

Examiner: 1

PO Box 469  
McClusky, ND  
County:

Status	Section	Bin Number	Bin Type	Base Point	Diameter or Bu/Ft (Irreg.) Length	Width	Side wall	Add for Hopper	Ded. for Obst.	Effective Depth	Add for Peak	Depth for Capac.	Bushels per Foot	Base Pack%	Bushel Capacity with Pack	
<b>Section: B</b>																
	B	106 T	Square	work floor belw dst floor -	0.000	11.60	11.50	36.00	0.00	0.00	36.000	0.000	36.0	107.2	6.20	4,098
	B	106 B	Square	work floor belw dst floor -	0.000	11.60	8.600	9.500	0.00	0.00	9.500	0.000	9.5	80.2	5.50	804
	B	107 T	Square	work floor belw dst floor -	0.000	11.60	11.50	36.00	0.00	0.00	36.000	0.000	36.0	107.2	6.20	4,098
	B	107 B	Square	work floor belw dst floor -	0.000	11.60	8.600	9.500	0.00	0.00	9.500	0.000	9.5	80.2	5.50	804
	B	108 T	Square	work floor belw dst floor	0.000	11.50	11.40	36.00	0.00	0.00	36.000	0.000	36.0	105.4	6.20	4,029
	B	108 B	Square	work floor belw dst floor -	0.000	11.30	8.600	9.500	0.00	0.00	9.500	0.000	9.5	78.1	5.50	783
Added	B	201	Peaked	eave	16.000	0.000	0.000	15.00	2.30	0.00	17.300	1.000	18.3	161.6	5.80	3,129
Added	B	202	Peaked	eave	16.000	0.000	0.000	15.00	2.30	0.00	17.300	1.000	18.3	161.6	5.80	3,129
Added	B	203	Peaked	eave	16.000	0.000	0.000	15.00	2.30	0.00	17.300	1.000	18.3	161.6	5.80	3,129
Added	B	204	Peaked	eave	16.000	0.000	0.000	15.00	2.30	0.00	17.300	1.000	18.3	161.6	5.80	3,129
Added	B	205	Peaked	eave	16.000	0.000	0.000	17.00	2.60	0.00	19.600	1.000	20.6	161.6	5.80	3,522
Added	B	206	Peaked	eave	16.000	0.000	0.000	17.00	2.60	0.00	19.600	1.000	20.6	161.6	5.80	3,522
<b>Bin count: 39</b>																
														<b>Facility: McClusky Section: B Total:</b>		<b>79,619</b>
														<b>To Even:</b>		<b>80,000</b>

**Section: C**

	C	001	Square	work floor	0.000	4.700	4.200	24.00	0.00	0.00	24.000	0.000	24.0	15.9	2.00	390
	C	002 T	Square	work floor	0.000	9.200	6.200	19.00	0.00	0.00	19.000	0.000	19.0	45.9	4.00	907
	C	002 B	Square	work floor - top 19'	0.000	9.300	9.200	25.00	0.00	0.00	25.000	0.000	25.0	68.8	5.20	1,809
	C	003	Square	work floor	0.000	9.600	9.200	44.00	0.00	0.00	44.000	0.000	44.0	71.0	5.20	3,286
	C	004 T	Irregular	work floor 11 x 9.6 less 5.7	54.700	0.000	0.000	8.000	0.00	0.00	8.000	0.000	8.0	54.7	4.50	458
	C	004 B	Square	work floor - top 8'	0.000	11.00	9.600	22.00	0.00	0.00	22.000	0.000	22.0	84.9	5.80	1,976
	C	005	Square	work floor	0.000	9.300	9.200	44.00	0.00	0.00	44.000	0.000	44.0	68.8	5.20	3,184

Exam Date:06/27/2012

Co-op Elevator of McClusky  
 PO Box 469  
 McClusky , ND  
 County:

Examiner: 1

Status	Section	Bin Number	Bin Type	Base Point	Diameter or Bu/Ft (Irreg.) Length	Width	Side wall	Add for Hopper	Ded. for Obst.	Effective Depth	Add for Peak	Depth for Capac.	Bushels per Foot	Base Pack%	Bushel Capacity with Pack	
	<b>Section: C</b>															
	C	006	Square	work floor	0.000	11.00	9.300	27.00	0.00	0.00	27.000	0.000	27.0	82.2	5.50	2,341
	C	007	Square	work floor	0.000	9.300	9.300	44.00	0.00	0.00	44.000	0.000	44.0	69.5	5.20	3,217
	C	010	Square	work floor	0.000	9.600	9.300	44.00	0.00	0.00	44.000	0.000	44.0	71.8	5.20	3,323
	C	011	Square	work floor	0.000	9.400	4.200	31.50	0.00	0.00	31.500	0.000	31.5	31.7	2.50	1,024
	C	012	Square	work floor	0.000	9.300	9.300	44.00	0.00	0.00	44.000	0.000	44.0	69.5	5.20	3,217
	C	0TB	Square	work floor	0.000	9.200	3.000	13.50	0.00	0.00	13.500	0.000	13.5	22.2	2.00	306
	C	101	Peaked		16.000	0.000	0.000	20.00	2.40	0.00	22.400	1.000	23.4	161.6	5.80	4,000
	C	102	Peaked		16.000	0.000	0.000	20.00	2.40	0.00	22.400	1.000	23.4	161.6	5.80	4,000
	C	103	Peaked		16.000	0.000	0.000	20.00	2.40	0.00	22.400	1.000	23.4	161.6	5.80	4,000
	C	104	Peaked		16.000	0.000	0.000	20.00	2.40	0.00	22.400	1.000	23.4	161.6	5.80	4,000
	C	105	Peaked		16.000	0.000	0.000	20.00	2.40	0.00	22.400	1.000	23.4	161.6	5.80	4,000
	C	106	Peaked		16.000	0.000	0.000	20.00	2.40	0.00	22.400	1.000	23.4	161.6	5.80	4,000

Bin count: 19

Facility: McClusky Section: C Total: **49,438**

To Even: **50,000**

**Overall Licensed Bin Capacity for:**

Co-op Elevator of McClusky

Bin count: 73

**Licensed Capacity:**  
(includes pack)

**397,862 Bu.**

**Licensed Capacity (to even):**  
(includes pack and section totals are rounded up to next highest 1000)

**399,000 Bu.**

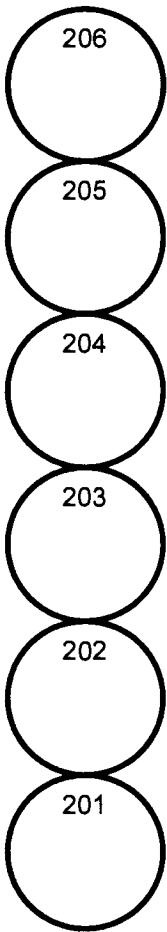

Section B  
 Bins 201 thru 206  
 Located west of section A  
 by Agonomy building

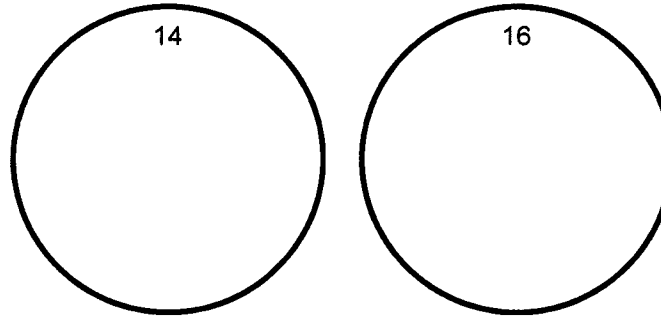

CO-OP ELEVATOR OF McCLUSKY  
 McCLUSKY N.D.  
 SECTION A

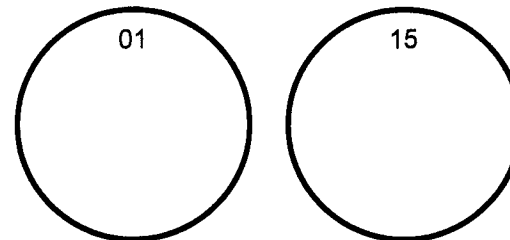
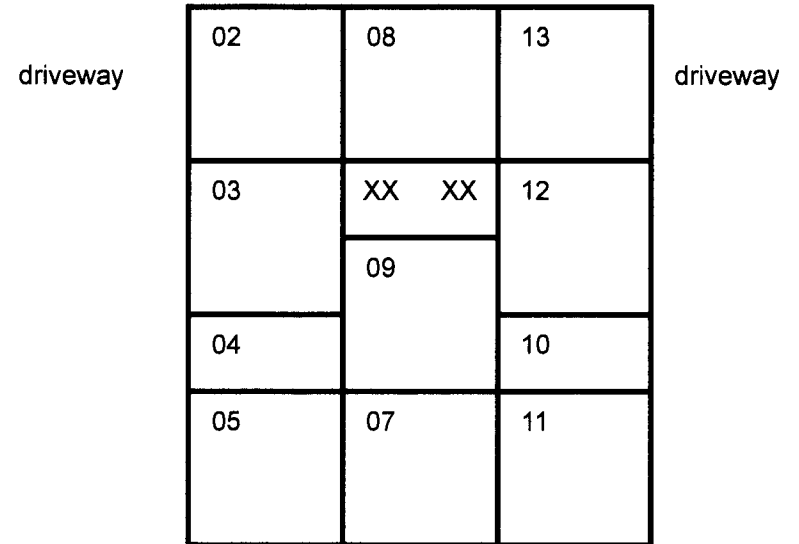

driveway & scale

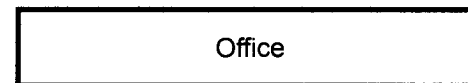

CO-OP ELEVATOR OF McCLUSKY  
McCLUSKY N.D.

rail line abandoned

SECTION B



SECTION B

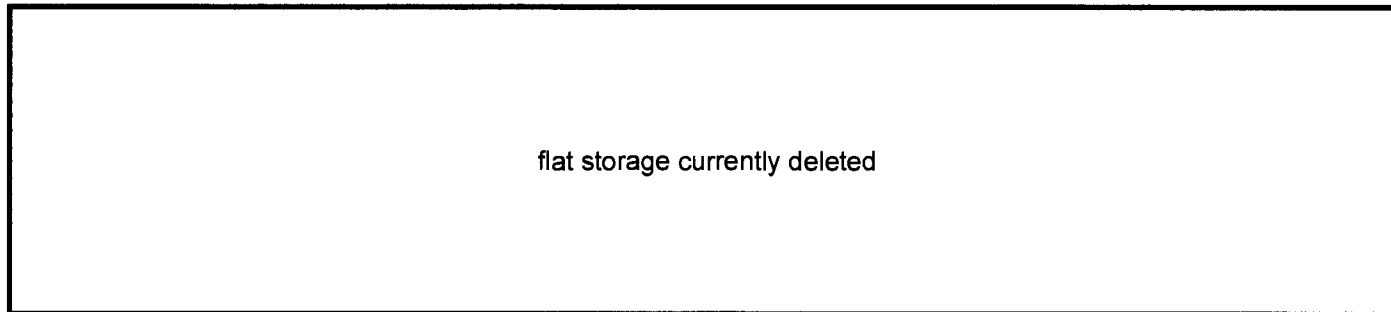

SECTION B  
located west of Section A

CO-OP ELEVATOR OF McCLUSKY  
McCLUSKY N.D.

SECTION C

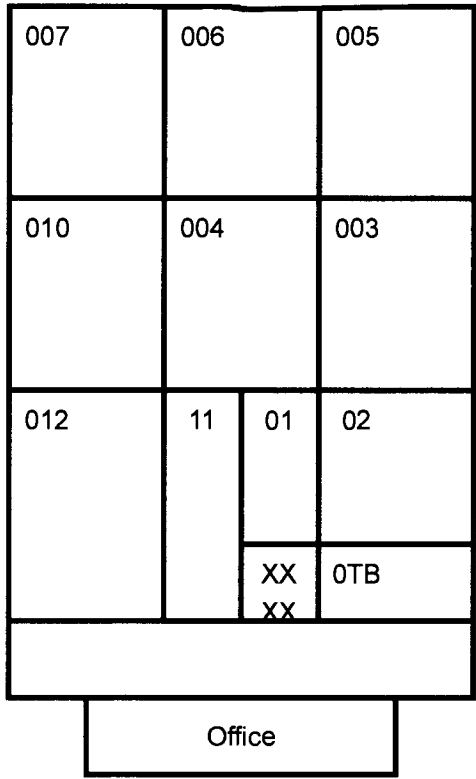

120' east



SECTION D

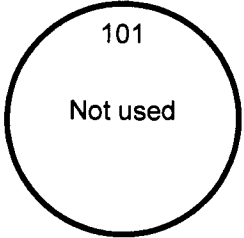

leased from Stein