

Exam Date:09/05/2012

Flasher Farmers Union Grain & Oil

Page: 1

Examiner: 1

PO Box 357
Flasher, ND
County:
Phone: 701-597-3338
CCC Number:

Location/Container Numbers/Comments	Section	Capacity
PART A - ADDITIONAL SPACE TO BE INCLUDED UNDER LICENSE		
<NO BINS ADDED>		
		Total: 0

PART B - SPACE TO BE DELETED UNDER LICENSE		
002	B	4,523
003	B	657
004 T	B	100
004B	B	3,618
005	B	1,492
006	B	4,433
007	B	1,386
009	B	1,450
010	B	4,433
011	B	4,523
012N	B	1,492
012S T	B	613
012SB	B	511
013	B	357
014	B	4,523
001	D	7,803
002	D	7,803
		Total: 49,717

PART C - ALL SPACE TO BE INCLUDED UNDER LICENSE		
	A	246,000
	D	24,000
		Total: 270,000

PART D - TOTAL CAPACITY BY FUNCTIONAL UNIT		
Flasher 1063	A D	270,000
		Total: 270,000

no changes made to capacity in grain program.

NDPSC Bin Capacity Chart

Exam Date:09/05/2012

Flasher Farmers Union Grain & Oil
 PO Box 357
 Flasher , ND
 County:

Page: 1

Examiner: 1

Status	Section	Bin Number	Bin Type	Base Point	Diameter or Bu/Ft (Irreg.) Length	Width	Side wall	Add for Hopper	Ded. for Obst.	Effective Depth	Add for Peak	Depth for Capac.	Bushels per Foot	Base Pack%	Bushel Capacity with Pack	
	Section: A															
	A	002	Square	Zero Point is the work floor	0.000	4.000	2.900	38.00	0.00	0.00	38.000	0.000	38.0	9.3	2.00	360
	A	003	Square	Zero Point is the work floor	0.000	11.20	9.500	38.00	0.00	0.00	38.000	0.000	38.0	85.5	5.80	3,437
	A	006	Square	Zero Point is the work floor	0.000	11.20	9.500	53.00	0.00	0.00	53.000	0.000	53.0	85.5	5.80	4,795
	A	007	Square	Zero Point is the work floor	0.000	11.20	10.20	52.00	0.00	0.00	52.000	0.000	52.0	91.8	5.80	5,051
	A	008 T	Irregular	work floor 9.5x6.4 less	29.100	0.000	0.000	9.000	0.00	0.00	9.000	0.000	9.0	29.1	2.50	269
	A	008B	Square	work floor -top 9'	0.000	9.500	6.400	28.00	0.00	0.00	28.000	0.000	28.0	48.9	4.20	1,426
	A	009	Square	Zero Point is the work floor	0.000	10.20	6.400	38.00	0.00	0.00	38.000	0.000	38.0	52.5	4.50	2,085
	A	010	Square	Zero Point is the work floor	0.000	11.20	10.20	38.00	0.00	0.00	38.000	0.000	38.0	91.8	5.80	3,690
	A	011	Square	Zero Point is the work floor	0.000	9.500	6.200	37.00	0.00	0.00	37.000	0.000	37.0	47.3	4.00	1,820
	A	012	Square	Zero Point is the work floor	0.000	10.20	6.200	53.00	0.00	0.00	53.000	0.000	53.0	50.8	4.50	2,813
	A	013	Square	Zero Point is the work floor	0.000	11.20	9.500	53.00	0.00	0.00	53.000	0.000	53.0	85.5	5.80	4,795
	A	015	Square	Zero Point is the work floor	0.000	11.20	9.500	53.00	0.00	0.00	53.000	0.000	53.0	85.5	5.80	4,795
	A	016	Square	Zero Point is the work floor	0.000	9.500	6.200	38.00	0.00	0.00	38.000	0.000	38.0	47.3	4.00	1,869
	A	101 T	Square	Zero Point is the work floor	0.000	14.40	11.50	46.50	0.00	0.00	46.500	0.000	46.5	133.1	6.50	6,591
	A	101B	Square	work floor - top 46.5'	0.000	12.00	11.50	6.000	0.00	0.00	6.000	0.000	6.0	110.9	6.20	706
	A	102 T	Square	Zero Point is the work floor	0.000	14.40	11.50	46.50	0.00	0.00	46.500	0.000	46.5	133.1	6.50	6,591
	A	102B	Square	work floor -top 46.5'	0.000	12.00	11.50	6.000	0.00	0.00	6.000	0.000	6.0	110.9	6.20	706
	A	103 T	Square	Zero Point is the work floor	0.000	14.40	11.60	46.50	0.00	0.00	46.500	0.000	46.5	134.3	6.50	6,651
	A	103B	Square	work floor - top 46.5'	0.000	12.00	11.60	6.000	0.00	0.00	6.000	0.000	6.0	111.9	6.20	713
	A	104 T	Square	Zero Point is the work floor	0.000	14.40	11.60	46.50	0.00	0.00	46.500	0.000	46.5	134.3	6.50	6,651
	A	104B	Square	work floor - top 46.5'	0.000	12.00	11.60	6.000	0.00	0.00	6.000	0.000	6.0	111.9	6.20	713
	A	105 T	Square	Zero Point is the work floor	0.000	14.40	11.60	46.50	0.00	0.00	46.500	0.000	46.5	134.3	6.50	6,651
	A	105B	Square	work floor -top 46.5'	0.000	12.00	11.60	6.000	0.00	0.00	6.000	0.000	6.0	111.9	6.20	713

NDPSC Bin Capacity Chart

Exam Date:09/05/2012

Flasher Farmers Union Grain & Oil
 PO Box 357
 Flasher , ND
 County:

Page: 2

Examiner: 1

Status	Section	Bin Number	Bin Type	Base Point	Diameter or Bu/Ft (Irreg.) Length	Width	Side wall	Add for Hopper	Ded. for Obst.	Effective Depth	Add for Peak	Depth for Capac.	Bushels per Foot	Base Pack%	Bushel Capacity with Pack	
	Section: A															
	A	106 T	Square	Zero Point is the work floor	0.000	14.40	11.60	46.50	0.00	0.00	46.500	0.000	46.5	134.3	6.50	6,651
	A	106B	Square	work floor - top 46.5'	0.000	12.00	11.60	6.000	0.00	0.00	6.000	0.000	6.0	111.9	6.20	713
	A	107 T	Square	Zero Point is the work floor	0.000	14.40	11.50	46.50	0.00	0.00	46.500	0.000	46.5	133.1	6.50	6,591
	A	107B	Square	work floor - top 46.5'	0.000	12.00	11.50	6.000	0.00	0.00	6.000	0.000	6.0	110.9	6.20	706
	A	108 T	Square	Zero Point is the work floor	0.000	14.40	11.50	46.50	0.00	0.00	46.500	0.000	46.5	133.1	6.50	6,591
	A	108B	Square	work floor - top 46.5'	0.000	12.00	11.50	6.000	0.00	0.00	6.000	0.000	6.0	110.9	6.20	706
	A	201	Square	Zero Point is the work floor	0.000	14.20	11.50	50.00	0.00	0.00	50.000	0.000	50.0	131.3	6.50	6,992
	A	202 T	Square	Zero Point is the work floor	0.000	13.50	11.50	44.50	0.00	0.00	44.500	0.000	44.5	124.8	6.50	5,915
	A	202B	Square	work floor -top 44.5'	0.000	11.50	9.100	7.000	0.00	0.00	7.000	0.000	7.0	84.1	5.80	623
	A	203	Square	Zero Point is the work floor	0.000	14.20	11.60	50.00	0.00	0.00	50.000	0.000	50.0	132.4	6.50	7,050
	A	204 T	Square	Zero Point is the work floor	0.000	13.50	11.60	44.50	0.00	0.00	44.500	0.000	44.5	125.9	6.50	5,967
	A	204B	Square	work floor - top 44.5'	0.000	11.60	9.100	7.000	0.00	0.00	7.000	0.000	7.0	84.9	5.80	628
	A	205	Square	Zero Point is the work floor	0.000	14.20	11.60	50.00	0.00	0.00	50.000	0.000	50.0	132.4	6.50	7,050
	A	206 T	Square	Zero Point is the work floor	0.000	13.50	11.60	44.50	0.00	0.00	44.500	0.000	44.5	125.9	6.50	5,967
	A	206B	Square	work floor - top 44.5'	0.000	11.60	9.100	7.000	0.00	0.00	7.000	0.000	7.0	84.9	5.80	628
	A	207	Square	Zero Point is the work floor	0.000	14.20	11.70	50.00	0.00	0.00	50.000	0.000	50.0	133.6	6.50	7,114
	A	208 T	Square	Zero Point is the work floor	0.000	13.50	11.70	44.50	0.00	0.00	44.500	0.000	44.5	127.0	6.50	6,019
	A	208B	Square	work floor -top 44.5'	0.000	11.70	9.100	7.000	0.00	0.00	7.000	0.000	7.0	85.6	5.80	634
	A	209	Square	Zero Point is the work floor	0.000	14.20	11.40	50.00	0.00	0.00	50.000	0.000	50.0	130.1	6.50	6,928
	A	210 T	Square	Zero Point is the work floor	0.000	11.40	11.10	9.000	0.00	0.00	9.000	0.000	9.0	101.7	6.00	970
	A	210 M	Square	work floor -top 9'	0.000	13.50	11.40	35.50	0.00	0.00	35.500	0.000	35.5	123.7	6.50	4,676
	A	210B	Square	work floor -top& mddle 44.5'	0.000	11.40	9.100	7.000	0.00	0.00	7.000	0.000	7.0	83.4	5.80	618
	A	301	Flat	top of sidewall `14'	0.000	142.0	50.00	13.00	0.00	0.00	13.000	0.000	13.0	5707.4	10.0	81,616

NDPSC Bin Capacity Chart

Exam Date:09/05/2012

Flasher Farmers Union Grain & Oil
PO Box 357
Flasher , ND
County:

Page: 3

Examiner: 1

Status	Section	Bin Number	Bin Type	Base Point	Diameter or Bu/Ft (Irreg.)		Side	Add	Ded.	Effective	Add	Depth	Bushels	Base	Bushel Capacity		
					Length	Width	wall	for	for	Depth	for	for	per	Pack%	with Pack		
								Hopper	Obst.		Peak	Capac.	Foot				
Bin count:		46													Facility: Flasher Section: A Total:		245,244
														To Even:		246,000	

Section: D

D	101	Peaked	top of sidewall -- 7' hpr	15.500	0.000	0.000	15.00	2.30	0.00	17.300	0.900	18.2	151.7	5.50	2,913		
D	102	Peaked	top of sidewall -- 7' hpr	15.500	0.000	0.000	15.00	2.30	0.00	17.300	0.900	18.2	151.7	5.50	2,913		
D	103	Peaked	top of sidewall -- 7' hpr	15.500	0.000	0.000	15.00	2.30	0.00	17.300	0.900	18.2	151.7	5.50	2,913		
D	104	Peaked	top of sidewall -- 7' hpr	15.500	0.000	0.000	15.00	2.30	0.00	17.300	0.900	18.2	151.7	5.50	2,913		
D	105	Peaked	top of sidewall -- 7' hpr	15.500	0.000	0.000	15.00	2.30	0.00	17.300	0.900	18.2	151.7	5.50	2,913		
D	106	Peaked	top of sidewall -- 7' hpr	15.500	0.000	0.000	15.00	2.30	0.00	17.300	0.900	18.2	151.7	5.50	2,913		
D	107	Peaked	top of sidewall -- 7' hpr	15.500	0.000	0.000	15.00	2.30	0.00	17.300	0.900	18.2	151.7	5.50	2,913		
D	108	Peaked	top of sidewall -- 7' hpr	15.500	0.000	0.000	15.00	2.30	0.00	17.300	0.900	18.2	151.7	5.50	2,913		
Bin count:		8													Facility: Flasher Section: D Total:		23,304
														To Even:		24,000	

<p>Overall Licensed Bin Capacity for: Flasher Farmers Union Grain & Oil</p> <p>Bin count: 54</p>	<p>Licensed Capacity: (includes pack) <u>268,548 Bu.</u></p> <p>Licensed Capacity (to even): (includes pack and section totals are rounded up to next highest 1000) <u>270,000 Bu.</u></p>
--	--

Corp # 2460

Flasher Farmers Union Elevator Co.

Flasher, north Dakota

Section D

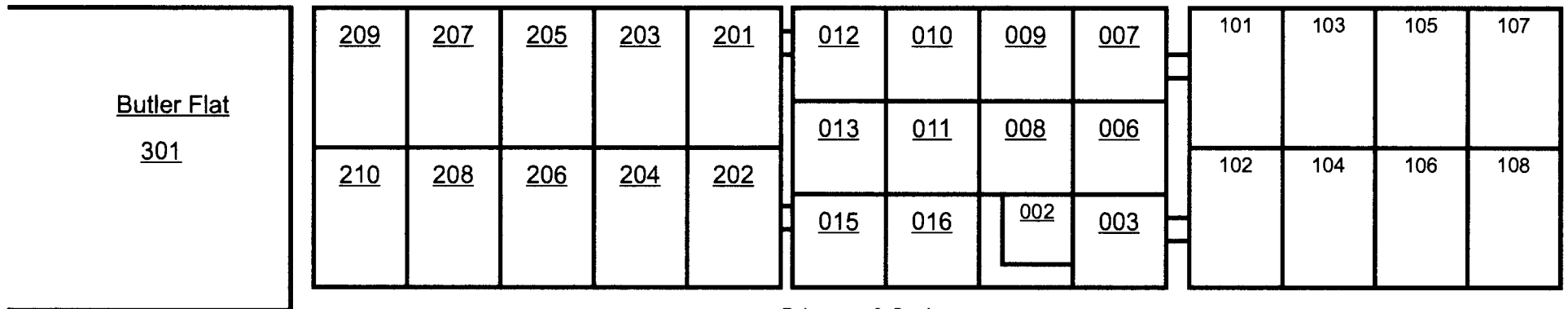
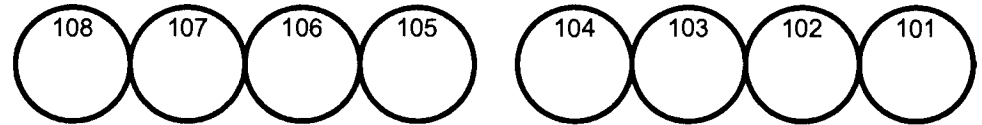

Section A