



APPLICATION FOR REVISION TO DELETE UNDISTURBED ACREAGE FROM A PERMIT TO ENGAGE IN SURFACE COAL MINING AND RECLAMATION OPERATIONS
 PUBLIC SERVICE COMMISSION
 RECLAMATION DIVISION
 SFN 10574 (1-2004)

2013

Name of Company, Corporation, Partnership, or Individual Leonardite Products, LLC		Date March 25 2013	
Address 501 E Broadway, PO Box 548		City Williston	Permit Number GRGR0501
		State ND	Zip Code 58801

The above named hereby makes application for Revision Number 4 to delete the following undisturbed acreage from the above surface coal mining Permit Number in the State of North Dakota (attach a copy of a metes and bounds description if appropriate):

NAME OF MINE	ACRES	LOCATION			
		SEC.	TWP.	RANGE	COUNTY
Stony Creek Mine	34.57	8	154N	100W	Williams
ADDRESS					
TOTAL ACRES	34.57				

Attached to this permit revision application is a narrative describing the proposed revision to delete undisturbed acreage from the permit, reasons for requesting the deletion, and how the deletion will affect the approved operation and reclamation plan with appropriate maps, cross-sections, revised mining and reclamation plans and other data that reflects the changes in the approved permit and which demonstrate compliance with Chapter 38-14.1 of the North Dakota Century Code, the rules promulgated thereunder, and the permit conditions of the approved permit.

Name of Official Cherie Harms

I, the above named official of the permit revision applicant, certify that:

1. The acreage in the permit revision application has not been disturbed by surface coal mining and reclamation operations; and
2. Information and documentation contained in the permit revision application affirmatively demonstrate that the permit revision application is accurate and complete and all the requirements of Chapter 38-14.1 of the North Dakota Century Code and of the rules promulgated thereunder have been compiled with.

Signature of Official <i>Cherie Harms</i>	Title President
--	---------------------------

VERIFICATION

Name

I, the above named, being first and duly sworn, verify that the information contained in the Permit Revision Application is true and correct to the best of my knowledge and belief.

Signature of Official	Title
-----------------------	-------

STATE OF North Dakota)
)ss.
 COUNTY OF Williams)

Subscribed and Sworn before me, this 25th day of March, 2013.

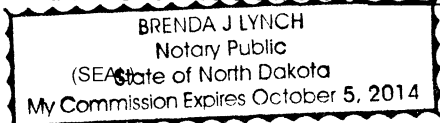

Brenda J Lynch
 Notary Public
 My Commission Expires: 10-5-2014

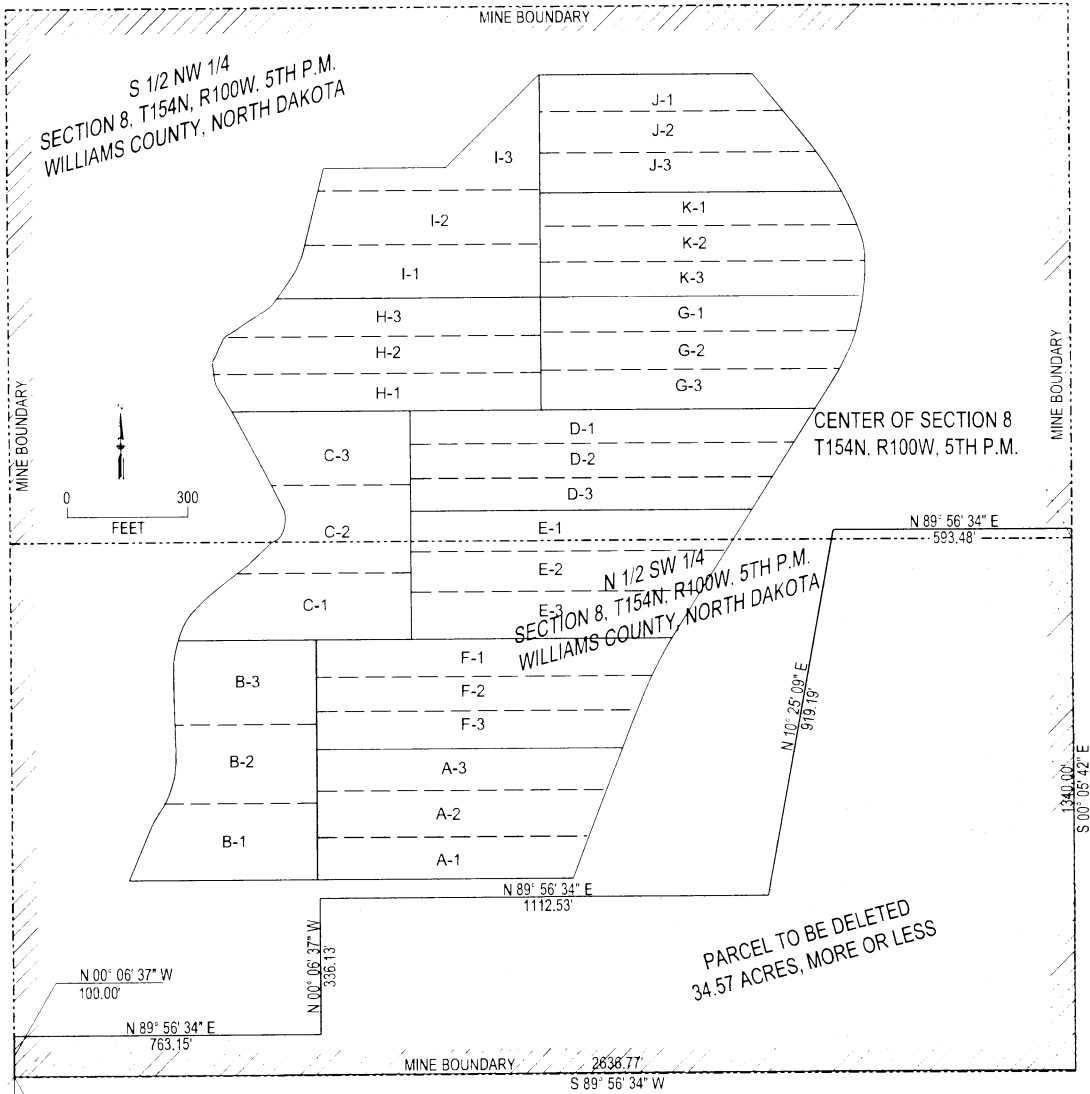

S 00° 06' 37" E
1316.45'

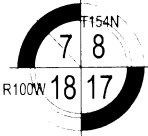

POINT OF BEGINNING
ND STATE PLANE COORDINATES
SPC (3301 ND N)
N 442,692.509
E 1,216,496.988

A parcel of land in the West Half (W 1/2), Section 8, Township 154 North, Range 100 West of the Fifth Principal Meridian, in Williams County, North Dakota more particularly described as follows:

Commencing at the Southwest Corner of said Section 8; thence N 00° 06' 37" W along the west line of said Section a distance of 1318.45 feet to the Point of Beginning; thence N 00° 06' 37" W a distance of 100.00 feet; thence N 89° 56' 34" E a distance of 763.15 feet; thence N 00° 06' 37" W a distance of 336.13 feet; thence N 89° 56' 34" E a distance of 1112.53 feet; thence N 10° 25' 09" E a distance of 919.19 feet; thence N 89° 56' 34" E a distance of 593.48 feet; thence S 00° 05' 42" E a distance of 1340.00 feet; thence S 89° 56' 34" W a distance of 2636.77 feet to the Point of Beginning. Said parcel contains 34.57 acres, more or less.

**EXHIBIT No. 1
APPLICATION FOR REVISION
TO DELETE UNDISTURBED ACREAGE
STONY CREEK MINE
WILLIAMS COUNTY, NORTH DAKOTA
LEONARDITE PRODUCTS, LLC**

The prepared revision is to delete a 34.57 acre parcel from the 160 acre mine as shown on the attached.

No mining or reclamation has taken place within the subject 34.57 acre parcel. Deleting this 34.57 acre parcel from the mine will not affect the approved operation and reclamation plan. The approved operation and reclamation plan does not include any mining activities in the 34.57 acre parcel.

The prepared revision to delete this undisturbed 34.57 acre parcel from the mine is to facilitate the construction and operation of a solid waste transfer and recycling station.

PARCEL DESCRIPTION

A parcel of land in the West Half (W ½), Section 8, Township 154 North, Range 100 West of the Fifth Principal Meridian, in Williams County, North Dakota more particularly described as follows:

Commencing at the Southwest Corner of said Section 8; thence N 00° 06' 37" W along the west line of said Section a distance of 1318.45 feet to the Point of Beginning; thence N 00° 06' 37" W a distance of 100.00 feet; thence N 89° 56' 34" E a distance of 763.15 feet; thence N 00° 06' 37" W a distance of 336.13 feet; thence N 89° 56' 34" E a distance of 1112.53 feet; thence N 10° 25' 09" E a distance of 919.19 feet; thence N 89° 56' 34" E a distance of 593.48 feet; thence S 00° 05' 42" E a distance of 1340.00 feet; thence S 89° 56' 34" W a distance of 2636.77 feet to the Point of Beginning. Said parcel contains 34.57 acres, more or less.

The location of the Point of Beginning described above is also described as follows:

ND State Plane Coordinates

SPC (3301 ND N)

N 442,692.509

E 1,216,496.988

Boundaries of the deleted parcel are marked with survey monuments (5/8" diameter x 24" reinforcing steel bar with surveyor's plastic cap) at each corner. Corners on the County Highway are marked with witness corners at the right-of-way line located 75 feet easterly from the section line.

Legal Description of Permit Area

Permit Area: S ½ NW ¼, Section 8, T154N, R100W, 5th P.M. Williams County, North Dakota and N ½ SW ¼ of Section 8, T154N, R100W, 5th P.M. Williams County, North Dakota excluding a parcel beginning at the Point of Beginning N442.692.509, E1.216.496.988; thence N 00° 06' 37" W a distance of 100.00 feet; thence N 89° 56' 34" E a distance of 763.15 feet; thence N 00° 06' 37" W a distance of 336.13 feet; thence N 89° 56' 34" E a distance of 1112.53 feet; thence N 10° 25' 09" E a distance of 919.19 feet; thence N 89° 56' 34" E a distance of 593.48 feet; thence S 00° 05' 42" E a distance of 1340.00 feet; thence S 89° 56' 34" W a distance of 2636.77 feet to the Point of Beginning. Said parcel contains 34.57 acres, more or less.

Permit Map and Legal Right

The permit map is Map B. The lease agreement is found in Exhibits M.

Surface and Subsurface Ownership Data

Map C displays all surface and Leonardite subsurface rights included in and contiguous to any part of the proposed permit area extending to a distance of one-fourth mile (402.33 meters) from the proposed permit boundary. A search of the records of the county tax roles was conducted to determine changes to the legal surface owners of record (NDCC 38-14.1-18(2)). Following is a list of names pertinent to Map C and their respective addresses: Leonardite Products, PO Box 548, Williston, ND 58802 (the Permit Applicant)

Federal - BLM,5001Southgate Drive, Billings, MT 59101-4669
City of Williston, Box 1306, Williston, ND 58802-1306
Lorin L. & Luciele M. Olson, 40 Gold Pan Lane, Billings, MT 59105
Lance & Jennifer Olson, 5166 134th Ave. NW, Williston, ND 58801
Gordon Ellis Residuary Trust, c/o First Nat. Bank & Trust, PO Box 1827, Williston, ND 58802
Jean Ellis remaindermen, 1128 7th Ave. East, Williston, ND 58801
James E. & Joanne E. Cozart, 13419 53rd St. NW, Williston, ND 58801
Edgar M. Boyd Post #37, Attn: Robert L. Evans, 425 7th Ave. W., Williston, ND 58801
Ernest M. Fix, etux, PO Box 765, Underwood, ND 58576
Wilbert & Irene Koch, 14060 W. Front St., Williston, ND 58801
Charles A. Dusell, PO Box 877, Williston, ND 58802
Lonny D. & Elaine J. Hiatt, 5237D, 134th Ave. NW, Williston, ND 58801
James A. & Teri L. Kihle, 5225A 134th Ave. NW, Williston, ND 58801
Jeff L. Kihle, 5225A 134th Ave. NW, Williston, ND 58801
Dennis N. Larson, 807 W Broadway, Williston, ND 58801
Richard J. & Cynthia J. Nichols, 5225C 134th Ave. NW, Williston, ND 58801
Williams County, 5237 124th Ave. NW, Williston, ND 58801
Leon B. & Audrey L. Olson etal, c/o First Nat. Bank & Trust, PO Box 1827, Williston, ND 58802
Ida Beckett, 5284 134th Ave. NW, Williston, ND 58801
Mark & Shelley Ellis, 5658 133rd Ave. NW, Williston, ND 58801
Rodney & Teri Nelson, 4905 44th St., Almont, ND 58520
Mark & Shelley A. Ellis, 5658 133rd Ave. NW, Williston, ND 58801
Juliana E. Reeves, 13381 53rd Lane NW, Williston, ND 58801
Claudette Johnson, PO Box 654, Williston, ND 58802-0654
Richard J. Nichols, 5225C 124th Ave NW, Williston, ND 58801-8807
Vance G. Naset, 5237E 134th Ave NW, Williston, ND 58801
Lynden & Meri B. Skaare, 316 Rose Lane, Williston, ND 58801
Keith & Joyce M. Janssen, PO Box 1404 Williston, ND 58802-1404

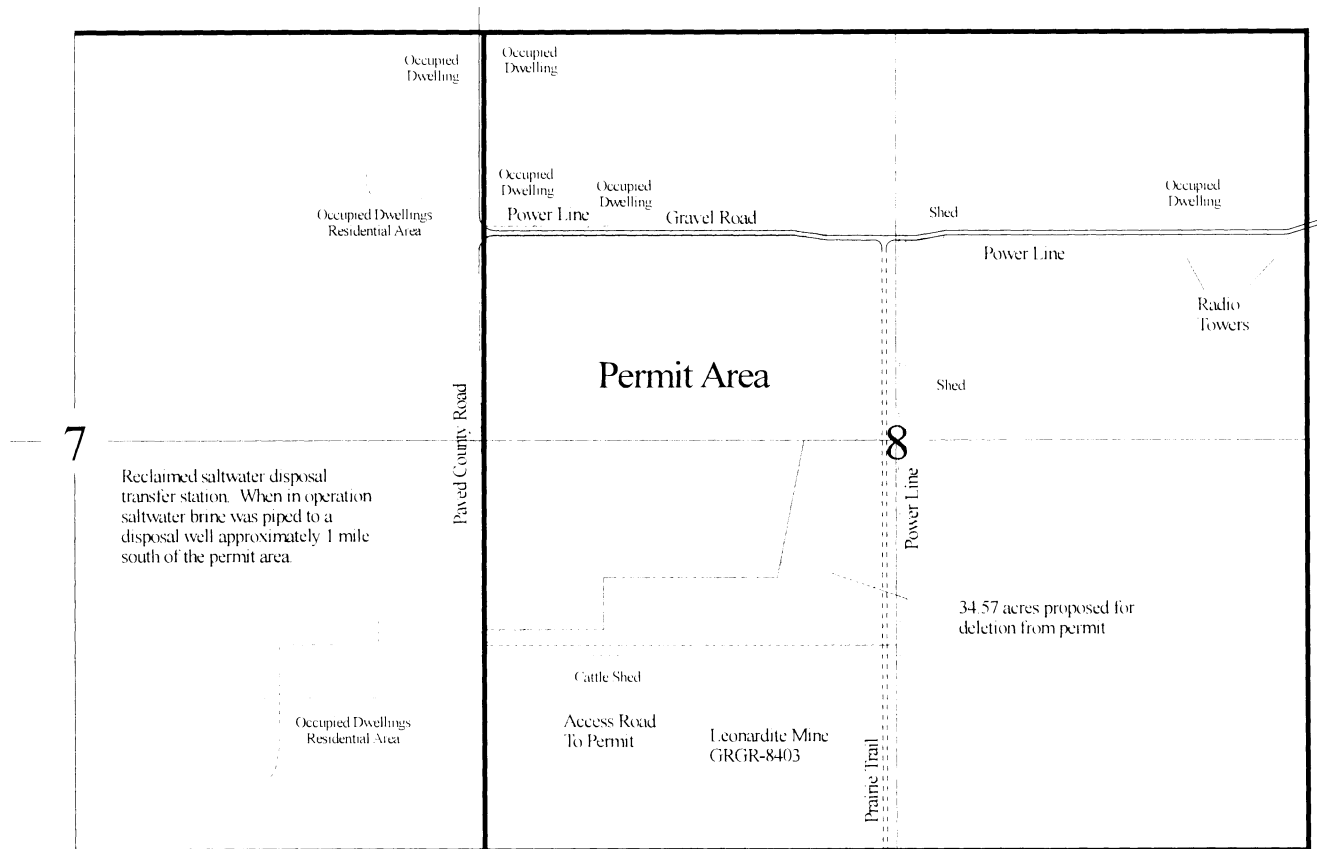

Legend

Permit Boundary

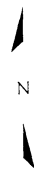

Leonardite Products

Stony Creek Mine
 Mine Permit Application GRGR-0501
 T 154 N, R 100 W
 Williams County, North Dakota

Permit Location Map - Map B

Revised April 15, 2005
 Revised March 31, 2013

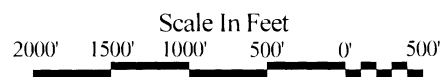

Date: 03-01-05 By: JBJ/CH

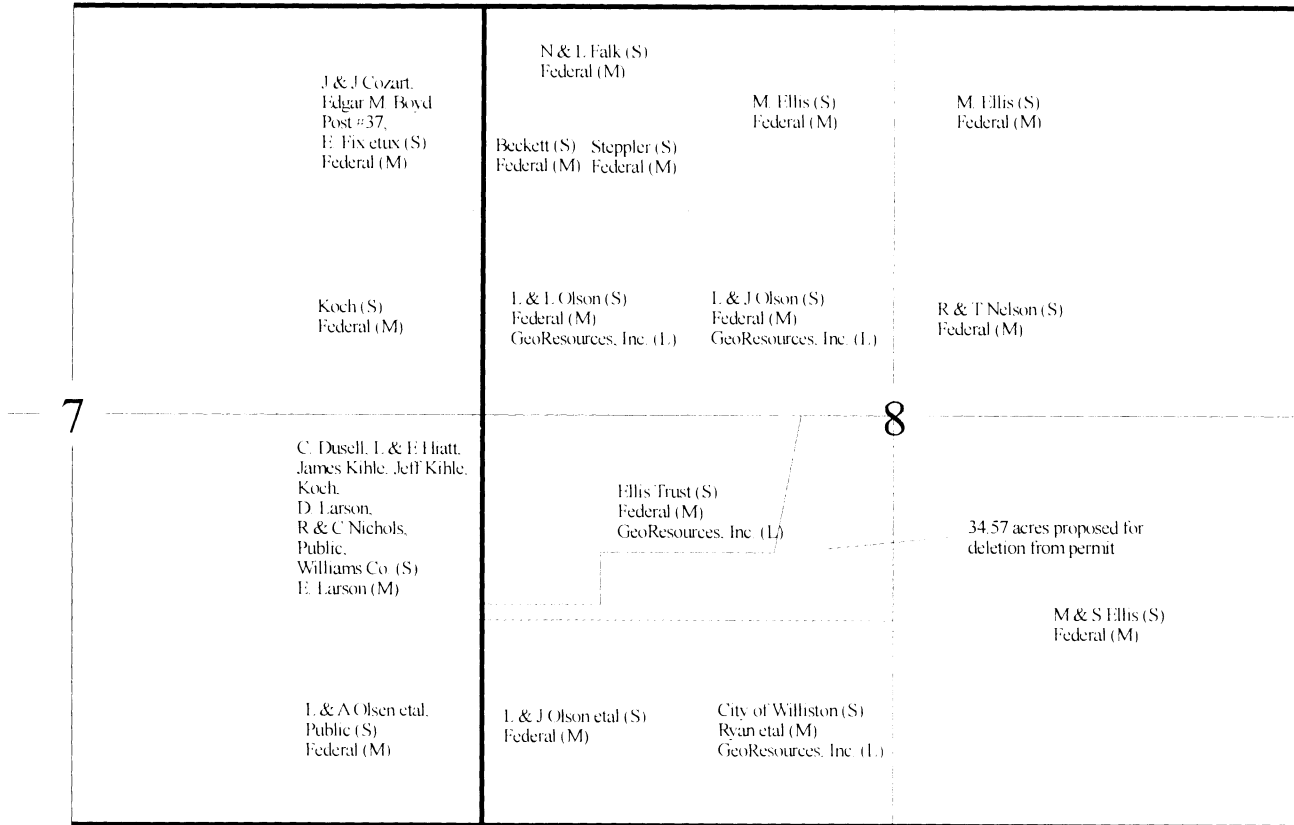

Legend

- Permit Boundary
- (S) Surface Owner
- (M) Mineral Owner
- (L) Lease

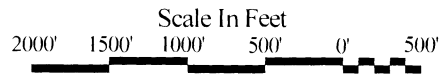
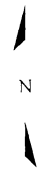

Leonardite Products

Stony Creek Mine
 Mine Permit Application GRGR-0501
 T 154 N, R 100 W
 Williams County, North Dakota

Property Map - Map C

Revised July 11, 2008
 Revised March 31, 2013

Date: 03-01-05 By: JBJ/CH

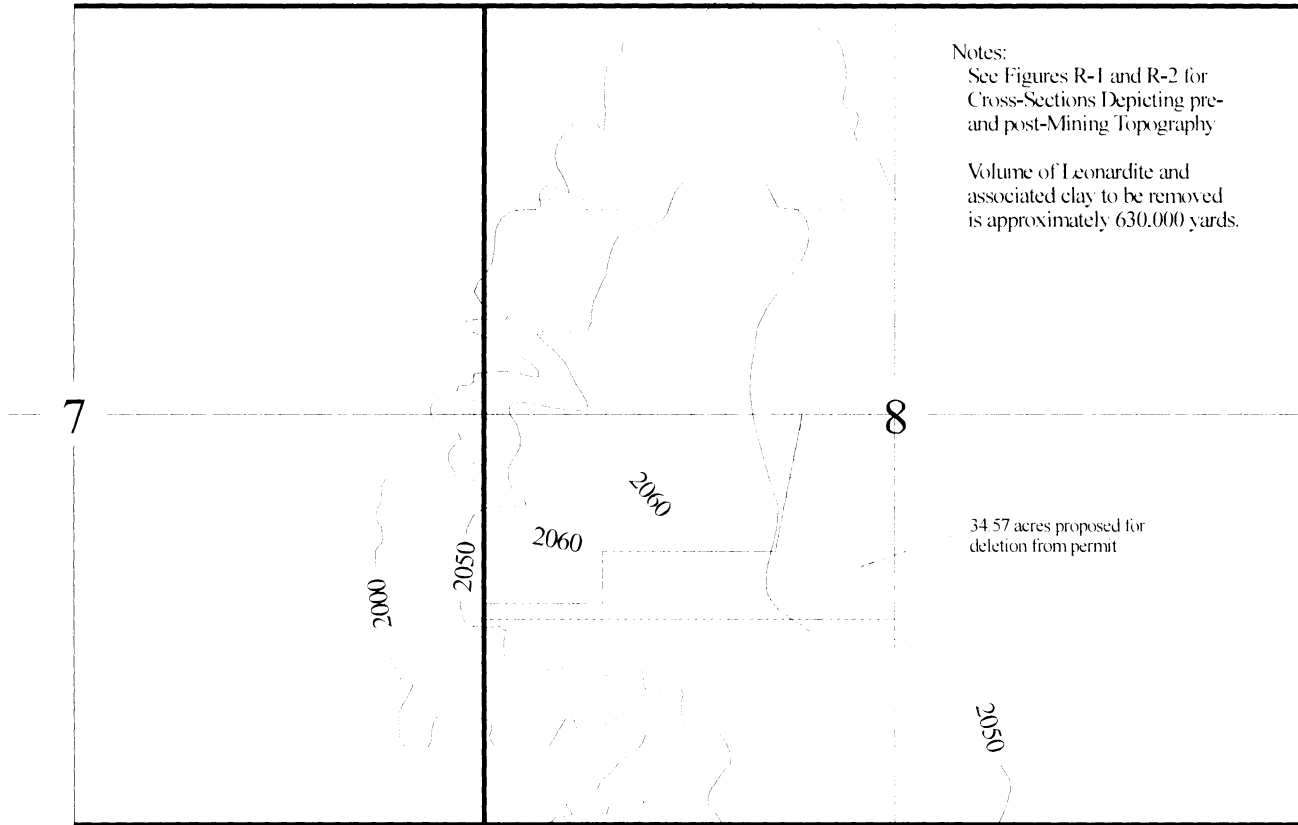

Legend

Permit Boundary

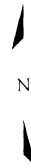

Leonardite Products

Stony Creek Mine
Mine Permit Application GRGR-0501
T 154 N, R 100 W
Williams County, North Dakota

Approximate Final Contours
Map G

Revised Apr 15, 2005
2nd Revision Aug 1, 2005
Revised Mar 31, 2013

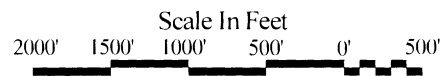

Date: 03-01-05 By: JBJ/CH

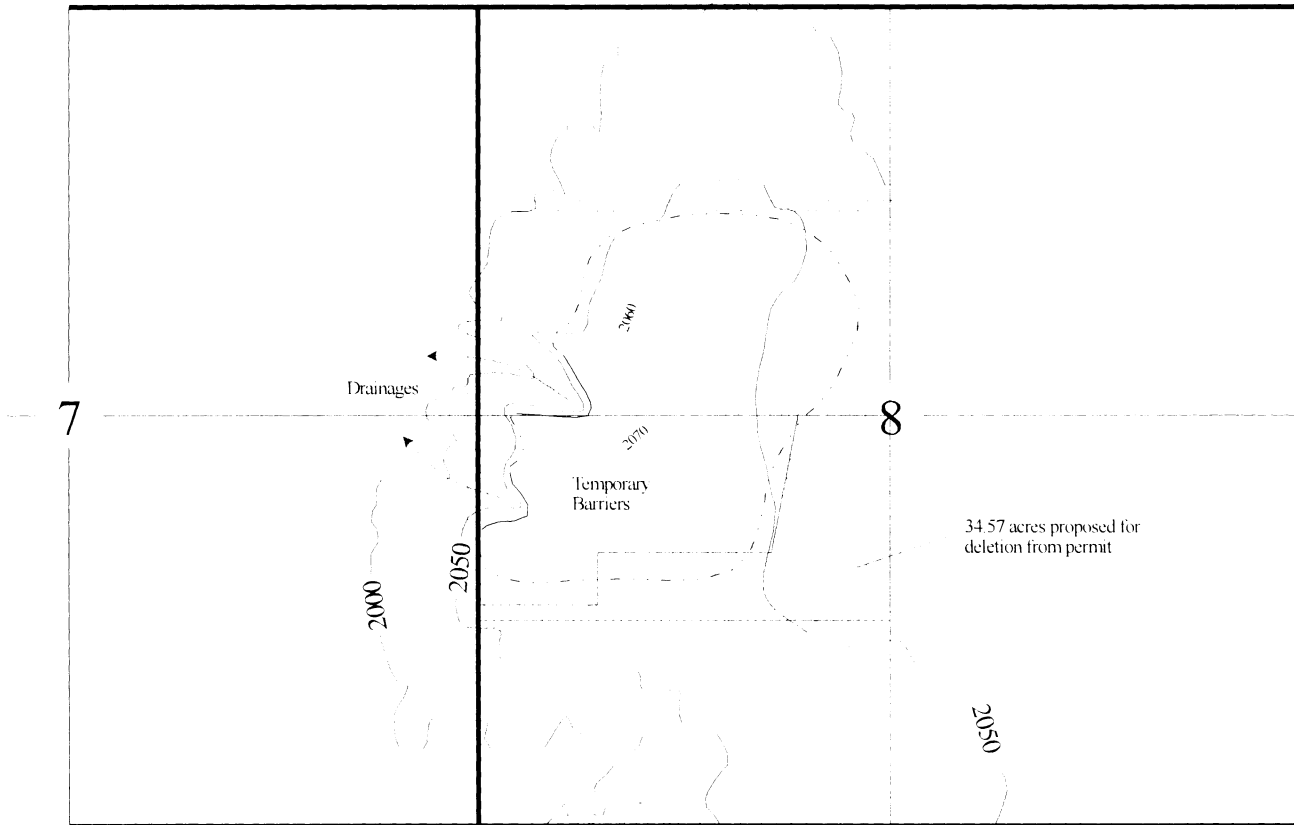

Legend

- - - - - Drainage Area Boundary Line
- Permit Boundary

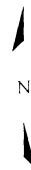

Leonardite Products

Stony Creek Mine
 Mine Permit Application GRGR-0501
 T 154 N, R 100 W
 Williams County, North Dakota

Surface Water Management Map H

Revised Apr 15, 2005
 Revised Mar 31, 2013

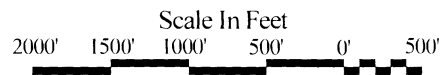

Date: 03-01-05 By: JBJ/CH