

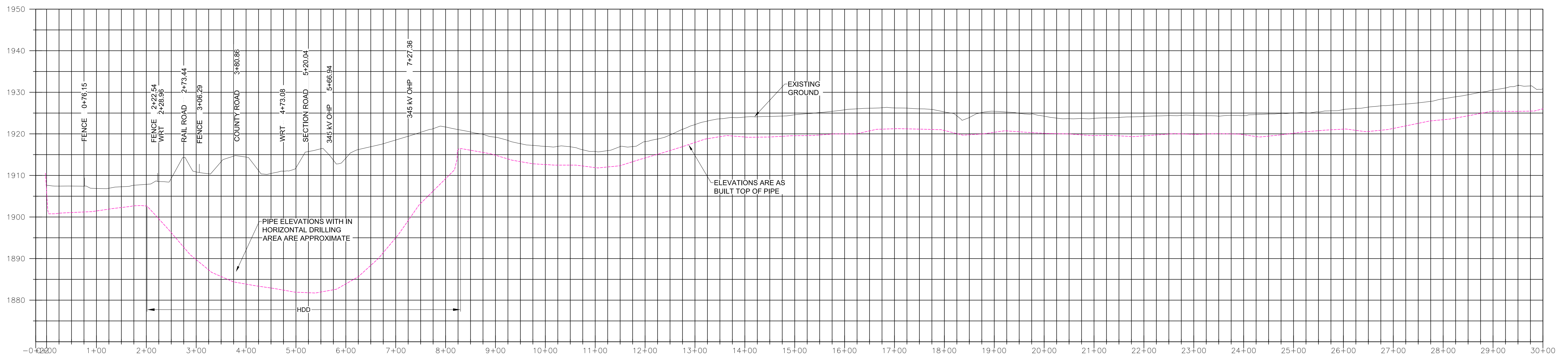

- LEGEND**
- AS BUILT ALIGNMENT
 - SECTION LINE
 - QUARTER SECTION LINE
 - QUARTER-QUARTER SECTION LINE
 - O-M-E OVERHEAD/UNDERGROUND ELECTRIC LINE
 - G CO2 GAS LINE
 - WRT WEST RIVER TELEPHONE/FIBER OPTIC LINE
 - OHP 345kV OVERHEAD POWER
 - FENCE LINE
 - 2' CONTOURS
 - △ CATHODIC PROTECTION TEST LOCATION

PLAN VIEW
SCALE: 1" = 100'



PROFILE VIEW
SCALE: 1" = 100' HORIZ
1" = 10' VERT.

CERTIFICATE OF ENGINEER

I, Maria Barnhardt, hereby certify that this drawing was prepared by me or under my direct supervision. That is a compilation of various drawings and the best available information supplied by others. This information has not been verified for accuracy and/or completeness and there for the engineer shall not be responsible for any error or omissions which may be incorporated as a result

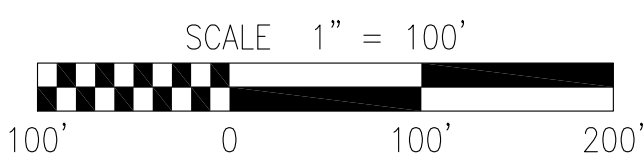

BASIS OF BEARING IS NAD27 ND STATE PLANE SOUTH ZONE. ALL DISTANCES ARE GRID DISTANCE.

REFERENCE DRAWINGS						
DESCRIPTION	DRAWING NO.					
ALIGNMENT DRAWING SHEET 2	7350-002C					
WELD DESIGNATION TABLE	7350-008C					
WELD DESIGNATION TABLE	7350-009C					
REV	ISSUE DATE	DESCRIPTION	DWN	CHK	APP	APP
0	7/8/15	AS BUILT	W.D.#40850210			

THIS DRAWING IS THE PROPERTY OF THE DAKOTA GASIFICATION COMPANY AND MAY NOT BE COPIED OR USED WITHOUT PRIOR AUTHORIZATION.

DAKOTA GASIFICATION COMPANY
420 COUNTY ROAD 26
BEULAH, ND 58523-9400

7350 AREA
DGC TO AVS 10" SNG PIPELINE
ALIGNMENT DRAWING SHEET 1

DWG. NO: 7350-001C SCALE: AS SHOWN
LDC. NO: D00043058

D00043058