

Mr. and Mrs. Robert Sprague
8720 20th ST SE
Courtenay, ND 58426

Mr. Darrell Nitschke
Public Service Commission's Executive Director
600 East Boulevard, Dept. 408
Bismarck, ND 58505-0480



July 18, 2013

Dear Mr. Darrell Nitschke and Public Service Commission,

We, Robert Sprague and Julie Sprague, are filing a request to consider additional evidence in Case # PU13-64 (Courtenay Wind Farm).

We just learned the proposed locations of the turbines, met towers and collector lines. We read this information in the Jamestown Sun published on 7-13-13. This is the first time we have seen a location map for the project.

We were under the impression from talking to local people involved with this project that the turbines would be located further north of our residence. We thought that Courtenay Wind Farm and Geronimo Energy would have contacted us if the turbines location affected us. We did not attend the hearing on 7-12-13 because we did not think we would be affected by the location of the turbines. After talking to the PSC on July 17, 2013 they helped us obtain clear and legible maps of the proposed Courtenay Wind Farm, Exhibit 3, 4 Part A, and 4 Part B.

We have lived at our residence: 8720 20th ST SE Courtenay, ND 58426 located in the northwest quarter of section 15, Ashland Township, range 142-63, Stutsman County, since 1995.

We have provided an aerial spraying service to the Courtenay, Wimbledon, and surrounding areas. We operate out of our residence, and fly from our private runway (8ND7) located behind our residence.

We have a beautiful country home that we have remodeled and two young children. We have enjoyed living in the country side these past eighteen years. Although we are not opposed to the Courtenay Wind Farm, we have many concerns. We have listed them and some will have attachments.

Concern # 1: Exhibit 4 Part B, clearly states that it includes homes within 5,000 ft of the project area. Exhibit 4 Part A shows locations of the residences. **Our residence is not listed on either exhibit 4 part B or shown on exhibit 4 part A.**

Our residence is within 5,000 ft of the project area. Our private runway (8ND7) is 5,230 ft from the project area.

We have attached a copy of Exhibit 4 Part A and marked our residence and runway

location. We have titled it residence and runway location.

We have concerns that turbines 1,2,3,10,11, 12,13,21,22, and permanent Met Tower B will affect the daily operations and safety of landings and take offs of our aerial spraying business runway. All the turbines are within two miles of the runway.

Concern # 2: Exhibit 4 Part B states it includes homes within 5,000 ft of the project area. Why was 5,000 ft chosen: Why not one mile which is 5,280 ft? Or, why not 2 miles or 3 miles?

We feel that 5,000 ft was chosen to exclude our private runway (8ND7) so that Geronimo Energy would not have to deal with FAA regulations concerning turbines and towers. But why was our residence was not included in exhibit 4 Part A and Exhibit 4 Part B? Our residence is within 5,000 ft of the project area.

Concern # 3: Our house faces east. Our only view of the country side. A direct view of the proposed turbines 1,2,3,10,11,12 and 13 will all be well within two miles. Our residence has five east facing windows with an open house plan. We are concerned with shadow flicker, and red blinking lights penetrating our home. We are also concerned that our property value will be lowered. Will we be compensated for property losses?

Concern# 4 Courtenay Wind Farm sent us information regarding buying shares in the project in the spring of 2013. We declined buying shares. Geronimo Energy has never contacted us or sent us any information regarding this project. We contacted them on 7-16-13 to express our issues. None were resolved.

Concern # 5 We believe that the people in the project area and around the project area should receive, by mail, Exhibit 3, Exhibit 4 Part A and Exhibit 4 Part B. Also, we would like to see residences, within two to three miles of the project area, included in the mailings. We ask for information and maps by mail because people are busy farming at this time of year and we have retired residences that may not have a computer and people may not know how to obtain this information. We were not provided with the project information and did not know how to obtain it, until we contacted the PSC.

After visiting with our neighbors, James and Sharon Hastings, about the turbine and tower locations we asked if they wanted us to include their request with ours. Their request to consider additional evidence in case #PU13-64 (Courtenay Wind Farm) is enclosed with our request letter.

In conclusion, we are not against Courtenay Wind Farm and Geronimo Energy, but **we do ask that turbines 1,2,3,10,11,12,13,21,22, and permanent Met Tower B be moved elsewhere.** We hope this project does not get railroaded through before area residences receive accurate information from Geronimo Energy, on paper, as to where the turbines, and met towers will be located and have a chance to express their concerns.

Sincerely,

Robert Sprague and Julie Sprague

I James O Hastings

on this day of July 18 2013

of my own free will express my objection to the Geronimo Energy turbines on SW corner of section two -142-63 address of 1878 88 Ave SE farm 5113 of USDA map

I have been declared 100% disabled by the USVA for traumatic stress disorder and noise and flashing lights can and has made my systems worse in the past .I am under medical care at this time to keep this under control .

I was told that the project would not or may not go through and I would have no towers near my retirement home and I would not hear any noise .

I am wondering why there was not an environment impact study done on this project. The area of towers is in a waterfowl fly way ,having studied towers in college , the killing of waterfowl was substantial.

With my health condition are they willing to buy me out and cover my losses ?

With towers in the minimum distance from my homestead who is going to pick up the loss of property value?

Why make the jog over to section 2 when they could have gone to sec.8,12,and 13 or any where but where they did!

Had Jay told me the truth when I talked to him I would not have signed up and would like to withdraw my consent.

I will turn this over to the USFWS service and the DAV attorneys to stop or reroute the turbines with my heart defibrillator and pace maker along with my PTSD .I felt this to be a bad Idea and oppose the turbines where they are now proposed .

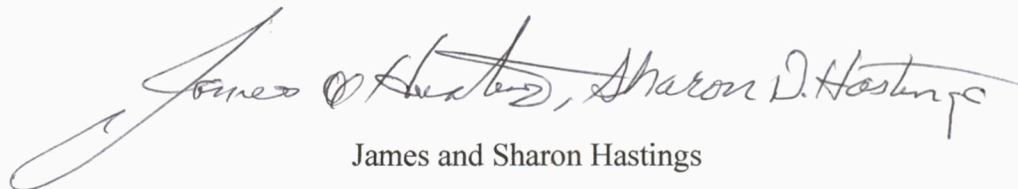
A handwritten signature in cursive script that reads "James O Hastings, Sharon D Hastings". The signature is written in dark ink and is positioned above the printed name.

James and Sharon Hastings

Residence and Runway Location

Residence

Runway

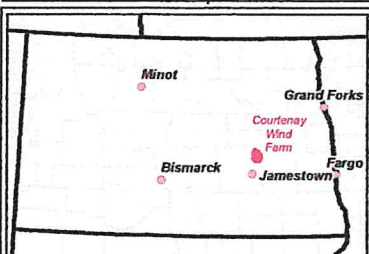
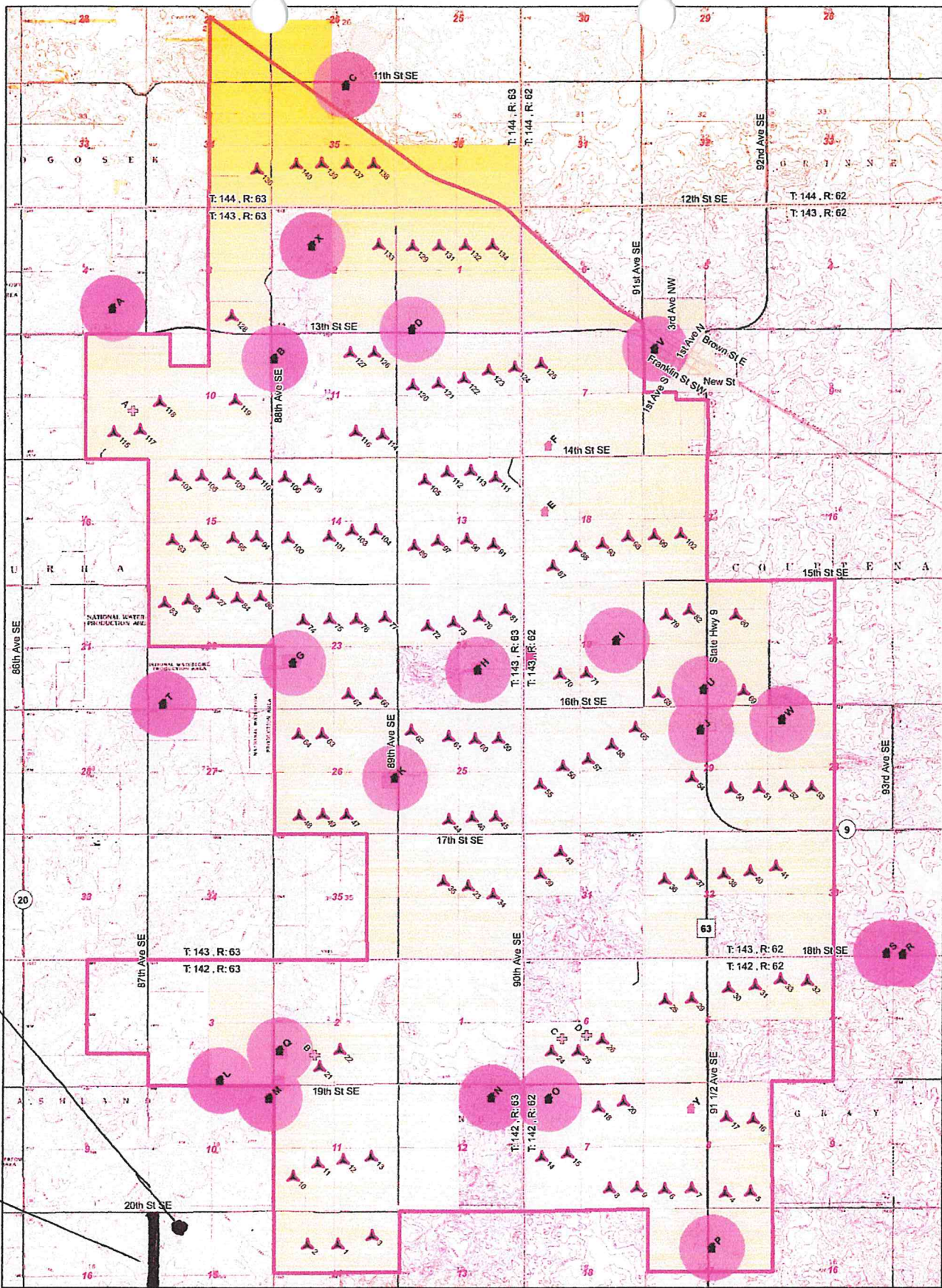

- Turbine Layout
 - Residence Setback (1400')
 - Permanent Met Towers
 - Project Area
 - Occupied Residence
 - Substation
 - Unoccupied Residence
 - Signed Parcel
- 0 0.4 0.8 1.6
Miles
- Source: Geronimo Energy, NGS USA Topo (2011),
Ventyx, ESRI et al: World Transportation (2012)



Home Setbacks,
Turbine Locations

Courtenay Wind Farm
Stutsman County, North Dakota

