

AFFIDAVIT OF PUBLICATION

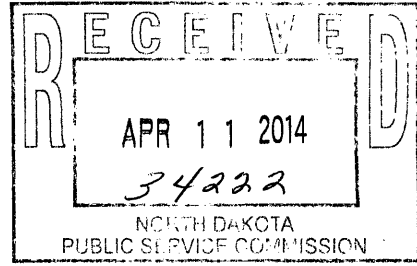

STATE OF NORTH DAKOTA)
COUNTY OF Mercer)

I SHELLEY CHASE, being first duly sworn, on my own oath, say, that I am the bookkeeper of the Hazen Star, a weekly newspaper of general circulation, published in the city of Hazen, that the advertisement headed:

DAKOTA WESTMORELAND HZ-APPLICATION SURFACE COAL PERMIT/LEGAL

a printed copy of which is here annexed, was published in the regular and entire issue of said newspaper during the period and time of publication, and that the notice was published in the newspaper proper, and not in a supplement,

for 4 consecutive week 02/27/2014 to wit:

Table with 4 columns: Column Inches, Price per inch, Total Price, and Date. Rows show 33.75 inch columns at \$5.94 per inch, totaling \$200.48 for dates 02/06/2014, 02/13/2014, 02/20/2014, and 02/27/2014.

Notary Fee \$1.00 Total Cost of Legal \$802.92

Handwritten signature of Shelley Chase

Handwritten signature of Paul P. Gores with handwritten text 3-28-14 WO# 401252

Subscribed and sworn to before me this 4th day of March A.D. 2014

(Seal) Darla J Mautz

Notary Public, State of North Dakota

My Commission Expires

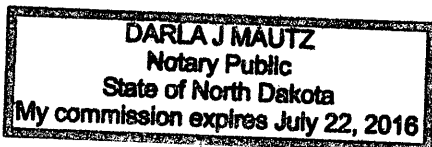

Public Notice

their claims within three months after the date of the first publication or mailing of this notice or said claims will be forever barred. Claims must either be presented to Patrick Moon, personal representative of the estate, 2611 25th Street S, Fargo, ND 58103, or filed with the Court:

Dated this 20th day of February, 2014.

Patrick Moon
Personal Representative
2611 25th Street S,
Fargo, ND 58103
Address

Lange & Donovan, PLLP
Gregory L. Lange #03491
Attorneys for the personal representative

P.O. Box 488
Hazen, ND 58545
First publication on the 27th day of February, 2014.
(2-27-14) (3-6-14) (3-13-14)

PUBLIC NOTICE

Notice is hereby given that on Tuesday, June 10, 2014 the annual school election will be held. The polling site

will be at the Underwood Public School. Polls will open at 11:00 a.m. and close at 7:00 p.m.

The school board members whose three year term expires in June: Brad Landenberger, City of Underwood - Mike Heger.

To file for the Rural area position, one must live outside of the city limits of Underwood or Riverdale.

Residents who desire to be on the ballot must file a Statement of Intent and Statement of Interests before 4:00 p.m., April 7th, 2014. The necessary forms for filing can be obtained from the Business Manager's office.

By order of the School Board of the Underwood School District #8.
Bobbi Jo Anderson
Business Manager
(2-27-14) (3-6-14)

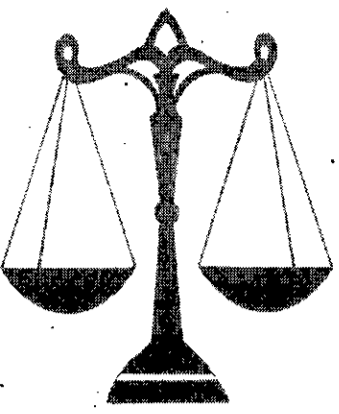

PUBLIC NOTICES
www.ndpublicnotices.com

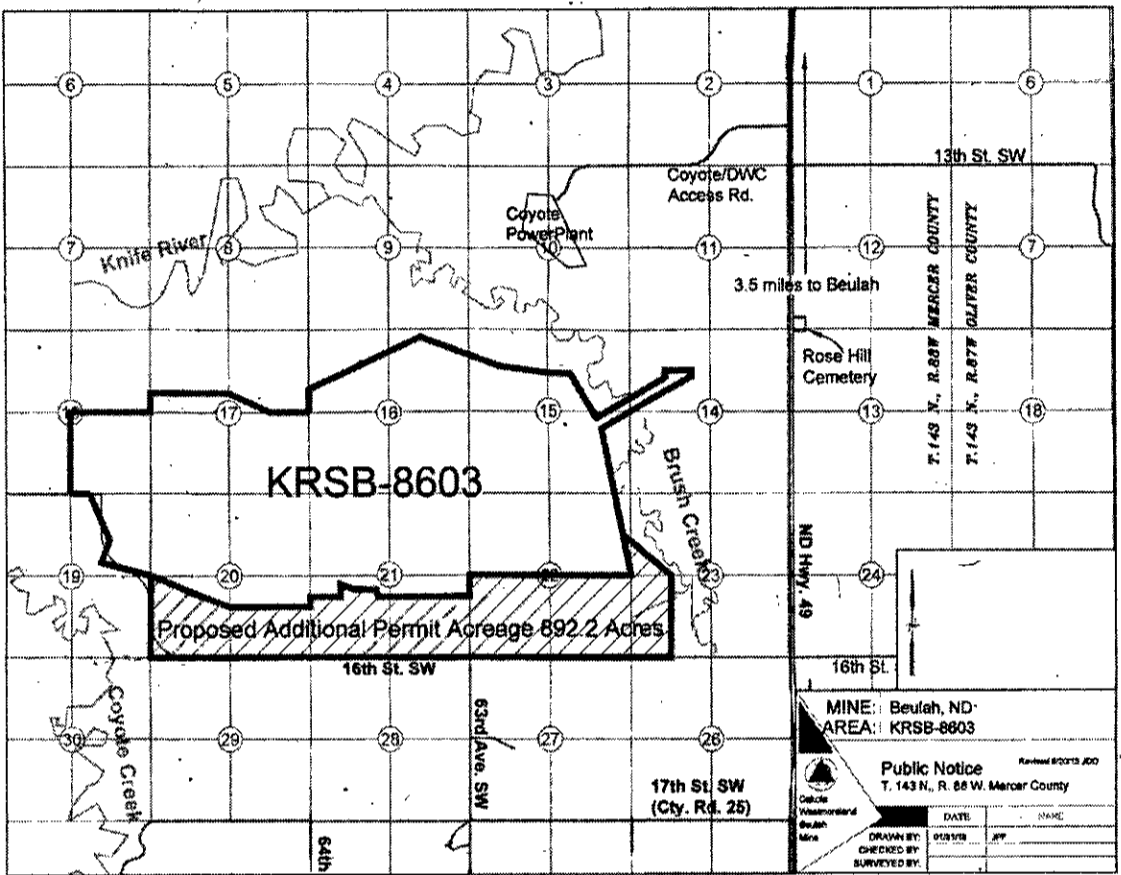

NOTICE OF APPLICATION FOR REVISION TO A SURFACE COAL MINE PERMIT

Please take notice that Dakota Westmoreland Corporation, PO Box 39, Beulah, North Dakota 58523, has made application to the North Dakota Public Service Commission for Revision No. 27 to Surface Coal Mining Permit KRSB-8603. Revision No. 27 adds 892.2 acres in Sections 20, 21, 22 and 23, T.143N., R.88W, Mercer County, to the existing permit area for a total of 3558.3 acres for coal excavation and mining and associated disturbance activities in support thereof. The section line common to Sections 22 and 23, excluding the north 1,400 feet, Township 143 North, Range 88 West, Mercer County, North Dakota will be mined through.

The permit area is located in Sections 14, 15, 16, 17, 18, 19, 20, 21, 22 and 23, T.143N., R.88W., Mercer County, North Dakota. This area is contained on the United States geological survey map named Medicine Butte, N.E., North Dakota. The precise location and boundaries of the permit area are depicted on the accompanying map.

This application is on file in the Office of the Director, Reclamation Division, Public Service Commission, 600 East Boulevard Avenue, Dept. 408, Bismarck, North Dakota 58505-0480 and the Office of the County Auditor, Mercer County, Stanton, North Dakota. It may be viewed at these locations during normal working hours.

Written comments, objections, requests for an informal conference or a petition to designate an area as unsuitable for surface coal mining operation that is within the area proposed to be added to the permit may be submitted by any person with an interest which is or may be adversely affected to the North Dakota Public Service Commission within 30 days of the last publication of this notice. Any request for an informal conference must include the reasons for the request.

The legal description and names of the apparent surface and mineral owners of the land included within the area to be added to the permit area is as follows:

T.143N., R.88W., Mercer County

LOCATION	SURFACE OWNER(S)	COAL OWNER(S)
N½S½, Sec. 20	Dakota Westmoreland Corporation	United States of America
S½S½, Sec. 20	Dakota Westmoreland Corporation	Dakota Westmoreland
S½, Sec. 21	Wilfred Fetch	State of North Dakota
	Angeline Braun	Wilfred Fetch
	Cary Unterseher	Angeline Braun
NE¼, Sec. 22	Terence Schmidt	Cary Unterseher
SE¼, Sec. 22	Vergene Christianson	United States of America
E½SW¼, Sec. 22	Ron Gunsch	United States of America
W½SW¼, Sec. 22	Rita Schmidt	United States of America
	Bonnita Schmidt	
	Debra (Schmidt) Hoerer	
	Darla (Schmidt) Ratzak	
	Gene Schmidt	
	Candida (Schmidt) Rhoades	
NW¼, Sec. 23	Terence Schmidt	Terence Schmidt
SW¼, Sec. 23	Terence Schmidt	Julia K. Allison
		Carl Bauer
		John Bauer
		Joan Brown
		Karen P. Dietz
		Margianna L. Hunt
		Nancy Weigel Jensen
		Kathy M. Leber
		Kathleen McCrary
		Tammy Schmidt
		Susan McCrary
		Cheryl McFadden
		David M. Pantermuehl
		John Pantermuehl
		Roland M. Pantermuehl
		Barbara Ann Teed
		Margaret Thorn
		Eugene Arnold Weigel
		Karel M. Weigel
		Janice P. Ziegler

(2-6-14) (2-13-14) (2-20-14) (2-27-14)



Classified Advertising Invoice

Bismarck Tribune
 PO BOX 4001
 LaCrosse, WI 54602-4001
 888-418-6474

DAKOTA WESTMORELAND

**PO BOX 39
 BEULAH ND 58523-0039**

Customer: **60007152**
 Phone: **(701) 873-4333**
 Date: **02/27/2014**

Date	Order #	Type	Order Amt
02/27/14	20704736	INV	1,404.00

Amount Paid: _____ CK #: _____

CREDIT CARD PAYMENT (circle one)



Card #: _____
 Exp Date: _____
 Signature: _____
 Credit card users: Fax to 608-791-8212

CashAmt

PLEASE DETACH AND RETURN TOP PORTION WITH YOUR PAYMENT

Lee Enterprises no longer accepts credit card payments sent via e-mail. Emails containing credit card numbers will be blocked. Please use the coupon above to send a credit card payment to remittance address located in the upper right corner. You may also send the coupon to a secure fax at 608-791-8212.

Date	Date	Times Run	Description	Lines	Class Code	Order Amt	Net Amt Due
			Mercer County / KRSB-8603	126.00	Legals	1,404.00	1,404.00
02/06/14	02/27/14	4	Bismarck Tribune				

Affidavit of Publication
 State of North Dakota) SS County of Burleigh
 Before me, a Notary Public for the State of North Dakota personally appeared CK who being duly sworn, deposes and says that he (she) is the Clerk of Bismarck Tribune Co., and that the publication(s) were made through the Bismarck Tribune on the following dates: 2/16, 13, 20, 27. Signed Calma Kuntz sworn and subscribed to before me this 13th day of March 20 14
Morgan Doll
 Notary Public in and for the State of North Dakota

MORGAN DOLL
 Notary Public
 State of North Dakota
 My Commission Expires Jan 26, 2017



Please return invoice or put order number on check. Thank You.

Remarks	Total Due: 1,404.00
---------	---------------------

Bismarck Tribune
www.bismarcktribune.com
 PO BOX 4001
 LaCrosse, WI 54602-4001

Paul P. Dore
 3-18-14
 WO # 401252

Terms: PAYMENT IS DUE UPON RECEIPT OF INVOICE

FOR REVISION TO A SURFACE COAL MINE PERMIT

Please take notice that Dakota Westmoreland Corporation, PO Box 39, Beulah, North Dakota 58523, has made application to the North Dakota Public Service Commission for Revision No. 27 to Surface Coal Mining Permit KRSE-8603. Revision No. 27 adds 892.2 acres in Sections 20, 21, 22 and 23, T.143N., R.88W, Mercer County, to the existing permit area for a total of 3558.3 acres for coal excavation and mining and associated disturbance activities in support thereof. The section line common to Sections 22 and 23, excluding the north 1,400 feet, Township 143 North, Range 88 West, Mercer County, North Dakota will be mined through.

The permit area is located in Sections 14, 15, 16, 17, 18, 19, 20, 21, 22 and 23, T.143N., R.88W, Mercer County, North Dakota. This area is contained on the United States geological survey map named Medicine Butte, N.E., North Dakota. The precise location and boundaries of the permit area are depicted on the accompanying map.

This application is on file in the Office of the Director, Reclamation Division, Public Service Commission, 600 East Boulevard Avenue, Dept. 408, Bismarck, North Dakota 58505-0480 and the Office of the County Auditor, Mercer County, Stanton, North Dakota. It may be viewed at these locations during normal working hours.

Written comments, objections, requests for an informal conference or a petition to designate an area as unsuitable for surface coal mining operation that is within the area proposed to be added to the permit may be submitted by any person with an interest which is or may be adversely affected to the North Dakota Public Service Commission within 30 days of the last publication of this notice. Any request for an informal conference must include the reasons for the request.

The legal description and names of the apparent surface and mineral owners of the land included within the area to be added to the permit area is as follows:

T.143N., R.88W., Mercer County

LOCATION	SURFACE OWNER(S)	COAL OWNER(S)
N1/2S1/2, Sec. 20	Dakota Westmoreland Corporation	United States of America
S1/2S1/2, Sec. 20	Dakota Westmoreland Corporation	Dakota Westmoreland State of North Dakota
S1/2, Sec. 21	Wilfred Fetch Angeline Braun Cary Unterseher	Wilfred Fetch Angeline Braun Cary Unterseher
NE1/4, Sec. 22	Terence Schmidt	United States of America
SE1/4, Sec. 22	Vergene Christianson	United States of America
E1/2SW1/4, Sec. 22	Ron Gunsch	United States of America
W1/2SW1/4, Sec. 22	Rita Schmidt Bonita Schmidt Debra (Schmidt) Hoerer Darla (Schmidt) Ratzak Gene Schmidt Candida (Schmidt) Rhoades	United States of America
NW1/4, Sec. 23	Terence Schmidt	Terence Schmidt Tammy Schmidt
SW1/4, Sec. 23	Terence Schmidt	Julia K. Allison Carl Bauer John Bauer Joan Brown Karen P. Dietz Margianna L. Hunt Nancy Weigel Jensen Kathy M. Leber Kathleen McCrary Susan McCrary Cheryl McFadden David M. Pantermuehl John Pantermuehl Roland M. Pantermuehl Barbara Ann Teed Margaret Thorn Eugene Arnold Weigel Karel M. Weigel Janice P. Ziegler

