

Exam Date:08/22/2013

Great Plains Processing, LLC dba

Page: 1

Examiner: 1

1100 19th Ave. N.

Fargo , ND

County: Barnes

Phone: 701-629-0591

CCC Number:

Location/Container Numbers/Comments	Section	Capacity
<b>PART A - ADDITIONAL SPACE TO BE INCLUDED UNDER LICENSE</b>		
G1	A	1,188
M1	A	1,188
M2	A	1,188
B1	A	580
B2	A	580
010	A	314
020	A	314
030	A	314
040	A	314
050	A	314
060	A	314
070	A	314
080	A	314
090	A	314
101	A	1,695
102	A	1,695
103	A	1,695
104	A	16,635
105	A	16,635
106	A	16,635
107	A	16,635
108	A	16,635
109	A	16,635
200	A	13,709
	<b>Total:</b>	<b>126,154</b>
<b>PART B - SPACE TO BE DELETED UNDER LICENSE</b>		
<NO BINS DELETED>		
	<b>Total:</b>	<b>0</b>
<b>PART C - ALL SPACE TO BE INCLUDED UNDER LICENSE</b>		
	A	127,000
	<b>Total:</b>	<b>127,000</b>
<b>PART D - TOTAL CAPACITY BY FUNCTIONAL UNIT</b>		
Valley City 1273	A	127,000
	<b>Total:</b>	<b>127,000</b>

Exam Date:08/22/2013

Great Plains Processing, LLC dba  
1100 19th Ave. N.  
Fargo , ND  
County: Barnes

Page: 1

Examiner: 1

Status	Section	Bin Number	Bin Type	Base Point	Diameter or Bu/Ft (Irreg.) Length	Width	Side wall	Add for Hopper	Ded. for Obst.	Effective Depth	Add for Peak	Depth for Capac.	Bushels per Foot	Base Pack%	Bushel Capacity with Pack
--------	---------	------------	----------	------------	---	-------	--------------	----------------------	----------------------	--------------------	--------------------	------------------------	------------------------	---------------	------------------------------

## Facility: Valley City

### Section: A

Added	A	010	Square		6.000	6.000	6.000	8.000	2.55	0.00	10.550	0.000	10.6	28.9	2.50	314
Added	A	020	Square		6.000	6.000	6.000	8.000	2.55	0.00	10.550	0.000	10.6	28.9	2.50	314
Added	A	030	Square		6.000	6.000	6.000	8.000	2.55	0.00	10.550	0.000	10.6	28.9	2.50	314
Added	A	040	Square		6.000	6.000	6.000	8.000	2.55	0.00	10.550	0.000	10.6	28.9	2.50	314
Added	A	050	Square		6.000	6.000	6.000	8.000	2.55	0.00	10.550	0.000	10.6	28.9	2.50	314
Added	A	060	Square		6.000	6.000	6.000	8.000	2.55	0.00	10.550	0.000	10.6	28.9	2.50	314
Added	A	070	Square		6.000	6.000	6.000	8.000	2.55	0.00	10.550	0.000	10.6	28.9	2.50	314
Added	A	080	Square		6.000	6.000	6.000	8.000	2.55	0.00	10.550	0.000	10.6	28.9	2.50	314
Added	A	090	Square		6.000	6.000	6.000	8.000	2.55	0.00	10.550	0.000	10.6	28.9	2.50	314
Added	A	101	Peaked		13.000	0.000	0.000	12.00	2.30	0.00	14.300	0.800	15.1	106.7	5.20	1,695
Added	A	102	Peaked		13.000	0.000	0.000	12.00	2.30	0.00	14.300	0.800	15.1	106.7	5.20	1,695
Added	A	103	Peaked		13.000	0.000	0.000	12.00	2.30	0.00	14.300	0.800	15.1	106.7	5.20	1,695
Added	A	104	Peaked		26.800	0.000	0.000	29.50	2.80	0.00	32.300	1.600	33.9	453.5	8.20	16,635
Added	A	105	Peaked		26.800	0.000	0.000	29.50	2.80	0.00	32.300	1.600	33.9	453.5	8.20	16,635
Added	A	106	Peaked		26.800	0.000	0.000	29.50	2.80	0.00	32.300	1.600	33.9	453.5	8.20	16,635
Added	A	107	Peaked		26.800	0.000	0.000	29.50	2.80	0.00	32.300	1.600	33.9	453.5	8.20	16,635
Added	A	108	Peaked		26.800	0.000	0.000	29.50	2.80	0.00	32.300	1.600	33.9	453.5	8.20	16,635
Added	A	109	Peaked		26.800	0.000	0.000	29.50	2.80	0.00	32.300	1.600	33.9	453.5	8.20	16,635
Added	A	200	Flat		0.000	68.00	38.00	6.000	0.00	0.00	6.000	0.000	6.0	2077.2	10.0	13,709
Added	A	B1	Square		7.000	10.00	5.000	10.70	3.30	0.00	14.000	0.000	14.0	40.2	3.00	580

Exam Date:08/22/2013

Great Plains Processing, LLC dba  
 1100 19th Ave. N.  
 Fargo , ND  
 County: Barnes

Examiner: 1

Status	Section	Bin Number	Bin Type	Base Point	Diameter or Bu/Ft (Irreg.) Length	Width	Side wall	Add for Hopper	Ded. for Obst.	Effective Depth	Add for Peak	Depth for Capac.	Bushels per Foot	Base Pack%	Bushel Capacity with Pack
--------	---------	------------	----------	------------	---	-------	--------------	----------------------	----------------------	--------------------	--------------------	------------------------	------------------------	---------------	------------------------------

## Facility: Valley City

### Section: A

Added	A	B2	Square		7.000	10.00	5.000	10.70	3.30	0.00	14.000	0.000	14.0	40.2	3.00	580
Added	A	G1	Square		10.000	10.00	10.00	10.70	3.30	0.00	14.000	0.000	14.0	80.4	5.50	1,188
Added	A	M1	Square		10.000	10.00	10.00	10.70	3.30	0.00	14.000	0.000	14.0	80.4	5.50	1,188
Added	A	M2	Square		10.000	10.00	10.00	10.70	3.30	0.00	14.000	0.000	14.0	80.4	5.50	1,188

**Bin count: 24**

**Facility: Valley City Section: A Total: 126,154**

**To Even: 127,000**

**Overall Licensed Bin Capacity for:**

**Great Plains Processing, LLC dba**

**Bin count: 24**

**Licensed Capacity:**

(includes pack)

**126,154 Bu.**

**Licensed Capacity (to even):**

(includes pack and section totals are rounded up to next highest 1000)

**127,000 Bu.**

Northern Plains Grain  
Valley City, ND

10	60	70
20	50	80
30	40	90

Lower Bins  
Above Mill Room

G 1	M 1
B 1	M 2
B 2	

Upper Bins

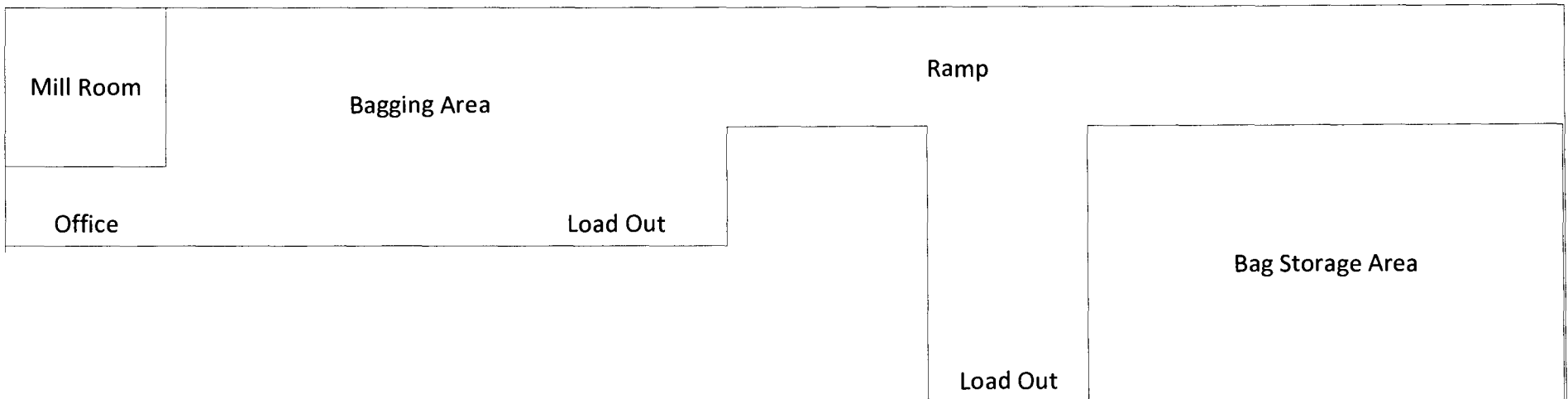

Northern Plains Grain & Milling  
Valley City, ND  
4085

