



30 west superior street / duluth, minnesota 55802-2093 / fax: 218-723-3955 /www.allete.com

David R. Moeller  
Senior Attorney  
218-723-3963  
dmoeller@allete.com

March 5, 2013

VIA OVERNIGHT DELIVERY



Mr. Darrel Nitschke  
Executive Secretary  
North Dakota Public Service Commission  
600 E. Boulevard Ave., Dept. 408  
Bismarck, North Dakota 58505-0480

**RE: Minnesota Power's Letter of Intent to Construct Transmission Facility and Request to Shorten the One-Year Time Requirement for Filing Application And Request for Jurisdictional Determination**

Dear Mr. Nitschke:

Minnesota Power, an operating division of ALLETE, Inc.,<sup>1</sup> must reroute two portions of its existing 250kV direct current transmission line ("DC Line") that runs between the Square Butte Substation in Center North Dakota and Minnesota Power's Arrowhead Substation Near Duluth, Minnesota. Minnesota Power acquired this line from Square Butte in 2009, which included the transfer of transmission facility permits in Case No. PU-09-631. The proposed reroutes will improve the transmission line's reliability, minimize potential environmental impacts and comply with North American Electric Reliability Council ("NERC") directives.

The purpose of this letter is to: (1) notify the North Dakota Public Service Commission ("Commission") of Minnesota Power's intent to reroute the transmission facility as required by N.D.C.C. § 49-22-07.1 and (2) request the Commission shorten the one-year waiting period between this notification and when applications for a Certificate of Corridor Compatibility and a Route Permit can be submitted as established by N.D. Admin. Code 69-06 03-01 to one day. This request is made pursuant to N.D.C.C. § 49-22-07.2.

<sup>1</sup> Minnesota Power is an operating division of ALLETE, Inc. ALLETE's Certificate of Good Standing issued by the North Dakota Secretary of State was provided to the Commission in a letter dated May 16, 2011 in Case No. PU-11-57.



30 west superior street / duluth, minnesota 55802-2093 / fax: 218-723-3955 /www.allete.com

Specifically, Minnesota Power is proposing to request Commission approval for the transmission facility reroutes to be located in and along an approximately 1.9 mile corridor in Kidder County and an approximately 0.7 mile corridor in Stutsman County. Attachment A is a map of both proposed DC line reroutes. N.D. Admin. Code 69-06-03-02(2). Minnesota Power anticipates initial site work construction to commence in fall 2013, contingent on obtaining all necessary approvals from the Commission and local governments, and be completed in fall 2013. N.D. Admin. Code 69-06-03-02(3). Minnesota Power estimates that the DC Line reroutes will cost approximately \$1.8 million, depending on final project design. N.D. Admin. Code 69-06-03-02(4).

Minnesota Power respectfully requests pursuant to N.D.C.C. § 49-22.07.2 that the Commission shorten the one-year waiting period between filing this letter of intent and the siting application to one day. N.D. Admin. Code. 69-06-03-01. The original and ten copies of this waiver application are being filed with the Commission as required by N.D. Admin. Code 69-06-06-01.2. In addition, Minnesota Power requests, to the extent applicable, a Commission determination pursuant to N.D. Admin. Code N.D. Admin. Code 69-06-06-01.2 whether the proposed reroute in Stutsman County, which is less than one mile, falls within the definition of transmission facility under N.D.C.C. § 49-22.03(12)(a)(2) and requires Commission approval.

If you have any questions, or need additional information, please contact me at the above-listed number.

Sincerely,

David R. Moeller

Attachment

c: Daniel McCourtney, Minnesota Power

# Minnesota Power Proposed Transmission Line Reroutes

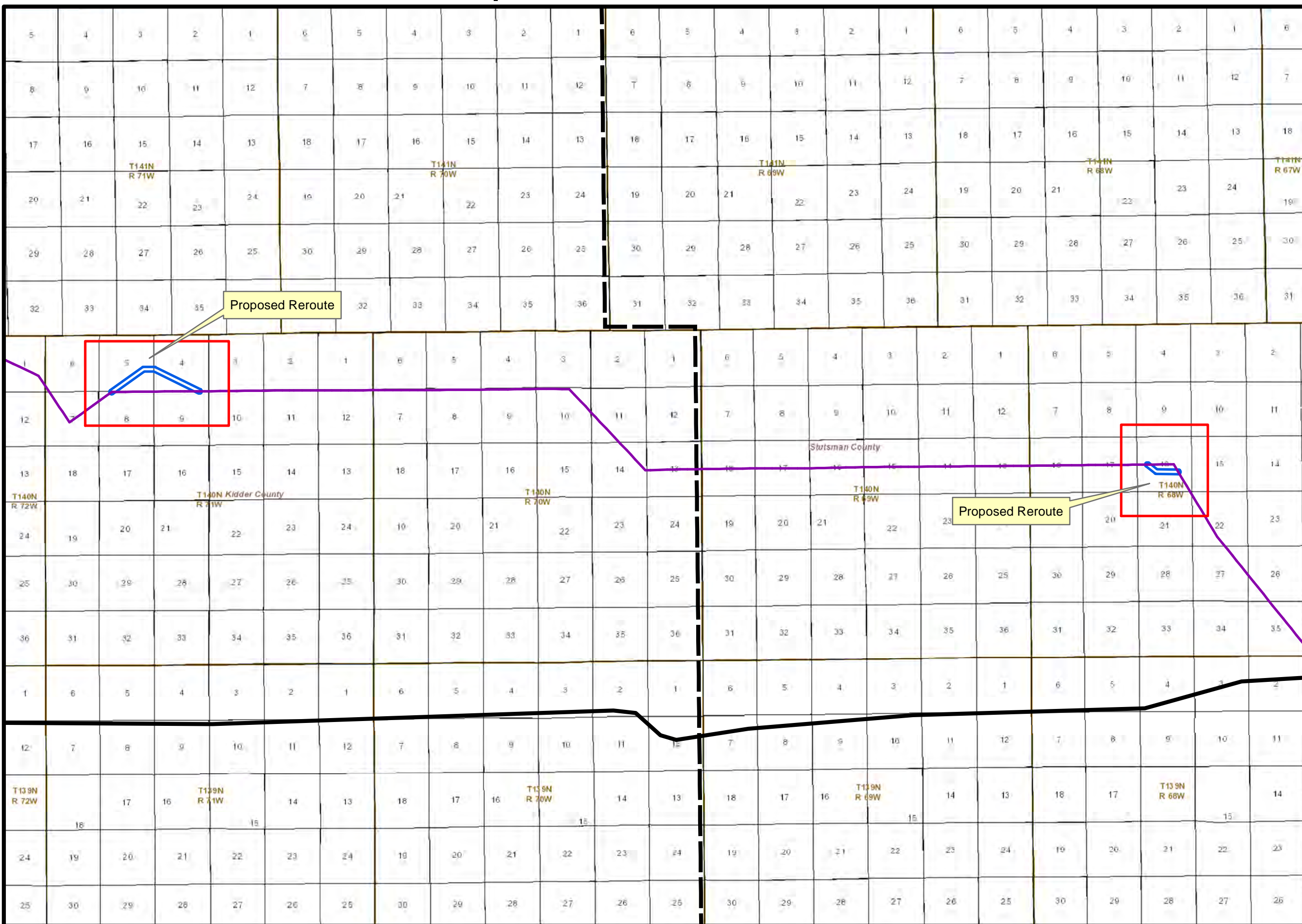

- Legend**
- Minnesota Power DC Line
  - Proposed\_Reroutes
  - Interstate 94
  - Kidder/Stutsman County Line
  - PLSS Sections
  - PLSS Townships
  - Counties

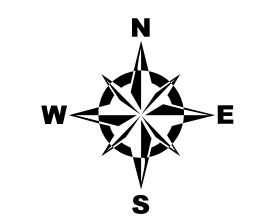

3.5 Kilometers

