



Square Butte
ELECTRIC COOPERATIVE

Phone 795-4000
P.O. Box 13200 • Grand Forks, ND 58208-3200



May 15, 2013

Secretary to the Commission
North Dakota Public Service Commission
State Capitol Building
Bismarck, North Dakota 58505

Dear Sir:

In accordance with Section 49-22-04 of the North Dakota Century Code, Square Butte Electric Cooperative herewith files the enclosed Ten-Year Plan with the North Dakota Public Service Commission.

Any questions concerning the contents of the enclosed document should be directed to me.

Sincerely,

MINNKOTA POWER COOPERATIVE, INC.

Dale Sollom
Planning Manager

Enclosure



TEN-YEAR PLAN

**SQUARE BUTTE ELECTRIC COOPERATIVE
Grand Forks, North Dakota**

Prepared for the North Dakota Public Service Commission
Pursuant to Section 49-22-04 of the
North Dakota Century Code

MPC
PLANNING DEPARTMENT

July 2013

TABLE OF CONTENTS

Page Number

INTRODUCTION	1
SECTION A: Existing Energy Conversion Facilities	2
SECTION B: Energy Conversion Facilities Under Construction	2
SECTION C: Proposed Energy Conversion Facilities on Which Construction is Intended Within the Ensuing Five Years	2
SECTION D: Proposed Energy Conversion Facilities During the Next Ten-Year Time Period	2
SECTION E: Existing Transmission Facilities (Electric)	2
SECTION F: Existing Transmission Facilities (Pipeline)	2
SECTION G: Proposed Transmission Facilities on Which Construction is Intended Within the Ensuing Five Years (Electric)	3
SECTION H: Proposed Transmission Facilities on Which Construction is Intended Within the Ensuing Five Years (Pipeline)	3
SECTION I: Proposed Transmission Facilities During the Next Ten-Year Time Period (Electric and Pipeline)	3
SECTION J: Regional Coordination	3
SECTION K: Environmental Information	3
SECTION L: Projected Demand for Service	3
EXHIBIT I: U.S. Department of Energy Form EIA-923	
EXHIBIT II: Federal Energy Regulatory Commission Form FERC-714	
EXHIBIT III: Square Butte Electric Cooperative Water Pipeline Map	

SQUARE BUTTE ELECTRIC COOPERATIVE TEN-YEAR PLAN

INTRODUCTION

Square Butte Electric Cooperative was organized in May 1972 as a cooperative corporation under the laws of the State of North Dakota.

Square Butte was organized principally to finance and arrange for the construction and operation of the Milton R. Young Unit 2, a 455 MW steam electric generator and a 463 mile \pm 250 kilovolt D.C. transmission line from its generating unit (located near Center, North Dakota) to Duluth, Minnesota.

Currently, 50 percent of the electrical energy produced by Young 2 is sold to Minnkota and 50 percent is sold to Minnesota Power.

On December 31, 2009 Square Butte sold its D.C. line to Minnesota Power. As part of the sale of the D.C. line, Minnkota will receive an increasing allocation of Young 2 electrical output beginning in 2014 when a new 345 kV transmission line from Center to Grand Forks is expected to be completed. Minnkota's allocation will increase, in varying increments, until 2026, at which point Minnkota will receive 100 percent of the electrical energy produced by Young 2.

**SQUARE BUTTE ELECTRIC COOPERATIVE
TEN-YEAR PLAN**

SECTION A: Existing Energy Conversion Facilities

1. See Exhibit I
2. None

SECTION B: Energy Conversion Facilities Under Construction

None

SECTION C: Proposed Energy Conversion Facilities on Which Construction is Intended
Within the Ensuing Five Years

None

SECTION D: Proposed Energy Conversion Facilities During the Next Ten-Year Time
Period

None

SECTION E: Existing Transmission Facilities (Electric)

None

SECTION F: Existing Transmission Facilities (Pipeline)

1. See Exhibit III
2.
 - a. Product type: water
 - b. Length of facilities in miles: 13
 - c. Pipe size: 30 inches
 - d. Maximum design operating pressure: 800 pounds per square inch
 - e. Maximum design flow rate: 30 cubic feet per second
 - f. Pump specifications: two 1500-horsepower electric motors with a capacity of 6740 gmp
 - g. Minimum cover over pipe: 7 feet
3. March 1977
4. None

SECTION G: Proposed Transmission Facilities on Which Construction is Intended Within the Ensuing Five Years (Electric)

None

SECTION H: Proposed Transmission Facilities on Which Construction is Intended Within the Ensuing Five Years (Pipeline)

None

SECTION I: Proposed Transmission Facilities During the Next Ten-Year Time Period (Electric and Pipeline)

None

SECTION J: Regional Coordination

See Minnkota Power Cooperative's Ten-Year Plan

SECTION K: Environmental Information

See Minnkota Power Cooperative's Ten-Year Plan

SECTION L: Projected Demand for Service

See Minnkota Power Cooperative's Ten-Year Plan

EXHIBIT I

U.S. Department of Energy Form EIA-923
(Supersedes U.S. Department of Energy Form EIA-767)
(Supersedes FERC Form 67)

NOTICE: This report is mandatory under the Federal Energy Administration Act of 1974 (Public Law 93-275). Failure to comply may result in criminal fines, civil penalties and other sanctions as provided by law. For further information concerning sanctions and data protections see the provision on sanctions and the provision concerning confidentiality of information in the instructions. Title 18 USC 1001 makes it a criminal offense for any person knowingly and willingly to make to any Agency or Department of the United States any false, fictitious, or fraudulent statements as to any matter within its jurisdiction.

SCHEDULE 1. IDENTIFICATION

Survey Contact

Contact Kay Schraeder Submit By 200003322
Title Accountant Submit Date 19-MAR-13
Address 1822 Mill Road Accept By
Accept Date
City/State/Zip Grand Forks ND 58208
Email kschraeder@minnkota.com Phone (701) 795-4266 Fax (701) 795-4215

Supervisor of Contact Person for Survey

Contact Craig Rustad
Title Accounting Manager
Address 1822 Mill Road
City/State/Zip Grand Forks ND 58208
Email crustad@minnkota.com Phone (701) 795-4261 Fax (701) 795-4215

Report For

Company Name Minnkota Power Coop, Inc
Plant Name Milton R Young
Plant ID 2823 Plant County Oliver
Plant Address 3401 24th Street S.W.
Plant City Center Plant State ND

Regulated Yes No
CHP Yes No
CHP Efficiency

For contact detail go to <http://www.eia.doe.gov/oss/forms.html#eia-923>

SCHEDULE 6. NONUTILITY ANNUAL SOURCE AND DISPOSITION OF ELECTRICITY
(Instructions for SCHEDULE 6 are on page 13)

SCHEDULE 6 collects calendar year data (no monthly detail).
Annual data are due by March 30 following the reporting year.
Report all generation in megawatthours (MWh) rounded to a whole number.

- | | |
|--------------------------------|--|
| (1) Gross Generation (Annual) | (4) Station Use |
| (2) Other Incoming Electricity | (5) Direct Use |
| | (6) Total Facility Use (4 + 5) |
| | (7) Retail Sales to Ultimate Customers |
| | (8) Sales for Resale (MWh) |
| | (9) Other Outgoing Electricity |
| (3) Total Sources (1 + 2) | (10) Total Disposition (6 + 7 + 8 + 9) |

Total Sources must equal Total Disposition (3 = 10)

Plants that cannot separate Station Use and Direct Use may enter zero in Station Use and the sum of Station Use and Direct Use in the Direct Use field.

SCHEDULE 7. ANNUAL REVENUES FROM SALES FOR RESALE
(Instruction for SCHEDULE 7 are on page 14.)

SCHEDULE 7 is to be completed by respondents who entered a positive amount on SCHEDULE 6, Disposition of Electricity, Item 8, Sales for Resale. Annual data are due by March 30 following the reporting year.

Sales for Resale is energy supplied to other electric utilities, cooperatives, municipalities, Federal and State electric agencies, or other entities for resale to end-use consumers.

Annual Revenues from Sales for Resale (in thousand dollars)

SCHEDULE 8. PART B. FINANCIAL INFORMATION
 (Instructions for SCHEDULE 8 PART B are on page15.)

If actual data are not available, provide an estimated value.

Operation and Maintenance (O&M) Expenditures During Year (Thousand Dollars)

Type	(1) Fly Ash	(2) Bottom Ash	(3) Flue Gas Desulfurization	(4) Water Pollution Abatement	(5) Other Pollution Abatement	(6) Total (1 + 2 + 3 + 4 + 5)
Collection	1,265	1,163	11,813	287	0	14,528
Disposal	930	663	602	12	0	2,207
Other	0	0	0	0	7,975	7,975

Capital Expenditures for New Structures and Equipment During Year, Excluding Land and Interest Expense (Thousand Dollars)

Type	(7) Air Pollution Abatement	(8) Water Pollution Abatement	(9) Solid/Contained Waste	(10) Other Pollution Abatement
Amount	4,680	10	7,346	0

Byproduct Sales Revenue During Year (Thousand Dollars)

Type	(11) Fly Ash	(12) Bottom Ash	(13) Fly and Bottom Ash Sold Intermingled	(14) Flue Gas Desulfurization	(15) Other Byproduct Revenue	(16) Total (11+12+13+14+15)
Amount	25	304	0	0	0	329

SCHEDULE 8. PART C. BOILER INFORMATION NITROGEN OXIDE EMISSION CONTROLS
(Instructions for SCHEDULE 8 PART C are on page 16.)

Complete a separate row for each boiler.

Note: The Boiler ID must match the Boiler ID as reported on Form EIA-860, "Annual Electric Generator Report."

No NOX Controls

Boiler ID	NOx Control In-Service (hours)	NOx Emission Rate (lbs/MMBtu)	
		Entire Year	May through September
B1	8,482	.3	.3
B2	8,138	.3	.3

SCHEDULE 8. PART D. COOLING SYSTEM INFORMATION, MONTHLY OPERATIONS

(Instructions for SCHEDULE 8 PART D are on page 16.)

Note: Cooling System ID must match the ID as reported on Form EIA-860, "Annual Electric Generator Report."
 Complete a separate row for each cooling system.

Cooling System ID	Status	Chlorine added to Cooling Water (1000 lbs)	Hours in Service	Average Annual Rate of Cooling Water (to nearest 0.1 ft ³ /sec)				Estimation	Maximum Cooling Water Temperature at Intake (F)		Maximum Cooling Water Temperature at Discharge Outlet (F)		Estimation	
				Diversion	Withdrawal	Discharge	Consumption		Monthly Avg	Monthly Max	Monthly Avg	Monthly Max		
Month 1														
CS1	OP	1	744	0	131.5	131.5	0	4	48	56	81	91	1	
CS2	OP	1	744	0	557	557	0	4	47	55	61	71	1	
Month 2														
CS1	OP	1	696	0	131.5	131.5	0	4	50	56	84	92	1	
CS2	OP	1	685	0	487.4	487.4	0	4	49	57	59	85	1	
Month 3														
CS1	OP	1	743	0	168.7	168.7	0	4	58	67	85	99	1	
CS2	OP	1	743	0	557	557	0	4	57	68	72	84	1	
Month 4														
CS1	OP	1	619	0	232.1	232.1	0	4	65	74	81	93	1	
CS2	OP	1	720	0	557	557	0	4	64	74	80	91	1	
Month 5														
CS1	OP	1	744	0	263	263	0	4	72	80	90	98	1	
CS2	OP	1	744	0	557	557	0	4	72	80	88	99	1	
Month 6														
CS1	OP	1	720	0	263	263	0	4	76	88	94	106	1	
CS2	OP	1	524	0	391.5	391.5	0	4	77	88	88	112	1	
Month 7														
CS1	OP	1	687	0	252.2	252.2	0	4	89	93	106	111	1	
CS2	OP	1	744	0	552.4	552.4	0	4	88	94	107	112	1	
Month 8														
CS1	OP	1	698	0	255.3	255.3	0	4	84	91	101	110	1	
CS2	OP	1	744	0	557	557	0	4	84	91	102	110	1	
Month 9														
CS1	OP	1	630	0	246	246	0	4	76	86	92	105	1	

EIA923 Power Plant Operations Report

Year: **2012** Plant: **2823** **Milton R Young**

CS2	OP	1	720	0	504.4	504.4	0	4	76	86	88	106	1
Month 10													
CS1	OP	1	505	0	221.3	221.3	0	4	62	72	85	101	1
CS2	OP	1	720	0	521.5	521.5	0	4	61	72	74	90	1
Month 11													
CS1	OP	1	720	0	131.5	131.5	0	4	54	63	88	99	1
CS2	OP	1	720	0	527.6	527.6	0	4	53	62	68	78	1
Month 12													
CS1	OP	1	744	0	193.4	193.4	0	4	50	55	76	92	1
CS2	OP	1	744	0	557	557	0	4	49	55	65	71	1

SCHEDULE 8. PART E . FLUE GAS PARTICULATE COLLECTION INFORMATION
(Instructions for SCHEDULE 8 PART E are on page 17)

Complete a separate row for each flue gas particulate collector.

Does not Apply

Removal Efficiency of Particulate Matter (nearest 0.1% by weight)

Flue Gas Particulate Collector ID	Status	Hours in Service	Typical Particulate Emissions Rate (nearest 0.01 lb/MMBtu)	At Annual Operating Factor	At 100% Load or Tested Efficiency	Date of Most Recent Efficiency Test (e.g., 12-2005)
ESP1	OP	8,573	.01	99.9	100	08-1975
ESP2	OP	8,255	.01	99.9	100	08-1977

SCHEDULE 8. PART F. FLUE GAS DESULFURIZATION UNIT INFORMATION, ANNUAL OPERATIONS
 (Instructions for SCHEDULE 8 PART F are on page 19.)

Note: Flue Gas Desulfurization ID must match the ID as reported on Form EIA-860, "Annual Electric Generator Report."
 Complete a separate row for each Flue Gas Desulfurization Unit.

ANNUAL OPERATIONS

Does not Apply

Removal Efficiency of Sulfur Dioxide (nearest 0.1% by wt)

Flue Gas Desulfurization Unit ID	FGD Unit Status	Hours In Service	Quantity of FGD Sorbent Used (to nearest 0.1 thousand tons)	Electrical Energy Consumption (MWh)	At Annual Operating Factor	At 100% Load or Tested Efficiency	Date of Most Recent Efficiency Test (e.g., 12-2005)
FGD1	OP	8,482	17.6	9,067	97.1	97.1	12-2012
FGD2	OP	8,138	32.7	31,103	95.7	95.7	12-2012

OPERATION AND MAINTENANCE EXPENDITURES DURING YEAR, EXCLUDING ELECTRICITY (THOUSAND DOLLARS)

Flue Gas Desulfurization Unit ID	Feed Materials and Chemicals	Labor and Supervision	Waste Disposal	Maintenance, Materials and All Other Costs	Total
FGD1	\$2,956	\$370	\$211	\$388	\$3,925
FGD2	\$5,598	\$596	\$391	\$1,905	\$8,490

Schedule 9 Comments

Schedule	Part	Item	Comment

Purchase Type	Fuel	Schedule	Prime Mover	Equipment ID	Rpt Month	Supplier	Error Log	Error Number & Description/Override	Ranges
		8A						844 Total volume of fly ash is an unexpectedly high or low portion of the combined total of fly ash and bottom ash; please check. Default	
		8F		FGD1				852 Total O&M expenditures exceed typical expenses to operate FGD units at steam electric power plants Default	

EXHIBIT II

Federal Energy Regulatory Commission Form FERC-714
(Supersedes FERC Form 12)



Federal Energy Regulatory Commission
FERC Form No. 714

Annual Electric Balancing Authority Area and Planning Area Report

For the Year Ending December 31, 2012

Form Approved
OMB Numbers: 1902 - 0140
(Expires: 01-31-2013)

Part I - Schedule 1. Identification and Certification

1. Respondent Identification:

Code: 17858 Name: Square Butte Electric Coop

2. Respondent Type: (Please check appropriate box and fill in name)

Part I: Balancing Authority Area (Complete Parts I, II, and IV)

Unit dispatch is not based on the economic dispatch of thermal units (i.e., a system lambda is not calculated)

Balancing Authority Area Name:

Part II: Planning Area (Complete Parts I, III, and IV)

Planning Area Name:

Minnkota Power Cooperative

3. Respondent Mailing Address:

Minnkota Power Cooperative
1822 Mill Road
Grand Forks, ND 58208-3200

4. Contact Person:

Name: Cameron Korynta
Title: Energy Marketer
E-mail address: ckorynta@minnkota.com

Telephone #: 701-795-4429 Ext:

5. Certifying Official:

Name: Cameron Korynta
Title: Energy Marketer Supervisor
Date: 05/14/2013

This report is an Original Revised Filing

**Annual Electric Balancing Authority Area and Planning
 Area Report**
 For the Year Ending December 31, 2012

Utility Code: 17858
 Utility Name: Square Butte Electric Coop

Part III - Schedule 1. Electric Utilities That Compose the Planning Area

Enter the name of each entity, including the respondent, that forms the planning area for which this report is being prepared and their coincident summer and winter peak demands in megawatts. Refer to the Form 714 instructions for specific guidelines.

Line No (a)	Electric Utility Name (b)	Electric Utility Coincident Peak Demand (MW)	
		Summer (c)	Winter (d)
1	Square Butte Electric Coop	450	450
2			
3			
4			
5			
6			
7			
8			
9			
10			
11			
12			
13			
14			
15			
16			
17			
18			
19			
20			
21			
22			
23			
24			
25			
26			
27			
28			
29			

**Annual Electric Balancing Authority Area and Planning
Area Report
For the Year Ending December 31, 2012**

Utility Code: 17858
Utility Name: Square Butte Electric Coop

Part III - Schedule 2. Planning Area Hourly Demand

Respondents must provide the following data: the planning area's actual hourly demand, in megawatts, for each hour of the year starting with 1 a.m. January 1 as more fully described in the Form 714 instructions. In column (b) indicate the time zone and the days for which daylight savings time was observed. This schedule will have 365 rows for the report year (366 rows for a leap year). For hours when this information is not available, enter "0.00" and provide, as a footnote to those hours, an explanation describing the reason for the unavailability of the data.

Date	Time Zone	0100	0200	0300	0400	0500	0600	0700	0800	0900	1000	1100	1200	1300	1400	1500	1600	1700	1800	1900	2000	2100	2200	2300	2400
(a)	(b)	(c)	(d)	(e)	(f)	(g)	(h)	(i)	(j)	(k)	(l)	(m)	(n)	(o)	(p)	(q)	(r)	(s)	(t)	(u)	(v)	(w)	(x)	(y)	(z)
01/01/2012	CST	329	329	329	329	329	329	330	329	330	329	328	329	329	329	330	330	366	428	429	430	374	330	330	330
01/02/2012	CST	331	331	330	331	330	330	366	431	428	427	428	429	429	429	430	429	429	429	429	429	430	429	429	429
01/03/2012	CST	429	429	429	426	428	430	430	431	431	427	430	432	431	433	431	431	430	429	430	429	429	428	429	370
01/04/2012	CST	329	331	331	331	365	430	427	426	427	426	425	426	427	427	427	427	427	427	427	429	426	428	429	429
01/05/2012	CST	429	428	429	428	427	428	429	421	428	427	429	428	429	428	428	427	425	424	424	419	425	423	421	383
01/06/2012	CST	414	353	329	364	422	422	426	427	417	427	426	428	427	426	426	429	427	428	426	428	425	417	427	428
01/07/2012	CST	430	425	429	427	430	431	430	431	430	430	429	430	431	431	431	430	431	429	430	429	429	430	430	428
01/08/2012	CST	429	429	429	430	430	428	429	428	430	429	429	430	431	431	432	429	432	430	429	430	429	429	428	336
01/09/2012	CST	337	331	331	329	379	428	430	428	428	410	427	430	432	429	427	431	431	431	430	430	430	429	431	429
01/10/2012	CST	387	381	405	432	430	430	430	430	429	429	430	429	431	431	431	431	430	430	429	429	429	428	427	429
01/11/2012	CST	429	429	428	427	429	416	429	423	412	422	402	345	331	330	329	330	333	390	430	426	427	426	425	374
01/12/2012	CST	332	330	330	330	330	370	429	428	427	427	427	428	429	429	431	432	431	430	429	429	429	430	429	428
01/13/2012	CST	429	426	429	428	429	430	430	429	429	429	430	430	431	430	431	432	430	429	429	428	430	429	430	430
01/14/2012	CST	430	429	429	429	429	429	429	428	428	428	429	430	431	429	431	430	431	430	430	430	430	430	430	429
01/15/2012	CST	429	427	418	413	405	398	393	400	429	409	408	417	419	386	388	405	428	427	422	429	423	422	419	378
01/16/2012	CST	335	331	340	393	423	426	428	426	429	428	428	429	429	429	429	429	429	429	429	429	429	428	427	410
01/17/2012	CST	422	372	328	333	391	428	428	428	427	426	428	427	429	428	428	429	428	427	428	428	427	428	428	428
01/18/2012	CST	428	427	428	428	427	417	430	429	428	424	423	426	426	426	423	426	427	428	428	428	424	426	427	429
01/19/2012	CST	429	429	429	430	430	429	429	429	429	430	430	428	430	431	430	433	431	431	430	431	429	430	430	431
01/20/2012	CST	430	430	430	430	428	428	428	428	428	427	429	428	429	430	429	430	429	430	430	430	430	429	430	429
01/21/2012	CST	427	416	430	429	429	429	429	429	429	428	429	429	430	430	429	430	429	429	429	430	430	430	404	330
01/22/2012	CST	332	332	331	330	329	373	433	431	430	430	431	432	431	431	429	429	430	429	429	428	429	429	428	429
01/23/2012	CST	378	329	328	329	382	432	429	279	208	356	424	429	428	479	428	430	429	429	429	429	429	428	429	429
01/24/2012	CST	429	428	428	429	429	429	429	429	429	430	430	430	431	432	431	431	431	431	431	430	431	430	429	429
01/25/2012	CST	430	428	429	429	429	429	429	431	431	431	430	431	430	431	427	422	422	420	421	423	429	429	425	430
01/26/2012	CST	430	429	429	428	430	417	431	429	427	428	430	430	428	430	430	431	430	429	430	430	430	428	428	429
01/27/2012	CST	430	428	430	429	429	428	429	428	427	427	427	428	428	427	428	428	427	421	414	428	427	427	427	372

**Annual Electric Balancing Authority Area and Planning
 Area Report**
 For the Year Ending December 31, 2012

Utility Code: 17858
 Utility Name: Square Butte Electric Coop

Part III - Schedule 2. Planning Area Hourly Demand (continued)

Date (a)	Time Zone (b)	0100 (c)	0200 (d)	0300 (e)	0400 (f)	0500 (g)	0600 (h)	0700 (i)	0800 (j)	0900 (k)	1000 (l)	1100 (m)	1200 (n)	1300 (o)	1400 (p)	1500 (q)	1600 (r)	1700 (s)	1800 (t)	1900 (u)	2000 (v)	2100 (w)	2200 (x)	2300 (y)	2400 (z)	
01/28/2012	CST	331	328	330	333	386	429	426	427	427	427	429	430	430	430	427	431	430	428	430	429	427	418	427	428	
01/29/2012	CST	427	424	428	428	426	427	427	428	428	427	428	429	429	428	429	430	430	429	429	428	429	416	427	424	
01/30/2012	CST	402	398	306	306	389	401	432	430	430	430	430	431	431	431	431	432	430	430	429	426	423	422	391	383	387
01/31/2012	CST	389	392	383	384	388	424	430	430	430	429	430	429	430	430	430	430	430	429	429	429	429	428	429	425	
02/01/2012	CST	427	429	428	429	428	429	429	428	429	429	429	430	430	430	430	430	431	430	430	430	430	371	280	67	
02/02/2012	CST	0	0	0	0	0	0	0	0	0	0	0	0	0	0	0	0	0	0	0	0	0	0	0	0	
02/03/2012	CST	0	0	0	0	0	0	0	0	0	0	0	0	0	0	0	0	0	0	0	0	0	0	0	0	
02/04/2012	CST	0	0	0	0	0	0	0	0	0	0	0	0	0	0	0	0	0	0	0	0	0	0	0	0	
02/05/2012	CST	0	0	0	0	0	0	0	0	0	0	0	0	0	0	0	0	0	0	0	0	0	0	0	0	
02/06/2012	CST	0	0	0	0	0	0	0	0	0	0	0	0	0	0	0	0	0	0	0	0	0	0	0	0	
02/07/2012	CST	0	0	0	0	0	0	0	0	0	0	0	0	0	0	0	0	0	33	89	194	239	243	224	245	293
02/08/2012	CST	333	364	413	430	429	430	429	427	426	426	425	430	432	432	430	429	428	417	427	429	431	430	430	430	
02/09/2012	CST	430	430	430	430	430	424	430	430	429	430	429	430	430	422	425	430	430	429	429	430	429	428	429	429	
02/10/2012	CST	428	427	429	411	418	427	435	432	432	432	431	430	431	431	431	431	431	432	431	430	432	431	431	431	
02/11/2012	CST	431	431	430	431	430	430	430	430	431	431	431	431	431	431	431	431	421	428	429	430	418	429	429	428	
02/12/2012	CST	428	364	427	431	431	430	431	431	430	430	430	430	430	431	430	432	431	431	430	429	430	430	430	428	
02/13/2012	CST	429	68	0	0	5	46	118	202	251	272	328	375	412	431	431	432	432	432	432	433	431	431	432	432	
02/14/2012	CST	430	431	430	430	431	431	431	415	404	429	430	430	432	430	431	337	0	19	102	204	314	383	403	430	
02/15/2012	CST	431	431	430	431	431	430	431	430	429	429	429	430	430	429	409	404	410	429	430	429	429	427	428	428	
02/16/2012	CST	429	429	430	430	430	429	430	431	432	431	432	431	433	431	427	302	113	0	0	0	0	0	0	0	
02/17/2012	CST	0	0	0	0	0	0	0	0	0	0	0	0	0	0	0	0	0	0	0	0	0	0	0	0	
02/18/2012	CST	0	0	0	0	0	0	0	0	0	0	10	60	132	202	254	279	334	356	407	434	428	428	427	425	
02/19/2012	CST	427	428	428	428	429	429	428	430	428	429	431	429	432	429	432	429	431	432	431	430	432	427	430	419	
02/20/2012	CST	422	416	429	414	430	431	430	431	430	430	429	430	431	430	431	431	432	431	431	431	430	431	429	429	
02/21/2012	CST	428	427	429	429	425	429	426	424	429	428	428	429	429	429	429	430	430	429	430	429	429	428	429	429	
02/22/2012	CST	429	429	429	429	428	429	429	428	429	429	429	429	429	429	430	430	431	430	430	429	430	430	429	430	
02/23/2012	CST	429	429	429	429	429	429	429	429	429	427	429	429	428	427	428	428	428	429	430	429	428	428	429	428	
02/24/2012	CST	430	429	430	429	428	411	428	431	428	428	429	447	437	428	429	430	430	427	429	429	428	429	429	429	
02/25/2012	CST	428	429	428	428	428	429	428	429	428	430	430	431	431	431	432	431	430	429	425	430	430	429	430	426	
02/26/2012	CST	430	377	431	429	429	426	429	429	428	430	430	430	429	431	429	429	430	430	430	430	431	428	427	424	
02/27/2012	CST	424	426	416	422	429	428	428	427	428	427	428	420	403	430	429	430	428	438	455	429	429	429	430	429	
02/28/2012	CST	429	428	429	430	430	431	430	430	430	431	430	429	429	429	429	429	429	429	429	429	429	430	429	430	
02/29/2012	CST	429	429	432	428	428	429	429	429	429	428	429	429	428	430	429	429	431	430	429	430	429	428	429	428	
03/01/2012	CST	428	429	428	430	431	430	456	455	457	456	454	433	431	430	431	431	431	433	431	432	431	431	430	430	

**Annual Electric Balancing Authority Area and Planning
Area Report**
For the Year Ending December 31, 2012

Utility Code: 17858
Utility Name: Square Butte Electric Coop

Part III - Schedule 2. Planning Area Hourly Demand (continued)

Date (a)	Time Zone (b)	0100 (c)	0200 (d)	0300 (e)	0400 (f)	0500 (g)	0600 (h)	0700 (i)	0800 (j)	0900 (k)	1000 (l)	1100 (m)	1200 (n)	1300 (o)	1400 (p)	1500 (q)	1600 (r)	1700 (s)	1800 (t)	1900 (u)	2000 (v)	2100 (w)	2200 (x)	2300 (y)	2400 (z)
03/02/2012	CST	429	430	429	427	429	428	429	430	429	429	430	429	430	429	430	429	430	429	427	429	428	429	429	428
03/03/2012	CST	427	428	427	418	427	427	429	425	430	430	429	430	429	429	430	430	430	431	430	430	430	430	430	430
03/04/2012	CST	430	404	430	430	430	430	431	430	429	430	429	431	430	430	430	430	430	429	430	431	430	429	427	430
03/05/2012	CST	430	430	430	430	430	430	430	430	431	430	430	430	429	431	430	432	432	431	432	430	430	427	428	429
03/06/2012	CST	422	404	408	415	405	410	430	428	430	429	429	431	430	430	431	428	430	429	429	429	414	427	422	383
03/07/2012	CST	394	397	396	388	384	406	416	428	427	426	427	427	427	427	427	427	427	428	427	428	428	427	428	345
03/08/2012	CST	331	333	333	374	402	420	428	427	428	401	411	431	430	429	430	429	429	429	429	428	428	428	427	428
03/09/2012	CST	427	427	427	427	427	428	429	429	431	429	430	430	431	431	432	432	431	432	432	411	409	432	428	431
03/10/2012	CST	348	328	331	330	352	405	423	420	432	432	430	431	430	425	415	428	422	430	431	431	428	431	427	363
03/11/2012	CST	330	331	330	331	337	405	431	428	430	429	430	430	430	430	431	430	430	430	430	430	430	430	431	430
03/12/2012	CST	370	330	336	406	432	430	430	430	430	430	431	431	431	432	431	431	431	431	431	431	429	428	429	429
03/13/2012	CST	429	429	429	429	430	429	429	412	428	429	430	434	436	429	406	399	387	428	390	387	386	376	330	331
03/14/2012	CST	331	331	331	334	381	394	427	428	398	412	432	430	430	430	430	431	431	431	430	431	430	429	429	349
03/15/2012	CST	332	401	432	429	400	430	429	430	429	433	430	430	430	430	430	430	430	430	430	430	431	430	430	430
03/16/2012	CST	430	430	430	430	429	432	429	429	429	430	430	429	430	430	430	430	430	431	430	431	422	420	355	330
03/17/2012	CST	330	330	330	330	333	400	425	430	430	430	430	430	430	424	405	423	414	405	429	430	429	421	345	330
03/18/2012	CST	329	330	329	330	329	333	393	424	430	404	423	413	408	405	411	432	430	410	423	432	429	392	336	332
03/19/2012	CST	329	330	331	331	331	335	403	427	414	432	430	430	431	428	239	201	202	204	226	251	249	250	251	251
03/20/2012	CST	250	251	253	251	250	248	250	252	252	253	252	253	253	254	256	253	253	253	253	254	251	253	253	253
03/21/2012	CST	253	254	254	253	254	253	252	251	251	251	253	254	253	254	253	254	255	254	255	255	253	254	255	255
03/22/2012	CST	255	255	254	255	254	253	254	252	253	253	253	253	253	253	255	255	254	255	255	255	266	383	432	431
03/23/2012	CST	432	431	431	431	431	431	431	431	431	430	431	430	430	430	430	429	430	431	430	430	430	430	430	430
03/24/2012	CST	431	429	430	430	430	431	429	429	428	430	430	431	430	429	430	429	430	429	430	429	429	428	428	428
03/25/2012	CST	428	429	427	427	428	428	429	429	429	429	430	429	429	430	430	430	430	430	430	429	429	401	380	342
03/26/2012	CST	329	329	330	332	383	422	430	429	431	426	431	397	430	430	427	429	430	431	430	428	366	331	330	329
03/27/2012	CST	331	330	330	330	332	401	433	430	430	430	430	430	431	429	430	430	430	431	431	430	430	428	423	348
03/28/2012	CST	329	332	383	422	430	428	429	428	429	429	428	429	429	430	431	431	431	430	431	430	430	429	430	427
03/29/2012	CST	427	420	423	426	430	429	430	426	425	430	429	429	430	431	430	432	430	431	431	431	430	429	430	428
03/30/2012	CST	428	428	429	431	431	431	431	433	431	432	432	432	432	433	432	432	433	433	431	431	430	431	430	430
03/31/2012	CST	431	429	430	431	430	430	430	431	431	430	432	430	430	430	432	430	237	199	216	352	432	433	432	403
04/01/2012	CST	318	365	432	432	429	430	430	431	430	430	429	430	430	430	430	431	421	430	429	430	431	420	402	398
04/02/2012	CST	379	381	381	417	432	429	430	406	430	429	430	430	429	431	430	433	430	430	430	429	430	430	423	337
04/03/2012	CST	332	332	330	339	417	431	429	428	429	430	430	431	429	429	429	433	430	430	430	430	430	430	430	429
04/04/2012	CST	429	429	428	428	430	418	416	429	429	430	430	429	431	430	430	430	430	430	431	430	431	430	429	430

**Annual Electric Balancing Authority Area and Planning
Area Report**
For the Year Ending December 31, 2012

Utility Code: 17858
Utility Name: Square Butte Electric Coop

Part III - Schedule 2. Planning Area Hourly Demand (continued)

Date (a)	Time Zone (b)	0100 (c)	0200 (d)	0300 (e)	0400 (f)	0500 (g)	0600 (h)	0700 (i)	0800 (j)	0900 (k)	1000 (l)	1100 (m)	1200 (n)	1300 (o)	1400 (p)	1500 (q)	1600 (r)	1700 (s)	1800 (t)	1900 (u)	2000 (v)	2100 (w)	2200 (x)	2300 (y)	2400 (z)
04/05/2012	CST	427	423	428	428	429	429	430	427	430	431	430	430	430	430	430	429	431	429	430	430	430	430	430	427
04/06/2012	CST	422	430	427	430	430	429	428	429	429	430	429	429	430	410	409	414	420	424	410	421	426	425	341	331
04/07/2012	CST	330	331	331	330	339	417	430	426	429	428	428	429	428	428	427	430	428	429	429	430	429	428	423	347
04/08/2012	CST	329	329	334	394	430	427	427	426	428	416	399	408	422	396	381	415	425	422	426	432	430	427	429	421
04/09/2012	CST	422	428	426	419	419	428	427	426	426	427	429	426	426	426	427	422	429	428	429	429	429	427	427	428
04/10/2012	CST	427	429	431	429	429	429	428	427	430	429	431	432	427	430	429	431	430	432	430	431	431	429	430	431
04/11/2012	CST	412	427	427	428	430	428	429	429	428	431	432	432	430	432	432	432	432	432	433	431	432	430	431	430
04/12/2012	CST	431	429	426	430	432	433	430	431	431	431	428	432	431	431	431	431	429	428	430	432	431	430	417	331
04/13/2012	CST	329	330	331	337	427	434	432	429	428	429	431	431	430	430	430	430	430	430	430	430	430	430	429	430
04/14/2012	CST	430	427	430	415	308	198	203	205	204	292	426	429	430	430	430	429	430	430	421	426	429	421	354	331
04/15/2012	CST	331	332	331	331	331	331	336	399	429	430	429	430	430	430	430	431	432	433	430	419	430	370	330	329
04/16/2012	CST	330	330	329	329	332	393	430	428	429	416	429	419	429	429	428	428	429	429	429	429	429	428	428	428
04/17/2012	CST	428	429	429	429	429	429	430	429	430	429	427	428	431	400	411	404	423	431	431	431	411	403	429	351
04/18/2012	CST	331	333	330	349	426	430	428	418	426	429	429	429	430	429	429	430	430	429	429	429	429	429	428	427
04/19/2012	CST	430	428	429	416	430	430	425	409	430	430	430	422	413	429	429	429	429	430	429	429	429	429	430	426
04/20/2012	CST	430	429	429	429	429	430	429	429	430	430	428	430	430	429	430	429	430	430	429	430	429	430	429	430
04/21/2012	CST	429	428	429	428	430	429	430	430	428	430	428	430	430	429	429	430	431	425	422	429	429	430	429	425
04/22/2012	CST	429	429	428	421	428	427	430	428	430	431	430	430	430	431	421	423	431	430	432	431	430	430	428	429
04/23/2012	CST	429	429	428	429	428	431	429	431	431	429	430	430	430	431	431	430	430	431	431	432	431	432	431	426
04/24/2012	CST	429	429	429	429	424	429	429	184	10	103	208	328	419	432	429	429	429	430	430	430	430	429	427	427
04/25/2012	CST	425	417	430	425	430	429	430	429	429	429	430	429	429	429	430	429	429	429	429	429	429	429	429	430
04/26/2012	CST	428	430	424	411	429	429	429	428	427	430	429	429	430	430	430	430	430	431	431	430	430	430	430	429
04/27/2012	CST	430	430	429	430	430	429	430	430	430	430	430	429	430	429	428	430	429	429	430	430	429	429	427	356
04/28/2012	CST	331	331	335	392	432	430	430	429	431	429	429	430	429	429	429	430	430	431	430	430	429	430	430	430
04/29/2012	CST	428	429	429	430	427	430	429	430	430	431	430	431	431	431	429	432	430	431	432	431	431	430	431	430
04/30/2012	CST	431	429	430	430	429	429	429	430	429	432	432	431	430	430	430	429	426	426	396	407	430	415	396	415
05/01/2012	CST	424	404	404	409	422	431	430	431	430	433	430	431	431	429	432	421	425	431	429	423	429	428	424	432
05/02/2012	CST	430	431	431	431	429	429	429	429	430	429	429	430	430	430	430	431	431	418	414	421	425	415	431	429
05/03/2012	CST	430	430	429	426	422	427	430	430	430	429	430	430	430	429	430	430	430	430	430	430	426	424	423	430
05/04/2012	CST	430	430	430	429	430	429	429	430	429	429	430	430	430	429	429	397	394	432	431	431	431	431	430	431
05/05/2012	CST	430	430	431	430	431	430	431	431	430	430	430	430	431	431	430	430	430	427	431	430	429	426	405	397
05/06/2012	CST	375	411	425	428	425	429	431	430	431	430	430	431	427	430	410	415	422	427	431	429	430	430	429	429
05/07/2012	CST	420	331	331	337	412	430	429	429	430	428	428	426	418	411	420	400	381	402	423	428	429	429	429	429
05/08/2012	CST	429	428	429	427	428	427	429	428	430	429	429	428	428	421	430	429	429	430	429	430	429	429	430	429

**Annual Electric Balancing Authority Area and Planning
 Area Report**
 For the Year Ending December 31, 2012

Utility Code: 17858
 Utility Name: Square Butte Electric Coop

Part III - Schedule 2. Planning Area Hourly Demand (continued)

Date (a)	Time Zone (b)	0100 (c)	0200 (d)	0300 (e)	0400 (f)	0500 (g)	0600 (h)	0700 (i)	0800 (j)	0900 (k)	1000 (l)	1100 (m)	1200 (n)	1300 (o)	1400 (p)	1500 (q)	1600 (r)	1700 (s)	1800 (t)	1900 (u)	2000 (v)	2100 (w)	2200 (x)	2300 (y)	2400 (z)	
05/09/2012	CST	430	429	428	429	429	429	430	426	429	429	429	429	430	429	430	429	430	426	429	430	429	430	430	425	
05/10/2012	CST	424	425	410	411	362	271	205	200	215	316	410	428	430	431	429	429	428	429	429	429	429	424	416	349	
05/11/2012	CST	329	329	330	330	332	394	429	426	427	420	428	427	428	428	429	429	429	430	429	429	429	429	428	429	
05/12/2012	CST	428	428	429	429	429	428	429	430	429	430	430	429	430	434	426	421	435	426	426	430	430	430	430	430	
05/13/2012	CST	430	430	430	429	429	430	429	430	433	429	430	430	430	430	431	431	430	430	430	430	430	433	430	430	
05/14/2012	CST	429	430	430	430	429	429	430	430	433	430	430	429	428	429	429	429	429	431	431	431	431	430	431	429	
05/15/2012	CST	429	430	429	430	430	431	430	430	431	432	430	431	431	431	431	431	431	430	431	430	431	431	431	431	
05/16/2012	CST	431	431	430	431	430	431	430	430	433	430	430	430	430	430	431	431	430	430	430	430	430	430	429	430	
05/17/2012	CST	429	429	428	430	430	430	430	431	431	432	431	431	427	429	430	430	429	431	431	431	431	430	430	422	
05/18/2012	CST	430	422	428	428	418	431	430	429	430	429	431	430	429	432	431	430	430	430	430	430	430	428	429	414	424
05/19/2012	CST	431	428	429	430	430	430	430	409	379	384	381	390	404	403	429	428	414	429	430	429	430	430	430	430	
05/20/2012	CST	363	430	430	430	429	429	429	430	430	430	430	430	430	430	429	430	429	429	430	430	430	430	430	430	
05/21/2012	CST	430	430	429	429	429	430	432	433	430	430	430	430	430	429	430	430	430	431	430	429	429	431	430	425	
05/22/2012	CST	430	411	426	428	430	429	430	429	428	405	404	398	380	353	329	330	330	330	330	331	330	330	330	330	
05/23/2012	CST	330	331	330	332	347	425	405	428	412	426	429	429	429	429	430	430	430	430	430	429	430	429	430	429	
05/24/2012	CST	430	429	429	430	430	429	427	430	429	429	429	429	430	429	431	430	430	430	431	430	430	430	430	433	
05/25/2012	CST	429	429	429	429	429	428	429	429	430	430	429	430	431	430	430	430	430	431	430	430	430	430	430	433	
05/26/2012	CST	431	429	411	427	418	418	397	430	430	431	431	430	430	428	431	421	431	430	430	424	430	430	427	408	
05/27/2012	CST	349	335	331	330	330	332	385	395	381	381	381	381	382	382	400	407	425	429	400	403	432	433	431	432	
05/28/2012	CST	431	431	431	431	429	429	429	428	429	428	314	178	169	188	195	313	393	433	431	430	430	429	430	430	
05/29/2012	CST	428	427	427	421	425	429	428	402	380	391	379	332	331	331	331	343	409	430	429	429	429	430	429	429	
05/30/2012	CST	429	429	429	429	429	429	429	429	430	430	430	430	429	429	429	430	430	430	429	430	429	430	429	429	
05/31/2012	CST	429	429	429	430	430	429	429	430	430	430	430	431	430	430	430	431	430	430	430	429	365	200	43	0	
06/01/2012	CST	0	0	0	0	0	0	0	0	0	0	0	0	1	1	1	0	0	0	0	0	0	0	0	0	
06/02/2012	CST	0	0	0	0	0	0	0	0	0	0	0	0	0	0	0	0	0	0	0	0	0	0	0	0	
06/03/2012	CST	0	0	0	0	0	0	0	0	0	0	0	0	0	0	0	0	0	0	0	0	0	0	0	0	
06/04/2012	CST	0	0	0	0	0	0	0	0	0	0	0	0	0	0	0	0	0	0	0	0	0	0	0	0	
06/05/2012	CST	0	0	0	0	0	0	0	0	0	0	0	0	0	0	0	0	0	0	0	0	0	0	0	0	
06/06/2012	CST	0	0	0	0	0	0	0	0	0	0	0	0	0	0	0	0	0	0	0	0	0	0	0	0	
06/07/2012	CST	0	0	0	0	0	10	41	86	163	192	185	171	166	167	167	171	189	188	187	191	194	206	207	205	
06/08/2012	CST	229	327	385	407	432	434	437	434	435	432	431	430	430	430	430	431	430	430	431	430	430	430	430	430	
06/09/2012	CST	419	385	331	386	416	415	425	441	424	422	423	423	424	423	352	198	201	202	198	196	197	198	199	198	
06/10/2012	CST	198	198	198	198	197	198	198	197	195	199	200	206	206	205	205	202	205	208	207	206	207	207	206	207	
06/11/2012	CST	208	207	207	207	206	208	208	204	183	165	166	162	170	203	211	211	210	212	211	212	210	209	210	209	

**Annual Electric Balancing Authority Area and Planning
Area Report**
For the Year Ending December 31, 2012

Utility Code: 17858
Utility Name: Square Butte Electric Coop

Part III - Schedule 2. Planning Area Hourly Demand (continued)

Date (a)	Time Zone (b)	0100 (c)	0200 (d)	0300 (e)	0400 (f)	0500 (g)	0600 (h)	0700 (i)	0800 (j)	0900 (k)	1000 (l)	1100 (m)	1200 (n)	1300 (o)	1400 (p)	1500 (q)	1600 (r)	1700 (s)	1800 (t)	1900 (u)	2000 (v)	2100 (w)	2200 (x)	2300 (y)	2400 (z)	
06/12/2012	CST	209	209	211	209	208	209	207	208	208	208	209	209	210	212	209	209	209	209	208	210	210	211	210	211	
06/13/2012	CST	210	209	207	208	207	208	209	208	208	209	210	211	210	206	206	207	207	207	207	207	208	207	207	205	
06/14/2012	CST	207	206	207	206	206	207	205	206	205	203	204	206	205	206	206	205	207	206	206	206	207	207	208	208	
06/15/2012	CST	207	205	204	205	208	208	207	208	208	208	210	208	208	208	207	208	186	57	0	0	0	0	0	0	
06/16/2012	CST	0	0	0	0	0	0	0	0	0	0	0	0	0	0	0	0	0	0	0	0	0	0	0	0	
06/17/2012	CST	0	0	0	0	0	0	0	0	0	0	0	0	0	0	0	0	0	0	0	0	0	0	0	0	
06/18/2012	CST	0	0	0	0	0	0	0	0	0	0	0	0	0	0	0	0	0	0	0	0	0	0	0	0	
06/19/2012	CST	0	0	0	0	0	0	0	0	0	0	0	0	0	0	0	0	0	0	0	0	4	28	67	133	
06/20/2012	CST	230	276	281	335	369	392	427	433	436	414	420	426	435	433	433	428	431	430	431	431	431	431	430	431	
06/21/2012	CST	430	430	431	430	430	430	430	431	430	430	430	431	430	430	419	431	430	430	430	430	431	430	430	430	
06/22/2012	CST	430	430	428	430	430	429	430	429	430	430	429	429	429	430	430	430	430	430	429	430	430	425	413	430	
06/23/2012	CST	427	349	331	330	331	335	401	431	429	429	429	429	429	429	429	429	429	429	428	428	429	430	429	425	428
06/24/2012	CST	428	425	347	330	333	402	432	425	428	429	428	429	424	420	429	428	430	429	428	429	430	430	429	424	
06/25/2012	CST	348	331	331	334	396	428	428	429	430	429	430	429	430	429	430	430	430	429	431	430	430	429	430	421	
06/26/2012	CST	426	348	331	336	396	431	430	430	431	433	429	429	430	429	429	429	430	429	430	429	430	429	430	417	334
06/27/2012	CST	328	331	329	328	330	333	397	429	428	429	429	429	429	428	429	429	429	428	429	430	430	429	429	429	429
06/28/2012	CST	429	429	430	429	429	429	428	430	428	428	429	430	428	429	429	429	429	428	429	430	429	430	429	428	428
06/29/2012	CST	429	429	429	428	429	429	429	428	429	428	429	428	428	431	430	427	428	429	429	429	429	429	429	429	429
06/30/2012	CST	419	424	414	430	428	429	428	429	428	428	429	428	429	428	428	428	428	428	428	429	428	429	428	429	431
07/01/2012	CST	429	429	429	429	429	428	429	428	428	428	428	428	429	428	428	428	428	428	429	428	428	429	428	429	431
07/02/2012	CST	431	431	431	431	429	429	428	428	428	428	428	428	428	428	428	428	431	431	431	431	429	428	429	428	429
07/03/2012	CST	431	430	430	422	212	189	131	5	0	0	0	0	0	0	24	124	210	273	339	376	416	413	419	421	
07/04/2012	CST	425	428	429	431	431	430	429	431	430	431	430	431	431	430	430	431	430	430	430	430	430	431	431	427	
07/05/2012	CST	418	429	425	430	429	430	430	431	429	430	429	430	429	427	430	430	430	430	430	429	430	429	430	429	
07/06/2012	CST	428	429	430	429	429	429	424	429	429	429	429	429	423	430	427	430	430	429	432	430	428	429	430	429	
07/07/2012	CST	430	430	429	430	429	427	429	430	430	429	430	429	430	429	430	430	430	431	432	432	431	431	431	429	
07/08/2012	CST	373	429	428	428	420	429	429	429	429	429	429	429	429	429	429	429	430	429	429	429	429	430	429	429	
07/09/2012	CST	428	428	429	429	429	429	428	429	429	429	429	429	429	429	429	429	429	429	429	429	429	429	429	429	429
07/10/2012	CST	429	429	429	429	429	429	428	428	430	431	428	428	429	429	430	429	429	429	429	429	429	430	430	430	
07/11/2012	CST	427	427	428	430	430	429	430	430	428	429	428	429	428	428	428	428	429	429	429	429	425	408	403	404	
07/12/2012	CST	419	430	429	429	429	429	429	429	428	429	428	429	428	428	426	422	417	418	419	418	418	419	419	424	
07/13/2012	CST	427	429	429	429	429	428	430	428	429	428	427	417	412	413	413	413	414	413	412	410	411	415	416	415	
07/14/2012	CST	415	416	414	413	414	414	415	413	414	413	414	414	418	429	429	430	429	428	425	425	427	427	430	419	
07/15/2012	CST	364	421	419	419	420	422	430	430	430	430	428	430	429	429	423	418	419	420	420	419	420	419	419	420	

**Annual Electric Balancing Authority Area and Planning
Area Report**
For the Year Ending December 31, 2012

Utility Code: 17858
Utility Name: Square Butte Electric Coop

Part III - Schedule 2. Planning Area Hourly Demand (continued)

Date (a)	Time Zone (b)	0100 (c)	0200 (d)	0300 (e)	0400 (f)	0500 (g)	0600 (h)	0700 (i)	0800 (j)	0900 (k)	1000 (l)	1100 (m)	1200 (n)	1300 (o)	1400 (p)	1500 (q)	1600 (r)	1700 (s)	1800 (t)	1900 (u)	2000 (v)	2100 (w)	2200 (x)	2300 (y)	2400 (z)
07/16/2012	CST	419	409	411	415	415	414	415	416	423	422	420	419	420	420	420	415	411	410	411	410	411	411	411	414
07/17/2012	CST	414	414	414	412	415	416	415	420	426	427	428	429	428	430	430	429	430	428	430	429	430	428	430	429
07/18/2012	CST	429	429	430	429	429	430	430	429	429	430	430	430	430	429	430	430	431	427	428	429	430	430	429	429
07/19/2012	CST	429	429	429	428	429	429	429	421	422	421	422	425	427	429	429	428	429	425	429	429	429	424	427	424
07/20/2012	CST	429	428	426	428	429	429	429	428	428	429	429	420	413	407	399	400	400	400	401	400	400	400	407	414
07/21/2012	CST	401	398	411	410	413	412	416	415	415	414	415	415	414	420	425	429	429	429	428	429	429	429	427	413
07/22/2012	CST	372	419	428	426	429	429	429	429	429	428	428	418	411	411	409	409	410	410	408	410	409	410	410	423
07/23/2012	CST	419	420	420	423	423	429	428	429	428	429	428	428	428	426	428	428	429	429	429	429	430	429	429	427
07/24/2012	CST	427	428	424	429	428	428	429	427	429	430	429	429	429	428	429	430	431	423	430	430	430	428	428	423
07/25/2012	CST	427	428	428	429	428	428	430	430	430	431	429	428	429	430	429	429	429	429	429	429	429	429	429	428
07/26/2012	CST	429	429	428	429	428	429	428	429	428	429	430	427	429	429	429	431	428	429	429	429	429	429	429	422
07/27/2012	CST	429	429	428	428	428	429	430	430	430	429	430	430	429	428	427	429	430	430	428	430	431	429	431	428
07/28/2012	CST	431	430	429	429	430	430	430	430	430	430	430	430	430	430	430	431	430	430	431	430	430	431	429	427
07/29/2012	CST	357	422	429	410	430	431	430	430	429	430	430	430	431	431	430	430	431	430	431	429	429	430	428	430
07/30/2012	CST	393	422	428	428	430	423	429	425	422	429	430	429	417	429	430	429	430	429	430	429	429	430	426	346
07/31/2012	CST	331	331	332	332	331	332	376	424	411	423	428	428	430	429	429	404	401	377	337	328	328	328	329	329
08/01/2012	CST	329	331	330	330	330	329	363	426	428	429	430	429	429	429	429	429	428	428	387	380	406	431	425	352
08/02/2012	CST	331	333	333	334	333	338	378	413	429	428	427	416	417	430	429	429	401	414	428	426	427	427	429	427
08/03/2012	CST	428	429	426	428	429	429	430	429	429	428	427	395	410	430	428	428	429	429	430	430	430	430	429	429
08/04/2012	CST	427	429	429	430	429	429	430	426	423	430	429	429	429	429	429	430	428	429	430	429	429	428	427	427
08/05/2012	CST	430	429	429	429	428	428	429	429	429	429	430	429	429	429	429	429	430	429	429	430	430	430	425	429
08/06/2012	CST	429	417	399	426	429	430	428	430	429	430	429	430	430	428	430	423	429	430	414	427	431	430	428	429
08/07/2012	CST	428	430	430	429	431	430	429	430	429	429	429	430	430	429	430	430	429	430	430	429	429	429	430	430
08/08/2012	CST	430	429	428	429	429	429	429	430	429	429	405	420	427	429	428	399	381	415	430	431	430	429	430	430
08/09/2012	CST	429	427	428	430	430	430	429	430	430	430	417	381	421	432	430	431	429	429	430	429	430	410	413	429
08/10/2012	CST	428	426	429	428	429	427	429	429	429	429	430	429	430	429	429	430	429	429	429	430	430	429	429	426
08/11/2012	CST	430	429	430	429	429	427	429	429	429	429	430	429	429	429	429	429	430	429	429	429	429	430	428	428
08/12/2012	CST	376	423	426	428	429	430	428	429	429	429	429	430	430	429	430	429	430	429	430	430	430	429	430	428
08/13/2012	CST	352	330	375	429	430	430	429	429	430	429	429	429	429	429	429	430	403	398	428	428	430	430	430	430
08/14/2012	CST	430	429	430	429	429	430	429	430	430	429	430	429	429	429	429	429	430	429	430	421	430	428	416	428
08/15/2012	CST	354	330	334	404	431	431	429	429	430	429	428	429	429	430	430	429	429	430	429	430	430	429	430	423
08/16/2012	CST	334	330	330	332	397	430	428	429	431	430	416	430	428	427	430	429	431	429	430	430	429	430	430	430
08/17/2012	CST	430	430	430	430	430	430	430	431	430	430	429	430	430	430	430	430	430	430	430	430	430	430	430	431
08/18/2012	CST	428	430	430	430	430	430	429	430	429	430	429	430	430	430	429	430	430	430	430	430	430	430	430	430

**Annual Electric Balancing Authority Area and Planning
 Area Report**
 For the Year Ending December 31, 2012

Utility Code: 17858
 Utility Name: Square Butte Electric Coop

Part III - Schedule 2. Planning Area Hourly Demand (continued)

Date (a)	Time Zone (b)	0100 (c)	0200 (d)	0300 (e)	0400 (f)	0500 (g)	0600 (h)	0700 (i)	0800 (j)	0900 (k)	1000 (l)	1100 (m)	1200 (n)	1300 (o)	1400 (p)	1500 (q)	1600 (r)	1700 (s)	1800 (t)	1900 (u)	2000 (v)	2100 (w)	2200 (x)	2300 (y)	2400 (z)
08/19/2012	CST	430	430	429	429	428	423	430	429	429	430	430	429	430	429	429	429	429	430	430	430	430	430	429	430
08/20/2012	CST	429	430	430	429	429	430	429	429	430	429	429	430	430	429	430	430	430	429	430	431	430	430	429	424
08/21/2012	CST	429	426	430	429	430	430	427	427	430	429	430	429	430	430	430	431	429	429	429	429	429	415	411	390
08/22/2012	CST	342	328	332	333	374	429	429	429	429	429	428	429	431	430	430	430	430	431	431	431	431	421	401	337
08/23/2012	CST	332	334	334	338	408	432	429	431	431	431	430	429	429	430	430	431	422	421	424	428	430	428	411	428
08/24/2012	CST	430	426	420	428	428	429	428	428	424	427	429	429	429	428	429	430	429	429	428	429	428	429	427	421
08/25/2012	CST	428	353	329	331	337	407	431	429	429	431	429	428	428	429	429	427	428	428	426	426	427	429	428	429
08/26/2012	CST	429	429	429	428	429	428	429	429	428	428	429	428	429	429	428	429	429	429	429	428	429	429	428	430
08/27/2012	CST	431	432	431	431	431	430	428	428	428	430	429	429	429	430	430	430	429	430	430	430	424	409	432	429
08/28/2012	CST	429	430	424	430	430	430	429	430	427	429	425	430	430	436	429	430	430	430	431	430	429	428	429	428
08/29/2012	CST	427	425	428	425	431	429	430	430	429	430	422	422	431	429	431	426	419	415	416	415	419	430	420	332
08/30/2012	CST	334	334	334	333	332	338	408	422	431	430	429	429	430	429	429	430	430	429	430	430	430	431	429	430
08/31/2012	CST	430	429	430	429	430	430	429	431	432	432	432	432	429	430	429	430	430	430	429	430	427	430	426	424
09/01/2012	CST	417	418	430	428	429	429	429	430	430	429	430	429	429	429	429	429	430	426	418	419	419	419	418	418
09/02/2012	CST	418	417	419	420	419	421	420	430	429	429	429	429	430	429	430	429	429	429	429	430	423	405	429	430
09/03/2012	CST	429	430	430	429	429	428	429	429	429	429	429	429	429	429	429	430	430	429	429	429	429	430	429	430
09/04/2012	CST	426	429	429	429	429	428	430	428	428	429	429	428	430	429	430	429	429	429	429	429	415	420	420	427
09/05/2012	CST	429	429	429	429	429	428	429	429	429	428	429	429	428	429	428	429	429	429	428	429	78	0	0	0
09/06/2012	CST	0	0	0	0	0	0	0	0	0	0	0	0	0	0	0	0	12	56	155	240	253	282	280	292
09/07/2012	CST	336	357	380	410	431	430	428	428	430	430	432	431	431	427	421	431	430	432	429	428	425	427	422	348
09/08/2012	CST	330	332	331	330	332	460	432	430	431	426	427	430	428	428	424	429	429	430	429	428	428	429	421	355
09/09/2012	CST	330	330	330	330	331	394	433	430	430	429	431	429	430	429	430	430	428	424	425	430	430	404	390	334
09/10/2012	CST	329	330	330	333	385	410	412	414	406	392	421	430	427	418	426	414	410	401	410	410	398	403	344	330
09/11/2012	CST	331	331	331	331	333	393	418	429	428	423	428	428	430	429	429	428	429	430	429	430	430	430	426	356
09/12/2012	CST	332	333	332	332	335	396	432	429	429	430	430	430	430	430	430	431	430	429	430	429	430	428	427	356
09/13/2012	CST	332	331	331	331	334	398	424	423	428	430	429	430	430	430	429	429	429	430	429	431	418	418	421	343
09/14/2012	CST	223	200	200	199	199	202	199	200	200	199	201	200	204	206	201	200	201	202	201	201	201	201	201	201
09/15/2012	CST	200	201	201	200	201	201	201	201	200	200	203	202	202	202	201	201	202	201	201	199	200	202	200	201
09/16/2012	CST	202	200	201	202	202	200	201	200	200	201	200	201	201	201	202	202	201	202	201	201	201	215	311	329
09/17/2012	CST	331	349	421	429	428	428	429	429	428	428	427	428	428	427	428	427	428	430	429	429	429	424	410	340
09/18/2012	CST	333	332	330	329	393	413	422	422	421	417	423	422	424	424	423	424	421	419	429	414	410	403	384	338
09/19/2012	CST	333	332	332	332	335	400	420	416	415	414	402	412	413	412	413	411	404	403	414	413	413	413	412	349
09/20/2012	CST	331	331	332	330	339	406	414	413	413	409	406	405	405	405	405	404	405	408	403	401	400	400	398	339
09/21/2012	CST	330	331	330	330	334	381	386	390	390	390	390	390	389	388	380	381	382	382	382	382	382	382	379	332

**Annual Electric Balancing Authority Area and Planning
Area Report
For the Year Ending December 31, 2012**

Utility Code: 17858
Utility Name: Square Butte Electric Coop

Part III - Schedule 2. Planning Area Hourly Demand (continued)

Date (a)	Time Zone (b)	0100 (c)	0200 (d)	0300 (e)	0400 (f)	0500 (g)	0600 (h)	0700 (i)	0800 (j)	0900 (k)	1000 (l)	1100 (m)	1200 (n)	1300 (o)	1400 (p)	1500 (q)	1600 (r)	1700 (s)	1800 (t)	1900 (u)	2000 (v)	2100 (w)	2200 (x)	2300 (y)	2400 (z)
09/22/2012	CST	331	331	330	330	334	379	382	381	381	382	381	381	381	382	382	382	381	382	382	381	382	382	379	334
09/23/2012	CST	332	331	331	331	334	372	374	373	373	374	374	374	374	373	374	373	373	374	368	368	364	364	361	329
09/24/2012	CST	329	330	330	329	333	359	358	358	357	356	354	353	351	346	339	340	340	338	335	335	331	330	329	326
09/25/2012	CST	325	325	325	325	325	324	323	323	305	305	305	303	304	308	308	307	306	306	305	232	97	12	0	0
09/26/2012	CST	0	0	0	0	0	0	0	0	0	0	0	0	0	0	0	0	0	0	0	0	0	0	0	0
09/27/2012	CST	0	0	0	0	0	0	0	0	0	0	0	0	0	0	0	0	0	0	0	0	0	0	0	0
09/28/2012	CST	0	0	0	0	0	0	0	0	0	0	0	0	0	0	0	0	0	0	0	0	0	0	0	0
09/29/2012	CST	0	0	0	0	0	0	0	0	0	0	0	0	0	0	0	0	0	0	0	0	0	0	0	0
09/30/2012	CST	0	0	0	0	0	0	0	0	0	0	0	0	0	0	0	0	0	0	0	0	0	0	0	0
10/01/2012	CST	0	0	0	0	0	0	0	0	0	0	0	0	0	0	0	0	0	0	0	0	3	35	77	171
10/02/2012	CST	221	233	257	300	313	316	355	387	425	430	430	431	431	432	431	430	431	431	430	431	430	430	430	431
10/03/2012	CST	430	430	431	430	430	429	430	430	429	430	429	430	429	429	428	428	428	428	428	428	428	419	332	330
10/04/2012	CST	331	331	333	331	332	353	417	429	426	426	428	429	428	428	427	431	430	430	429	430	429	428	429	406
10/05/2012	CST	419	429	428	428	429	429	428	428	431	428	431	430	431	431	431	432	380	358	355	353	357	423	432	431
10/06/2012	CST	430	431	431	431	431	431	429	430	430	430	431	431	431	431	431	431	431	431	431	430	431	430	430	429
10/07/2012	CST	430	430	429	429	429	429	429	430	430	430	431	431	431	431	432	431	431	431	431	432	429	429	430	426
10/08/2012	CST	431	401	425	417	433	431	431	432	431	431	429	431	431	431	429	430	431	431	431	431	431	430	431	428
10/09/2012	CST	430	428	425	428	425	430	429	429	429	426	426	430	428	430	430	429	429	430	430	429	430	428	427	421
10/10/2012	CST	427	428	422	430	428	429	429	429	430	429	430	430	429	431	431	430	431	430	430	428	418	415	427	406
10/11/2012	CST	388	407	397	424	423	429	429	430	429	430	430	430	430	429	430	430	430	430	430	430	430	423	428	424
10/12/2012	CST	430	429	429	428	426	429	423	429	429	421	431	424	416	405	406	405	406	404	398	431	421	402	351	331
10/13/2012	CST	330	304	300	299	300	299	299	300	300	299	301	302	301	299	299	299	299	299	299	299	299	300	298	298
10/14/2012	CST	298	298	298	298	298	299	299	268	204	205	224	251	252	294	301	300	300	300	300	299	299	299	296	298
10/15/2012	CST	298	299	299	299	299	299	300	302	300	300	299	300	299	284	206	80	1	0	0	0	0	0	0	
10/16/2012	CST	0	0	0	0	0	0	0	0	0	8	83	123	220	196	184	269	296	295	296	298	297	298	258	196
10/17/2012	CST	194	199	201	199	198	197	196	194	198	204	202	203	204	205	204	204	203	205	205	207	207	206	207	206
10/18/2012	CST	208	207	208	207	206	207	205	206	205	206	206	206	206	207	205	207	205	206	205	205	206	205	206	205
10/19/2012	CST	206	207	208	206	205	206	204	205	205	206	207	205	205	205	206	205	204	246	300	363	405	432	427	428
10/20/2012	CST	428	428	429	430	429	430	429	430	430	430	430	431	430	430	428	427	431	430	431	431	432	428	400	409
10/21/2012	CST	416	416	406	402	423	419	429	429	429	429	429	429	429	429	430	429	429	429	430	428	429	429	428	428
10/22/2012	CST	429	429	429	429	427	429	428	429	429	428	429	428	429	429	428	428	427	427	429	429	429	428	428	429
10/23/2012	CST	428	428	430	431	428	428	429	428	428	428	429	430	429	429	429	428	430	429	429	429	429	428	428	427
10/24/2012	CST	430	429	429	430	429	428	429	429	430	430	430	429	429	427	430	429	426	430	430	353	93	0	0	0
10/25/2012	CST	0	0	0	0	0	0	0	0	0	0	0	0	0	0	0	0	0	0	0	0	0	0	0	0

**Annual Electric Balancing Authority Area and Planning
Area Report**
For the Year Ending December 31, 2012

Utility Code: 17858
Utility Name: Square Butte Electric Coop

Part III - Schedule 2. Planning Area Hourly Demand (continued)

Date (a)	Time Zone (b)	0100 (c)	0200 (d)	0300 (e)	0400 (f)	0500 (g)	0600 (h)	0700 (i)	0800 (j)	0900 (k)	1000 (l)	1100 (m)	1200 (n)	1300 (o)	1400 (p)	1500 (q)	1600 (r)	1700 (s)	1800 (t)	1900 (u)	2000 (v)	2100 (w)	2200 (x)	2300 (y)	2400 (z)	
10/26/2012	CST	0	0	0	0	0	0	0	0	0	0	0	0	0	0	0	0	0	0	0	0	0	0	0	0	
10/27/2012	CST	0	0	0	0	0	0	25	101	190	218	256	291	327	364	390	399	411	427	427	422	430	430	429	429	
10/28/2012	CST	429	428	429	429	429	391	61	229	322	400	426	428	429	430	429	430	430	429	429	429	429	430	428	430	
10/29/2012	CST	426	429	428	430	429	429	428	428	428	426	428	430	432	431	430	430	430	430	430	430	430	432	430	428	
10/30/2012	CST	430	430	429	430	429	430	430	430	430	430	430	432	432	431	430	430	429	430	430	429	429	428	428	427	
10/31/2012	CST	428	426	428	427	429	430	428	428	429	427	429	429	431	430	429	430	429	430	429	429	429	429	429	429	
11/01/2012	CST	428	423	427	428	428	429	429	430	428	429	429	431	429	429	430	430	430	428	429	428	429	428	428	428	
11/02/2012	CST	428	428	428	427	427	429	429	429	428	429	429	430	429	429	429	424	424	430	430	429	429	430	431	430	430
11/03/2012	CST	430	430	430	431	430	431	429	430	430	430	430	429	430	430	430	430	429	430	430	431	429	429	430	430	430
11/04/2012	CST	390	430	431	431	430	430	429	430	429	429	429	430	429	430	429	430	429	430	430	430	430	430	429	430	
11/05/2012	CST	430	431	430	431	427	411	427	431	431	427	430	429	430	432	428	428	429	430	429	424	431	429	428	413	
11/06/2012	CST	385	360	329	330	330	330	335	336	330	329	328	329	330	331	341	418	427	430	430	429	430	429	430	422	
11/07/2012	CST	430	429	429	429	429	430	429	429	433	429	430	429	431	429	429	431	430	431	414	404	382	397	381	331	
11/08/2012	CST	330	320	329	329	338	400	417	420	429	430	426	429	430	430	429	430	429	429	428	429	428	428	428	429	
11/09/2012	CST	428	428	427	428	427	428	428	429	430	430	430	431	428	428	429	429	430	429	429	430	430	427	429	403	
11/10/2012	CST	415	427	422	419	426	430	427	429	427	431	430	431	430	430	430	430	429	430	429	429	429	426	354	332	
11/11/2012	CST	332	331	331	332	331	335	395	430	428	428	428	428	428	429	429	421	429	428	428	429	429	429	429	428	
11/12/2012	CST	428	428	429	427	427	429	427	428	429	429	429	404	347	387	432	430	427	429	431	430	430	430	431	430	
11/13/2012	CST	430	431	430	430	429	428	430	432	431	429	429	429	429	429	429	429	429	429	429	429	429	428	429	428	
11/14/2012	CST	428	428	429	428	428	429	429	428	429	429	429	429	429	431	431	431	431	429	430	430	429	429	428	428	
11/15/2012	CST	429	426	430	430	428	429	428	430	429	430	430	430	432	431	430	429	430	429	429	429	427	429	429	429	
11/16/2012	CST	429	429	428	429	429	428	429	428	429	428	429	430	430	430	430	430	431	431	430	432	423	421	413	433	430
11/17/2012	CST	427	416	426	429	428	429	427	423	429	429	430	429	430	426	431	430	429	431	430	430	430	429	430	426	
11/18/2012	CST	423	354	415	429	426	404	421	429	430	428	429	430	430	431	430	431	432	431	430	429	419	417	428	421	
11/19/2012	CST	406	421	414	404	413	432	430	430	430	430	431	430	430	430	430	430	430	430	429	430	430	429	428	429	
11/20/2012	CST	428	428	429	429	430	429	429	428	430	429	430	430	430	430	430	430	431	430	431	430	430	430	431	430	
11/21/2012	CST	429	397	424	406	416	424	431	430	429	430	430	427	431	429	431	431	431	431	430	431	431	431	419	358	
11/22/2012	CST	334	330	330	330	330	331	374	415	431	430	430	429	429	418	377	387	410	430	428	428	428	428	425	352	
11/23/2012	CST	330	329	330	334	390	420	428	428	428	428	428	428	428	429	431	432	432	441	435	429	431	430	429	431	
11/24/2012	CST	429	430	430	430	429	421	394	292	139	19	0	0	0	0	0	0	0	0	0	0	0	0	0	0	
11/25/2012	CST	0	0	0	0	0	0	0	0	0	0	0	0	0	0	0	0	0	0	0	0	0	0	0	0	
11/26/2012	CST	0	0	0	0	0	0	0	0	0	0	0	0	0	0	0	0	0	0	0	0	0	0	0	0	
11/27/2012	CST	0	0	0	0	0	0	0	0	0	0	14	75	161	242	305	324	380	421	434	433	428	430	429	430	
11/28/2012	CST	430	430	430	429	429	428	429	428	429	430	429	430	429	428	428	428	421	430	430	429	430	430	429	429	

**Annual Electric Balancing Authority Area and Planning
 Area Report**
 For the Year Ending December 31, 2012

Utility Code: 17858
 Utility Name: Square Butte Electric Coop

Part III - Schedule 2. Planning Area Hourly Demand (continued)

Date (a)	Time Zone (b)	0100 (c)	0200 (d)	0300 (e)	0400 (f)	0500 (g)	0600 (h)	0700 (i)	0800 (j)	0900 (k)	1000 (l)	1100 (m)	1200 (n)	1300 (o)	1400 (p)	1500 (q)	1600 (r)	1700 (s)	1800 (t)	1900 (u)	2000 (v)	2100 (w)	2200 (x)	2300 (y)	2400 (z)
11/29/2012	CST	430	428	430	429	428	428	429	429	429	429	429	429	430	430	430	430	430	430	429	430	430	430	430	430
11/30/2012	CST	430	430	430	430	430	430	430	430	430	430	430	431	430	430	430	432	429	431	425	396	430	431	426	430
12/01/2012	CST	430	429	426	422	430	431	431	432	432	432	432	432	432	433	432	431	431	431	430	430	430	430	430	430
12/02/2012	CST	430	430	429	430	429	429	430	429	430	430	430	430	429	431	430	430	430	430	430	426	430	428	430	429
12/03/2012	CST	431	427	426	408	405	422	428	428	431	429	430	431	431	430	430	430	428	430	430	429	428	429	429	429
12/04/2012	CST	428	427	428	477	428	428	427	428	428	428	429	428	429	431	430	431	430	432	431	429	428	429	429	428
12/05/2012	CST	428	428	428	428	429	429	421	429	429	429	430	429	429	431	429	430	430	426	424	416	419	405	424	344
12/06/2012	CST	331	333	332	334	395	433	431	430	429	429	429	429	429	429	429	429	430	427	429	429	427	429	428	429
12/07/2012	CST	429	429	429	430	426	426	428	429	429	428	429	428	428	429	428	428	429	428	428	428	429	429	429	432
12/08/2012	CST	431	431	432	430	430	431	431	431	431	430	430	431	430	431	430	429	429	429	428	428	428	427	428	427
12/09/2012	CST	428	428	428	428	426	426	428	428	428	428	428	428	428	428	429	429	428	428	428	429	430	429	430	430
12/10/2012	CST	422	426	429	430	430	430	430	429	430	431	431	432	432	432	430	430	431	430	431	431	430	431	429	430
12/11/2012	CST	430	430	430	429	428	425	429	426	429	428	429	428	430	430	429	431	429	443	441	430	429	429	429	429
12/12/2012	CST	429	429	426	430	430	430	430	430	430	430	430	430	430	430	429	430	429	429	430	429	430	429	429	429
12/13/2012	CST	426	429	429	429	427	429	428	429	428	428	429	430	430	430	430	430	431	430	431	432	432	430	431	430
12/14/2012	CST	430	430	430	430	430	430	430	430	431	431	430	429	430	431	430	430	430	430	429	430	430	428	429	429
12/15/2012	CST	418	430	429	430	430	430	430	430	429	430	429	430	430	430	428	427	429	430	429	430	430	429	429	429
12/16/2012	CST	429	340	313	316	370	430	430	430	430	429	429	430	429	429	429	429	429	429	430	429	429	429	429	429
12/17/2012	CST	428	429	429	429	429	428	429	429	429	429	429	429	430	430	429	430	430	429	429	430	430	429	429	430
12/18/2012	CST	430	429	429	430	429	429	430	429	429	429	430	429	430	430	431	431	432	430	430	430	430	430	429	429
12/19/2012	CST	427	429	428	427	428	428	428	428	428	428	429	428	428	428	429	429	429	428	429	428	429	429	428	428
12/20/2012	CST	428	428	422	425	417	428	427	427	428	428	428	429	430	429	431	431	432	431	431	431	430	429	429	428
12/21/2012	CST	428	429	428	428	429	429	429	429	428	428	429	430	430	431	430	431	431	431	431	431	429	428	428	428
12/22/2012	CST	430	430	432	428	428	430	426	359	284	304	381	403	425	428	429	429	428	429	428	428	429	428	430	430
12/23/2012	CST	430	278	216	210	296	422	430	429	429	429	426	426	426	426	428	429	429	428	429	428	429	429	430	429
12/24/2012	CST	430	429	429	429	430	429	429	429	429	429	429	429	429	430	430	429	430	430	429	430	428	429	428	430
12/25/2012	CST	430	429	429	430	421	420	420	430	429	431	430	430	430	430	430	430	430	431	431	430	430	430	430	430
12/26/2012	CST	430	431	430	430	420	420	420	431	429	430	430	429	430	429	430	429	429	428	429	430	430	429	429	430
12/27/2012	CST	428	430	430	430	430	431	430	430	430	429	430	428	430	429	429	429	429	430	430	430	429	429	429	428
12/28/2012	CST	428	429	429	429	429	429	429	428	428	427	429	428	429	430	430	429	430	430	430	429	430	429	429	429
12/29/2012	CST	429	428	428	429	430	429	430	429	430	429	430	431	431	431	431	431	431	431	431	430	429	430	429	430
12/30/2012	CST	428	369	426	430	431	430	430	428	427	429	428	430	431	432	430	430	430	431	431	429	430	430	430	429
12/31/2012	CST	429	429	429	428	428	429	429	428	429	428	429	429	429	429	429	429	429	429	428	428	427	428	429	428

**Annual Electric Balancing Authority Area and Planning
 Area Report
 For the Year Ending December 31, 2012**

Utility Code: 17858
 Utility Name: Square Butte Electric Coop

Part III - Schedule 2. Forecast Summer and Winter Peak Demand and Annual Net Energy for Load

Provide the planning area's forecast summer and winter peak demand, in megawatts, and annual net energy for load, in megawatthours, for the next ten years.

Line No (a)	Year (b)	Summer Forecast (MW) (c)	Winter Forecast (MW) (d)	Forecast of Annual Net Energy for Load (MWh) (e)
1	2013	430	430	3,000,000
2	2014	430	430	3,200,000
3	2015	430	430	3,200,000
4	2016	430	430	3,000,000
5	2017	430	430	3,200,000
6	2018	430	430	3,200,000
7	2019	430	430	3,000,000
8	2020	430	430	3,200,000
9	2021	430	430	3,200,000
10	2022	430	430	3,000,000

EXHIBIT III

Square Butte Electric Cooperative

Water Pipeline Map

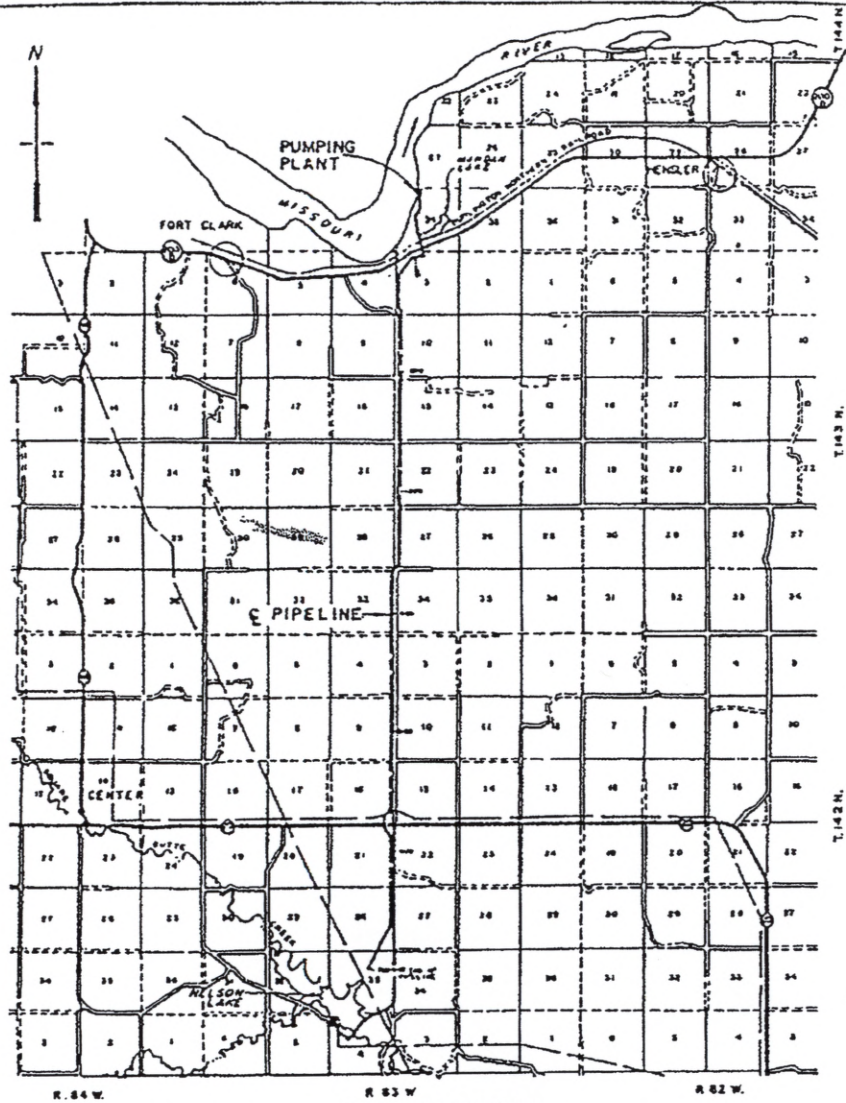

SITE LOCATION
 (OLIVER COUNTY)
 SCALE IN MILES



LOCATION MAP
 SCALE IN MILES
 0 50 100 150

PREPARED BY DATE DRAWN BY CHECKED BY APPROVED BY PROJECT NO.		FOR JAMES D. BURTON, JR. CIVIL ENGINEER 1201 1/2 S. 10th St. BISMARCK, N.D. 58101		SQUARE BUTTE ELECTRIC COOPERATIVE GRAND FORKS, NORTH DAKOTA MILTON A. YOUNG STATION CENTER, NORTH DAKOTA	NELSON LAKE MAKEUP SYS: LOCATION & SITE MAP 0971-005-032 1
---	--	--	--	---	---