

Exam Date: 11/04/2013

Galesburg Co-operative Elevator Company

Page: 1

Examiner: 1

PO Box 115

Galesburg, ND

County:

Phone: 701-488-2216

CCC Number:

Location/Container Numbers/Comments	Section	Capacity
PART A - ADDITIONAL SPACE TO BE INCLUDED UNDER LICENSE		
701NW	A	555,596
702SW	A	641,131
	Total:	1,196,727
PART B - SPACE TO BE DELETED UNDER LICENSE		
ground	Z	249,006
	Total:	249,006
PART C - ALL SPACE TO BE INCLUDED UNDER LICENSE		
	A	2,733,000
	B	1,077,000
	G	586,000
	Total:	4,396,000
PART D - TOTAL CAPACITY BY FUNCTIONAL UNIT		
Galesburg 495	A B G	4,396,000
	Total:	4,396,000

GALESBURG COOPERATIVE ELEV. CO.
 GALESBURG N.D.
 SECTION B page 4

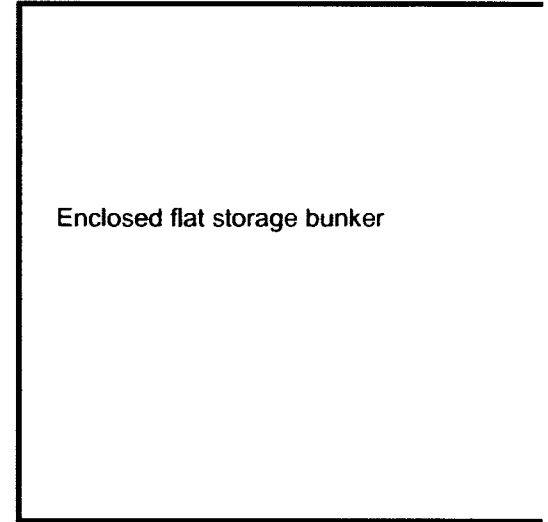
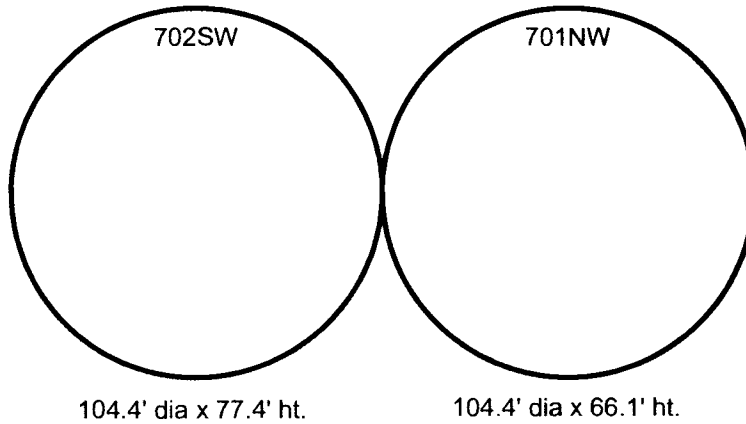

601 quonset	#601 Not Licensed	foundation 47.0' W x 2.0' ht.
Section A		3.0' ht. width = 47.0'
base dimensions above foundation 47.6' W x 300.0' L		5.0' ht. width = 45.8'
1st side wall support top of to floor 8.0'		7.0' ht. width = 44.1'
2nd side wall support 13.0'		9.0' ht. width = 41.6'
3rd side wall support 19.5'		
center bottom u-trough to floor 20.0'		
u-trough space on center 2.25'		

BNSF RAIL

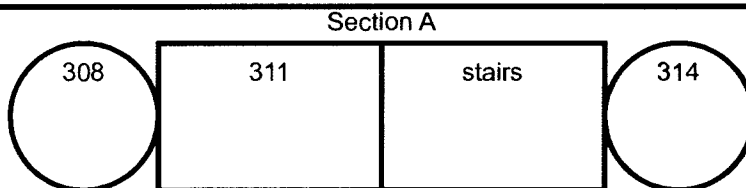

GALESBURG COOPERATIVE ELEV. CO.
GALESBURG ND
SECTION B enclosed flat storage bunker

Base 00 EXT1-B
Top 00EXT1-T

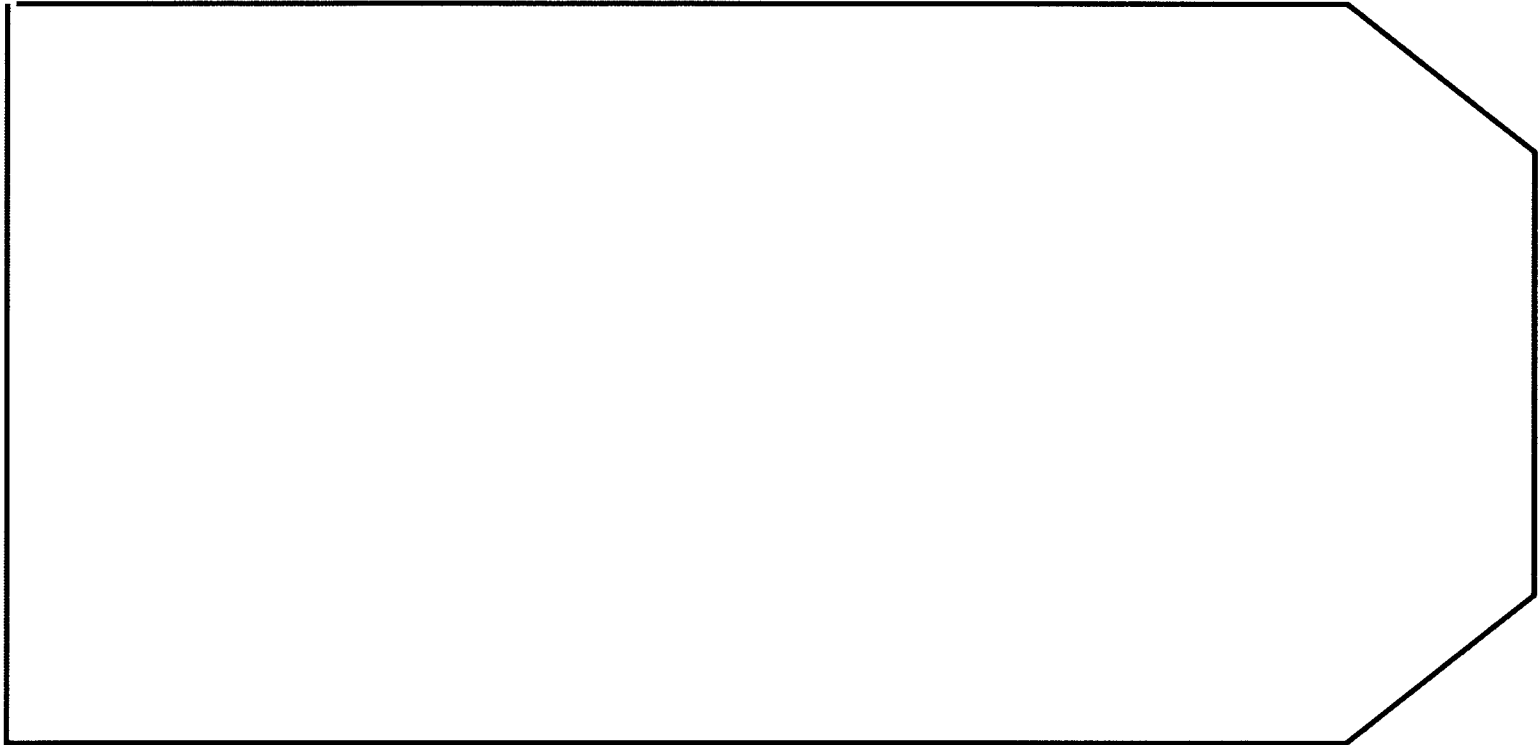

Basics
11.5' grain wall ht.
250' length x 218' width
40,119.5 bu./ft
20 degree angle of repose = a peak ht. of $39.6' / 3 = 13.2'$ of grain above bunker wall
see calculations page for more information

BNSF RAIL

ELEVATOR COMPLEX

GALESBERG COOPERATIVE ELEV. CO.
GALESBURG N.D.
SECTION G
0.05 m. east of Section B
bin site east of town

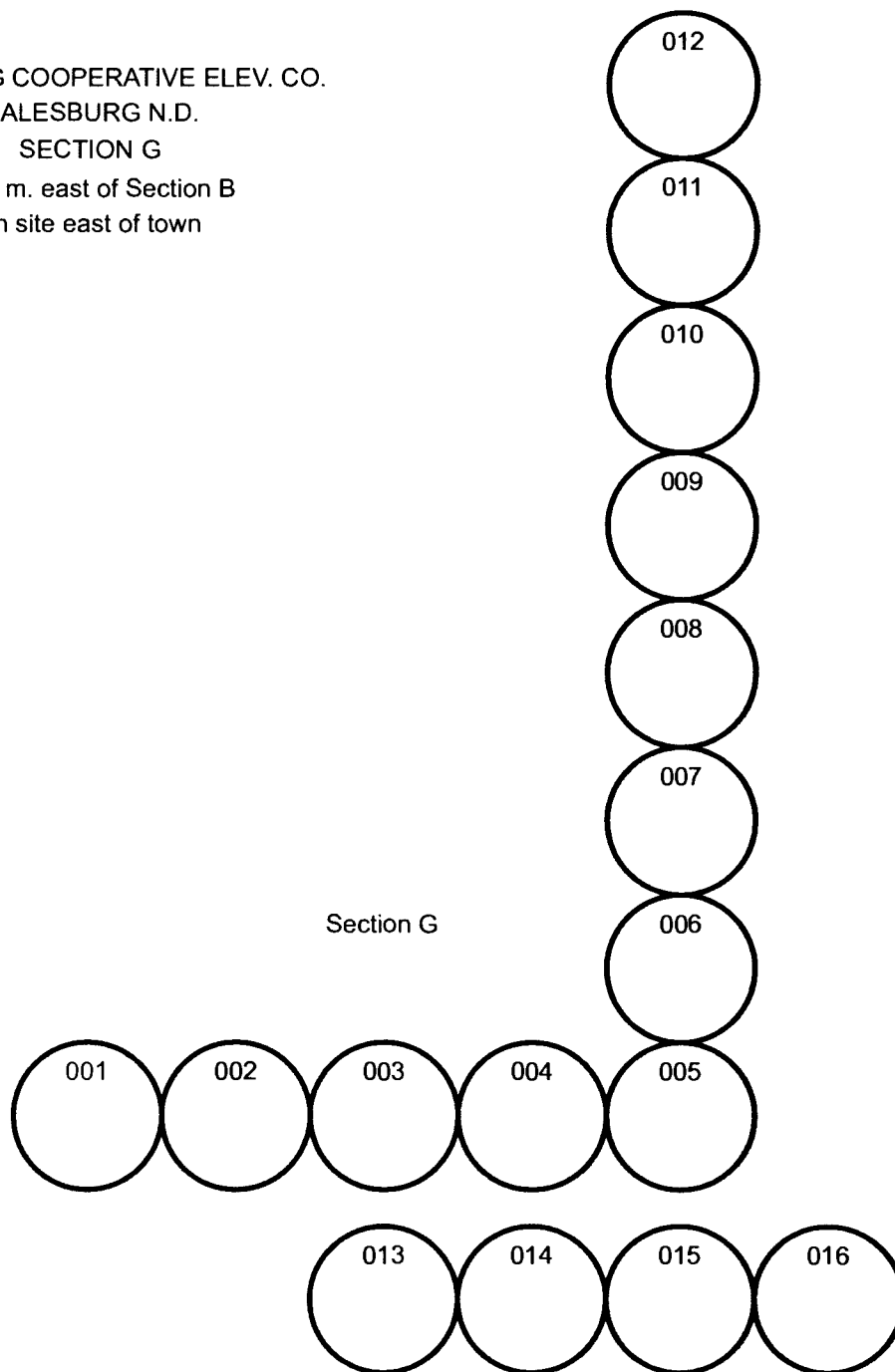

GALESBURG COOPERATIVE ELEV. CO.
 GALESBURG N.D.
 SECTION A page 2

BNSF RAIL

XXXXXXXX EXCLUDED SPACE XXXXXXXXXXXXXXXX

116	114	112	111	110	109		202	204	206	208	210	212	214	216
XXXXXXX EXCLUDED SPACE XXXXXXXXXXXXXXXX														
117	118	123	101	107	106									
XXXXXXX EXCLUDED SPACE XXXXXXXXXXXXXXXX														
119	121	122	103	104	1TB									
XXXXXXX EXCLUDED SPACE XXXXXXXXXXXXXXXX														
			102		105		201	203	205	207	209	211	213	215

SECTION A

OFFICE

GALESBURG COOPERATIVE ELEV. CO.
 GALESBURG N.D.
 SECTION A page 1

BNSF RAIL

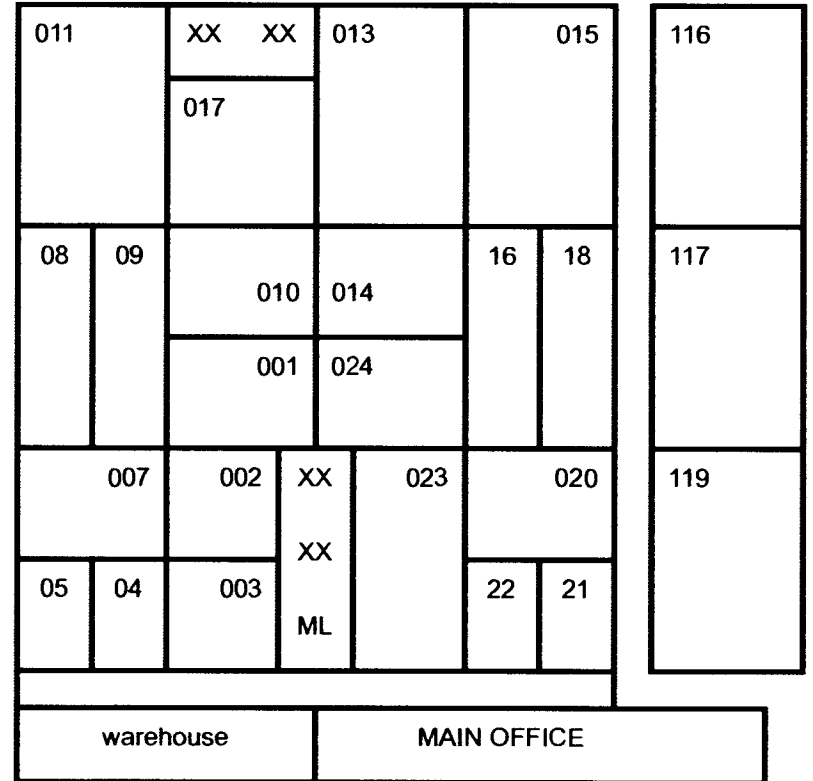
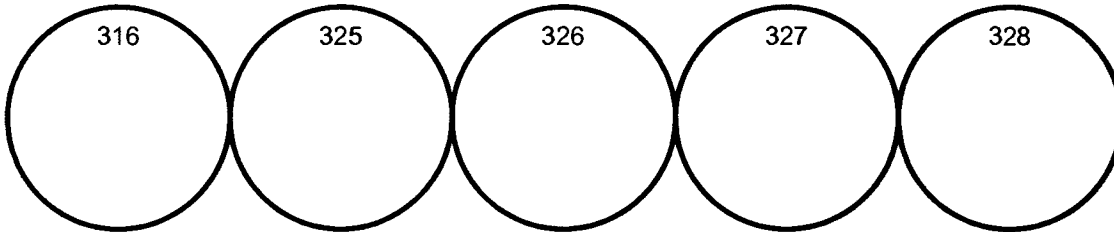

BNSF RAIL

GALESBURG COOPERATIVE ELEV. CO.
GALESBURG N.D.
SECTION A page 3

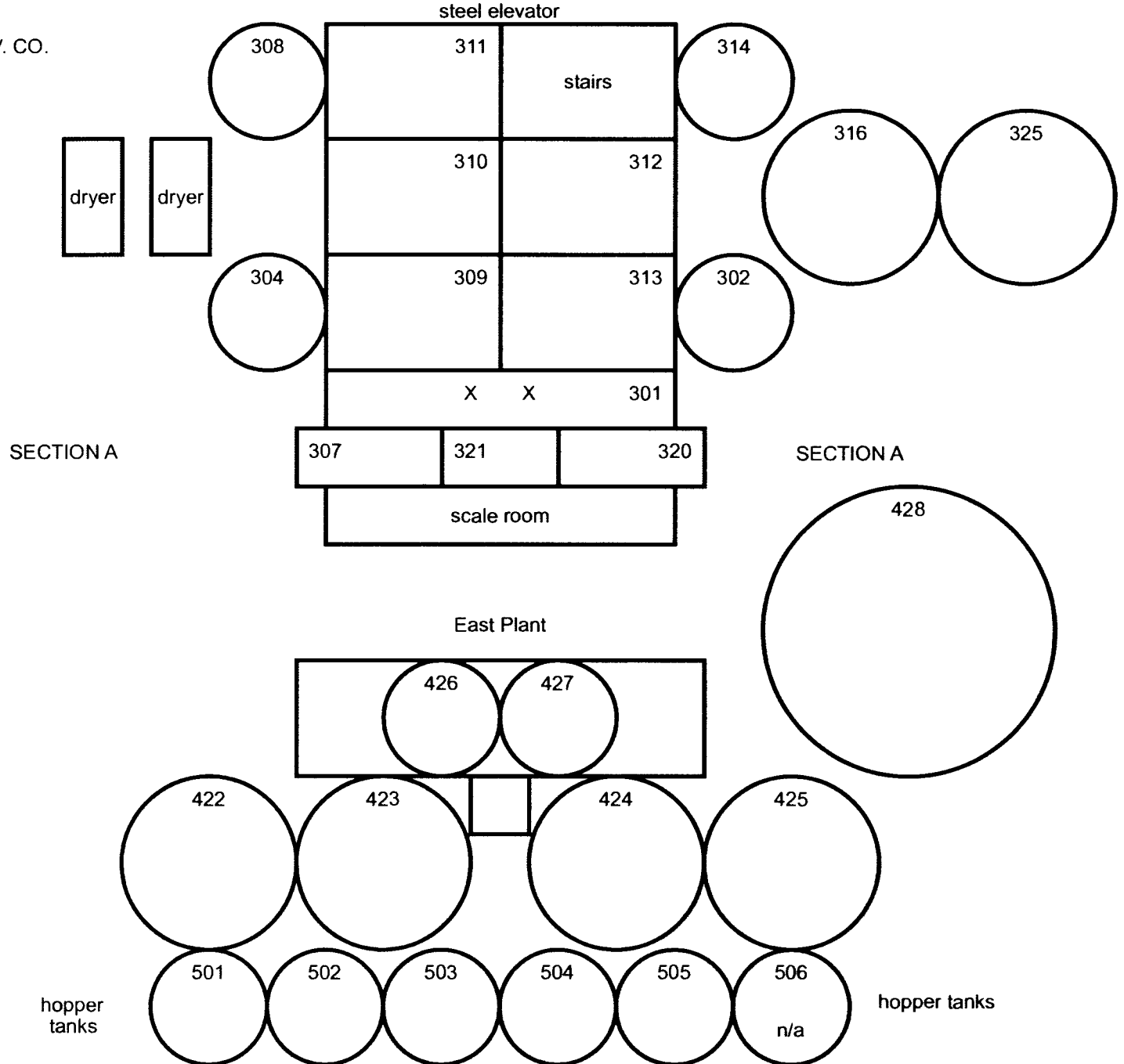

Exam Date: 11/04/2013

Galesburg Co-operative Elevator Company

Page: 1

Examiner: 1

PO Box 115
Galesburg, ND
County:

Status	Section	Bin Number	Bin Type	Base Point	Diameter or Bu/Ft (Irreg.)	Length	Width	Side wall	Add for Hopper	Ded. for Obst.	Effective Depth	Add for Peak	Depth for Capac.	Bushels per Foot	Base Pack%	Bushel Capacity with Pack
--------	---------	------------	----------	------------	-------------------------------	--------	-------	--------------	----------------------	----------------------	--------------------	--------------------	------------------------	------------------------	---------------	------------------------------

Facility: Galesburg

Section: A

A	001 T		Square	work floor	0.000	6.900	5.700	11.00	0.00	0.00	11.000	0.000	11.0	31.6	2.50	357
A	001 B		Square	work floor - top 11' - 4' hpr	0.000	6.700	5.700	43.00	2.00	0.00	45.000	0.000	45.0	30.7	2.50	1,417
A	002 T		Square	work floor	0.000	4.000	3.700	11.00	0.00	0.00	11.000	0.000	11.0	11.9	2.00	134
A	002 M		Square	work floor - top 11'	0.000	3.800	3.500	17.00	0.00	0.00	17.000	0.000	17.0	10.7	2.00	186
A	002B		Square	work floor - top & middle 28'	0.000	10.80	3.500	18.00	6.00	0.00	24.000	0.000	24.0	30.4	2.50	748
A	003 T		Square	work floor	0.000	6.800	3.700	11.00	0.00	0.00	11.000	0.000	11.0	20.2	2.00	226
A	003 B		Square	work floor - top 11' - 6' hpr	0.000	6.600	3.500	13.00	3.00	0.00	16.000	0.000	16.0	18.6	2.00	304
A	004 T		Square	work floor	0.000	8.200	5.800	11.00	0.00	0.00	11.000	0.000	11.0	38.2	3.00	433
A	004 B		Square	work floor - top 11' - 6' hpr	0.000	8.000	5.500	40.00	3.00	0.00	43.000	0.000	43.0	35.4	3.00	1,568
A	005 T		Square	work floor	0.000	8.000	5.800	11.00	0.00	0.00	11.000	0.000	11.0	37.3	3.00	422
A	005 B		Square	work floor - top 11' - 6' hpr	0.000	7.800	5.500	40.00	3.00	0.00	43.000	0.000	43.0	34.5	3.00	1,529
A	007 T		Square	work floor	0.000	16.80	5.200	11.00	0.00	0.00	11.000	0.000	11.0	70.2	5.20	812
A	007 M		Square	work floor - top 11'	0.000	16.60	4.900	43.00	0.00	0.00	43.000	0.000	43.0	65.4	5.00	2,953
A	007B		Square	work floor - top & middle 54'	0.000	16.30	10.50	15.00	4.00	0.00	19.000	0.000	19.0	137.6	6.50	2,784
A	008 T		Square	work floor	0.000	12.00	8.000	11.00	0.00	0.00	11.000	0.000	11.0	77.2	5.50	896
A	008 B		Square	work floor - top 11' - 4' hpr	0.000	12.00	7.800	43.00	2.00	0.00	45.000	0.000	45.0	75.2	5.50	3,570
A	009 T		Square	work floor	0.000	12.00	8.200	11.00	0.00	0.00	11.000	0.000	11.0	79.1	5.50	918
A	009 B		Square	work floor - top 11' - 4' hpr	0.000	12.00	8.000	43.00	2.00	0.00	45.000	0.000	45.0	77.2	5.50	3,665
A	010 T		Square	work floor	0.000	6.900	5.700	11.00	0.00	0.00	11.000	0.000	11.0	31.6	2.50	357
A	010 B		Square	work floor - top 11' - 4' hpr	0.000	6.700	5.700	43.00	2.00	0.00	45.000	0.000	45.0	30.7	2.50	1,417
A	011 T		Square	work floor	0.000	16.80	11.10	11.00	0.00	0.00	11.000	0.000	11.0	149.9	6.80	1,761

Exam Date:11/04/2013

Galesburg Co-operative Elevator Company

Page: 2

Examiner: 1

PO Box 115
Galesburg , ND
County:

Status	Section	Bin Number	Bin Type	Base Point	Diameter or Bu/Ft (Irreg).	Length	Width	Side wall	Add for Hopper	Ded. for Obst.	Effective Depth	Add for Peak	Depth for Capac.	Bushels per Foot	Base Pack%	Bushel Capacity with Pack
--------	---------	------------	----------	------------	-------------------------------	--------	-------	--------------	----------------------	----------------------	--------------------	--------------------	------------------------	------------------------	---------------	------------------------------

Facility: Galesburg

Section: A

A	011 M	Square	work floor - top 11'	0.000	16.60	10.80	44.00	0.00	0.00	44.000	0.000	44.0	144.1	6.80	6,771
A	011B	Square	work floor - top & middle 55'	0.000	16.30	10.50	11.00	4.00	0.00	15.000	0.000	15.0	137.6	6.50	2,198
A	013 T	Irregular	work floor - 11.1x6.9 less	48.300	0.000	0.000	11.00	0.00	0.00	11.000	0.000	11.0	48.3	4.20	553
A	013 M	Irregular	work floor - top 11' -	44.900	0.000	0.000	5.000	0.00	0.00	5.000	0.000	5.0	44.9	3.50	233
A	013B	Square	work floor - top & middle 16'	0.000	10.50	6.700	38.00	2.00	0.00	40.000	0.000	40.0	56.6	4.80	2,373
A	014 T	Square	work floor	0.000	6.900	5.700	11.00	0.00	0.00	11.000	0.000	11.0	31.6	2.50	357
A	014 B	Square	work floor - top 11'-4' hppr	0.000	6.700	5.700	43.00	2.00	0.00	45.000	0.000	45.0	30.7	2.50	1,417
A	015 T	Square	work floor	0.000	16.80	11.10	11.00	0.00	0.00	11.000	0.000	11.0	149.9	6.80	1,761
A	015 M	Square	work floor - top 11'	0.000	16.60	10.80	44.00	0.00	0.00	44.000	0.000	44.0	144.1	6.80	6,771
A	015B	Square	work floor - top & middle 55'	0.000	16.30	10.50	11.00	4.00	0.00	15.000	0.000	15.0	137.6	6.50	2,198
A	016 T	Square	work floor	0.000	12.00	8.200	11.00	0.00	0.00	11.000	0.000	11.0	79.1	5.50	918
A	016 B	Square	work floor - top 11' -4' hppr	0.000	12.00	8.000	43.00	2.00	0.00	45.000	0.000	45.0	77.2	5.50	3,665
A	017 T	Square	work floor	0.000	6.900	5.200	11.00	0.00	0.00	11.000	0.000	11.0	28.8	2.50	325
A	017 B	Square	work floor - top 11' - 4' hppr	0.000	6.700	5.000	43.00	2.00	0.00	45.000	0.000	45.0	26.9	2.50	1,241
A	018 T	Square	work floor	0.000	12.00	8.000	11.00	0.00	0.00	11.000	0.000	11.0	77.2	5.50	896
A	018 B	Square	work floor - top 11'- 4' hppr	0.000	12.00	7.800	43.00	2.00	0.00	45.000	0.000	45.0	75.2	5.50	3,570
A	020 T	Square	work floor	0.000	16.80	5.200	11.00	0.00	0.00	11.000	0.000	11.0	70.2	5.20	812
A	020 M	Square	work floor - top 11'	0.000	16.60	4.900	43.00	0.00	0.00	43.000	0.000	43.0	65.4	5.00	2,953
A	020B	Square	work floor - top & middle 54'	0.000	16.30	10.50	15.00	4.00	0.00	19.000	0.000	19.0	137.6	6.50	2,784
A	021 T	Square	work floor	0.000	8.000	5.800	11.00	0.00	0.00	11.000	0.000	11.0	37.3	3.00	422
A	021 B	Square	work floor - top 11' -6' hppr	0.000	7.800	5.500	40.00	3.00	0.00	43.000	0.000	43.0	34.5	3.00	1,529

NDPSC Bin Capacity Chart

Exam Date: 11/04/2013

Galesburg Co-operative Elevator Company

Page: 3

Examiner: 1

PO Box 115
Galesburg, ND
County:

Status	Section	Bin Number	Bin Type	Base Point	Diameter or Bu/Ft (Irreg.) Length	Width	Side wall	Add for Hopper	Ded. for Obst.	Effective Depth	Add for Peak	Depth for Capac.	Bushels per Foot	Base Pack%	Bushel Capacity with Pack
--------	---------	------------	----------	------------	---	-------	--------------	----------------------	----------------------	--------------------	--------------------	------------------------	------------------------	---------------	------------------------------

Facility: Galesburg**Section: A**

A	022 T	Square	work floor		0.000	8.200	5.800	11.00	0.00	0.00	11.000	0.000	11.0	38.2	3.00	433
A	022 B	Square	work floor - top 11' - 6' hppr		0.000	8.000	5.500	40.00	3.00	0.00	43.000	0.000	43.0	35.4	3.00	1,568
A	023 T	Square	work floor		0.000	11.10	4.100	11.00	0.00	0.00	11.000	0.000	11.0	36.6	3.00	415
A	023 B	Square	work floor - top 11'		0.000	10.80	3.900	41.00	0.00	0.00	41.000	0.000	41.0	33.9	2.50	1,425
A	024 T	Square	work floor		0.000	6.900	5.700	11.00	0.00	0.00	11.000	0.000	11.0	31.6	2.50	357
A	024 B	Square	work floor - top 11' - 4' hppr		0.000	6.700	5.700	43.00	2.00	0.00	45.000	0.000	45.0	30.7	2.50	1,417
A	201 T	Square	work floor		0.000	14.60	10.30	43.00	0.00	0.00	43.000	0.000	43.0	120.9	6.50	5,537
A	201 B	Square	work floor - top 43'		0.000	10.30	9.900	8.000	0.00	0.00	8.000	0.000	8.0	82.0	5.50	692
A	202	Square	work floor		0.000	14.00	10.30	51.00	0.00	0.00	51.000	0.000	51.0	115.9	6.20	6,277
A	203 T	Square	work floor		0.000	14.60	10.70	43.00	0.00	0.00	43.000	0.000	43.0	125.6	6.50	5,752
A	203 B	Square	work floor - top 43'		0.000	10.70	9.900	8.000	0.00	0.00	8.000	0.000	8.0	85.2	5.80	722
A	204	Square	work floor		0.000	14.00	10.70	51.00	0.00	0.00	51.000	0.000	51.0	120.4	6.50	6,539
A	205 T	Square	work floor		0.000	14.60	10.60	43.00	0.00	0.00	43.000	0.000	43.0	124.4	6.50	5,697
A	205 B	Square	work floor - top 43'		0.000	10.60	9.900	8.000	0.00	0.00	8.000	0.000	8.0	84.4	5.80	714
A	206	Square	work floor		0.000	14.00	10.60	51.00	0.00	0.00	51.000	0.000	51.0	119.3	6.20	6,461
A	207 T	Square	work floor -		0.000	14.60	10.70	43.00	0.00	0.00	43.000	0.000	43.0	125.6	6.50	5,752
A	207 B	Square	work floor - top 43'		0.000	10.70	9.900	8.000	0.00	0.00	8.000	0.000	8.0	85.2	5.80	722
A	208	Square	work floor		0.000	14.00	10.70	51.00	0.00	0.00	51.000	0.000	51.0	120.4	6.50	6,539
A	209 T	Square	work floor		0.000	14.60	10.60	43.00	0.00	0.00	43.000	0.000	43.0	124.4	6.50	5,697
A	209 B	Square	work floor - top 43'		0.000	10.60	9.900	8.000	0.00	0.00	8.000	0.000	8.0	84.4	5.80	714
A	210	Square	work floor		0.000	14.00	10.60	51.00	0.00	0.00	51.000	0.000	51.0	119.3	6.20	6,461

NDPSC Bin Capacity Chart

Exam Date: 11/04/2013

Galesburg Co-operative Elevator Company

Page: 4

Examiner: 1

PO Box 115
Galesburg, ND
County:

Status	Section	Bin Number	Bin Type	Base Point	Diameter or Bu/Ft (Irreg.) Length	Width	Side wall	Add for Hopper	Ded. for Obst.	Effective Depth	Add for Peak	Depth for Capac.	Bushels per Foot	Base Pack%	Bushel Capacity with Pack
--------	---------	------------	----------	------------	---	-------	--------------	----------------------	----------------------	--------------------	--------------------	------------------------	------------------------	---------------	------------------------------

Facility: Galesburg**Section: A**

A	211 T	Square	work floor		0.000	14.60	10.70	43.00	0.00	0.00	43.000	0.000	43.0	125.6	6.50	5,752
A	211 B	Square	work floor - top 43'		0.000	10.70	9.900	8.000	0.00	0.00	8.000	0.000	8.0	85.2	5.80	722
A	212	Square	work floor		0.000	14.00	10.70	51.00	0.00	0.00	51.000	0.000	51.0	120.4	6.50	6,539
A	213 T	Square	work floor		0.000	14.60	10.70	43.00	0.00	0.00	43.000	0.000	43.0	125.6	6.50	5,752
A	213 B	Square	work floor - top 43'		0.000	10.70	9.900	8.000	0.00	0.00	8.000	0.000	8.0	85.2	5.80	722
A	214	Square	work floor		0.000	14.00	10.70	51.00	0.00	0.00	51.000	0.000	51.0	120.4	6.50	6,539
A	215 T	Square	work floor		0.000	14.60	10.30	43.00	0.00	0.00	43.000	0.000	43.0	120.9	6.50	5,537
A	215 B	Square	work floor - top 43'		0.000	10.30	9.900	8.000	0.00	0.00	8.000	0.000	8.0	82.0	5.50	692
A	216	Square	work floor		0.000	14.00	10.30	51.00	0.00	0.00	51.000	0.000	51.0	115.9	6.20	6,277
A	301	Square	eaves		0.000	12.50	6.500	21.00	0.00	0.00	21.000	0.000	21.0	65.3	5.00	1,440
A	302	Peaked	eaves		21.000	0.000	0.000	48.00	2.70	0.00	50.700	1.300	52.0	278.4	6.80	15,461
A	304	Peaked	eaves		21.000	0.000	0.000	48.00	2.70	0.00	50.700	1.300	52.0	278.4	6.80	15,461
A	307	Square	eaves		0.000	14.90	12.50	22.00	0.00	0.00	22.000	0.000	22.0	149.7	6.80	3,517
A	308	Peaked	eaves		21.000	0.000	0.000	48.00	2.70	0.00	50.700	1.300	52.0	278.4	6.80	15,461
A	309	Square	eaves		0.000	8.000	6.200	44.50	0.00	0.00	44.500	0.000	44.5	39.9	3.00	1,829
A	310	Square	eaves		0.000	8.000	6.200	44.50	0.00	0.00	44.500	0.000	44.5	39.9	3.00	1,829
A	311	Square	eaves		0.000	10.00	6.200	21.00	0.00	0.00	21.000	0.000	21.0	49.8	4.20	1,090
A	312	Square	eaves		0.000	8.000	6.200	44.50	0.00	0.00	44.500	0.000	44.5	39.9	3.00	1,829
A	313	Square	eaves		0.000	8.000	6.200	44.50	0.00	0.00	44.500	0.000	44.5	39.9	3.00	1,829
A	314	Peaked	eaves		21.000	0.000	0.000	48.00	2.70	0.00	50.700	1.300	52.0	278.4	6.80	15,461
A	316	Peaked	eaves		42.000	0.000	0.000	66.00	0.00	0.00	66.000	2.500	68.5	1113.7	10.0	83,917

Client ID: 184

NDPSC Bin Capacity Chart

11/04/2013 11:03:24 AM

Exam Date: 11/04/2013

Galesburg Co-operative Elevator Company

Page: 5

Examiner: 1

PO Box 115
Galesburg, ND
County:

Status	Section	Bin Number	Bin Type	Base Point	Diameter or Bu/Ft (Irreg). Length	Width	Side wall	Add for Hopper	Ded. for Obst.	Effective Depth	Add for Peak	Depth for Capac.	Bushels per Foot	Base Pack%	Bushel Capacity with Pack
--------	---------	------------	----------	------------	---	-------	--------------	----------------------	----------------------	--------------------	--------------------	------------------------	------------------------	---------------	------------------------------

Facility: Galesburg**Section: A**

	A	320	Square	eaves	0.000	14.90	12.50	22.00	0.00	0.00	22.000	0.000	22.0	149.7	6.80	3,517
	A	321	Square	eaves	0.000	14.90	12.50	22.00	0.00	0.00	22.000	0.000	22.0	149.7	6.80	3,517
	A	325	Peaked	eaves	42.000	0.000	0.000	66.00	0.00	0.00	66.000	2.500	68.5	1113.7	10.0	83,917
	A	326	Peaked	eaves	42.000	0.000	0.000	66.00	0.00	0.00	66.000	2.500	68.5	1113.7	10.0	83,917
	A	327	Peaked	eaves	42.000	0.000	0.000	66.00	0.00	0.00	66.000	2.500	68.5	1113.7	10.0	83,917
	A	328	Peaked	eaves	41.800	0.000	0.000	61.40	0.00	0.00	61.400	2.500	63.9	1103.1	10.0	77,537
	A	422	Peaked	eaves	42.000	0.000	0.000	80.70	0.00	0.00	80.700	2.500	83.2	1113.7	10.0	101,926
	A	423	Peaked	eaves	42.000	0.000	0.000	80.70	0.00	0.00	80.700	2.500	83.2	1113.7	10.0	101,926
	A	424	Peaked	eaves	42.000	0.000	0.000	80.70	0.00	0.00	80.700	2.500	83.2	1113.7	10.0	101,926
	A	425	Peaked	eaves	42.000	0.000	0.000	80.70	0.00	0.00	80.700	2.500	83.2	1113.7	10.0	101,926
	A	426	Peaked	eaves	15.000	0.000	0.000	18.30	2.30	0.00	20.600	0.900	21.5	142.1	5.50	3,223
	A	427	Peaked	eaves	15.000	0.000	0.000	18.30	2.30	0.00	20.600	0.900	21.5	142.1	5.50	3,223
	A	428	Peaked	eaves	90.000	0.000	0.000	69.50	0.00	0.00	69.500	6.300	75.8	5113.9	10.0	426,397
	A	501	Peaked	eaves	18.000	0.000	0.000	16.00	2.30	0.00	18.300	1.100	19.4	204.6	6.00	4,207
	A	502	Peaked	eaves	18.000	0.000	0.000	16.00	2.30	0.00	18.300	1.100	19.4	204.6	6.00	4,207
	A	503	Peaked	eaves	18.000	0.000	0.000	16.00	2.30	0.00	18.300	1.100	19.4	204.6	6.00	4,207
	A	504	Peaked	eaves	18.000	0.000	0.000	16.00	2.30	0.00	18.300	1.100	19.4	204.6	6.00	4,207
	A	505	Peaked	eaves	18.000	0.000	0.000	16.00	2.30	0.00	18.300	1.100	19.4	204.6	6.00	4,207
Added	A	701NW	Peaked	top of sidewall	104.40	0.000	0.000	66.10	0.00	0.00	66.100	7.300	73.4	6881.3	10.0	555,596
Added	A	702SW	Peaked	top of sidewall	104.40	0.000	0.000	77.40	0.00	0.00	77.400	7.300	84.7	6881.3	10.0	641,131

Client ID: 184

NDPSC Bin Capacity Chart

11/04/2013 11:03:24 AM

Exam Date: 11/04/2013

Galesburg Co-operative Elevator Company
 PO Box 115
 Galesburg, ND
 County:

Page: 6

Examiner: 1

Status	Section	Bin Number	Bin Type	Base Point	Diameter or Bu/Ft (Irreg.)		Side wall	Add for Hopper	Ded. for Obst.	Effective Depth	Add for Peak	Depth for Capac.	Bushels per Foot	Base Pack%	Bushel Capacity with Pack
					Length	Width									
Bin count: 104															Facility: Galesburg Section: A Total: 2,732,382
															To Even: 2,733,000

Section: B

B	00EXT1 B	Irregular	top bunker wall- deduct 0.3'	40120	223.4	223.4	11.50	0.00	0.30	11.200	0.000	11.2	40119.5	10.0	494,272
B	00EXT1 T	Irregular	20 degree angle of repose	40120	223.4	223.4	13.20	0.00	0.00	13.200	0.000	13.2	40119.5	10.0	582,535
Bin count: 2															Facility: Galesburg Section: B Total: 1,076,807
															To Even: 1,077,000

Section: G

G	001	Peaked	top of sidewall	42.000	0.000	0.000	26.70	0.00	0.00	26.700	2.500	29.2	1113.7	10.0	35,772
G	002	Peaked	top of sidewall	42.000	0.000	0.000	26.70	0.00	0.00	26.700	2.500	29.2	1113.7	10.0	35,772
G	003	Peaked	top of sidewall	42.000	0.000	0.000	26.70	0.00	0.00	26.700	2.500	29.2	1113.7	10.0	35,772
G	004	Peaked	top of sidewall	42.000	0.000	0.000	26.70	0.00	0.00	26.700	2.500	29.2	1113.7	10.0	35,772
G	005	Peaked	top of sidewall	42.000	0.000	0.000	26.70	0.00	0.00	26.700	2.500	29.2	1113.7	10.0	35,772
G	006	Peaked	top of sidewall	42.000	0.000	0.000	26.70	0.00	0.00	26.700	2.500	29.2	1113.7	10.0	35,772
G	007	Peaked	top of sidewall	42.000	0.000	0.000	26.70	0.00	0.00	26.700	2.500	29.2	1113.7	10.0	35,772
G	008	Peaked	top of sidewall	42.000	0.000	0.000	26.70	0.00	0.00	26.700	2.500	29.2	1113.7	10.0	35,772
G	009	Peaked	top of sidewall	42.000	0.000	0.000	26.70	0.00	0.00	26.700	2.500	29.2	1113.7	10.0	35,772
G	010	Peaked	top of sidewall	42.000	0.000	0.000	26.70	0.00	0.00	26.700	2.500	29.2	1113.7	10.0	35,772
G	011	Peaked	top of sidewall	42.000	0.000	0.000	26.70	0.00	0.00	26.700	2.500	29.2	1113.7	10.0	35,772
G	012	Peaked	top of sidewall	42.000	0.000	0.000	26.70	0.00	0.00	26.700	2.500	29.2	1113.7	10.0	35,772
G	013	Peaked	top of sidewall	42.000	0.000	0.000	29.30	0.00	0.00	29.300	2.500	31.8	1113.7	10.0	38,958
G	014	Peaked	top of sidewall	42.000	0.000	0.000	29.30	0.00	0.00	29.300	2.500	31.8	1113.7	10.0	38,958

Client ID: 184

NDPSC Bin Capacity Chart

11/04/2013 11:03:24 AM

Exam Date: 11/04/2013

Galesburg Co-operative Elevator Company
PO Box 115
Galesburg, ND
County:

Page: 7

Examiner: 1

Status	Section	Bin Number	Bin Type	Base Point	Diameter or Bu/Ft (Irreg.)	Length	Width	Side wall	Add for Hopper	Ded. for Obst.	Effective Depth	Add for Peak	Depth for Capac.	Bushels per Foot	Base Pack%	Bushel Capacity with Pack
--------	---------	------------	----------	------------	-------------------------------	--------	-------	--------------	----------------------	----------------------	--------------------	--------------------	------------------------	------------------------	---------------	------------------------------

Facility: Galesburg

Section: G

G	015	Peaked	top of sidewall	42.000	0.000	0.000	29.30	0.00	0.00	29.300	2.500	31.8	1113.7	10.0	38,958
G	016	Peaked	top of sidewall	42.000	0.000	0.000	29.30	0.00	0.00	29.300	2.500	31.8	1113.7	10.0	38,958

Bin count: 16

Facility: Galesburg Section: G Total: 585,096

To Even: 586,000

Overall Licensed Bin Capacity for:

Galesburg Co-operative Elevator Company

Bin count: 122

Licensed Capacity:
(includes pack)

4,394,285 Bu.

Licensed Capacity (to even):
(includes pack and section totals are rounded up to next highest 1000)

4,396,000 Bu.