

Steele Farmers Elev

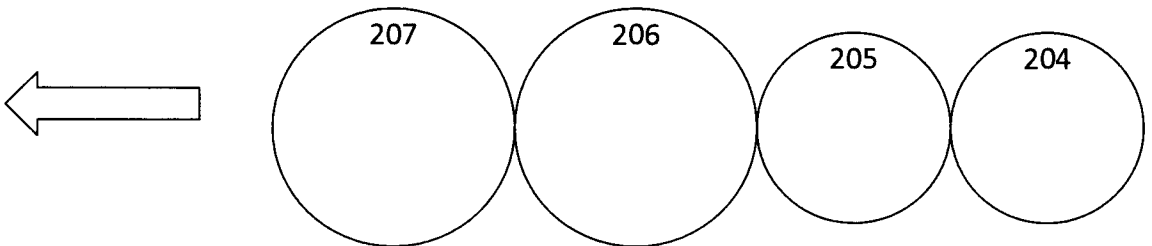
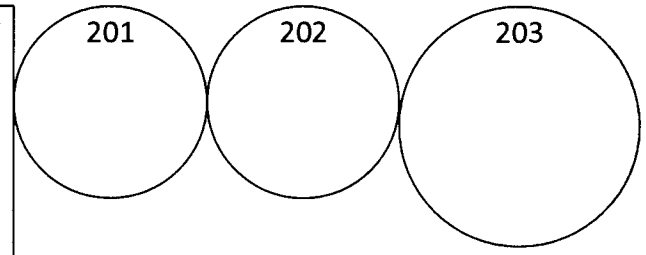
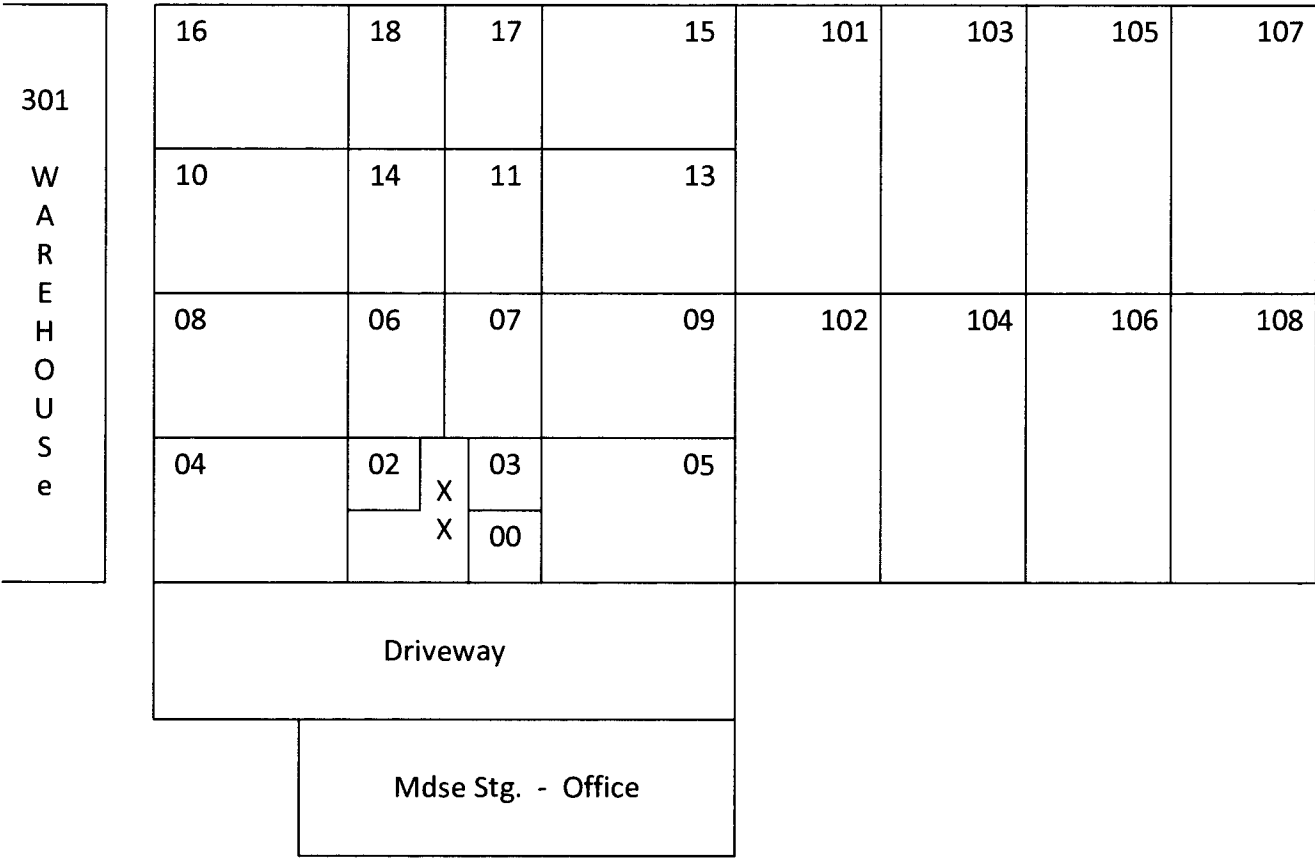
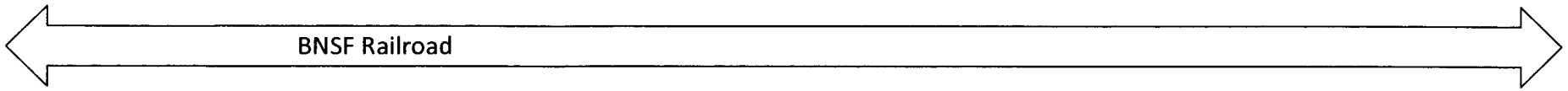

Exam Date:07/25/2013

Steele Farmers Elevator

Page: 1

Examiner: 1

Box 259
Steele, ND
County:

Status	Section	Bin Number	Bin Type	Base Point	Diameter or Bu/Ft (Irreg).		Side wall	Add for Hopper	Ded. for Obst.	Effective Depth	Add for Peak	Depth for Capac.	Bushels per Foot	Base Pack%	Bushel Capacity with Pack
					Length	Width									

Facility: Steele

Section: A

A	000	Square	work floor		0.000	3.400	3.000	20.00	0.00	0.00	20.000	0.000	20.0	8.2	2.00	167
A	002	Square	work floor		0.000	2.600	3.000	37.00	0.00	0.00	37.000	0.000	37.0	6.3	2.00	238
A	003 T	Square	work floor		0.000	4.000	3.000	20.00	0.00	0.00	20.000	0.000	20.0	9.6	2.00	196
A	003B	Square	work floor	T20'	0.000	7.400	3.000	17.00	0.00	0.00	17.000	0.000	17.0	17.8	2.00	309
A	004	Square	work floor		0.000	7.400	12.20	50.50	0.00	0.00	50.500	0.000	50.5	72.6	5.20	3,857
A	005	Square	work floor		0.000	7.400	12.20	50.50	0.00	0.00	50.500	0.000	50.5	72.6	5.20	3,857
A	006	Square	work floor		0.000	7.700	6.400	38.00	0.00	0.00	38.000	0.000	38.0	39.6	3.00	1,550
A	007	Square	work floor		0.000	7.700	6.400	38.00	0.00	0.00	38.000	0.000	38.0	39.6	3.00	1,550
A	008	Square	work floor		0.000	7.700	12.20	50.50	0.00	0.00	50.500	0.000	50.5	75.5	5.50	4,023
A	009	Square	work floor		0.000	7.700	12.20	50.50	0.00	0.00	50.500	0.000	50.5	75.5	5.50	4,023
A	010	Square	work floor		0.000	7.700	12.20	50.50	0.00	0.00	50.500	0.000	50.5	75.5	5.50	4,023
A	011	Square	work floor		0.000	7.700	6.400	37.50	0.00	0.00	37.500	0.000	37.5	39.6	3.00	1,530
A	013	Square	work floor		0.000	7.700	12.20	50.50	0.00	0.00	50.500	0.000	50.5	75.5	5.50	4,023
A	014	Square	work floor		0.000	7.700	6.400	37.50	0.00	0.00	37.500	0.000	37.5	39.6	3.00	1,530
A	015	Square	work floor		0.000	7.400	12.20	50.50	0.00	0.00	50.500	0.000	50.5	72.6	5.20	3,857
A	016	Square	work floor		0.000	7.400	12.20	50.50	0.00	0.00	50.500	0.000	50.5	72.6	5.20	3,857
A	017	Square	work floor		0.000	7.400	6.400	37.00	0.00	0.00	37.000	0.000	37.0	38.1	3.00	1,452
A	018	Square	work floor		0.000	7.400	6.400	37.00	0.00	0.00	37.000	0.000	37.0	38.1	3.00	1,452
A	101	Square	work floor		0.000	15.20	9.200	46.00	0.00	0.00	46.000	0.000	46.0	112.4	6.20	5,491
A	102 T	Square	work floor		0.000	15.60	9.200	39.00	0.00	0.00	39.000	0.000	39.0	115.4	6.20	4,780
A	102B	Square	work floor	T39'	0.000	11.00	9.200	7.500	0.00	0.00	7.500	0.000	7.5	81.4	5.50	645

Exam Date:07/25/2013

Steele Farmers Elevator

Page: 2

Examiner: 1

Box 259
Steele, ND
County:

Status	Section	Bin Number	Bin Type	Base Point	Diameter or Bu/Ft (Irreg).		Side wall	Add for Hopper	Ded. for Obst.	Effective Depth	Add for Peak	Depth for Capac.	Bushels per Foot	Base Pack%	Bushel Capacity with Pack
					Length	Width									

Facility: Steele

Section: A

A	103	Square	work floor	0.000	15.20	11.60	46.00	0.00	0.00	46.000	0.000	46.0	141.7	6.80	6,961
A	104 T	Square	work floor	0.000	15.60	11.60	39.00	0.00	0.00	39.000	0.000	39.0	145.5	6.80	6,061
A	104B	Square	work floor T39'	0.000	11.00	11.60	7.500	0.00	0.00	7.500	0.000	7.5	102.6	6.00	816
A	105	Square	work floor	0.000	15.20	11.60	46.00	0.00	0.00	46.000	0.000	46.0	141.7	6.80	6,961
A	106 T	Square	work floor	0.000	15.60	11.60	39.00	0.00	0.00	39.000	0.000	39.0	145.5	6.80	6,061
A	106B	Square	work floor T39'	0.000	11.00	11.60	7.500	0.00	0.00	7.500	0.000	7.5	102.6	6.00	816
A	107	Square	work floor	0.000	15.20	9.100	46.00	0.00	0.00	46.000	0.000	46.0	111.2	6.20	5,432
A	108 T	Square	work floor	0.000	15.60	9.100	39.00	0.00	0.00	39.000	0.000	39.0	114.1	6.20	4,726
A	108B	Square	work floor T39'	0.000	11.00	9.100	7.500	0.00	0.00	7.500	0.000	7.5	80.5	5.50	637
A	201	Peaked	top of sidewall	36.000	0.000	0.000	60.00	0.00	0.00	60.000	2.200	62.2	818.2	10.0	55,981
A	202	Peaked	top of sidewall	36.000	0.000	0.000	60.00	0.00	0.00	60.000	2.200	62.2	818.2	10.0	55,981
A	203	Peaked	top of sidewall	42.000	0.000	0.000	37.00	0.00	0.00	37.000	2.500	39.5	1113.7	10.0	48,390
A	204	Peaked	top of sidewall	36.000	0.000	0.000	17.70	0.00	0.00	17.700	2.200	19.9	818.2	10.0	17,910
A	205	Peaked	top of sidewall	36.000	0.000	0.000	17.70	0.00	0.00	17.700	2.200	19.9	818.2	10.0	17,910
A	206	Peaked	top of sidewall	42.000	0.000	0.000	21.00	0.00	0.00	21.000	2.500	23.5	1113.7	10.0	28,789
A	207	Peaked	top of sidewall	42.000	0.000	0.000	21.00	0.00	0.00	21.000	2.500	23.5	1113.7	10.0	28,789
A	301	Flat	bottom of header plate	0.000	101.8	36.10	11.50	0.00	0.00	11.500	0.000	11.5	2954.2	10.0	37,370

Bin count: 38

Facility: Steele Section: A Total: 382,001To Even: 383,000

Overall Licensed Bin Capacity for:

Steele Farmers Elevator

Bin count: 38

Licensed Capacity:

(includes pack)

382,001 Bu.

Licensed Capacity (to even):

(includes pack and section totals are rounded up to next highest 1000)

383,000 Bu.
