

**STATE OF NORTH DAKOTA
PUBLIC SERVICE COMMISSION**

**Montana-Dakota Utilities Co. / Otter Tail Power Company
345 kV Transmission. Line – Dickey County
Siting Application**

Case No. PU-13-840

**NOTICE OF FILINGS AND NOTICE OF HEARING
February 12, 2014**

On October 21, 2013, Montana-Dakota Utilities Co., a Division of MDU Resources Group, Inc., and Otter Tail Power Company filed joint applications for a waiver of procedures and time schedules, a corridor certificate and a route permit to construct approximately 11 miles of 345 kV electric transmission line and associated facilities from a new Ellendale 345 kV substation to the South Dakota Border in Dickey County as shown on the attached map. This is the North Dakota portion of an Ellendale to Big Stone project.

Applicants request the Commission waive procedures and time schedules set forth in North Dakota Century Code chapter 49-22 and North Dakota Administrative Code article 69-06 to allow for a single consolidated application for corridor certificate and route permit and to hold a combined hearing on the waiver request and the applications for corridor certificate and route permit. The Commission finds the applications complete.

A Public Hearing is scheduled to begin April 1, 2014 at 9:30 a.m. at the Fireside Restaurant, 415 1st Ave N, Ellendale, North Dakota 58436. The issues to be considered in the joint application for waiver of procedures and time schedules are:

1. Are the proposed facilities of such length, design, location, or purpose that they will produce minimal adverse effects and that adherence to applicable procedures and time schedules may be waived?
2. Is it appropriate for the Commission to waive any procedures and time schedules as requested in the application?

The issues to be considered in the applications for certificate of corridor compatibility and route permit are:

1. Will the location, construction, and operation of the proposed facilities produce minimal adverse effects on the environment and upon the welfare of the citizens of North Dakota?
2. Are the proposed facilities compatible with the environmental preservation and the efficient use of resources?
3. Will the proposed facility locations minimize adverse human and environmental impact while ensuring continuing system reliability and integrity and ensuring that energy needs are met and fulfilled in an orderly and timely fashion?

For more information contact the Public Service Commission, State Capitol, Bismarck, North Dakota 58505, 701-328-2400; or Relay North Dakota, 1-800-366-6888 TTY. If you require any auxiliary aids or services, such as readers, signers, or Braille materials, please notify the Commission.

PUBLIC SERVICE COMMISSION

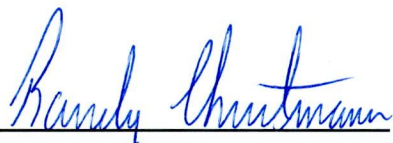
**Randy Christmann
Commissioner**



**Brian P. Kalk
Chairman**

**Julie Fedorchak
Commissioner**

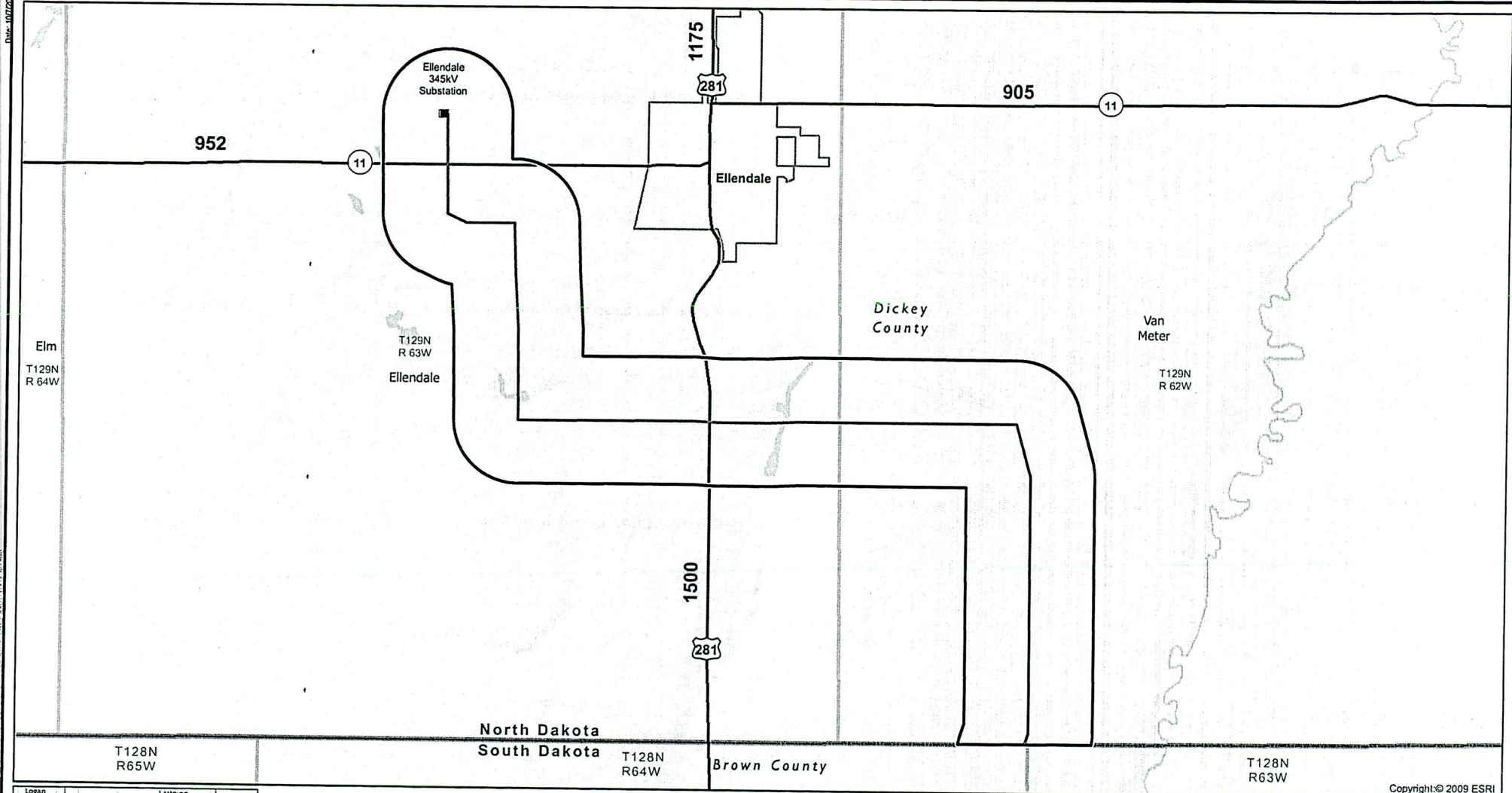
Dic-147261

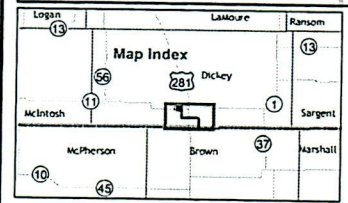

Copyright:© 2009 ESRI



Data Source: NDDOT 2012

- North Dakota Route
- ▭ North Dakota Corridor
- Project End Point
- Highway

AA DT (Average Annual Daily Traffic) - 1175

THE TRAFFIC FIGURES ARE THE TOTAL AT THE CLOSEST HIGHWAY INTERSECTION OR TOWN

Figure 5
 Average Annual Daily Traffic
 Big Stone South to Ellendale
 345 kV Transmission Line Project

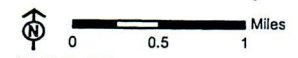

BSS+E
 Big Stone South to Ellendale

Scale 1:45,000