

STATE OF NORTH DAKOTA
PUBLIC SERVICE COMMISSION

Montana-Dakota Utilities Co. / Otter Tail Power Company
345 kV Transmission Line- Dickey County
Siting Application

Case No. PU-13-840

AFFIDAVIT OF SERVICE REGULAR AND ELECTRONIC MAIL

STATE OF NORTH DAKOTA
COUNTY OF BURLEIGH

Geralyn R. Schmaltz deposes and says that:

she is over the age of 18 years and not a party to this action and, on the **6th day of October, 2017**, she deposited in the United States Mail, Bismarck, North Dakota, **4** envelopes by first class mail, fully prepaid and **45** addressees electronically mailed a copy of:

- **Notice of Filing and Notice of Opportunity for Hearing**

The envelopes and electronic mails respectively were addressed as follows:

See attached list.

Each post office address shown is the respective addressee's last reasonably ascertainable post office address and each email address is the respective addressee's last reasonably ascertainable electronic mailing address.

Subscribed and sworn to before me
this **6th day of October, 2017**.

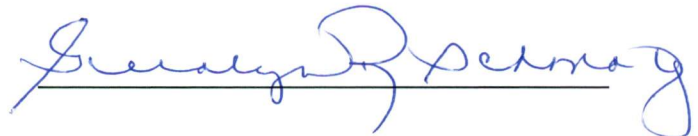

Notary Public

SEAL

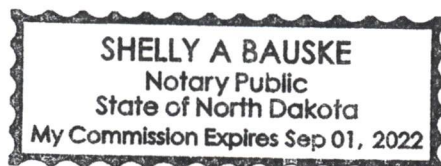

County Commission
Dickey County Courthouse
PO Box 215
Ellendale ND 58436

County Auditor
Dickey County Courthouse
PO Box 215
Ellendale ND 58436

Federal Aviation Administration
Bismarck Airports District Office, BIS-i
Bismarck ND 58504

City of Ellendale
Mayor
PO Box 267
Ellendale ND 58436

ndaero@nd.gov
Gaye Niemiller
Aeronautics Commission
PO Box 5020
Bismarck ND 58502-5020

masagsve@nd.gov
Matt Sagsveen
Attorney General's Office

dhseo@nd.gov
Department of Human Services

energyimpact@nd.gov
Energy Infrastructure and Impact Office

ppicha@nd.gov
Paul Picha
Historical Society

sjdavis@nd.gov
Scott Davis
Indian Affairs Commission
State Capitol - 1st Floor J Wing INSIDE
Bismarck ND 58505

jjhuibregtse@nd.gov
Jared Huibregste
N D Water Commission
900 E Boulevard
Bismarck ND 58505

jay.fuhrer@nd.usda.gov
Jay Fuhrer
NATURAL RESOURCE CONSERVATION SVC
PO BOX 1458
BISMARCK ND 58502-1458

ksonsalla@nd.gov
Kevin Sonsalla
ND Department of Commerce

jgisinger@nd.gov
Jennifer Gisinger
ND Dept. of Commerce

goehring@nd.gov
Doug Goehring
Agriculture Department
State Capitol
Bismarck ND 58505

todd.j.lindquist@usace.army.mil
Todd Lindquist
Corp of Engineers
PO Box 527
Riverdale ND 58565-0527

cte@nd.gov
Dept of Career and Technical Education
State Capitol
Bismarck ND 58505

governor@nd.gov
Doug Burgum
Governor's Office
State Capitol
Bismarck ND 58505

squinnell@nd.gov
Susan Quinnell
Historical Society

samuele.warren.1@us.af.mil
Sam Warren
Minot Air Force Base

gheiser@nd.gov
Gerald Heiser
N D Water Commission
900 E Boulevard
Bismarck ND 58505

ndascd@lincolnoakes.com
ND Assoc of Soil Conservation Dist
3310 University Drive
Bismarck ND 58504-7564

mdockter@nd.gov
Monte Dockter
ND Department of Transportation
State Highway Building
Bismarck ND 58505

Larry.kotchman@nds.u.edu
MR LARRY KOTCHMAN
ND FOREST SERVICE
MOLBERG CENTER 307 1ST STREET EAST
BOTTINEAU ND 58318

tsteinwa@nd.gov
Terry Steinwand
ND GAME & FISH DEPT
INSIDE MAIL

caboyd@nd.gov
Clint Boyd
ND Geological Survey

emurphy@nd.gov
MR ED MURPHY
ND GEOLOGICAL SURVEY

mkommer@nd.gov
Michelle Kommer
ND Job Service
P.O. Box 5507 INSIDE MAIL
Bismarck ND 58506-5507

labor@nd.gov
ND Labor Department

mhumann@nd.gov
Mike Humann
ND Land Department

jjkringstad@ndpipelines.com
ND Pipeline Authority

ndicino@nd.gov
North Dakota Industrial Commission

melissabaker@nd.gov
Melissa Baker
North Dakota Parks & Rec
1600 E Century Ave, Ste. 3 INSIDE MAIL
Bismarck ND 58503-0649

TylerHamman@lignite.com
Tyler Hamman
North Dakota Transmission Authority

gerbele@nd.gov
Garland Eberle
State Engineer
ND Water Commission

krockema@nd.gov
Karl Rockeman
State Health Department

pwax@nd.gov
Peter Wax
State Health Department

dglatt@nd.gov
Dave Glatt
State Health Department

kskroch@nd.gov
Kathy Skroch
State Representative
10105 155th Avenue SE
Lidgerwood ND 58053-9761

jmagrums@nd.gov
Jeffrey Magrum
State Representative
PO Box 467
Hazelton ND 58544-0467

mbrandenburg@nd.gov
MIKE BRANDENBURG
STATE REPRESENTATIVE
8044 COUNTY ROAD 34
EDGELEY ND 58433-9761

sertelt@nd.gov
Sebastian Ertelt
State Senator

jdotzenrod@nd.gov
JIM DOTZENROD
STATE SENATOR
507 5TH ST
WYNDMERE ND 58081-4217

rerbele@nd.gov
ROBERT S ERBELE
STATE SENATOR
6512 51ST AVE SE
LEHR ND 58460-9149

wendy ross@nps.gov
Wendy Ross
Theodore Roosevelt Nat'l Park
PO Box 7
Medora ND 58645

gjwiche@usgs.gov
District Chief
U S Geological Survey
821 E Interstate Ave
Bismarck ND 58501

managementauthority@fws.gov

US Fish & Wildlife Service
3425 Miriam Ave
Bismarck ND 58501

sschwenke@fs.fed.us
Sherri Schwenke
U S Forest Service
240 W Century Ave
Bismarck ND 58501-1494

cenwo-de@usace.army.mil
District Engineer
US Army Engineer District Omaha
1616 Capitol Ave
Omaha NE 68102

**STATE OF NORTH DAKOTA
PUBLIC SERVICE COMMISSION**

**Montana-Dakota Utilities Co. / Otter Tail Power Company
345 kV Transmission Line – Dickey County
Siting Application**

Case No. PU-13-840

NOTICE OF FILING AND NOTICE OF OPPORTUNITY FOR HEARING

October 4, 2017

On July 10, 2014, the Commission issued Corridor Certificate No. 154 and Route Permit No. 166 to Montana-Dakota Utilities Co., a Division of MDU Resources Group, Inc. and Otter Tail Power Company (Applicants) authorizing approximately 11 miles of 345 kV electric transmission line and associated facilities from a new Ellendale 345 kV substation to the South Dakota Border in Dickey County. This is the North Dakota portion of an Ellendale to Big Stone project.

On June 6, 2017 and September 6, 2017, Applicants filed consolidated applications for second amended corridor certificate and route permit, requesting minor corridor and route modifications from transmission line structures 29 to 32 in section 20 of Van Meter Township (T129N, R62W) in Dickey County, as shown on the attached map. The Commission finds the consolidated amendment applications complete. The issues to be considered in this matter are:

1. Will the location, construction, and operation of the proposed facilities produce minimal adverse effects on the environment and upon the welfare of the citizens of North Dakota?
2. Are the proposed facilities compatible with the environmental preservation and the efficient use of resources?
3. Will the proposed facility locations minimize adverse human and environmental impact while ensuring continuing system reliability and integrity and ensuring that energy needs are met and fulfilled in an orderly and timely fashion?

Those interested are invited to comment in writing. Persons desiring a hearing must file a written request identifying their interest in the proceedings and the reasons for requesting a hearing. **Comments and requests for hearing must be received by November 10, 2017.** If deemed appropriate, the Commission can determine the matter without a hearing.

For more information contact the Public Service Commission, State Capitol, Bismarck, North Dakota 58505, 701-328-2400; or Relay North Dakota, 1-800-366-6888 TTY. If you require any auxiliary aids or services, such as readers, signers, or Braille materials, please notify the Commission.

PUBLIC SERVICE COMMISSION



**Brian Kroshus
Commissioner**

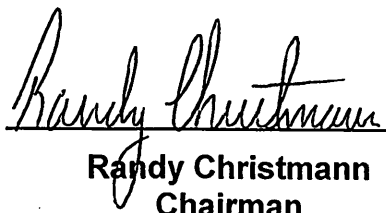

**Randy Christmann
Chairman**



**Julie Fedorchak
Commissioner**

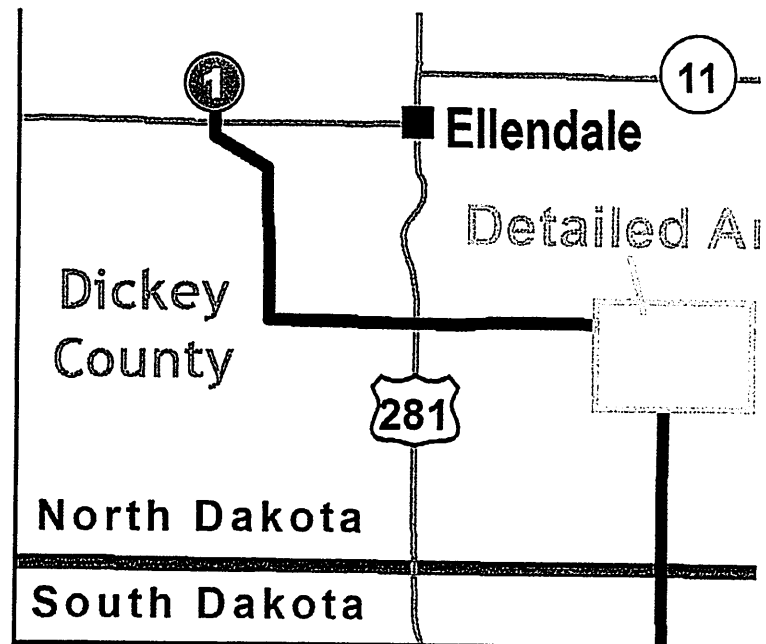
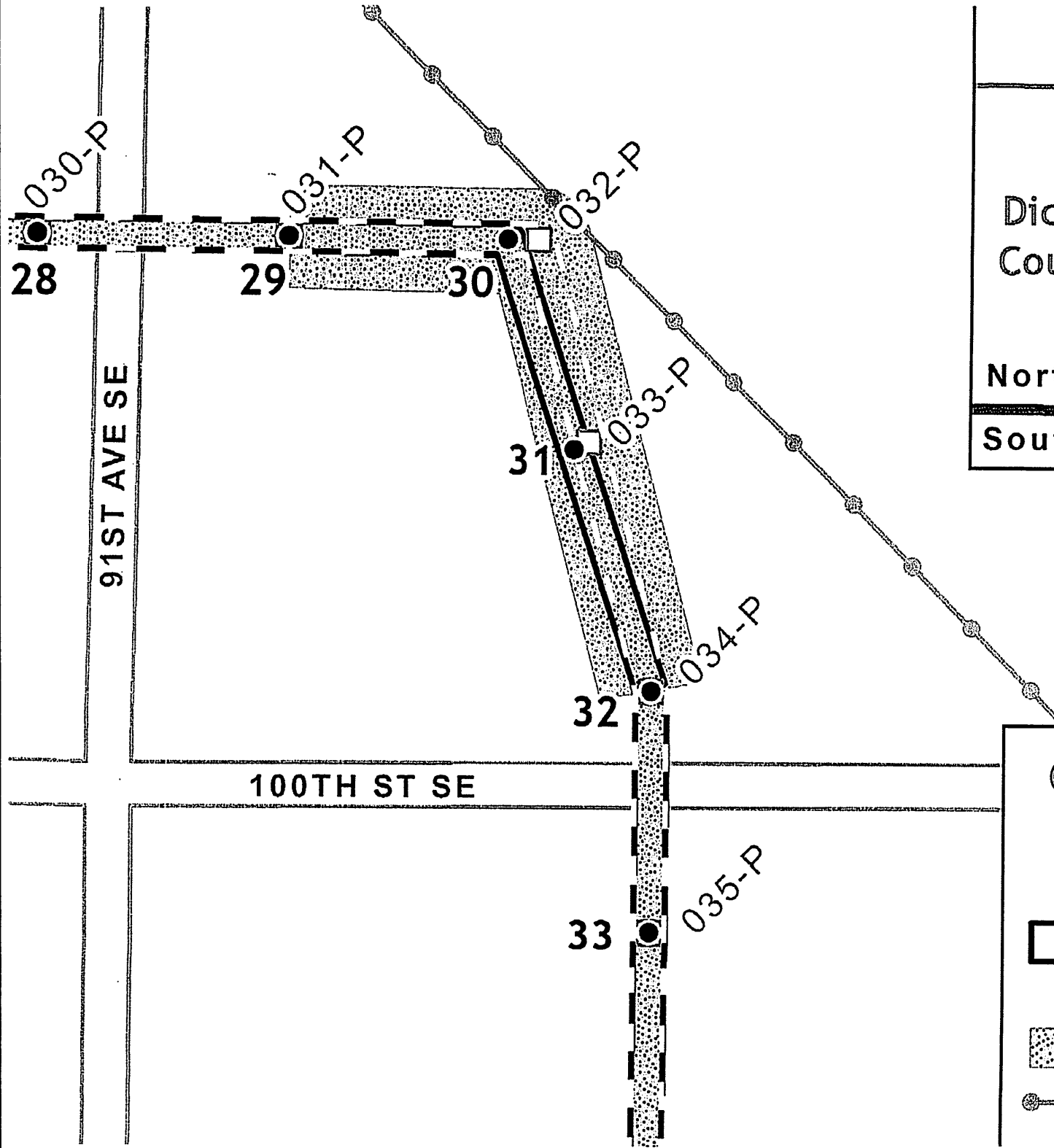

- ①** Ellendale 345kV Substation
- Facility Structures as of 2/3/2017
- Facility Structures as of 8/28/2011
- ▭ Facility ROW as of 2/3/2017
- ▨ Facility Corridor from 8/28/2011
- ▨ North Dakota Corridor
- ⊙ Existing Transmission Line