

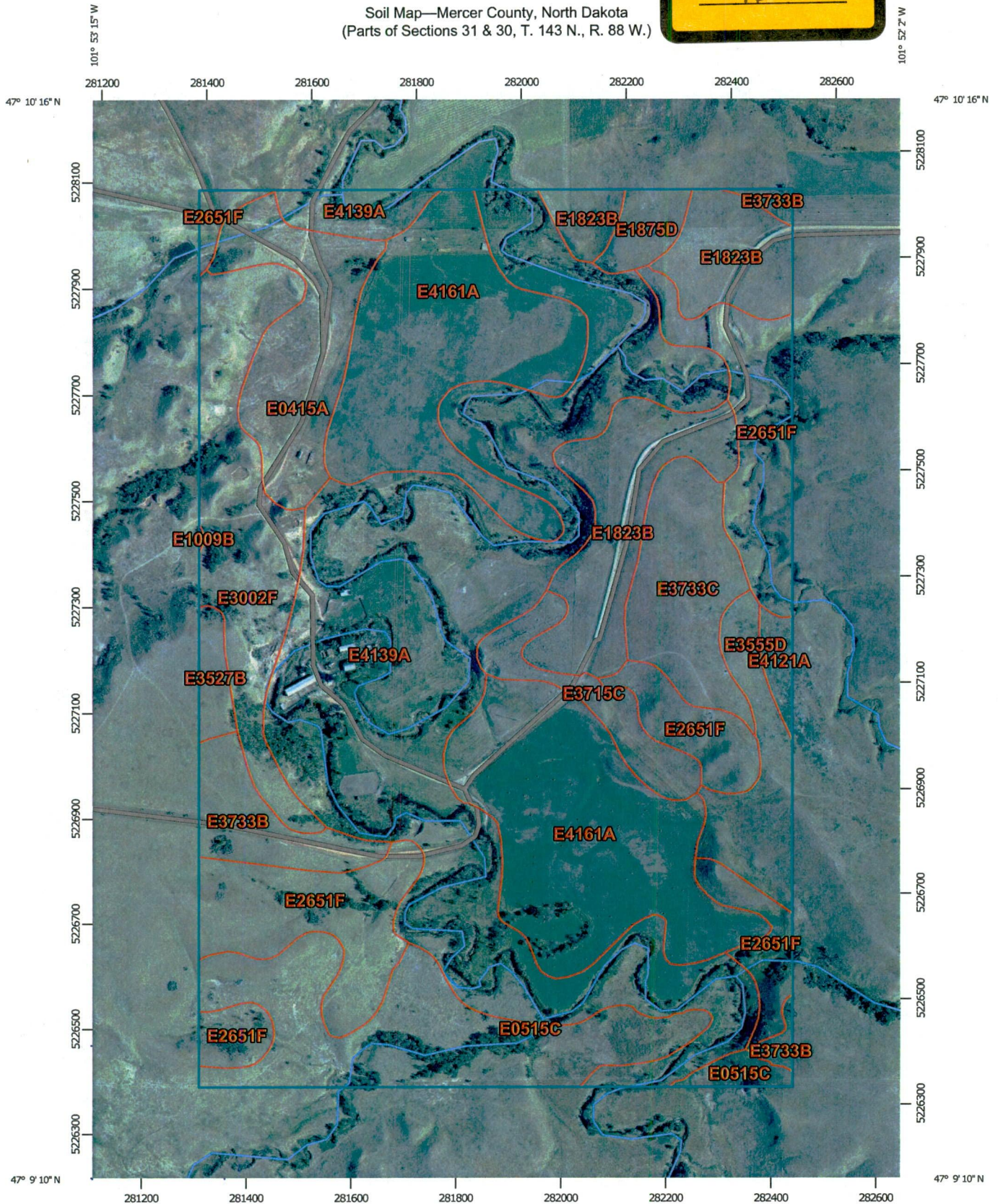

Soil Map—Mercer County, North Dakota
(Parts of Sections 31 & 30, T. 143 N., R. 88 W.)



Map Scale: 1:9,920 if printed on A portrait (8.5" x 11") sheet.
0 100 200 400 600 Meters
0 450 900 1800 2700 Feet
Map projection: Web Mercator Corner coordinates: WGS84 Edge tics: UTM Zone 14N WGS84

Soil Map—Mercer County, North Dakota
(Parts of Sections 31 & 30, T. 143 N., R. 88 W.)

MAP LEGEND

Area of Interest (AOI)

 Area of Interest (AOI)

Soils

 Soil Map Unit Polygons

 Soil Map Unit Lines

 Soil Map Unit Points

Special Point Features

 Blowout

 Borrow Pit

 Clay Spot

 Closed Depression

 Gravel Pit

 Gravelly Spot

 Landfill

 Lava Flow

 Marsh or swamp

 Mine or Quarry

 Miscellaneous Water

 Perennial Water

 Rock Outcrop

 Saline Spot

 Sandy Spot

 Severely Eroded Spot

 Sinkhole

 Slide or Slip

 Sodic Spot

 Spoil Area

 Stony Spot

 Very Stony Spot

 Wet Spot

 Other

 Special Line Features

Water Features

 Streams and Canals

Transportation

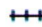
 Rails

 Interstate Highways

 US Routes

 Major Roads

 Local Roads

Background

 Aerial Photography

MAP INFORMATION

The soil surveys that comprise your AOI were mapped at 1:20,000.

Please rely on the bar scale on each map sheet for map measurements.

Source of Map: Natural Resources Conservation Service
Web Soil Survey URL: <http://websoilsurvey.nrcs.usda.gov>
Coordinate System: Web Mercator (EPSG:3857)

Maps from the Web Soil Survey are based on the Web Mercator projection, which preserves direction and shape but distorts distance and area. A projection that preserves area, such as the Albers equal-area conic projection, should be used if more accurate calculations of distance or area are required.

This product is generated from the USDA-NRCS certified data as of the version date(s) listed below.

Soil Survey Area: Mercer County, North Dakota
Survey Area Data: Version 21, Sep 19, 2014

Soil map units are labeled (as space allows) for map scales 1:50,000 or larger.

Date(s) aerial images were photographed: Aug 22, 2010—Sep 25, 2010

The orthophoto or other base map on which the soil lines were compiled and digitized probably differs from the background imagery displayed on these maps. As a result, some minor shifting of map unit boundaries may be evident.

Map Unit Legend

Mercer County, North Dakota (ND057)			
Map Unit Symbol	Map Unit Name	Acres in AOI	Percent of AOI
E0415A	Belfield-Daglum complex, 0 to 2 percent slopes	23.0	4.8%
E0515C	Rhoades-Daglum complex, 6 to 9 percent slopes	39.3	8.3%
E1009B	Moreau-Barkof silty clays, 3 to 6 percent slopes	0.1	0.0%
E1823B	Parshall fine sandy loam, 2 to 6 percent slopes	37.3	7.8%
E1875D	Telfer loamy fine sand, 6 to 15 percent slopes	4.6	1.0%
E2651F	Werner-Amor-Arnegard loams, 9 to 50 percent slopes	58.8	12.3%
E3002F	Ringling-Cabba complex, 9 to 35 percent slopes	30.9	6.5%
E3527B	Williams-Bowbells loams, 3 to 6 percent slopes	3.5	0.7%
E3555D	Zahl-Williams loams, 9 to 15 percent slopes	13.3	2.8%
E3715C	Flaxton-Livona fine sandy loams, 6 to 9 percent slopes	9.4	2.0%
E3733B	Flaxton-Williams complex, 3 to 6 percent slopes	12.9	2.7%
E3733C	Flaxton-Williams complex, 6 to 9 percent slopes	19.0	4.0%
E4121A	Havrelon loam, 0 to 2 percent slopes, occasionally flooded	2.6	0.5%
E4139A	Korchea-Fluvaquents complex, channeled, 0 to 2 percent slopes, frequently flooded	134.5	28.2%
E4161A	Straw loam, 0 to 2 percent slopes, rarely flooded	86.9	18.3%
Totals for Area of Interest		476.1	100.0%