

Jeffcoat-Sacco, Illona

From: no-reply@tylerhost.net
Sent: Friday, January 23, 2015 10:31 PM
To: Jeffcoat-Sacco, Illona
Subject: Notification of Service for Case No. 08-2014-CV-02349 (Capital Electric Cooperative, Inc. vs. North Dakota Public Service Commission, et al.)

This is a service filing for Case No. 08-2014-CV-02349, Capital Electric Cooperative, Inc. vs. North Dakota Public Service Commission, et al..

Date Submitted: 1/23/2015 10:30:25 PM

Filing Code: Exhibit

Filing Desc: Exhibit 2

The following are service contacts on this filing:

North Dakota Public Service Commission:

Ryan Norrell (rmnorrell@ndwaterlaw.com)

Illona Jeffcoat-Sacco (ijs@nd.gov)

Capital Electric Cooperative, Inc.:

Matthew Olson (molson@pringlend.com)

Montana-Dakota Utilities Co., a Division of MDU Resources Group, Inc.:

Paul Sanderson (psanderson@esattorneys.com)

Kelsey Krapp (kkrapp@esattorneys.com)

Daniel Kuntz (dan.kuntz@mduresources.com)

[Download Document](#)

If the link above is not accessible, copy this URL into your browser's address bar to view the document:

<http://northdakota.tylerhost.net/ViewServiceDocuments.aspx?SID=68cb1975-2650-4f1b-8e04-6305cf36ba0b&RID=49412cb2-6729-4357-8437-a9ee9e857bf1>

This message was automatically generated using Odyssey File & Serve; do not reply to this email.

For assistance, contact the North Dakota Court's Information Technology Department at 701.328.4218. Support is available 8 a.m. to 5 p.m. CT, Monday through Friday.

96 PU-13-871 Filed: 1/23/2015 Pages: 2
APPEAL – notification of service – Exhibit 2

Capital Electric Cooperative Inc.

McKenzie Electric Points

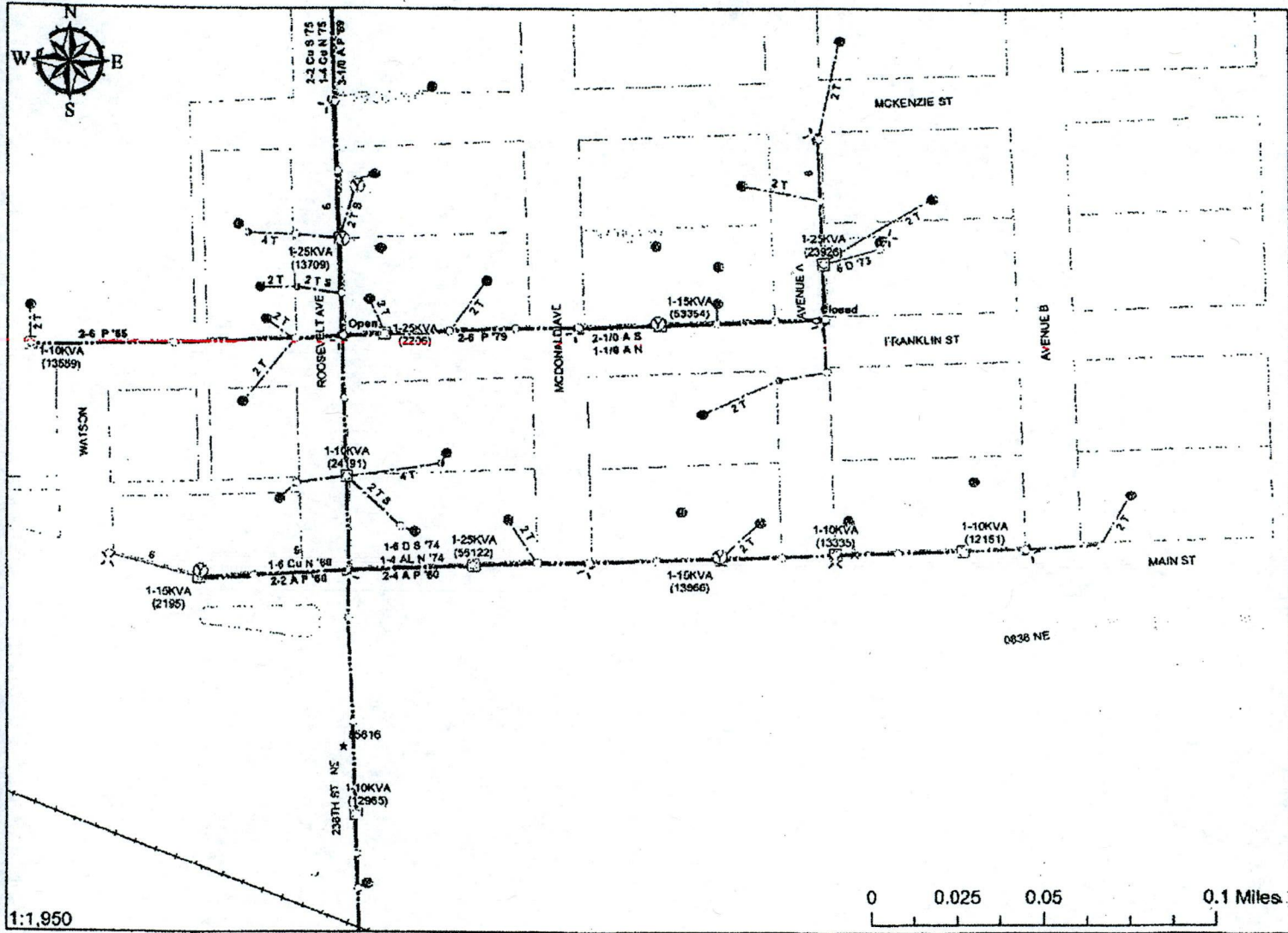

Electrical Assets

Electric Service Point

- Single Meter Service Point
29 Customers served within 2 mile radius

Primary Overhead Electric Line

- Neutral Only
- Single Phase Primary Overhead
- Two Phase Primary Overhead
- Three Phase Primary Overhead

Secondary Overhead Electric Line

- Single Phase Secondary Overhead
- Three Phase Secondary Overhead
- Single Phase Service Overhead
- Three Phase Service Overhead
- Overhead Streetlight Line
- OH Yard/Flood Light Line

1:1,950

0 0.025 0.05 0.1 Miles

21 PU-13-871 Filed: 5/15/2014 Page 1
Exhibit MDU-2

Montana-Dakota Utilities Co. a Division of MDU Resources Group Inc.

Filed - Clerk of District Court
1/23/2015 10:30:25 PM
Burleigh County, ND

Filed - Clerk of District Court
12/17/2014 4:18:36 PM