

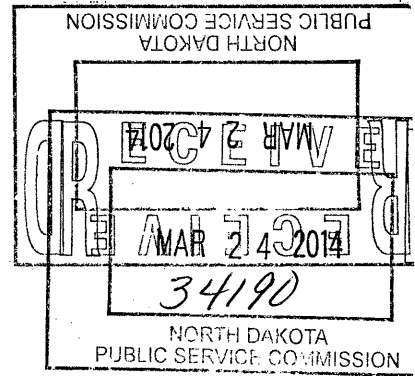

FALKIRK MINE

March 20, 2014



Mr. James R. Deutsch
Reclamation Director
ND State Public Service Commission
600 East Boulevard, Dept. 408
Bismarck, ND 58505

RE: Affidavit of Publication for Revision 24, Mid-Term Review, to Permit NAFK-9503

Dear Mr. Deutsch:

Please find enclosed copies of the Affidavit of Publication for Revision 24, Mid-Term Review, to Falkirk's Mining Permit NAFK-9503. The publication was published for four consecutive weeks in The McLean County Independent on January 23rd and 30th and February 6th and 13th and in The Bismarck Tribune on January 22nd and 29th and February 5th and 12th, 2014.

If you have any questions or comments, please contact me at 250-2434.

Sincerely,

THE FALKIRK MINING COMPANY

Diana Edinger
Administrative Assistant

DGE
Attachments

10 RC-13-893 Filed 03/24/2014 Pages: 21
Copies of affidavits of newspaper publication filed by the applicant
Falkirk Mining Company
Diana Edinger

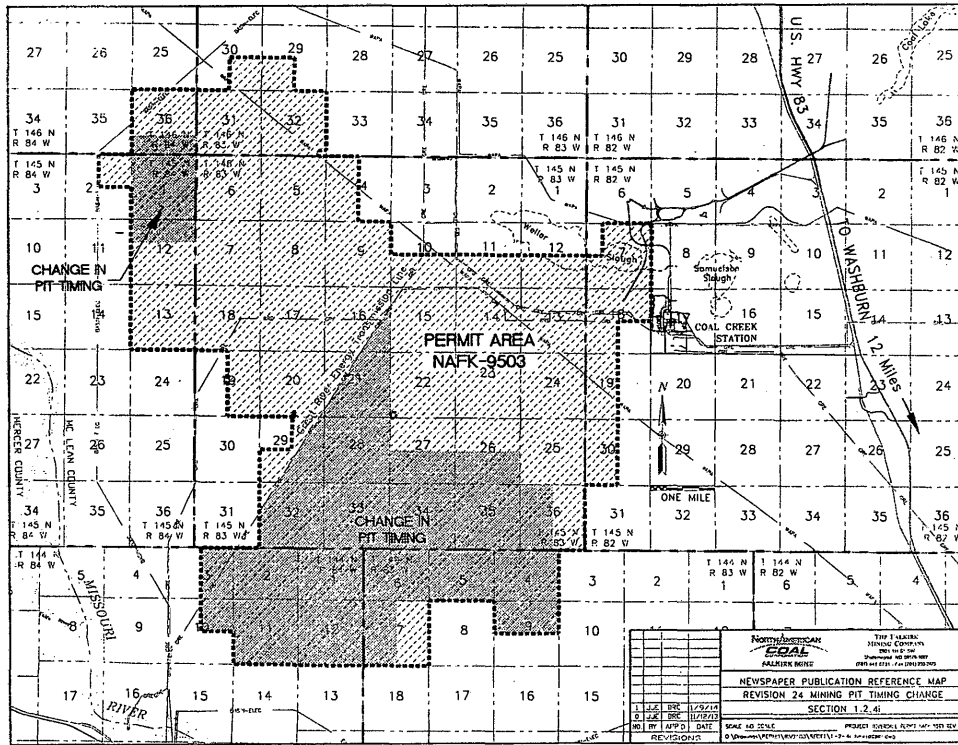

Notice of surface coal mining permit revisions

NOTICE OF FILING TO REVISE A PERMIT FOR SURFACE COAL MINING OPERATIONS

The Falkirk Mining Company, P.O. Box 1087, Underwood, ND 58576, has filed an application to revise surface coal mining activities in Permit NAFK-9503. The revision application contains detailed plans to revise the mine plan, post-mining topography, and reclamation schedule for the remaining unmined areas within the Permit. The revision also contains information to update the Permit in response to a mid-term review of sections pertaining to legal and financial, ground water hydrology, soils, operations, reclamation and monitoring plans, and Permit conditions. There are no changes being proposed to the post-mining land use. The revision also updates the surface water management plans and the transportation facilities. Falkirk and the following landowners have lands and/or coal on which the updated mining schedule is proposed as indicated by the labeled shaded areas on the accompanying reference map:

TRACT 23
 Township 145 North, Range 83 West
 Section 36: NW¼
 Surface Ownership:
 Coal Ownership:

The Falkirk Mining Company
 Carol J. Reinhiller and Thomas R. Reinhiller
 Joy M. Ochsner and Gary L. Ochsner
 Judith K. Simpenderfer and Jerome D. Simpenderfer
 Sylvia Thompson
 North Dakota Department of Trust Lands

TRACT 38
 Township 145 North, Range 83 West
 Section 26: SW¼
 Surface Ownership:
 Coal Ownership:

The Falkirk Mining Company
 Anne Carlsen Center for Children
 Home on the Range
 Dakota Boys Ranch of Minot
 Trinity Lutheran Church Foundation
 Birka Country Church
 First Lutheran Church
 Melvin A. Christenson Revocable Trust
 Darlene Roach

TRACT 39
 Township 145 North, Range 83 West
 Section 26: SE¼
 Surface Ownership:
 Coal Ownership:

The Falkirk Mining Company
 William Frederick Lindell and Patricia Lindell
 Rita McCreary and Edward McCreary

TRACT 40
Township 145 North, Range 83 West
Section 35: NE¼
Surface Ownership:
Coal Ownership:

The Falkirk Mining Company
The Falkirk Mining Company

TRACT 41
Township 145 North, Range 83 West
Section 35: W½NW¼
Surface Ownership:
Coal Ownership:

The Falkirk Mining Company
Anne Carlsen Center for Children
Home on the Range
Dakota Boys Ranch of Minot
Trinity Lutheran Church Foundation
Birka Country Church
First Lutheran Church
Melvin A. Christenson Revocable Trust
Darlene Roach

TRACT 42
Township 145 North, Range 83 West
Section 35: E½NW¼
Surface Ownership:
Coal Ownership:

The Falkirk Mining Company
Dean A. Swanson
Debra Nelson
Sandra Strinden
George Lynn Swanson

TRACT 43
Township 144 North, Range 83 West
Section 4: Lots 1, 2, 3, and 4, less the south 40 rods of Lots 1 and 2
Surface Ownership:
Coal Ownership:

The Falkirk Mining Company
Ernest E. Slagg, Life Estate
Remaindermen:
George L. Swanson and Val Rae Swanson
Adeline M. Slagg
Elda Ann Baisch
Marlys Slagg
Kevin Slagg
Wayne Slagg
Julie Slagg
Melanie Slagg Irwin
Donavan Slagg
Miles J. Slagg
Marsha F. Slagg
Carolyne S. Currier
Jerald Slagg
Connie Jo Hill
Val Rae Swanson

TRACT 44
Township 144 North, Range 83 West
Section 4: The south 40 rods of Lots 1 and 2
Surface Ownership:
Coal Ownership:

The Falkirk Mining Company
North Dakota Department of Trust Lands
Adeline M. Slagg
Elda Ann Baisch
Marlys Slagg
Kevin Slagg
Wayne Slagg
Julie Slagg
Melanie Slagg Irwin
Donavan Slagg
Miles J. Slagg
Marsha F. Slagg
Carolyne S. Currier
Jerald Slagg
Connie Jo Hill
Val Rae Swanson

TRACT 45
Township 144 North, Range 83 West
Section 4: SW¼
Surface Ownership:
Coal Ownership:

The Falkirk Mining Company
Gertrude E. Burck
Cleo Kersey
Kitty Tweeten

TRACT 46
Township 144 North, Range 83 West
Section 4: SE $\frac{1}{4}$
Surface Ownership:
Coal Ownership:

The Falkirk Mining Company
North Dakota Department of Trust Lands
Elda Ann Baisch
Carolyne S. Currier
Melanie Slagg Irwin
Donavan Slagg
Miles J. Slagg
Marsha F. Slagg
Jerald A. Slagg
Connie Jo Hill
Val Rae Swanson
Adeline M. Slagg
Marlys Slagg
Kevin Slagg
Wayne Slagg
Julie Slagg

TRACT 47
Township 144 North, Range 83 West
Section 5: Lots 3 and 4
Surface Ownership:
Coal Ownership:

Milton L. Holznagel Revocable Trust
Milton L. Holznagel Revocable Trust

TRACT 48
Township 144 North, Range 83 West
Section 5: Lots 1 and 2
Surface Ownership:

Coal Ownership:

Roger Peterson, Life Estate
Remaindermen:
Neal Peterson
Cheryl Gillespie
Roger Peterson, Life Estate
Remaindermen:
Neal Peterson
Cheryl Gillespie

TRACT 49
Township 144 North, Range 83 West
Section 5: SW $\frac{1}{4}$, less an 8 ac. tract in the SE $\frac{1}{4}$ SW $\frac{1}{4}$
Surface Ownership:
Coal Ownership:

Milton L. Holznagel Revocable Trust Dated 1-9-95
Milton L. Holznagel Revocable Trust Dated 1-9-95

TRACT 50
Township 144 North, Range 83 West
Section 5: An 8 ac. tract in the SE $\frac{1}{4}$ SW $\frac{1}{4}$
Surface Ownership:
Coal Ownership:

The Falkirk Mining Company
The Falkirk Mining Company

TRACT 51
Township 144 North, Range 83 West
Section 5: SE $\frac{1}{4}$
Surface Ownership:

Coal Ownership:

Roger Peterson, Life Estate
Remaindermen:
Neal Peterson
Cheryl Gillespie
Roger Peterson, Life Estate
Remaindermen:
Neal Peterson
Cheryl Gillespie

TRACT 52
Township 144 North, Range 83 West
Section 9: NW¼
Surface Ownership:
Coal Ownership:

The Falkirk Mining Company
Marlys D. Allen and Lisa E. Allen
April Azar
Jana J. Azar
WLK Resources, LLC
Fred S. Wright, Jr.
Nancy Elizabeth Brooks
Mary Evelyn King
Dana Denise Wright
Major David L. Wright
Thomas Russell Wright, Jr.
Fred S. Wright, Jr., Trustee of the
Fred S. Wright, Jr. Trust
Plains Exploration & Production Company
Henry Lerman
Irving Lerner
Linda Petroleum Co.
Williston Projects, Inc.
Cotton 4 Mineral Trust
Cotton 6 Mineral Trust
George E. Moss, Jr.
John K. Moss
Myra Ellen Moss
Murex Petroleum Corporation
Frank Jeppi Bi-Pass Trust
J & L Hauptman Family Partnership
Philip Mandel
Louis Dorfman
Myron H. Dorfman
Singer Bros.
S&P Co., a Louisiana partnership
Fleischaker Mineral Company, LLC
Teton Properties, LLC
S D Resources, Ltd.
A.G.S. Limited Partnership
Eculirra Oil & Gas, L.L.C.

TRACT 53
Township 144 North, Range 83 West
Section 9: NE¼
Surface Ownership:
Coal Ownership:

The Falkirk Mining Company
North Dakota Department of Trust Lands
April Azar
Jana J. Azar
WLK Resources, LLC
Fred S. Wright, Jr.
Nancy Elizabeth Brooks
Mary Evelyn King
Dana Denise Wright
Major David L. Wright
Thomas Russell Wright, Jr.
Fred S. Wright, Jr., Trustee of the
Fred S. Wright, Jr. Trust
Plains Exploration & Production Company
Henry Lerman
Irving Lerner
Linda Petroleum Co.
Williston Projects, Inc.
Cotton 4 Mineral Trust
Cotton 6 Mineral Trust
George E. Moss, Jr.
John K. Moss
Myra Ellen Moss
Murex Petroleum Corporation
Frank Jeppi Bi-Pass Trust
J & L Hauptman Family Partnership
Philip Mandel
Louis Dorfman
Myron H. Dorfman
Singer Bros.
S&P Co., a Louisiana partnership
Fleischaker Mineral Company, LLC
Teton Properties, LLC
S D Resources, Ltd.
A.G.S. Limited Partnership
Eculirra Oil & Gas, L.L.C.

TRACT 62
Township 145 North, Range 83 West
Section 21: SE $\frac{1}{4}$
Surface Ownership:
Coal Ownership:

The Falkirk Mining Company
The Falkirk Mining Company

TRACT 69
Township 145 North, Range 83 West
Section 28: N $\frac{1}{2}$ NW $\frac{1}{4}$, W $\frac{1}{2}$ NE $\frac{1}{4}$
Surface Ownership:
Coal Ownership:

The Falkirk Mining Company
Erma Carlson
Marva D. Finck
Karen J. Carlson

TRACT 70
Township 145 North, Range 83 West
Section 28: E $\frac{1}{2}$ NE $\frac{1}{4}$
Surface Ownership:
Coal Ownership:

The Falkirk Mining Company
Marva Deane Finck

TRACT 71
Township 145 North, Range 83 West
Section 28: SW $\frac{1}{4}$, S $\frac{1}{2}$ NW $\frac{1}{4}$
Surface Ownership:
Coal Ownership:

Eileen C. Zander
Eileen C. Zander
Barbara J. Hoffer

TRACT 72
Township 145 North, Range 83 West
Section 28: SE $\frac{1}{4}$
Surface Ownership:
Coal Ownership:

Dwight D. Gradin and Denise Gradin
Dwight D. Gradin and Denise Gradin
Miles W. Gradin
Wallyn K. Lee
Mark E. Gradin, as Trustee of the Mark E. Gradin
Revocable Trust
Kyle E. Gradin
Timothy L. Johannes and Tammy S. Johannes
Tanya I. Johannes and Steven E. Miller

TRACT 75
Township 145 North, Range 83 West
Section 27: SW $\frac{1}{4}$
Surface Ownership:
Coal Ownership:

The Falkirk Mining Company
Janice E. Hanson
Bonnie J. Kuntz

TRACT 76
Township 145 North, Range 83 West
Section 27: SE $\frac{1}{4}$
Surface Ownership:
Coal Ownership:

The Falkirk Mining Company
Janice E. Hanson
Bonnie J. Kuntz

TRACT 77
Township 145 North, Range 83 West
Section 33: NW $\frac{1}{4}$
Surface Ownership:
Coal Ownership:

Dwight D. Gradin and Denise Gradin
Dwight D. Gradin and Denise Gradin
Miles W. Gradin
Wallyn K. Lee
Mark E. Gradin, as Trustee of the Mark E. Gradin
Revocable Trust
Kyle E. Gradin
Timothy L. Johannes and Tammy S. Johannes
Tanya I. Johannes and Steven E. Miller

TRACT 78
Township 145 North, Range 83 West
Section 33: NE $\frac{1}{4}$
Surface Ownership:
Coal Ownership:

Dwight D. Gradin and Denise Gradin
Dwight D. Gradin and Denise Gradin
Miles W. Gradin
Wallyn K. Lee
Mark E. Gradin, as Trustee of the Mark E. Gradin
Revocable Trust
Kyle E. Gradin
Timothy L. Johannes and Tammy S. Johannes
Tanya I. Johannes and Steven E. Miller

TRACT 79
Township 145 North, Range 83 West
Section 34: NW¼
Surface Ownership:
Coal Ownership:

Neal Peterson and Beverly Peterson
Sharyn M. Calton and Scott Calton

TRACT 80
Township 145 North, Range 83 West
Section 34: North 100 ac. of the NE¼
Surface Ownership:
Coal Ownership:

The Falkirk Mining Company
Anne Carlsen Center for Children
Home on the Range
Dakota Boys Ranch of Minot
Trinity Lutheran Church Foundation
Birka Country Church
First Lutheran Church
Melvin A. Christenson Revocable Trust
Darlene Roach

TRACT 81
Township 145 North, Range 83 West
Section 34: South 60 ac. of the NE¼
Surface Ownership:
Coal Ownership:

The Falkirk Mining Company
Anne Carlsen Center for Children
Home on the Range
Dakota Boys Ranch of Minot
Trinity Lutheran Church Foundation
Birka Country Church
First Lutheran Church
Melvin A. Christenson Revocable Trust
Darlene Roach

TRACT 82
Township 145 North, Range 83 West
Section 34: SW¼
Surface Ownership:

Mildred Leidholm, as Trustee of the
Lloyd Leidholm Testamentary Trust
Roy B. Leidholm and Eva Leidholm, Life Estate
Remaindermen:
Brian Leidholm
Cordell Leidholm
Glynda Janz
Karen Perkerewicz
Dean Leidholm
Tammy Novak
Sharon Rivers
Dwayne Leidholm
Mildred Jahner and Valentine Jahner, Life Estate
Remaindermen:
Curtis Jahner
Brent Jahner

Coal Ownership:

Mildred Leidholm, as Trustee of the
Lloyd Leidholm Testamentary Trust
Roy B. Leidholm and Eva Leidholm, Life Estate
Remaindermen:
Brian Leidholm
Cordell Leidholm
Glynda Janz
Karen Perkerewicz
Dean Leidholm
Tammy Novak
Sharon Rivers
Dwayne Leidholm
Mildred Jahner and Valentine Jahner, Life Estate
Remaindermen:
Curtis Jahner
Brent Jahner

TRACT 83
Township 145 North, Range 83 West
Section 34: SE¼
Surface Ownership:
Coal Ownership:

The Falkirk Mining Company
James Peterson
Dennis L. Peterson
Duaine J. Peterson
Jane Schulz
Susan Krebsbach
North Dakota Department of Trust Lands

TRACT 84
Township 145 North, Range 83 West
Section 35: SW¼
Surface Ownership:
Coal Ownership:

The Falkirk Mining Company
William F. Lindell and Patricia Lindell
Robert L. Erickson and Susan F. Lawrence

TRACT 85
Township 145 North, Range 83 West
Section 35: SE¼
Surface Ownership:
Coal Ownership:

The Falkirk Mining Company
Barbara J. Hoffer
Eileen C. Zander
Alma Nelson
Arvin Swanson
Marcia Steinwand
Rodney Swanson
Sheryl Willits

TRACT 86
Township 145 North, Range 83 West
Section 36: SW¼
Surface Ownership:
Coal Ownership:

The Falkirk Mining Company
James Peterson
Dennis L. Peterson
Duaine J. Peterson
Jane Schulz
Susan Krebsbach
North Dakota Department of Trust Lands

TRACT 88
Township 144 North, Range 83 West
Section 6: Gov't Lots 1, 2, N½SE¼
Surface Ownership:
Coal Ownership:

Dean A. Swanson and Sandra Lynn Swanson
The Estate of Iona Jean Vujovich

TRACT 89
Township 144 North, Range 83 West
Section 6: Gov't Lots 3, 4, and 5, NE¼SW¼
Surface Ownership:

Mildred Leidholm, as Trustee of the
Lloyd Leidholm Testamentary Trust
Roy B. Leidholm and Eva Leidholm, Life Estate
Remaindermen:
Brian Leidholm
Cordell Leidholm
Glynda Janz
Karen Perkerewicz
Dean Leidholm
Tammy Novak
Sharon Rivers
Dwayne Leidholm
Mildred Jahner and Valentine Jahner, Life Estate
Remaindermen:

Coal Ownership:

Curtis Jahner
Brent Jahner
Mildred Leidholm, as Trustee of the
Lloyd Leidholm Testamentary Trust
Roy B. Leidholm and Eva Leidholm, Life Estate
Remaindermen:
Brian Leidholm
Cordell Leidholm
Glynda Janz
Karen Perkerewicz
Dean Leidholm
Tammy Novak
Sharon Rivers
Dwayne Leidholm
Mildred Jahner and Valentine Jahner, Life Estate
Remaindermen:
Curtis Jahner
Brent Jahner

TRACT 90
Township 144 North, Range 83 West
Section 6: Gov't Lot 6, SE¼SW¼, S½SE¼
Surface Ownership:
Coal Ownership:

Stephen P. Swanson
United States of America – Bureau of
Land Management

TRACT 92
Township 144 North, Range 83 West
Section 7: Gov't Lot 1, E $\frac{1}{2}$ NW $\frac{1}{4}$
Surface Ownership:
Coal Ownership:

Glenda G. Scholl
Glenda G. Scholl
Jenene M. Kittleson
Marian Gullickson

TRACT 93
Township 144 North, Range 83 West
Section 7: Gov't Lot 2
Surface Ownership:
Coal Ownership:

Glenda G. Scholl
Glenda G. Scholl
Jenene M. Kittleson and Michael A. Kittleson
Marian Gullickson and Dwaine Gullickson

TRACT 95
Township 144 North, Range 83 West
Section 7: Gov't Lots 3, 4, E $\frac{1}{2}$ SW $\frac{1}{4}$
Surface Ownership:
Coal Ownership:

Glenda G. Scholl
Glenda G. Scholl

TRACT 96
Township 144 North, Range 84 West
Section 1: Gov't Lots 1, 2, 3, and 4
Surface Ownership:
Coal Ownership:

Michael M. Thyberg
Michael M. Thyberg

TRACT 97
Township 144 North, Range 84 West
Section 1: SE $\frac{1}{4}$
Surface Ownership:
Coal Ownership:

Carol Sauer
Carol Sauer
Lavern I. Johnson
North Dakota Department of Trust Lands

TRACT 98
Township 144 North, Range 84 West
Section 1: SW $\frac{1}{4}$
Surface Ownership:
Coal Ownership:

Dean A. Swanson
Dean A. Swanson
Stephen P. Swanson

TRACT 99
Township 144 North, Range 84 West
Section 2: Gov't Lots 1, 2, less 5.51 acres in Lot 2
Surface Ownership:

Mark Swanson and Pamela L. Hopkins
Stephen P. Swanson
United States of America – Bureau of
Land Management

Coal Ownership:

TRACT 100
Township 144 North, Range 84 West
Section 2: 5.51 acres in Gov't Lot 2, described as follows: Beginning at the Northeast corner of said Lot 2, T144N-R84W, thence South 400', thence West 600'; thence North 400'; thence East 600' to the point of beginning

Surface Ownership:
Coal Ownership:

Stephen P. Swanson
United States of America – Bureau of
Land Management

TRACT 101
Township 144 North, Range 84 West
Section 2: Gov't Lots 3 and 4
Surface Ownership:
Coal Ownership:

Stephen P. Swanson
United States of America – Bureau of
Land Management

TRACT 102
Township 144 North, Range 84 West
Section 2: SE $\frac{1}{4}$, SW $\frac{1}{4}$
Surface Ownership:
Coal Ownership:

Forrest W. Ecklund and Alyce F. Ecklund
Forrest W. Ecklund and Alyce F. Ecklund

TRACT 103
Township 144 North, Range 84 West
Section 3: Gov't Lots 1, 2, SE $\frac{1}{4}$
Surface Ownership:
Coal Ownership:

Forrest W. Ecklund and Alyce F. Ecklund
Forrest W. Ecklund and Alyce F. Ecklund

TRACT 104
Township 144 North, Range 84 West
Section 10: NE¼
Surface Ownership:
Coal Ownership:

Miller Brothers Ranch, L.L.L.P.
Doretta Dene Clark
Margo Jean Vranna
Shirley Seher
Roger Clements Clark
Velma Cleveland
Scott Lang and Kay Lang
Lamoure Besse and Patricia Besse
Scott Schmidt and Casey Schmidt

TRACT 105
Township 144 North, Range 84 West
Section 11: NE¼, SE¼
Surface Ownership:
Coal Ownership:

Miller Brothers Ranch, L.L.L.P.
Doretta Dene Clark
Margo Jean Vranna
Shirley Seher
Roger Clements Clark
Velma Cleveland
Scott Lang and Kay Lang
Lamoure Besse and Patricia Besse
Scott Schmidt and Casey Schmidt

TRACT 106
Township 144 North, Range 84 West
Section 11: NW¼
Surface Ownership:
Coal Ownership:

Miller Brothers Ranch, L.L.L.P.
Doretta Dene Clark
Margo Jean Vranna
Shirley Seher
Roger Clements Clark
Velma Cleveland
Scott Lang and Kay Lang
Lamoure Besse and Patricia Besse
Scott Schmidt and Casey Schmidt

TRACT 107
Township 144 North, Range 84 West
Section 11: SW¼
Surface Ownership:
Coal Ownership:

Miller Brothers Ranch, L.L.L.P.
Doretta Dene Clark
Margo Jean Vranna
Shirley Seher
Roger Clements Clark
Velma Cleveland
Scott Lang and Kay Lang
Lamoure Besse and Patricia Besse
Scott Schmidt and Casey Schmidt

TRACT 108
Township 144 North, Range 84 West
Section 12: N½NE¼
Surface Ownership:
Coal Ownership:

Glenda G. Scholl
Jenene M. Kittleson and Michael A. Kittleson

TRACT 109
Township 144 North, Range 84 West
Section 12: S½NE¼
Surface Ownership:
Coal Ownership:

Kay M. Hegvik
Marian Gullickson and Dwaine Gullickson
George L. Swanson and Val Rae Swanson
Dean A. Swanson and Sandy L. Swanson

TRACT 110
Township 144 North, Range 84 West
Section 12: NW¼
Surface Ownership:
Coal Ownership:

Harley J. Scholl
United States of America – Bureau of
Land Management

TRACT 111
Township 144 North, Range 84 West
Section 12: SE¼
Surface Ownership:
Coal Ownership:

Glenda G. Scholl
Glenda G. Scholl
George Scholl
Marian Gullickson
Jenene Kittleson

TRACT 112
Township 144 North, Range 84 West
Section 12: SW¼
Surface Ownership:
Coal Ownership:

Roger Peterson
Roger Peterson

TRACT 132
Township 145 North, Range 83 West
Section 16: NE¼
Surface Ownership:
Coal Ownership:

The Falkirk Mining Company
Pauline M. Rosberg
The Denver G. Rosberg Credit Trust
North Dakota Department of Trust Lands

TRACT 134
Township 145 North, Range 83 West
Section 16: N½SE¼
Surface Ownership:
Coal Ownership:

The Falkirk Mining Company
Pennington Living Trust Dated 4-28-99
North Dakota Department of Trust Lands

TRACT 135
Township 145 North, Range 83 West
Section 16: S½SE¼
Surface Ownership:
Coal Ownership:

The Falkirk Mining Company
Pauline M. Rosberg
The Denver G. Rosberg Credit Trust
North Dakota Department of Trust Lands

TRACT 143
Township 145 North, Range 83 West
Section 21: N½, SW¼, less 0.49 ac. in the NW¼
Surface Ownership:
Coal Ownership:

The Falkirk Mining Company
Pauline M. Rosberg
The Denver G. Rosberg Credit Trust
Robert C. Mann
Audrey M. Crum
Margaret E. Tollerud

TRACT 145
Township 145 North, Range 83 West
Section 29: NE¼
Surface Ownership:
Coal Ownership:

Mary Jane Miller
Mary Jane Miller
Nancy J. Bridges and Jennifer Anne Barber,
Co-Trustees or the Successor Trustee of The
Nancy J. Bridges Trust Dated November 15, 2011

TRACT 146
Township 145 North, Range 83 West
Section 29: S½
Surface Ownership:

Coal Ownership:

Robert C. Mann
Audrey M. Crum
Margaret E. Tollerud
Robert C. Mann
Audrey M. Crum
Margaret E. Tollerud
Leslie Peterson
Barbara Peterson

TRACT 147
Township 145 North, Range 83 West
Section 32: NE¼
Surface Ownership:
Coal Ownership:

Barbara J. Hoffer
Barbara J. Hoffer
Eileen C. Zander

TRACT 148
Township 145 North, Range 83 West
Section 32: NW¼
Surface Ownership:

Coal Ownership:

Robert C. Mann
Audrey M. Crum
Margaret E. Tollerud
The Stewart E. Bowers and Joyce W. Bowers
1989 Inter Vivos Trust Dated 6-23-89
Robert C. Mann
Audrey M. Crum
Margaret E. Tollerud
Mueller Industries, Inc.
Mary C. Henderson

TRACT 149
Township 145 North, Range 83 West
Section 32: SE¼
Surface Ownership:
Coal Ownership:

Michael M. Thyberg
Michael M. Thyberg

TRACT 150
Township 145 North, Range 83 West
Section 32: SW¼
Surface Ownership:
Coal Ownership:

Michael M. Thyberg
United States of America – Bureau of
Land Management

TRACT 151
Township 145 North, Range 83 West
Section 33: SE¼, SW¼
Surface Ownership:
Coal Ownership:

Dwight D. Gradin and Denise Gradin
Dwight D. Gradin and Denise Gradin
Miles W. Gradin
Wallyn K. Lee
Mark E. Gradin, as Trustee of the Mark E. Gradin
Revocable Trust
Kyle E. Gradin
Timothy L. Johannes and Tammy S. Johannes
Tanya L. Johannes and Steven E. Miller

TRACT 152
Township 145 North, Range 84 West
Section 1: Gov't Lots 1, 2, 3, 4, S½N½, SE¼
Surface Ownership:
Coal Ownership:

The Falkirk Mining Company
William Frederick Lindell and Patricia L. Lindell
Rita McCreary

TRACT 153
Township 145 North, Range 84 West
Section 1: SW¼
Surface Ownership:
Coal Ownership:

The Falkirk Mining Company
Beth Bruestle
Kent Swanson
Timothy Bruestle
Ryan Bruestle
Erika Bruestle

TRACT 155
Township 145 North, Range 84 West
Section 12: E½NE¼, SW¼NE¼, NE¼SE¼
Surface Ownership:
Coal Ownership:

The Falkirk Mining Company
Beth Bruestle
Kent Swanson
Timothy Bruestle
Ryan Bruestle
Erika Bruestle
United States of America

TRACT 156
Township 145 North, Range 84 West
Section 12: E½NW¼, NE¼SW¼, NW¼NE¼
Surface Ownership:
Coal Ownership:

The Falkirk Mining Company
Beth Bruestle
Kent Swanson
Timothy Bruestle
Ryan Bruestle
Erika Bruestle

TRACT 157
Township 145 North, Range 84 West
Section 12: W½W½, SE¼SW¼, S½SE½
Surface Ownership:
Coal Ownership:

The Falkirk Mining Company
United States of America – Bureau of
Land Management

TRACT 174
Township 146 North, Range 84 West
Section 36: S½SE¼
Surface Ownership:
Coal Ownership:

Donald D. Landenberger and Karen S. Landenberger
Donald D. Landenberger
Velma Schacher
Leila Landenberger
Gary Landenberger
Kathy Landenberger Kesselring
Diane Nelson
North Dakota Department of Trust Lands

TRACT 175A
Township 146 North, Range 84 West
Section 36: SW¼
Surface Ownership:
Coal Ownership:

The Falkirk Mining Company
David J. LeRoy and Dorothy M. LeRoy
North Dakota Department of Trust Lands

Copies of the application for revision of a surface coal mining permit are available for public inspection at the offices of the North Dakota Public Service Commission, 600 East Boulevard Ave., Bismarck, ND 58505-0480 and at the office of the County Auditor, McLean County Courthouse, Washburn, ND 58577.

Written comments, objections, or requests for informal conferences on the application may be submitted by any person with an interest which is or may be adversely affected to the North Dakota Public Service Commission, 600 East Boulevard Ave, Bismarck, ND 58505-0480 within 30 days after the last publication of this notice.

(Jan. 23, 30, Feb. 6, 13, 2014)



Classified Advertising Invoice

Bismarck Tribune
 PO BOX 4001
 LaCrosse, WI 54602-4001
 In State 701-250-8218
 Toll free 800-472-2273

THE FALKIRK MINING COMPANY

2801 1ST ST SW
 PO BOX 1087
 UNDERWOOD ND 58576

Customer: **60018525**
 Phone: **(701) 250-2472**
 Date: **02/12/2014**

Date	Order #	Type	Order Amt
02/12/14	20701331	INV	9,780.00

Amount Paid: _____ CK #: _____

CashAmt

CREDIT CARD PAYMENT (circle one)



Card #: _____
 Exp Date: _____
 Signature: _____
 Credit card users: Fax to 608-791-8212

PLEASE DETACH AND RETURN TOP PORTION WITH YOUR PAYMENT

Lec Enterprises no longer accepts credit card payments sent via e-mail. Emails containing credit card numbers will be blocked. Please use the coupon above to send a credit card payment to remittance address located in the upper right corner. You may also send the coupon to a secure fax at 608-791-8212.

Date	Date	Times Run	Description	Lines	Class Code	Order Amt	Net Amt Due
			PO48424 / Permit NAFK-9503	200.00	Legals	9,780.00	9,780.00
01/22/14	02/12/14	4	Bismarck Tribune				

ck
 Bismarck Tribune
 1/22, 29, 2/5, 12
 February
 Morgan
 Call
 Oliver-Kuntz
 20th

Material Received by legals
 Date 2/22/14
 Approved for Payment DRear

MORGAN DOLL
 Notary Public
 State of North Dakota
 My Commission Expires Jan. 26, 2017

Please return invoice or put order number on check. Thank You.

Remarks	Total Due: 9,780.00
---------	---------------------

Bismarck Tribune
 www.bismarcktribune.com
 PO BOX 4001
 LaCrosse, WI 54602-4001

Terms: PAYMENT IS DUE UPON RECEIPT OF INVOICE

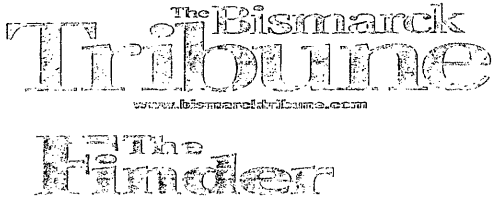

Classified Advertising Invoice

Bismarck Tribune
 PO BOX 4001
 LaCrosse, WI 54602-4001
 In State 701-250-8218
 Toll free 800-472-2273

THE FALKIRK MINING COMPANY
 2801 1ST ST SW
 PO BOX 1087
 UNDERWOOD ND 58576

Customer: 60018525
 Phone: (701) 250-2472
 Date: 02/12/2014

CREDIT CARD PAYMENT (circle one)



Card #: _____
 Exp Date: _____
 Signature: _____
 Credit card users: Fax to 608-791-8212

Date	Order #	Type	Order Amt
02/12/14	20701231	INV	9,780.00

Amount Paid: _____	CK #: _____
--------------------	-------------

Cash Amt _____

PLEASE DETACH AND RETURN TOP PORTION WITH YOUR PAYMENT

Lee Enterprises no longer accepts credit card payments sent via e-mail. Emails containing credit card numbers will be blocked. Please use the coupon above to send a credit card payment to remittance address located in the upper right corner. You may also send the coupon to a secure fax at 608-791-8212.

Date	Date	Times Run	Description	Lines	Class Code	Order Amt	Net Amt Due
			PO48424 / Permit NAFK-9503	200.00	Legals	9,780.00	9,780.00
01/22/14	02/12/14	4	Bismarck Tribune				

ok
 Bismarck Tribune
 12/29/13
 February 20th
 Mary Ball

ARJUN DOLL
 Mayor Public
 State of North Dakota
 401 Washington Blvd. Bldg. 200
 Bismarck, ND 58505

DR. W.

Please return invoice or put order number on check. Thank You.

Remarks	Total Due: 9,780.00
---------	---------------------

Bismarck Tribune
 www.bismarcktribune.com
 PO BOX 4001
 LaCrosse, WI 54602-4001

**NOTICE OF FILING TO REVISE A PERMIT FOR
SURFACE COAL MINING OPERATIONS**

The Falkirk Mining Company, P.O. Box 1087, Underwood, ND 58576, has filed an application to revise surface coal mining activities in Permit NAFK-9503. The revision application contains detailed plans to revise the mine plan, post-mining topography, and reclamation schedule for the remaining unmined areas within the Permit. The revision also contains information to update the Permit in response to a mid-term review of sections pertaining to legal and financial, ground water hydrology, soils, operations, reclamation and monitoring plans, and Permit conditions. There are no changes being proposed to the post-mining land use. The revision also updates the surface water management plans and the transportation facilities. Falkirk and the following landowners have lands and/or coal on which the updated mining schedule is proposed as indicated by the labeled shaded areas on the accompanying reference map:

TRACT 23

Township 145 North, Range 83 West

Section 36: NW1/4

Surface Ownership: The Falkirk Mining Company
Coal Ownership: Carol J. Reinhiller and Thomas R. Reinhiller
Joy M. Ochsner and Gary L. Ochsner
Judith K. Simpenderfer and Jerome D. Simpenderfer
Sylvia Thompson
North Dakota Department of Trust Lands

TRACT 38

Township 145 North, Range 83 West

Section 26: SW1/4

Surface Ownership: The Falkirk Mining Company
Coal Ownership: Anne Carlsen Center for Children
Home on the Range
Dakota Boys Ranch of Minot
Trinity Lutheran Church Foundation
Birka Country Church
First Lutheran Church
Melvin A. Christenson Revocable Trust
Darlene Roach

TRACT 39

Township 145 North, Range 83 West

Section 26: SE1/4

Surface Ownership: The Falkirk Mining Company
Coal Ownership: William Frederick Lindell and Patricia Lindell
Rita McCreary and Edward McCreary

TRACT 40

Township 145 North, Range 83 West

Section 35: NE1/4

Surface Ownership: The Falkirk Mining Company
Coal Ownership: The Falkirk Mining Company

TRACT 41

Township 145 North, Range 83 West

Section 35: W1/2NW1/4

Surface Ownership: The Falkirk Mining Company
Coal Ownership: Anne Carlsen Center for Children
Home on the Range
Dakota Boys Ranch of Minot
Trinity Lutheran Church Foundation
Birka Country Church
First Lutheran Church
Melvin A. Christenson Revocable Trust
Darlene Roach

TRACT 42

Township 145 North, Range 83 West

Section 35: E1/2NW1/4

Surface Ownership: The Falkirk Mining Company
Coal Ownership: Dean A. Swanson
Debra Nelson
Sandra Strinden
George Lynn Swanson

TRACT 43

Township 144 North, Range 83 West

Section 4: Lots 1, 2, 3, and 4, less the south 40 rods of Lots 1 and 2

Surface Ownership: The Falkirk Mining Company
Coal Ownership: Ernest E. Slagg, Life Estate
Remaindermen:
George L. Swanson and Val Rae Swanson
Adeline M. Slagg
Elda Ann Baisch
Marlys Slagg
Kevin Slagg
Wayne Slagg
Julie Slagg
Melanie Slagg Irwin
Donavan Slagg
Miles J. Slagg
Marsha F. Slagg
Carolyn S. Currier
Jerald Slagg
Connie Jo Hill
Val Rae Swanson

TRACT 44

Township 144 North, Range 83 West

Section 4: The south 40 rods of Lots 1 and 2

Surface Ownership: The Falkirk Mining Company
Coal Ownership: North Dakota Department of Trust Lands
Adeline M. Slagg
Elda Ann Baisch
Marlys Slagg
Kevin Slagg
Wayne Slagg
Julie Slagg
Melanie Slagg Irwin
Donavan Slagg
Miles J. Slagg
Marsha F. Slagg
Carolyn S. Currier
Jerald Slagg
Connie Jo Hill
Val Rae Swanson

TRACT 45

Township 144 North, Range 83 West

Section 4: SW1/4

Surface Ownership: The Falkirk Mining Company
Coal Ownership: Gertrude E. Burck
Cleo Kersey
Kitty Tweeten

TRACT 46

Township 144 North, Range 83 West

Section 4: SE1/4

Surface Ownership: The Falkirk Mining Company
Coal Ownership: North Dakota Department of Trust Lands
Elda Ann Baisch
Carolyn S. Currier
Melanie Slagg Irwin
Donavan Slagg
Miles J. Slagg
Marsha F. Slagg
Jerald A. Slagg
Connie Jo Hill
Val Rae Swanson
Adeline M. Slagg
Marlys Slagg
Kevin Slagg
Wayne Slagg
Julie Slagg

TRACT 47

Township 144 North, Range 83 West

Section 5: Lots 3 and 4

Surface Ownership: Milton L. Holznagel Revocable Trust
Coal Ownership: Milton L. Holznagel Revocable Trust

TRACT 48

Township 144 North, Range 83 West

Section 5: Lots 1 and 2

Surface Ownership: Roger Peterson, Life Estate
Remaindermen:
Neal Peterson
Cheryl Gillespie
Coal Ownership: Roger Peterson, Life Estate
Remaindermen:
Neal Peterson
Cheryl Gillespie

TRACT 49

Township 144 North, Range 83 West

Section 5: SW1/4, less an 8 ac. tract in the SE1/4SW1/4

Surface Ownership: Milton L. Holznagel Revocable Trust Dated 1-9-95
Coal Ownership: Milton L. Holznagel Revocable Trust Dated 1-9-95

TRACT 50

Township 144 North, Range 83 West

Section 5: An 8 ac. tract in the SE1/4SW1/4

Surface Ownership: The Falkirk Mining Company
Coal Ownership: The Falkirk Mining Company

TRACT 51

Township 144 North, Range 83 West

Section 5: SE1/4

Surface Ownership: Roger Peterson, Life Estate
Remaindermen:
Neal Peterson
Cheryl Gillespie
Coal Ownership: Roger Peterson, Life Estate
Remaindermen:
Neal Peterson
Cheryl Gillespie

TRACT 52

Township 144 North, Range 83 West

Section 9: NW1/4

Surface Ownership:

Coal Ownership:

The Falkirk Mining Company
 Marlys D. Allen and Lisa E. Allen
 April Azar
 Jana J. Azar
 WLK Resources, LLC
 Fred S. Wright, Jr.
 Nancy Elizabeth Brooks
 Mary Evelyn King
 Dana Denise Wright
 Major David L. Wright
 Thomas Russell Wright, Jr.
 Fred S. Wright, Jr., Trustee of the Fred S. Wright, Jr. Trust
 Plains Exploration & Production Company
 Henry Lerman
 Irving Lerner
 Linda Petroleum Co.
 Williston Projects, Inc.
 Cotton 4 Mineral Trust
 Cotton 6 Mineral Trust
 George E. Moss, Jr.
 John K. Moss
 Myra Ellen Moss
 Murex Petroleum Corporation
 Frank Jeppi Bi-Pass Trust
 J & L Hauptman Family Partnership
 Philip Mandel
 Louis Dorfman
 Myron H. Dorfman
 Singer Bros.
 S&P Co., a Louisiana partnership
 Fleischaker Mineral Company, LLC
 Teton Properties, LLC
 S D Resources, Ltd.
 A.G.S. Limited Partnership
 Eculirra Oil & Gas, L.L.C.

TRACT 53

Township 144 North, Range 83 West

Section 9: NE1/4

Surface Ownership:

Coal Ownership:

The Falkirk Mining Company
 North Dakota Department of Trust Lands
 April Azar
 Jana J. Azar
 WLK Resources, LLC
 Fred S. Wright, Jr.
 Nancy Elizabeth Brooks
 Mary Evelyn King
 Dana Denise Wright
 Major David L. Wright
 Thomas Russell Wright, Jr.
 Fred S. Wright, Jr., Trustee of the Fred S. Wright, Jr. Trust
 Plains Exploration & Production Company
 Henry Lerman
 Irving Lerner
 Linda Petroleum Co.
 Williston Projects, Inc.
 Cotton 4 Mineral Trust
 Cotton 6 Mineral Trust
 George E. Moss, Jr.
 John K. Moss
 Myra Ellen Moss
 Murex Petroleum Corporation
 Frank Jeppi Bi-Pass Trust
 J & L Hauptman Family Partnership
 Philip Mandel
 Louis Dorfman
 Myron H. Dorfman
 Singer Bros.
 S&P Co., a Louisiana partnership
 Fleischaker Mineral Company, LLC
 Teton Properties, LLC
 S D Resources, Ltd.
 A.G.S. Limited Partnership
 Eculirra Oil & Gas, L.L.C.

TRACT 62

Township 145 North, Range 83 West

Section 21: SE1/4

Surface Ownership:

Coal Ownership:

The Falkirk Mining Company
 The Falkirk Mining Company

TRACT 69

Township 145 North, Range 83 West

Section 28: N1/2NW1/4, W1/2NE1/4

Surface Ownership:

Coal Ownership:

The Falkirk Mining Company
 Erma Carlson
 Marva D. Finck
 Karen J. Carlson

TRACT 70

Township 145 North, Range 83 West

Section 28: E1/2NE1/4

Surface Ownership:

Coal Ownership:

The Falkirk Mining Company
 Marva Deane Finck

TRACT 71

Township 145 North, Range 83 West

Section 28: SW1/4, S1/2NW1/4

Surface Ownership:

Coal Ownership:

Eileen C. Zander
 Eileen C. Zander
 Barbara J. Hoffer

TRACT 72

Township 145 North, Range 83 West

Section 28: SE1/4

Surface Ownership:

Coal Ownership:

Dwight D. Gradin and Denise Gradin
 Dwight D. Gradin and Denise Gradin
 Miles W. Gradin
 Wallyn K. Lee
 Mark E. Gradin, as Trustee of the Mark E. Gradin
 Revocable Trust
 Kyle E. Gradin
 Timothy L. Johannes and Tammy S. Johannes
 Tanya I. Johannes and Steven E. Miller

TRACT 75

Township 145 North, Range 83 West

Section 27: SW1/4

Surface Ownership:

Coal Ownership:

The Falkirk Mining Company
 Janice E. Hanson
 Bonnie J. Kuntz

TRACT 76

Township 145 North, Range 83 West

Section 27: SE1/4

Surface Ownership:

Coal Ownership:

The Falkirk Mining Company
 Janice E. Hanson
 Bonnie J. Kuntz

TRACT 77

Township 145 North, Range 83 West

Section 33: NW1/4

Surface Ownership:

Coal Ownership:

Dwight D. Gradin and Denise Gradin
 Dwight D. Gradin and Denise Gradin
 Miles W. Gradin
 Wallyn K. Lee
 Mark E. Gradin, as Trustee of the Mark E. Gradin
 Revocable Trust
 Kyle E. Gradin
 Timothy L. Johannes and Tammy S. Johannes
 Tanya I. Johannes and Steven E. Miller

TRACT 78

Township 145 North, Range 83 West

Section 33: NE1/4

Surface Ownership:

Coal Ownership:

Dwight D. Gradin and Denise Gradin
 Dwight D. Gradin and Denise Gradin
 Miles W. Gradin
 Wallyn K. Lee
 Mark E. Gradin, as Trustee of the Mark E. Gradin
 Revocable Trust
 Kyle E. Gradin
 Timothy L. Johannes and Tammy S. Johannes
 Tanya I. Johannes and Steven E. Miller

TRACT 79

Township 145 North, Range 83 West

Section 34: NW1/4

Surface Ownership:

Coal Ownership:

Neal Peterson and Beverly Peterson
 Sharyn M. Calton and Scott Calton

TRACT 80

Township 145 North, Range 83 West

Section 34: North 100 ac. of the NE1/4

Surface Ownership:

Coal Ownership:

The Falkirk Mining Company
 Anne Carlsen Center for Children
 Home on the Range
 Dakota Boys Ranch of Minot
 Trinity Lutheran Church Foundation
 Birka Country Church
 First Lutheran Church
 Melvin A. Christenson Revocable Trust
 Darlene Roach

TRACT 81

Township 145 North, Range 83 West

Section 34: South 60 ac. of the NE1/4

Surface Ownership:

Coal Ownership:

The Falkirk Mining Company
 Anne Carlsen Center for Children
 Home on the Range
 Dakota Boys Ranch of Minot
 Trinity Lutheran Church Foundation
 Birka Country Church
 First Lutheran Church
 Melvin A. Christenson Revocable Trust
 Darlene Roach

TRACT 82

Township 145 North, Range 83 West

Section 34: SW1/4

Surface Ownership:

Mildred Leidholm, as Trustee of the Lloyd Leidholm Testamentary Trust
 Roy B. Leidholm and Eva Leidholm, Life Estate
 Remaindermen:
 Brian Leidholm
 Cordell Leidholm
 Glynda Janz
 Karen Perkerewicz
 Dean Leidholm
 Tammy Novak
 Sharon Rivers
 Dwayne Leidholm
 Mildred Jahner and Valentine Jahner, Life Estate
 Remaindermen:
 Curtis Jahner
 Brent Jahner

Coal Ownership:

Mildred Leidholm, as Trustee of the Lloyd Leidholm Testamentary Trust
 Roy B. Leidholm and Eva Leidholm, Life Estate
 Remaindermen:
 Brian Leidholm
 Cordell Leidholm
 Glynda Janz
 Karen Perkerewicz
 Dean Leidholm
 Tammy Novak
 Sharon Rivers
 Dwayne Leidholm
 Mildred Jahner and Valentine Jahner, Life Estate
 Remaindermen:
 Curtis Jahner
 Brent Jahner

TRACT 83

Township 145 North, Range 83 West

Section 34: SE1/4

Surface Ownership:

The Falkirk Mining Company

Coal Ownership:

James Peterson
 Dennis L. Peterson
 Duaine J. Peterson
 Jane Schulz
 Susan Krebsbach
 North Dakota Department of Trust Lands

TRACT 84

Township 145 North, Range 83 West

Section 35: SW1/4

Surface Ownership:

The Falkirk Mining Company

Coal Ownership:

William F. Lindell and Patricia Lindell
 Robert L. Erickson and Susan F. Lawrence

TRACT 85

Township 145 North, Range 83 West

Section 35: SE1/4

Surface Ownership:

The Falkirk Mining Company

Coal Ownership:

Barbara J. Hoffer
 Eileen C. Zander
 Alma Nelson
 Arvin Swanson
 Marcia Steinwand
 Rodney Swanson
 Sheryl Willits

TRACT 86

Township 145 North, Range 83 West

Section 36: SW1/4

Surface Ownership:

The Falkirk Mining Company

Coal Ownership:

James Peterson
 Dennis L. Peterson
 Duaine J. Peterson
 Jane Schulz
 Susan Krebsbach
 North Dakota Department of Trust Lands

TRACT 88

Township 144 North, Range 83 West

Section 6: Gov't Lots 1, 2, N1/2SE1/4

Surface Ownership:

Dean A. Swanson and Sandra Lynn Swanson

Coal Ownership:

The Estate of Iona Jean Vujovich

TRACT 89

Township 144 North, Range 83 West

Section 6: Gov't Lots 3, 4, and 5, NE1/4SW1/4

Surface Ownership:

Mildred Leidholm, as Trustee of the Lloyd Leidholm Testamentary Trust
 Roy B. Leidholm and Eva Leidholm, Life Estate
 Remaindermen:
 Brian Leidholm
 Cordell Leidholm
 Glynda Janz
 Karen Perkerewicz
 Dean Leidholm
 Tammy Novak
 Sharon Rivers
 Dwayne Leidholm
 Mildred Jahner and Valentine Jahner, Life Estate
 Remaindermen:
 Curtis Jahner
 Brent Jahner

Coal Ownership:

Mildred Leidholm, as Trustee of the Lloyd Leidholm Testamentary Trust
 Roy B. Leidholm and Eva Leidholm, Life Estate
 Remaindermen:
 Brian Leidholm
 Cordell Leidholm
 Glynda Janz
 Karen Perkerewicz
 Dean Leidholm
 Tammy Novak
 Sharon Rivers
 Dwayne Leidholm
 Mildred Jahner and Valentine Jahner, Life Estate
 Remaindermen:
 Curtis Jahner
 Brent Jahner

TRACT 90

Township 144 North, Range 83 West

Section 6: Gov't Lot 6, SE1/4SW1/4, S1/2SE1/4

Surface Ownership:

Stephen P. Swanson

Coal Ownership:

United States of America – Bureau of Land Management

TRACT 92

Township 144 North, Range 83 West

Section 7: Gov't Lot 1, E1/2NW1/4

Surface Ownership:

Glenda G. Scholl

Coal Ownership:

Glenda G. Scholl
 Jenene M. Kittleson
 Marian Gullickson

TRACT 93

Township 144 North, Range 83 West

Section 7: Gov't Lot 2

Surface Ownership:

Glenda G. Scholl

Coal Ownership:

Glenda G. Scholl
 Jenene M. Kittleson and Michael A. Kittleson
 Marian Gullickson and Dwaine Gullickson

TRACT 95

Township 144 North, Range 83 West

Section 7: Gov't Lots 3, 4, E1/2SW1/4

Surface Ownership:

Glenda G. Scholl

Coal Ownership:

Glenda G. Scholl

TRACT 96

Township 144 North, Range 84 West

Section 1: Gov't Lots 1, 2, 3, and 4

Surface Ownership:

Michael M. Thyberg

Coal Ownership:

Michael M. Thyberg

TRACT 97

Township 144 North, Range 84 West

Section 1: SE1/4

Surface Ownership:

Carol Sauer

Coal Ownership:

Carol Sauer
 Lavern I. Johnson
 North Dakota Department of Trust Lands

TRACT 98

Township 144 North, Range 84 West

Section 1: SW1/4

Surface Ownership:

Dean A. Swanson

Coal Ownership:

Dean A. Swanson
 Stephen P. Swanson

TRACT 99

Township 144 North, Range 84 West

Section 2: Gov't Lots 1, 2, less 5.51 acres in Lot 2

Surface Ownership:

Mark Swanson and Pamela L. Hopkins

Coal Ownership:

Stephen P. Swanson
 United States of America – Bureau of Land Management

TRACT 100

Township 144 North, Range 84 West

Section 2: 5.51 acres in Gov't Lot 2, described as follows: Beginning at the Northeast corner of said Lot 2, T144N-R84W, thence South 400', thence West 600'; thence North 400'; thence East 600' to the point of beginning

Surface Ownership:

Stephen P. Swanson

Coal Ownership:

United States of America – Bureau of Land Management

TRACT 101

Township 144 North, Range 84 West

Section 2: Gov't Lots 3 and 4

Surface Ownership:

Stephen P. Swanson

Coal Ownership:

United States of America – Bureau of Land Management

TRACT 102

Township 144 North, Range 84 West

Section 2: SE1/4, SW1/4

Surface Ownership:

Forrest W. Ecklund and Alyce F. Ecklund

Coal Ownership:

Forrest W. Ecklund and Alyce F. Ecklund

TRACT 103

Township 144 North, Range 84 West

Section 3: Gov't Lots 1, 2, SE1/4

Surface Ownership:

Forrest W. Ecklund and Alyce F. Ecklund

Coal Ownership:

Forrest W. Ecklund and Alyce F. Ecklund

TRACT 104

Township 144 North, Range 84 West

Section 10: NE1/4

Surface Ownership:

Miller Brothers Ranch, L.L.L.P.

Coal Ownership:

Doretta Dene Clark
Margo Jean Vranna
Shirley Seher
Roger Clements Clark
Velma Cleveland
Scott Lang and Kay Lang
Lamoure Besse and Patricia Besse
Scott Schmidt and Casey Schmidt**TRACT 105**

Township 144 North, Range 84 West

Section 11: NE1/4, SE1/4

Surface Ownership:

Miller Brothers Ranch, L.L.L.P.

Coal Ownership:

Doretta Dene Clark
Margo Jean Vranna
Shirley Seher
Roger Clements Clark
Velma Cleveland
Scott Lang and Kay Lang
Lamoure Besse and Patricia Besse
Scott Schmidt and Casey Schmidt**TRACT 106**

Township 144 North, Range 84 West

Section 11: NW1/4

Surface Ownership:

Miller Brothers Ranch, L.L.L.P.

Coal Ownership:

Doretta Dene Clark
Margo Jean Vranna
Shirley Seher
Roger Clements Clark
Velma Cleveland
Scott Lang and Kay Lang
Lamoure Besse and Patricia Besse
Scott Schmidt and Casey Schmidt**TRACT 107**

Township 144 North, Range 84 West

Section 11: SW1/4

Surface Ownership:

Miller Brothers Ranch, L.L.L.P.

Coal Ownership:

Doretta Dene Clark
Margo Jean Vranna
Shirley Seher
Roger Clements Clark
Velma Cleveland
Scott Lang and Kay Lang
Lamoure Besse and Patricia Besse
Scott Schmidt and Casey Schmidt**TRACT 108**

Township 144 North, Range 84 West

Section 12: N1/2NE1/4

Surface Ownership:

Glenda G. Scholl

Coal Ownership:

Jenene M. Kittleson and Michael A. Kittleson

TRACT 109

Township 144 North, Range 84 West

Section 12: S1/2NE1/4

Surface Ownership:

Kay M. Hegvik

Coal Ownership:

Marian Gullickson and Dwaine Gullickson
George L. Swanson and Val Rae Swanson
Dean A. Swanson and Sandy L. Swanson**TRACT 110**

Township 144 North, Range 84 West

Section 12: NW1/4

Surface Ownership:

Harley J. Scholl

Coal Ownership:

United States of America – Bureau of Land Management

TRACT 111

Township 144 North, Range 84 West

Section 12: SE1/4

Surface Ownership:

Glenda G. Scholl

Coal Ownership:

Glenda G. Scholl
George Scholl
Marian Gullickson
Jenene Kittleson**TRACT 112**

Township 144 North, Range 84 West

Section 12: SW1/4

Surface Ownership:

Roger Peterson

Coal Ownership:

Roger Peterson

TRACT 132

Township 145 North, Range 83 West

Section 16: NE1/4

Surface Ownership:

The Falkirk Mining Company

Coal Ownership:

Pauline M. Rosberg
The Denver G. Rosberg Credit Trust
North Dakota Department of Trust Lands**TRACT 134**

Township 145 North, Range 83 West

Section 16: N1/2SE1/4

Surface Ownership:

The Falkirk Mining Company

Coal Ownership:

Pennington Living Trust Dated 4-28-99
North Dakota Department of Trust Lands**TRACT 135**

Township 145 North, Range 83 West

Section 16: S1/2SE1/4

Surface Ownership:

The Falkirk Mining Company

Coal Ownership:

Pauline M. Rosberg
The Denver G. Rosberg Credit Trust
North Dakota Department of Trust Lands**TRACT 143**

Township 145 North, Range 83 West

Section 21: N1/2, SW1/4, less 0.49 ac. in the NW1/4

Surface Ownership:

The Falkirk Mining Company

Coal Ownership:

Pauline M. Rosberg
The Denver G. Rosberg Credit Trust
Robert C. Mann
Audrey M. Crum
Margaret E. Tollerud**TRACT 145**

Township 145 North, Range 83 West

Section 29: NE1/4

Surface Ownership:

Mary Jane Miller

Coal Ownership:

Mary Jane Miller
Nancy J. Bridges and Jennifer Anne Barber,
Co-Trustees or the Successor Trustee of
The Nancy J. Bridges Trust Dated November 15, 2011**TRACT 146**

Township 145 North, Range 83 West

Section 29: S1/2

Surface Ownership:

Robert C. Mann

Coal Ownership:

Audrey M. Crum
Margaret E. Tollerud
Robert C. Mann
Audrey M. Crum
Margaret E. Tollerud
Leslie Peterson
Barbara Peterson**TRACT 147**

Township 145 North, Range 83 West

Section 32: NE1/4

Surface Ownership:

Barbara J. Hoffer

Coal Ownership:

Barbara J. Hoffer
Eileen C. Zander**TRACT 148**

Township 145 North, Range 83 West

Section 32: NW1/4

Surface Ownership:

Robert C. Mann

Coal Ownership:

Audrey M. Crum
Margaret E. Tollerud
The Stewart E. Bowers and Joyce W. Bowers
1989 Inter Vivos
Trust Dated 6-23-89
Robert C. Mann
Audrey M. Crum
Margaret E. Tollerud
Mueller Industries, Inc.
Mary C. Henderson**TRACT 149**

Township 145 North, Range 83 West

Section 32: SE1/4

Surface Ownership:

Michael M. Thyberg

Coal Ownership:

Michael M. Thyberg

TRACT 150

Township 145 North, Range 83 West

Section 32: SW1/4

Surface Ownership:

Michael M. Thyberg

Coal Ownership:

United States of America – Bureau of Land Management

TRACT 151

Township 145 North, Range 83 West

Section 33: SE1/4, SW1/4

Surface Ownership:

Dwight D. Gradin and Denise Gradin

Coal Ownership:

Dwight D. Gradin and Denise Gradin
Miles W. Gradin
Wallyn K. Lee
Mark E. Gradin, as Trustee of the Mark E. Gradin
Revocable Trust
Kyle E. Gradin
Timothy L. Johannes and Tammy S. Johannes
Tanya L. Johannes and Steven E. Miller

TRACT 152

Township 145 North, Range 84 West

Section 1: Gov't Lots 1, 2, 3, 4, S1/2N1/2, SE1/4

Surface Ownership: The Falkirk Mining Company
Coal Ownership: William Frederick Lindell and Patricia L. Lindell
Rita McCreary

TRACT 153

Township 145 North, Range 84 West

Section 1: SW1/4

Surface Ownership: The Falkirk Mining Company
Coal Ownership: Beth Bruestle
Kent Swanson
Timothy Bruestle
Ryan Bruestle
Erika Bruestle

TRACT 155

Township 145 North, Range 84 West

Section 12: E1/2NE1/4, SW1/4NE1/4, NE1/4SE1/4

Surface Ownership: The Falkirk Mining Company
Coal Ownership: Beth Bruestle
Kent Swanson
Timothy Bruestle
Ryan Bruestle
Erika Bruestle
United States of America

TRACT 156

Township 145 North, Range 84 West

Section 12: E1/2NW1/4, NE1/4SW1/4, NW1/4NE1/4

Surface Ownership: The Falkirk Mining Company
Coal Ownership: Beth Bruestle
Kent Swanson
Timothy Bruestle
Ryan Bruestle
Erika Bruestle

TRACT 157

Township 145 North, Range 84 West

Section 12: W1/2W1/2, SE1/4SW1/4, S1/2SE1/2

Surface Ownership: The Falkirk Mining Company
Coal Ownership: United States of America – Bureau of Land Management

TRACT 174

Township 146 North, Range 84 West

Section 36: S1/2SE1/4

Surface Ownership: Donald D. Landenberger and Karen S. Landenberger
Coal Ownership: Donald D. Landenberger
Velma Schacher
Leila Landenberger
Gary Landenberger
Kathy Landenberger Kesselring
Diane Nelson
North Dakota Department of Trust Lands

TRACT 175A

Township 146 North, Range 84 West

Section 36: SW1/4

Surface Ownership: The Falkirk Mining Company
Coal Ownership: David J. LeRoy and Dorothy M. LeRoy
North Dakota Department of Trust Lands

Copies of the application for revision of a surface coal mining permit are available for public inspection at the offices of the North Dakota Public Service Commission, 600 East Boulevard Ave., Bismarck, ND 58505-0480 and at the office of the County Auditor, McLean County Courthouse, Washburn, ND 58577.

Written comments, objections, or requests for informal conferences on the application may be submitted by any person with an interest which is or may be adversely affected to the North Dakota Public Service Commission, 600 East Boulevard Ave., Bismarck, ND 58505-0480 within 30 days after the last publication of this notice.

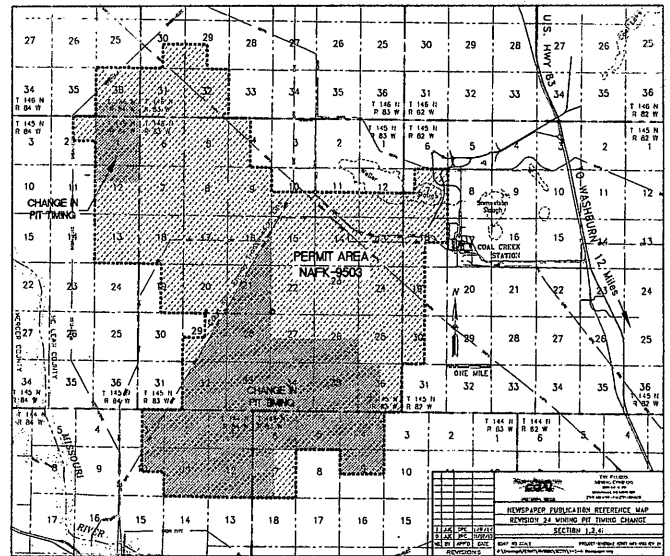

1/22, 29, 2/5 & 12 - 20701331