

STATE OF NORTH DAKOTA
PUBLIC SERVICE COMMISSION

ALLETE, Inc.
250kV DC Trans Line Reroute – Cass County
Siting Application

Case No. PU-14-121

NOTICE OF FILING AND NOTICE OF OPPORTUNITY FOR HEARING

April 9, 2014

On March 17, 2014 Minnesota Power, an Operating Division of ALLETE, Inc. filed applications for a corridor certificate, route permit and a waiver of procedures and time schedules authorizing the rerouting of approximately 0.7 miles of existing 250 kV DC electric transmission line around a flood control basin in Township 137N, Range 54W, Section 11 in Cass County, North Dakota as shown on the attached map.

Minnesota Power requests the Commission waive procedures and time schedules under NDCC chapter 49-22 and ND Admin. Code article 69-06 to allow consolidated applications for corridor certificate and route permit and waive the requirement to hold a public hearing.

The issues to be considered in Minnesota Power's application for waiver of procedures and time schedules are:

1. Are the proposed facilities of such length, design, location, or purpose that they will produce minimal adverse effects and that adherence to applicable procedures and time schedules may be waived?
2. Is it appropriate for the Commission to waive any procedures and time schedules as requested in the application?

The issues to be considered in Minnesota Power's applications for certificate of corridor compatibility and route permit are:

1. Will the location, construction, and operation of the proposed facilities produce minimal adverse effects on the environment and upon the welfare of the citizens of North Dakota?
2. Are the proposed facilities compatible with the environmental preservation and the efficient use of resources?
3. Will the proposed facility locations minimize adverse human and environmental impact while ensuring continuing system reliability and integrity and ensuring that energy needs are met and fulfilled in an orderly and timely fashion?

Those interested are invited to comment on the applications in writing. Persons desiring a hearing must file a written request identifying their interest in the proceeding and the reasons for requesting a hearing. **Comments and requests for hearing must be received by May 16, 2014.** If deemed appropriate, the Commission can determine the matter without a hearing.

For more information contact the Public Service Commission, State Capitol, Bismarck, North Dakota 58505, 701-328-2400; or Relay North Dakota, 1-800-366-6888 TTY. If you require any auxiliary aids or services, such as readers, signers, or Braille materials, please notify the Commission.

PUBLIC SERVICE COMMISSION

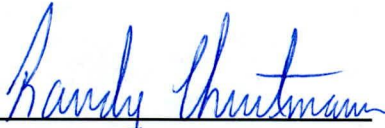

Randy Christmann
Commissioner

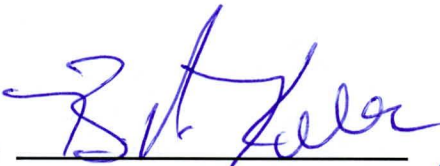



Brian P. Kalk
Chairman

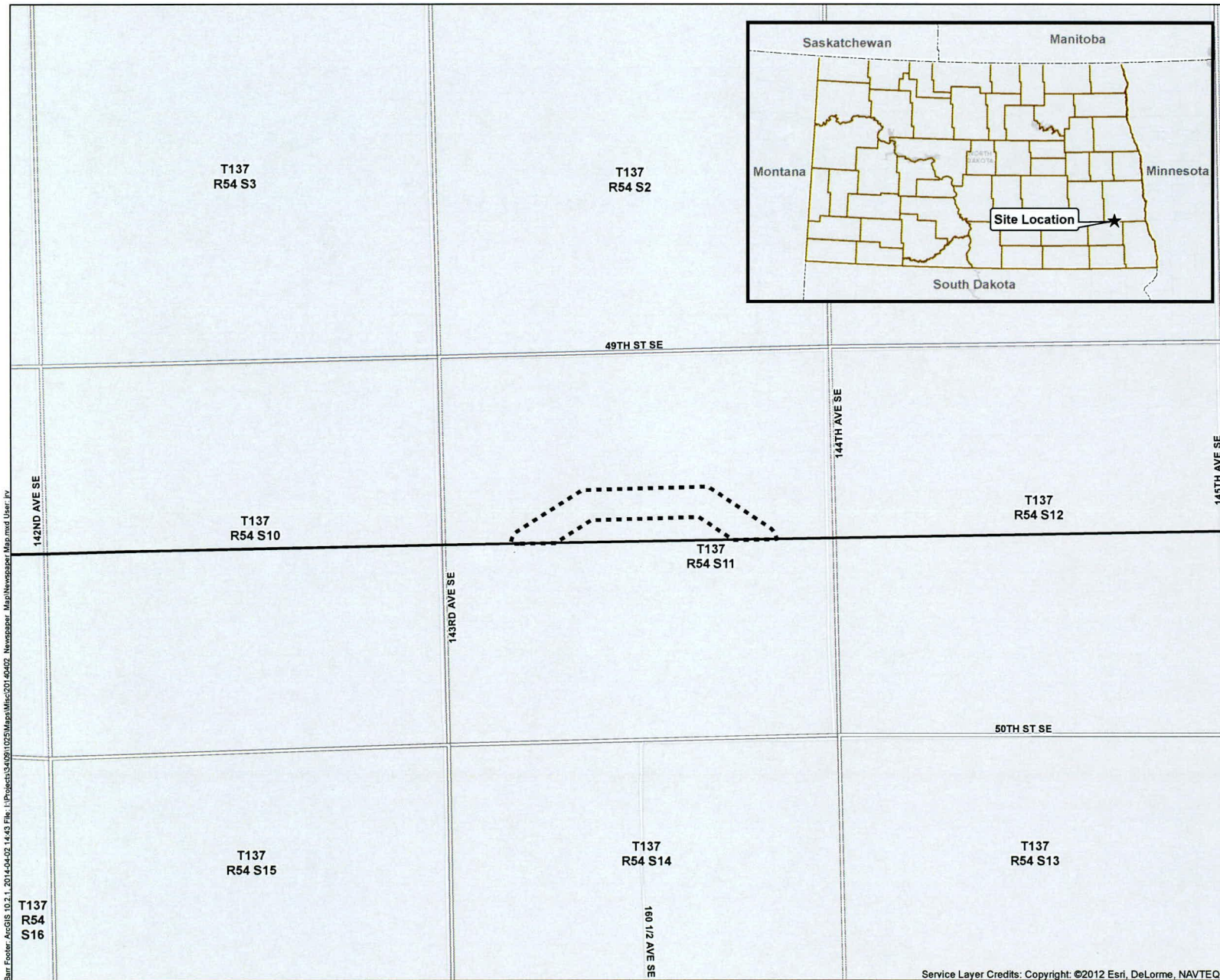

Julie Fedorchak
Commissioner



-  Existing Line
-  Proposed Reroute
-  Public Land Survey Section

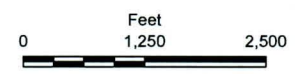

Figure 1-1
 PROJECT LOCATION MAP
 Minnesota Power
 Cass County, ND

Bar Footer: ArcGIS 10.2.1, 2014-04-09 14:43 File: I:\Projects\34981\025\Maps\Misc\2014-04-09_NewsPaper_Map\NewsPaper_Map.mxd User: JTV

Service Layer Credits: Copyright: ©2012 Esri, DeLorme, NAVTEQ