

STATE OF NORTH DAKOTA  
PUBLIC SERVICE COMMISSION

Allete, Inc.  
250kV DC Trans. Line Reroute- Cass County  
Siting Application

Case No. PU-14-121

AFFIDAVIT OF SERVICE BY CERTIFIED MAIL

STATE OF NORTH DAKOTA  
COUNTY OF BURLEIGH

Cara DeSaye deposes and says that:

she is over the age of 18 years and not a party to this action and, on the 11<sup>th</sup> day of April, 2014, she deposited in the United States Mail, Bismarck, North Dakota, one envelope with certified postage, return receipt requested, fully prepaid, securely sealed and each containing a photocopy of:

Notice of Filing and Notice of Opportunity for Hearing

The envelope was addressed as follows:

David Moeller  
Minnesota Power  
30 West Superior Street  
Duluth MN 55802

Cert. No. 7013 0600 0001 7154 5376

The address shown is the respective addressee's last reasonably ascertainable post office address.

Subscribed and sworn to before me  
this 11<sup>th</sup> day of April, 2014.

SEAL

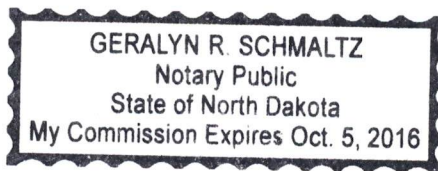

*Cara DeSaye*  
\_\_\_\_\_  
*Geralyn R. Schmaltz*  
\_\_\_\_\_  
Notary Public

**STATE OF NORTH DAKOTA  
PUBLIC SERVICE COMMISSION**

**ALLETE, Inc.  
250kV DC Trans Line Reroute – Cass County  
Siting Application**

**Case No. PU-14-121**

**NOTICE OF FILING AND NOTICE OF OPPORTUNITY FOR HEARING**

**April 9, 2014**

On March 17, 2014 Minnesota Power, an Operating Division of ALLETE, Inc. filed applications for a corridor certificate, route permit and a waiver of procedures and time schedules authorizing the rerouting of approximately 0.7 miles of existing 250 kV DC electric transmission line around a flood control basin in Township 137N, Range 54W, Section 11 in Cass County, North Dakota as shown on the attached map.

Minnesota Power requests the Commission waive procedures and time schedules under NDCC chapter 49-22 and ND Admin. Code article 69-06 to allow consolidated applications for corridor certificate and route permit and waive the requirement to hold a public hearing.

The issues to be considered in Minnesota Power's application for waiver of procedures and time schedules are:

1. Are the proposed facilities of such length, design, location, or purpose that they will produce minimal adverse effects and that adherence to applicable procedures and time schedules may be waived?
2. Is it appropriate for the Commission to waive any procedures and time schedules as requested in the application?

The issues to be considered in Minnesota Power's applications for certificate of corridor compatibility and route permit are:

1. Will the location, construction, and operation of the proposed facilities produce minimal adverse effects on the environment and upon the welfare of the citizens of North Dakota?
2. Are the proposed facilities compatible with the environmental preservation and the efficient use of resources?
3. Will the proposed facility locations minimize adverse human and environmental impact while ensuring continuing system reliability and integrity and ensuring that energy needs are met and fulfilled in an orderly and timely fashion?

Those interested are invited to comment on the applications in writing. Persons desiring a hearing must file a written request identifying their interest in the proceeding and the reasons for requesting a hearing. **Comments and requests for hearing must be received by May 16, 2014.** If deemed appropriate, the Commission can determine the matter without a hearing.

For more information contact the Public Service Commission, State Capitol, Bismarck, North Dakota 58505, 701-328-2400; or Relay North Dakota, 1-800-366-6888 TTY. If you require any auxiliary aids or services, such as readers, signers, or Braille materials, please notify the Commission.

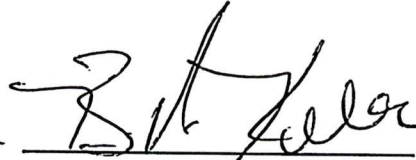

**PUBLIC SERVICE COMMISSION**

  
**Randy Christmann**  
Commissioner

  
**Brian P. Kalk**  
Chairman

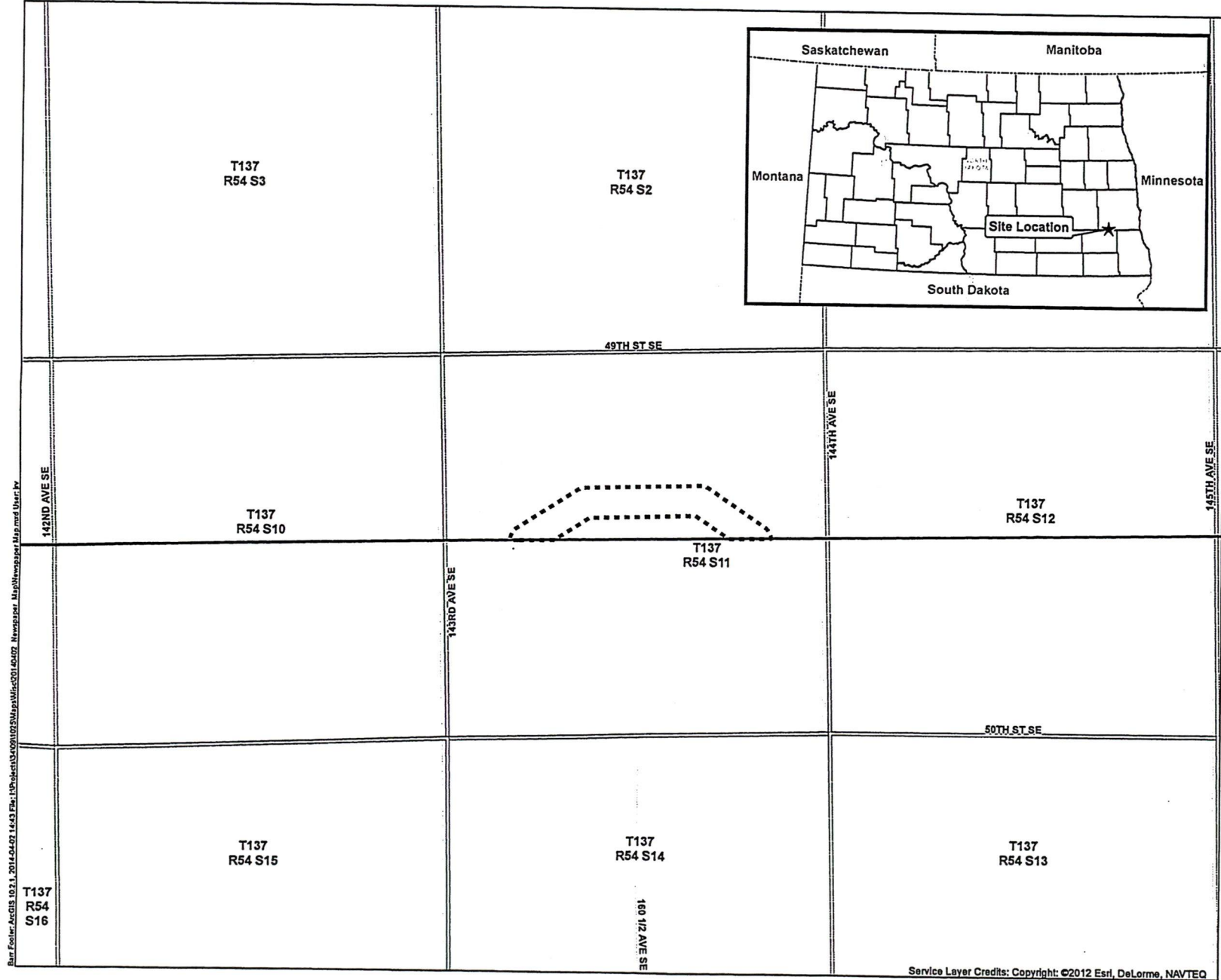
  
**Julie Fedorchak**  
Commissioner



-  Existing Line
-  Proposed Reroute
-  Public Land Survey Section

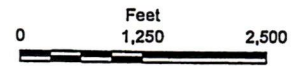

Figure 1-1  
PROJECT LOCATION MAP  
Minnesota Power  
Cass County, ND

Bar: Poster-ArcGIS\_10.3.1\_2014-04-07 14:53:17; I:\Project\04\09\07\01\Map\Miner\01\04092\_Newsprint\_Map\Newsprint\_Map.mxd User: jw

Service Layer Credits: Copyright: ©2012 Esri, DeLorme, NAVTEQ