

OWNER	452+98 657' OKROP DANIEL	459+55 1,937' RAMBOUSEK ANDREW	478+92 1,342' HAVELKA DAVID	482+35 2,030' RAMBOUSEK ANDREW	512+65 49' ROAD MARSH DUANE R & DORIS	515+13 197' MARSH DUANE R & DORIS	515+11 87' COUNTY ROAD	519+07 2,942' RIDL KURT ETAL	545+58 645+58 MARSH DUANE R & DORIS	554+75 2,036' MARSH DUANE R & DORIS	556+75 1,056' HAVELKA GERALD	576+32 3,310' MARSH DUANE & DORIS	612+71 87' SECTION ROAD	612+71 242' KOSTELECKY RODNEY A	612+71
CROSSINGS	458+16 DUCK CREEK 458+26 DRAINAGE	469+53 FENCE	482+92 DUCK CREEK	512+42 3RD ST SW 515+46 110TH AVE SW	513+13 140N 97W SECTION 18 515+09 140N 97W SECTION 17	545+41 FENCE 554+75 DRAINAGE	556+75 FENCE	576+30 FENCE 578+51 3RD ST SW	609+72 140N 97W SECTION 21						
SURVEY NOTES															
FOREIGN LINE XING				513+62 Fiber Optic 514+03 Fiber Optic 514+03 Fiber Optic 518+42 Fiber Optic			539+43 CRUDE OIL PIPELINE 539+71 GAS PIPELINE 539+90 WATER LINE			581+30 CRUDE OIL PIPELINE 581+42 CRUDE OIL PIPELINE 581+63 CRUDE OIL PIPELINE					

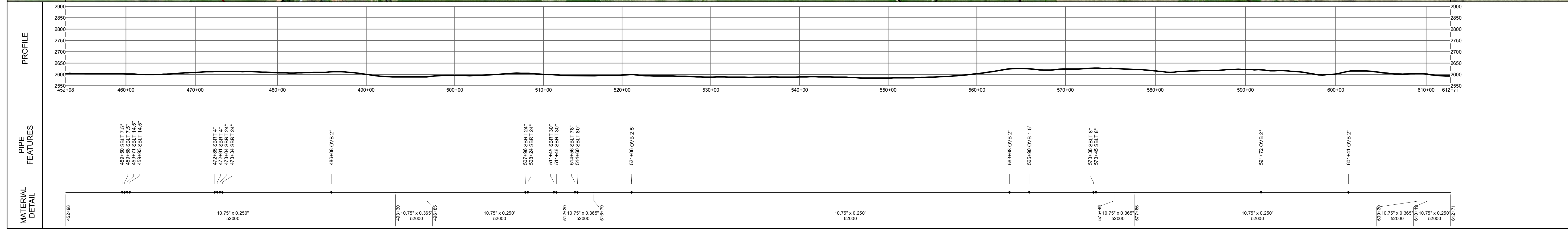

LEGEND 	PIPE DETAIL 452+98 493+30 10.75" x 0.250", 4/1/2015, 52000 (4,032) 493+30 496+85 10.75" x 0.365", 4/1/2015, 52000 (355) 496+85 512+30 10.75" x 0.250", 4/1/2015, 52000 (1,545) 512+30 516+79 10.75" x 0.365", 4/1/2015, 52000 (450) 516+79 575+46 10.75" x 0.250", 4/1/2015, 52000 (5,866) 575+46 577+66 10.75" x 0.365", 4/1/2015, 52000 (221) 577+66 609+30 10.75" x 0.250", 4/1/2015, 52000 (3,164) 609+30 610+19 10.75" x 0.365", 4/1/2015, 52000 (89) 610+19 612+71 10.75" x 0.250", 4/1/2015, 52000 (252)	OPERATING PRESSURE 452+98 612+71 MAOP: 1440	TEST PRESSURE 452+98 612+71 TEST PRESSURE: 1850.
	BELLE FOURCHE PIPELINE COMPANY SKUNK HILL TO DICKINSON LOOP STARK COUNTY, ND T140N R97W Sec. 7 T140N R97W Sec. 18 T140N R97W Sec. 17 T140N R97W Sec. 20 T140N R97W Sec. 21		
Scale: 1:6,000 MAOP RATING 1440 PSI Generate Date: 5/27/2015 Line Name: SKUNK HILL TO DICKINSON Sheet Number: 005 of 006			