

OWNER	612+71 3,186' KOSTELECKY RODNEY A	644+57 124' COUNTY ROAD 180	644+57 1,866' RIDL KURT ETAL	684+46 1,759' KOPP SUSAN	682+06 1,238' RIDL ARTHUR S ETAL	684+43 1,939' SHANNON ROGETTE IRREVOCABLE TRUST	713+81 2,522' FALLER FAMILY REVOCABLE TRUST	739+03
CROSSINGS								
SURVEY NOTES		645+33 140N 97W SECTION 28		678+20 DRAINAGE	682+11 140N 97W SECTION 27		714+39 DRAINAGE	
FOREIGN LINE XING	637+00 CRUDE OIL PIPELINE 637+17 CRUDE OIL PIPELINE 637+37 CRUDE OIL PIPELINE	643+96 CRUDE OIL PIPELINE 644+11 OPEN DITCH 646+38 SOUTH WEST WATER PIPELINE 646+77 TELEPHONE 646+79 TELEPHONE		682+06 SOUTH WEST WATER 683+34 TELEPHONE 683+35 TELEPHONE		684+43 ENERGY GAS LINE 684+42 CHECK GAS LINE	724+43 C 12 ENERGY GAS LINE	732+89 ABANDONED PIPELINE 732+89 ABANDONED PIPELINE 734+97 CRUDE OIL PIPELINE 735+86 ABANDONED PIPELINE 739+13 POWERLINE 739+20 POWERLINE

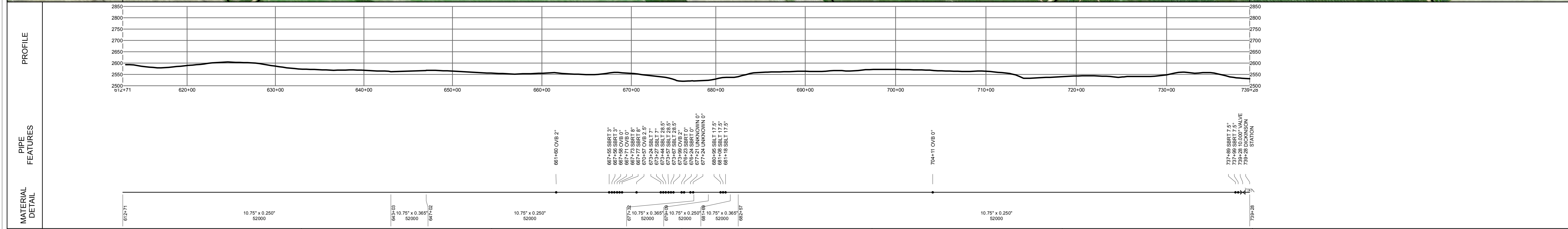

LEGEND	
	SECTION LINE
	RAILROAD
	DRAINAGE
	FENCE
	ROAD
	BURIED CABLE
	POWER LINE
	TOP OF BANK
	TELEPHONE LINE
	OVERHEAD POWER LINE
	BURIED PIPELINE
	PROPERTY LINE
	BURIED WATER LINE
	TILE
	STATION EQUATION
	RIVER WEIGHT
	DRIP
	VALVE
	METER
	REGULATOR
	CASING
	SLEEVE
	TEST LEAD
	REDUCER
	RECTIFIER
	TAPTEE
	PIG SIGNAL
	AERIAL MARKER
	RECEIVER
	LAUNCHER
	PIPE INFLECTION
	WELD CAP

PIPE DETAIL	
612+71	643+03 10.75" x 0.250", 4/1/2015, 52000, (3,032)
643+03	647+02 10.75" x 0.365", 4/1/2015, 52000, (399)
647+02	677+32 10.75" x 0.250", 4/1/2015, 52000, (3,029)
677+32	679+09 10.75" x 0.365", 4/1/2015, 52000, (177)
679+09	681+69 10.75" x 0.250", 4/1/2015, 52000, (280)
681+69	682+57 10.75" x 0.365", 4/1/2015, 52000, (88)
682+57	739+28 10.75" x 0.250", 4/1/2015, 52000, (5,671)
OPERATING PRESSURE	
612+71	739+28 MAOP: 1440
TEST PRESSURE	
612+71	739+28 TEST PRESSURE: 1850
VALVES	
739+28	10.00" DICKINSON VALVE (DICKINSON)

**BELLE FOURCHE PIPELINE COMPANY**  
**SKUNK HILL TO DICKINSON LOOP**  
 STARK COUNTY, ND

T140N R97W Sec. 21  
 T140N R97W Sec. 28  
 T140N R97W Sec. 27

Scale: 1:6,000 MAOP RATING 1440 PSI

Generate Date: 5/27/2015

Line Name: SKUNK HILL TO DICKINSON

Sheet Number: 006 of 006