

Enbridge Energy, Limited Partnership  
26 East Superior Street, Suite 309  
Duluth, MN 55802

Brad Shamla  
Vice President, U.S. Operations  
Office: 952-607-3430  
Cell: 218-269-5458  
Email: [brad.shamla@enbridge.com](mailto:brad.shamla@enbridge.com)



May 2, 2014



Commissioner Brian P. Kalk  
Commissioner Julie Fedorchak  
Commissioner Randy Christmann  
c/o Mr. Darrell Nitschke  
Executive Secretary  
North Dakota Public Service Commission  
600 East Blvd, Dept 408  
Bismarck, North Dakota 58505-0480

**RE: Enbridge Energy, Limited Partnership's Certification Pursuant to N.D.C.C. § 49-22-03(3) for Pipeline Segment: Line 3, Pembina County, North Dakota**

Dear Commissioners:

This letter is provided to notify the North Dakota Public Service Commission ("Commission") that Enbridge Energy, Limited Partnership ("Enbridge"), intends to replace a segment of its existing Line 3 Pipeline located in Pembina, North Dakota ("Project") as part of its ongoing maintenance program. Since the Project is for maintenance of an existing pipeline, rather than construction of a new pipeline, prior notification to the Commission is not required under the North Dakota Energy Conversion and Transmission Facility Siting Act, N.D.C.C. Ch. 49-22 ("Siting Act"). However, because "construction" is so broadly defined in N.D.C.C. § 49-22-03, Enbridge is submitting this letter and the enclosed Certification to ensure compliance with N.D.C.C. § 49-22-03(3)(a).

As set forth in the Certification, Enbridge intends to replace an approximate 15.72 mile segment of its existing Line 3, a 34-inch pipeline, located entirely in Pembina County, North Dakota. Certification at ¶ 2. This replacement segment is part of Enbridge's existing Line 3 pipeline, which extends approximately 1,031 miles between Hardisty, Alberta, Canada and Superior, Wisconsin. *Id.* at ¶ 3. Line 3 is a transmission facility which was original constructed in 1967 prior to enactment of the Siting Act (April 9, 1975), and is, therefore, granted a corridor width of three hundred fifty feet on either side of the centerline pursuant to N.D.C.C. § 49-22-03(3)(a)(1)(c). *Id.* at ¶ 4.

The Project will consist of installation of approximately 15.72 miles of new 34-inch pipe, a tie-over to tie the new pipe to the existing Line 3 Pipeline, and four new 34-inch valves. Certification at ¶ 5. A map depicting the Project is attached to the Certification as **Exhibit A**. The replaced portion of the existing Line 3 Pembina County Segment will be deactivated once the new segment is placed in service. *Id.* at ¶ 6. Construction of the Project is scheduled to begin on or about May 12, 2014. *Id.* at ¶ 11.

ENB LL 52245044

1 **PU-14-226** Filed: 5/2/2014 Pages: 5  
**Certification regarding exclusion and avoidance areas and supporting documentation**

Enbridge Energy, Limited Partnership

Brad Shamla, VP, US Ops



In accordance with N.D.C.C. § 49-22-03(3)(a), Enbridge certifies as follows:

1. The Project's construction activities will be conducted wholly within 350 feet on either side of the existing Line 3 Pipeline centerline. (see N.D.C.C. § 49-22-03(3)(a)(1)(c)). All necessary right-of-way easements within the specified corridor have been acquired. Certification at ¶ 7.
2. An environmental analysis, conducted for Enbridge in March 2014, evaluated Enbridge's Project relative to the Exclusion and Avoidance Areas set forth in N.D. Admin. Code § 69-06-08-02, and the Project will not affect any known Exclusion or Avoidance Areas (see § 49-22-03(3)(a)(2) and (3)). Certification at ¶ 8. One Avoidance Area, a historic ox-cart trail known as Angle Road, which is an area of historic, archaeological, or paleontological significance, is located within the Project right-of-way. *Id.* at ¶ 9. However, Enbridge has previously avoided Angle Road by boring beneath it, and plans to do so again for the Project; therefore, the Project will not impact the site. *Id.*
3. Enbridge will comply with all applicable federal, state and local laws and permitting requirements, including all applicable conditions and protections in siting laws and rules (see N.D.C.C. § 49-22-03(3)(a)(3)). Certification at ¶ 10. As noted previously, since Line 3 was constructed prior to the Siting Act, no prior Commission orders exist that are applicable to the facility at issue. See Certification at ¶ 4.

Enbridge requests that the Commission acknowledge receipt of the attached Certification. Enbridge appreciates the time and attention provided to this matter by the Commission and its Staff. Please contact Sally Joyce, Regulatory Project Supervisor, at 713-353-6328 if you have any questions regarding this matter.

Sincerely,

A handwritten signature in black ink, appearing to read 'B. Shamla'.

Brad Shamla  
Vice President, US Operations

Attachment: Certification

cc: Ms. Illona Jeffcoat Sacco  
Mr. Patrick J. Fahn



8. An environmental analysis was conducted for the Project in March, 2014, to evaluate the Project relative to the Exclusion Areas and Avoidance Areas set forth in N.D. Admin. Code § 69-06-08-02, and the Project will not affect any known Exclusion or Avoidance Areas.

9. One Avoidance Area, a historic ox-cart trail known as Angle Road, which is an area of historic, archaeological, or paleontological significance, is located within the Project right-of-way. However, Enbridge has previously avoided Angle Road by boring beneath it, and intends to do so again for the Project; therefore, the Project will not impact the site.

10. Enbridge will comply with all applicable federal, state and local laws and permitting requirements, including all applicable conditions and protections in siting laws and rules.

11. Construction of the Project is scheduled to begin on or about May 12, 2014.

FURTHER AFFIANT SAYETH NOT.



Brad Shamla  
Vice President, US Operations

Subscribed and sworn to before me  
this 2nd day of May, 2014.

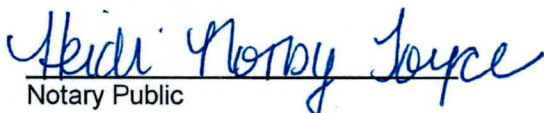

Notary Public

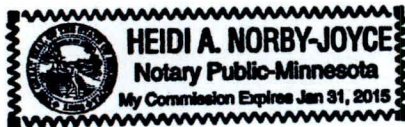

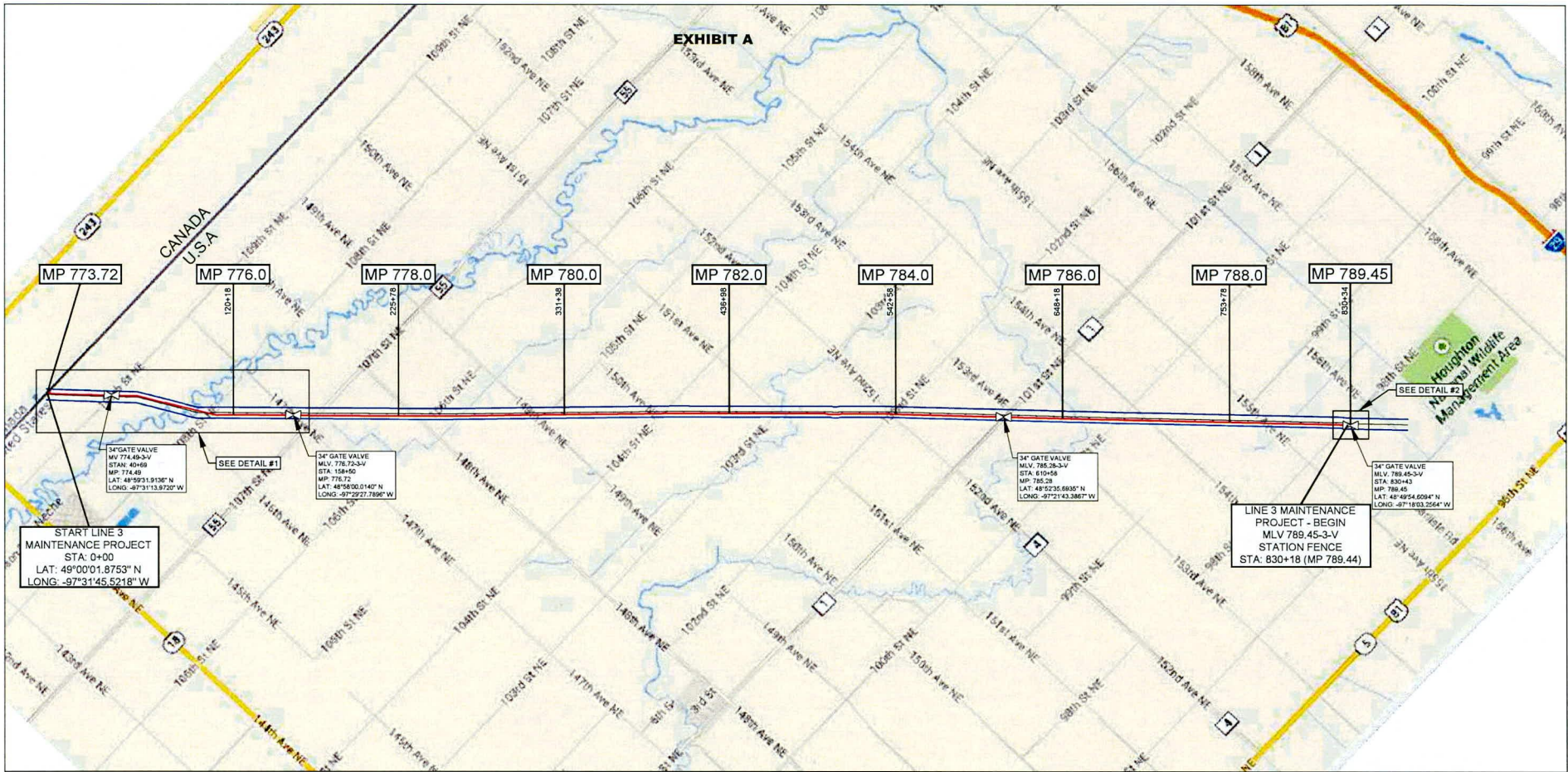

PIPE SPECIFICATIONS  
 MAIN LINE PIPE: 34in. O.D. x 0.600 W.T./API-5L/X-70/DSAW/14-16 MILS FBE  
 HDD & CROSSING PIPE: 34in. O.D. x 0.680 W.T./API-5L/X-70/DSAW/14-16 MILS FBE W/40 MILS ARO

PROJECT COORDINATE SYSTEM IS MINNESOTA STATE PLANE NORTH ZONE, NAMD 83, US FEET.

ELEVATION DATUM IS NAVD 88.



Enbridge Energy, Limited Partnership  
 By Enbridge Pipelines (Lakehead) L.L.C.  
 It's General Partner

**LINE 3 MAINTENANCE PROJECT**  
**PROPOSED 34 in. LINE 3 PIPELINE**  
 DISTANCE: 15.72 MILES  
 M.P. 773.7 TO M.P. 789.44

NO SCALE      REGULATORY MAP      03/12/14

