

400 North Fourth Street
Bismarck, ND 58501
(701) 222-7900

June 18, 2014

Executive Secretary
North Dakota Public Service Commission
State Capitol – Department 408
600 East Boulevard Avenue
Bismarck, ND 58505-0480

RE: Case No. PU-14-351
Application for Permanent Authority to
Extend Service to Tim Wickenheiser at
Almont, North Dakota

Montana-Dakota Utilities Co. (Montana Dakota), a Division of MDU Resources Group, Inc., herewith respectfully submits an original and one copy of an Application for Permanent Authority to extend electric service to Tim Wickenheiser at a location in the NE ¼ NW ¼ of Section 35, Township 131N, Range 76W, Emmons County, North Dakota.

Please acknowledge receipt by stamping or initialing the duplicate copy of this letter attached hereto and returning the same in the enclosed self-addressed, stamped envelope.

Sincerely,



Tamie A. Aberle
Director of Regulatory Affairs

Enclosures
cc/enc.

Gary Hulm - KEM Electric Cooperative
Don Bohle - Mobridge Office

**BEFORE THE PUBLIC SERVICE COMMISSION
OF THE STATE OF NORTH DAKOTA**

In the Matter of the Application)
of MONTANA-DAKOTA UTILITIES CO.,)
a Division of MDU Resources Group,)
Inc., for an Order and Certificate to)
Extend Service to Tim Wickenheiser)
at Strasburg, North Dakota)

Case No. PU-14-351

APPLICATION FOR PERMANENT AUTHORITY

MONTANA-DAKOTA UTILITIES CO., for its Application to the Public Service Commission of North Dakota, respectfully alleges:

I.

The full name of Applicant is Montana-Dakota Utilities Co., a Division of MDU Resources Group, Inc., and the post office address of its principal office is 400 North Fourth Street, Bismarck, North Dakota 58501. Applicant is a public utility subject to the jurisdiction of and regulation by the Public Service Commission of North Dakota, under Title 49, N.D.C.C., as amended. MDU Resources Group, Inc.'s Certificate of Incorporation is incorporated herein by reference, and the Commission is requested to take official notice of the same.

II.

This Application is made pursuant to the provisions of Chapter 49-03, N.D.C.C., as amended, and the Rules of Practice and Procedure promulgated by the Commission.

III.

Application has been requested by Tim Wickenheiser, hereinafter referred to as "Customer," to provide electric service to him at a point located in the NE ¼ NW ¼ of

Section 35, Township 131N, Range 76W, Emmons County, North Dakota as shown on the map attached hereto, marked Exhibit A, and made a part hereof by reference. Customer will need electric service in June 2014. Correspondence to the Customer should be directed to:

Tim Wickenheiser
8920 Hwy 83 SE
Strasburg, ND 58573

IV.

The service required by Customer at said location is underground grain bin service, and the length of the extension will be approximately 1500 feet, as shown by Exhibit A. The location of the proposed service is within the economic service area of Applicant and service will be extended under the provisions of the rules and regulations applicable thereto. It is Applicant's public utility obligation to furnish the requested service, and the public convenience and necessity requires, and will be served by, Applicant furnishing the requested service to this Customer at said location. The Temporary Authority Permit is attached as Exhibit B.

V.

Submitted as Exhibit C with this Application is an Appearance by Customer herein, in which Customer states to the Commission that he desires electric service from Applicant as a public utility subject to the jurisdiction of, and regulation by, this Commission. In said Appearance, Customer also waives Notice of Opportunity for Hearing and Notice of Hearing upon this Application, or a hearing thereon, and requests the Commission to issue an Order and Certificate of Public Convenience and Necessity authorizing this requested and needed service.

EXHIBIT A

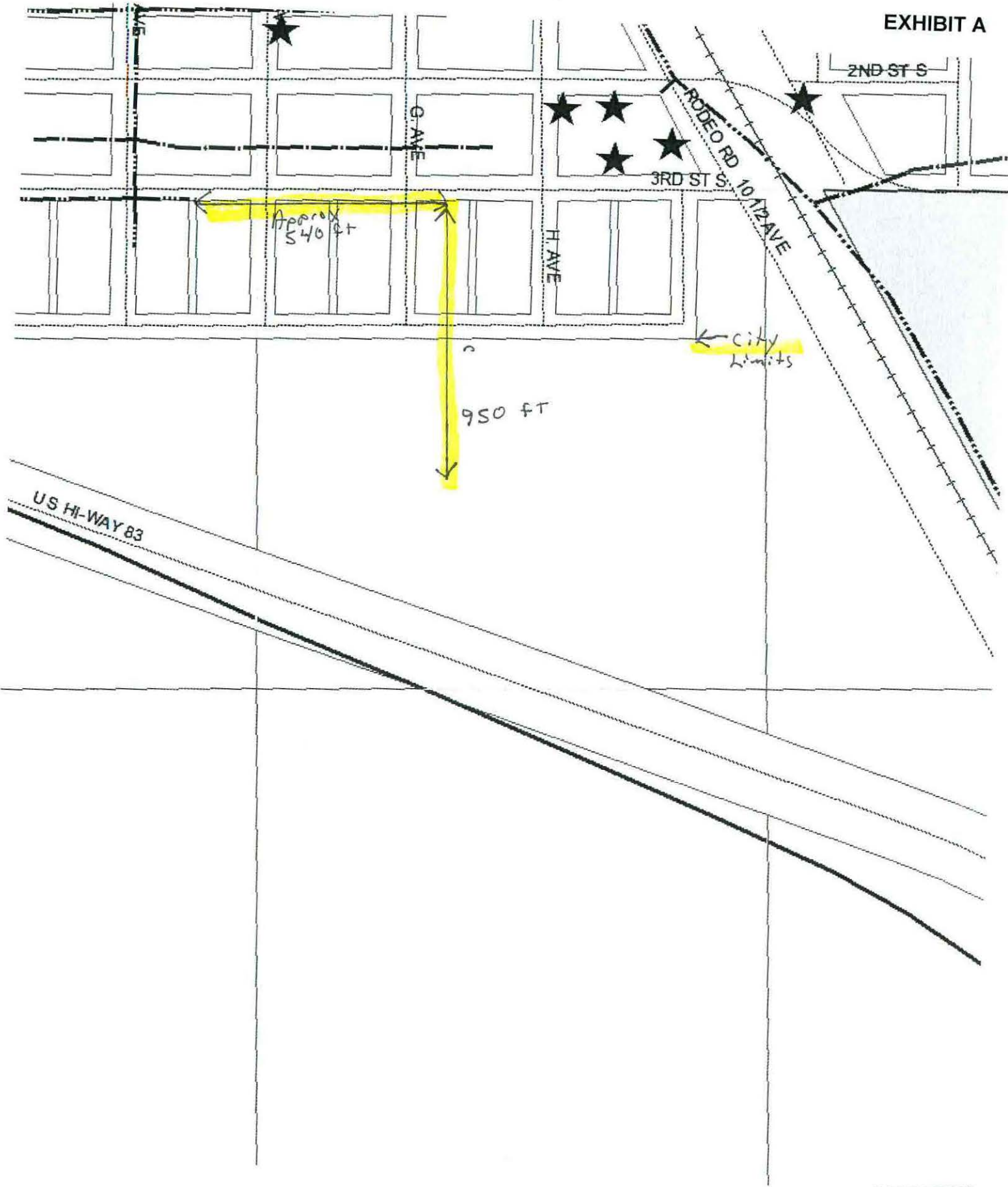



TEMPORARY AUTHORITY PERMIT
NORTH DAKOTA PUBLIC SERVICE COMMISSION
PUBLIC UTILITIES
 SFN 50560 (6-96)

EXHIBIT B

Date 6-4-14	Time 9:50	<input type="checkbox"/> a.m. <input checked="" type="checkbox"/> p.m.	Name of Utility Montana Dakota Util.	Telephone Number 605-845-3636
Name of Person Calling Don Bohle			Name of Coop Serving KEM	
Name of Customer Tim Wickenheiser		Location Sec NE35 Twp 131N R 76W		
Address			County Emmons	
City Strasburg			State ND	Zip Code
Name of Nearest City Strasburg			Distance to the City 600 ft	
When will service be extended? upon approval		Type of Service <input type="checkbox"/> Residence <input type="checkbox"/> Storage <input checked="" type="checkbox"/> Grain Bin <input type="checkbox"/> Other _____		
Extension Length to Most Economical Point of Service Utility: 1500 ft Coop: 1 mile		Extension <input type="checkbox"/> Overhead <input checked="" type="checkbox"/> Underground		
Has customer signed request for service? <input checked="" type="checkbox"/> Yes <input type="checkbox"/> No		Will cooperative protest application? <input type="checkbox"/> Yes <input checked="" type="checkbox"/> No		
Name of Person Contacted (PSC Use)		Date of Contact (PSC Use)	Time (PSC Use) <input type="checkbox"/> a.m. <input checked="" type="checkbox"/> p.m.	
Estimated Cost of Extension \$19,142		Estimated Revenue \$540		
Under what rate filed with the Public Service Commission will customer be served? rate 30				
Will extension cross over coop lines? <input type="checkbox"/> Yes <input checked="" type="checkbox"/> No		Will extension cross over railroad tracks? <input type="checkbox"/> Yes <input checked="" type="checkbox"/> No		
Temporary Authority Authorized By <input type="checkbox"/> Telephone <input type="checkbox"/> Letter		Date Authorized 6/11/14		
Authorized By (Name of Commissioner) <i>Mu Fedorchak</i>				

Extension must be made from most economical point of service.

Comments:
 this is going to be additional grain bin site with 4 air bins. The customer requested three phase power we will build 550' in city limits and then come from the edge of town 950' south to the bin site.

BEFORE THE PUBLIC SERVICE COMMISSION
OF THE STATE OF NORTH DAKOTA

EXHIBIT C

In the Matter of the Application of
Montana-Dakota Utilities Co.,
a Division of MDU Resources Group, Inc.

Case No. _____

APPEARANCE BY CUSTOMER

Tim Wickenheiser

hereinafter referred to as "Customer", hereby makes a voluntary appearance in this matter and states the following to the Commission:

I.

That he (it) desires electric service from Montana-Dakota Utilities Co. as a public utility subject to the jurisdiction of, and regulation by, this Commission, and has requested said public utility to provide him (it) with immediate electric service at the point located as stated in the Application herein.

That customer further states that he (it) is in need of and has demanded immediate service at said location for the reasons set forth in the Application herein. Customer waives notice of opportunity for hearing and notice of hearing upon said Application, or a hearing thereon, and requests the Commission to issue an Order and Certificate of Public Convenience and Necessity authorizing this requested and needed service, and that provisions be made therein authorizing extension of immediate service.

II.

That all the allegations of the Application herein are true and correct.

WHEREFORE, the undersigned, being the Customer involved herein, prays for the entry of an Order and Certificate of Public Convenience and Necessity by the Commission, authorizing the Applicant to immediately extend the requested and needed service to Customer at said location, subject to such appropriate and proper conditions to be appended to and made a part of such Temporary Order and Certificate as the Commission may determine, said Temporary Order and Certificate to become final as may be set forth in the conditions appended thereto; and for such other and further relief as may be proper in the premises.

Dated: 6/4/14

Tim Wickenheiser
(Customer)