

Exam Date: 12/08/2014

Full Circle Ag
 8997 Hwy 32
 Forman, ND
 County: Sargent
 Phone: 701-724-6213
 CCC Number:

Page: 1

Examiner: 1

Location/Container Numbers/Comments	Section	Capacity
PART A - ADDITIONAL SPACE TO BE INCLUDED UNDER LICENSE		
310	G	610,236
311	G	610,236
bunker 03	Z	480,675
bunker 04	Z	480,675
		Total: 2,181,822

PART B - SPACE TO BE DELETED UNDER LICENSE

<NO BINS DELETED>

Total: 0

PART C - ALL SPACE TO BE INCLUDED UNDER LICENSE

A	202,000
C	472,000
F	18,000
G	2,469,000
H	1,011,000
N	260,000
Z	1,804,000
Total: 6,236,000	

PART D - TOTAL CAPACITY BY FUNCTIONAL UNIT

Forman	1240	G H Z	5,284,000
Gwinner	1239	A C F N	952,000
			Total: 6,236,000

NDPSC Bin Capacity Chart

Exam Date: 12/08/2014

Full Circle Ag
8997 Hwy 32
Forman, ND
County: Sargent

Examiner: 1

Status	Section	Bin Number	Bin Type	Base Point	Diameter or Bu/Ft (Irreg.)	Length	Width	Side wall	Add for Hopper	Ded. for Obst.	Effective Depth	Add for Peak	Depth for Capac.	Bushels per Foot	Base Pack%	Bushel Capacity with Pack
--------	---------	------------	----------	------------	-------------------------------	--------	-------	--------------	----------------------	----------------------	--------------------	--------------------	------------------------	------------------------	---------------	------------------------------

Facility: Forman

Section: G

	G	301	Peaked	top of sidewall	33.000	0.000	0.000	66.10	0.00	0.00	66.100	2.000	68.1	687.5	9.50	51,267
	G	302	Peaked	top of sidewall	33.000	0.000	0.000	66.10	0.00	0.00	66.100	2.000	68.1	687.5	9.50	51,267
	G	303	Peaked	top of sidewall	48.000	0.000	0.000	61.40	0.00	0.00	61.400	3.400	64.8	1454.6	10.0	103,684
	G	304	Peaked	top of sidewall	48.000	0.000	0.000	61.40	0.00	0.00	61.400	3.400	64.8	1454.6	10.0	103,684
	G	305	Peaked	top of sidewall	48.000	0.000	0.000	61.40	0.00	0.00	61.400	3.400	64.8	1454.6	10.0	103,684
	G	306	Peaked	top of sidewall	48.000	0.000	0.000	61.40	0.00	0.00	61.400	3.400	64.8	1454.6	10.0	103,684
	G	307	Peaked	top of sidewall	78.000	0.000	0.000	61.40	0.00	0.00	61.400	5.500	66.9	3841.1	10.0	282,667
	G	308	Peaked	top of sidewall	78.000	0.000	0.000	61.40	0.00	0.00	61.400	5.500	66.9	3841.1	10.0	282,667
	G	309	Peaked	top of sidewall	55.800	0.000	0.000	72.50	0.00	0.00	72.500	3.900	76.4	1965.8	10.0	165,206
Added	G	310	Peaked	top of sidewall	105.00	0.000	0.000	72.30	0.00	0.00	72.300	7.400	79.7	6960.6	10.0	610,236
Added	G	311	Peaked	top of sidewall	105.00	0.000	0.000	72.30	0.00	0.00	72.300	7.400	79.7	6960.6	10.0	610,236

Bin count: 11

Facility: Forman Section: G Total: **2,468,282**

To Even: **2,469,000**

Section: H

	H	300	Flat	top of sidewall	25.000	406.5	133.3	10.00	0.00	0.00	10.000	11.10	21.1	43558.2	10.0	1,010,986
--	---	-----	------	-----------------	--------	-------	-------	-------	------	------	--------	-------	------	---------	------	-----------

Bin count: 1

Facility: Forman Section: H Total: **1,010,986**

To Even: **1,011,000**

Client ID: 3891

NDPSC Bin Capacity Chart

01/09/2015 11:16:22 AM

Exam Date: 12/08/2014

Full Circle Ag
8997 Hwy 32
Forman, ND
County: Sargent

Page: 2

Examiner: 1

Status	Section	Bin Number	Bin Type	Base Point	Diameter or Bu/Ft (Irreg.)	Length	Width	Side wall	Add for Hopper	Ded. for Obst.	Effective Depth	Add for Peak	Depth for Capac.	Bushels per Foot	Base Pack%	Bushel Capacity with Pack
--------	---------	------------	----------	------------	-------------------------------	--------	-------	--------------	----------------------	----------------------	--------------------	--------------------	------------------------	------------------------	---------------	------------------------------

Facility: Forman

Section: Z

	Z	bunker 01	Temporary		22.500	300.0	120.0	3.750	0.00	0.00	3.750	10.00	13.8	27737.9	10.0	421,061
	Z	bunker 02	Temporary		22.500	300.0	120.0	3.750	0.00	0.00	3.750	10.00	13.8	27737.9	10.0	421,061
Added	Z	bunker 03	Temporary		22.500	300.0	120.0	5.250	0.00	0.00	5.250	9.800	15.1	28938.9	10.0	480,675
Added	Z	bunker 04	Temporary		22.500	300.0	120.0	5.250	0.00	0.00	5.250	9.800	15.1	28938.9	10.0	480,675

Bin count: 4

Facility: Forman Section: Z Total: **1,803,472**

To Even: **1,804,000**

Exam Date: 12/08/2014

Full Circle Ag
8997 Hwy 32
Forman, ND
County: Sargent

Page: 3

Examiner: 1

Status	Section	Bin Number	Bin Type	Base Point	Diameter or Bu/Ft (Irreg.) Length	Width	Side wall	Add for Hopper	Ded. for Obst.	Effective Depth	Add for Peak	Depth for Capac.	Bushels per Foot	Base Pack%	Bushel Capacity with Pack
--------	---------	------------	----------	------------	---	-------	--------------	----------------------	----------------------	--------------------	--------------------	------------------------	------------------------	---------------	------------------------------

Facility: Gwinner

Section: A

A	001	Square	work floor		0.000	11.50	3.200	47.00	0.00	0.00	47.000	0.000	47.0	29.6	2.50	1,426
A	002	Square	work floor		0.000	7.000	3.500	22.00	0.00	0.00	22.000	0.000	22.0	19.7	2.00	442
A	003	Square	work floor		0.000	6.000	5.500	49.00	0.00	0.00	49.000	0.000	49.0	26.5	2.50	1,331
A	004	Square	work floor		0.000	6.000	5.500	49.00	0.00	0.00	49.000	0.000	49.0	26.5	2.50	1,331
A	005 T	Square	work floor		0.000	12.50	5.500	49.00	0.00	0.00	49.000	0.000	49.0	55.3	4.80	2,840
A	005 B	Square	work floor -top 49'		0.000	12.50	11.50	15.00	0.00	0.00	15.000	0.000	15.0	115.6	6.20	1,842
A	006	Square	work floor		0.000	12.50	5.200	49.00	0.00	0.00	49.000	0.000	49.0	52.3	4.50	2,678
A	007	Square	work floor		0.000	6.200	5.200	48.00	0.00	0.00	48.000	0.000	48.0	25.9	2.50	1,274
A	008	Square	work floor		0.000	12.50	5.500	49.00	0.00	0.00	49.000	0.000	49.0	55.3	4.80	2,840
A	009	Square	work floor		0.000	12.50	5.500	49.00	0.00	0.00	49.000	0.000	49.0	55.3	4.80	2,840
A	010 T	Square	work floor		0.000	5.500	2.000	12.00	0.00	0.00	12.000	0.000	12.0	8.8	2.00	108
A	010 B	Square	work floor-top 12'		0.000	6.200	5.500	36.00	0.00	0.00	36.000	0.000	36.0	27.4	2.50	1,011
A	011 T	Square	work floor		0.000	12.50	5.500	49.00	0.00	0.00	49.000	0.000	49.0	55.3	4.80	2,840
A	011 B	Square	work floor - top 49'		0.000	12.50	11.50	15.00	0.00	0.00	15.000	0.000	15.0	115.6	6.20	1,842
A	013	Square	work floor		0.000	11.50	6.200	49.00	0.00	0.00	49.000	0.000	49.0	57.3	4.80	2,943
A	014	Square	work floor		0.000	11.50	6.500	49.00	0.00	0.00	49.000	0.000	49.0	60.1	4.80	3,086
A	015	Square	work floor		0.000	6.500	5.500	48.00	0.00	0.00	48.000	0.000	48.0	28.7	2.50	1,412
A	016 T	Square	work floor		0.000	12.50	5.500	49.00	0.00	0.00	49.000	0.000	49.0	55.3	4.80	2,840
A	016 B	Square	work floor -top 49'		0.000	12.50	11.50	15.00	0.00	0.00	15.000	0.000	15.0	115.6	6.20	1,842
A	017	Square	work floor		0.000	12.50	5.500	49.00	0.00	0.00	49.000	0.000	49.0	55.3	4.80	2,840
A	018	Square	work floor		0.000	12.50	5.500	49.00	0.00	0.00	49.000	0.000	49.0	55.3	4.80	2,840

Exam Date: 12/08/2014

Full Circle Ag
8997 Hwy 32
Forman, ND
County: Sargent

Page: 4

Examiner: 1

Status	Section	Bin Number	Bin Type	Base Point	Diameter or Bu/Ft (Irreg.) Length	Width	Side wall	Add for Hopper	Ded. for Obst.	Effective Depth	Add for Peak	Depth for Capac.	Bushels per Foot	Base Pack%	Bushel Capacity with Pack
--------	---------	------------	----------	------------	---	-------	--------------	----------------------	----------------------	--------------------	--------------------	------------------------	------------------------	---------------	------------------------------

Facility: Gwinner

Section: A

A	020	Square	work floor		0.000	12.50	5.200	49.00	0.00	0.00	49.000	0.000	49.0	52.3	4.50	2,678
A	021 T	Square	work floor		0.000	12.50	5.500	49.00	0.00	0.00	49.000	0.000	49.0	55.3	4.80	2,840
A	021 B	Square	work floor -top 49'		0.000	12.50	11.50	15.00	0.00	0.00	15.000	0.000	15.0	115.6	6.20	1,842
A	022	Square	work floor		0.000	11.50	3.200	47.00	0.00	0.00	47.000	0.000	47.0	29.6	2.50	1,426
A	023	Square	work floor		0.000	6.000	5.500	49.00	0.00	0.00	49.000	0.000	49.0	26.5	2.50	1,331
A	024	Square	work floor		0.000	6.000	5.500	49.00	0.00	0.00	49.000	0.000	49.0	26.5	2.50	1,331
A	025	Square	work floor		0.000	6.500	5.200	48.00	0.00	0.00	48.000	0.000	48.0	27.2	2.50	1,339
A	101 T	Square	work floor		0.000	14.00	12.50	49.00	0.00	0.00	49.000	0.000	49.0	140.7	6.80	7,363
A	101 B	Square	work floor- top 49'		0.000	15.50	14.00	11.00	0.00	0.00	11.000	0.000	11.0	174.4	7.00	2,052
A	102	Square	work floor		0.000	14.00	13.70	60.00	0.00	0.00	60.000	0.000	60.0	154.2	6.80	9,881
A	103A	Square	work floor		0.000	14.00	14.00	22.00	0.00	0.00	22.000	0.000	22.0	157.6	7.00	3,710
A	103B T	Square	work floor		0.000	14.00	14.00	31.00	0.00	0.00	31.000	0.000	31.0	157.6	7.00	5,228
A	103B B	Square	work floor -top 31' blind bin		0.000	14.00	10.30	7.000	0.00	0.00	7.000	0.000	7.0	115.9	6.20	861
A	104	Square	work floor		0.000	13.60	6.200	49.00	0.00	0.00	49.000	0.000	49.0	67.8	5.20	3,495
A	105	Square	work floor		0.000	14.00	13.60	60.00	0.00	0.00	60.000	0.000	60.0	153.1	6.80	9,811
A	106	Square	work floor		0.000	15.20	14.00	60.00	0.00	0.00	60.000	0.000	60.0	171.1	7.00	10,985
A	107	Square	work floor		0.000	15.20	6.200	49.00	0.00	0.00	49.000	0.000	49.0	75.8	5.50	3,918
A	109	Square	work floor		0.000	15.20	14.00	60.00	0.00	0.00	60.000	0.000	60.0	171.1	7.00	10,985
A	111	Square	work floor		0.000	14.00	13.60	60.00	0.00	0.00	60.000	0.000	60.0	153.1	6.80	9,811
A	112 T	Square	work floor		0.000	14.00	14.00	53.00	0.00	0.00	53.000	0.000	53.0	157.6	7.00	8,938
A	112 B	Square	work floor -top 53'		0.000	14.00	10.30	7.000	0.00	0.00	7.000	0.000	7.0	115.9	6.20	861

NDPSC Bin Capacity Chart

Exam Date: 12/08/2014

Full Circle Ag
8997 Hwy 32
Forman, ND
County: Sargent

Examiner: 1

Status	Section	Bin Number	Bin Type	Base Point	Diameter or Bu/Ft (Irreg.)		Side wall	Add for Hopper	Ded. for Obst.	Effective Depth	Add for Peak	Depth for Capac.	Bushels per Foot	Base Pack%	Bushel Capacity with Pack
					Length	Width									

Facility: Gwinner

Section: A

A	113	Square	work floor	0.000	14.00	13.70	60.00	0.00	0.00	60.000	0.000	60.0	154.2	6.80	9,881
A	114 T	Square	work floor	0.000	14.00	12.50	49.00	0.00	0.00	49.000	0.000	49.0	140.7	6.80	7,363
A	114 B	Square	work floor -top 49'	0.000	15.50	14.00	11.00	0.00	0.00	11.000	0.000	11.0	174.4	7.00	2,052
A	115	Square	work floor	0.000	13.70	6.200	49.00	0.00	0.00	49.000	0.000	49.0	68.3	5.20	3,521
A	116	Square	work floor	0.000	12.40	6.200	49.00	0.00	0.00	49.000	0.000	49.0	61.8	4.80	3,173
A	201	Peaked	top of sidewall	24.000	0.000	0.000	40.00	0.00	0.00	40.000	1.400	41.4	363.7	7.80	16,231
A	202	Peaked	top of sidewall	24.000	0.000	0.000	40.00	0.00	0.00	40.000	1.400	41.4	363.7	7.80	16,231
Bin count: 49															Facility: Gwinner Section: A Total: 201,586
														To Even: 202,000	

Section: C

C	001	Peaked	top of sidewall	40.400	0.000	0.000	39.00	0.00	0.00	39.000	2.400	41.4	1030.5	10.0	46,929
C	002	Peaked	top of sidewall	40.400	0.000	0.000	39.00	0.00	0.00	39.000	2.400	41.4	1030.5	10.0	46,929
C	003	Peaked	top of sidewall	40.400	0.000	0.000	39.00	0.00	0.00	39.000	2.400	41.4	1030.5	10.0	46,929
C	004	Peaked	top of sidewall	40.400	0.000	0.000	39.00	0.00	0.00	39.000	2.400	41.4	1030.5	10.0	46,929
C	005	Peaked	top of sidewall	40.400	0.000	0.000	39.00	0.00	0.00	39.000	2.400	41.4	1030.5	10.0	46,929
C	006	Peaked	top of sidewall	40.400	0.000	0.000	39.00	0.00	0.00	39.000	2.400	41.4	1030.5	10.0	46,929
C	007	Peaked	top of sidewall	40.400	0.000	0.000	39.00	0.00	0.00	39.000	2.400	41.4	1030.5	10.0	46,929
C	008	Peaked	top of sidewall	40.400	0.000	0.000	39.00	0.00	0.00	39.000	2.400	41.4	1030.5	10.0	46,929
C	009	Peaked	top of sidewall	40.400	0.000	0.000	39.00	0.00	0.00	39.000	2.400	41.4	1030.5	10.0	46,929

NDPSC Bin Capacity Chart

Exam Date: 12/08/2014

Full Circle Ag
8997 Hwy 32
Forman, ND
County: Sargent

Examiner: 1

Status	Section	Bin Number	Bin Type	Base Point	Diameter or Bu/Ft (Irreg.)	Length	Width	Side wall	Add for Hopper	Ded. for Obst.	Effective Depth	Add for Peak	Depth for Capac.	Bushels per Foot	Base Pack%	Bushel Capacity with Pack
--------	---------	------------	----------	------------	-------------------------------	--------	-------	--------------	----------------------	----------------------	--------------------	--------------------	------------------------	------------------------	---------------	------------------------------

Facility: Gwinner

Section: C

C	010	Peaked	top of sidewall	40.400	0.000	0.000	39.00	0.00	0.00	39.000	2.400	41.4	1030.5	10.0	46,929
C	Load Out	Peaked	top of sidewall	16.000	0.000	0.000	10.00	2.30	0.00	12.300	1.000	13.3	161.6	5.80	2,274
Bin count:		11													
														Facility: Gwinner Section: C Total:	471,564
														To Even:	472,000

Section: F

F	001	Peaked	top of sidewall	15.000	0.000	0.000	22.00	0.00	0.00	22.000	0.900	22.9	142.1	5.50	3,433
F	002	Peaked	top of sidewall	15.000	0.000	0.000	22.00	0.00	0.00	22.000	0.900	22.9	142.1	5.50	3,433
F	003	Peaked	top of sidewall	15.000	0.000	0.000	22.00	0.00	0.00	22.000	0.900	22.9	142.1	5.50	3,433
F	004	Peaked	top of sidewall	15.000	0.000	0.000	22.00	0.00	0.00	22.000	0.900	22.9	142.1	5.50	3,433
F	005	Peaked	top of sidewall	15.000	0.000	0.000	22.00	0.00	0.00	22.000	0.900	22.9	142.1	5.50	3,433
Bin count:		5													
														Facility: Gwinner Section: F Total:	17,165
														To Even:	18,000

Section: N

N	013	Peaked	top of side wall	36.000	0.000	0.000	25.90	0.00	0.00	25.900	2.200	28.1	818.2	10.0	25,290
N	014	Peaked	top of side wall	36.000	0.000	0.000	25.90	0.00	0.00	25.900	2.200	28.1	818.2	10.0	25,290
N	017	Peaked	top of sidewall	42.000	0.000	0.000	25.90	0.00	0.00	25.900	2.500	28.4	1113.7	10.0	34,792
N	018	Peaked	top of sidewall	42.000	0.000	0.000	25.90	0.00	0.00	25.900	2.500	28.4	1113.7	10.0	34,792
N	019	Peaked	top of sidewall	42.000	0.000	0.000	25.90	0.00	0.00	25.900	2.500	28.4	1113.7	10.0	34,792

Client ID: 3891

NDPSC Bin Capacity Chart

01/09/2015 11:16:22 AM

Exam Date: 12/08/2014

Full Circle Ag
8997 Hwy 32
Forman, ND
County: Sargent

Page: 7

Examiner: 1

Status	Section	Bin Number	Bin Type	Base Point	Diameter or Bu/Ft (Irreg.)	Length	Width	Side wall	Add for Hopper	Ded. for Obst.	Effective Depth	Add for Peak	Depth for Capac.	Bushels per Foot	Base Pack%	Bushel Capacity with Pack
--------	---------	------------	----------	------------	-------------------------------	--------	-------	--------------	----------------------	----------------------	--------------------	--------------------	------------------------	------------------------	---------------	------------------------------

Facility: Gwinner

Section: N

N	020	Peaked	top of sidewall	42.000	0.000	0.000	25.90	0.00	0.00	25.900	2.500	28.4	1113.7	10.0	34,792
N	021	Peaked	top of sidewall	42.000	0.000	0.000	25.90	0.00	0.00	25.900	2.500	28.4	1113.7	10.0	34,792
N	022	Peaked	top of sidewall	42.000	0.000	0.000	25.90	0.00	0.00	25.900	2.500	28.4	1113.7	10.0	34,792

Bin count: 8

Facility: Gwinner Section: N Total: 259,332

To Even: 260,000

Overall Licensed Bin Capacity for:

Full Circle Ag

Bin count: 89

Licensed Capacity:
(includes pack)

6,232,387 Bu.

Licensed Capacity (to even):
(includes pack and section totals are
rounded up to next highest 1000)

6,236,000 Bu.

Full Circle Ag
Forman
Section G

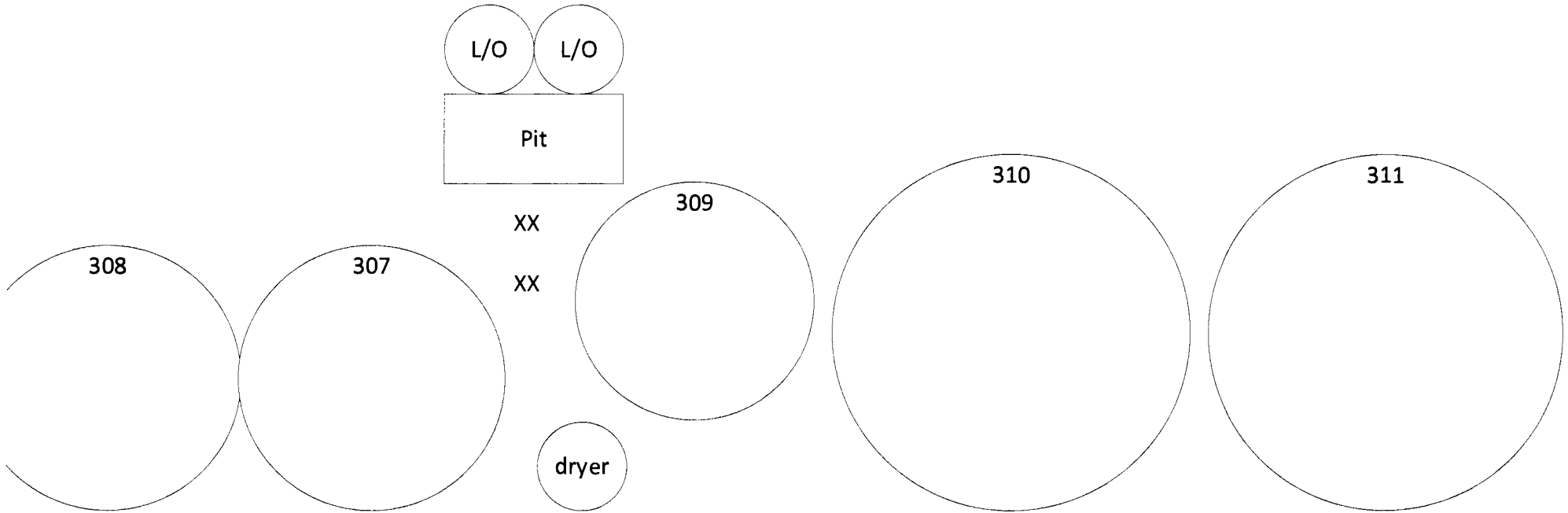
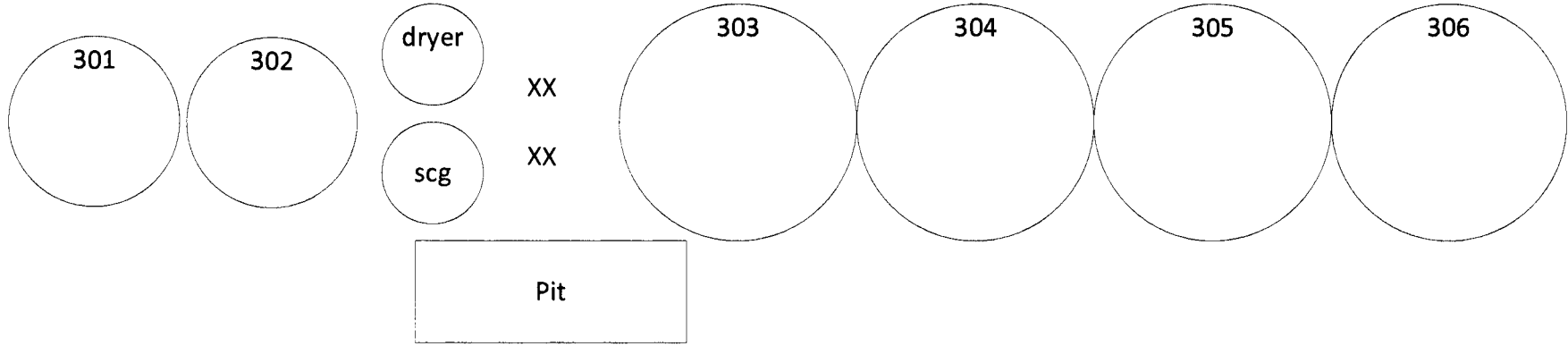
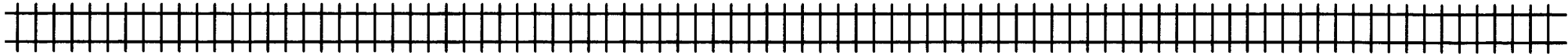

Full Circle Ag
Forman
Section H

Base Dimensions

Inside width 133.3' x inside length 406.6'

Grain wall ht. 9.5'

Using 20.5 degree angle of repose = peak ht. above grain wall of 25'

Angled offset = 66.65'

Center grain peak ht. ground to top = 34.5'

Capacity

43,558.2 bu/ft x 20.6' adjusted grain depth x 1.1 (10% pack) = 988,000 bushels

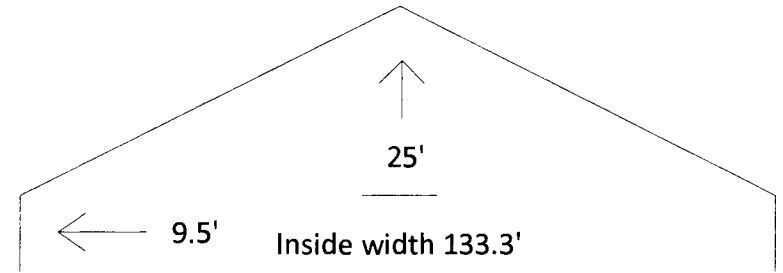

Inside length 406.5'

Full Circle Ag
Gwinner Location
Sections A & F

Note-103B is blind bin under 103A

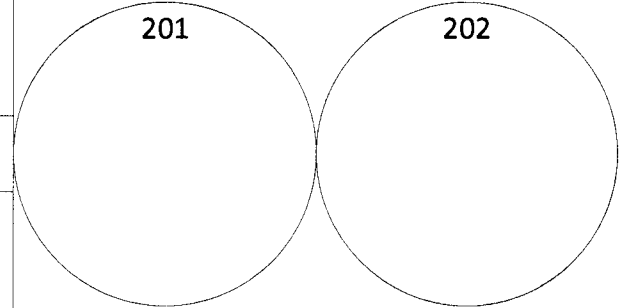
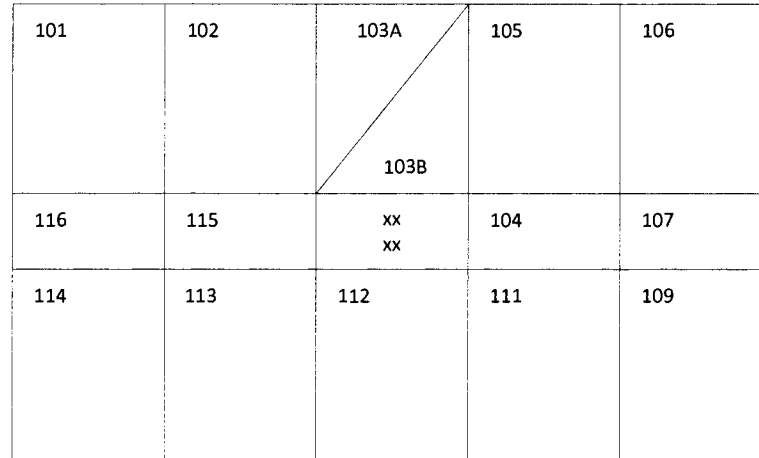
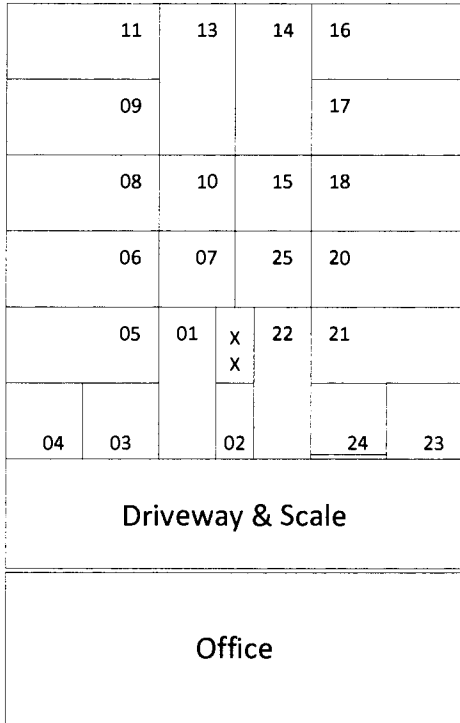

Section A

Section C

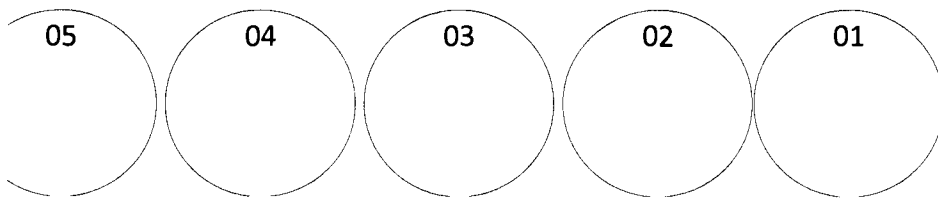

Section F

Full Circle Ag
Gwinner Location
Section C

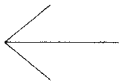
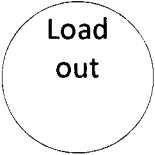
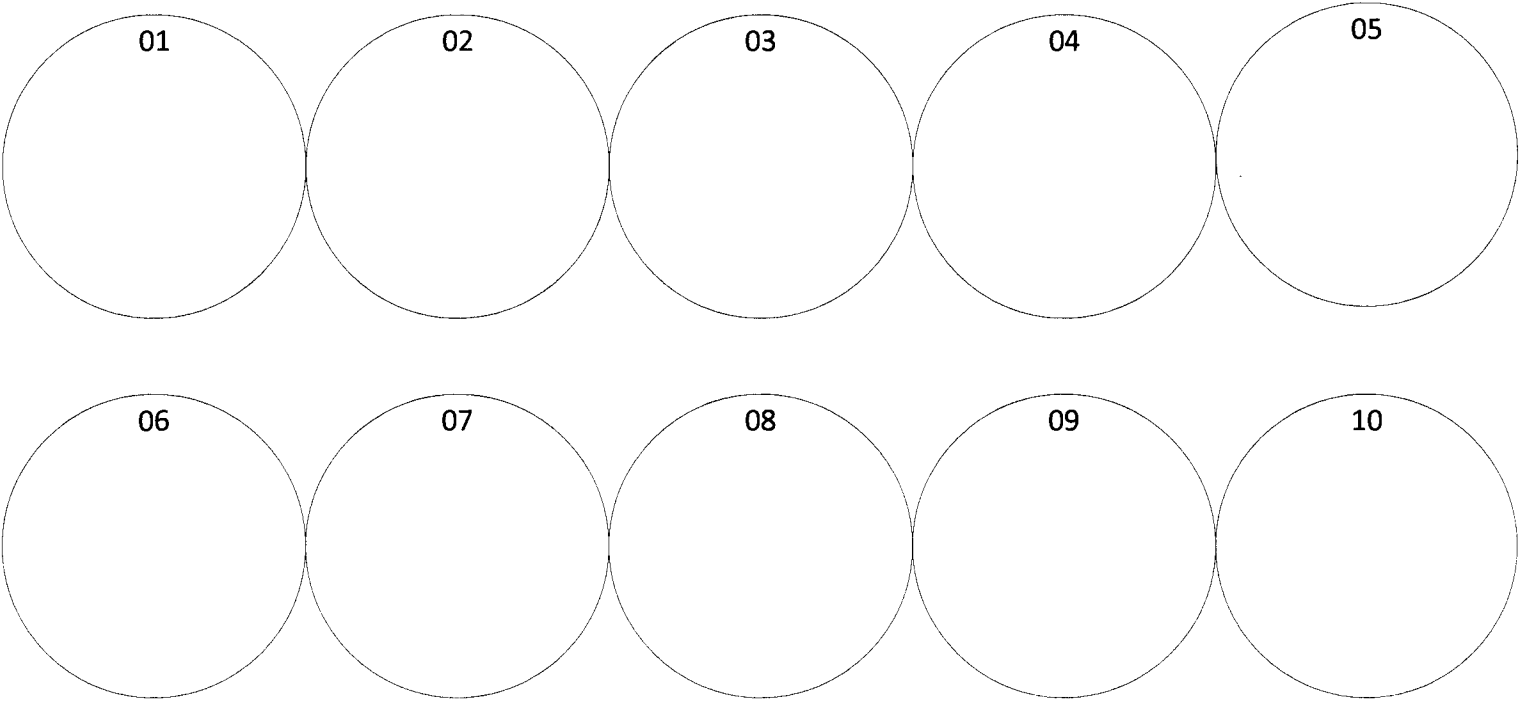

Section A

Full Circle Ag
Bin site – 2 miles west of
Gwinner on Hwy 13
Section N

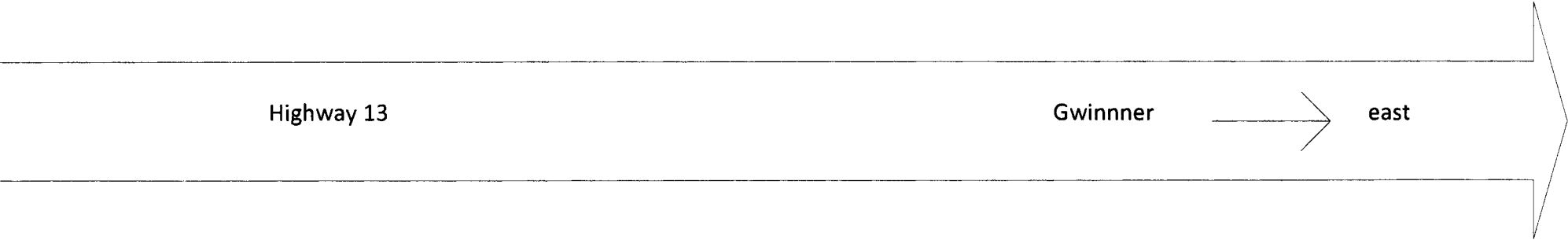
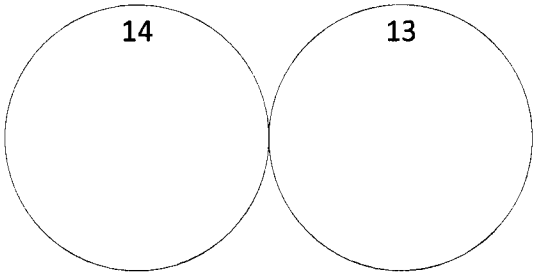
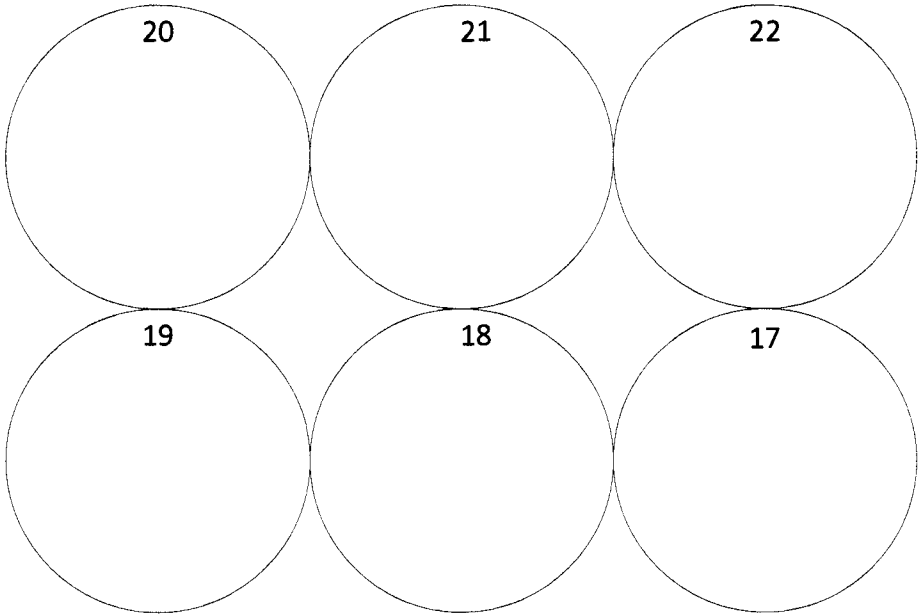

Full Circle Ag
Forman, ND
Section Z

← Section G

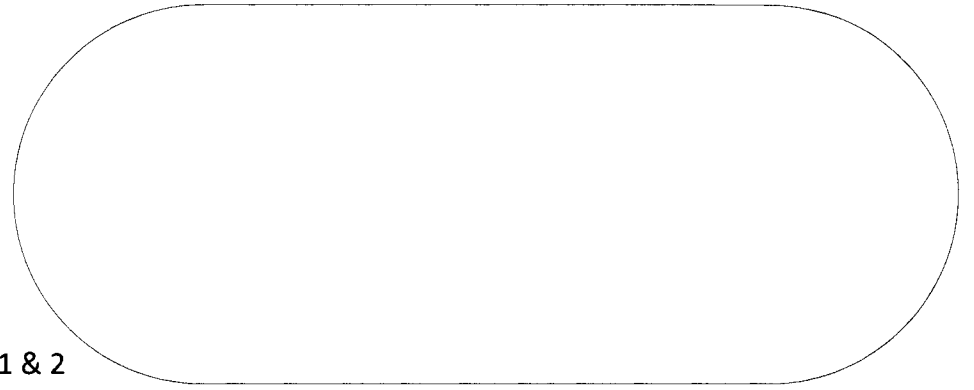
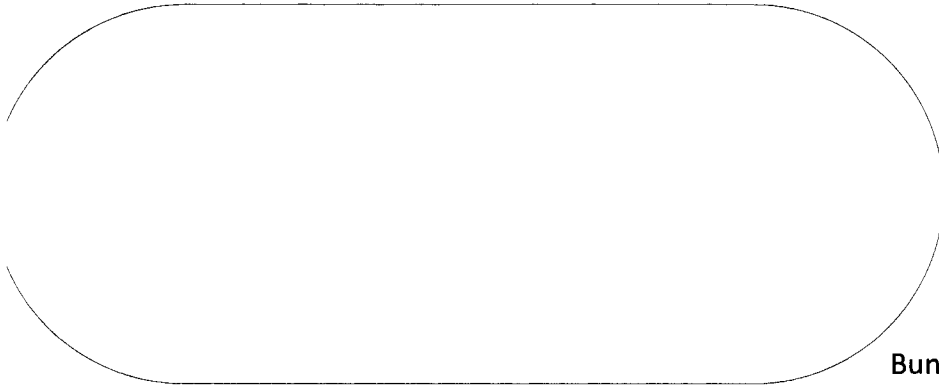

Bunkers 1 & 2
3.75' sidewall

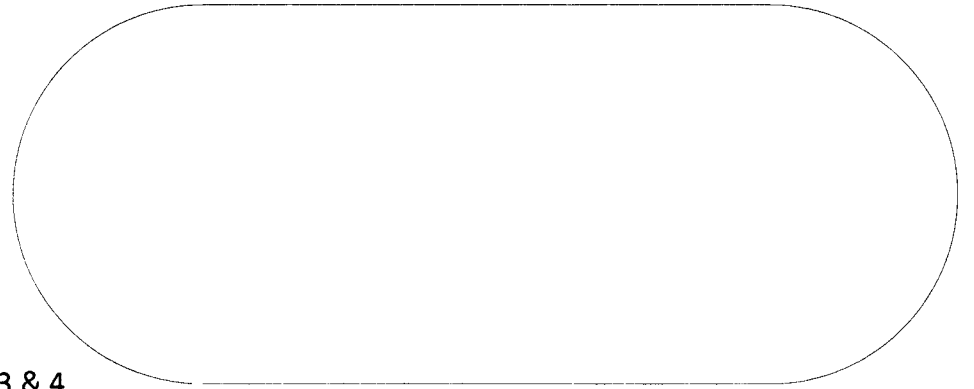
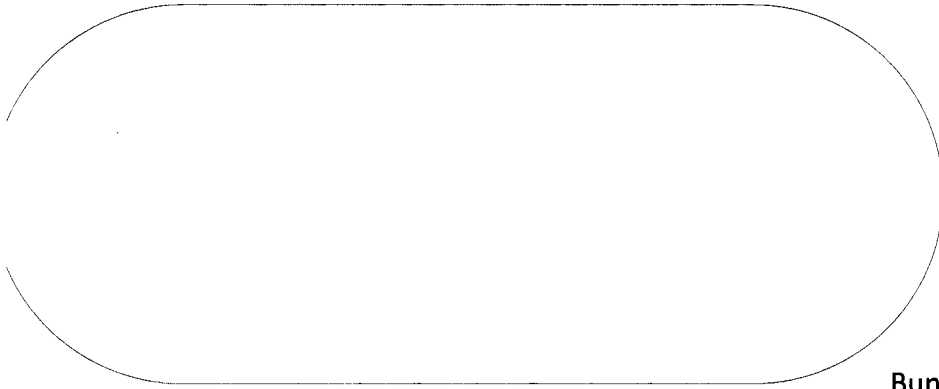

Bunkers 3 & 4
5.25' sidewall

Bunkers 1-2-3-4
120' wide & 300' long
60' offset & 22.5' peak ht.