



**TEMPORARY AUTHORITY PERMIT**  
 NORTH DAKOTA PUBLIC SERVICE COMMISSION  
 PUBLIC UTILITIES  
 SFN 50560 (6-96)

Date 7/11/2014	Time 10:00 <input type="checkbox"/> a.m. <input type="checkbox"/> p.m.	Name of Utility Montana-Dakota Utilities Co.	Telephone Number 1-701-224-5815
Name of Person Calling Craig Lohstrefer		Name of Coop Serving Mor-Gran-Sou	
Name of Customer Chris or Anna Cook		Location Sec SE28 Twp 139N R 84W	
Address 4951 County Rd 84		County Morton	
City Judson		State ND	Zip Code 58563
Name of Nearest City Judson		Distance to the City Just on west side of city limits	
When will service be extended? July, 2014		Type of Service <input checked="" type="checkbox"/> Residence <input type="checkbox"/> Storage <input type="checkbox"/> Grain Bin <input type="checkbox"/> Other _____	
Extension Length to Most Economical Point of Service Utility: 500' Coop: 1320'		Extension <input checked="" type="checkbox"/> Overhead <input type="checkbox"/> Underground	
Has customer signed request for service? <input checked="" type="checkbox"/> Yes <input type="checkbox"/> No		Will cooperative protest application? <input type="checkbox"/> Yes <input type="checkbox"/> No	
Name of Person Contacted (PSC Use)		Date of Contact (PSC Use)	Time (PSC Use) <input type="checkbox"/> a.m. <input type="checkbox"/> p.m.
Estimated Cost of Extension \$5,044.00		Estimated Revenue \$2,400.00 annual	
Under what rate filed with the Public Service Commission will customer be served? Rate 10			
Will extension cross over coop lines? <input type="checkbox"/> Yes <input checked="" type="checkbox"/> No		Will extension cross over railroad tracks? <input type="checkbox"/> Yes <input checked="" type="checkbox"/> No	
Temporary Authority Authorized By <input type="checkbox"/> Telephone <input type="checkbox"/> Letter		Date Authorized	
Authorized By (Name of Commissioner)			

Extension must be made from most economical point of service.

**Comments:**  
 Overhead construction from existing MDU overhead primary three phase on west side of County Rd 84. Extend overhead primary single phase west approximately 350' to deadend pole with a transformer. From transformer pole, 150' single phase underground service to house.

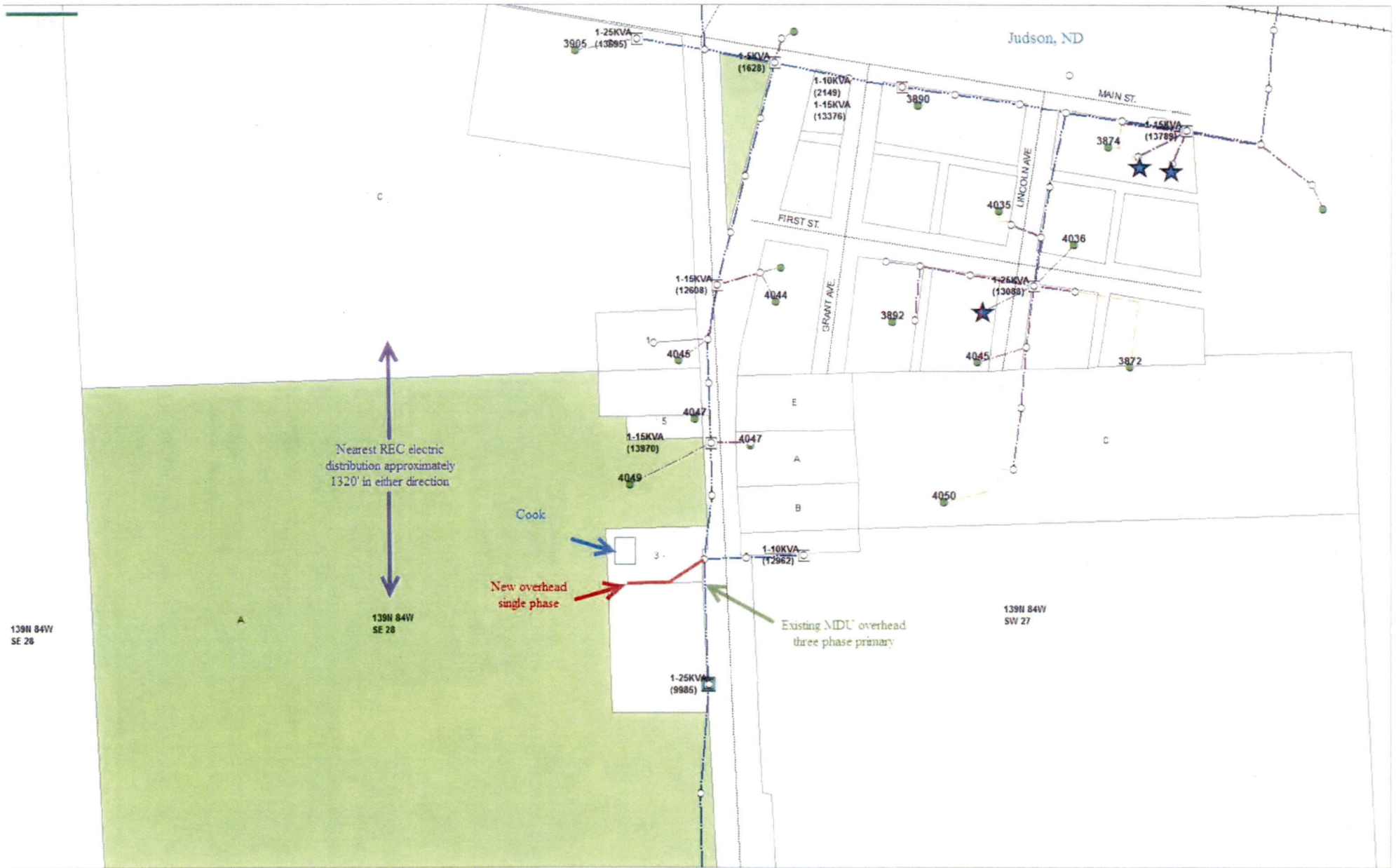

BEFORE THE PUBLIC SERVICE COMMISSION  
OF THE STATE OF NORTH DAKOTA

In the Matter of the Application of  
Montana-Dakota Utilities Co.,  
a Division of MDU Resources Group, Inc.

Case No. \_\_\_\_\_

**APPEARANCE BY CUSTOMER**

Chris or Anna Cook

hereinafter referred to as "Customer", hereby makes a voluntary appearance in this matter and states the following to the Commission:

I.

That he (it) desires electric service from Montana-Dakota Utilities Co. as a public utility subject to the jurisdiction of, and regulation by, this Commission, and has requested said public utility to provide him (it) with immediate electric service at the point located as stated in the Application herein.

That customer further states that he (it) is in need of and has demanded immediate service at said location for the reasons set forth in the Application herein. Customer waives notice of opportunity for hearing and notice of hearing upon said Application, or a hearing thereon, and requests the Commission to issue an Order and Certificate of Public Convenience and Necessity authorizing this requested and needed service, and that provisions be made therein authorizing extension of immediate service.

II.

That all the allegations of the Application herein are true and correct.

WHEREFORE, the undersigned, being the Customer involved herein, prays for the entry of an Order and Certificate of Public Convenience and Necessity by the Commission, authorizing the Applicant to immediately extend the requested and needed service to Customer at said location, subject to such appropriate and proper conditions to be appended to and made a part of such Temporary Order and Certificate as the Commission may determine, said Temporary Order and Certificate to become final as may be set forth in the conditions appended thereto; and for such other and further relief as may be proper in the premises.

Dated: 7-17-14

Chris Cook  
(Customer)