



Public Service Commission

State of North Dakota

COMMISSIONERS

Brian P. Kalk
Randy Christmann
Julie Fedorchak

Executive Secretary
Darrell Nitschke

600 East Boulevard, Dept. 408
Bismarck, North Dakota 58505-0480
Web: www.psc.nd.gov
E-mail: ndpsc@nd.gov
Phone: 701-328-2400
ND Toll Free: 1-877-245-6685
Fax: 701-328-2410
TDD: 800-366-6888 or 711

October 30, 2014

Geri Coyne
Otter Tail Power Company
gcoyne@otpc.com

Reference: PU-14-765 Temporary Authority Permit

Dear Ms. Coyne:

We received your request to extend electric service to Canadian Pacific Railway Company at a site located in the SW ¼, NE 1/4, Section 20, Township 130N, R 48W, Richland County, North Dakota. Temporary authority was granted by Commissioner Julie Fedorchak on October 29, 2014. Extensions must be made from the most economical point of service.

Please submit your formal application for permanent authority as soon as possible so we may work on finalizing this request. Thank you.

Best regards,

A handwritten signature in black ink that reads "Kathy Acker".

Kathy Acker
Public Utilities Division

Enclosure



TEMPORARY AUTHORITY PERMIT
NORTH DAKOTA PUBLIC SERVICE COMMISSION
PUBLIC UTILITIES
 SFN 50560 (6-96)

Date 10/28/14	Time 10:05	<input checked="" type="checkbox"/> a.m. <input type="checkbox"/> p.m.	Name of Utility Otter Tail Power Company	Telephone Number 701-671-6001
Name of Person Calling Geri Coyne			Name of Coop Serving Dakota Valley Electric Coop	
Name of Customer Canadian Pacific Railway		Location Sec SW1/4, NE 1/4 Sec 20 Twp 130 R 48		
Address Battle Creek Bldg 1010 Shop Road			County Richland	
City St Paul,			State MN	Zip Code 55106
Name of Nearest City Fairmount			Distance to the City 5 1/2 mi	
When will service be extended? 11/3/14		Type of Service <input type="checkbox"/> Residence <input type="checkbox"/> Storage <input type="checkbox"/> Grain Bin <input checked="" type="checkbox"/> Other communication bldg		
Extension Length to Most Economical Point of Service Utility: 1125 Coop: 1/2 mile		Extension <input type="checkbox"/> Overhead <input checked="" type="checkbox"/> Underground		
Has customer signed request for service? <input checked="" type="checkbox"/> Yes <input type="checkbox"/> No		Will cooperative protest application? <input type="checkbox"/> Yes <input type="checkbox"/> No		
Name of Person Contacted (PSC Use)		Date of Contact (PSC Use)	Time (PSC Use) <input type="checkbox"/> a.m. <input type="checkbox"/> p.m.	
Estimated Cost of Extension \$20,000		Estimated Revenue \$300/yr		
Under what rate filed with the Public Service Commission will customer be served? 50-404				
Will extension cross over coop lines? <input type="checkbox"/> Yes <input checked="" type="checkbox"/> No		Will extension cross over railroad tracks? <input type="checkbox"/> Yes <input checked="" type="checkbox"/> No		
Temporary Authority Authorized By <input type="checkbox"/> Telephone <input type="checkbox"/> Letter		Date Authorized 10/29/14		
Authorized By (Name of Commissioner) <i>Julie Fedorchak</i>				

Extension must be made from most economical point of service.

Comments:

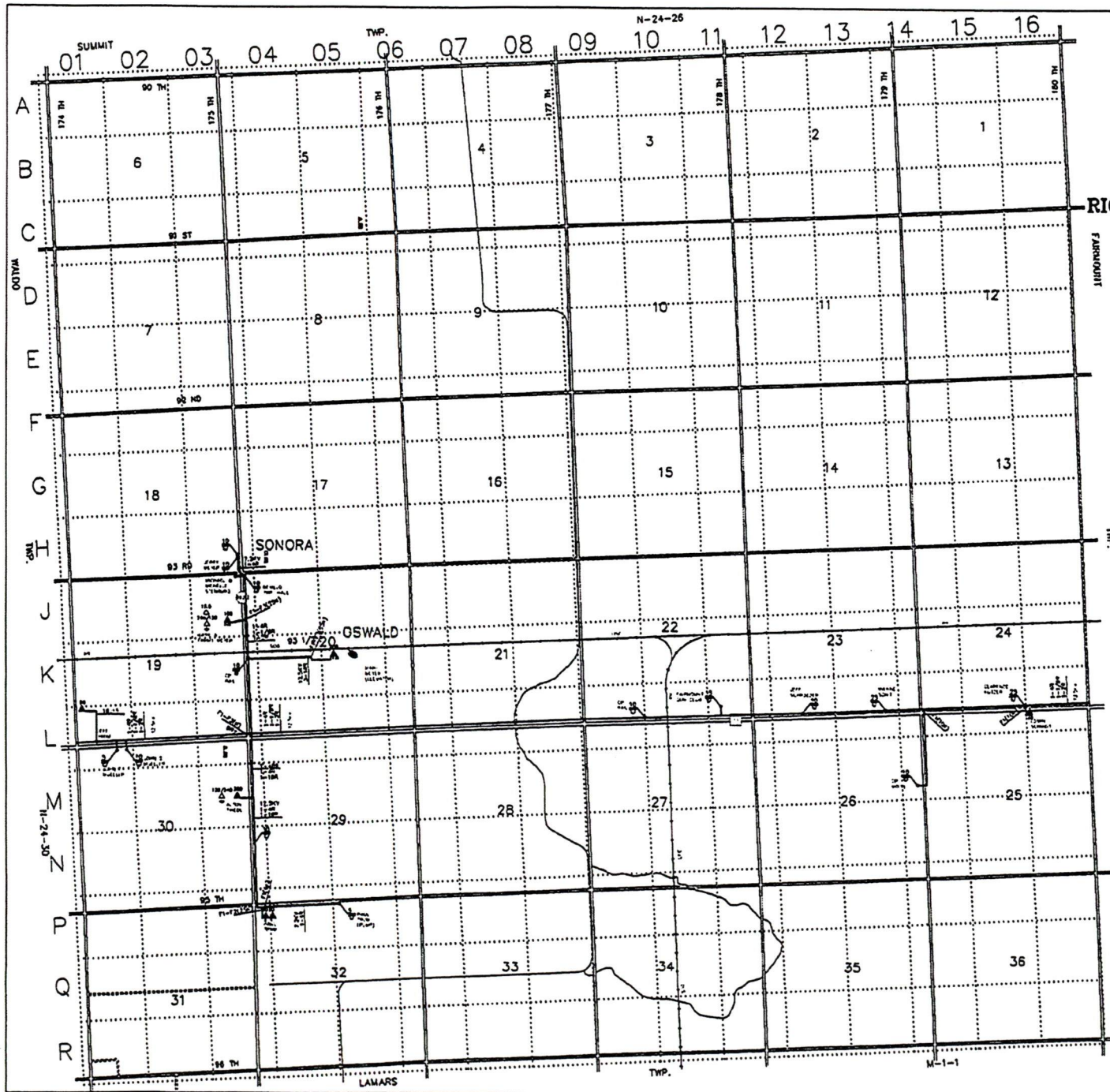

DEVILLO TOWNSHIP

T-130-N : R-48-W
RICHLAND COUNTY, NORTH DAKOTA

Scale: 1" = 2000' 12-12-2000
BY : S. GUNDERSON

Reference USGS 7.5 minute series
quadangle maps:
Hankinson, SE, ND 1954
Sonora, ND 1972

LEGEND

1	TOWNSHIP	1	SCHOOL	1	STATE HIGHWAY
2	COUNTY	2	TOWNSHIP	2	STATE ROAD
3	SECTION	3	SECTION	3	STATE ROAD
4	SECTION	4	SECTION	4	STATE ROAD
5	SECTION	5	SECTION	5	STATE ROAD
6	SECTION	6	SECTION	6	STATE ROAD
7	SECTION	7	SECTION	7	STATE ROAD
8	SECTION	8	SECTION	8	STATE ROAD
9	SECTION	9	SECTION	9	STATE ROAD
10	SECTION	10	SECTION	10	STATE ROAD
11	SECTION	11	SECTION	11	STATE ROAD
12	SECTION	12	SECTION	12	STATE ROAD
13	SECTION	13	SECTION	13	STATE ROAD
14	SECTION	14	SECTION	14	STATE ROAD
15	SECTION	15	SECTION	15	STATE ROAD
16	SECTION	16	SECTION	16	STATE ROAD
17	SECTION	17	SECTION	17	STATE ROAD
18	SECTION	18	SECTION	18	STATE ROAD
19	SECTION	19	SECTION	19	STATE ROAD
20	SECTION	20	SECTION	20	STATE ROAD
21	SECTION	21	SECTION	21	STATE ROAD
22	SECTION	22	SECTION	22	STATE ROAD
23	SECTION	23	SECTION	23	STATE ROAD
24	SECTION	24	SECTION	24	STATE ROAD
25	SECTION	25	SECTION	25	STATE ROAD
26	SECTION	26	SECTION	26	STATE ROAD
27	SECTION	27	SECTION	27	STATE ROAD
28	SECTION	28	SECTION	28	STATE ROAD
29	SECTION	29	SECTION	29	STATE ROAD
30	SECTION	30	SECTION	30	STATE ROAD
31	SECTION	31	SECTION	31	STATE ROAD
32	SECTION	32	SECTION	32	STATE ROAD
33	SECTION	33	SECTION	33	STATE ROAD
34	SECTION	34	SECTION	34	STATE ROAD
35	SECTION	35	SECTION	35	STATE ROAD
36	SECTION	36	SECTION	36	STATE ROAD

NOTE: ALL AREAS OF 1/2 AC OR MORE ARE OWNED.



N-24-31
RICHLAND COUNTY

REV: 3/08/12
BY: DAB