

LEONARDITE PRODUCTS-LLC

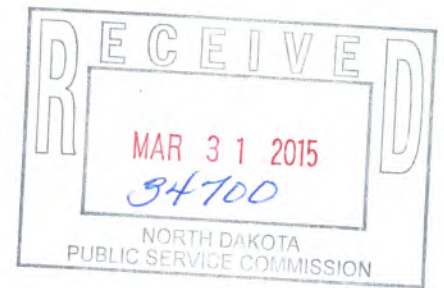

March 31, 2015

James R. Deutsch, Director
Reclamation Division
Public Service Commission
600 East Boulevard Ave. Dept. 408
Bismarck, ND 58505-0480

Dear Jim Deutsch,

Attached are corrected documents for Leonardite Products' "Application for Revision to Delete Undisturbed acreage from a Permit to engage in Surface Coal Mining and Reclamation Operations" for GRGR 0501, Stony Creek Mine. These pages are in response to your letter dated January 22, 2015.

This application asks to remove 14.28 acres from the permit area for a Triangle Petroleum Corporation Drill Pad.

In this package you will find:

1. Page L-2, Section II Legal Requirements, updated with the description for the deleted parcel along with the corrected property owners as submitted with Revision 5, Midterm Review, earlier this month.
2. Map B, is included this time.
3. Map C, is updated to include the surface owners as revised in Revision 5, Midterm Review, earlier this month.
4. Likewise, on Map C the coal ownership is labeled appropriately.
5. Map D
 - a. The haul road is removed
 - b. The topsoil and subsoil piles are properly identified and the overburden pile, which does not exist was removed from the map.

I hope these changes are satisfactory for this deleted parcel.

Thank you for your consideration.

Best Regards,

A handwritten signature in blue ink that reads "Cherie Harms". The signature is fluid and cursive.

Cherie Harms
701-471-2704 cell
Cherie@leonarditeproducts.com

Legal Description of Permit Area

Permit Area: S½NW¼, Section 8, T154N, R100W, 5th P.M. Williams County, North Dakota and N ½ SW ¼ of Section 8, T154N, R100W, 5th P.M. Williams County, North Dakota excluding a parcel beginning at the Point of Beginning N442,692.509, E1,216,496.988; thence N 00° 06' 37" W a distance of 100.00 feet; thence N 89° 56' 34" E a distance of 763.15 feet; thence N 00° 06' 37" W a distance of 336.13 feet; thence N 89° 56' 34" E a distance of 1112.53 feet; thence N 10° 25' 09" E a distance of 919.19 feet; thence N 89° 56' 34" E a distance of 593.48 feet; thence S 00° 05' 42" E a distance of 1340.00 feet; thence S 89° 56' 34" W a distance of 2636.77 feet to the Point of Beginning. Said parcel contains 34.57 acres, more or less.

Also excluding a parcel of land located in the Southwest quarter of the Northwest quarter (SW1/4NW1/4) commencing at the west quarter corner of said Section Eight (8), said point being a rebar; thence N 02° 10' 11" E along the west line of the Northwest quarter (NW1/4) of said Section Eight (8), a distance of 437.01 feet to the point of beginning; thence continuing N 02° 10' 11" E along said west line a distance of 881.94 Feet; Thence S 87° 48' 58" E, a distance of 771.85 feet; thence S 02° 15' 37" W, a distance of 381.22 Feet ; Thence S 16° 42' 59" W, a distance of 233.00 feet; thence S 45° 27' 39" W, a distance of 377.78 feet; thence N 87° 49' 56" W, a distance of 453.68 feet to the point of the beginning. Said parcel contains 14.28 acres, more or less.

Permit Map and Legal Right

The permit map is Map B. The lease agreement is found in Exhibits M.

Surface and Subsurface Ownership Data

Map C displays all surface right and Leonardite subsurface rights included in and contiguous to any part of the proposed permit area extending to a distance of one-fourth mile (402.33 meters) from the proposed permit boundary. (NDAC 69-05.2-08-02(1)(a)) A search of the, North Dakota Recorders Information Network NDRIN and county tax records was conducted to determine changes to the legal owners of record. (NDCC 38-14.1-18(2)). Following is a list of names and addresses of the surface and coal owners within and adjacent to the permit area as required by NDCC 38-14.1-14(1)(c)(2) and NDCC38-14.1-14(1)(d).

Leonardite Products, PO Box 548, Williston, ND 58802 (the Permit Applicant)

Surface Owners

SE1/4SE1/4 of Section 7

Lance and Jennifer Olson, 5166 134th Ave. NW, Williston, ND 58801
Ellis Trust etal, Gordon E of 5658 133rd Ave NW, Williston, ND 58801
Donald and Diane Reinholdt, 13415 Kings View Lane, Williston, ND 58801
Calvin and Shari Nass, 51212 1st Ave. W., Williston, ND 58801
Cynthia McCall, 634 E. Broadway #1174, Williston, ND 58801
Todd Sutton and Gabrielle Sutton, 5502 135th Ave NW, Williston, ND 58801
Brett Eichmann and Amanda M Eichmann, 1111 7th Ave. E, Williston, ND 58801
Darlene Bishop, PO Box 4 Williston, ND 58802-0004,
Tina and Donald Flesness, PO Box 2263, Williston, ND 58802-2263 (joint tenants)
Carl and Carol Shackelford, 13406 Kings View Lane, Williston, ND 58801
Raider Construction, Inc, 13410 Kings View Lane, Williston, ND 58801
Savage Companies, 13412 Kings View Lane, Williston, ND 58801 or 901- W legacy Center, Midvale Utah 84047
Dennis and Tina Nordaune, 13416 Kings View Lane, Williston, ND 58801

NE1/4SE1/4 Section 7

Casey and Megan Moran, 5237C 134th Ave. NW, Williston, ND 58801
Douglass Bumgardner and Polly Bumgardner, 5229 134th Ave NW, Williston, ND 58801
Hay Creek Properties, LLC, PO box 1891, Williston, ND 58802-1891
Joseph and Louise Skaare, 316 Rose Lane, Williston, ND 58801
James and Teri Kihle, 5225A134th Ave NW, Williston, ND 58801
James Kihle, 5225A134th Ave NW, Williston, ND 58801
Williston Holding Company, Inc. 9531 W 78th St. STE 340, Eden Prairie, MN 55344
Vance Neset, 5237 E 137th Ave, Williston, ND 58801
Lonny and Elaine Hiatt, 5237 134th Ave NW, Williston, ND 58801

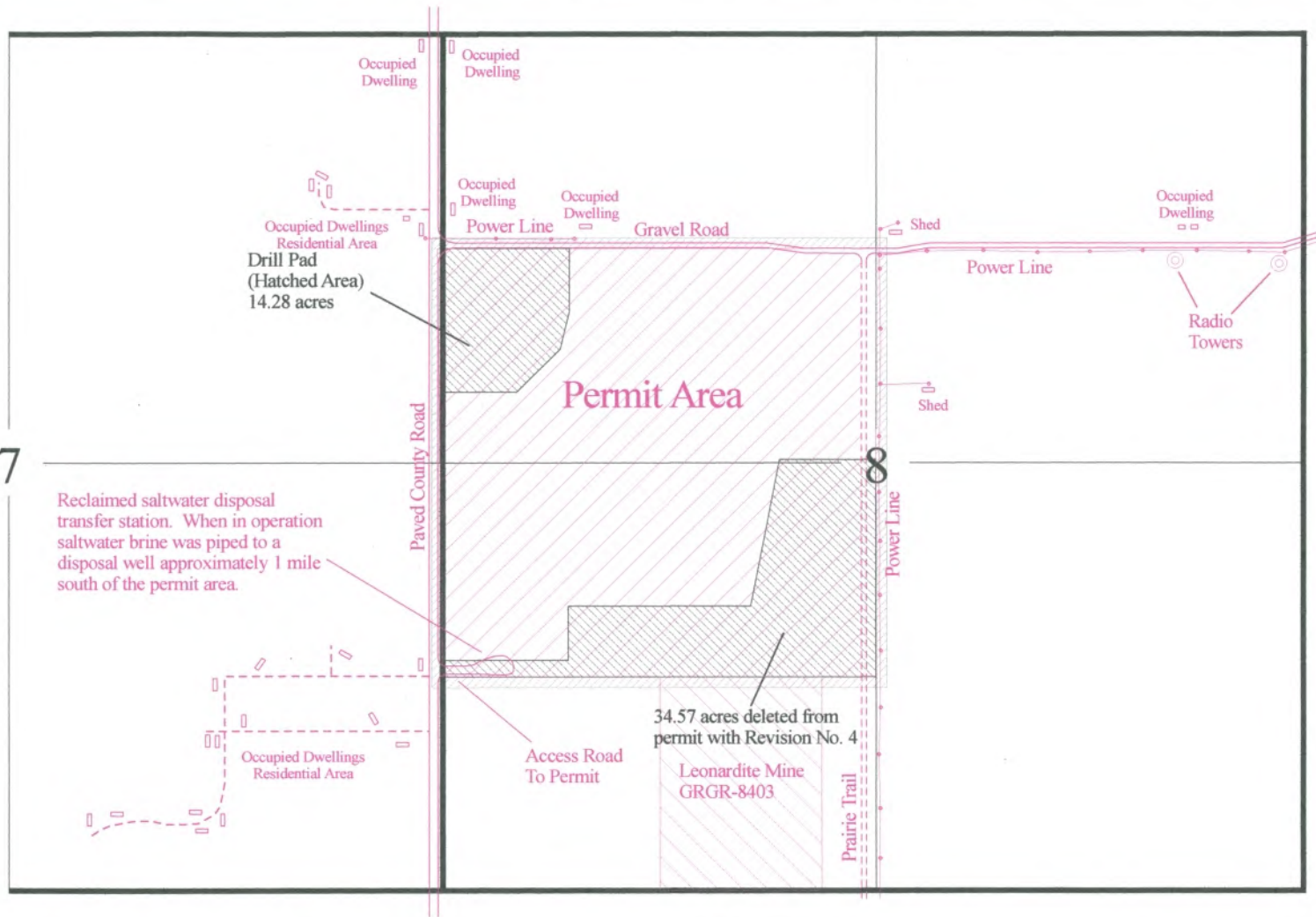

Revision #6, Deleted Partcel

Legend

 Permit Boundary

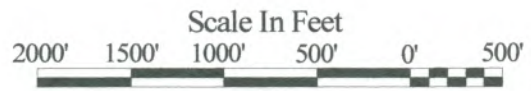
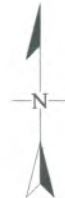

Leonardite Products	
Stony Creek Mine Mine Permit Application GRGR-0501 T 154 N, R 100 W Williams County, North Dakota	
Permit Location Map - Map B	
Date: 03-30-15	By: JB/CH

Section 7 Surface owners cont'd

NE1/4NE1/4
 Harold Hanson
 D & D Alton
 Walter Ramsey
 John Ramsey
 Betty Jo McNary
 V & J Miller
 V & E Huravitch
 Darren Logan

M & D Hansen
 Kimberly Lester
 Rory Koch
 Edgar M. Boyd Post #37
 Adrian Cotton
 Anthony Hurt
 J & J Cozart (S)
 Federal (C)
 cont'd on left

Drill Pad
 (Hatched Area)
 14.28 acres

W & I Koch
 James Christianson
 (S)
 Federal (C)

Neal Falk (S)
 Federal (C)

Ida Beckett (S)
 Federal (C)
 Julianna Reeves (S)
 Federal (C)

Mark Ellis (S)
 Federal (C)

M. Ellis (S)
 Federal (C)

Ellis-Olson, LLC (S)
 Federal (C)
 Leonardite
 Products, LLC (L)

Ellis-Olson, LLC (S)
 Federal (C)
 Leonardite
 Products, LLC (L)

R & T Nelson (S)
 Federal (C)

7

D & P Bumgardner
 Hay Creek Props
 J & L Skaare
 J & T Kilhe
 Williston Holding Co.
 Vance Neset
 L & E Hiatt
 C & M Moran (S)
 Federal (C)

Ellis-Olson LLC (S)
 Federal (C)
 Leonardite Products, LLC (L)

8

34.57 acres deleted from
 permit with Revision No. 4

M & S Ellis (S)
 Federal (C)

SE1/4SE1/4
 C & C Shackelford
 Raider Construction
 Savage Companies
 D & T Nordaune
 Darlene Bishop
 T & D Flesness

L & J Olson
 Ellis Trust
 D & D Reinholdt
 C & S Nass
 Cynthia McCall
 T & G Sutton
 B & A Eichmann (S)
 Federal (C)
 cont'd on left

Ellis Olson, LLC (S)
 Federal (C)

City of Williston (S)
 Ryan etal (C)

Revision 6 -Deleted Parcel

Legend

-  Permit Boundary
- (S) Surface Owner
- (C) Coal Owner
- (L) Lease

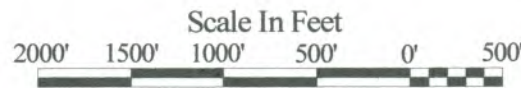
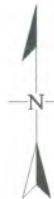

Leonardite Products

Stony Creek Mine
 Mine Permit Application GRGR-0501
 T 154 N, R 100 W
 Williams County, North Dakota

Property Map - Map C

Date: **03-30-15**

By: **JB/CH/MB**

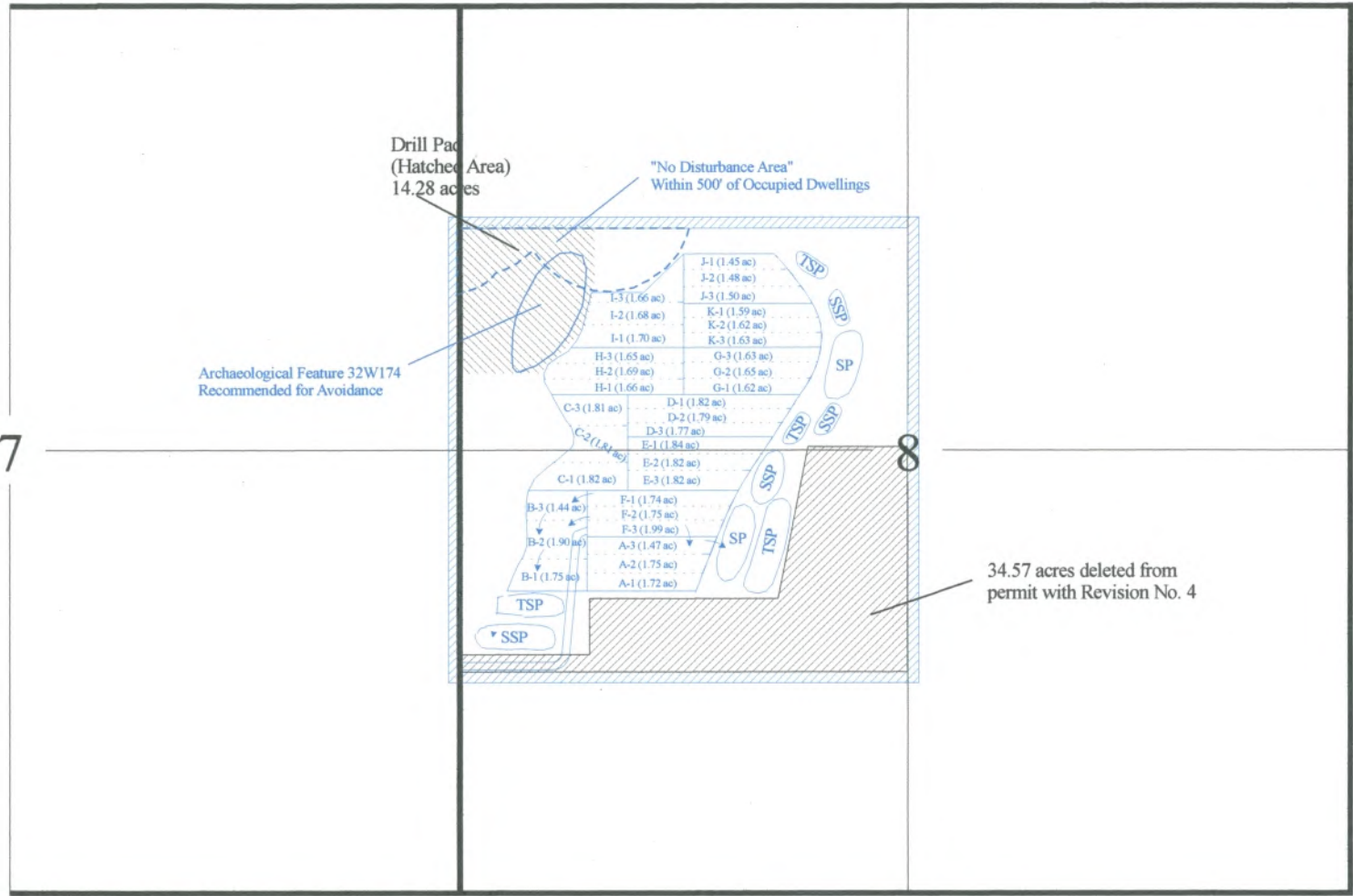

Revision #6 / Deleted Parcel

Legend

 Permit Boundary

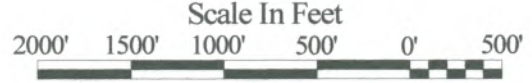
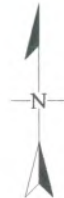

Leonardite Products	
Stony Creek Mine Mine Permit Application GRGR-0501 T 154 N, R 100 W Williams County, North Dakota	
Mine Plan Map - Map D	
Date: 03-30-15	By: JB/CH/MB