

OWNER	CROSSINGS	SURVEY NOTES	ROUTING NOTES
626+21 KESSEL LEN TESTAMENTARY TRUST 2,256' 603+43 ROCK, LOREN 603+30	603+24 35TH ST SW	620+60 SAG 3" 609+38 SAG 3" 608+41 SAG 3" 605+53 SBRT 7" 604+48 FENCE 603+43 T140N R100W 36 602+19 FENCE 602+19 FENCE 600+43 SBRT 14" 599+69 SBRT	
2,748' TALKINGTON, SHANE	588+48 DRAINAGE	593+85 OVB 4" 588+64 OVB 4" 585+80 FENCE	
2,647' TALKINGTON, SHANE	589+11 ROUGH RIDER ELECTRIC	579+10 OVB 4" 575+71 FENCE 572+49 SAG 3" 570+86 OVB 3" 569+82 SAG 3" 566+12 OVB 3" 566+28 OVB 3" 565+44 SAG 3"	
2,700' KOCH, ANDREW & CHRISTINE TRUST	524+42 HEART RIVER	562+64 SAG 2" 549+35 FENCE 549+38 T140N R99W 30 549+06 FENCE	
3,021' KOCH, ANDREW & CHRISTINE TRUST		527+35 SAG 3" 525+64 SBRT 13" 524+85 SAG 10" 524+85 SAG 10" 524+83 OVB 4" 522+05 SAG 520+30 OVB 3" 518+36 OVB 4" 518+36 FENCE 517+81 SAG 5" 517+40 SAG 6"	
81' KOCH, ANDREW & CHRISTINE TRUST		513+79 SAG 3" 505+25 SAG 3" 504+70 OVB 4" 499+03 SAG 3" 488+19 OVB 3" 486+31 SAG 3"	
3,360' FRANK, THEODORE D	481+23 39RD ST SW	481+67 FENCE 481+64 SBRT 481+23 T140N R99W 19 483+68 SAG 3" 483+02 OVB 3" 480+67 OVB 3" 480+26 OVB 3" 476+33 OVB 3" 474+76 SAG 3" 461+80 SAG 3" 461+25 OVB 5"	

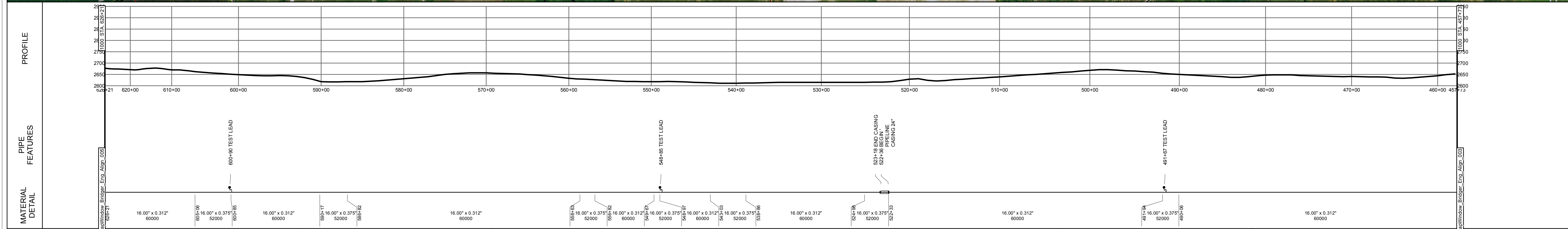

LEGEND		PIPE DETAIL	COATING DETAIL
SECTION LINE	STATION EQUATION	457+73 490+06 16.00' x 0.312" .. 60000, (3,233')	457+73 490+06 FBE, (3233')
RAILROAD	RIVER WEIGHT	490+06 491+94 16.00' x 0.375" .. 52000, (1,188')	490+06 491+94 FBE + ARO, (188')
DRAINAGE	PIPE WEIGHT	491+94 522+33 16.00' x 0.312" .. 60000, (3,039')	491+94 522+33 FBE, (3039')
FENCE	VALVE	522+33 524+98 16.00' x 0.375" .. 52000, (265')	522+33 524+98 FBE + ARO, (265')
ROAD	METER	524+98 538+86 16.00' x 0.312" .. 60000, (1,389')	524+98 538+86 FBE, (1389')
BURIED CABLE	REGULATOR	538+86 543+03 16.00' x 0.375" .. 52000, (416')	538+86 543+03 FBE + ARO, (416')
POWER LINE	RECEIVER	543+03 548+97 16.00' x 0.312" .. 60000, (595')	543+03 548+97 FBE, (595')
TOP OF BANK	CASING	548+97 549+67 16.00' x 0.375" .. 52000, (69')	548+97 549+67 FBE + ARO, (69')
TELEPHONE LINE	SLEEVE	549+67 556+82 16.00' x 0.312" .. 60000, (716')	549+67 556+82 FBE, (716')
OVERHEAD POWER LINE	PIPE INFLECTION	556+82 558+63 16.00' x 0.375" .. 52000, (181')	556+82 558+63 FBE + ARO, (181')
BURIED PIPELINE	WELD CAP	558+63 586+82 16.00' x 0.312" .. 60000, (2,819')	558+63 586+82 FBE, (2819')
PROPERTY LINE		586+82 590+17 16.00' x 0.375" .. 52000, (336')	586+82 590+17 FBE + ARO, (336')
BURIED WATER LINE		590+17 600+85 16.00' x 0.312" .. 60000, (1,067')	590+17 600+85 FBE, (1067')
TILE		600+85 605+06 16.00' x 0.375" .. 52000, (421')	600+85 605+06 FBE + ARO, (421')
		605+06 626+21 16.00' x 0.312" .. 60000, (2,115')	605+06 626+21 FBE, (2115')

BRIDGER PIPELINE LLC
SKUNK HILL TO FRYBURG
 STARK COUNTY, ND

T140N R99W Sec. 18
 T140N R99W Sec. 19
 T140N R99W Sec. 30
 T140N R99W Sec. 31
 T140N R100W Sec. 36

Scale: 1" = 1000'

Generate Date: 3/25/2016
 Line Name: FOUR BEARS 16 INCH
 Sheet Number: 004 of 005