

Hamre, John G.

From: Jason Stelzer <jason@paradigmmidstream.com>
Sent: Thursday, June 24, 2021 1:50 PM
To: -Info-Public Service Commission
Subject: PU-15-114/15-670/15-744 Tree and Shrub Reports
Attachments: Milo Wisness.pdf; Paradigm Plantings.xlsx; Paradigm Tree Report 2020.xlsx; Paradigm Tree Report.xlsx; Copy of Statewide ND-CPA-4 Tree_Workbook.xls; Donny Nelson.pdf

***** **CAUTION:** This email originated from an outside source. Do not click links or open attachments unless you know they are safe. *****

To whom it may concern:

In 2016, PSC staff approved a plan to be used by Paradigm for tree and shrub mitigation. All three projects were grouped together for purposes of the reports by county. The overwhelming majority of trees/shrubs to be replaced were in McKenzie County and Paradigm contracted with the NRCS office in Watford City to handle monitoring and planting. There was only one landowner in Mountrail who wanted trees replanted and he wanted to do the work himself (he was planting the trees at his homestead so we paid him for the trees, planting, and monitoring). Attached please find the reports from the NRCS related to the planting which began in 2017. Please let me know if you have any questions.

Jason Stelzer
Director-Permitting, Land, and Right of Way
(214) 389-8159 Direct
(817) 781-1924 Mobile

CONFIDENTIALITY NOTICE This electronic mail transmission is confidential, may be privileged and should be read or retained only by the intended recipient. If you have received this transmission in error, please immediately notify the sender and delete it from your system.

- 84 PU-15-744 Filed 06/24/2021 Pages: 8
Email with attached reports related to tree and shrub mitigation
Paradigm Midstream Services - ND, LLC
Jason Stelzer
- 64 PU-15-670 Filed 06/24/2021 Pages: 8
Email with attached reports related to tree and shrub mitigation
Paradigm Midstream Services - ND, LLC
Jason Stelzer
- 130 PU-15-114 Filed 06/24/2021 Pages: 8
Email with attached reports related to tree and shrub mitigation
Paradigm Midstream Services - ND, LLC
Jason Stelzer

Paradigm Pipeline Project

Landowner	Phone Number	Trees Removed	Trees to Replace	Yes/No	Tree Bank	Total Planted	Total Cost
Donnie Nelson	701-580-2182	136	272	Yes	0	274	\$1,799.10
Gary and Patsy Levang	N/A	6	12	No	12		
Larry Veeder		320	320	No	320		
David Veeder	406-670-9220	63	126	Yes	0		
Curtis and Sharon Anderson		258	516	Yes	0		
Milo Wisness	701-421-1004	38	76	Yes	0	76	\$114.00
Larry and Barbara Henderson	701-421-9954	8	16	Yes	0		
Larry Jones	701-675-2426	85	160	Wants 150	10		
US Department of Interior (Reservation)		60	120	Yes	0		
Tom Wilkinson	701-421-0414	54	108	Yes	0		
Jay Sandstrom	N/A	56	112	No	112		
Sherri Reynolds	N/A	5	10	No	10		
Michael Little Field	N/A	2	4	No	4		
Daryl and Pam Locken	701-898-1462	3	6	Yes	0		
Daniel and Beatrice Kannianen	N/A	21	40	No	40		

Yellow= DONE
 Blue=Doesn't Want
 Red=Mountrail County

Total: 508 \$1,913.10

Remaining in tree replacement

WEST - TREE AND SHRUB PLANTING WORKSHEET

Name **Donny Nelson** Address **3751 104th Ave NW Keene, ND 58847** Phone # **701-580-2182** Date: **11/15/2016**

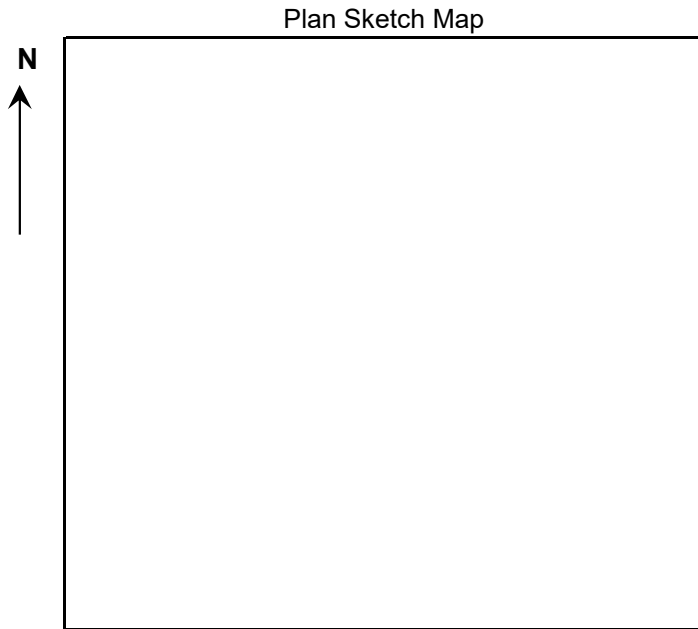

Quarter **NE 1/4** Section **22** Twshp **152** Range **95**

Planned by: **JH** Plan approved by: _____

Planned Soil Mapunit / name component(s) **E3527A**

Conservation Tree & Shrub Group **3** Select MLRA **54**

Type of Planting **New**

Landuse **Farmstead** Cost share Program _____

Site Preparation **Tilled/Herbicide** Site protected from livestock? **Yes**

Condition of site at planting time: _____

Spacing between rows: **20** feet

Distance from Windward row to roads or bldgs: **N/A** feet
(Minimum 200' on N & W, and 100' on S & E)

Planted by: _____

Remarks / Management (Weed Control) Date: _____

No Ground Prep, Yes Weedbarrier

This practice installation MEETS / DOES NOT MEET the ND FOTG standards and specification:

Certified By:

Date:

Field No.	Planned Length	Planted Length	Planted Width	Acres	Row #	Primary Species of Tree or Shrub	Type or Variety	Alternating Specie	Average Spacing in row	Number Planted (est)	Number Planted (actual)	Primary Specie Suitability	Alternating Specie Suitability				
1	375		20	0.17	1	Caragana			5	75	0	suitable	0				
1	365		20	0.17	2	Spruce, Blue			11	33	0	suitable	0				
1	355		20	0.16	3	Boxelder			11	32	0	suitable	0				
1	345		20	0.16	4	Lilac, Common			5	69	0	suitable	0				
			0	0.00	5					0	0	0	0				
2	300		20	0.14	6	Spruce, Blue			11	27	0	suitable	0				
2	290		20	0.13	7	Boxelder			11	26	0	suitable	0				
2	280		20	0.13	8	Lilac, Common			5	56	0	suitable	0				
			0	0.00	9					0	0	0	0				
			0	0.00	10					0	0	0	0				
			0	0.00	11					0	0	0	0				
			0	0.00	12					0	0	0	0				
			0	0.00	13					0	0	0	0				
			0	0.00	14					0	0	0	0				
			0	0.00	15					0	0	0	0				
			0	0.00	16					0	0	0	0				
Totals										2310	0	140	1.06	319	0		

McKenzie County SCD
 PO Box 583
 Watford City, ND 58854
 (701) 842-3628x3
 kalsey.kronberg@nd.nacdnet.net
 t

Invoice 2402



BILL TO

Milo Wisness
 4153 110th Ave NW
 Keene, ND 58847

DATE 06/22/2017	PLEASE PAY \$471.77	DUE DATE 07/22/2017
--------------------	-------------------------------	------------------------

DATE	ACCOUNT SUMMARY	AMOUNT
06/05/2017	Balance Forward	\$357.77
	Payments and credits between 06/05/2017 and 06/22/2017	0.00
	New charges (details below)	114.00
	Total Amount Due	\$471.77

ACTIVITY	QTY	RATE	AMOUNT
Trees/Shrubs:Hand Plant Tree- Pre Sale	76	1.50	114.00
TOTAL OF NEW CHARGES			114.00
TOTAL DUE			\$471.77

THANK YOU.

McKenzie County SCD
PO Box 583
Watford City, ND 58854
(701) 842-3628x3
kalsey.kronberg@nd.nacdnet.net

Invoice 2383



BILL TO
Nelson, Don

DATE
06/22/2017

PLEASE PAY
\$1,799.10

DUE DATE
07/22/2017

ACTIVITY	QTY	RATE	AMOUNT
Machine Planting/under 2000 25 Machine Planting \$30.00/ 100 Feet if under 2000 feet	19.99	30.00	599.70
Weedbarrier Installation/2000' or less Weedbarrier Installation of 60.00 per 100 feet if less than 2000"	19.99	60.00	1,199.40

TOTAL DUE

\$1,799.10

THANK YOU.