

Date:10/05/2015

The Arthur Companies, Inc.  
 PO Box 145  
 Arthur, ND  
 County:  
 Phone: 701-967-8312  
 CCC Number:

Page: 1

: 2

Location/Container Numbers/Comments	Section	Capacity
<b>PART A - ADDITIONAL SPACE TO BE INCLUDED UNDER LICENSE</b>		
008	L	290,230
		<b>Total: 290,230</b>

**PART B - SPACE TO BE DELETED UNDER LICENSE**

<NO BINS DELETED>		
		<b>Total: 0</b>

**PART C - ALL SPACE TO BE INCLUDED UNDER LICENSE**

A	357,000	
A-1	203,000	
B	531,000	
C	497,000	
D	3,966,000	
H	104,000	
I	124,000	
J	300,000	
K	182,000	
L	830,000	
M	100,000	
N	18,000	
P	509,000	
Q	3,213,000	
R	848,000	
S	462,000	
W	497,000	
XT1	2,235,000	
		<b>Total: 14,976,000</b>

**PART D - TOTAL CAPACITY BY FUNCTIONAL UNIT**

Anamoose 1077	K L M	1,112,000
Arthur 328	A B C P	1,894,000
Ayr 331	N Q XT1	5,466,000
Buffalo 459	S	462,000
Harvey 332	A-1 D H I J	4,697,000
Page 1157	R W	1,345,000
		<b>Total: 14,976,000</b>

Exam Date:10/05/2015

The Arthur Companies, Inc.

Page: 1

Examiner: 2

PO Box 145

Arthur, ND

County:

Status	Section	Bin Number	Bin Type	Base Point	Diameter or Bu/Ft (Irreg).	Length	Width	Side wall	Add for Hopper	Ded. for Obst.	Effective Depth	Add for Peak	Depth for Capac.	Bushels per Foot	Base Pack%	Bushel Capacity with Pack
--------	---------	------------	----------	------------	-------------------------------	--------	-------	--------------	----------------------	----------------------	--------------------	--------------------	------------------------	------------------------	---------------	------------------------------

## Facility: Anamoose

### Section: K

K	001 T	Irregular	top of sidewall	14.100	4.188	4.188	21.00	0.00	0.00	21.000	0.000	21.0	14.1	2.00	302
K	001 B	Irregular	top of sidewall	29.300	6.037	6.037	23.00	0.00	0.00	23.000	0.000	23.0	29.3	2.50	691
K	002	Irregular	top of sidewall	14.100	4.188	4.188	22.00	0.00	0.00	22.000	0.000	22.0	14.1	2.00	316
K	003	Irregular	top of sidewall	99.500	11.13	11.13	64.00	0.00	0.00	64.000	0.000	64.0	99.5	6.00	6,750
K	005	Irregular	top of sidewall	26.800	5.774	5.774	44.00	0.00	0.00	44.000	0.000	44.0	26.8	2.50	1,208
K	006	Irregular	top of sidewall	50.700	7.942	7.942	43.00	0.00	0.00	43.000	0.000	43.0	50.7	4.50	2,278
K	007	Irregular	top of sidewall	50.700	7.942	7.942	43.00	0.00	0.00	43.000	0.000	43.0	50.7	4.50	2,278
K	008	Irregular	top of sidewall	26.800	5.774	5.774	44.00	0.00	0.00	44.000	0.000	44.0	26.8	2.50	1,208
K	009	Irregular	top of sidewall	99.500	11.13	11.13	64.00	0.00	0.00	64.000	0.000	64.0	99.5	6.00	6,750
K	010	Irregular	top of sidewall	52.700	8.097	8.097	43.00	0.00	0.00	43.000	0.000	43.0	52.7	4.50	2,368
K	013	Irregular	top of sidewall	52.700	8.097	8.097	43.00	0.00	0.00	43.000	0.000	43.0	52.7	4.50	2,368
K	014	Irregular	top of sidewall	98.600	11.08	11.08	64.00	0.00	0.00	64.000	0.000	64.0	98.6	6.00	6,689
K	015	Irregular	top of sidewall	26.800	5.774	5.774	44.00	0.00	0.00	44.000	0.000	44.0	26.8	2.50	1,208
K	017 T	Irregular	top of sidewall	51.300	7.989	7.989	44.00	0.00	0.00	44.000	0.000	44.0	51.3	4.50	2,359
K	017 B	Irregular	top of sidewall	104.30	11.39	11.39	20.00	0.00	0.00	20.000	0.000	20.0	104.3	6.00	2,211
K	018	Irregular	top of sidewall	51.300	7.989	7.989	44.00	0.00	0.00	44.000	0.000	44.0	51.3	4.50	2,359
K	019	Irregular	top of sidewall	26.800	5.774	5.774	44.00	0.00	0.00	44.000	0.000	44.0	26.8	2.50	1,208
K	020	Irregular	top of sidewall	98.600	11.08	11.08	64.00	0.00	0.00	64.000	0.000	64.0	98.6	6.00	6,689
K	021	Irregular	top of sidewall	17.000	4.599	4.599	44.00	0.00	0.00	44.000	0.000	44.0	17.0	2.00	763
K	201	Peaked	top of sidewall	16.000	0.000	0.000	20.00	2.00	0.00	22.000	1.000	23.0	161.6	5.80	3,933
K	202	Peaked	top of sidewall	16.000	0.000	0.000	20.00	2.00	0.00	22.000	1.000	23.0	161.6	5.80	3,933
K	301	Peaked	top of sidewall	30.000	30.00	0.000	59.00	0.00	0.00	59.000	1.800	60.8	568.2	9.00	37,656

### NDPSC Bin Capacity Chart

Exam Date:10/05/2015

The Arthur Companies, Inc.  
 PO Box 145  
 Arthur , ND  
 County:

Examiner: 2

Status	Section	Bin Number	Bin Type	Base Point	Diameter or Bu/Ft (Irreg.) Length	Width	Side wall	Add for Hopper	Ded. for Obst.	Effective Depth	Add for Peak	Depth for Capac.	Bushels per Foot	Base Pack%	Bushel Capacity with Pack
--------	---------	------------	----------	------------	---	-------	--------------	----------------------	----------------------	--------------------	--------------------	------------------------	------------------------	---------------	------------------------------

## Facility: Anamoose

### Section: K

K	302	Peaked	top of sidewall		36.000	0.000	0.000	59.00	0.00	0.00	59.000	2.200	61.2	818.2	10.0	55,081
K	303	Peaked	top of sidewall		30.000	0.000	0.000	48.00	0.00	0.00	48.000	1.800	49.8	568.2	9.00	30,843

Bin count: 24

Facility: Anamoose Section: K Total: **181,449**

To Even: **182,000**

### Section: L

L	001	Peaked	top of sidewall		35.900	35.90	0.000	59.00	0.00	0.00	59.000	2.200	61.2	813.7	10.0	54,778
L	002	Peaked	top of sidewall		35.900	0.000	0.000	59.00	0.00	0.00	59.000	2.200	61.2	813.7	10.0	54,778
L	003	Peaked	top of sidewall		35.900	0.000	0.000	59.00	0.00	0.00	59.000	2.200	61.2	813.7	10.0	54,778
L	004	Peaked	top of sidewall		35.900	0.000	0.000	59.00	0.00	0.00	59.000	2.200	61.2	813.7	10.0	54,778
L	005	Peaked	top of sidewall		71.800	71.80	0.000	58.90	0.00	0.00	58.900	5.000	63.9	3254.8	10.0	228,780
L	006	Peaked	top of sidewall		18.000	0.000	0.000	43.00	0.00	0.00	43.000	1.100	44.1	204.6	6.00	9,564
L	007	Peaked	top of sidewall		48.000	0.000	0.000	47.80	0.00	0.00	47.800	3.400	51.2	1454.6	10.0	81,924
Added	L	008	Peaked	top of sidewall	77.600	0.000	0.000	64.00	0.00	0.00	64.000	5.400	69.4	3801.8	10.0	290,230

Bin count: 8

Facility: Anamoose Section: L Total: **829,610**

To Even: **830,000**

### Section: M

M	ground	Temporary	100,000 bushels of ground		21.000	60.00	198.0	0.100	0.00	0.00	0.100	9.400	9.5	9549.8	10.0	99,795
---	--------	-----------	---------------------------	--	--------	-------	-------	-------	------	------	-------	-------	-----	--------	------	--------

Bin count: 1

Facility: Anamoose Section: M Total: **99,795**

To Even: **100,000**

Exam Date:10/05/2015

The Arthur Companies, Inc.

Page: 3

Examiner: 2

PO Box 145

Arthur, ND

County:

Status	Section	Bin Number	Bin Type	Base Point	Diameter or Bu/Ft (Irreg).	Length	Width	Side wall	Add for Hopper	Ded. for Obst.	Effective Depth	Add for Peak	Depth for Capac.	Bushels per Foot	Base Pack%	Bushel Capacity with Pack
--------	---------	------------	----------	------------	-------------------------------	--------	-------	--------------	----------------------	----------------------	--------------------	--------------------	------------------------	------------------------	---------------	------------------------------

## Facility: Harvey

### Section: A-1

A-1	002	Square	floor over bins	0.000	9.400	3.600	38.00	0.00	0.00	38.000	0.000	38.0	27.2	2.50	1,060
A-1	004	Square	floor over bins	0.000	9.800	5.700	38.00	0.00	0.00	38.000	0.000	38.0	44.9	3.50	1,766
A-1	005 T	Square	floor over bins	0.000	9.800	3.600	38.00	0.00	0.00	38.000	0.000	38.0	28.4	2.50	1,106
A-1	005 B	Square	work floor - top 38'	0.000	9.800	9.200	17.00	0.00	0.00	17.000	0.000	17.0	72.5	5.20	1,297
A-1	006	Square	floor over bins	0.000	9.300	9.200	55.00	0.00	0.00	55.000	0.000	55.0	68.8	5.20	3,981
A-1	007 T	Irregular	2.3 x 6.5 with obstruct 2.5 x	7.400	0.000	0.000	12.00	0.00	0.00	12.000	0.000	12.0	7.4	2.00	91
A-1	007 B	Square	work floor - top 12'	0.000	2.300	6.500	26.00	0.00	0.00	26.000	0.000	26.0	12.0	2.00	318
A-1	008 T	Irregular	9.3 x 6.5 with obstruct 2.5 x	42.000	0.000	0.000	12.00	0.00	0.00	12.000	0.000	12.0	42.0	3.50	522
A-1	008 B	Square	work floor - top 12'	0.000	9.300	6.500	23.00	0.00	0.00	23.000	0.000	23.0	48.6	4.20	1,165
A-1	010 T	Irregular	9.3 x 6.4 with obstruct 3 x 3.3	39.800	0.000	0.000	12.00	0.00	0.00	12.000	0.000	12.0	39.8	3.00	492
A-1	010 B	Square	work floor - top 12'	0.000	9.300	6.400	23.00	0.00	0.00	23.000	0.000	23.0	47.8	4.00	1,143
A-1	011	Square	floor over bins	0.000	9.300	9.200	55.00	0.00	0.00	55.000	0.000	55.0	68.8	5.20	3,981
A-1	012	Square	floor over bins	0.000	7.400	6.500	38.00	0.00	0.00	38.000	0.000	38.0	38.7	3.00	1,515
A-1	013	Square	floor over bins	0.000	9.800	5.700	38.00	0.00	0.00	38.000	0.000	38.0	44.9	3.50	1,766
A-1	014 T	Square	floor over bins	0.000	9.800	3.600	38.00	0.00	0.00	38.000	0.000	38.0	28.4	2.50	1,106
A-1	014 B	Square	work floor - top 38'	0.000	9.800	9.200	17.00	0.00	0.00	17.000	0.000	17.0	72.5	5.20	1,297
A-1	015	Square	floor over bins	0.000	9.400	9.200	55.00	0.00	0.00	55.000	0.000	55.0	69.5	5.20	4,022
A-1	016	Square	floor over bins	0.000	5.000	4.000	36.00	0.00	0.00	36.000	0.000	36.0	16.1	2.00	592
A-1	017	Square	floor over bins	0.000	9.400	9.200	55.00	0.00	0.00	55.000	0.000	55.0	69.5	5.20	4,022
A-1	018 T	Irregular	9.8 x 6.4 with obstruct 2.5 x	43.800	0.000	0.000	12.00	0.00	0.00	12.000	0.000	12.0	43.8	3.50	544
A-1	018 B	Square	work floor-- top 12'	0.000	9.800	6.400	26.00	0.00	0.00	26.000	0.000	26.0	50.4	4.50	1,369
A-1	101 T	Square	floor over bins	0.000	9.400	10.40	50.00	0.00	0.00	50.000	0.000	50.0	78.6	5.50	4,146

Exam Date:10/05/2015

The Arthur Companies, Inc.

Page: 4

Examiner: 2

PO Box 145  
Arthur, ND  
County:

Status	Section	Bin Number	Bin Type	Base Point	Diameter or Bu/Ft (Irreg).		Side wall	Add for Hopper	Ded. for Obst.	Effective Depth	Add for Peak	Depth for Capac.	Bushels per Foot	Base Pack%	Bushel Capacity with Pack
					Length	Width									

## Facility: Harvey

### Section: A-1

A-1	101 B	Square	work floor - top 50'	0.000	12.20	10.40	7.000	0.00	0.00	7.000	0.000	7.0	102.0	6.00	757
A-1	102 T	Square	floor over bins	0.000	9.400	10.40	50.00	0.00	0.00	50.000	0.000	50.0	78.6	5.50	4,146
A-1	102 B	Square	work floor-- top 50'	0.000	10.20	10.40	12.00	0.00	0.00	12.000	0.000	12.0	85.3	5.80	1,083
A-1	103 T	Square	floor over bins	0.000	9.400	10.60	50.00	0.00	0.00	50.000	0.000	50.0	80.1	5.50	4,225
A-1	103 B	Square	work floor-- top 50'	0.000	12.20	10.60	7.000	0.00	0.00	7.000	0.000	7.0	104.0	6.00	772
A-1	104 T	Square	floor over bins	0.000	9.400	10.60	50.00	0.00	0.00	50.000	0.000	50.0	80.1	5.50	4,225
A-1	104 B	Square	work floor - top 50'	0.000	10.20	10.60	12.00	0.00	0.00	12.000	0.000	12.0	86.9	5.80	1,103
A-1	105 T	Square	floor over bins	0.000	9.400	10.60	50.00	0.00	0.00	50.000	0.000	50.0	80.1	5.50	4,225
A-1	105 B	Square	work floor - top 50'	0.000	12.20	10.60	7.000	0.00	0.00	7.000	0.000	7.0	104.0	6.00	772
A-1	106 T	Square	floor over bins	0.000	9.400	10.60	50.00	0.00	0.00	50.000	0.000	50.0	80.1	5.50	4,225
A-1	106 B	Square	work floor - top 50'	0.000	10.20	10.60	12.00	0.00	0.00	12.000	0.000	12.0	86.9	5.80	1,103
A-1	107 T	Square	floor over bins	0.000	9.400	10.40	50.00	0.00	0.00	50.000	0.000	50.0	78.6	5.50	4,146
A-1	107 B	Square	work floor - top 50'	0.000	12.20	10.40	7.000	0.00	0.00	7.000	0.000	7.0	102.0	6.00	757
A-1	108 T	Square	floor over bins	0.000	9.400	10.40	50.00	0.00	0.00	50.000	0.000	50.0	78.6	5.50	4,146
A-1	108 B	Square	work floor - top 50'	0.000	10.20	10.40	12.00	0.00	0.00	12.000	0.000	12.0	85.3	5.80	1,083
A-1	109	Square	floor over bins	0.000	10.00	10.40	50.00	0.00	0.00	50.000	0.000	50.0	83.6	5.80	4,422
A-1	110	Square	floor over bins	0.000	10.00	10.60	50.00	0.00	0.00	50.000	0.000	50.0	85.2	5.80	4,507
A-1	111	Square	floor over bins	0.000	10.00	10.60	50.00	0.00	0.00	50.000	0.000	50.0	85.2	5.80	4,507
A-1	112	Square	floor over bins	0.000	10.00	10.40	50.00	0.00	0.00	50.000	0.000	50.0	83.6	5.80	4,422
A-1	202	Square	floor over bins	0.000	5.200	3.100	27.00	0.00	0.00	27.000	0.000	27.0	13.0	2.00	358
A-1	203 T	Square	floor over bins	0.000	4.000	3.100	27.00	0.00	0.00	27.000	0.000	27.0	10.0	2.00	275
A-1	203 B	Square	work floor - top 27'	0.000	9.500	3.100	36.00	0.00	0.00	36.000	0.000	36.0	23.7	2.00	870

Exam Date:10/05/2015

The Arthur Companies, Inc.

Page: 5

Examiner: 2

PO Box 145

Arthur, ND

County:

Status	Section	Bin Number	Bin Type	Base Point	Diameter or Bu/Ft (Irreg). Length	Width	Side wall	Add for Hopper	Ded. for Obst.	Effective Depth	Add for Peak	Depth for Capac.	Bushels per Foot	Base Pack%	Bushel Capacity with Pack
--------	---------	------------	----------	------------	---	-------	--------------	----------------------	----------------------	--------------------	--------------------	------------------------	------------------------	---------------	------------------------------

## Facility: Harvey

### Section: A-1

A-1	204 T	Square	floor over bins	0.000	9.500	10.30	71.00	0.00	0.00	71.000	0.000	71.0	78.7	5.50	5,895
A-1	204 B	Square	work floor - top 71'	0.000	12.90	10.30	9.000	0.00	0.00	9.000	0.000	9.0	106.8	6.20	1,021
A-1	205	Square	floor over bins	0.000	9.500	11.00	75.00	0.00	0.00	75.000	0.000	75.0	84.0	5.80	6,665
A-1	207	Square	floor over bins	0.000	11.00	11.00	75.00	0.00	0.00	75.000	0.000	75.0	97.3	6.00	7,736
A-1	208	Square	floor over bins	0.000	11.00	10.30	71.00	0.00	0.00	71.000	0.000	71.0	91.1	5.80	6,843
A-1	209	Square	floor over bins	0.000	11.00	9.600	75.00	0.00	0.00	75.000	0.000	75.0	84.9	5.80	6,737
A-1	210 T	Square	floor over bins	0.000	10.30	9.600	71.00	0.00	0.00	71.000	0.000	71.0	79.5	5.50	5,955
A-1	210 B	Square	work floor - top 71'	0.000	12.90	10.30	9.000	0.00	0.00	9.000	0.000	9.0	106.8	6.20	1,021
A-1	211	Square	floor over bins	0.000	13.10	9.600	63.00	0.00	0.00	63.000	0.000	63.0	101.1	6.00	6,751
A-1	213 T	Square	floor over bins	0.000	10.20	9.600	71.00	0.00	0.00	71.000	0.000	71.0	78.7	5.50	5,895
A-1	213 B	Square	work floor - top 71'	0.000	12.90	10.20	9.000	0.00	0.00	9.000	0.000	9.0	105.8	6.20	1,011
A-1	214	Square	floor over bins	0.000	11.20	9.600	75.00	0.00	0.00	75.000	0.000	75.0	86.4	5.80	6,856
A-1	216 T	Irregular	check this bin	91.500	0.000	0.000	11.00	0.00	0.00	11.000	0.000	11.0	91.5	5.80	1,065
A-1	216 B	Irregular	work floor - top 11'	110.60	0.000	0.000	52.00	0.00	0.00	52.000	0.000	52.0	110.6	6.20	6,108
A-1	217	Square	floor over bins	0.000	11.00	11.20	75.00	0.00	0.00	75.000	0.000	75.0	99.0	6.00	7,871
A-1	218	Square	floor over bins	0.000	11.00	10.20	71.00	0.00	0.00	71.000	0.000	71.0	90.2	5.80	6,775
A-1	219 T	Square	floor over bins	0.000	10.20	9.500	71.00	0.00	0.00	71.000	0.000	71.0	77.9	5.50	5,835
A-1	219 B	Square	work floor - top 71'	0.000	12.90	10.20	9.000	0.00	0.00	9.000	0.000	9.0	105.8	6.20	1,011
A-1	220	Square	floor over bins	0.000	11.20	9.500	75.00	0.00	0.00	75.000	0.000	75.0	85.5	5.80	6,785
A-1	221	Square	floor over bins	0.000	9.500	3.500	63.00	0.00	0.00	63.000	0.000	63.0	26.7	2.50	1,724
A-1	300 A	Flat	bag storage	0.000	24.00	45.00	5.000	0.00	0.00	5.000	0.000	5.0	868.2	10.0	4,775
A-1	300B	Flat	bag storage	0.000	24.00	45.00	5.000	0.00	0.00	5.000	0.000	5.0	868.2	10.0	4,775

### NDPSC Bin Capacity Chart

Exam Date: 10/05/2015

The Arthur Companies, Inc.  
PO Box 145  
Arthur, ND  
County:

Page: 6

Examiner: 2

Status	Section	Bin Number	Bin Type	Base Point	Diameter or Bu/Ft (Irreg.) Length	Width	Side wall	Add for Hopper	Ded. for Obst.	Effective Depth	Add for Peak	Depth for Capac.	Bushels per Foot	Base Pack%	Bushel Capacity with Pack
--------	---------	------------	----------	------------	---	-------	--------------	----------------------	----------------------	--------------------	--------------------	------------------------	------------------------	---------------	------------------------------

**Bin count: 66**

**Facility: Harvey Section: A-1 Total: 202,540**

To Even: 203,000

## Section: D

D	001	Peaked	eave at sidewall		41.900	0.000	0.000	51.00	0.00	0.00	51.000	2.500	53.5	1108.4	10.0	65,229
D	002	Peaked	eave at sidewall roof 26.4'		89.600	0.000	0.000	48.40	0.00	0.00	48.400	6.300	54.7	5068.6	10.0	304,977
D	003	Peaked	eave at sidewall		41.900	0.000	0.000	51.00	0.00	0.00	51.000	2.500	53.5	1108.4	10.0	65,229
D	007	Peaked	eave at sidewall		14.000	0.000	0.000	19.80	0.00	0.00	19.800	0.800	20.6	123.7	5.50	2,688
D	008	Peaked	eave at sidewall		23.900	0.000	0.000	40.40	0.00	0.00	40.400	1.400	41.8	360.6	7.80	16,249
D	009	Peaked	eave at sidewall		14.000	0.000	0.000	19.80	0.00	0.00	19.800	0.800	20.6	123.7	5.50	2,688
D	010	Peaked	eave at sidewall		41.900	0.000	0.000	51.00	0.00	0.00	51.000	2.500	53.5	1108.4	10.0	65,229
D	011	Peaked	eave at sidewall		41.900	0.000	0.000	58.70	0.00	0.00	58.700	2.500	61.2	1108.4	10.0	74,617
D	012	Peaked	eave at sidewall		41.900	0.000	0.000	58.70	0.00	0.00	58.700	2.500	61.2	1108.4	10.0	74,617
D	101 S	Peaked	eave at sidewall		77.600	0.000	0.000	58.75	0.00	0.00	58.750	5.400	64.2	3801.8	10.0	268,484
D	102 S	Peaked	eave at sidewall		77.600	0.000	0.000	58.75	0.00	0.00	58.750	5.400	64.2	3801.8	10.0	268,484
D	103 S	Peaked	eave at sidewall		77.600	0.000	0.000	58.75	0.00	0.00	58.750	5.400	64.2	3801.8	10.0	268,484
D	104 S	Peaked	eave at sidewall		77.600	0.000	0.000	58.75	0.00	0.00	58.750	5.400	64.2	3801.8	10.0	268,484
D	200	Flat	top of sidewall & bttm		15.000	406.7	133.5	10.00	0.00	0.00	10.000	15.00	25.0	43645.1	10.0	1,200,241
D	201	Peaked	eave at sidewall		134.30	0.000	0.000	72.00	0.00	0.00	72.000	9.400	81.4	11387.3	10.0	1,019,619

**Bin count: 15**

**Facility: Harvey Section: D Total: 3,965,319**

To Even: 3,966,000

## Section: H

H	001	Peaked	eave at side wall		47.800	0.000	0.000	29.80	0.00	0.00	29.800	2.900	32.7	1442.5	10.0	51,887
H	002	Peaked	eave at side wall		47.800	0.000	0.000	29.80	0.00	0.00	29.800	2.900	32.7	1442.5	10.0	51,887

## NDPSC Bin Capacity Chart

Exam Date: 10/05/2015

The Arthur Companies, Inc.

Page: 7

Examiner: 2

PO Box 145

Arthur, ND

County:

Status	Section	Bin Number	Bin Type	Base Point	Diameter or Bu/Ft (Irreg.) Length	Width	Side wall	Add for Hopper	Ded. for Obst.	Effective Depth	Add for Peak	Depth for Capac.	Bushels per Foot	Base Pack%	Bushel Capacity with Pack	
<b>Bin count:</b>		<b>2</b>											<b>Facility: Harvey Section: H Total:</b>	<b>103,774</b>		
														<b>To Even:</b>	<b>104,000</b>	
<b>Section: I</b>																
I		001	Square	floor over bins	0.000	8.000	8.000	36.00	0.00	0.00	36.000	0.000	36.0	51.4	4.50	1,933
I		002	Square	floor over bins	0.000	8.000	8.000	36.00	0.00	0.00	36.000	0.000	36.0	51.4	4.50	1,933
I		004	Square	floor over bins	0.000	8.000	8.000	36.00	0.00	0.00	36.000	0.000	36.0	51.4	4.50	1,933
I		005	Square	floor over bins	0.000	8.000	8.000	36.00	0.00	0.00	36.000	0.000	36.0	51.4	4.50	1,933
I		006	Square	floor over bins	0.000	8.000	8.000	36.00	0.00	0.00	36.000	0.000	36.0	51.4	4.50	1,933
I		007	Square	floor over bins	0.000	8.000	8.000	36.00	0.00	0.00	36.000	0.000	36.0	51.4	4.50	1,933
I		008	Square	floor over bins	0.000	8.000	8.000	36.00	0.00	0.00	36.000	0.000	36.0	51.4	4.50	1,933
I		010	Square	floor over bins	0.000	8.000	8.000	36.00	0.00	0.00	36.000	0.000	36.0	51.4	4.50	1,933
I		011	Peaked	top side wall	15.000	0.000	0.000	47.70	2.30	0.00	50.000	0.900	50.9	142.1	5.50	7,631
I		012	Peaked	top side wall	15.000	0.000	0.000	47.70	2.30	0.00	50.000	0.900	50.9	142.1	5.50	7,631
I		013	Peaked	top side wall	15.000	0.000	0.000	47.70	2.30	0.00	50.000	0.900	50.9	142.1	5.50	7,631
I		014	Peaked	top side wall	24.000	0.000	0.000	51.30	0.00	0.00	51.300	1.400	52.7	363.7	7.80	20,662
I		015	Peaked	top side wall	24.000	0.000	0.000	50.70	0.00	0.00	50.700	1.400	52.1	363.7	7.80	20,427
I		016	Peaked	top side wall	24.000	0.000	0.000	50.70	0.00	0.00	50.700	1.400	52.1	363.7	7.80	20,427
I		040	Peaked	top side wall-seed hopper	16.000	0.000	0.000	15.00	2.00	0.00	17.000	1.000	18.0	161.6	5.80	3,078
I		041	Peaked	top side wall-seed hopper	16.000	0.000	0.000	15.00	2.00	0.00	17.000	1.000	18.0	161.6	5.80	3,078
I		042	Peaked	top side wall-seed hopper	16.000	0.000	0.000	15.00	2.00	0.00	17.000	1.000	18.0	161.6	5.80	3,078
I		043	Peaked	top side wall-seed hopper	15.500	0.000	0.000	20.00	2.30	0.00	22.300	0.900	23.2	151.7	5.50	3,713
I		044	Peaked	top side wall-seed hopper	15.500	0.000	0.000	20.00	2.30	0.00	22.300	0.900	23.2	151.7	5.50	3,713
I		045	Peaked	top side wall-seed hopper	15.500	0.000	0.000	20.00	2.30	0.00	22.300	0.900	23.2	151.7	5.50	3,713
I		046	Peaked	top side wall-seed hopper	15.500	0.000	0.000	20.00	2.30	0.00	22.300	0.900	23.2	151.7	5.50	3,713

Client ID: 2101

### NDPSC Bin Capacity Chart

10/05/2015 02:47:23 PM

Exam Date:10/05/2015

The Arthur Companies, Inc.  
PO Box 145  
Arthur , ND  
County:

Page: 8

Examiner: 2

Status	Section	Bin Number	Bin Type	Base Point	Diameter or Bu/Ft (Irreg.)	Length	Width	Side wall	Add for Hopper	Ded. for Obst.	Effective Depth	Add for Peak	Depth for Capac.	Bushels per Foot	Base Pack%	Bushel Capacity with Pack
--------	---------	------------	----------	------------	-------------------------------	--------	-------	--------------	----------------------	----------------------	--------------------	--------------------	------------------------	------------------------	---------------	------------------------------

**Bin count: 21**

**Facility: Harvey Section: I Total: 123,959**

**To Even: 124,000**

## Section: J

J	ground		Temporary	300,000 bushels of ground	19.000	385.0	100.0	0.100	0.00	0.00	0.100	8.700	8.8	30948.6	10.0	299,583
---	--------	--	-----------	---------------------------	--------	-------	-------	-------	------	------	-------	-------	-----	---------	------	---------

**Bin count: 1**

**Facility: Harvey Section: J Total: 299,583**

**To Even: 300,000**

**Overall Licensed Bin Capacity for:**

**The Arthur Companies, Inc.**

**Bin count: 138**

**Licensed Capacity:**  
(includes pack)

**14,967,265 Bu.**

**Licensed Capacity (to even):**  
(includes pack and section totals are  
rounded up to next highest 1000)

**14,976,000 Bu.**

THE ARTHUR COMPANIES  
INC. Corp# 2101  
Harvey Farmers Elevator  
Prairie Towers location  
Section D & I

↑  
To Flat 200 & tank 201

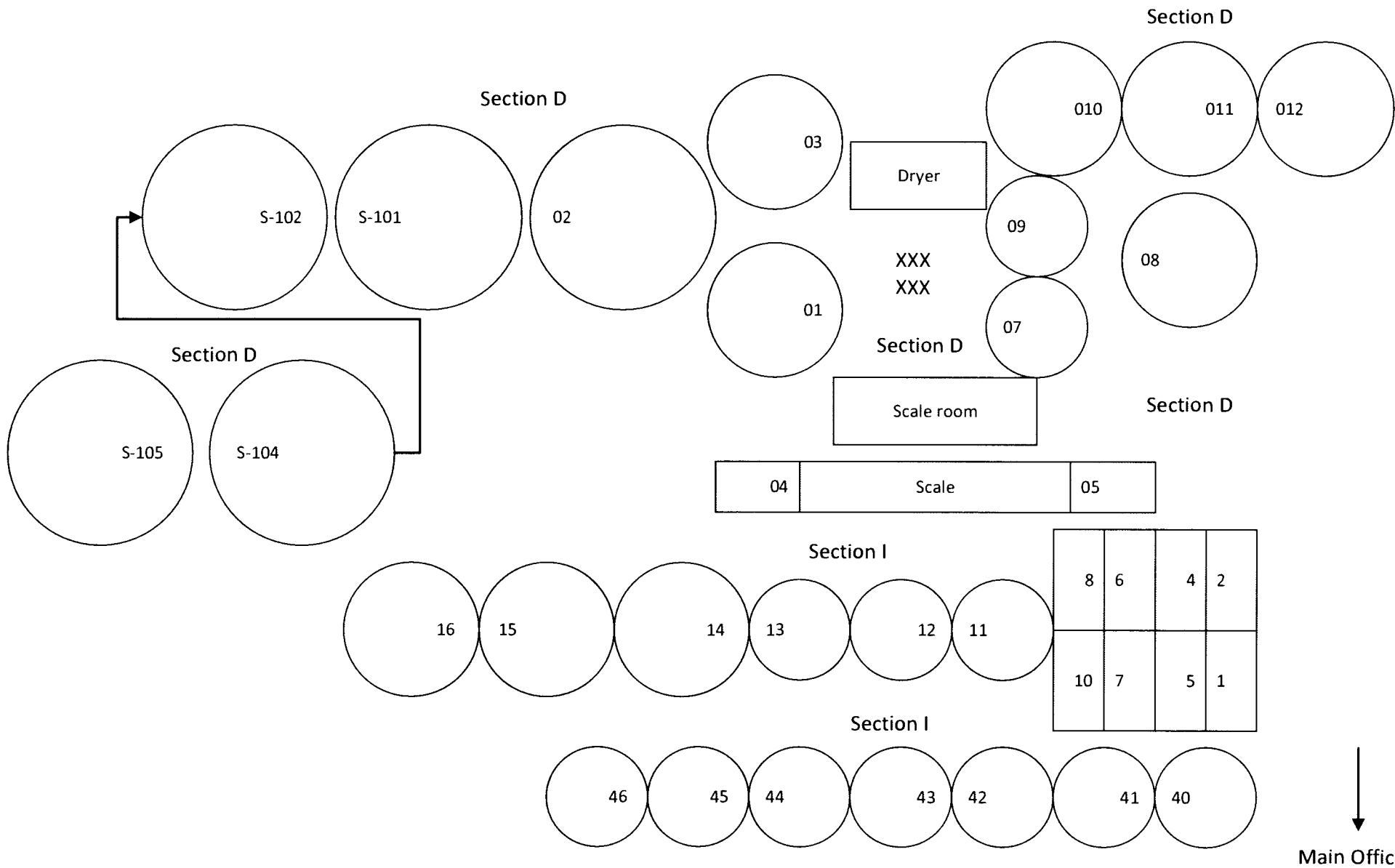

THE ARTHUR COMPANIES  
INC. Corp# 2101  
Harvey Farmers Elevator  
Prairie Towers location  
Section D flat & large tank

Page 2 of 2 at Prairie Towers

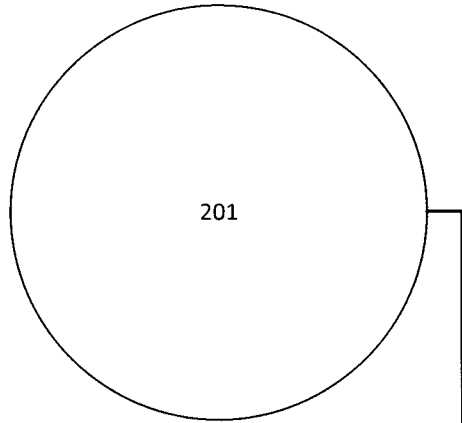

200 flat hoop covered  
406.7'L x133.5'W  
10' grain wall  
40' bottom conveyor frame

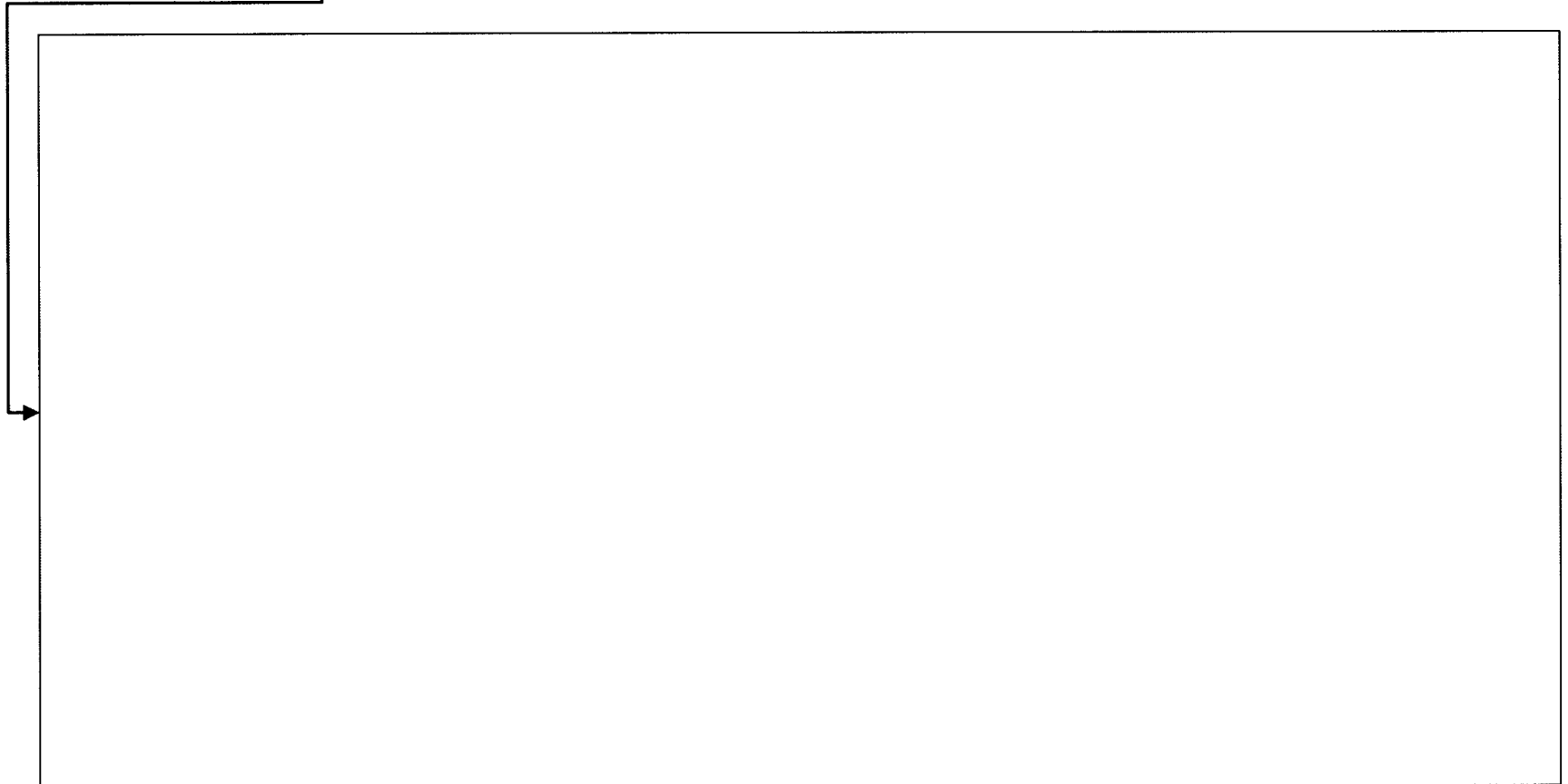
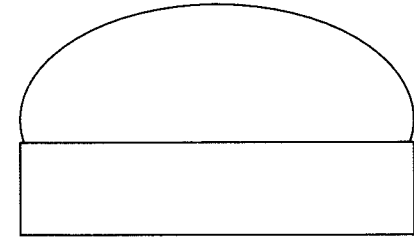

THE ARTHUR COMPANIES  
 INC. Corp# 2101  
 Harvey Farmers Elevator  
 Harvey city location  
 Section A

214	213	211		210	209	06		08	010		011	101	
217	218	216		208	207	05	04	07		018	13	14	109
220	219	21	X	03	204	205	012		016		017	102	
			X	02			02	XX		XX			ML

Driveway & scales

Office & scale room	
---------------------	--

Continued on page 2



THE ARTHUR COMPANIES  
INC. Corp# 2101  
Harvey Farmers Elevator  
Harvey city location  
Section A

Continued from page 1



011	101	103	105	107
014	109	110	111	112
017	102	104	106	108

Section A

200' east



Section H

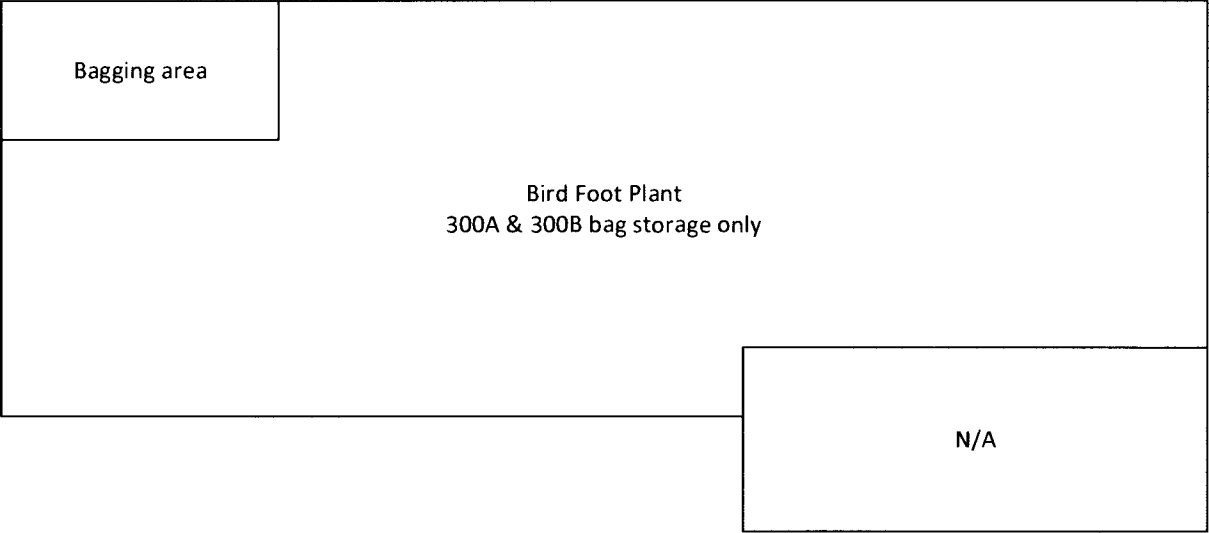
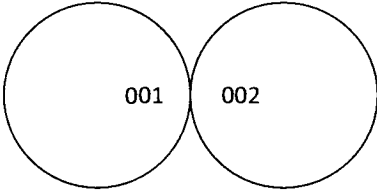

THE ARTHUR COMPANIES  
 INC. Corp# 2101  
 Harvey Farmers Elevator  
 Anamoose location  
 Section K & L

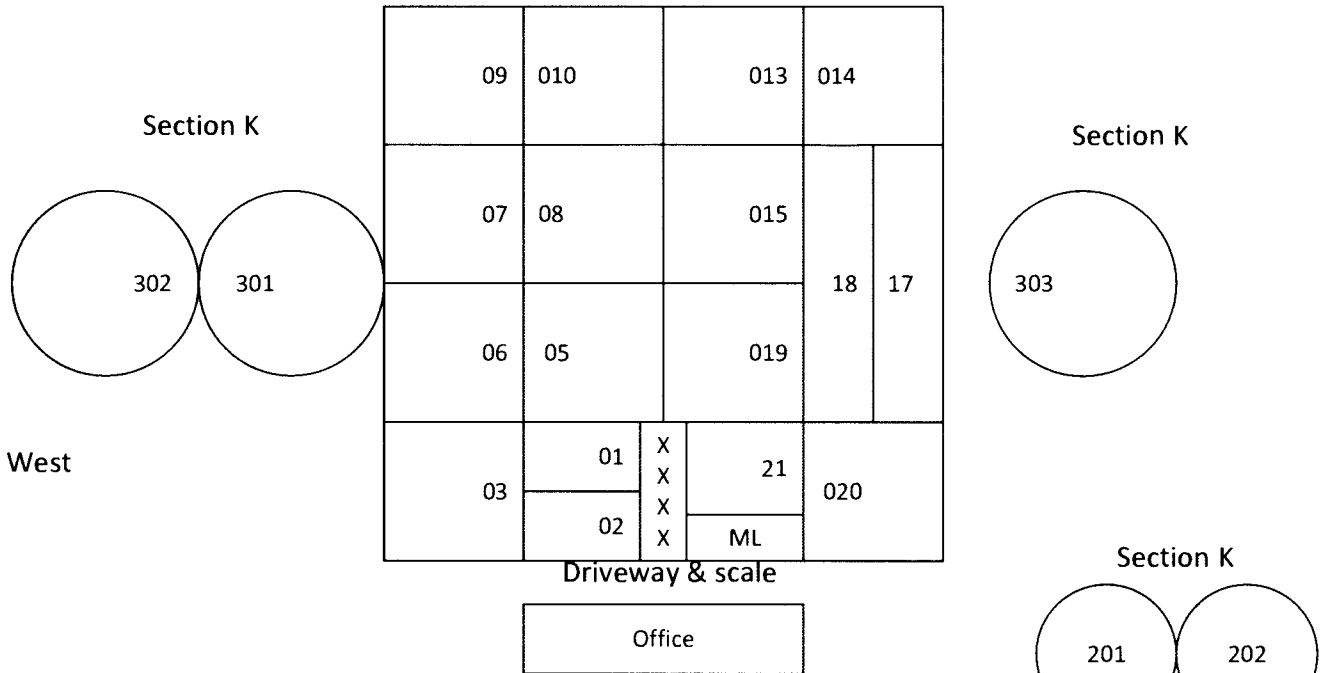

To Section L 350' West



Hopper bins 250' east

