

Exam Date:11/09/2015

Max Farmers Elevator

Page: 1

Examiner: 1

PO Box 68

Max , ND

County:

Phone: 701-679-2400

CCC Number:

Location/Container Numbers/Comments	Section	Capacity
<b>PART A - ADDITIONAL SPACE TO BE INCLUDED UNDER LICENSE</b>		
F01	B	3,539
F02	B	3,539
F03	B	3,539
F04	B	3,539
F05	B	4,000
F06	B	4,000
F07	B	4,000
F08	B	4,000
F09	B	4,000
F10	B	4,000
	<b>Total:</b>	<b>38,156</b>
<b>PART B - SPACE TO BE DELETED UNDER LICENSE</b>		
new_bin_01	B	191,660
	<b>Total:</b>	<b>191,660</b>
<b>PART C - ALL SPACE TO BE INCLUDED UNDER LICENSE</b>		
	A	1,551,000
	B	39,000
	<b>Total:</b>	<b>1,590,000</b>
<b>PART D - TOTAL CAPACITY BY FUNCTIONAL UNIT</b>		
Max 121	A B	1,590,000
	<b>Total:</b>	<b>1,590,000</b>

Exam Date: 11/09/2015

Max Farmers Elevator

Page: 1

Examiner: 1

PO Box 68

Max, ND

County:

Status	Section	Bin Number	Bin Type	Base Point	Diameter or Bu/Ft (Irreg).		Side wall	Add for Hopper	Ded. for Obst.	Effective Depth	Add for Peak	Depth for Capac.	Bushels per Foot	Base Pack%	Bushel Capacity with Pack
					Length	Width									

## Facility: Max

### Section: A

A	004	Square	work floor		0.000	6.900	5.800	53.00	0.00	0.00	53.000	0.000	53.0	32.2	2.50	1,750
A	006	Square	work floor		0.000	14.30	11.10	69.00	0.00	0.00	69.000	0.000	69.0	127.6	6.50	9,376
A	007	Square	work floor		0.000	14.30	11.00	69.00	0.00	0.00	69.000	0.000	69.0	126.4	6.50	9,289
A	008	Square	work floor		0.000	6.900	5.900	53.00	0.00	0.00	53.000	0.000	53.0	32.7	2.50	1,776
A	009	Square	work floor		0.000	12.20	7.000	50.00	0.00	0.00	50.000	0.000	50.0	68.6	5.20	3,608
A	010	Square	work floor		0.000	7.200	3.300	22.00	0.00	0.00	22.000	0.000	22.0	19.1	2.00	428
A	011	Square	work floor		0.000	12.20	7.200	50.00	0.00	0.00	50.000	0.000	50.0	70.6	5.20	3,714
A	012 T	Square	work floor		0.000	14.10	5.000	54.00	0.00	0.00	54.000	0.000	54.0	56.7	4.80	3,209
A	012 B	Square	work floor - top 54'		0.000	14.10	11.10	15.00	0.00	0.00	15.000	0.000	15.0	125.8	6.50	2,010
A	013	Square	work floor		0.000	14.10	11.00	69.00	0.00	0.00	69.000	0.000	69.0	124.7	6.50	9,163
A	014	Square	work floor		0.000	12.20	6.900	50.00	0.00	0.00	50.000	0.000	50.0	67.7	5.20	3,561
A	015 T	Square	work floor - scale in bin		0.000	5.200	2.200	13.00	0.00	0.00	13.000	0.000	13.0	9.2	2.00	122
A	015 B	Square	work floor - top 13'		0.000	6.900	5.200	37.00	0.00	0.00	37.000	0.000	37.0	28.8	2.50	1,093
A	016	Square	work floor		0.000	12.20	6.800	50.00	0.00	0.00	50.000	0.000	50.0	66.7	5.00	3,502
A	017	Square	work floor		0.000	11.00	6.900	50.00	0.00	0.00	50.000	0.000	50.0	61.0	4.80	3,196
A	018 T	Square	work floor		0.000	3.700	3.300	22.00	0.00	0.00	22.000	0.000	22.0	9.8	2.00	220
A	018 B	Square	work floor - top 22'		0.000	11.10	3.300	23.00	0.00	0.00	23.000	0.000	23.0	29.4	2.50	693
A	019	Square	work floor		0.000	6.900	5.900	50.00	0.00	0.00	50.000	0.000	50.0	32.7	2.50	1,676
A	020	Square	work floor		0.000	11.10	4.400	45.00	0.00	0.00	45.000	0.000	45.0	39.3	3.00	1,822
A	021	Square	work floor		0.000	12.20	6.900	50.00	0.00	0.00	50.000	0.000	50.0	67.7	5.20	3,561
A	022	Square	work floor		0.000	6.900	6.000	50.00	0.00	0.00	50.000	0.000	50.0	33.3	2.50	1,707

Exam Date:11/09/2015

Max Farmers Elevator

Page: 2

Examiner: 1

PO Box 68

Max, ND

County:

Status	Section	Bin Number	Bin Type	Base Point	Diameter or Bu/Ft (Irreg).		Side wall	Add for Hopper	Ded. for Obst.	Effective Depth	Add for Peak	Depth for Capac.	Bushels per Foot	Base Pack%	Bushel Capacity with Pack
					Length	Width									

## Facility: Max

### Section: A

A	023 T	Square	work floor	0.000	11.70	11.00	58.00	0.00	0.00	58.000	0.000	58.0	103.5	6.00	6,363
A	023 B	Square	work floor - top 58'	0.000	14.80	11.50	10.00	0.00	0.00	10.000	0.000	10.0	136.8	6.50	1,457
A	024 T	Square	work floor	0.000	11.80	11.00	58.00	0.00	0.00	58.000	0.000	58.0	104.3	6.00	6,412
A	024 B	Square	work floor - top 58'	0.000	14.80	11.50	10.00	0.00	0.00	10.000	0.000	10.0	136.8	6.50	1,457
A	025	Square	work floor	0.000	12.20	11.70	59.00	0.00	0.00	59.000	0.000	59.0	114.7	6.20	7,187
A	026	Square	work floor	0.000	12.20	11.80	59.00	0.00	0.00	59.000	0.000	59.0	115.7	6.20	7,249
A	027 T	Square	work floor	0.000	11.70	11.00	58.00	0.00	0.00	58.000	0.000	58.0	103.5	6.00	6,363
A	027 B	Square	work floor - top 58'	0.000	14.80	11.50	10.00	0.00	0.00	10.000	0.000	10.0	136.8	6.50	1,457
A	028 T	Square	work floor	0.000	11.80	11.00	58.00	0.00	0.00	58.000	0.000	58.0	104.3	6.00	6,412
A	028 B	Square	work floor - top 58'	0.000	14.80	11.50	10.00	0.00	0.00	10.000	0.000	10.0	136.8	6.50	1,457
A	029 T	Square	work floor	0.000	11.50	11.00	58.00	0.00	0.00	58.000	0.000	58.0	101.7	6.00	6,253
A	029 B	Square	work floor - top 58'	0.000	14.80	11.10	10.00	0.00	0.00	10.000	0.000	10.0	132.1	6.50	1,407
A	030	Square	work floor	0.000	12.20	11.50	59.00	0.00	0.00	59.000	0.000	59.0	112.8	6.20	7,068
A	032 T	Square	work floor	0.000	11.50	11.00	58.00	0.00	0.00	58.000	0.000	58.0	101.7	6.00	6,253
A	032 B	Square	work floor -top 58'	0.000	14.80	11.10	10.00	0.00	0.00	10.000	0.000	10.0	132.1	6.50	1,407
A	101 T	Square	work floor	0.000	17.10	15.10	61.50	0.00	0.00	61.500	0.000	61.5	207.6	7.00	13,661
A	101 B	Square	work floor - top 61.5'	0.000	14.80	14.40	8.000	0.00	0.00	8.000	0.000	8.0	171.3	7.00	1,466
A	102 T	Square	work floor	0.000	17.10	15.10	61.50	0.00	0.00	61.500	0.000	61.5	207.6	7.00	13,661
A	102 B	Square	work floor - top 61.5'	0.000	14.80	14.40	8.000	0.00	0.00	8.000	0.000	8.0	171.3	7.00	1,466
A	103 T	Square	work floor	0.000	17.10	15.40	61.50	0.00	0.00	61.500	0.000	61.5	211.7	7.00	13,931
A	103 B	Square	work floor - top 61.5'	0.000	15.20	14.40	8.000	0.00	0.00	8.000	0.000	8.0	175.9	7.00	1,505

Exam Date: 11/09/2015

Max Farmers Elevator

Page: 3

Examiner: 1

PO Box 68

Max, ND

County:

Status	Section	Bin Number	Bin Type	Base Point	Diameter or Bu/Ft (Irreg).		Side wall	Add for Hopper	Ded. for Obst.	Effective Depth	Add for Peak	Depth for Capac.	Bushels per Foot	Base Pack%	Bushel Capacity with Pack
					Length	Width									

## Facility: Max

### Section: A

A	104 T	Square	work floor	0.000	17.10	15.40	61.50	0.00	0.00	61.500	0.000	61.5	211.7	7.00	13,931
A	104 B	Square	work floor - top 61.5'	0.000	15.20	14.40	8.000	0.00	0.00	8.000	0.000	8.0	175.9	7.00	1,505
A	105 T	Square	work floor	0.000	17.10	15.40	61.50	0.00	0.00	61.500	0.000	61.5	211.7	7.00	13,931
A	105 B	Square	work floor - top 61.5'	0.000	15.20	14.40	8.000	0.00	0.00	8.000	0.000	8.0	175.9	7.00	1,505
A	106 T	Square	work floor	0.000	17.10	15.40	61.50	0.00	0.00	61.500	0.000	61.5	211.7	7.00	13,931
A	106 B	Square	work floor - top 61.5'	0.000	15.20	14.40	8.000	0.00	0.00	8.000	0.000	8.0	175.9	7.00	1,505
A	107 T	Square	work floor	0.000	17.10	15.40	61.50	0.00	0.00	61.500	0.000	61.5	211.7	7.00	13,931
A	107 B	Square	work floor - top 61.5'	0.000	15.20	14.40	8.000	0.00	0.00	8.000	0.000	8.0	175.9	7.00	1,505
A	108 T	Square	work floor	0.000	17.10	15.40	61.50	0.00	0.00	61.500	0.000	61.5	211.7	7.00	13,931
A	108 B	Square	work floor top 61.5'	0.000	15.20	14.40	8.000	0.00	0.00	8.000	0.000	8.0	175.9	7.00	1,505
A	109 T	Square	work floor	0.000	17.10	15.40	61.50	0.00	0.00	61.500	0.000	61.5	211.7	7.00	13,931
A	109 B	Square	work floor - top 61.5'	0.000	15.20	14.40	8.000	0.00	0.00	8.000	0.000	8.0	175.9	7.00	1,505
A	110 T	Square	work floor	0.000	17.10	15.40	61.50	0.00	0.00	61.500	0.000	61.5	211.7	7.00	13,931
A	110 B	Square	work floor - top 61.5'	0.000	15.20	14.40	8.000	0.00	0.00	8.000	0.000	8.0	175.9	7.00	1,505
A	111 T	Irregular	work floor 11.8 x 15 scale	107.90	0.000	0.000	11.00	0.00	0.00	11.000	0.000	11.0	107.9	6.20	1,261
A	111 B	Square	work floor - top 11'	0.000	15.00	11.80	58.50	0.00	0.00	58.500	0.000	58.5	142.3	6.80	8,891
A	112	Square	work floor	0.000	15.00	11.80	69.50	0.00	0.00	69.500	0.000	69.5	142.3	6.80	10,563
A	113 T	Irregular	work floor 15 x 5 scale	46.600	0.000	0.000	11.00	0.00	0.00	11.000	0.000	11.0	46.6	4.00	534
A	113 B	Square	work floor - top 11'	0.000	15.00	5.000	44.00	0.00	0.00	44.000	0.000	44.0	60.3	4.80	2,780
A	201	Round	top of slab	20.000	0.000	0.000	100.5	0.00	0.00	100.50	0.000	100.5	252.5	6.50	27,025
A	202	Irregular	top of slab - interstice	88.700	0.000	0.000	73.00	0.00	0.00	73.000	0.000	73.0	88.7	5.80	6,851

Exam Date:11/09/2015

Max Farmers Elevator

Page: 4

Examiner: 1

PO Box 68

Max , ND

County:

Status	Section	Bin Number	Bin Type	Base Point	Diameter or Bu/Ft (Irreg).	Length	Width	Side wall	Add for Hopper	Ded. for Obst.	Effective Depth	Add for Peak	Depth for Capac.	Bushels per Foot	Base Pack%	Bushel Capacity with Pack
--------	---------	------------	----------	------------	-------------------------------	--------	-------	--------------	----------------------	----------------------	--------------------	--------------------	------------------------	------------------------	---------------	------------------------------

## Facility: Max

### Section: A

A	203	Irregular	top of slab - interstice		37.800	0.000	0.000	73.00	0.00	0.00	73.000	0.000	73.0	37.8	3.00	2,842
A	206	Irregular	top of slab - interstice		37.800	0.000	0.000	73.00	0.00	0.00	73.000	0.000	73.0	37.8	3.00	2,842
A	207	Irregular	top of slab - interstice		93.600	0.000	0.000	73.00	0.00	0.00	73.000	0.000	73.0	93.6	5.80	7,229
A	208	Round	top of slab		20.000	0.000	0.000	100.5	0.00	0.00	100.50	0.000	100.5	252.5	6.50	27,025
A	210	Round	top of slab		20.000	0.000	0.000	99.50	0.00	0.00	99.500	0.000	99.5	252.5	6.50	26,757
A	213	Irregular	top of slab - interstice		69.500	0.000	0.000	74.00	0.00	0.00	74.000	0.000	74.0	69.5	5.20	5,410
A	214	Irregular	top of slab - interstice		69.500	0.000	0.000	47.00	0.00	0.00	47.000	0.000	47.0	69.5	5.20	3,437
A	217	Round	top of slab		20.000	0.000	0.000	99.50	0.00	0.00	99.500	0.000	99.5	252.5	6.50	26,757
A	300	Peaked	top of sidewall		49.300	0.000	0.000	65.50	0.00	0.00	65.500	3.500	69.0	1534.5	10.0	116,469
A	301	Round	top of slab		37.000	0.000	0.000	93.00	0.00	0.00	93.000	0.000	93.0	864.3	10.0	88,418
A	302	Round	top of slab		37.000	0.000	0.000	93.00	0.00	0.00	93.000	0.000	93.0	864.3	10.0	88,418
A	303	Round	top of slab		37.000	0.000	0.000	93.00	0.00	0.00	93.000	0.000	93.0	864.3	10.0	88,418
A	304	Round	top of slab		37.000	0.000	0.000	93.00	0.00	0.00	93.000	0.000	93.0	864.3	10.0	88,418
A	401	Round	top of slab		26.100	0.000	0.000	102.0	0.00	0.00	102.00	0.000	102.0	430.1	8.20	47,467
A	402	Round	top of slab		26.100	0.000	0.000	103.5	0.00	0.00	103.50	0.000	103.5	430.1	8.20	48,165
A	403	Round	top of slab		26.100	0.000	0.000	103.5	0.00	0.00	103.50	0.000	103.5	430.1	8.20	48,165
A	404	Round	top of slab		26.100	0.000	0.000	102.0	0.00	0.00	102.00	0.000	102.0	430.1	8.20	47,467
A	405	Irregular	top of slab interstice		143.40	0.000	0.000	103.5	0.00	0.00	103.50	0.000	103.5	143.4	6.80	15,851
A	406	Round	top of roof		46.000	0.000	0.000	96.50	0.00	0.00	96.500	0.000	96.5	1335.9	10.0	141,805
A	407	Round	top of roof		46.000	0.000	0.000	96.50	0.00	0.00	96.500	0.000	96.5	1335.9	10.0	141,805
A	408	Round	top of roof		46.000	0.000	0.000	96.50	0.00	0.00	96.500	0.000	96.5	1335.9	10.0	141,805

# NDPSC Bin Capacity Chart

Exam Date: 11/09/2015

Max Farmers Elevator  
PO Box 68  
Max, ND  
County:

Examiner: 1

Status	Section	Bin Number	Bin Type	Base Point	Diameter or Bu/Ft (Irreg.) Length	Width	Side wall	Add for Hopper	Ded. for Obst.	Effective Depth	Add for Peak	Depth for Capac.	Bushels per Foot	Base Pack%	Bushel Capacity with Pack
<b>Bin count:</b>		<b>84</b>											<b>Facility: Max Section: A Total:</b>	<b>1,550,295</b>	
														<b>To Even:</b>	<b>1,551,000</b>

## Section: B

Added	B	F01	Peaked	top of sidewall	16.000	0.000	0.000	17.00	2.70	0.00	19.700	1.000	20.7	161.6	5.80	3,539
Added	B	F02	Peaked	top of sidewall	16.000	0.000	0.000	17.00	2.70	0.00	19.700	1.000	20.7	161.6	5.80	3,539
Added	B	F03	Peaked	top of sidewall	16.000	0.000	0.000	17.00	2.70	0.00	19.700	1.000	20.7	161.6	5.80	3,539
Added	B	F04	Peaked	top of sidewall	16.000	0.000	0.000	17.00	2.70	0.00	19.700	1.000	20.7	161.6	5.80	3,539
Added	B	F05	Peaked	top of sidewall	16.000	0.000	0.000	20.00	2.40	0.00	22.400	1.000	23.4	161.6	5.80	4,000
Added	B	F06	Peaked	top of sidewall	16.000	0.000	0.000	20.00	2.40	0.00	22.400	1.000	23.4	161.6	5.80	4,000
Added	B	F07	Peaked	top of sidewall	16.000	0.000	0.000	20.00	2.40	0.00	22.400	1.000	23.4	161.6	5.80	4,000
Added	B	F08	Peaked	top of sidewall	16.000	0.000	0.000	20.00	2.40	0.00	22.400	1.000	23.4	161.6	5.80	4,000
Added	B	F09	Peaked	top of sidewall	16.000	0.000	0.000	20.00	2.40	0.00	22.400	1.000	23.4	161.6	5.80	4,000
Added	B	F10	Peaked	top of sidewall	16.000	0.000	0.000	20.00	2.40	0.00	22.400	1.000	23.4	161.6	5.80	4,000
<b>Bin count:</b>		<b>10</b>											<b>Facility: Max Section: B Total:</b>	<b>38,156</b>		
														<b>To Even:</b>	<b>39,000</b>	

**Overall Licensed Bin Capacity for:**

**Max Farmers Elevator**

**Bin count: 94**

**Licensed Capacity:**  
(includes pack)

**1,588,451 Bu.**

**Licensed Capacity (to even):**  
(includes pack and section totals are rounded up to next highest 1000)

**1,590,000 Bu.**

Max Farmers Elevator  
Max, ND  
Section A - Concrete

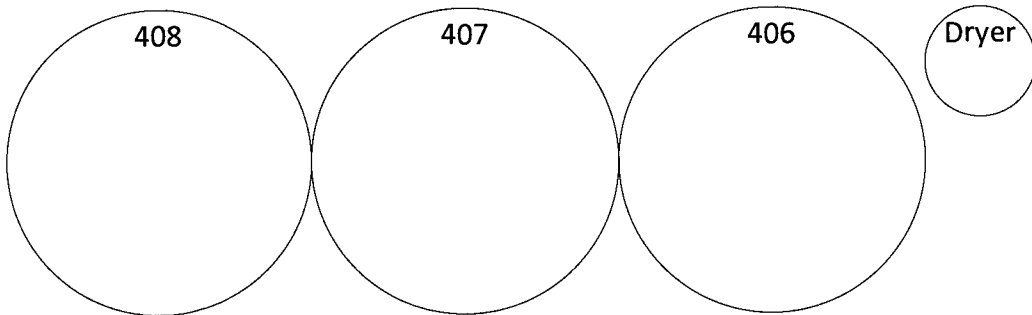
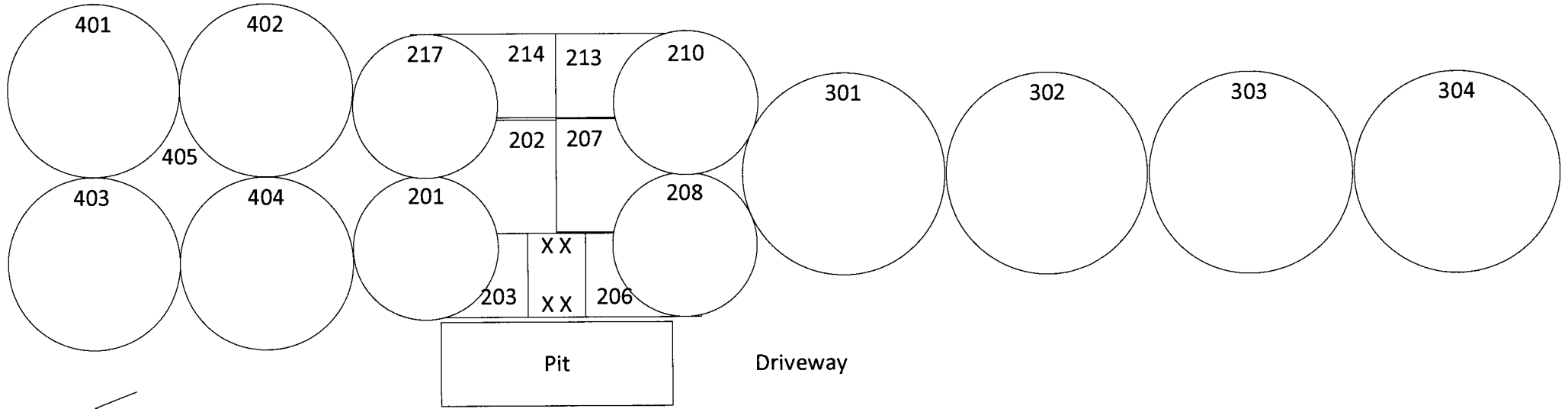
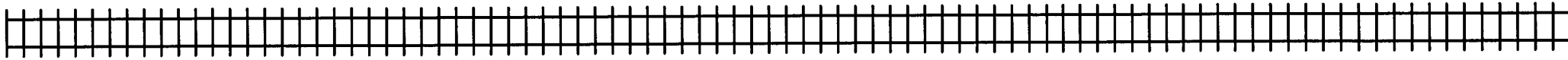

Max Farmers Elevator  
 Max, ND  
 Section A - West

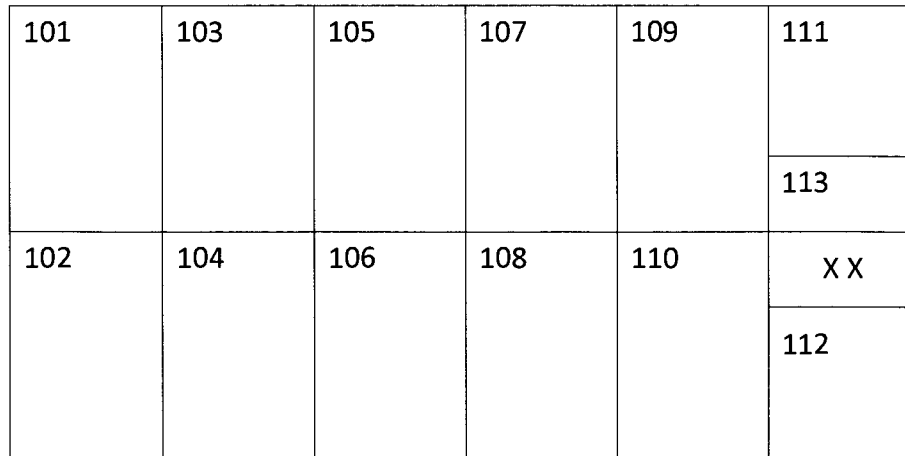
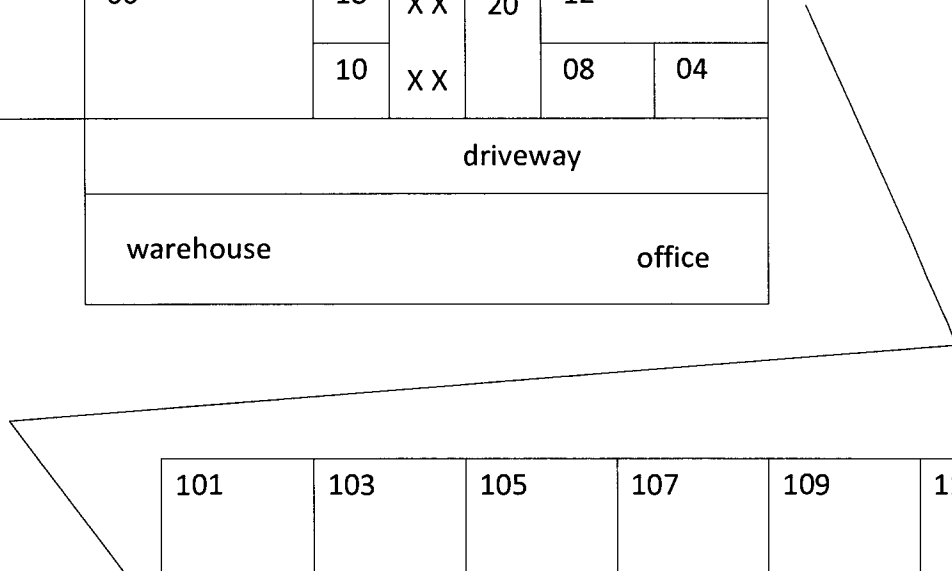
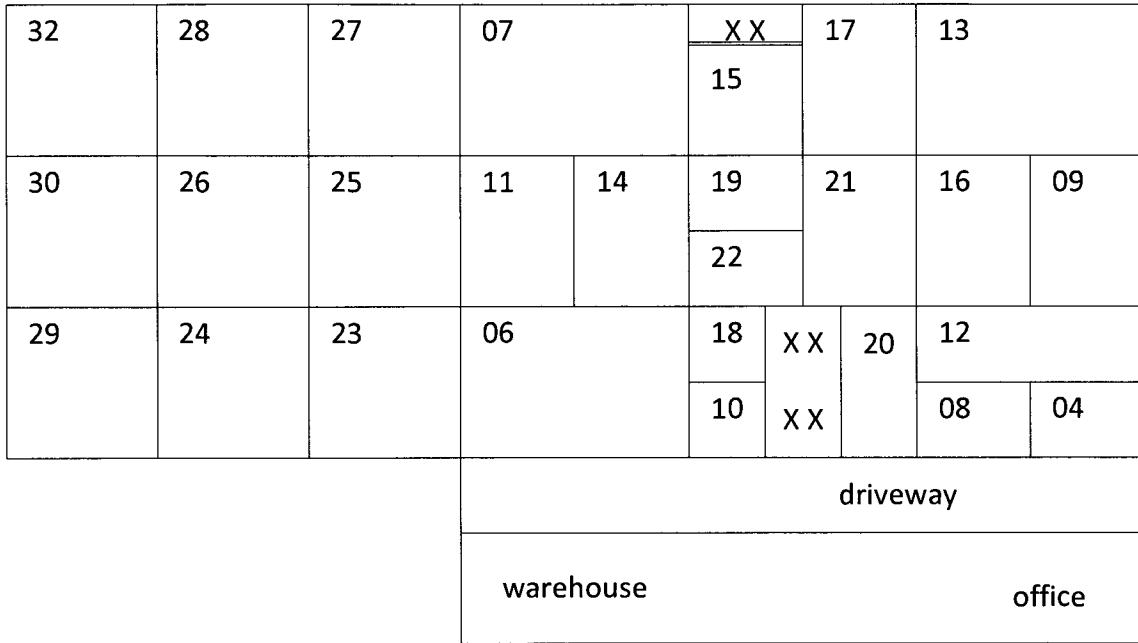
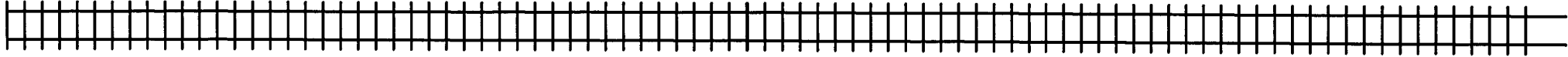

Dryer

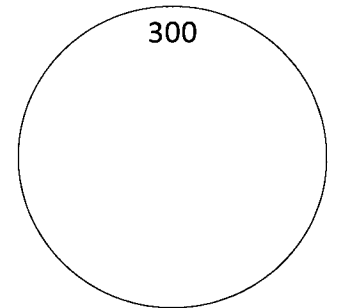

Max Farmers Elevator  
Max, ND  
Section B

Temporary Bag  
Storage Area



Main Elevator



North

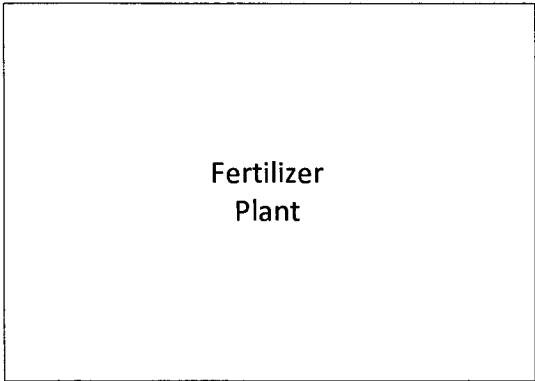
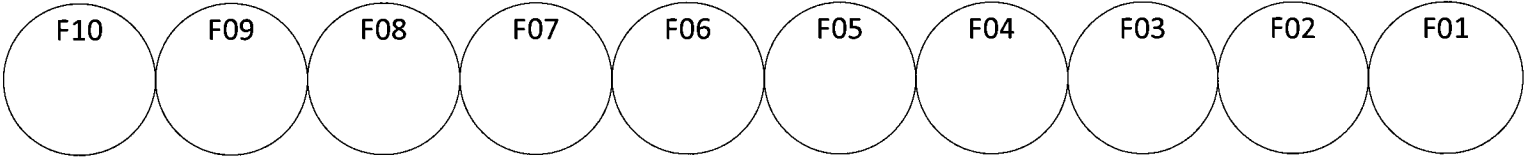

Highway 83

