

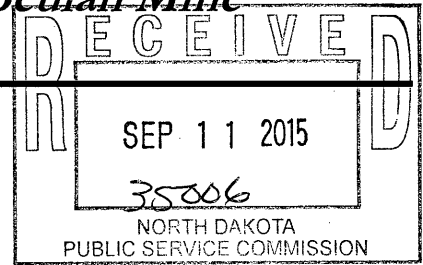

Dakota Westmoreland Corporation - Beulah Mine
A Subsidiary of WESTMORELAND COAL COMPANY



September 9, 2015

Mr. James R. Deutsch
Director, Reclamation Division
Public Service Commission
600 E Boulevard Ave, Dept 408
Bismarck, ND 58505-0480

Dear Mr. Deutsch:

Re: Revision No. 30, KRSB-8802
Affidavits of Publication

Pursuant to the requirements of Chapter 38-14-1, NDCC, Section 38-14.1-18(1), attached for your files are copies of affidavits of publication from the *Bismarck Tribune*, the *Hazen Star* and the *Center Republican*.

If you have any questions, please contact me at extension 3926.

Sincerely,

Paula L. Gores
Permit Coordinator
Engineering and Environmental

/s/
Encl/

8 RC-15-425 Filed 09/11/2015 Pages: 8
Affidavits of newspaper publication filed by the applicant
Dakota Westmoreland Corporation
Paula Gores

10 RC-15-424 Filed 09/11/2015 Pages: 8
Affidavits of newspaper publication filed by the applicant
Dakota Westmoreland Corporation
Paula Gores



DAKOTA WESTMORELAND
ACCOUNTS PAYABLE
PO BOX 842909
BOSTON MA 02284-2909

Cust
Ph
D

Date	Order #	Type	Order Amt
08/13/15	20799333	INV	2,616.00

Amount Paid	CK #
-------------	------

Cash Amt

CREDIT CARD
MasterCard
Card #:
Exp Date:
Signature:
Credit card used

Line	Code	Advertiser	Agency
17	NI/2	Dakota Westmoreland Corp.	Daryl E. Zimmerman, Kristjan Melsted, Margery Trenbeath, Laura Bailey Waldemar Melsted, Alfred Kristjanson, Esther Syrup, Margaret Blumhardt, Emily Gundmundson, Ed L. Hurley George Kristjanson, Evelyn Hjalmarson, Joyce Perila, Joe A. Kristjanson, Rosalyn Bruhschwein, Marcella Erickson, Melvin Kristjanson Ruth Melstad, Marino S. Melstad, Elin Mathewson
18	NW1/4	Leland Erickson, Michael C. Bergquist Gerald Bergquist	Leland Erickson Michael C. Bergquist Gerald Bergquist
18	NE1/4	E. Wayne Boland, Delvin Reich, Joseph Edward Reich Stephanie Ann Keltner Jack Patrick Reich	E. Wayne Boland, Delvin Reich, Joseph Edward Reich Stephanie Ann Keltner Jack Patrick Reich
18	SW1/4	Bertha, Faith & Faye LLC	Bertha Orth Bertha, Faith & Faye LLC
18	SE1/4	Jerome & Jane Boeshans	Esther Koehler, E. Wayne Boland, Delvin Reich, Joseph Edward Reich, Stephanie Ann Keltner, Jack Patrick Reich
19	NE1/4	William & Miles Heth	William & Miles Heth State of North Dakota
19	SE1/4	William & Miles Heth	William & Miles Heth
19	W1/2	Darell Herman	Karen A. Heth Marleen T. Schnaidt Mary Margaret Wolf Darell J. Herman
20	NW1/4, SW1/4NE1/4	William & Miles Heth	USA

PLEASE DETACH AND RETURN TOP PORTION WITH YOUR

Lee Enterprises no longer accepts credit card payments sent via e-mail. Emails containing the coupon above to send a credit card payment to remittance address located in the coupon. You may also send the coupon to a secure fax at 608-791-8212.

Date	Date	Times Run	Description	Lines
07/23/15	08/13/15	4	Bismarck Tribune	328.00

Affidavit of Publication

State of North Dakota) SS County of Burleigh
Before me, a Notary Public for the State of North Dakota personally appeared CK who being duly sworn, deposes and says that he (she) is the Clerk of Bismarck Tribune Co., and that the publication(s) were made through the Bismarck Tribune on the following dates: 7/23, 30, 8/6, 13 Signed Calvin Kuntz sworn and subscribed to before me this 8th day of September, 2015
Notary Public in and for the State of North Dakota

MORGAN DOLL
Notary Public
State of North Dakota
My Commission Expires Jan 28, 2017

NOTICE OF APPLICATION FOR REVISION AND RENEWAL TO A SURFACE MINE PERMIT

Please take notice that Dakota Westmoreland Corporation, PO Box 39, Beulah, North Dakota 58523, has made application to the North Dakota Public Service Commission for Revision No. 30 and Renewal No. 5 for permit KRSB-8802 at its Beulah Mine. KRSB-8802 is located in Sections 10, 11, 12, 13, 14, 15 and 24, T.143N., R.88W., Mercer County, ND and Sections 7, 8, 17, 18, 19 and 20, T.143N., R.87W., Oliver County, ND. The precise location and boundary of the land included is depicted on the accompanying map. Permit KRSB-8802 encompasses 4,905.9 acres for coal excavation, mining and associated disturbance activities in support thereof. Coal removal has been completed from this permit area but final reclamation of portions of the permit area remains to be completed. A number of facilities (shop/office, coal dump, haulroads, etc) are also being used to support mining in another permit area. Revision No. 30 updates the current permit to reflect changes necessary for the next permit term including updates to the legal and financial sections, general operations and reclamation plans. Renewal No. 5 will allow mining and reclamation activities to continue during the next five-year permit term ending October 23, 2020. Dakota Westmoreland Corporation's application is on file in the Office of the Director, Reclamation Division, Public Service Commission, State Capitol, Bismarck, North Dakota, and in the Office of the County Auditor, Mercer County, Stanton, and Oliver County, Center, North Dakota. This application is available for public inspection therein during normal business hours. Any persons with an interest which is or may be adversely affected may file written comments, objections, or request an informal conference on the revision and renewal

Please return invoice

Remarks

Bismarck Trib
www.bismarcktribune.com
PO BOX 4001
LaCrosse, WI

Terms: PAYMEN

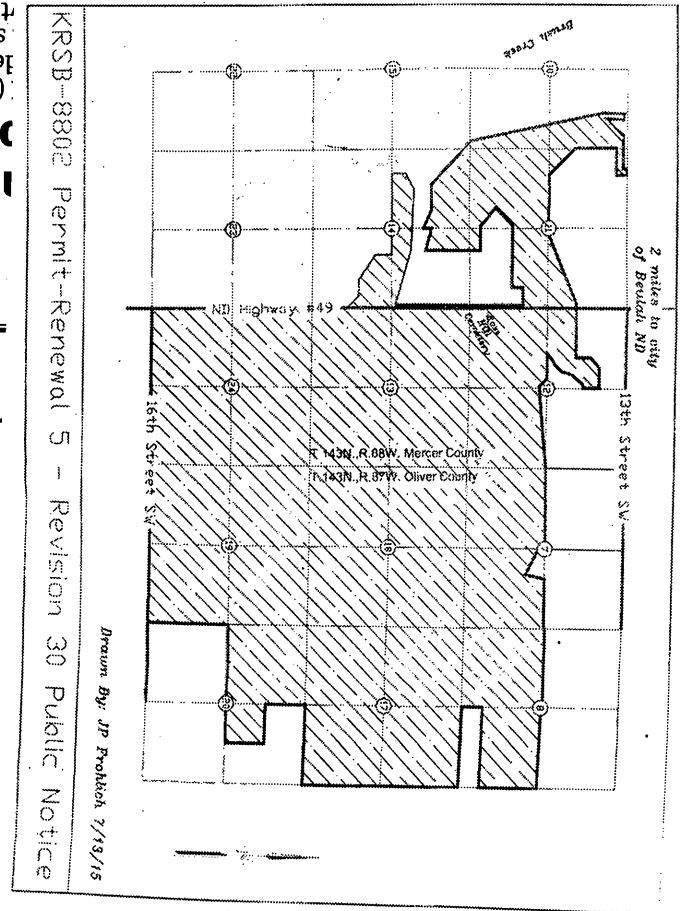

AFFIDAVIT OF PUBLICATION

STATE OF NORTH DAKOTA)
)
COUNTY OF Mercer)

I SHELLEY CHASE, being first duly sworn, on my own oath, say, that I am the bookkeeper of the Hazen Star, a weekly newspaper of general circulation, published in the city of Hazen, that the advertisement headed:

DAKOTA WESTMORELAND COAL COMPANY HZ-REVISION NO 30 RENEWAL NO 5 KRSB-8802/LEGAL

a printed copy of which is here annexed, was published in the regular and entire issue of said newspaper during the period and time of publication, and that the notice was published in the newspaper proper, and not in a supplement,

for 4 consecutive week 08/13/2015 to wit:

Column Inches 56.25	\$6.38	\$358.88	07/23/2015
Column Inches 56.25	\$6.38	\$358.88	07/30/2015
Column Inches 56.25	\$6.38	\$358.88	08/06/2015
Column Inches 56.25	\$6.38	\$358.88	08/13/2015

Notary Fee \$1.00 Total Cost of Legal \$1,436.52

Shelley Chase

Subscribed and sworn to before me this 13th day of August A.D. 2015

(Seal) *Darla J. Mautz*
Notary Public, State of North Dakota

My Commission Expires

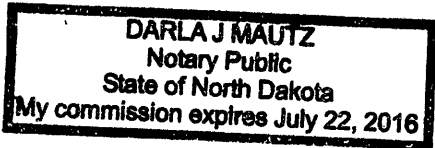

**NOTICE OF APPLICATION
FOR REVISION AND RENEWAL TO A SURFACE MINE PERMIT**

Public Notice

Please take notice that Dakota Westmoreland Corporation, PO Box 39, Beulah, North Dakota 58523, has made application to the North Dakota Public Service Commission for Revision No. 30 and Renewal No. 5 for permit KRSB-8802 at its Beulah Mine.

KRSB-8802 is located in Sections 10, 11, 12, 13, 14, 15 and 24, T.143N., R.88W., Mercer County, ND and Sections 7, 8, 17, 18, 19 and 20, T.143N., R.87W., Oliver County, ND. The precise location and boundary of the land included is depicted on the accompanying map.

Permit KRSB-8802 encompasses 4,905.9 acres for coal excavation, mining and associated disturbance activities in support thereof. Coal removal has been completed from this permit area but final reclamation of portions of the permit area remains to be completed. A number of facilities (shop/office, coal dump, haulroads, etc) are also being used to support mining in another permit area. Revision No. 30 updates the current permit to reflect changes necessary for the next permit term including updates to the legal and financial sections, general operations and reclamation plans. Renewal No. 5 will allow mining and reclamation activities to continue during the next five-year permit term ending October 23, 2020.

Dakota Westmoreland Corporation's application is on file in the Office of the Director, Reclamation Division, Public Service Commission, State Capitol, Bismarck, North Dakota, and in the Office of the County Auditor, Mercer County, Stanton, and Oliver County, Center, North Dakota. This application is available for public inspection therein during normal business hours.

Any persons with an interest which is or may be adversely affected may file written comments, objections, or request an informal conference on the revision and renewal applications with the North Dakota Public Service Commission, 600 East Boulevard, Dept. 408, Bismarck ND 58505-0480, within 30 days of the last publication of this notice. Any request for an informal conference must include the reasons for the request.

The legal description and names of the apparent surface and subsurface mineral owners of land included within the area applied for are as follows:

Mercer County, T.143N., R.88W.

SECTION	LOCATION	SURFACE OWNER(S)	COAL OWNER(S)
10	E1/2E1/2	Otter Tail Power Co. Northern Municipal Power Agcy. Montana-Dakota Utilities Co. Northwestern Energy Dakota Westmoreland Corp.	State of North Dakota and the USA
11	W1/2	Otter Tail Power Co. Northern Municipal Power Agcy. Montana-Dakota Utilities Co. Northwestern Energy Dakota Westmoreland Corp.	Glenn & Beatrice Murray Gary Murray Phyllis O'Neil Armon & Peggy Jo Wolff Family Mineral Trust
11	NE1/4	Otter Tail Power Co. Northern Municipal Power Agcy. Montana-Dakota Utilities Co. Northwestern Energy	Glenn & Beatrice Murray Gary Murray Phyllis O'Neil Armon & Peggy Jo Wolff Family Mineral Trust
11	SE1/4	Dakota Westmoreland Corp. Otter Tail Power Co. Northern Municipal Power Agcy. Montana-Dakota Utilities Co. Northwestern Energy	Henry G. Grishkowsky Delmar N. Grishkowsky Eldon Grishkowsky
12	NW1/4	Allegra & Leroy Boeckel	Allegra Boeckel, George J. Jr. and Margaret Permann
12	SE1/4	Abbey Family Partnership	Abbey Family Partnership State of North Dakota Abbey Family Partnership
12	SW1/4	Otter Tail Power Co. Northern Municipal Power Agcy. Montana-Dakota Utilities Co. Northwestern Energy Dakota Westmoreland Corp.	State of North Dakota Abbey Family Partnership State of North Dakota
13	NW1/4	Darell Herman	Abbey Family Partnership
13	NE1/4	Darell Herman	Bertha, Faith & Faye LLC
13	N1/2SE1/4	Darell Herman	Bertha, Faith & Faye LLC
13	SW1/4,	Darell Herman	Darell Herman, Karen Heth
		S1/2SE1/4	Mary Margaret Wolf

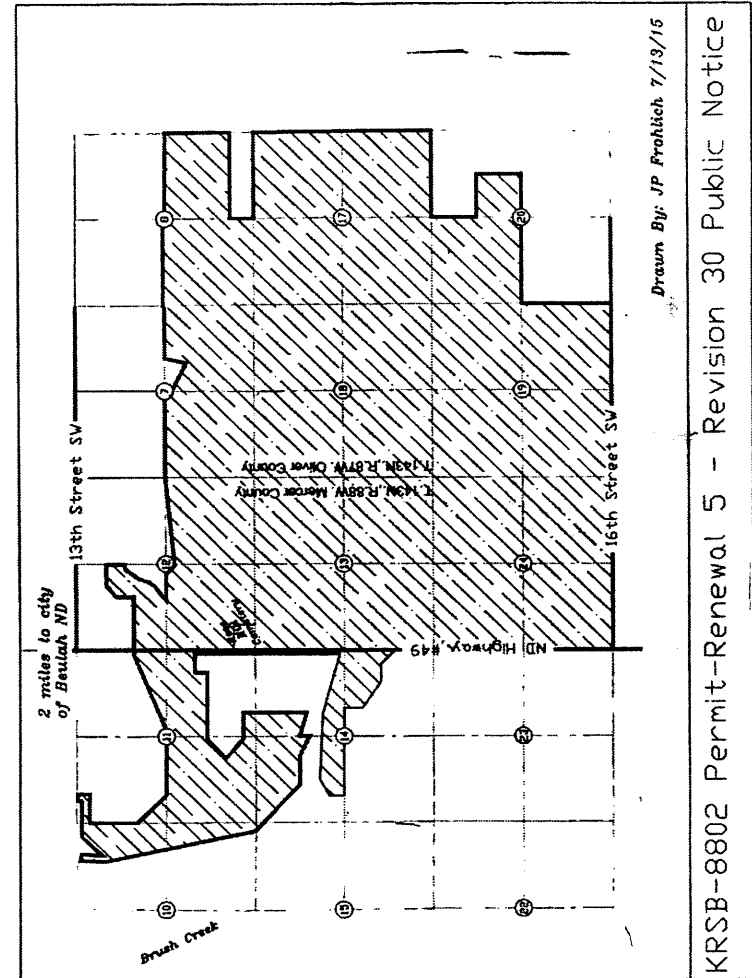

Drawn By: JP Prohlich 7/13/15

KRSB-8802 Permit-Renewal 5 - Revision 30 Public Notice

(7-23-15) (7-30-15) (8-6-15) (8-13-15)

ch
il
L
e
ll
(

14	SE1/4	Montana-Dakota Utilities Co.	Jonathan W.A. Liebelt Estate
15	NE1/4	Northwestern Energy Dakota Westmoreland Corp.	Robert A. Keogh Priscilla A. Keogh Faye L. Keogh Claire C. Schwalbe
24	NE1/4	Jonathan W.A. Liebelt Estate Bertha, Faith & Faye LLC	Bertha Orth Bertha, Faith & Faye LLC USA USA
24	NW1/4	Jonathan W.A. Liebelt Estate	
24	S1/2	Bertha, Faith & Faye LLC	

Oliver County, T.143N., R.87W.

<u>SECTION</u>	<u>LOCATION</u>	<u>SURFACE OWNER(S)</u>	<u>COAL OWNER(S)</u>
7	S1/2	Dennis Neuberger	Alice Neuberger, Dennis Neuberger, Dale Neuberger, Audrey Cody, Marvelli McMains Marion McKinney Baird USA
8	SW1/4	Ken Neuberger	William & Miles Heth
8	SE1/4	Elmer N. Neuberger	William & Miles Heth
17	SW1/4	William & Miles Heth	Daryl E. Zimmerman, Kristjan Melsted, Margery Trenbeath, Laura Bailey
17	SE1/4	William & Miles Heth	Waldemar Melsted, Alfred Kristjanson, Esther Syrup, Margaret Blumhardt, Emily Gundmundson, Ed L. Hurley
17	N1/2	Dakota Westmoreland Corp.	George Kristjanson, Evelyn Hjalmarson, Joyce Perila, Joe A. Kristjanson, Rosalyn Bruhschwein, Marcella Erickson, Melvin Kristjanson Ruth Melstad, Marino S. Melstad, Elin Mathewson
18	NW1/4	Leland Erickson, Michael C. Bergquist Gerald Bergquist	Leland Erickson Michael C. Bergquist Gerald Bergquist
18	NE1/4	E. Wayne Boland, Delvin Reich, Joseph Edward Reich Stephanie Ann Keltner Jack Patrick Reich	E. Wayne Boland, Delvin Reich, Joseph Edward Reich Stephanie Ann Keltner Jack Patrick Reich
18	SW1/4	Bertha, Faith & Faye LLC Bertha, Faith & Faye LLC	Bertha Orth
18	SE1/4	Jerome & Jane Boeshans	Esther Koehler, E. Wayne Boland, Delvin Reich, Joseph Edward Reich, Stephanie Ann Keltner, Jack Patrick Reich
19	NE1/4	William & Miles Heth State of North Dakota	William & Miles Heth
19	SE1/4	William & Miles Heth	William & Miles Heth
19	W1/2	Darell Herman	Karen A. Heth Marleen T. Schnaidt USA
20	NW1/4, SW1/4NE1/4	William & Miles Heth	

AFFIDAVIT OF PUBLICATION

STATE OF NORTH DAKOTA)
)
)
COUNTY OF Oliver)

I SHELLEY CHASE, being first duly sworn, on my own oath, say, that I am the bookkeeper of the Center Republican, a weekly newspaper of general circulation, published in the city of Center, that the advertisement headed:

DAKOTA WESTMORELAND COAL COMPANY CR-REVISION NO 30 RENEWAL NO 5 KRSB-8802/LEGAL

a printed copy of which is here annexed, was published in the regular and entire issue of said newspaper during the period and time of publication, and that the notice was published in the newspaper proper, and not in a supplement,

for 4 consecutive week 08/13/2015 to wit:

Column Inches 56.25	\$6.38	\$358.88	07/23/2015
Column Inches 56.25	\$6.38	\$358.88	07/30/2015
Column Inches 56.25	\$6.38	\$358.88	08/06/2015
Column Inches 56.25	\$6.38	\$358.88	08/13/2015

Notary Fee \$1.00 Total Cost of Legal \$1,436.52

Shelley Chase

Subscribed and sworn to before me this 13th day of August A.D. 2015

(Seal) *Darla J. Mautz*

Notary Public, State of North Dakota

My Commission Expires

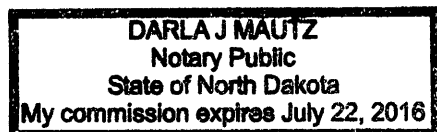

**NOTICE OF APPLICATION
FOR REVISION AND RENEWAL TO A SURFACE MINE PERMIT**

Please take notice that Dakota Westmoreland Corporation, PO Box 39, Beulah, North Dakota 58523, has made application to the North Dakota Public Service Commission for Revision No. 30 and Renewal No. 5 for permit KRSB-8802 at its Beulah Mine.

KRSB-8802 is located in Sections 10, 11, 12, 13, 14, 15 and 24, T.143N., R.88W., Mercer County, ND and Sections 7, 8, 17, 18, 19 and 20, T.143N., R.87W., Oliver County, ND. The precise location and boundary of the land included is depicted on the accompanying map.

Permit KRSB-8802 encompasses 4,905.9 acres for coal excavation, mining and associated disturbance activities in support thereof. Coal removal has been completed from this permit area but final reclamation of portions of the permit area remains to be completed. A number of facilities (shop/office, coal dump, haulroads, etc) are also being used to support mining in another permit area. Revision No. 30 updates the current permit to reflect changes necessary for the next permit term including updates to the legal and financial sections, general operations and reclamation plans. Renewal No. 5 will allow mining and reclamation activities to continue during the next five-year permit term ending October 23, 2020.

Dakota Westmoreland Corporation's application is on file in the Office of the Director, Reclamation Division, Public Service Commission, State Capitol, Bismarck, North Dakota, and in the Office of the County Auditor, Mercer County, Stanton, and Oliver County, Center, North Dakota. This application is available for public inspection therein during normal business hours.

Any persons with an interest which is or may be adversely affected may file written comments, objections, or request an informal conference on the revision and renewal applications with the North Dakota Public Service Commission, 600 East Boulevard, Dept. 408, Bismarck ND 58505-0480, within 30 days of the last publication of this notice. Any request for an informal conference must include the reasons for the request.

The legal description and names of the apparent surface and subsurface mineral owners of land included within the area applied for are as follows:

Mercer County, T.143N., R.88W.

<u>SECTION</u>	<u>LOCATION</u>	<u>SURFACE OWNER(S)</u>	<u>COAL OWNER(S)</u>
10	E1/2E1/2	Otter Tail Power Co. Northern Municipal Power Agcy. Montana-Dakota Utilities Co. Northwestern Energy Dakota Westmoreland Corp.	State of North Dakota and the USA
11	W1/2	Otter Tail Power Co. Northern Municipal Power Agcy. Montana-Dakota Utilities Co. Northwestern Energy Dakota Westmoreland Corp.	Glenn & Beatrice Murray Gary Murray Phyllis O'Neil Armon & Peggy Jo Wolff Family Mineral Trust
11	NE1/4	Otter Tail Power Co. Northern Municipal Power Agcy. Montana-Dakota Utilities Co. Northwestern Energy	Glenn & Beatrice Murray Gary Murray Phyllis O'Neil Armon & Peggy Jo Wolff Family Mineral Trust
11	SE1/4	Dakota Westmoreland Corp. Otter Tail Power Co. Northern Municipal Power Agcy. Montana-Dakota Utilities Co. Northwestern Energy	Henry G. Grishkowsky Delmar N. Grishkowsky Eldon Grishkowsky
12	NW1/4	Allegra & Leroy Boeckel	Allegra Boeckel, George J. Jr. and Margaret Permann
12	SE1/4	Abbey Family Partnership	Abbey Family Partnership State of North Dakota
12	SW1/4	Otter Tail Power Co. Northern Municipal Power Agcy. Montana-Dakota Utilities Co. Northwestern Energy Dakota Westmoreland Corp.	Abbey Family Partnership State of North Dakota
13	NW1/4	Darell Herman	Abbey Family Partnership
13	NE1/4	Darell Herman	Bertha, Faith & Faye LLC
13	N1/2SE1/4	Darell Herman	Bertha, Faith & Faye LLC
13	SW1/4,	Darell Herman	Darell Herman, Karen Heth
13	S1/2SE1/4	Darell Herman	Mary Margaret Wolf

Public Notice

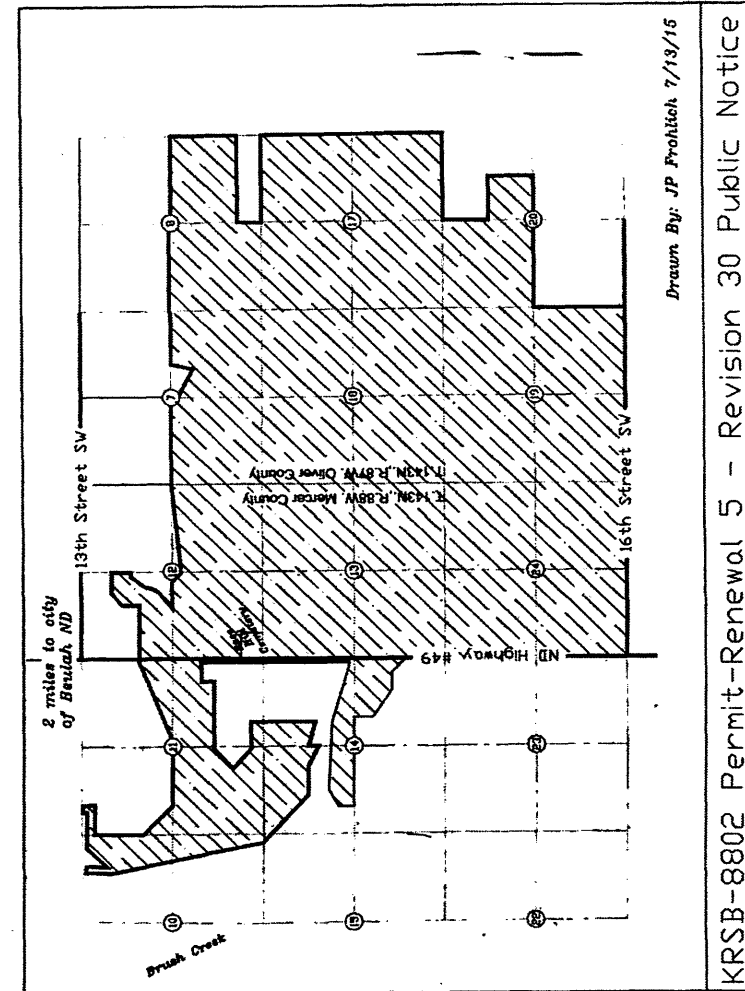

(7-23-15) (7-30-15) (8-6-15) (8-13-15)

KRSB-8802 Permit-Renewal 5 - Revision 30 Public Notice

		Montana-Dakota Utilities Co. Northwestern Energy Dakota Westmoreland Corp.	
14	SE1/4	Jonathan W.A. Liebelt Estate	Jonathan W.A. Liebelt Estate
15	NE1/4	Otter Tail Power Co. Northern Municipal Power Agcy. Montana-Dakota Utilities Co. Northwestern Energy Dakota Westmoreland Corp.	Robert A. Keogh Priscilla A. Keogh Faye L. Keogh Claire C. Schwalbe
24	NE1/4	Bertha, Faith & Faye LLC	Bertha Orth Bertha, Faith & Faye LLC
24	NW1/4	Jonathan W.A. Liebelt Estate	USA
24	S1/2	Bertha, Faith & Faye LLC	USA

Oliver County, T.143N., R.87W.

<u>SECTION</u>	<u>LOCATION</u>	<u>SURFACE OWNER(S)</u>	<u>COAL OWNER(S)</u>
7	S1/2	Dennis Neuberger	Alice Neuberger, Dennis Neuberger, Dale Neuberger, Audrey Cody, Marvell McMains Marion McKinney Baird USA
8	SW1/4	Ken Neuberger	William & Miles Heth
8	SE1/4	Elmer N. Neuberger	William & Miles Heth
17	SW1/4	William & Miles Heth	Daryl E. Zimmerman, Kristjan Melsted, Margery Trenbeath, Laura Bailey Waldemar Melsted, Alfred Kristjanson, Esther Syrup, Margaret Blumhardt, Emily Gundmundson, Ed L. Hurley George Kristjanson, Evelyn Hjalmarson, Joyce Perla, Joe A. Kristjanson, Rosalyn Bruhschwein, Marcella Erickson, Melvin Kristjanson Ruth Melstad, Marino S. Melstad, Elin Mathewson
17	SE1/4	William & Miles Heth	Leland Erickson
17	N1/2	Dakota Westmoreland Corp.	Michael C. Bergquist Gerald Bergquist
18	NW1/4	Leland Erickson, Michael C. Bergquist Gerald Bergquist	E. Wayne Boland, Delvin Reich, Joseph Edward Reich Stephanie Ann Keltner Jack Patrick Reich
18	NE1/4	E. Wayne Boland, Delvin Reich, Joseph Edward Reich Stephanie Ann Keltner Jack Patrick Reich	Bertha Orth
18	SW1/4	Bertha, Faith & Faye LLC Bertha, Faith & Faye LLC	Esther Koehler, E. Wayne Boland, Delvin Reich, Joseph Edward Reich, Stephanie Ann Keltner, Jack Patrick Reich
18	SE1/4	Jerome & Jane Boeshans	William & Miles Heth
19	NE1/4	William & Miles Heth State of North Dakota	William & Miles Heth Karen A. Heth Marleen T. Schnaidt USA
19	SE1/4	William & Miles Heth	
19	W1/2	Darell Herman	
20	NW1/4, SW1/4NE1/4	William & Miles Heth	