



**TEMPORARY AUTHORITY PERMIT**  
 NORTH DAKOTA PUBLIC SERVICE COMMISSION  
 PUBLIC UTILITIES  
 SFN 50560 (6-96)

Date 11/05/2015	Time 12:00	<input type="checkbox"/> a.m. <input checked="" type="checkbox"/> p.m.	Name of Utility Montana Dakota Utilities Co.	Telephone Number 701-224-5837
Name of Person Calling Doug Wiseman			Name of Coop Serving Mor-Gran-Sou	
Name of Customer BNSF Railway		Location Sec 23 Twp 139N R 86W		
Address East off of 50th Ave, North of Almont, ND			County Morton	
City Almont		State ND	Zip Code 58520	
Name of Nearest City New Salem			Distance to the City 3.5 miles	
When will service be extended? Fall 2015		Type of Service <input type="checkbox"/> Residence <input type="checkbox"/> Storage <input type="checkbox"/> Grain Bin <input checked="" type="checkbox"/> Other <u>Signal</u>		
Extension Length to Most Economical Point of Service Utility: 4400' Coop: 4700'		Extension <input type="checkbox"/> Overhead <input checked="" type="checkbox"/> Underground		
Has customer signed request for service? <input checked="" type="checkbox"/> Yes <input type="checkbox"/> No		Will cooperative protest application? <input type="checkbox"/> Yes <input checked="" type="checkbox"/> No		
Name of Person Contacted (PSC Use)		Date of Contact (PSC Use)	Time (PSC Use) <input type="checkbox"/> a.m. <input type="checkbox"/> p.m.	
Estimated Cost of Extension \$20,021		Estimated Revenue \$240.00 Annual		
Under what rate filed with the Public Service Commission will customer be served? 20				
Will extension cross over coop lines? <input type="checkbox"/> Yes <input checked="" type="checkbox"/> No		Will extension cross over railroad tracks? <input type="checkbox"/> Yes <input checked="" type="checkbox"/> No		
Temporary Authority Authorized By <input type="checkbox"/> Telephone <input type="checkbox"/> Letter		Date Authorized		
Authorized By (Name of Commissioner)				

Extension must be made from most economical point of service.

**Comments:**

Extend single phase underground primary to feed a BNSF Railway solar signal. MDU will come off the single phase overhead line along CTY RD 86 with single phase underground cable. MDU will be installing 1-25KVA pad-mounted transformer.

Total project to cost approximately \$20,021. MDU will be using a two year revenue of \$480.00 Customer will be providing the trench from the overhead pole to the new transformer and will be responsible for 100% of construction costs minus the \$480.00 in revenue.

Gary Kreidt  
7503

Nearest Mor-Gran-Sou location is approximately 4700' from the signal location

New Salem  
3.5 Miles

39th St

39th St

86

Single Phase Underground 1/0 Primary line extension to feed solar signal. New Line will come off of our Single phase overhead Primary and will be approximately 4400 feet.

Signal Location  
LS39 MP31.83

Almont 8.5  
Miles

New 25KVA  
Transformer

1-2/A/P'69  
1-2/A/N'69  
1-4/A/P'69  
1-4/A/N

50th Ave

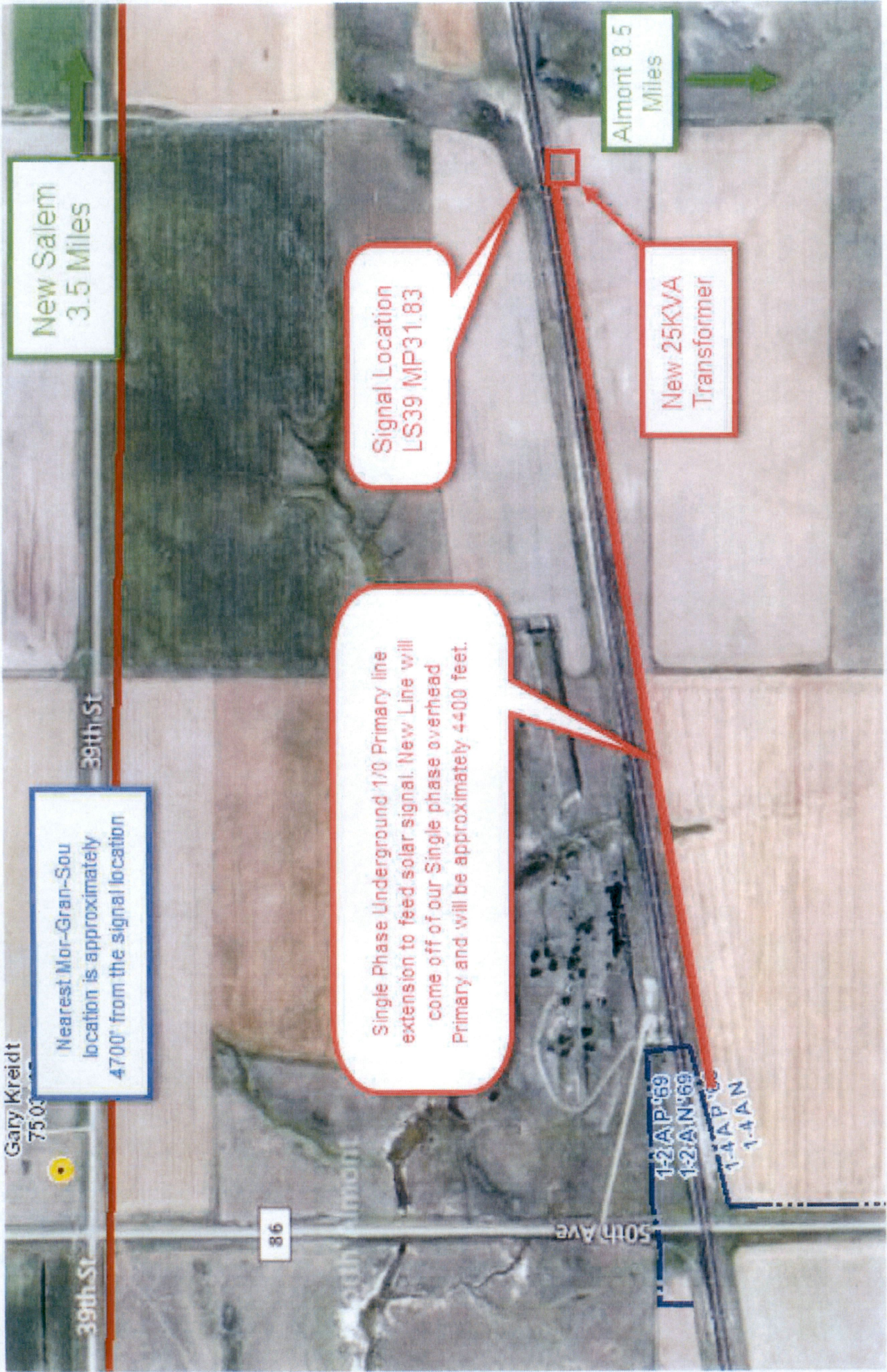

## Wiseman, Doug

---

**From:** Randy Ressler <rressler@morgransou.com>  
**Sent:** Wednesday, November 04, 2015 3:08 PM  
**To:** Wiseman, Doug  
**Subject:** Re: Service to BNSF Hut West of New Salem  
**Attachments:** Picture (Device Independent Bitmap) 1.jpg

\*\*\* This is an EXTERNAL email. Exercise caution. \*\*\*

He is correct Doug. We figured that hut is pretty close to your existing line so go ahead

Sent from Randy's iPhone

On Nov 4, 2015, at 2:36 PM, Wiseman, Doug <[Doug.Wiseman@MDU.com](mailto:Doug.Wiseman@MDU.com)> wrote:

Randy: We got a call from Bill Streibel with BNSF on service to this railroad hut which is now solar powered. He said they talked to you guys and you weren't interested in running service to this load and told them to check with us. Just checking to make sure that is the story before we make an application to PSC. Let me know if you would/will object.

<Picture (Device Independent Bitmap) 1.jpg>

Doug Wiseman  
Region Electric Supt.  
Montana-Dakota Utilities Co.  
(701) 224-5837-Office  
(701) 391-5119-Cell

### Privacy and Confidentiality Notice

The information in this message is intended for the named recipients only. It may contain information that is privileged, confidential or otherwise protected from disclosure. If you are not the intended recipient, you are hereby notified that any disclosure, copying, distribution, or the taking of any action in reliance on the contents of this message is strictly prohibited. If you have received this e-mail in error, do not print it or disseminate it or its contents. In such event, please notify the sender by return e-mail and delete the e-mail file immediately thereafter. Thank you.