

March 4, 2016

Mr. James R. Deutsch  
Reclamation Director  
ND State Public Service Commission  
600 East Boulevard, Dept. 408  
Bismarck, ND 58505

**RE: Affidavit of Publication for Revision 27, Renewal #4 to Permit NAFK-9503**

Dear Mr. Deutsch:

Please find enclosed copies of the Affidavit of Publication for Revision 27, Renewal #4 to Falkirk's Mining Permit NAFK-9503. The publication was published for four consecutive weeks in The McLean County Independent and in The Bismarck Tribune on January 7<sup>th</sup>, 14<sup>th</sup>, 21<sup>st</sup>, and 28<sup>th</sup>, 2016.

If you have any questions or comments, please call 250-2420 or email me at [tara.voigt@nacoal.com](mailto:tara.voigt@nacoal.com).

Sincerely,

**THE FALKIRK MINING COMPANY**

Tara Voigt  
Executive Assistant

TV  
Attachments

- 12 RC-15-756 Filed 03/07/2016 Pages: 43  
Affidavits of newspaper publication filed by the applicant  
Falkirk Mining Company  
Tara Voigt
- 12 RC-15-755 Filed 03/07/2016 Pages: 43  
Affidavits of newspaper publication filed by the applicant



**Classified Advertising Invoice**

**Bismarck Tribune**

PO BOX 4001  
LaCrosse, WI 54602-4001

888-418-6474

FEB - 8 2016

**THE FALKIRK MINING COMPANY**

2801 1ST ST SW  
PO BOX 1087  
UNDERWOOD ND 58576

Customer: 60018525  
Phone: (701) 250-2472  
Date: 01/28/2016

Date	Order #	Type	Order Amt
01/28/16	20826111	INV	20,820.00

Amount Paid: \_\_\_\_\_ CK #: \_\_\_\_\_

**CREDIT CARD PAYMENT (circle one)**



Card #: \_\_\_\_\_  
Exp Date: \_\_\_\_\_  
Signature: \_\_\_\_\_  
Credit card users: Fax to 608-791-8212

CashAmt

PLEASE DETACH AND RETURN TOP PORTION WITH YOUR PAYMENT

Lee Enterprises no longer accepts credit card payments sent via e-mail. Emails containing credit card numbers will be blocked. Please use the coupon above to send a credit card payment to remittance address located in the upper right corner. You may also send the coupon to a secure fax at 608-791-8212.

Date	Date	Times Run	Description	Lines	Class Code	Order Amt	Net Amt Due
01/07/16	01/28/16	4	Bismarck Tribune	200.00	Legals	20,820.00	20,820.00
			PO69061 / Permit NAFK-9503				

**Affidavit of Publication**

State of North Dakota ) SS County of Burleigh  
Before me, a Notary Public for the State of North Dakota personally appeared ck who being duly sworn, deposes and says that he (she) is the Clerk of Bismarck Tribune Co., and that the publication(s) were made through the Bismarck Tribune on the following dates: 1/7, 14, 21, 28 Signed Calina Kuntz sworn and subscribed to before me this 5th day of February 2016  
Morgan Doll  
Notary Public in and for the State of North Dakota

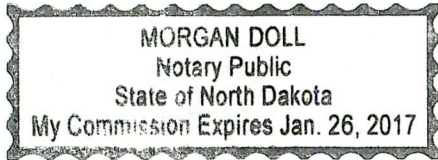

Please return invoice or put order number on check. Thank You.

Remarks	Total Due: 20,820.00
---------	----------------------

**Bismarck Tribune**  
www.bismarcktribune.com  
PO BOX 4001  
LaCrosse, WI 54602-4001

Terms: PAYMENT IS DUE UPON RECEIPT OF INVOICE

**NOTICE OF FILING OF AN APPLICATION FOR  
RENEWAL OF PERMIT TO CONDUCT  
SURFACE COAL MINING AND RECLAMATION OPERATIONS,  
AND A REVISION TO UPDATE PERMIT INFORMATION**

The Falkirk Mining Company, P.O. Box No. 1087, Underwood, North Dakota 58576-1087, as applicant, has filed renewal and revision applications for Surface Coal Mining Permit NAFK-9503, covering portions of Sections 29, 30, 31, and 32, T146N, R83W and Section 36, T146N, R84W and Sections 7, 18, 19, and 30, T145N, R82W and Sections 4, 5, 6, 7, 8, 9, 10, 11, 12, 13, 14, 15, 16, 17, 18, 19, 20, 21, 22, 23, 24, 25, 26, 27, 28, 29, 32, 33, 34, 35, and 36, T145N, R83W and Sections 1, 2, 12, and 13, T145N, R84W and Sections 4, 5, 6, 7, and 9, T144N, R83W and Sections 1, 2, 3, 10, 11, and 12, T144N, R84W in McLean County, North Dakota, which contains 29,310.4 acres.

This revision updates pertinent permit-related information resulting from the Commission's pre-renewal review of the NAFK-9503 mining permit. Information being updated includes surface and coal interest and ownership, description of ground water hydrology, wildlife monitoring and management plan, operation and reclamation plans, post-mining land use and revegetation and surface water information. Renewal No. 4 to Permit NAFK-9503 will extend the permit term another five years until April 17, 2021 and the Revision identifies the coal removal subarea that will be mined during the next 5-year Permit term.

The permit area is located southwest of Underwood, North Dakota. The map shows the location of the City of Underwood, North Dakota, and the boundaries of the permit area. The owners of the surface and coal in the permit area are as follows:

**TRACT 1**

**Township 145 North, Range 82 West**

**Section 7: NE $\frac{1}{4}$ , E $\frac{1}{2}$ NW $\frac{1}{4}$**

Surface Ownership: The Falkirk Mining Company  
Laverna Scheid  
The Nokota Company  
Linda Louise Schmidt, Trustee of the  
Linda L. Schmidt 2007 Revocable Trust  
Coal Ownership: Arthur V. Seay, III  
Sidney Ray Lawler

**TRACT 2**

**Township 145 North, Range 82 West**

**Section 7: E $\frac{1}{2}$ SW $\frac{1}{4}$ , SE $\frac{1}{4}$**

Surface Ownership: The Falkirk Mining Company  
LeRoy D. Traxel and Norma Traxel  
The Nokota Company  
Linda Louise Schmidt, Trustee of the  
Linda L. Schmidt 2007 Revocable Trust  
Coal Ownership: Arthur V. Seay, III  
Sidney Ray Lawler

**TRACT 3**

**Township 145 North, Range 82 West**

**Section 8: A triangular tract lying within the NW $\frac{1}{4}$ NW $\frac{1}{4}$ , containing .4 acres, more or less**

Surface Ownership: Great River Energy  
Coal Ownership: Great River Energy

**TRACT 4**

**Township 145 North, Range 82 West**

**Section 18: NE $\frac{1}{4}$**

Surface Ownership: The Falkirk Mining Company  
Laurance L. Heger and Nancy L. Heger  
Red Crown Royalties, LLC  
Coal Ownership: Three Forks Oil Corporation  
The Nokota Company

**TRACT 5**

**Township 145 North, Range 82 West**

**Section 18: E $\frac{1}{2}$  of Lot 1, Lot 2, E $\frac{1}{2}$ NW $\frac{1}{4}$**

Surface Ownership: The Falkirk Mining Company  
Laurance L. Heger and Nancy L. Heger  
Red Crown Royalties, LLC  
Coal Ownership: Three Forks Oil Corporation  
The Nokota Company

**TRACT 6**

**Township 145 North, Range 82 West**

**Section 18: The W $\frac{1}{2}$  of Lot 1**

Surface Ownership: The Falkirk Mining Company  
Laurance L. Heger and Nancy L. Heger  
Red Crown Royalties, LLC  
Coal Ownership: Three Forks Oil Corporation  
The Nokota Company

**TRACT 7**

**Township 145 North, Range 82 West**

**Section 18: Lots 3, 4, E $\frac{1}{2}$ SW $\frac{1}{4}$**

Surface Ownership: The Falkirk Mining Company  
Coal Ownership: United States of America - Bureau of Land Management

**TRACT 8**

**Township 145 North, Range 82 West**

**Section 19: Lots 1, 2, E $\frac{1}{2}$ NW $\frac{1}{4}$**

Surface Ownership: The Falkirk Mining Company  
John C. Samuelson  
Barbara Lee Jones  
Coal Ownership: Bruce Allen Gradin  
Loren F. Gradin

**TRACT 9**

**Township 145 North, Range 82 West**

**Section 19: Lots 3, 4, E $\frac{1}{2}$ SW $\frac{1}{4}$**

Surface Ownership: The Falkirk Mining Company  
Janet Steckler  
Coal Ownership: Lucille Gardella  
Maurice Heger and Ione Heger  
Loren F. Gradin

**TRACT 10**

**Township 145 North, Range 82 West**

**Section 30: Lots 1, 2, E $\frac{1}{2}$ NW $\frac{1}{4}$**

Surface Ownership: The Falkirk Mining Company  
Coal Ownership: Marian Reinhardt  
North Dakota Department of Trust Lands

**TRACT 11**

**Township 145 North, Range 82 West**

**Section 30: Lots 3, 4, E $\frac{1}{2}$ SW $\frac{1}{4}$**

Surface Ownership: Roger O. Peterson, Life Estate  
Remaindermen:  
Neal Peterson  
Cheryl Gillespie  
Coal Ownership: Roger O. Peterson, Life Estate  
Remaindermen:  
Neal Peterson  
Cheryl Gillespie

**TRACT 12**

**Township 145 North, Range 83 West**

**Section 13: SE $\frac{1}{4}$**

Surface Ownership: The Falkirk Mining Company  
Coal Ownership: Heger Land Trust Dated 4-30-08, Deborah Siem,  
Laurance Heger, and Carl Heger, Trustees  
Richard Ernsdorf  
August R. Johnson  
Jean Neville, Life Estate  
Remaindermen:  
Laurel A. Ross  
Linda J. Dillon  
Robert L. Neville

**TRACT 13**

**Township 145 North, Range 83 West**

**Section 24: NE $\frac{1}{4}$ , less Outlot A**

Surface Ownership: The Falkirk Mining Company  
Coal Ownership: Barbara Lee Jones, Life Estate  
Remaindermen:  
Bruce Allen Gradin

**TRACT 14**

**Township 145 North, Range 83 West**

**Section 24: Outlot A of the NE $\frac{1}{4}$  described as follows:**  
Beginning at a point that is located 1484.0 feet South of the northeast corner of Section 24, thence West and parallel with the North section line a distance of 1972.0 feet to a point, thence North and parallel with the East section line a distance of 492.0 feet, thence West and parallel with the North section line a distance of 668.0 feet to the quarter section line, thence South along the quarter section line a distance of 918.0 feet, thence East and parallel with the North section line a distance of 668.0 feet, thence North and parallel with the East section line a distance of 226.0 feet, thence East and parallel with the North section line a distance of 1972.0 feet to the East section line of Section 24, thence North along the East section line a distance of 200 feet to the point of beginning. Containing 23.14 acres, more or less.

Surface Ownership: The Falkirk Mining Company  
Coal Ownership: Randy Van Asperen  
Barbara Lee Jones  
Bruce Allen Gradin

**TRACT 15**

**Township 145 North, Range 83 West**

**Section 24: NW $\frac{1}{4}$**

Surface Ownership: The Falkirk Mining Company  
Coal Ownership: Michael Berg  
Barbara Lee Jones  
Bruce Allen Gradin

**TRACT 16**

**Township 145 North, Range 83 West**

**Section 24: SW $\frac{1}{4}$**

Surface Ownership: The Falkirk Mining Company  
Coal Ownership: Barbara Lee Jones  
Bruce Allen Gradin

**TRACT 17**

**Township 145 North, Range 83 West**

**Section 24: SE $\frac{1}{4}$**

Surface Ownership: The Falkirk Mining Company  
Coal Ownership: Carol J. Reinhiller and Thomas R. Reinhiller  
Joy M. Ochsner and Gary L. Ochsner  
Judith K. Simpenderfer and Jerome D. Simpenderfer  
Sylvia Thompson

**TRACT 18**

**Township 145 North, Range 83 West**

**Section 25: NE $\frac{1}{4}$**

Surface Ownership: The Falkirk Mining Company  
Coal Ownership: John C. Samuelson and Helen K. Samuelson  
Shaun Stewart  
Erica LeFevers  
Chris Stewart  
Brett Stewart  
Sarah LeFevers

**TRACT 19**

**Township 145 North, Range 83 West**

**Section 25: NW $\frac{1}{4}$**

Surface Ownership: The Falkirk Mining Company  
Coal Ownership: Rita McCreary and Edward McCreary  
William Frederick Lindell and Patricia Lindell

Continued from Pg. 3C

**TRACT 20**

**Township 145 North, Range 83 West**

**Section 25: SW¼**

Surface Ownership: The Falkirk Mining Company  
Coal Ownership: Jeffrey G. Culver  
Harry W. Samuelson, Jr., as Trustee of the  
Harry W. Samuelson, Jr. Revocable Trust  
Lois Samuelson, as Trustee of the  
Lois Samuelson Revocable Trust

**TRACT 21**

**Township 145 North, Range 83 West**

**Section 25: SE¼**

Surface Ownership: The Falkirk Mining Company  
Coal Ownership: John C. Samuelson and Helen K. Samuelson  
Dorothy E. Samuelson

**TRACT 22**

**Township 145 North, Range 83 West**

**Section 36: NE¼**

Surface Ownership: The Falkirk Mining Company  
Coal Ownership: North Dakota Department of Trust Lands  
Carol Adams  
Sharon Huber  
Donald Bender  
Paul J. Bender  
Brenda Dietrich  
Warren Dietrich  
Marlin Bender  
Merlin Bender  
LeRoy Bender  
The Estate of Elmer Bender  
Dean Bender  
Rayland J. Bender  
Trent Bender  
Nanette Aragon  
Hope Witte

**TRACT 23**

**Township 145 North, Range 83 West**

**Section 36: NW¼**

Surface Ownership: The Falkirk Mining Company  
Coal Ownership: Carol J. Reinhiller and Thomas R. Reinhiller  
Joy M. Ochsner and Gary L. Ochsner  
Judith K. Simpenderfer and Jerome D. Simpenderfer  
Sylvia Thompson  
North Dakota Department of Trust Lands

**TRACT 24**

**Township 145 North, Range 83 West**

**Section 13: SW¼**

Surface Ownership: The Falkirk Mining Company  
Coal Ownership: AgriBank, FCB  
Adele C. Saylor  
Myldred Swanson  
Myrtle Breeding  
Stanley E. Saylor, Sr.  
Norma J. Schacher  
Linda G. Hoerner  
Elizabeth Reiland

**TRACT 25**

**Township 145 North, Range 83 West**

**Section 11: SW¼**

Surface Ownership: The Falkirk Mining Company  
Coal Ownership: Arnold J. Schafer and Gretchen M. Schafer,  
Life Estate  
Remaindermen:  
Mary Schafer Conlon  
Macy J. Schafer  
Marty J. Schafer  
Monty R. Schafer  
AgriBank, FCB

**TRACT 26**

**Township 145 North, Range 83 West**

**Section 11: SE¼**

Surface Ownership: The Falkirk Mining Company  
Coal Ownership: Paul D. Saylor  
John E. Saylor  
Peter Saylor  
Daniel Saylor  
Ruth Reberg  
Matthew Saylor  
Mark Saylor  
Myrtle Breeding  
Gilbert J. Reiland  
Stanley E. Saylor, Sr.  
Lynette J. Jahner  
Pamela L. Tangen  
Michael W. Schacher  
Linda G. Hoerner

**TRACT 27**

**Township 145 North, Range 83 West**

**Section 13: NE¼**

Surface Ownership: The Falkirk Mining Company  
Coal Ownership: Heger Land Trust Dated 4-30-08, Deborah Siem,  
Laurance Heger, and Carl Heger, Trustees  
North Dakota Department of Trust Lands  
The Nokota Company  
Three Forks Oil Corporation  
Red Crown Royalties, LLC

**TRACT 28**

**Township 145 North, Range 83 West**

**Section 13: NW¼**

Surface Ownership: The Falkirk Mining Company  
Coal Ownership: Raymond R. Schafer, Terry B. Schafer, and Wallace L.  
Schafer as Co-Trustees of The Ervin R. Schafer  
Revocable Trust  
W. L. Braun Oil Properties Revocable Trust  
Dated 10-22-98  
Laverna McKelvy  
Gail I. Schafer  
The Falkirk Mining Company

**TRACT 29**

**Township 145 North, Range 83 West**

**Section 14: NE¼**

Surface Ownership: The Falkirk Mining Company  
Coal Ownership: The Ervin R. Schafer Revocable Trust Dated 10-10-89

**TRACT 30**

**Township 145 North, Range 83 West**

**Section 14: NW¼**

Surface Ownership: The Falkirk Mining Company  
Coal Ownership: The Adeline L. Schafer Revocable Trust  
Dated 10-10-89

**TRACT 31**

**Township 145 North, Range 83 West**

**Section 14: SW¼**

Surface Ownership: The Falkirk Mining Company  
Coal Ownership: Richard Ernsdorf  
Three Forks Oil Corporation  
The Nokota Company  
The Falkirk Mining Company

**TRACT 32**

**Township 145 North, Range 83 West**

**Section 14: SE¼**

Surface Ownership: The Falkirk Mining Company  
Coal Ownership: August R. Johnson  
Three Forks Oil Corporation  
The Nokota Company  
The Falkirk Mining Company

**TRACT 33**

**Township 145 North, Range 83 West**

**Section 23: E¼**

Surface Ownership: The Falkirk Mining Company  
Coal Ownership: Rita McCreary and Edward McCreary  
William Frederick Lindell and Patricia Lindell

**TRACT 34**

**Township 145 North, Range 83 West**

**Section 23: NW¼**

Surface Ownership: The Falkirk Mining Company  
Coal Ownership: Terry Ollenburger  
Audrey Schubarth  
Jane Ollenburger  
Monte Ollenburger

**TRACT 35**

**Township 145 North, Range 83 West**

**Section 23: SW¼**

Surface Ownership: The Falkirk Mining Company  
Coal Ownership: Barbara J. Hoffer  
Eileen C. Zander

**TRACT 36**

**Township 145 North, Range 83 West**

**Section 26: NE¼**

Surface Ownership: William Frederick Lindell and Patricia Lindell  
Coal Ownership: William Frederick Lindell and Patricia Lindell  
Rita McCreary and Edward McCreary

**TRACT 37**

**Township 145 North, Range 83 West**

**Section 26: NW¼**

Surface Ownership: The Falkirk Mining Company  
Coal Ownership: William Frederick Lindell and Patricia Lindell  
Rita McCreary and Edward McCreary

**TRACT 38**

**Township 145 North, Range 83 West**

**Section 26: SW¼**

Surface Ownership: The Falkirk Mining Company  
Coal Ownership: Anne Carlsen Center for Children  
Home on the Range  
Dakota Boys Ranch of Minot  
Trinity Lutheran Church Foundation  
Birka Country Church  
First Lutheran Church  
Melvin A. Christenson Revocable Trust  
Darlene Roach

**TRACT 39**

**Township 145 North, Range 83 West**

**Section 26: SE¼**

Surface Ownership: The Falkirk Mining Company  
Coal Ownership: William Frederick Lindell and Patricia Lindell  
Rita McCreary and Edward McCreary

**TRACT 40**

**Township 145 North, Range 83 West**

**Section 35: NE¼**

Surface Ownership: The Falkirk Mining Company  
Coal Ownership: The Falkirk Mining Company

**TRACT 41**  
**Township 145 North, Range 83 West**

**Section 35: W $\frac{1}{2}$ NW $\frac{1}{4}$**   
Surface Ownership: The Falkirk Mining Company  
Coal Ownership: Anne Carlsen Center for Children  
Home on the Range  
Dakota Boys Ranch of Minot  
Trinity Lutheran Church Foundation  
Birka Country Church  
First Lutheran Church  
Melvin A. Christenson Revocable Trust  
Darlene Roach

**TRACT 42**  
**Township 145 North, Range 83 West**

**Section 35: E $\frac{1}{2}$ NW $\frac{1}{4}$**   
Surface Ownership: The Falkirk Mining Company  
Coal Ownership: Dean A. Swanson  
Debra Nelson  
Sandra Strinden  
George Lynn Swanson

**TRACT 43**  
**Township 144 North, Range 83 West**

**Section 4: Lots 1, 2, 3, and 4, less the south 40 rods of Lots 1 and 2**  
Surface Ownership: The Falkirk Mining Company  
Coal Ownership: Ernest E. Slagg, Life Estate  
Remaindermen:  
George L. Swanson and Val Rae Swanson  
Adeline M. Slagg  
Elda Ann Baisch  
Marlys Slagg  
Kevin Slagg  
Wayne Slagg  
Julie Slagg  
Melanie Slagg Irwin  
Donavan Slagg  
Miles J. Slagg  
Marsha F. Slagg  
Carolyne S. Currier  
Jerald Slagg  
Connie Jo Hill  
Val Rae Swanson

**TRACT 44**  
**Township 144 North, Range 83 West**

**Section 4: The south 40 rods of Lots 1 and 2**  
Surface Ownership: The Falkirk Mining Company  
Coal Ownership: North Dakota Department of Trust Lands  
Adeline M. Slagg  
Elda Ann Baisch  
Marlys Slagg  
Kevin Slagg  
Wayne Slagg  
Julie Slagg  
Melanie Slagg Irwin  
Donavan Slagg  
Miles J. Slagg  
Marsha F. Slagg  
Carolyne S. Currier  
Jerald Slagg  
Connie Jo Hill  
Val Rae Swanson

**TRACT 45**  
**Township 144 North, Range 83 West**

**Section 4: SW $\frac{1}{4}$**   
Surface Ownership: The Falkirk Mining Company  
Coal Ownership: Gertrude E. Burck  
Cleo Kersey  
Kitty Tweeten

**TRACT 46**  
**Township 144 North, Range 83 West**

**Section 4: SE $\frac{1}{4}$**   
Surface Ownership: The Falkirk Mining Company  
Coal Ownership: North Dakota Department of Trust Lands  
Elda Ann Baisch  
Carolyne S. Currier  
Melanie Slagg Irwin  
Donavan Slagg  
Miles J. Slagg  
Marsha F. Slagg  
Jerald A. Slagg  
Connie Jo Hill  
Val Rae Swanson  
Adeline M. Slagg  
Marlys Slagg  
Kevin Slagg  
Wayne Slagg  
Julie Slagg

**TRACT 47**  
**Township 144 North, Range 83 West**

**Section 5: Lots 3 and 4**  
Surface Ownership: Milton L. Holznagel Revocable Trust dated 1-9-95  
Coal Ownership: Milton L. Holznagel Revocable Trust dated 1-9-95

**TRACT 48**  
**Township 144 North, Range 83 West**

**Section 5: Lots 1 and 2**  
Surface Ownership: The Falkirk Mining Company  
Coal Ownership: Roger Peterson, Life Estate  
Remaindermen:  
Neal Peterson  
Cheryl Gillespie

**TRACT 49**  
**Township 144 North, Range 83 West**

**Section 5: SW $\frac{1}{4}$ , less an 8 ac. tract in the SE $\frac{1}{4}$ SW $\frac{1}{4}$**   
Surface Ownership: Milton L. Holznagel Revocable Trust Dated 1-9-95  
Coal Ownership: Milton L. Holznagel Revocable Trust Dated 1-9-95

**TRACT 50**  
**Township 144 North, Range 83 West**

**Section 5: An 8 ac. tract in the SE $\frac{1}{4}$ SW $\frac{1}{4}$**   
Surface Ownership: The Falkirk Mining Company  
Coal Ownership: The Falkirk Mining Company

**TRACT 51**  
**Township 144 North, Range 83 West**

**Section 5: SE $\frac{1}{4}$**   
Surface Ownership: The Falkirk Mining Company  
Coal Ownership: Roger Peterson, Life Estate  
Remaindermen:  
Neal Peterson  
Cheryl Gillespie

**TRACT 52**  
**Township 144 North, Range 83 West**

**Section 9: NW $\frac{1}{4}$**   
Surface Ownership: The Falkirk Mining Company  
Coal Ownership: Marlys D. Peterson and Lisa E. Allen  
April Azar  
Jana J. Azar  
WLK North Dakota, LLC  
Fred S. Wright, Jr.  
Nancy Elizabeth Brooks  
Mary Evelyn King  
Dana Denise Wright  
Major David L. Wright  
Thomas Russell Wright, Jr.  
Fred S. Wright, Jr., Trustee of the  
Fred S. Wright, Jr. Trust  
Plains Exploration & Production Company  
Henry Lerman  
Irving Lerner  
Linda Petroleum Co.  
Williston Projects, Inc.  
Cotton 4 Mineral Trust  
Cotton 6 Mineral Trust  
George E. Moss, Jr.  
John K. Moss  
Myra Ellen Moss  
Murex Petroleum Corporation  
Frank Jeppi Bi-Pass Trust  
J & L Hauptman Family Partnership  
Phillip Mandel  
Louis Dorfman  
Cynthia Renee Dorfman  
Shelley Fonda Roberts  
Singer Bros.  
S&P Co., a Louisiana partnership  
Fleischaker Mineral Company, LLC  
Teton Properties, LLC  
S D Resources, Ltd.  
A.G.S. Limited Partnership  
Eculirra Oil & Gas, L.L.C.

**TRACT 53**  
**Township 144 North, Range 83 West**

**Section 9: NE $\frac{1}{4}$**   
Surface Ownership: The Falkirk Mining Company  
Coal Ownership: North Dakota Department of Trust Lands  
April Azar  
Jana J. Azar  
WLK North Dakota, LLC  
Fred S. Wright, Jr.  
Nancy Elizabeth Brooks  
Mary Evelyn King  
Dana Denise Wright  
Major David L. Wright  
Thomas Russell Wright, Jr.  
Fred S. Wright, Jr., Trustee of the  
Fred S. Wright, Jr. Trust  
Plains Exploration & Production Company  
Henry Lerman  
Irving Lerner  
Linda Petroleum Co.  
Williston Projects, Inc.  
Cotton 4 Mineral Trust  
Cotton 6 Mineral Trust  
George E. Moss, Jr.  
John K. Moss  
Myra Ellen Moss  
Murex Petroleum Corporation

Frank Jeppi Bi-Pass Trust  
J & L Hauptman Family Partnership  
Philip Mandel  
Louis Dorfman  
Cynthia Renee Dorfman  
Shelley Fonda Roberts  
Singer Bros.  
S&P Co., a Louisiana partnership  
Fleischaker Mineral Company, LLC  
Teton Properties, LLC  
S D Resources, Ltd.  
A.G.S. Limited Partnership  
Eculirra Oil & Gas, L.L.C.

**TRACT 54**  
**Township 145 North, Range 83 West**

**Section 10: SW $\frac{1}{4}$**   
Surface Ownership: The Falkirk Mining Company  
Coal Ownership: Pennington Living Trust Dated 4-28-99

**TRACT 55**  
**Township 145 North, Range 83 West**

**Section 10: SE $\frac{1}{4}$**   
Surface Ownership: The Falkirk Mining Company  
Coal Ownership: MDR Landenberger Family Trust Dated 10-19-02

**TRACT 56**  
**Township 145 North, Range 83 West**

**Section 15: NW $\frac{1}{4}$**   
Surface Ownership: The Falkirk Mining Company  
Coal Ownership: Barbara J. Hoffer  
Eileen C. Zander  
North Dakota Department of Trust Lands

**TRACT 57**  
**Township 145 North, Range 83 West**

**Section 15: NE $\frac{1}{4}$ , less tracts of 7.21 ac. and 5.75 ac.**  
Surface Ownership: The Falkirk Mining Company  
Coal Ownership: Dean A. Swanson  
Debra Nelson  
Sandra Strinden  
George Lynn Swanson  
North Dakota Department of Trust Lands

**TRACT 58**  
**Township 145 North, Range 83 West**

**Section 15: 5.75 ac. in the NE $\frac{1}{4}$**   
Surface Ownership: The Falkirk Mining Company  
Coal Ownership: The Falkirk Mining Company  
North Dakota Department of Trust Lands

**TRACT 59**  
**Township 145 North, Range 83 West**

**Section 15: 7.21 ac in the NE $\frac{1}{4}$**   
Surface Ownership: The Falkirk Mining Company  
Coal Ownership: George L. Swanson and Val Rae Swanson  
North Dakota Department of Trust Lands

**TRACT 60**  
**Township 145 North, Range 83 West**

**Section 15: SW $\frac{1}{4}$**   
Surface Ownership: The Falkirk Mining Company  
Coal Ownership: MDR Landenberger Family Trust Dated 10-19-02  
The Reserve Petroleum Company

**TRACT 61**  
**Township 145 North, Range 83 West**

**Section 15: SE $\frac{1}{4}$**   
Surface Ownership: The Falkirk Mining Company  
Coal Ownership: The Reserve Petroleum Company  
North Dakota Department of Trust Lands

**TRACT 62**  
**Township 145 North, Range 83 West**

**Section 21: SE $\frac{1}{4}$**   
Surface Ownership: The Falkirk Mining Company  
Coal Ownership: The Falkirk Mining Company

**TRACT 63**  
**Township 145 North, Range 83 West**

**Section 22: NW $\frac{1}{4}$**   
Surface Ownership: The Falkirk Mining Company  
Coal Ownership: Dean A. Swanson  
Debra Nelson  
Sandra Strinden  
George Lynn Swanson  
Estates of Carl H. Reimers and Margaret A. Reimers  
Darlene Ostboe  
Michael Ranum  
Mark Ranum  
Andrew Ranum  
Norm Ostboe and Darlene A. Ostboe  
Brian W. Bloomquist  
Bruce B. Bloomquist  
Estate of Gerald T. Woolworth  
Patricia A. Reimers  
Mary O. Reimers  
Charlotte L. Potter  
Gary B. Reimers  
Arlyce J. Stroh  
Karen Louise Sorensen

**TRACT 64**  
**Township 145 North, Range 83 West**

**Section 22: NE $\frac{1}{4}$**   
Surface Ownership: The Falkirk Mining Company  
Coal Ownership: Milton Saylor and Kathy Saylor  
Marcia Walker, Life Estate  
Remaindermen:  
John B. Walker  
Samuel C. Walker

**TRACT 65**  
**Township 145 North, Range 83 West**

**Section 22: SW $\frac{1}{4}$ , less 5 ac. in the SW corner and less the SE $\frac{1}{4}$ SE $\frac{1}{4}$ SW $\frac{1}{4}$**   
Surface Ownership: The Falkirk Mining Company  
Coal Ownership: Erma Carlson  
Marva Deane Finck  
Karen Carlson

**TRACT 66**  
**Township 145 North, Range 83 West**

**Section 22: SE $\frac{1}{4}$ SE $\frac{1}{4}$ SW $\frac{1}{4}$ , less 3.75 ac.**  
Surface Ownership: The Falkirk Mining Company  
Coal Ownership: Erma Carlson  
Marva Deane Finck  
Karen Carlson

**TRACT 66A**  
**Township 145 North, Range 83 West**

**Section 22: 3.75 ac. in the SE $\frac{1}{4}$ SE $\frac{1}{4}$ SW $\frac{1}{4}$**   
Surface Ownership: The Falkirk Mining Company  
Coal Ownership: The Falkirk Mining Company

**TRACT 67**  
**Township 145 North, Range 83 West**

**Section 22: SE $\frac{1}{4}$ , less the SW $\frac{1}{4}$ SW $\frac{1}{4}$ SE $\frac{1}{4}$**   
Surface Ownership: The Falkirk Mining Company  
Coal Ownership: Dean A. Swanson  
Debra Nelson  
Sandra Strinden  
George Lynn Swanson

**TRACT 68**  
**Township 145 North, Range 83 West**

**Section 22: SW $\frac{1}{4}$ SW $\frac{1}{4}$ SE $\frac{1}{4}$**   
Surface Ownership: The Falkirk Mining Company  
Coal Ownership: Dean A. Swanson  
Debra Nelson  
Sandra Strinden  
George Lynn Swanson

**TRACT 69**  
**Township 145 North, Range 83 West**

**Section 28: N $\frac{1}{2}$ NW $\frac{1}{4}$ , W $\frac{1}{2}$ NE $\frac{1}{4}$**   
Surface Ownership: The Falkirk Mining Company  
Coal Ownership: Erma Carlson  
Marva D. Finck  
Karen J. Carlson

**TRACT 70**  
**Township 145 North, Range 83 West**

**Section 28: E $\frac{1}{2}$ NE $\frac{1}{4}$**   
Surface Ownership: The Falkirk Mining Company  
Coal Ownership: Marva Deane Finck

**TRACT 71**  
**Township 145 North, Range 83 West**

**Section 28: SW $\frac{1}{4}$ , S $\frac{1}{2}$ NW $\frac{1}{4}$**   
Surface Ownership: The Falkirk Mining Company  
Coal Ownership: Eileen C. Zander and Merle Zander  
Barbara J. Hoffer

**TRACT 72**  
**Township 145 North, Range 83 West**

**Section 28: SE $\frac{1}{4}$**   
Surface Ownership: Dwight D. Gradin and Denise Gradin  
Coal Ownership: Dwight D. Gradin and Denise Gradin  
Linda Gradin  
Wallyn K. Lee  
Mark E. Gradin, as Trustee of the  
Mark E. Gradin Revocable Trust  
Kyle E. Gradin  
Timothy L. Johannes and Tammy S. Johannes  
Tanya I. Johannes and Steven E. Miller

**TRACT 73**  
**Township 145 North, Range 83 West**

**Section 27: NW $\frac{1}{4}$**   
Surface Ownership: The Falkirk Mining Company  
Coal Ownership: Erma Carlson  
Estates of Carl H. Reimers and Margaret A. Reimers  
Darlene Ostboe  
Michael Ranum  
Mark Ranum  
Andrew Ranum  
Norm Ostboe and Darlene A. Ostboe  
Brian W. Bloomquist  
Bruce B. Bloomquist  
Estate of Gerald T. Woolworth  
Patricia A. Reimers  
Mary O. Reimers  
Charlotte L. Potter  
Gary B. Reimers

Arlyce J. Stroh  
Karen Louise Sorensen

**TRACT 74****Township 145 North, Range 83 West****Section 27: NE $\frac{1}{4}$** 

Surface Ownership: The Falkirk Mining Company  
Coal Ownership: Erna Carlson

**TRACT 75****Township 145 North, Range 83 West****Section 27: SW $\frac{1}{4}$** 

Surface Ownership: The Falkirk Mining Company  
Coal Ownership: Janice E. Hanson  
Bonnie J. Kuntz

**TRACT 76****Township 145 North, Range 83 West****Section 27: SE $\frac{1}{4}$** 

Surface Ownership: The Falkirk Mining Company  
Coal Ownership: Janice E. Hanson  
Bonnie J. Kuntz

**TRACT 77****Township 145 North, Range 83 West****Section 33: NW $\frac{1}{4}$** 

Surface Ownership: Dwight D. Gradin and Denise Gradin  
Coal Ownership: Dwight D. Gradin and Denise Gradin  
Linda Gradin  
Wallyn K. Lee  
Mark E. Gradin, as Trustee of the  
Mark E. Gradin Revocable Trust  
Kyle E. Gradin  
Timothy L. Johannes and Tammy S. Johannes  
Tanya I. Johannes and Steven E. Miller

**TRACT 78****Township 145 North, Range 83 West****Section 33: NE $\frac{1}{4}$** 

Surface Ownership: Dwight D. Gradin and Denise Gradin  
Coal Ownership: Dwight D. Gradin and Denise Gradin  
Linda Gradin  
Wallyn K. Lee  
Mark E. Gradin, as Trustee of the  
Mark E. Gradin Revocable Trust  
Kyle E. Gradin  
Timothy L. Johannes and Tammy S. Johannes  
Tanya I. Johannes and Steven E. Miller

**TRACT 79****Township 145 North, Range 83 West****Section 34: NW $\frac{1}{4}$** 

Surface Ownership: The Falkirk Mining Company  
Coal Ownership: Sharyn M. Calton and Scott Calton

**TRACT 80****Township 145 North, Range 83 West****Section 34: North 100 ac. of the NE $\frac{1}{4}$** 

Surface Ownership: The Falkirk Mining Company  
Coal Ownership: Anne Carlsen Center for Children  
Home on the Range  
Dakota Boys Ranch of Minot  
Trinity Lutheran Church Foundation  
Birka Country Church  
First Lutheran Church  
Melvin A. Christenson Revocable Trust  
Darlene Roach

**TRACT 81****Township 145 North, Range 83 West****Section 34: South 60 ac. of the NE $\frac{1}{4}$** 

Surface Ownership: The Falkirk Mining Company  
Coal Ownership: Anne Carlsen Center for Children  
Home on the Range  
Dakota Boys Ranch of Minot  
Trinity Lutheran Church Foundation  
Birka Country Church  
First Lutheran Church  
Melvin A. Christenson Revocable Trust  
Darlene Roach

**TRACT 82****Township 145 North, Range 83 West****Section 34: SW $\frac{1}{4}$** 

Surface Ownership: The Falkirk Mining Company  
Coal Ownership: Mildred Jahner and Valentine Jahner, Life Estate  
Remaindermen:  
Curtis Jahner  
Brent Jahner  
Mildred Leidholm, as Trustee of the Lloyd Leidholm  
Testamentary Trust  
Eva Leidholm, Life Estate  
Remaindermen:  
Brian Leidholm  
Cordell Leidholm  
Glynda Janz  
Karen Perkerewicz  
Dean Leidholm  
Tammy Novak  
Sharon Rivers  
Dwayne Leidholm  
Mildred Jahner and Valentine Jahner, Life Estate  
Remaindermen:  
Curtis Jahner  
Brent Jahner

**TRACT 83****Township 145 North, Range 83 West****Section 34: SE $\frac{1}{4}$** 

Surface Ownership: The Falkirk Mining Company  
Coal Ownership: James Peterson  
Dennis L. Peterson  
Duaine J. Peterson  
Jane Schulz  
Susan Krebsbach  
North Dakota Department of Trust Lands

**TRACT 84****Township 145 North, Range 83 West****Section 35: SW $\frac{1}{4}$** 

Surface Ownership: The Falkirk Mining Company  
Coal Ownership: William F. Lindell and Patricia Lindell  
Robert L. Erickson and Susan F. Lawrence

**TRACT 85****Township 145 North, Range 83 West****Section 35: SE $\frac{1}{4}$** 

Surface Ownership: The Falkirk Mining Company  
Coal Ownership: Barbara J. Hoffer  
Eileen C. Zander  
Alma Nelson  
Arvin Swanson  
Marcia Steinwand  
Rodney Swanson  
Sheryl Willits

**TRACT 86****Township 145 North, Range 83 West****Section 36: SW $\frac{1}{4}$** 

Surface Ownership: The Falkirk Mining Company  
Coal Ownership: James Peterson  
Dennis L. Peterson  
Duaine J. Peterson  
Jane Schulz  
Susan Krebsbach  
North Dakota Department of Trust Lands

**TRACT 87****Township 145 North, Range 83 West****Section 36: SE $\frac{1}{4}$** 

Surface Ownership: Dean A. Swanson and Sandra Lynn Swanson  
Coal Ownership: North Dakota Department of Trust Lands  
Duaine J. Peterson and Deana R. Peterson

**TRACT 88****Township 144 North, Range 83 West****Section 6: Gov't Lots 1, 2, N $\frac{1}{2}$ SE $\frac{1}{4}$** 

Surface Ownership: The Falkirk Mining Company  
Coal Ownership: The Estate of Iona Jean Vujovich

**TRACT 89****Township 144 North, Range 83 West****Section 6: Gov't Lots 3, 4, and 5, NE $\frac{1}{4}$ SW $\frac{1}{4}$** 

Surface Ownership: The Falkirk Mining Company  
Coal Ownership: Mildred Jahner and Valentine Jahner, Life Estate  
Remaindermen:  
Curtis Jahner  
Brent Jahner  
Eva Leidholm, Life Estate  
Remaindermen:  
Brian Leidholm  
Cordell Leidholm  
Glynda Janz  
Karen Perkerewicz  
Dean Leidholm  
Tammy Novak  
Sharon Rivers  
Dwayne Leidholm  
Mildred Jahner and Valentine Jahner, Life Estate  
Remaindermen:  
Curtis Jahner  
Brent Jahner  
Mildred Leidholm, as Trustee of the Lloyd Leidholm  
Testamentary Trust

**TRACT 90****Township 144 North, Range 83 West****Section 6: Gov't Lot 6, SE $\frac{1}{4}$ SW $\frac{1}{4}$ , S $\frac{1}{2}$ SE $\frac{1}{4}$** 

Surface Ownership: Stephen P. Swanson  
Coal Ownership: United States of America - Bureau of Land  
Management

**TRACT 91****Township 144 North, Range 83 West****Section 7: NE $\frac{1}{4}$** 

Surface Ownership: Milton L. Holznagel Revocable Trust Dated 1-9-95  
Coal Ownership: Kammey Mahowald  
Deborah Aasen  
W. L. Braun Oil Properties Revocable Trust  
Dated 10-22-98  
Barbara Lee Jones  
Bruce Allen Gradin

**TRACT 92****Township 144 North, Range 83 West**

**Section 7: Gov't Lot 1, E½NW¼**

Surface Ownership: Glenda G. Scholl  
Coal Ownership: Glenda G. Scholl  
Jenene M. Kittleson  
Marian Gullickson

**TRACT 93**

**Township 144 North, Range 83 West**

**Section 7: Gov't Lot 2**

Surface Ownership: Glenda G. Scholl  
Coal Ownership: Glenda G. Scholl  
Jenene M. Kittleson and Michael A. Kittleson  
Marian Gullickson and Dwaine Gullickson

**TRACT 94**

**Township 144 North, Range 83 West**

**Section 7: SE¼**

Surface Ownership: Dean A. Swanson and Sandra Lynn Swanson  
Coal Ownership: The Estate of Iona Jean Vujovich

**TRACT 95**

**Township 144 North, Range 83 West**

**Section 7: Gov't Lots 3, 4, E½SW¼**

Surface Ownership: Glenda G. Scholl  
Coal Ownership: Glenda G. Scholl

**TRACT 96**

**Township 144 North, Range 84 West**

**Section 1: Gov't Lots 1, 2, 3, and 4**

Surface Ownership: Michael M. Thyberg  
Coal Ownership: Michael M. Thyberg

**TRACT 97**

**Township 144 North, Range 84 West**

**Section 1: SE¼**

Surface Ownership: Carol Sauer  
Coal Ownership: Carol Sauer  
Richard D. Johnson  
Ronald L. Johnson  
Rhonda M. Johnson  
Rodney Edwin Johnson  
Robyn Smith  
North Dakota Department of Trust Lands

**TRACT 98**

**Township 144 North, Range 84 West**

**Section 1: SW¼**

Surface Ownership: The Falkirk Mining Company  
Coal Ownership: Dean A. Swanson and Sandra L. Swanson  
Stephen P. Swanson

**TRACT 99**

**Township 144 North, Range 84 West**

**Section 2: Gov't Lots 1, 2, less 5.51 acres in Lot 2**

Surface Ownership: Mark Swanson and Pamela L. Hopkins  
Coal Ownership: Stephen P. Swanson  
United States of America – Bureau of Land Management

**TRACT 100**

**Township 144 North, Range 84 West**

**Section 2: 5.51 acres in Gov't Lot 2, described as follows: Beginning at the Northeast corner of said Lot 2, T144N-R84W, thence South 400', thence West 600'; thence North 400'; thence East 600' to the point of beginning.**

Surface Ownership: Stephen P. Swanson  
Coal Ownership: United States of America – Bureau of Land Management

**TRACT 101**

**Township 144 North, Range 84 West**

**Section 2: Gov't Lots 3 and 4**

Surface Ownership: Stephen P. Swanson  
Coal Ownership: United States of America – Bureau of Land Management

**TRACT 102**

**Township 144 North, Range 84 West**

**Section 2: SE¼, SW¼**

Surface Ownership: Forrest W. Ecklund and Alyce F. Ecklund  
Coal Ownership: Forrest W. Ecklund and Alyce F. Ecklund

**TRACT 103**

**Township 144 North, Range 84 West**

**Section 3: Gov't Lots 1, 2, SE¼**

Surface Ownership: Forrest W. Ecklund and Alyce F. Ecklund  
Coal Ownership: Forrest W. Ecklund and Alyce F. Ecklund

**TRACT 104**

**Township 144 North, Range 84 West**

**Section 10: NE¼**

Surface Ownership: Miller Brothers Ranch, L.L.L.P.  
Coal Ownership: Doretta Dene Clark  
Margo Jean Vranna  
Shirley Seher  
Roger Clements Clark  
Velma Cleveland  
Scott Lang and Kay Lang  
Lamoure Besse and Patricia Besse  
Scott Schmidt and Casey Schmidt

**TRACT 105**

**Township 144 North, Range 84 West**

**Section 11: NE¼, SE¼**

Surface Ownership: Miller Brothers Ranch, L.L.L.P.  
Coal Ownership: Doretta Dene Clark  
Margo Jean Vranna  
Shirley Seher  
Roger Clements Clark  
Velma Cleveland  
Scott Lang and Kay Lang  
Lamoure Besse and Patricia Besse  
Scott Schmidt and Casey Schmidt

**TRACT 106**

**Township 144 North, Range 84 West**

**Section 11: NW¼**

Surface Ownership: Miller Brothers Ranch, L.L.L.P.  
Coal Ownership: Doretta Dene Clark  
Margo Jean Vranna  
Shirley Seher  
Roger Clements Clark  
Velma Cleveland  
Scott Lang and Kay Lang  
Lamoure Besse and Patricia Besse  
Scott Schmidt and Casey Schmidt

**TRACT 107**

**Township 144 North, Range 84 West**

**Section 11: SW¼**

Surface Ownership: Miller Brothers Ranch, L.L.L.P.  
Coal Ownership: Doretta Dene Clark  
Margo Jean Vranna  
Shirley Seher  
Roger Clements Clark  
Velma Cleveland  
Scott Lang and Kay Lang  
Lamoure Besse and Patricia Besse  
Scott Schmidt and Casey Schmidt

**TRACT 108**

**Township 144 North, Range 84 West**

**Section 12: N½NE¼**

Surface Ownership: Glenda G. Scholl  
Coal Ownership: Jenene M. Kittleson and Michael A. Kittleson

**TRACT 109**

**Township 144 North, Range 84 West**

**Section 12: S½NE¼**

Surface Ownership: Kay M. Hegvik  
Coal Ownership: Marian Gullickson and Dwaine Gullickson  
George L. Swanson and Val Rae Swanson  
Dean A. Swanson and Sandy L. Swanson

**TRACT 110**

**Township 144 North, Range 84 West**

**Section 12: NW¼**

Surface Ownership: Harley J. Scholl  
Coal Ownership: United States of America – Bureau of Land Management

**TRACT 111**

**Township 144 North, Range 84 West**

**Section 12: SE¼**

Surface Ownership: Glenda G. Scholl  
Coal Ownership: Glenda G. Scholl  
George Scholl  
Marian Gullickson  
Jenene Kittleson

**TRACT 112**

**Township 144 North, Range 84 West**

**Section 12: SW¼**

Surface Ownership: Roger Peterson  
Coal Ownership: Roger Peterson

**TRACT 113**

**Township 145 North, Range 83 West**

**Section 4: Gov't Lots 3, 4, S½NW¼**

Surface Ownership: The Falkirk Mining Company  
Coal Ownership: David J. LeRoy and Dorothy M. LeRoy  
W. L. Braun Oil Properties Revocable Trust  
Laverna McKelvy  
Gail I. Schafer  
AgriBank, FCB  
The Falkirk Mining Company

**TRACT 114**

**Township 145 North, Range 83 West**

**Section 4: SW¼**

Surface Ownership: The Falkirk Mining Company  
Coal Ownership: David J. LeRoy and Dorothy M. LeRoy  
AgriBank, FCB

**TRACT 115**

**Township 145 North, Range 83 West**

**Section 5: Gov't Lot 1, SE¼NE¼**

Surface Ownership: LeRoy's Circle W Inc.  
Coal Ownership: LeRoy's Circle W Inc.

**TRACT 116**

**Township 145 North, Range 83 West**

**Section 5: Gov't Lots 2, 3 and 4, SW¼NE¼, S½NW¼**

Surface Ownership: David J. LeRoy and Dorothy M. LeRoy  
Coal Ownership: David J. LeRoy and Dorothy M. LeRoy

**TRACT 117**

**Township 145 North, Range 83 West**

**Section 5: S $\frac{1}{2}$**

Surface Ownership: The Falkirk Mining Company  
Coal Ownership: David J. LeRoy and Dorothy M. LeRoy

**TRACT 118**

**Township 145 North, Range 83 West**

**Section 6: Gov't Lots 1, 2, S $\frac{1}{2}$ NE $\frac{1}{4}$ , N $\frac{1}{2}$ SE $\frac{1}{4}$**

Surface Ownership: The Falkirk Mining Company  
Coal Ownership: Pennington Living Trust Dated 4-28-99  
AgriBank, FCB

**TRACT 119**

**Township 145 North, Range 83 West**

**Section 6: Gov't Lots 3, 4, 5, 6, SE $\frac{1}{4}$ NW $\frac{1}{4}$ , NE $\frac{1}{4}$ SW $\frac{1}{4}$**

Surface Ownership: Delbert Saylor and Cletus Saylor  
Coal Ownership: Delbert Saylor and Cletus Saylor

**TRACT 120**

**Township 145 North, Range 83 West**

**Section 6: Gov't Lot 7, SE $\frac{1}{4}$ SW $\frac{1}{4}$ , S $\frac{1}{2}$ SE $\frac{1}{4}$**

Surface Ownership: The Falkirk Mining Company  
Coal Ownership: James B. LeRoy and Debra D. LeRoy  
David J. LeRoy and Dorothy M. LeRoy

**TRACT 121**

**Township 145 North, Range 83 West**

**Section 7: E $\frac{1}{2}$**

Surface Ownership: The Falkirk Mining Company  
Coal Ownership: David J. LeRoy and Dorothy M. LeRoy  
Darlys A. Schock  
Kenneth Leidholm

**TRACT 122**

**Township 145 North, Range 83 West**

**Section 7: North 1/3 of Gov't Lots 1, 2, 3, 4, and E $\frac{1}{2}$ W $\frac{1}{2}$**

Surface Ownership: Milton Saylor and Kathy Saylor  
Coal Ownership: Milton Saylor and Kathy Saylor  
The Reserve Petroleum Company

**TRACT 123**

**Township 145 North, Range 83 West**

**Section 7: Middle 1/3 of Gov't Lots 1, 2, 3, 4, and E $\frac{1}{2}$ W $\frac{1}{2}$**

Surface Ownership: The Falkirk Mining Company  
Coal Ownership: Irene K. Grosz  
The Reserve Petroleum Company

**TRACT 124**

**Township 145 North, Range 83 West**

**Section 7: South 1/3 of Gov't Lots 1, 2, 3, 4, and E $\frac{1}{2}$ W $\frac{1}{2}$**

Surface Ownership: The Falkirk Mining Company  
Coal Ownership: Darin Saylor  
Roger Saylor  
The Reserve Petroleum Company

**TRACT 125**

**Township 145 North, Range 83 West**

**Section 8: N $\frac{1}{2}$**

Surface Ownership: Lynn H. Stewart Revocable Trust  
Coal Ownership: Lynn H. Stewart Revocable Trust  
Melanie Casanova  
Camille C. Bonstrom  
Chandler L. Feuk  
Brad Feuk  
Cleome Hennessy, Trustee of the Hennessy Trust  
Dated 3-9-99

**TRACT 126**

**Township 145 North, Range 83 West**

**Section 8: SE $\frac{1}{4}$**

Surface Ownership: The Falkirk Mining Company  
Coal Ownership: Richard E. Ott and Virginia A. Ott

**TRACT 127**

**Township 145 North, Range 83 West**

**Section 8: SW $\frac{1}{4}$**

Surface Ownership: The Falkirk Mining Company  
Coal Ownership: Sylvia Ann Ott

**TRACT 128**

**Township 145 North, Range 83 West**

**Section 9: NE $\frac{1}{4}$  less 1.02 ac. hwy.**

Surface Ownership: The Falkirk Mining Company  
Coal Ownership: Curtis Schafer  
Ardis Sullivan  
Linda Lamb  
Mavis Cummings

**TRACT 129**

**Township 145 North, Range 83 West**

**Section 9: NW $\frac{1}{4}$**

Surface Ownership: John Meyer  
Patricia Syvertsen  
Barbara J. Barnenek  
The Charles A. Jenson and Sharon Kennedy Jenson  
Revocable Living Trust Dated 6-23-06  
J & S J Living Trust Dated 1-22-02  
Ronald H. Johnson  
Salley Sue Meyer  
Terry D. Johnson  
Roxette A. Denne  
John Meyer  
Patricia Syvertsen  
Barbara J. Barnenek  
The Charles A. Jenson and Sharon Kennedy Jenson  
Revocable Living Trust Dated 6-23-06  
J & S J Living Trust Dated 1-22-02  
Ronald H. Johnson  
Salley Sue Meyer  
Terry D. Johnson  
Roxette A. Denne

Coal Ownership:

**TRACT 130**

**Township 145 North, Range 83 West**

**Section 9: SE $\frac{1}{4}$**

Surface Ownership: The Falkirk Mining Company  
Coal Ownership: Lillian L. Saylor  
Steven Saylor  
Bryan Saylor  
Greg Saylor  
The Reserve Petroleum Company  
AgriBank, FCB

**TRACT 131**

**Township 145 North, Range 83 West**

**Section 9: SW $\frac{1}{4}$**

Surface Ownership: The Falkirk Mining Company  
Coal Ownership: David J. LeRoy and Dorothy M. LeRoy

**TRACT 132**

**Township 145 North, Range 83 West**

**Section 16: NE $\frac{1}{4}$**

Surface Ownership: The Falkirk Mining Company  
Coal Ownership: Pauline M. Rosberg  
North Dakota Department of Trust Lands

**TRACT 133**

**Township 145 North, Range 83 West**

**Section 16: NW $\frac{1}{4}$ , SW $\frac{1}{4}$**

Surface Ownership: Pauline M. Rosberg  
Coal Ownership: Pauline M. Rosberg  
Robert C. Mann  
Audrey M. Crum  
Margaret E. Tollerud

**TRACT 134**

**Township 145 North, Range 83 West**

**Section 16: N $\frac{1}{2}$ SE $\frac{1}{4}$**

Surface Ownership: The Falkirk Mining Company  
Coal Ownership: Pennington Living Trust Dated 4-28-99  
North Dakota Department of Trust Lands

**TRACT 135**

**Township 145 North, Range 83 West**

**Section 16: S $\frac{1}{2}$ SE $\frac{1}{4}$**

Surface Ownership: The Falkirk Mining Company  
Coal Ownership: Pauline M. Rosberg  
North Dakota Department of Trust Lands

**TRACT 136**

**Township 145 North, Range 83 West**

**Section 17: N $\frac{1}{2}$ , SE $\frac{1}{4}$ , E $\frac{1}{2}$ SW $\frac{1}{4}$ , W $\frac{1}{2}$ SW $\frac{1}{4}$**

Surface Ownership: Pauline M. Rosberg  
Coal Ownership: Pauline M. Rosberg  
Jessica Potter  
Darralu S. Lindholm  
Martha Specht  
Mary O'Brien Specht  
Estate of Deloris Potter  
Linda Anderson  
Nancy Watkins  
Larry Woodall  
Estate of Phyllis Ann Hermanson

**TRACT 137**

**Township 145 North, Range 83 West**

**Section 18: Gov't Lots 1, 2, 3, 4, E $\frac{1}{2}$ W $\frac{1}{2}$ , NE $\frac{1}{4}$**

Surface Ownership: The Falkirk Mining Company  
Coal Ownership: Andrew W. Jensen and Kimberly A. Jensen

**TRACT 138**

**Township 145 North, Range 83 West**

**Section 18: SE $\frac{1}{4}$**

Surface Ownership: The Falkirk Mining Company  
Coal Ownership: United States of America - Bureau of Land Management

**TRACT 139**

**Township 145 North, Range 83 West**

**Section 19: NE $\frac{1}{4}$**

Surface Ownership: Eileen C. Zander  
Coal Ownership: Eileen C. Zander  
Barbara J. Hoffer

**TRACT 140**

**Township 145 North, Range 83 West**

**Section 19: SE $\frac{1}{4}$**

Surface Ownership: The Falkirk Mining Company  
Coal Ownership: Donna Sandvik  
Dan Swanson  
Randy Swanson  
Laurance L. Heger and Nancy L. Heger

**TRACT 141**

**Township 145 North, Range 83 West**

**Section 20: N $\frac{1}{2}$ , SE $\frac{1}{4}$  less 2 acres in the SW corner of the SE $\frac{1}{4}$**

Surface Ownership: The Falkirk Mining Company

Continued from Pg. 5C

Coal Ownership: Beth Bruestle  
Kent Swanson  
Timothy Bruestle  
Ryan Bruestle  
Erika Bruestle  
Pauline M. Rosberg  
Robert C. Mann  
Audrey M. Crum  
Margaret E. Tollerud  
North Dakota Community Foundation UTETCF  
James and Winnifred Marvin Scholarship Fund  
Leslie Peterson  
Barbara Peterson

**TRACT 142**

**Township 145 North, Range 83 West**

**Section 20: SW $\frac{1}{4}$**

Surface Ownership: Sylvia Thompson  
Carol J. Reinhillier  
Joy M. Ochsner  
Judith K. Simpferderfer  
Coal Ownership: Sylvia Thompson  
Carol J. Reinhillier  
Joy M. Ochsner  
Judith K. Simpferderfer

**TRACT 143**

**Township 145 North, Range 83 West**

**Section 21: N $\frac{1}{2}$ , SW $\frac{1}{4}$ , less 0.49 ac. in the NW $\frac{1}{4}$**

Surface Ownership: The Falkirk Mining Company  
Coal Ownership: Pauline M. Rosberg  
Robert C. Mann  
Audrey M. Crum  
Margaret E. Tollerud

**TRACT 144**

**Township 145 North, Range 83 West**

**Section 21: 0.49 ac. in the NW $\frac{1}{4}$ , beginning at a point on the east line of said NW $\frac{1}{4}$ , Section 21, said point being 33 feet south of the northeast corner thereof; thence south 140 feet; thence west 150 feet; thence north 140 feet; thence east 150 feet to the point of beginning.**

Surface Ownership: The Falkirk Mining Company  
Coal Ownership: Pauline M. Rosberg  
Robert C. Mann  
Audrey M. Crum  
Margaret E. Tollerud

**TRACT 145**

**Township 145 North, Range 83 West**

**Section 29: NE $\frac{1}{4}$**

Surface Ownership: The Falkirk Mining Company  
Coal Ownership: Mary Jane Miller  
Nancy J. Bridges and Jennifer Anne Barber,  
Co-Trustees or the Successor Trustee of The Nancy  
J. Bridges Trust Dated November 15, 2011

**TRACT 146**

**Township 145 North, Range 83 West**

**Section 29: S $\frac{1}{2}$**

Surface Ownership: Robert C. Mann  
Audrey M. Crum  
Margaret E. Tollerud  
Coal Ownership: Robert C. Mann  
Audrey M. Crum  
Margaret E. Tollerud  
Leslie Peterson  
Barbara Peterson

**TRACT 147**

**Township 145 North, Range 83 West**

**Section 32: NE $\frac{1}{4}$**

Surface Ownership: Barbara J. Hoffer  
Coal Ownership: Barbara J. Hoffer  
Eileen C. Zander

**TRACT 148**

**Township 145 North, Range 83 West**

**Section 32: NW $\frac{1}{4}$**

Surface Ownership: Robert C. Mann  
Audrey M. Crum  
Margaret E. Tollerud  
Coal Ownership: The Stewart E. Bowers and Joyce W. Bowers  
1989 Inter Vivos Trust Dated 6-23-89  
Robert C. Mann  
Audrey M. Crum  
Margaret E. Tollerud  
Mueller Industries, Inc.  
Mary C. Henderson

**TRACT 149**

**Township 145 North, Range 83 West**

**Section 32: SE $\frac{1}{4}$**

Surface Ownership: Michael M. Thyberg  
Coal Ownership: Michael M. Thyberg

**TRACT 150**

**Township 145 North, Range 83 West**

**Section 32: SW $\frac{1}{4}$**

Surface Ownership: Michael M. Thyberg  
Coal Ownership: United States of America – Bureau of Land  
Management

**TRACT 151**

**Township 145 North, Range 83 West**

**Section 33: SE $\frac{1}{4}$ , SW $\frac{1}{4}$**

Surface Ownership: Dwight D. Gradin and Denise Gradin  
Coal Ownership: Dwight D. Gradin and Denise Gradin  
Linda Gradin  
Wallyn K. Lee  
Mark E. Gradin, as Trustee of the  
Mark E. Gradin Revocable Trust  
Kyle E. Gradin  
Timothy L. Johannes and Tammy S. Johannes  
Tanya L. Johannes and Steven E. Miller

**TRACT 152**

**Township 145 North, Range 84 West**

**Section 1: Gov't Lots 1, 2, 3, 4, S $\frac{1}{2}$ N $\frac{1}{2}$ , SE $\frac{1}{4}$**

Surface Ownership: The Falkirk Mining Company  
Coal Ownership: William Frederick Lindell and Patricia L. Lindell  
Rita McCreary

**TRACT 153**

**Township 145 North, Range 84 West**

**Section 1: SW $\frac{1}{4}$**

Surface Ownership: The Falkirk Mining Company  
Coal Ownership: Beth Bruestle  
Kent Swanson  
Timothy Bruestle  
Ryan Bruestle  
Erika Bruestle

**TRACT 154**

**Township 145 North, Range 84 West**

**Section 2: Gov't Lots 1, 2, SE $\frac{1}{4}$ NE $\frac{1}{4}$ , SW $\frac{1}{4}$ NE $\frac{1}{4}$**

Surface Ownership: The Falkirk Mining Company  
Coal Ownership: David J. LeRoy and Dorothy M. LeRoy  
North Dakota Department of Trust Lands

**TRACT 155**

**Township 145 North, Range 84 West**

**Section 12: E $\frac{1}{2}$ NE $\frac{1}{4}$ , SW $\frac{1}{4}$ NE $\frac{1}{4}$ , NE $\frac{1}{4}$ SE $\frac{1}{4}$**

Surface Ownership: The Falkirk Mining Company  
Coal Ownership: Beth Bruestle  
Kent Swanson  
Timothy Bruestle  
Ryan Bruestle  
Erika Bruestle  
United States of America – Bureau of Land

Management

**TRACT 156**

**Township 145 North, Range 84 West**

**Section 12: E $\frac{1}{2}$ NW $\frac{1}{4}$ , NE $\frac{1}{4}$ SW $\frac{1}{4}$ , NW $\frac{1}{4}$ NE $\frac{1}{4}$**

Surface Ownership: The Falkirk Mining Company

Coal Ownership: Beth Bruestle  
Kent Swanson  
Timothy Bruestle  
Ryan Bruestle  
Erika Bruestle

**TRACT 157**

**Township 145 North, Range 84 West**

**Section 12: W $\frac{1}{2}$ W $\frac{1}{2}$ , SE $\frac{1}{4}$ SW $\frac{1}{4}$ , S $\frac{1}{2}$ SE $\frac{1}{2}$**

Surface Ownership: The Falkirk Mining Company

Coal Ownership: United States of America – Bureau of Land Management

**TRACT 158**

**Township 145 North, Range 84 West**

**Section 12: NW $\frac{1}{4}$ SE $\frac{1}{4}$**

Surface Ownership: The Falkirk Mining Company

Coal Ownership: United States of America – Bureau of Land Management

**TRACT 159**

**Township 145 North, Range 84 West**

**Section 13: NE $\frac{1}{4}$**

Surface Ownership: The Falkirk Mining Company

Coal Ownership: Douglas Kesselring  
Jerome Vonderheide  
Donald Kesselring  
Judith K. Fiol  
Marjorie K. Williams  
Beverly Singleton

**TRACT 160**

**Township 145 North, Range 84 West**

**Section 13: W $\frac{1}{2}$**

Surface Ownership: The Falkirk Mining Company

Coal Ownership: Douglas Kesselring

**TRACT 161**

**Township 145 North, Range 84 West**

**Section 13: SE $\frac{1}{4}$**

Surface Ownership: The Falkirk Mining Company

Coal Ownership: Beth Bruestle  
Kent Swanson  
Timothy Bruestle  
Ryan Bruestle  
Erika Bruestle

**TRACT 162**

**Township 146 North, Range 83 West**

**Section 29: SW $\frac{1}{4}$**

Surface Ownership: Paul Hardy and Lori Hardy

Coal Ownership: Paul Hardy and Lori Hardy

**TRACT 163**

**Township 146 North, Range 83 West**

**Section 30: SE $\frac{1}{4}$**

Surface Ownership: Ralph E. Saylor Living Trust Dated 11-24-97

Coal Ownership: Jean M. Saylor

**TRACT 164**

**Township 146 North, Range 83 West**

**Section 31: NE $\frac{1}{4}$ , NE $\frac{1}{4}$ SE $\frac{1}{4}$**

Surface Ownership: Esther M. Horst, Life Estate

Remaindermen:  
Cleaton Saylor  
Neoma J. Vogel  
Barton Saylor  
Elton Saylor  
Rodney Kraft, as Trustee of The Lyla Ann Kraft Family Trust

Coal Ownership: Esther M. Horst

**TRACT 165**

**Township 146 North, Range 83 West**

**Section 31: Gov't Lots 1, 2, E $\frac{1}{2}$ NW $\frac{1}{4}$**

Surface Ownership: Timothy D. Saylor

Coal Ownership: Timothy D. Saylor

**TRACT 166**

**Township 146 North, Range 83 West**

**Section 31: NW $\frac{1}{4}$ SE $\frac{1}{4}$**

Surface Ownership: The Falkirk Mining Company

Coal Ownership: David J. LeRoy and Dorothy M. LeRoy

**TRACT 167**

**Township 146 North, Range 83 West**

**Section 31: SE $\frac{1}{4}$ SE $\frac{1}{4}$ , E $\frac{1}{2}$ SW $\frac{1}{4}$ SE $\frac{1}{4}$**

Surface Ownership: Delbert Saylor and Cletus Saylor

Coal Ownership: Delbert Saylor and Cletus Saylor

**TRACT 168**

**Township 146 North, Range 83 West**

**Section 31: Gov't Lots 3, 4, E $\frac{1}{2}$ SW $\frac{1}{4}$ , W $\frac{1}{2}$ SW $\frac{1}{4}$ SE $\frac{1}{4}$**

Surface Ownership: The Falkirk Mining Company

Coal Ownership: Nevin E. Fisher and Lyla R. Fisher  
Harold B. Saylor

**TRACT 169**

**Township 146 North, Range 83 West**

**Section 32: N $\frac{1}{4}$ , NW $\frac{1}{4}$ SW $\frac{1}{4}$**

Surface Ownership: Delbert Saylor and Cletus Saylor

Coal Ownership: Delbert Saylor and Cletus Saylor

**TRACT 170**

**Township 146 North, Range 83 West**

**Section 32: SE $\frac{1}{4}$ , less Outlot A**

Surface Ownership: The Falkirk Mining Company

Coal Ownership: David J. LeRoy and Dorothy M. LeRoy  
W. L. Braun Oil Properties Revocable Trust  
Dated 10-22-98

AgriBank, FCB

Laverna McKelvy

Gail I. Schafer

The Falkirk Mining Company

**TRACT 171**

**Township 146 North, Range 83 West**

**Section 32: S $\frac{1}{2}$ SW $\frac{1}{4}$ , NE $\frac{1}{4}$ SW $\frac{1}{4}$**

Surface Ownership: Delbert Saylor and Cletus Saylor

Coal Ownership: United States of America – Bureau of Land Management

**TRACT 172**

**Township 146 North, Range 84 West**

**Section 36: NE $\frac{1}{4}$**

Surface Ownership: Linda L. Saylor Living Trust Dated 11-24-97

Ralph E. Saylor Living Trust Dated 11-24-97

Linda L. Saylor Living Trust Dated 11-24-97

Ralph E. Saylor Living Trust Dated 11-24-97

Jerome Vonderheide

Donald Kesselring

Judith K. Fiol

Marjorie K. Williams

Beverly Singleton

Douglas Kesselring

North Dakota Department of Trust Lands

**TRACT 173**

**Township 146 North, Range 84 West**

**Section 36: N $\frac{1}{2}$ SE $\frac{1}{4}$**

Surface Ownership: The Falkirk Mining Company

Coal Ownership: Leslie Landenberger and Ruby Landenberger  
North Dakota Department of Trust Lands



AFFIDAVIT OF PUBLICATION

STATE OF NORTH DAKOTA )  
 )  
COUNTY OF McLean )  
 )

I SHELLEY CHASE, being first duly sworn, on my own oath, say, that I am the bookkeeper of the McLean County Independent, a weekly newspaper of general circulation, published in the city of Garrison, that the advertisement headed:

FALKIRK MINING CO GR-PO# <sup>69060</sup> ~~68060~~ RENEWAL PERMIT W/MAP LEGAL

a printed copy of which is here annexed, was published in the regular and entire issue of said newspaper during the period and time of publication, and that the notice was published in the newspaper proper, and not in a supplement,

for 4 consecutive week 01/28/2016 to wit:

Column Inches 603.25	\$6.38	\$3,848.74	01/07/2016
Column Inches 603.25	\$6.38	\$3,848.74	01/14/2016
Column Inches 603.25	\$6.38	\$3,848.74	01/21/2016
Column Inches 603.25	\$6.38	\$3,848.74	01/28/2016

Notary Fee \$1.00 Total Cost of Legal \$15,395.96

*Shelley Chase*

Subscribed and sworn to before me this 28<sup>th</sup> day of January A.D. 2016

(Seal) *Darla J Mautz*

Notary Public, State of North Dakota

My Commission Expires

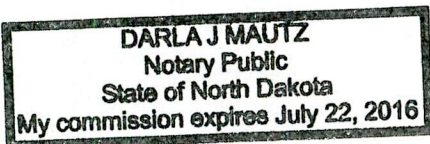

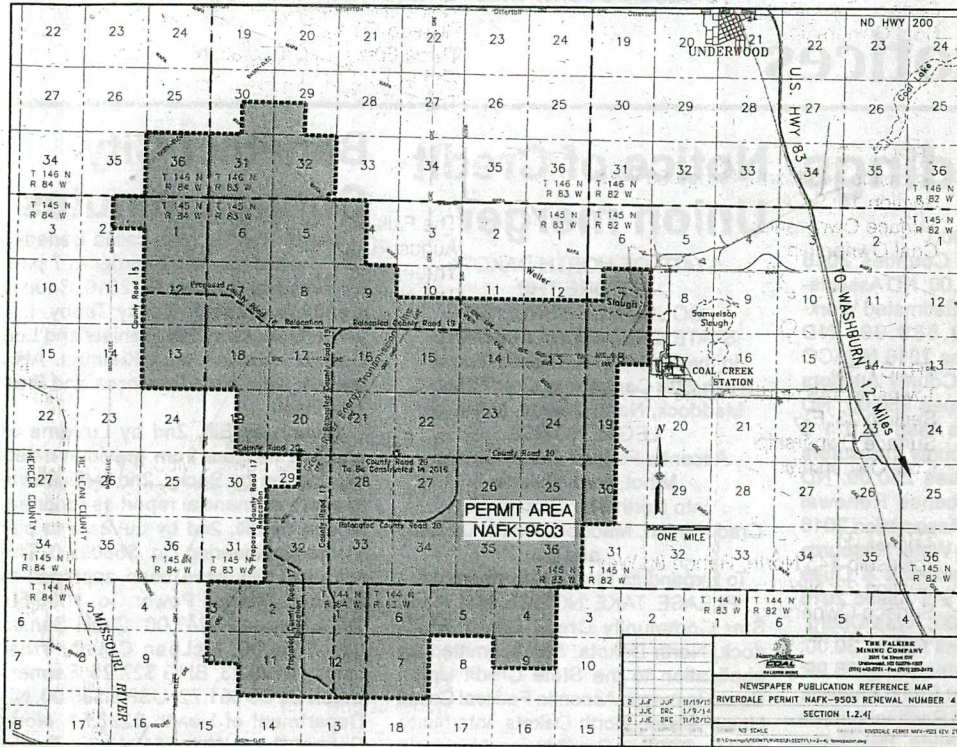

**Notice of filing of an application for renewal of permit to conduct surface coal mining and reclamation operations, and a revision to update permit information**

The Falkirk Mining Company, P.O. Box No. 1087, Underwood, North Dakota 58576-1087, as applicant, has filed renewal and revision applications for Surface Coal Mining Permit NAFK-9503, covering portions of Sections 29, 30, 31, and 32, T146N, R83W and Section 36, T146N, R84W and Sections 7, 18, 19, and 30, T145N, R82W and Sections 4, 5, 6, 7, 8, 9, 10, 11, 12, 13, 14, 15, 16, 17, 18, 19, 20, 21, 22, 23, 24, 25, 26, 27, 28, 29, 32, 33, 34, 35, and 36, T145N, R83W and Sections 1, 2, 12, and 13, T145N, R84W and Sections 4, 5, 6, 7, and 9, T144N, R83W and Sections 1, 2, 3, 10, 11, and 12, T144N, R84W in McLean County, North Dakota, which contains 29,310.4 acres.

This revision updates pertinent permit-related information resulting from the Commission's pre-renewal review of the NAFK-9503 mining permit. Information being updated includes surface and coal interest and ownership, description of ground water hydrology, wildlife monitoring and management plan, operation and reclamation plans, post-mining land use and revegetation and surface water information. Renewal No. 4 to Permit NAFK-9503 will extend the permit term another five years until April 17, 2021 and the Revision identifies the coal removal subarea that will be mined during the next 5-year Permit term.

The permit area is located southwest of Underwood, North Dakota. The map shows the location of the City of Underwood, North Dakota, and the boundaries of the permit area.

The owners of the surface and coal in the permit area are as follows:

TRACT 1  
Township 145 North, Range 82 West  
Section 7: NE¼, E½NW¼  
Surface Ownership:  
Coal Ownership:

The Falkirk Mining Company  
Laverna Scheid  
The Nokota Company  
Linda Louise Schmidt, Trustee of the  
Linda L. Schmidt  
2007 Revocable Trust  
Arthur V. Seay, III  
Sidney Ray Lawler

**TRACT 2**

Township 145 North, Range 82 West

Section 7: E $\frac{1}{2}$ SW $\frac{1}{4}$ , SE $\frac{1}{4}$

Surface Ownership:

Coal Ownership:

The Falkirk Mining Company  
LeRoy D. Traxel and Norma Traxel  
The Nokota Company  
Linda Louise Schmidt, Trustee of the  
Linda L. Schmidt  
2007 Revocable Trust  
Arthur V. Seay, III  
Sidney Ray Lawler

**TRACT 3**

Township 145 North, Range 82 West

Section 8: A triangular tract lying within the NW $\frac{1}{4}$ NW $\frac{1}{4}$ , containing .4 acres, more or less

Surface Ownership:

Coal Ownership:

Great River Energy  
Great River Energy

**TRACT 4**

Township 145 North, Range 82 West

Section 18: NE $\frac{1}{4}$

Surface Ownership:

Coal Ownership:

The Falkirk Mining Company  
Laurance L. Heger and Nancy L. Heger  
Red Crown Royalties, LLC  
Three Forks Oil Corporation  
The Nokota Company

**TRACT 5**

Township 145 North, Range 82 West

Section 18: E $\frac{1}{2}$  of Lot 1, Lot 2, E $\frac{1}{2}$ NW $\frac{1}{4}$

Surface Ownership:

Coal Ownership:

The Falkirk Mining Company  
Laurance L. Heger and Nancy L. Heger  
Red Crown Royalties, LLC  
Three Forks Oil Corporation  
The Nokota Company

**TRACT 6**

Township 145 North, Range 82 West

Section 18: The W $\frac{1}{2}$  of Lot 1

Surface Ownership:

Coal Ownership:

The Falkirk Mining Company  
Laurance L. Heger and Nancy L. Heger  
Red Crown Royalties, LLC  
Three Forks Oil Corporation  
The Nokota Company

**TRACT 7**

Township 145 North, Range 82 West

Section 18: Lots 3, 4, E $\frac{1}{2}$ SW $\frac{1}{4}$

Surface Ownership:

Coal Ownership:

The Falkirk Mining Company  
United States of America –  
Bureau of Land Management

**TRACT 8**

Township 145 North, Range 82 West

Section 19: Lots 1, 2, E $\frac{1}{2}$ NW $\frac{1}{4}$

Surface Ownership:

Coal Ownership:

The Falkirk Mining Company  
John C. Samuelson  
Barbara Lee Jones

Bruce Allen Gradin  
Loren F. Gradin

**TRACT 9**

Township 145 North, Range 82 West

Section 19: Lots 3, 4, E $\frac{1}{2}$ SW $\frac{1}{4}$

Surface Ownership:

Coal Ownership:

The Falkirk Mining Company

Janet Steckler

Lucille Gardella

Maurice Heger and Ione Heger

Loren F. Gradin

**TRACT 10**

Township 145 North, Range 82 West

Section 30: Lots 1, 2, E $\frac{1}{2}$ NW $\frac{1}{4}$

Surface Ownership:

Coal Ownership:

The Falkirk Mining Company

Marian Reinhardt

North Dakota Department of Trust Lands

**TRACT 11**

Township 145 North, Range 82 West

Section 30: Lots 3, 4, E $\frac{1}{2}$ SW $\frac{1}{4}$

Surface Ownership:

Coal Ownership:

Roger O. Peterson, Life Estate

Remaindermen:

Neal Peterson

Cheryl Gillespie

Roger O. Peterson, Life Estate

Remaindermen:

Neal Peterson

Cheryl Gillespie

**TRACT 12**

Township 145 North, Range 83 West

Section 13: SE $\frac{1}{4}$

Surface Ownership:

Coal Ownership:

The Falkirk Mining Company

Heger Land Trust Dated 4-30-08,

Deborah Siem, Laurance Heger,

and Carl Heger, Trustees

Richard Ernsdorf

August R. Johnson

Jean Neville, Life Estate

Remaindermen:

Laurel A. Ross

Linda J. Dillon

Robert L. Neville

**TRACT 13**

Township 145 North, Range 83 West

Section 24: NE $\frac{1}{4}$ , less Outlot A

Surface Ownership:

Coal Ownership:

The Falkirk Mining Company

Barbara Lee Jones, Life Estate

Remaindermen:

Bruce Allen Gradin

**TRACT 14**

Township 145 North, Range 83 West

Section 24: Outlot A of the NE $\frac{1}{4}$  described as follows:

Beginning at a point that is located 1484.0 feet South of the northeast corner of Section 24, thence West and parallel with the North section line a distance of 1972.0 feet to a point, thence North and parallel with the East section line a distance of 492.0 feet, thence West and parallel with the North section line a distance of 668.0 feet to the quarter section line, thence South along the quarter section line a distance of 918.0 feet, thence East and parallel with the North section line a distance of 668.0 feet, thence North and parallel with the East section line a distance of 226.0 feet, thence East and parallel with the North section line a distance of 1972.0 feet to the East section line of Section 24, thence North along the East section line a distance of 200 feet to the point of beginning. Containing 23.14 acres, more or less.

Surface Ownership:

Coal Ownership:

The Falkirk Mining Company

Randy Van Asperen

Barbara Lee Jones

Bruce Allen Gradin

**TRACT 15**

Township 145 North, Range 83 West

Section 24: NW $\frac{1}{4}$

Surface Ownership:

Coal Ownership:

The Falkirk Mining Company

Michael Berg

Barbara Lee Jones

Bruce Allen Gradin

**TRACT 16**

Township 145 North, Range 83 West

Section 24: SW $\frac{1}{4}$

Surface Ownership:

Coal Ownership:

The Falkirk Mining Company

Barbara Lee Jones

Bruce Allen Gradin

**TRACT 17**

Township 145 North, Range 83 West

Section 24: SE $\frac{1}{4}$

Surface Ownership:

Coal Ownership:

The Falkirk Mining Company

Carol J. Reinhiller and Thomas R. Reinhiller

Joy M. Ochsner and Gary L. Ochsner

Judith K. Simpfinderfer and

Jerome D. Simpfinderfer

Sylvia Thompson

**TRACT 18**

Township 145 North, Range 83 West

Section 25: NE $\frac{1}{4}$

Surface Ownership:

Coal Ownership:

The Falkirk Mining Company

John C. Samuelson and Helen K. Samuelson

Shaun Stewart

Erica LeFevers

Chris Stewart

Brett Stewart

Sarah LeFevers

**TRACT 19**

Township 145 North, Range 83 West

Section 25: NW $\frac{1}{4}$

Surface Ownership:

Coal Ownership:

The Falkirk Mining Company

Rita McCreary and Edward McCreary

William Frederick Lindell and Patricia Lindell

**TRACT 20**

Township 145 North, Range 83 West

Section 25: SW $\frac{1}{4}$

Surface Ownership:

Coal Ownership:

The Falkirk Mining Company

Jeffrey G. Culver

Harry W. Samuelson, Jr., as Trustee

of the Harry W. Samuelson,

Jr. Revocable Trust

Lois Samuelson, as Trustee of the

Lois Samuelson Revocable Trust

TRACT 21  
Township 145 North, Range 83 West  
Section 25: SE¼  
Surface Ownership:  
Coal Ownership:

The Falkirk Mining Company  
John C. Samuelson and Helen K. Samuelson  
Dorothy E. Samuelson

TRACT 22  
Township 145 North, Range 83 West  
Section 36: NE¼  
Surface Ownership:  
Coal Ownership:

The Falkirk Mining Company  
North Dakota Department of Trust Lands  
Carol Adams  
Sharon Huber  
Donald Bender  
Paul J. Bender  
Brenda Dietrich  
Warren Dietrich  
Marlin Bender  
Merlin Bender  
LeRoy Bender  
The Estate of Elmer Bender  
Dean Bender  
Rayland J. Bender  
Trent Bender  
Nanette Aragon  
Hope Witte

TRACT 23  
Township 145 North, Range 83 West  
Section 36: NW¼  
Surface Ownership:  
Coal Ownership:

The Falkirk Mining Company  
Carol J. Reinhillier and Thomas R. Reinhillier  
Joy M. Ochsner and Gary L. Ochsner  
Judith K. Simpfenderfer and  
Jerome D. Simpfenderfer  
Sylvia Thompson  
North Dakota Department of Trust Lands

TRACT 24  
Township 145 North, Range 83 West  
Section 13: SW¼  
Surface Ownership:  
Coal Ownership:

The Falkirk Mining Company  
AgriBank, FCB  
Adele C. Saylor  
Myldred Swanson  
Myrtle Breeding  
Stanley E. Saylor, Sr.  
Norma J. Schacher  
Linda G. Hoerner  
Elizabeth Reiland

TRACT 25  
Township 145 North, Range 83 West  
Section 11: SW¼  
Surface Ownership:  
Coal Ownership:

The Falkirk Mining Company  
Arnold J. Schafer and Gretchen M. Schafer,  
Life Estate  
Remaindermen:  
Mary Schafer Conlon  
Macy J. Schafer  
Marty J. Schafer  
Monty R. Schafer  
AgriBank, FCB

**TRACT 26**

Township 145 North, Range 83 West

Section 11: SE¼

Surface Ownership:

Coal Ownership:

The Falkirk Mining Company

Paul D. Saylor

John E. Saylor

Peter Saylor

Daniel Saylor

Ruth Reberg

Matthew Saylor

Mark Saylor

Myrtle Breeding

Gilbert J. Reiland

Stanley E. Saylor, Sr.

Lynette J. Jahner

Pamela L. Tangen

Michael W. Schacher

Linda G. Hoerner

**TRACT 27**

Township 145 North, Range 83 West

Section 13: NE¼

Surface Ownership:

Coal Ownership:

The Falkirk Mining Company

Heger Land Trust Dated 4-30-08, Deborah Siem,

Laurance Heger, and Carl Heger, Trustees

North Dakota Department of Trust Lands

The Nokota Company

Three Forks Oil Corporation

Red Crown Royalties, LLC

**TRACT 28**

Township 145 North, Range 83 West

Section 13: NW¼

Surface Ownership:

Coal Ownership:

The Falkirk Mining Company

Raymond R. Schafer, Terry B. Schafer,

and Wallace L. Schafer as Co-Trustees of

The Ervin R. Schafer Revocable Trust

W. L. Braun Oil Properties Revocable

Trust Dated 10-22-98

Laverna McKelvy

Gail I. Schafer

The Falkirk Mining Company

**TRACT 29**

Township 145 North, Range 83 West

Section 14: NE¼

Surface Ownership:

Coal Ownership:

The Falkirk Mining Company

The Ervin R. Schafer Revocable Trust

Dated 10-10-89

**TRACT 30**

Township 145 North, Range 83 West

Section 14: NW¼

Surface Ownership:

Coal Ownership:

The Falkirk Mining Company

The Adeline L. Schafer Revocable Trust

Dated 10-10-89

**TRACT 31**

Township 145 North, Range 83 West

Section 14: SW¼

McLean County Independent, Thursday, Jan. 28, 2016 – 23

Surface Ownership: The Falkirk Mining Company  
Coal Ownership: Richard Ernsdorf  
Three Forks Oil Corporation  
The Nokota Company  
The Falkirk Mining Company

TRACT 32  
Township 145 North, Range 83 West  
Section 14: SE¼  
Surface Ownership: The Falkirk Mining Company  
Coal Ownership: August R. Johnson  
Three Forks Oil Corporation  
The Nokota Company  
The Falkirk Mining Company

TRACT 33  
Township 145 North, Range 83 West  
Section 23: E½  
Surface Ownership: The Falkirk Mining Company  
Coal Ownership: Rita McCreary and Edward McCreary  
William Frederick Lindell and Patricia Lindell

TRACT 34  
Township 145 North, Range 83 West  
Section 23: NW¼  
Surface Ownership: The Falkirk Mining Company  
Coal Ownership: Terry Ollenburger  
Audrey Schubarth  
Jane Ollenburger  
Monte Ollenburger

TRACT 35  
Township 145 North, Range 83 West  
Section 23: SW¼  
Surface Ownership: The Falkirk Mining Company  
Coal Ownership: Barbara J. Hoffer  
Eileen C. Zander

TRACT 36  
Township 145 North, Range 83 West  
Section 26: NE¼  
Surface Ownership: William Frederick Lindell and Patricia Lindell  
Coal Ownership: William Frederick Lindell and Patricia Lindell  
Rita McCreary and Edward McCreary

TRACT 37  
Township 145 North, Range 83 West  
Section 26: NW¼  
Surface Ownership: The Falkirk Mining Company  
Coal Ownership: William Frederick Lindell and Patricia Lindell  
Rita McCreary and Edward McCreary

TRACT 38  
Township 145 North, Range 83 West  
Section 26: SW¼  
Surface Ownership: The Falkirk Mining Company  
Coal Ownership: Anne Carlsen Center for Children  
Home on the Range  
Dakota Boys Ranch of Minot  
Trinity Lutheran Church Foundation  
Birka Country Church  
First Lutheran Church  
Melvin A. Christenson Revocable Trust  
Darlene Roach

TRACT 39  
Township 145 North, Range 83 West  
Section 26: SE $\frac{1}{4}$   
Surface Ownership:  
Coal Ownership:

The Falkirk Mining Company  
William Frederick Lindell and Patricia Lindell  
Rita McCreary and Edward McCreary

TRACT 40  
Township 145 North, Range 83 West  
Section 35: NE $\frac{1}{4}$   
Surface Ownership:  
Coal Ownership:

The Falkirk Mining Company  
The Falkirk Mining Company

TRACT 41  
Township 145 North, Range 83 West  
Section 35: W $\frac{1}{2}$ NW $\frac{1}{4}$   
Surface Ownership:  
Coal Ownership:

The Falkirk Mining Company  
Anne Carlsen Center for Children  
Home on the Range  
Dakota Boys Ranch of Minot  
Trinity Lutheran Church Foundation  
Birka Country Church  
First Lutheran Church  
Melvin A. Christenson Revocable Trust  
Darlene Roach

TRACT 42  
Township 145 North, Range 83 West  
Section 35: E $\frac{1}{2}$ NW $\frac{1}{4}$   
Surface Ownership:  
Coal Ownership:

The Falkirk Mining Company  
Dean A. Swanson  
Debra Nelson  
Sandra Strinden  
George Lynn Swanson

TRACT 43  
Township 144 North, Range 83 West  
Section 4: Lots 1, 2, 3, and 4, less the south 40 rods of Lots 1 and 2  
Surface Ownership:  
Coal Ownership:

The Falkirk Mining Company  
Ernest E. Slagg, Life Estate  
Remaindermen:  
George L. Swanson and Val Rae Swanson  
Adeline M. Slagg  
Eida Ann Baisch  
Marlys Slagg  
Kevin Slagg  
Wayne Slagg  
Julie Slagg  
Melanie Slagg Irwin  
Donavan Slagg  
Miles J. Slagg  
Marsha F. Slagg  
Carolyne S. Currier  
Jerald Slagg  
Connie Jo Hill  
Val Rae Swanson

TRACT 44  
Township 144 North, Range 83 West  
Section 4: The south 40 rods of Lots 1 and 2

**24 — McLean County Independent, Thursday, Jan. 28, 2016**

Surface Ownership: The Falkirk Mining Company  
Coal Ownership: North Dakota Department of Trust Lands  
Adeline M. Slagg  
Elda Ann Baisch  
Marlys Slagg  
Kevin Slagg  
Wayne Slagg  
Julie Slagg  
Melanie Slagg Irwin  
Donavan Slagg  
Miles J. Slagg  
Marsha F. Slagg  
Carolyne S. Currier  
Jerald Slagg  
Connie Jo Hill  
Val Rae Swanson

**TRACT 45**

Township 144 North, Range 83 West

Section 4: SW¼

Surface Ownership:

Coal Ownership:

The Falkirk Mining Company  
Gertrude E. Burck  
Cleo Kersey  
Kitty Tweeten

**TRACT 46**

Township 144 North, Range 83 West

Section 4: SE¼

Surface Ownership:

Coal Ownership:

The Falkirk Mining Company  
North Dakota Department of Trust Lands  
Elda Ann Baisch  
Carolyne S. Currier  
Melanie Slagg Irwin  
Donavan Slagg  
Miles J. Slagg  
Marsha F. Slagg  
Jerald A. Slagg  
Connie Jo Hill  
Val Rae Swanson  
Adeline M. Slagg  
Marlys Slagg  
Kevin Slagg  
Wayne Slagg  
Julie Slagg

**TRACT 47**

Township 144 North, Range 83 West

Section 5: Lots 3 and 4

Surface Ownership:

Coal Ownership:

Milton L. Holznagel Revocable Trust dated 1-9-95  
Milton L. Holznagel Revocable Trust dated 1-9-95

**TRACT 48**

Township 144 North, Range 83 West

Section 5: Lots 1 and 2

Surface Ownership:

Coal Ownership:

The Falkirk Mining Company  
Roger Peterson, Life Estate  
Remaindermen:  
Neal Peterson  
Cheryl Gillespie

**TRACT 49**

Township 144 North, Range 83 West

Section 5: SW¼, less an 8 ac. tract in the SE¼SW¼

Surface Ownership:

Coal Ownership:

Milton L. Holznagel Revocable Trust Dated 1-9-95  
Milton L. Holznagel Revocable Trust Dated 1-9-95

**TRACT 50**  
Township 144 North, Range 83 West  
Section 5: An 8 ac. tract in the SE $\frac{1}{4}$ SW $\frac{1}{4}$   
Surface Ownership: The Falkirk Mining Company  
Coal Ownership: The Falkirk Mining Company

**TRACT 51**  
Township 144 North, Range 83 West  
Section 5: SE $\frac{1}{4}$   
Surface Ownership: The Falkirk Mining Company  
Coal Ownership: Roger Peterson, Life Estate  
Remaindermen:  
Neal Peterson  
Cheryl Gillespie

**TRACT 52**  
Township 144 North, Range 83 West  
Section 9: NW $\frac{1}{4}$   
Surface Ownership: The Falkirk Mining Company  
Coal Ownership: Marlys D. Peterson and Lisa E. Allen  
April Azar  
Jana J. Azar  
WLK North Dakota, LLC  
Fred S. Wright, Jr.  
Nancy Elizabeth Brooks  
Mary Evelyn King  
Dana Denise Wright  
Major David L. Wright  
Thomas Russell Wright, Jr.  
Fred S. Wright, Jr., Trustee of the  
Fred S. Wright, Jr. Trust  
Plains Exploration & Production Company  
Henry Lerman  
Irving Lerner  
Linda Petroleum Co.  
Williston Projects, Inc.  
Cotton 4 Mineral Trust  
Cotton 6 Mineral Trust  
George E. Moss, Jr.  
John K. Moss  
Myra Ellen Moss  
Murex Petroleum Corporation  
Frank Jeppi Bi-Pass Trust  
J & L Hauptman Family Partnership  
Philip Mandel  
Louis Dorfman  
Cynthia Renee Dorfman  
Shelley Fonda Roberts  
Singer Bros.  
S&P Co., a Louisiana partnership  
Fleischaker Mineral Company, LLC  
Teton Properties, LLC  
S D Resources, Ltd.  
A.G.S. Limited Partnership  
Eculirra Oil & Gas, L.L.C.

**TRACT 53**  
Township 144 North, Range 83 West  
Section 9: NE $\frac{1}{4}$

Surface Ownership:  
Coal Ownership:

The Falkirk Mining Company  
North Dakota Department of Trust Lands  
April Azar  
Jana J. Azar  
WLK North Dakota, LLC  
Fred S. Wright, Jr.  
Nancy Elizabeth Brooks  
Mary Evelyn King  
Dana Denise Wright  
Major David L. Wright  
Thomas Russell Wright, Jr.  
Fred S. Wright, Jr., Trustee of the  
Fred S. Wright, Jr. Trust  
Plains Exploration & Production Company  
Henry Lerman  
Irving Lerner  
Linda Petroleum Co.  
Williston Projects, Inc.  
Cotton 4 Mineral Trust  
Cotton 6 Mineral Trust  
George E. Moss, Jr.  
John K. Moss  
Myra Ellen Moss  
Murex Petroleum Corporation  
Frank Jeppi Bi-Pass Trust  
J & L Hauptman Family Partnership  
Philip Mandel  
Louis Dorfman  
Cynthia Renee Dorfman  
Shelley Fonda Roberts  
Singer Bros.  
S&P Co., a Louisiana partnership  
Fleischaker Mineral Company, LLC  
Teton Properties, LLC  
S D Resources, Ltd.  
A.G.S. Limited Partnership  
Eculirra Oil & Gas, L.L.C.

TRACT 54  
Township 145 North, Range 83 West  
Section 10: SW¼  
Surface Ownership:  
Coal Ownership:

The Falkirk Mining Company  
Pennington Living Trust Dated 4-28-99

TRACT 55  
Township 145 North, Range 83 West  
Section 10: SE¼  
Surface Ownership:  
Coal Ownership:

The Falkirk Mining Company  
MDR Landenberger Family Trust Dated 10-19-02

TRACT 56  
Township 145 North, Range 83 West  
Section 15: NW¼  
Surface Ownership:  
Coal Ownership:

The Falkirk Mining Company  
Barbara J. Hoffer  
Eileen C. Zander  
North Dakota Department of Trust Lands

TRACT 57  
Township 145 North, Range 83 West  
Section 15: NE¼, less tracts of 7.21 ac. and 5.75 ac.  
Surface Ownership:  
Coal Ownership:

The Falkirk Mining Company  
Dean A. Swanson  
Debra Nelson  
Sandra Strinden  
George Lynn Swanson  
North Dakota Department of Trust Lands

**TRACT 58**

Township 145 North, Range 83 West

Section 15: 5.75 ac. in the NE¼

Surface Ownership: The Falkirk Mining Company

Coal Ownership: The Falkirk Mining Company  
North Dakota Department of Trust Lands

**TRACT 59**

Township 145 North, Range 83 West

Section 15: 7.21 ac in the NE¼

Surface Ownership: The Falkirk Mining Company

Coal Ownership: George L. Swanson and Val Rae Swanson  
North Dakota Department of Trust Lands

**TRACT 60**

Township 145 North, Range 83 West

Section 15: SW¼

Surface Ownership: The Falkirk Mining Company

Coal Ownership: MDR Landenberger Family Trust Dated 10-19-02  
The Reserve Petroleum Company

**TRACT 61**

Township 145 North, Range 83 West

Section 15: SE¼

Surface Ownership: The Falkirk Mining Company

Coal Ownership: The Reserve Petroleum Company  
North Dakota Department of Trust Lands

**TRACT 62**

Township 145 North, Range 83 West

Section 21: SE¼

Surface Ownership: The Falkirk Mining Company

Coal Ownership: The Falkirk Mining Company

**TRACT 63**

Township 145 North, Range 83 West

Section 22: NW¼

Surface Ownership: The Falkirk Mining Company

Coal Ownership: Dean A. Swanson  
Debra Nelson  
Sandra Strinden  
George Lynn Swanson  
Estates of Carl H. Reimers and  
Margaret A. Reimers  
Darlene Ostboe  
Michael Ranum  
Mark Ranum  
Andrew Ranum  
Norm Ostboe and Darlene A. Ostboe  
Brian W. Bloomquist  
Bruce B. Bloomquist  
Estate of Gerald T. Woolworth  
Patricia A. Reimers  
Mary O. Reimers  
Charlotte L. Potter  
Gary B. Reimers  
Arylce J. Stroh

Karen Louise Sorensen

**TRACT 64**

Township 145 North, Range 83 West

Section 22: NE $\frac{1}{4}$

Surface Ownership:

Coal Ownership:

The Falkirk Mining Company  
Milton Saylor and Kathy Saylor  
Marcia Walker, Life Estate  
Remaindermen:  
John B. Walker  
Samuel C. Walker

**TRACT 65**

Township 145 North, Range 83 West

Section 22: SW $\frac{1}{4}$ , less 5 ac. in the SW corner and less the SE $\frac{1}{4}$ SE $\frac{1}{4}$ SW $\frac{1}{4}$

Surface Ownership:

Coal Ownership:

The Falkirk Mining Company  
Erma Carlson  
Marva Deane Finck  
Karen Carlson

**TRACT 66**

Township 145 North, Range 83 West

Section 22: SE $\frac{1}{4}$ SE $\frac{1}{4}$ SW $\frac{1}{4}$ , less 3.75 ac.

Surface Ownership:

Coal Ownership:

The Falkirk Mining Company  
Erma Carlson  
Marva Deane Finck  
Karen Carlson

**TRACT 66A**

Township 145 North, Range 83 West

Section 22: 3.75 ac. in the SE $\frac{1}{4}$ SE $\frac{1}{4}$ SW $\frac{1}{4}$

Surface Ownership:

Coal Ownership:

The Falkirk Mining Company  
The Falkirk Mining Company

**TRACT 67**

Township 145 North, Range 83 West

Section 22: SE $\frac{1}{4}$ , less the SW $\frac{1}{4}$ SW $\frac{1}{4}$ SE $\frac{1}{4}$

Surface Ownership:

Coal Ownership:

The Falkirk Mining Company  
Dean A. Swanson  
Debra Nelson  
Sandra Strinden  
George Lynn Swanson

**TRACT 68**

Township 145 North, Range 83 West

Section 22: SW $\frac{1}{4}$ SW $\frac{1}{4}$ SE $\frac{1}{4}$

Surface Ownership:

Coal Ownership:

The Falkirk Mining Company  
Dean A. Swanson  
Debra Nelson  
Sandra Strinden  
George Lynn Swanson

**TRACT 69**

Township 145 North, Range 83 West

Section 28: N $\frac{1}{2}$ NW $\frac{1}{4}$ , W $\frac{1}{2}$ NE $\frac{1}{4}$

Surface Ownership:

Coal Ownership:

The Falkirk Mining Company  
Erma Carlson  
Marva D. Finck  
Karen J. Carlson

**TRACT 70**  
Township 145 North, Range 83 West  
Section 28: E $\frac{1}{2}$ NE $\frac{1}{4}$   
Surface Ownership: The Falkirk Mining Company  
Coal Ownership: Marva Deane Finck

**TRACT 71**  
Township 145 North, Range 83 West  
Section 28: SW $\frac{1}{4}$ , S $\frac{1}{2}$ NW $\frac{1}{4}$   
Surface Ownership: The Falkirk Mining Company  
Coal Ownership: Eileen C. Zander and Merle Zander  
Barbara J. Hoffer

**TRACT 72**  
Township 145 North, Range 83 West  
Section 28: SE $\frac{1}{4}$   
Surface Ownership: Dwight D. Gradin and Denise Gradin  
Coal Ownership: Dwight D. Gradin and Denise Gradin  
Linda Gradin  
Wallyn K. Lee  
Mark E. Gradin, as Trustee of the Mark E. Gradin  
Revocable Trust  
Kyle E. Gradin  
Timothy L. Johannes and Tammy S. Johannes  
Tanya I. Johannes and Steven E. Miller

**TRACT 73**  
Township 145 North, Range 83 West  
Section 27: NW $\frac{1}{4}$   
Surface Ownership: The Falkirk Mining Company  
Coal Ownership: Erma Carlson  
Estates of Carl H. Reimers and  
Margaret A. Reimers  
Darlene Ostboe  
Michael Ranum  
Mark Ranum  
Andrew Ranum  
Norm Ostboe and Darlene A. Ostboe  
Brian W. Bloomquist  
Bruce B. Bloomquist  
Estate of Gerald T. Woolworth  
Patricia A. Reimers  
Mary O. Reimers  
Charlotte L. Potter  
Gary B. Reimers  
Arlyce J. Stroh  
Karen Louise Sorensen

**TRACT 74**  
Township 145 North, Range 83 West  
Section 27: NE $\frac{1}{4}$   
Surface Ownership: The Falkirk Mining Company  
Coal Ownership: Erma Carlson

**TRACT 75**  
Township 145 North, Range 83 West  
Section 27: SW $\frac{1}{4}$   
Surface Ownership: The Falkirk Mining Company  
Coal Ownership: Janice E. Hanson  
Bonnie J. Kuntz

**TRACT 76**  
Township 145 North, Range 83 West  
Section 27: SE $\frac{1}{4}$

McLean County Independent, Thursday, Jan. 28, 2016 – 25

Surface Ownership: The Falkirk Mining Company  
Coal Ownership: Janice E. Hanson  
Bonnie J. Kuntz

TRACT 77

Township 145 North, Range 83 West

Section 33: NW¼

Surface Ownership:

Coal Ownership:

Dwight D. Gradin and Denise Gradin  
Dwight D. Gradin and Denise Gradin  
Linda Gradin  
Wallyn K. Lee  
Mark E. Gradin, as Trustee of the  
Mark E. Gradin Revocable Trust  
Kyle E. Gradin  
Timothy L. Johannes and Tammy S. Johannes  
Tanya I. Johannes and Steven E. Miller

TRACT 78

Township 145 North, Range 83 West

Section 33: NE¼

Surface Ownership:

Coal Ownership:

Dwight D. Gradin and Denise Gradin  
Dwight D. Gradin and Denise Gradin  
Linda Gradin  
Wallyn K. Lee  
Mark E. Gradin, as Trustee of the  
Mark E. Gradin Revocable Trust  
Kyle E. Gradin  
Timothy L. Johannes and Tammy S. Johannes  
Tanya I. Johannes and Steven E. Miller

TRACT 79

Township 145 North, Range 83 West

Section 34: NW¼

Surface Ownership:

Coal Ownership:

The Falkirk Mining Company  
Sharyn M. Calton and Scott Calton

TRACT 80

Township 145 North, Range 83 West

Section 34: North 100 ac. of the NE¼

Surface Ownership:

Coal Ownership:

The Falkirk Mining Company  
Anne Carlsen Center for Children  
Home on the Range  
Dakota Boys Ranch of Minot  
Trinity Lutheran Church Foundation  
Birka Country Church  
First Lutheran Church  
Melvin A. Christenson Revocable Trust  
Darlene Roach

TRACT 81

Township 145 North, Range 83 West

Section 34: South 60 ac. of the NE¼

Surface Ownership:

Coal Ownership:

The Falkirk Mining Company  
Anne Carlsen Center for Children  
Home on the Range  
Dakota Boys Ranch of Minot  
Trinity Lutheran Church Foundation  
Birka Country Church  
First Lutheran Church  
Melvin A. Christenson Revocable Trust  
Darlene Roach

**TRACT 82**  
Township 145 North, Range 83 West  
Section 34: SW¼  
Surface Ownership:

The Falkirk Mining Company  
Mildred Jahner and Valentine Jahner, Life Estate

Remaindermen:  
Curtis Jahner  
Brent Jahner

Coal Ownership:

Mildred Leidholm, as Trustee of the  
Lloyd Leidholm Testamentary Trust  
Eva Leidholm, Life Estate

Remaindermen:  
Brian Leidholm  
Cordell Leidholm  
Glynda Janz  
Karen Perkerewicz  
Dean Leidholm  
Tammy Novak  
Sharon Rivers  
Dwayne Leidholm

Mildred Jahner and Valentine Jahner, Life Estate

Remaindermen:  
Curtis Jahner  
Brent Jahner

**TRACT 83**  
Township 145 North, Range 83 West  
Section 34: SE¼  
Surface Ownership:  
Coal Ownership:

The Falkirk Mining Company

James Peterson  
Dennis L. Peterson  
Duaine J. Peterson  
Jane Schulz  
Susan Krebsbach

North Dakota Department of Trust Lands

**TRACT 84**  
Township 145 North, Range 83 West  
Section 35: SW¼  
Surface Ownership:  
Coal Ownership:

The Falkirk Mining Company  
William F. Lindell and Patricia Lindell  
Robert L. Erickson and Susan F. Lawrence

**TRACT 85**  
Township 145 North, Range 83 West  
Section 35: SE¼  
Surface Ownership:  
Coal Ownership:

The Falkirk Mining Company

Barbara J. Hoffer  
Eileen C. Zander  
Alma Nelson  
Arvin Swanson  
Marcia Steinwand  
Rodney Swanson  
Sheryl Willits

**TRACT 86**  
Township 145 North, Range 83 West  
Section 36: SW¼  
Surface Ownership:  
Coal Ownership:

The Falkirk Mining Company

James Peterson  
Dennis L. Peterson  
Duaine J. Peterson  
Jane Schulz

26 — McLean County Independent, Thursday, Jan. 28, 2016

Susan Krebsbach  
North Dakota Department of Trust Lands

TRACT 87  
Township 145 North, Range 83 West  
Section 36: SE $\frac{1}{4}$   
Surface Ownership:  
Coal Ownership:

Dean A. Swanson and Sandra Lynn Swanson  
North Dakota Department of Trust Lands  
Duaine J. Peterson and Deana R. Peterson

TRACT 88  
Township 144 North, Range 83 West  
Section 6: Gov't Lots 1, 2, N $\frac{1}{2}$ SE $\frac{1}{4}$   
Surface Ownership:  
Coal Ownership:

The Falkirk Mining Company  
The Estate of Iona Jean Vujovich

TRACT 89  
Township 144 North, Range 83 West  
Section 6: Gov't Lots 3, 4, and 5, NE $\frac{1}{4}$ SW $\frac{1}{4}$   
Surface Ownership:

The Falkirk Mining Company  
Mildred Jahner and Valentine Jahner, Life Estate

Coal Ownership:

Remaindermen:  
Curtis Jahner  
Brent Jahner  
Eva Leidholm, Life Estate  
Remaindermen:  
Brian Leidholm  
Cordell Leidholm  
Glynda Janz  
Karen Perkerewicz  
Dean Leidholm  
Tammy Novak  
Sharon Rivers  
Dwayne Leidholm  
Mildred Jahner and Valentine Jahner, Life Estate  
Remaindermen:  
Curtis Jahner  
Brent Jahner  
Mildred Leidholm, as Trustee of the Lloyd Leidholm  
Testamentary Trust

TRACT 90  
Township 144 North, Range 83 West  
Section 6: Gov't Lot 6, SE $\frac{1}{4}$ SW $\frac{1}{4}$ , S $\frac{1}{2}$ SE $\frac{1}{4}$   
Surface Ownership:  
Coal Ownership:

Stephen P. Swanson  
United States of America —  
Bureau of Land Management

TRACT 91  
Township 144 North, Range 83 West  
Section 7: NE $\frac{1}{4}$   
Surface Ownership:  
Coal Ownership:

Milton L. Holznagel Revocable Trust Dated 1-9-95  
Kammey Mahowald  
Deborah Aasen  
W. L. Braun Oil Properties Revocable Trust  
Dated 10-22-98  
Barbara Lee Jones  
Bruce Allen Gradin

TRACT 92  
Township 144 North, Range 83 West  
Section 7: Gov't Lot 1, E $\frac{1}{2}$ NW $\frac{1}{4}$   
Surface Ownership:  
Coal Ownership:

Glenda G. Scholl  
Glenda G. Scholl  
Jenene M. Kittleson  
Marian Gullickson

**TRACT 93**

Township 144 North, Range 83 West

Section 7: Gov't Lot 2

Surface Ownership:

Coal Ownership:

Glenda G. Scholl

Glenda G. Scholl

Jenene M. Kittleson and Michael A. Kittleson

Marian Gullickson and Dwaine Gullickson

**TRACT 94**

Township 144 North, Range 83 West

Section 7: SE¼

Surface Ownership:

Coal Ownership:

Dean A. Swanson and Sandra Lynn Swanson

The Estate of Iona Jean Vujovich

**TRACT 95**

Township 144 North, Range 83 West

Section 7: Gov't Lots 3, 4, E½SW¼

Surface Ownership:

Coal Ownership:

Glenda G. Scholl

Glenda G. Scholl

**TRACT 96**

Township 144 North, Range 84 West

Section 1: Gov't Lots 1, 2, 3, and 4

Surface Ownership:

Coal Ownership:

Michael M. Thyberg

Michael M. Thyberg

**TRACT 97**

Township 144 North, Range 84 West

Section 1: SE¼

Surface Ownership:

Coal Ownership:

Carol Sauer

Carol Sauer

Richard D. Johnson

Ronald L. Johnson

Rhonda M. Johnson

Rodney Edwin Johnson

Robyn Smith

North Dakota Department of Trust Lands

**TRACT 98**

Township 144 North, Range 84 West

Section 1: SW¼

Surface Ownership:

Coal Ownership:

The Falkirk Mining Company

Dean A. Swanson and Sandra L. Swanson

Stephen P. Swanson

**TRACT 99**

Township 144 North, Range 84 West

Section 2: Gov't Lots 1, 2, less 5.51 acres in Lot 2

Surface Ownership:

Coal Ownership:

Mark Swanson and Pamela L. Hopkins

Stephen P. Swanson

United States of America –

Bureau of Land Management

**TRACT 100**

Township 144 North, Range 84 West

Section 2: 5.51 acres in Gov't Lot 2, described as follows: Beginning at the Northeast corner of said Lot 2, T144N-R84W, thence South 400', thence West 600'; thence North 400'; thence East 600' to the point of beginning.

Surface Ownership: Stephen P. Swanson  
Coal Ownership: United States of America –  
Bureau of Land Management

TRACT 101  
Township 144 North, Range 84 West  
Section 2: Gov't Lots 3 and 4  
Surface Ownership: Stephen P. Swanson  
Coal Ownership: United States of America –  
Bureau of Land Management

TRACT 102  
Township 144 North, Range 84 West  
Section 2: SE $\frac{1}{4}$ , SW $\frac{1}{4}$   
Surface Ownership: Forrest W. Ecklund and Alyce F. Ecklund  
Coal Ownership: Forrest W. Ecklund and Alyce F. Ecklund

TRACT 103  
Township 144 North, Range 84 West  
Section 3: Gov't Lots 1, 2, SE $\frac{1}{4}$   
Surface Ownership: Forrest W. Ecklund and Alyce F. Ecklund  
Coal Ownership: Forrest W. Ecklund and Alyce F. Ecklund

TRACT 104  
Township 144 North, Range 84 West  
Section 10: NE $\frac{1}{4}$   
Surface Ownership: Miller Brothers Ranch, L.L.L.P.  
Coal Ownership: Doretta Dene Clark  
Margo Jean Vranna  
Shirley Seher  
Roger Clements Clark  
Velma Cleveland  
Scott Lang and Kay Lang  
Lamoure Besse and Patricia Besse  
Scott Schmidt and Casey Schmidt

TRACT 105  
Township 144 North, Range 84 West  
Section 11: NE $\frac{1}{4}$ , SE $\frac{1}{4}$   
Surface Ownership: Miller Brothers Ranch, L.L.L.P.  
Coal Ownership: Doretta Dene Clark  
Margo Jean Vranna  
Shirley Seher  
Roger Clements Clark  
Velma Cleveland  
Scott Lang and Kay Lang  
Lamoure Besse and Patricia Besse  
Scott Schmidt and Casey Schmidt

TRACT 106  
Township 144 North, Range 84 West  
Section 11: NW $\frac{1}{4}$   
Surface Ownership: Miller Brothers Ranch, L.L.L.P.  
Coal Ownership: Doretta Dene Clark  
Margo Jean Vranna  
Shirley Seher  
Roger Clements Clark  
Velma Cleveland  
Scott Lang and Kay Lang  
Lamoure Besse and Patricia Besse  
Scott Schmidt and Casey Schmidt

TRACT 107  
Township 144 North, Range 84 West  
Section 11: SW¼  
Surface Ownership:  
Coal Ownership:

Miller Brothers Ranch, L.L.L.P.  
Doretta Dene Clark  
Margo Jean Vrana  
Shirley Seher  
Roger Clements Clark  
Velma Cleveland  
Scott Lang and Kay Lang  
Lamoure Besse and Patricia Besse  
Scott Schmidt and Casey Schmidt

TRACT 108  
Township 144 North, Range 84 West  
Section 12: N½NE¼  
Surface Ownership:  
Coal Ownership:

Glenda G. Scholl  
Jenene M. Kittleson and Michael A. Kittleson

TRACT 109  
Township 144 North, Range 84 West  
Section 12: S½NE¼  
Surface Ownership:  
Coal Ownership:

Kay M. Hegvik  
Marian Gullickson and Dwaine Gullickson  
George L. Swanson and Val Rae Swanson  
Dean A. Swanson and Sandy L. Swanson

TRACT 110  
Township 144 North, Range 84 West  
Section 12: NW¼  
Surface Ownership:  
Coal Ownership:

Harley J. Scholl  
United States of America –  
Bureau of Land Management

TRACT 111  
Township 144 North, Range 84 West  
Section 12: SE¼  
Surface Ownership:  
Coal Ownership:

Glenda G. Scholl  
Glenda G. Scholl  
George Scholl  
Marian Gullickson  
Jenene Kittleson

TRACT 112  
Township 144 North, Range 84 West  
Section 12: SW¼  
Surface Ownership:  
Coal Ownership:

Roger Peterson  
Roger Peterson

TRACT 113  
Township 145 North, Range 83 West  
Section 4: Gov't Lots 3, 4, S½NW¼  
Surface Ownership:  
Coal Ownership:

The Falkirk Mining Company  
David J. LeRoy and Dorothy M. LeRoy  
W. L. Braun Oil Properties Revocable Trust  
Laverna McKelvy  
Gail I. Schafer  
AgriBank, FCB  
The Falkirk Mining Company

TRACT 114  
Township 145 North, Range 83 West  
Section 4: SW¼

Surface Ownership: The Falkirk Mining Company  
Coal Ownership: David J. LeRoy and Dorothy M. LeRoy  
AgriBank, FCB

TRACT 115  
Township 145 North, Range 83 West  
Section 5: Gov't Lot 1, SE $\frac{1}{4}$ NE $\frac{1}{4}$   
Surface Ownership: LeRoys' Circle W Inc.  
Coal Ownership: LeRoys' Circle W Inc.

TRACT 116  
Township 145 North, Range 83 West  
Section 5: Gov't Lots 2, 3 and 4, SW $\frac{1}{4}$ NE $\frac{1}{4}$ , S $\frac{1}{2}$ NW $\frac{1}{4}$   
Surface Ownership: David J. LeRoy and Dorothy M. LeRoy  
Coal Ownership: David J. LeRoy and Dorothy M. LeRoy

TRACT 117  
Township 145 North, Range 83 West  
Section 5: S $\frac{1}{2}$   
Surface Ownership: The Falkirk Mining Company  
Coal Ownership: David J. LeRoy and Dorothy M. LeRoy

TRACT 118  
Township 145 North, Range 83 West  
Section 6: Gov't Lots 1, 2, S $\frac{1}{2}$ NE $\frac{1}{4}$ , N $\frac{1}{2}$ SE $\frac{1}{4}$   
Surface Ownership: The Falkirk Mining Company  
Coal Ownership: Pennington Living Trust Dated 4-28-99  
AgriBank, FCB

TRACT 119  
Township 145 North, Range 83 West  
Section 6: Gov't Lots 3, 4, 5, 6, SE $\frac{1}{4}$ NW $\frac{1}{4}$ , NE $\frac{1}{4}$ SW $\frac{1}{4}$   
Surface Ownership: Delbert Sayler and Cletus Sayler  
Coal Ownership: Delbert Sayler and Cletus Sayler

TRACT 120  
Township 145 North, Range 83 West  
Section 6: Gov't Lot 7, SE $\frac{1}{4}$ SW $\frac{1}{4}$ , S $\frac{1}{2}$ SE $\frac{1}{4}$   
Surface Ownership: The Falkirk Mining Company  
Coal Ownership: James B. LeRoy and Debra D. LeRoy  
David J. LeRoy and Dorothy M. LeRoy

TRACT 121  
Township 145 North, Range 83 West  
Section 7: E $\frac{1}{2}$   
Surface Ownership: The Falkirk Mining Company  
Coal Ownership: David J. LeRoy and Dorothy M. LeRoy  
Darlys A. Schock  
Kenneth Leidholm

TRACT 122  
Township 145 North, Range 83 West  
Section 7: North 1/3 of Gov't Lots 1, 2, 3, 4, and E $\frac{1}{2}$ W $\frac{1}{2}$   
Surface Ownership: Milton Sayler and Kathy Sayler  
Coal Ownership: Milton Sayler and Kathy Sayler  
The Reserve Petroleum Company

TRACT 123  
Township 145 North, Range 83 West  
Section 7: Middle 1/3 of Gov't Lots 1, 2, 3, 4, and E $\frac{1}{2}$ W $\frac{1}{2}$   
Surface Ownership: The Falkirk Mining Company  
Coal Ownership: Irene K. Grosz  
The Reserve Petroleum Company

**TRACT 124**

Township 145 North, Range 83 West  
Section 7: South 1/3 of Gov't Lots 1, 2, 3, 4, and E 1/2 W 1/2

Surface Ownership:  
Coal Ownership:

The Falkirk Mining Company  
Darin Saylor  
Roger Saylor  
The Reserve Petroleum Company

**TRACT 125**

Township 145 North, Range 83 West  
Section 8: N 1/2

Surface Ownership:  
Coal Ownership:

Lynn H. Stewart Revocable Trust  
Lynn H. Stewart Revocable Trust  
Melanie Casanova  
Camille C. Bonstrom  
Chandler L. Feuk  
Brad Feuk  
Cleome Hennessy, Trustee of the Hennessy Trust  
Dated 3-9-99

**TRACT 126**

Township 145 North, Range 83 West  
Section 8: SE 1/4

Surface Ownership:  
Coal Ownership:

The Falkirk Mining Company  
Richard E. Ott and Virginia A. Ott

**TRACT 127**

Township 145 North, Range 83 West  
Section 8: SW 1/4

Surface Ownership:  
Coal Ownership:

The Falkirk Mining Company  
Sylvia Ann Ott

**TRACT 128**

Township 145 North, Range 83 West  
Section 9: NE 1/4 less 1.02 ac. hwy.

Surface Ownership:  
Coal Ownership:

The Falkirk Mining Company  
Curtis Schafer  
Ardis Sullivan  
Linda Lamb  
Mavis Cummings

**TRACT 129**

Township 145 North, Range 83 West  
Section 9: NW 1/4

Surface Ownership:

John Meyer  
Patricia Syvertsen  
Barbara J. Bambenek  
The Charles A. Jenson and Sharon Kennedy  
Jenson Revocable Living Trust Dated 6-23-06  
J & S J Living Trust Dated 1-22-02  
Ronald H. Johnson  
Salley Sue Meyer  
Terry D. Johnson  
Roxette A. Denne  
John Meyer  
Patricia Syvertsen  
Barbara J. Bambenek  
The Charles A. Jenson and Sharon Kennedy  
Jenson Revocable Living Trust Dated 6-23-06  
J & S J Living Trust Dated 1-22-02  
Ronald H. Johnson  
Salley Sue Meyer

Coal Ownership:

McLean County Independent, Thursday, Jan. 28, 2016 – 27

Terry D. Johnson  
Roxette A. Denne

**TRACT 130**

Township 145 North, Range 83 West  
Section 9: SE $\frac{1}{4}$   
Surface Ownership:  
Coal Ownership:

The Falkirk Mining Company  
Lillian L. Saylor  
Steven Saylor  
Bryan Saylor  
Greg Saylor  
The Reserve Petroleum Company  
AgriBank, FCB

**TRACT 131**

Township 145 North, Range 83 West  
Section 9: SW $\frac{1}{4}$   
Surface Ownership:  
Coal Ownership:

The Falkirk Mining Company  
David J. LeRoy and Dorothy M. LeRoy

**TRACT 132**

Township 145 North, Range 83 West  
Section 16: NE $\frac{1}{4}$   
Surface Ownership:  
Coal Ownership:

The Falkirk Mining Company  
Pauline M. Rosberg  
North Dakota Department of Trust Lands

**TRACT 133**

Township 145 North, Range 83 West  
Section 16: NW $\frac{1}{4}$ , SW $\frac{1}{4}$   
Surface Ownership:  
Coal Ownership:

Pauline M. Rosberg  
Pauline M. Rosberg  
Robert C. Mann  
Audrey M. Crum  
Margaret E. Tollerud

**TRACT 134**

Township 145 North, Range 83 West  
Section 16: N $\frac{1}{2}$ SE $\frac{1}{4}$   
Surface Ownership:  
Coal Ownership:

The Falkirk Mining Company  
Pennington Living Trust Dated 4-28-99  
North Dakota Department of Trust Lands

**TRACT 135**

Township 145 North, Range 83 West  
Section 16: S $\frac{1}{2}$ SE $\frac{1}{4}$   
Surface Ownership:  
Coal Ownership:

The Falkirk Mining Company  
Pauline M. Rosberg  
North Dakota Department of Trust Lands

**TRACT 136**

Township 145 North, Range 83 West  
Section 17: N $\frac{1}{2}$ , SE $\frac{1}{4}$ , E $\frac{1}{2}$ SW $\frac{1}{4}$ , W $\frac{1}{2}$ SW $\frac{1}{4}$   
Surface Ownership:  
Coal Ownership:

Pauline M. Rosberg  
Pauline M. Rosberg  
Jessica Potter  
Darralu S. Lindholm  
Martha Specht  
Mary O'Brien Specht  
Estate of Deloris Potter  
Linda Anderson  
Nancy Watkins  
Larry Woodall  
Estate of Phyllis Ann Hermanson

TRACT 137  
Township 145 North, Range 83 West  
Section 18: Gov't Lots 1, 2, 3, 4, E½W½, NE¼  
Surface Ownership:  
Coal Ownership:

The Falkirk Mining Company  
Andrew W. Jensen and Kimberly A. Jensen

TRACT 138  
Township 145 North, Range 83 West  
Section 18: SE¼  
Surface Ownership:  
Coal Ownership:

The Falkirk Mining Company  
United States of America –  
Bureau of Land Management

TRACT 139  
Township 145 North, Range 83 West  
Section 19: NE¼  
Surface Ownership:  
Coal Ownership:

Eileen C. Zander  
Eileen C. Zander  
Barbara J. Hoffer

TRACT 140  
Township 145 North, Range 83 West  
Section 19: SE¼  
Surface Ownership:  
Coal Ownership:

The Falkirk Mining Company  
Donna Sandvik  
Dan Swanson  
Randy Swanson  
Laurance L. Heger and Nancy L. Heger

TRACT 141  
Township 145 North, Range 83 West  
Section 20: N½, SE¼ less 2 acres in the SW corner of the SE¼  
Surface Ownership:  
Coal Ownership:

The Falkirk Mining Company  
Beth Bruestle  
Kent Swanson  
Timothy Bruestle  
Ryan Bruestle  
Erika Bruestle  
Pauline M. Rosberg  
Robert C. Mann  
Audrey M. Crum  
Margaret E. Tollerud  
North Dakota Community Foundation UTETCF  
James and Winnifred Marvin Scholarship Fund  
Leslie Peterson  
Barbara Peterson

TRACT 142  
Township 145 North, Range 83 West  
Section 20: SW¼  
Surface Ownership:

Sylvia Thompson  
Carol J. Reinhiller  
Joy M. Ochsner  
Judith K. Simpenderfer  
Sylvia Thompson  
Carol J. Reinhiller  
Joy M. Ochsner  
Judith K. Simpenderfer

Coal Ownership:

28 — McLean County Independent, Thursday, Jan. 28, 2016

TRACT 143

Township 145 North, Range 83 West  
Section 21: N½, SW¼, less 0.49 ac. in the NW¼  
Surface Ownership:  
Coal Ownership:

The Falkirk Mining Company  
Pauline M. Rosberg  
Robert C. Mann  
Audrey M. Crum  
Margaret E. Tollerud

TRACT 144

Township 145 North, Range 83 West  
Section 21: 0.49 ac. in the NW¼, beginning at a point on the east line of said NW¼, Section 21, said point being 33 feet south of the northeast corner thereof; thence south 140 feet; thence west 150 feet; thence north 140 feet; thence east 150 feet to the point of beginning. Surface Ownership:  
The Falkirk Mining Company  
Coal Ownership:

Pauline M. Rosberg  
Robert C. Mann  
Audrey M. Crum  
Margaret E. Tollerud

TRACT 145

Township 145 North, Range 83 West  
Section 29: NE¼  
Surface Ownership:  
Coal Ownership:

The Falkirk Mining Company  
Mary Jane Miller  
Nancy J. Bridges and Jennifer Anne Barber,  
Co-Trustees or the Successor Trustee of The  
Nancy J. Bridges Trust Dated November 15, 2011

TRACT 146

Township 145 North, Range 83 West  
Section 29: S½  
Surface Ownership:

Coal Ownership:

Robert C. Mann  
Audrey M. Crum  
Margaret E. Tollerud  
Robert C. Mann  
Audrey M. Crum  
Margaret E. Tollerud  
Leslie Peterson  
Barbara Peterson

TRACT 147

Township 145 North, Range 83 West  
Section 32: NE¼  
Surface Ownership:  
Coal Ownership:

Barbara J. Hoffer  
Barbara J. Hoffer  
Eileen C. Zander

TRACT 148

Township 145 North, Range 83 West  
Section 32: NW¼  
Surface Ownership:

Coal Ownership:

Robert C. Mann  
Audrey M. Crum  
Margaret E. Tollerud  
The Stewart E. Bowers and Joyce W. Bowers  
1989 Inter Vivos Trust Dated 6-23-89  
Robert C. Mann  
Audrey M. Crum  
Margaret E. Tollerud  
Mueller Industries, Inc.  
Mary C. Henderson

**TRACT 149**  
Township 145 North, Range 83 West  
Section 32: SE $\frac{1}{4}$   
Surface Ownership:  
Coal Ownership:

Michael M. Thyberg  
Michael M. Thyberg

**TRACT 150**  
Township 145 North, Range 83 West  
Section 32: SW $\frac{1}{4}$   
Surface Ownership:  
Coal Ownership:

Michael M. Thyberg  
United States of America -  
Bureau of Land Management

**TRACT 151**  
Township 145 North, Range 83 West  
Section 33: SE $\frac{1}{4}$ , SW $\frac{1}{4}$   
Surface Ownership:  
Coal Ownership:

Dwight D. Gradin and Denise Gradin  
Dwight D. Gradin and Denise Gradin  
Linda Gradin  
Wallyn K. Lee  
Mark E. Gradin, as Trustee of the Mark E. Gradin  
Revocable Trust  
Kyle E. Gradin  
Timothy L. Johannes and Tammy S. Johannes  
Tanya L. Johannes and Steven E. Miller

**TRACT 152**  
Township 145 North, Range 84 West  
Section 1: Gov't Lots 1, 2, 3, 4, S $\frac{1}{2}$ N $\frac{1}{2}$ , SE $\frac{1}{4}$   
Surface Ownership:  
Coal Ownership:

The Falkirk Mining Company  
William Frederick Lindell and Patricia L. Lindell  
Rita McCreary

**TRACT 153**  
Township 145 North, Range 84 West  
Section 1: SW $\frac{1}{4}$   
Surface Ownership:  
Coal Ownership:

The Falkirk Mining Company  
Beth Bruestle  
Kent Swanson  
Timothy Bruestle  
Ryan Bruestle  
Erika Bruestle

**TRACT 154**  
Township 145 North, Range 84 West  
Section 2: Gov't Lots 1, 2, SE $\frac{1}{4}$ NE $\frac{1}{4}$ , SW $\frac{1}{4}$ NE $\frac{1}{4}$   
Surface Ownership:  
Coal Ownership:

The Falkirk Mining Company  
David J. LeRoy and Dorothy M. LeRoy  
North Dakota Department of Trust Lands

**TRACT 155**  
Township 145 North, Range 84 West  
Section 12: E $\frac{1}{2}$ NE $\frac{1}{4}$ , SW $\frac{1}{4}$ NE $\frac{1}{4}$ , NE $\frac{1}{4}$ SE $\frac{1}{4}$   
Surface Ownership:  
Coal Ownership:

The Falkirk Mining Company  
Beth Bruestle  
Kent Swanson  
Timothy Bruestle  
Ryan Bruestle  
Erika Bruestle  
United States of America -  
Bureau of Land Management

**TRACT 156**

Township 145 North, Range 84 West  
Section 12: E $\frac{1}{2}$ NW $\frac{1}{4}$ , NE $\frac{1}{4}$ SW $\frac{1}{4}$ , NW $\frac{1}{4}$ NE $\frac{1}{4}$   
Surface Ownership:  
Coal Ownership:

The Falkirk Mining Company  
Beth Bruestle  
Kent Swanson  
Timothy Bruestle  
Ryan Bruestle  
Erika Bruestle

TRACT 157  
Township 145 North, Range 84 West  
Section 12: W $\frac{1}{2}$ W $\frac{1}{2}$ , SE $\frac{1}{4}$ SW $\frac{1}{4}$ , S $\frac{1}{2}$ SE $\frac{1}{2}$   
Surface Ownership:  
Coal Ownership:

The Falkirk Mining Company  
United States of America -  
Bureau of Land Management

TRACT 158  
Township 145 North, Range 84 West  
Section 12: NW $\frac{1}{4}$ SE $\frac{1}{4}$   
Surface Ownership:  
Coal Ownership:

The Falkirk Mining Company  
United States of America -  
Bureau of Land Management

TRACT 159  
Township 145 North, Range 84 West  
Section 13: NE $\frac{1}{4}$   
Surface Ownership:  
Coal Ownership:

The Falkirk Mining Company  
Douglas Kesselring  
Jerome Vonderheide  
Donald Kesselring  
Judith K. Fiol  
Marjorie K. Williams  
Beverly Singleton

TRACT 160  
Township 145 North, Range 84 West  
Section 13: W $\frac{1}{2}$   
Surface Ownership:  
Coal Ownership:

The Falkirk Mining Company  
Douglas Kesselring

TRACT 161  
Township 145 North, Range 84 West  
Section 13: SE $\frac{1}{4}$   
Surface Ownership:  
Coal Ownership:

The Falkirk Mining Company  
Beth Bruestle  
Kent Swanson  
Timothy Bruestle  
Ryan Bruestle  
Erika Bruestle

TRACT 162  
Township 146 North, Range 83 West  
Section 29: SW $\frac{1}{4}$   
Surface Ownership:  
Coal Ownership:

Paul Hardy and Lori Hardy  
Paul Hardy and Lori Hardy

TRACT 163  
Township 146 North, Range 83 West  
Section 30: SE $\frac{1}{4}$   
Surface Ownership:  
Coal Ownership:

Ralph E. Saylor Living Trust Dated 11-24-97  
Jean M. Saylor

**TRACT 164**  
Township 146 North, Range 83 West  
Section 31: NE $\frac{1}{4}$ , NE $\frac{1}{4}$ SE $\frac{1}{4}$   
Surface Ownership: Esther M. Horst, Life Estate

Remaindermen:  
Cleaton Saylor  
Neoma J. Vogel  
Barton Saylor  
Elton Saylor  
Rodney Kraft, as Trustee of The Lyla Ann Kraft  
Family Trust  
Coal Ownership: Esther M. Horst

**TRACT 165**  
Township 146 North, Range 83 West  
Section 31: Gov't Lots 1, 2, E $\frac{1}{2}$ NW $\frac{1}{4}$   
Surface Ownership: Timothy D. Saylor  
Coal Ownership: Timothy D. Saylor

**TRACT 166**  
Township 146 North, Range 83 West  
Section 31: NW $\frac{1}{4}$ SE $\frac{1}{4}$   
Surface Ownership: The Falkirk Mining Company  
Coal Ownership: David J. LeRoy and Dorothy M. LeRoy

**TRACT 167**  
Township 146 North, Range 83 West  
Section 31: SE $\frac{1}{4}$ SE $\frac{1}{4}$ , E $\frac{1}{2}$ SW $\frac{1}{4}$ SE $\frac{1}{4}$   
Surface Ownership: Delbert Saylor and Cletus Saylor  
Coal Ownership: Delbert Saylor and Cletus Saylor

**TRACT 168**  
Township 146 North, Range 83 West  
Section 31: Gov't Lots 3, 4, E $\frac{1}{2}$ SW $\frac{1}{4}$ , W $\frac{1}{2}$ SW $\frac{1}{4}$ SE $\frac{1}{4}$   
Surface Ownership: The Falkirk Mining Company  
Coal Ownership: Nevin E. Fisher and Lyla R. Fisher  
Harold B. Saylor

**TRACT 169**  
Township 146 North, Range 83 West  
Section 32: N $\frac{1}{2}$ , NW $\frac{1}{4}$ SW $\frac{1}{4}$   
Surface Ownership: Delbert Saylor and Cletus Saylor  
Coal Ownership: Delbert Saylor and Cletus Saylor

**TRACT 170**  
Township 146 North, Range 83 West  
Section 32: SE $\frac{1}{4}$ , less Outlot A  
Surface Ownership: The Falkirk Mining Company  
Coal Ownership: David J. LeRoy and Dorothy M. LeRoy  
W. L. Braun Oil Properties Revocable  
Trust Dated 10-22-98  
AgriBank, FCB  
Laverna McKelvy  
Gail I. Schafer  
The Falkirk Mining Company

**TRACT 171**  
Township 146 North, Range 83 West  
Section 32: S $\frac{1}{2}$ SW $\frac{1}{4}$ , NE $\frac{1}{4}$ SW $\frac{1}{4}$   
Surface Ownership: Delbert Saylor and Cletus Saylor  
Coal Ownership: United States of America -  
Bureau of Land Management

**TRACT 172** See FALLKIRK page 29

# FALKIRK

continued from page 28

Township 146 North, Range 84 West  
Section 36: NE $\frac{1}{4}$   
Surface Ownership:

Linda L. Sayler Living Trust Dated 11-24-97  
Ralph E. Sayler Living Trust Dated 11-24-97  
Linda L. Sayler Living Trust Dated 11-24-97  
Ralph E. Sayler Living Trust Dated 11-24-97  
Jerome Vonderheide  
Donald Kesselring  
Judith K. Fiol  
Marjorie K. Williams  
Beverly Singleton  
Douglas Kesselring  
North Dakota Department of Trust Lands

Coal Ownership:

TRACT 173  
Township 146 North, Range 84 West  
Section 36: N $\frac{1}{2}$ SE $\frac{1}{4}$   
Surface Ownership:  
Coal Ownership:

The Falkirk Mining Company  
Leslie Landenberger and Ruby Landenberger  
North Dakota Department of Trust Lands

TRACT 174  
Township 146 North, Range 84 West  
Section 36: S $\frac{1}{2}$ SE $\frac{1}{4}$   
Surface Ownership:

Donald D. Landenberger and  
Karen S. Landenberger, Life Estate  
Remaindermen:  
Terry Landenberger  
Douglas Landenberger  
Camey Mcauley

Coal Ownership:

Terry Landenberger and Bonnie Landenberger  
Douglas Landenberger and Alice Landenberger  
Camey Mcauley and Donald Mcauley  
Velma Schacher  
Leila Landenberger  
Gary Landenberger  
Kathy Landenberger Kesselring  
Diane Nelson  
North Dakota Department of Trust Lands

TRACT 175  
Township 146 North, Range 84 West  
Section 36: NW $\frac{1}{4}$   
Surface Ownership:  
Coal Ownership:

The Falkirk Mining Company  
David J. LeRoy and Dorothy M. LeRoy  
North Dakota Department of Trust Lands

TRACT 175A  
Township 146 North, Range 84 West  
Section 36: SW $\frac{1}{4}$   
Surface Ownership:  
Coal Ownership:

The Falkirk Mining Company  
David J. LeRoy and Dorothy M. LeRoy  
North Dakota Department of Trust Lands

TRACT 176  
Township 145 North, Range 82 West  
Section 7: Gov't Lots 3 and 4  
Surface Ownership:  
Coal Ownership:

The Falkirk Mining Company  
Laurance L. Heger and Nancy L. Heger

TRACT 177  
Township 145 North, Range 83 West  
Section 12: The East 1/3 of the SE $\frac{1}{4}$   
Surface Ownership:  
Coal Ownership:

The Falkirk Mining Company  
Bradley A. Landenberger  
Beverly J. Sauter and Edwin R. Sauter

TRACT 178

Township 145 North, Range 83 West  
Section 12: The East 1/3 of the West 2/3 of the SE $\frac{1}{4}$

Surface Ownership:

The Falkirk Mining Company

Coal Ownership:

Bradley A. Landenberger  
Betty L. Brumfield and Richard S. Brumfield

TRACT 179

Township 145 North, Range 83 West  
Section 12: The West 1/3 of the SE $\frac{1}{4}$

Surface Ownership:

The Falkirk Mining Company

Coal Ownership:

Bradley A. Landenberger  
Phyllis Schauer

TRACT 180

Township 145 North, Range 83 West  
Section 12: SW $\frac{1}{4}$

Surface Ownership:

The Falkirk Mining Company

Coal Ownership:

Kenneth Stadick  
Laurel Miller

Operations within 100 feet of the outside rights-of-way of the following section lines will be necessary during the planned mining for this permit. Prior to operations being conducted in this 100-foot area, Falkirk will obtain the approval of the Board of McLean County Commissioners, the road authority, subject to public notice and hearing. A copy of the documents from the Board of Commissioners approving the operation within 100 feet and road closures will be forwarded to the ND Public Service Commission.

1. The east-west section line between the SE4 of Section 35, T146N, R84W and the NE4 of Section 2, T145N, R84W.
2. The east-west section line between the SW4 of Section 33, T146N, R83W and the NW4 of Section 4, T145N, R83W.
3. The east-west section line between the SE4 of Section 4 and the NE4 of Section 9, T145N, R83W.
4. The east-west section line between Section 31, T145N, R83W and the NW4 of Section 2 and the NE4 of Section 3, T144N, R84W.
5. The north-south section line between the SE4 of Section 10 and the SW4 of Section 11, T145N, R83W.

No surface coal mining operations will be located within 100 feet of the outside rights-of-way of any of these county and section line roads until they are closed by the McLean Co. Board of Commissioners. Before the rights-of-way and associated setback corridors are disturbed, approval from the McLean Board of County Commissioners will be obtained. Notice and opportunity for a hearing will be provided as required in several sections of ND Century Code.

County Road 16 located on the east-west section line between Sections 4 and 9, 5 and 8, 6 and 7, T145N, R83W, and Sections 1 and 12, T145N, R84W is proposed to be relocated south approximately  $\frac{1}{2}$  to 1 mile to accommodate the inception of mining in this permit area. The relocation will need to be in place approximately 30 years according to currently proposed mine plans. County Road 17 located between Section 28 and 29, 32 and 33, T145N, R83W and through Sections 1 and 12, T144N, R84W is proposed to be relocated west approximately  $\frac{1}{2}$  to 1 mile to accommodate the inception of mining in this permit area. The relocation will need to be in place approximately 15 years according to currently proposed mine plans. The proposed relocations will be the subject of a petition and hearing process conducted by the McLean County Board of Commissioners prior to being approved or finalized. No other road relocations are being currently requested.

County Road 20 between Sections 21 and 28, 22 and 27, T145N, R83W will be constructed and open in 2016. The relocated County Road 20 between Sections 28 and 33, 27 and 34, and 27 and 26, T145N, R83W will be closed in 2016.

Copies of the application for revision and renewal of a surface coal mining permit are available for public inspection at the offices of the North Dakota Public Service Commission, 600 East Boulevard Ave., Bismarck, ND 58505-0480 and at the office of the County Auditor, McLean County Courthouse, Washburn, ND 58577.

Written comments, objections, or requests for informal conferences on the application may be submitted by any person with an interest which is or may be adversely affected to the North Dakota Public Service Commission, 600 East Boulevard Ave., Bismarck, ND 58505-0480 within 30 days after the last publication of this notice. The written request should state the concerns or objections regarding the revision and renewal.

(Jan. 7, 14, 21, 28, 2016)