

Exam Date: 11/30/2017

North Dakota Bean LLC

Page: 1

Examiner: 1

County:

Phone:

CCC Number:

Location/Container Numbers/Comments	Section	Capacity
<b>PART A - ADDITIONAL SPACE TO BE INCLUDED UNDER LICENSE</b>		
109	A	3,317
		<b>Total: 3,317</b>
<b>PART B - SPACE TO BE DELETED UNDER LICENSE</b>		
<NO BINS DELETED>		
		<b>Total: 0</b>
<b>PART C - ALL SPACE TO BE INCLUDED UNDER LICENSE</b>		
	A	195,000
		<b>Total: 195,000</b>
<b>PART D - TOTAL CAPACITY BY FUNCTIONAL UNIT</b>		
Grand Forks 1304	A	195,000
		<b>Total: 195,000</b>

Exam Date: 11/30/2017

North Dakota Bean LLC

Page: 1

Examiner: 1

County:

Status	Section	Bin Number	Bin Type	Base Point	Diameter or Bu/Ft (Irreg.)	Length	Width	Side wall	Add for Hopper	Ded. for Obst.	Effective Depth	Add for Peak	Depth for Capac.	Bushels per Foot	Base Pack%	Bushel Capacity with Pack
--------	---------	------------	----------	------------	----------------------------	--------	-------	-----------	----------------	----------------	-----------------	--------------	------------------	------------------	------------	---------------------------

## Facility: Grand Forks

### Section: A

A	002	Square	top of vertical bin wall	0.000	10.20	6.100	15.60	0.00	0.00	15.600	0.000	15.6	50.0	4.20	813
A	005	Square	top of vertical bin wall	0.000	10.20	6.100	15.60	0.00	0.00	15.600	0.000	15.6	50.0	4.20	813
A	007	Square	top of vertical bin wall	0.000	8.200	8.100	21.00	0.00	0.00	21.000	0.000	21.0	53.4	4.50	1,171
A	008	Square	top of vertical bin wall	0.000	8.200	8.100	21.00	0.00	0.00	21.000	0.000	21.0	53.4	4.50	1,171
A	101	Flat	grain wall ht. 20.4' cnvyr	0.000	49.20	49.20	16.00	0.00	0.00	16.000	0.000	16.0	1945.9	10.0	34,247
A	102	Flat	grain wall ht. 20.4' cnvyr	0.000	49.20	39.30	16.00	0.00	0.00	16.000	0.000	16.0	1554.3	10.0	27,356
A	103	Flat	grain wall ht. 20.4' cnvyr	0.000	21.50	9.000	7.000	0.00	0.00	7.000	0.000	7.0	155.5	6.80	1,163
A	104	Flat	grain wall ht. 20.4' cnvyr	0.000	27.70	9.000	5.500	0.00	0.00	5.500	0.000	5.5	200.4	7.00	1,179
A	105	Flat	grain wall ht. 20.4' cnvyr	0.000	48.90	38.00	16.00	0.00	0.00	16.000	0.000	16.0	1493.7	10.0	26,289
A	106	Flat	grain wall ht. 20.4' cnvyr	0.000	49.20	24.10	16.00	0.00	0.00	16.000	0.000	16.0	953.2	10.0	16,776
A	107	Flat	grain wall ht. 20.4' cnvyr	0.000	49.20	24.30	16.00	0.00	0.00	16.000	0.000	16.0	961.1	10.0	16,916
A	108	Peaked	top of sidewall	53.500	0.000	0.000	28.10	0.00	0.00	28.100	3.700	31.8	1807.1	10.0	63,213
Added	A 109	Peaked	top of sidewall	16.000	0.000	0.000	16.00	2.35	0.00	18.350	1.000	19.4	161.6	5.80	3,317

Bin count: 13

Facility: Grand Forks Section: A Total: **194,424**

To Even: **195,000**

**Overall Licensed Bin Capacity for:**

North Dakota Bean LLC

Bin count: 13

**Licensed Capacity:**

(includes pack)

**194,424 Bu.**

**Licensed Capacity (to even):**

(includes pack and section totals are rounded up to next highest 1000)

**195,000 Bu.**

North

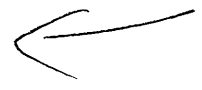

4385  
North Dakota Bean  
Grand Forks, ND

Railroad

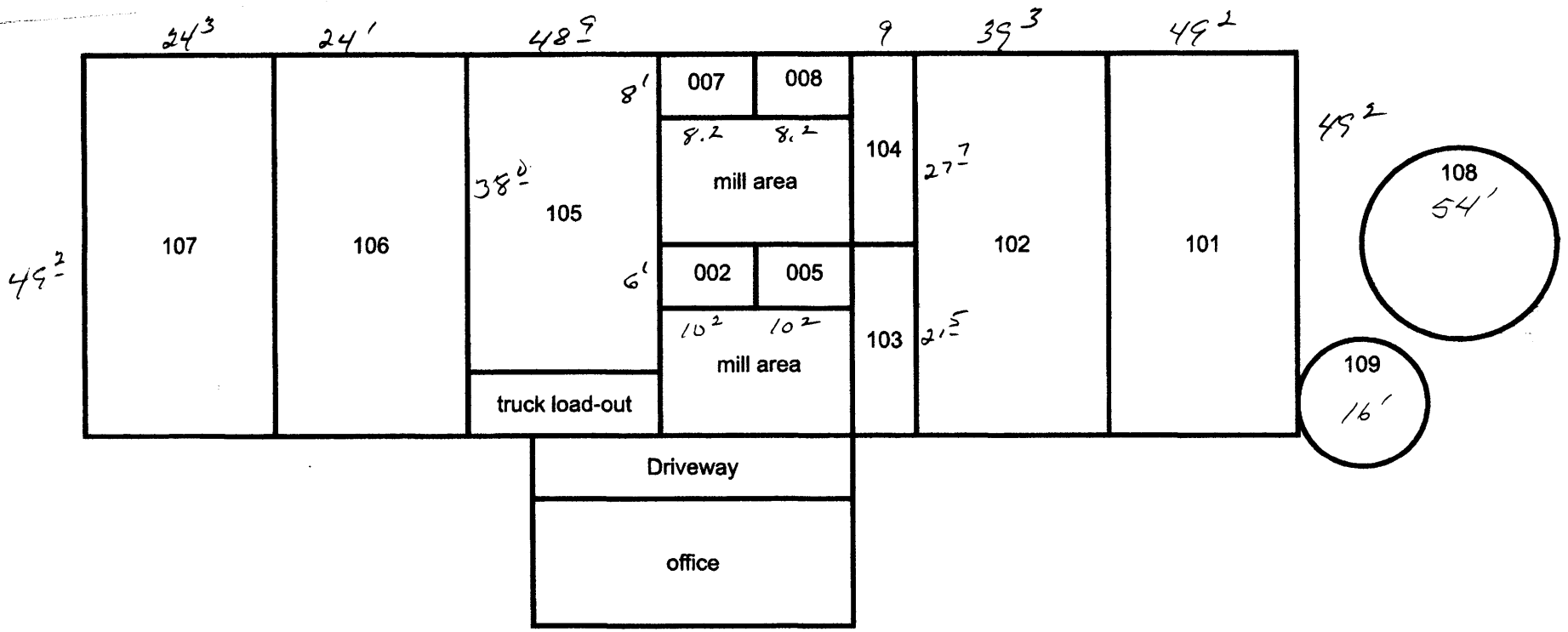

old Hwy 81

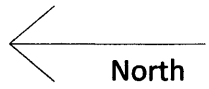

North Dakota Bean  
Grand Forks, ND  
Corp # 4385

