

Exam Date:04/23/2018

Alliance Valley Bean, LLC
 3729 Elevator Road
 Larimore, ND
 County: Grand Forks

Status	Section	Bin Number	Bin Type	Base Point	Diameter or Bu/Ft (Irreg.) Length	Width	Side wall	Add for Hopper	Ded. for Obst.	Effective Depth	Add for Peak	Depth for Capac.	Bushels per Foot	Base Pack%	Bushel Capacity with Pack
--------	---------	------------	----------	------------	---	-------	--------------	----------------------	----------------------	--------------------	--------------------	------------------------	------------------------	---------------	------------------------------

Facility: Larimore

Section: A

A	001	Peaked	eave at side wall		36.000	0.000	0.000	33.20	0.00	0.00	33.200	2.200	35.4	818.2	10.0	31,860
A	001-FB	Peaked	eave at side wall		14.000	0.000	0.000	30.00	2.00	0.00	32.000	0.800	32.8	123.7	5.50	4,280
A	002	Peaked	eave at side wall		36.000	0.000	0.000	33.20	0.00	0.00	33.200	2.200	35.4	818.2	10.0	31,860
A	002-FB	Peaked	eave at side wall		14.000	0.000	0.000	30.00	2.00	0.00	32.000	0.800	32.8	123.7	5.50	4,280
A	003	Peaked	eave at side wall		36.000	0.000	0.000	33.20	0.00	0.00	33.200	2.200	35.4	818.2	10.0	31,860
A	004	Peaked	eave at side wall		30.000	0.000	0.000	22.30	0.00	0.00	22.300	1.800	24.1	568.2	9.00	14,926
A	005	Peaked	eave at side wall		30.000	0.000	0.000	22.30	0.00	0.00	22.300	1.800	24.1	568.2	9.00	14,926
A	006	Peaked	eave at side wall		48.000	0.000	0.000	40.30	0.00	0.00	40.300	3.400	43.7	1454.6	10.0	69,923
A	009	Flat	bag storage		0.000	100.8	59.00	2.500	0.00	0.00	2.500	0.000	2.5	4780.7	10.0	13,147
A	010	Flat	overhead drag to floor 22.0'		0.000	237.4	59.00	8.100	0.00	0.00	8.100	0.000	8.1	11259.3	10.0	100,320
A	011	Peaked	eave at side wall		21.000	0.000	0.000	14.00	2.80	0.00	16.800	1.300	18.1	278.4	6.80	5,382
A	R1	Round	eave at side wall		12.000	0.000	0.000	12.40	2.00	0.00	14.400	0.000	14.4	90.9	5.00	1,374
A	R2	Round	eave at side wall		12.000	0.000	0.000	12.40	2.00	0.00	14.400	0.000	14.4	90.9	5.00	1,374

Bin count: 13

Facility: Larimore Section: A Total: 325,512

To Even: 326,000

Section: B

B	007	Peaked	eave at side wall		24.000	0.000	0.000	24.00	3.70	0.00	27.700	1.400	29.1	363.7	7.80	11,410
B	008	Peaked	eave at side wall		24.000	0.000	0.000	24.00	3.70	0.00	27.700	1.400	29.1	363.7	7.80	11,410
B	009	Peaked	eave at side wall		15.000	0.000	0.000	17.50	2.00	0.00	19.500	0.900	20.4	142.1	5.50	3,058
B	010	Peaked	eave at side wall		15.000	0.000	0.000	17.50	2.00	0.00	19.500	0.900	20.4	142.1	5.50	3,058

Client ID: 4016

NDPSC Bin Capacity Chart

06/28/2018 12:22:57 PM

Exam Date:04/23/2018

Alliance Valley Bean, LLC
3729 Elevator Road
Larimore , ND
County: Grand Forks

Page: 2

Examiner: 2

Status	Section	Bin Number	Bin Type	Base Point	Diameter or Bu/Ft (Irreg.)	Length	Width	Side wall	Add for Hopper	Ded. for Obst.	Effective Depth	Add for Peak	Depth for Capac.	Bushels per Foot	Base Pack%	Bushel Capacity with Pack
--------	---------	------------	----------	------------	-------------------------------	--------	-------	--------------	----------------------	----------------------	--------------------	--------------------	------------------------	------------------------	---------------	------------------------------

Facility: Larimore**Section: B**

B	012	Peaked	eave at side wall		15.000	0.000	0.000	17.50	2.00	0.00	19.500	0.900	20.4	142.1	5.50	3,058
B	013	Peaked	eave at side wall		48.000	0.000	0.000	40.30	0.00	0.00	40.300	3.400	43.7	1454.6	10.0	69,923
B	014	Peaked	eave at side wall		15.000	0.000	0.000	18.30	2.40	0.00	20.700	0.900	21.6	142.1	5.50	3,238
B	GSI	Peaked	eave at side wall		12.000	0.000	0.000	10.00	2.20	0.00	12.200	0.700	12.9	90.9	5.00	1,232

Bin count: 8

Facility: Larimore Section: B Total: **106,387**To Even: **107,000****Section: T**

Added	T	001	Quonset	B.Trosen quonset north of	0.000	100.0	80.00	7.100	0.00	0.00	7.100	0.000	7.1	6396.9	10.0	49,960
Added	T	002	Quonset	B.Trosen quonset north of	0.000	100.0	80.00	7.100	0.00	0.00	7.100	0.000	7.1	6396.9	10.0	49,960

Bin count: 2

Facility: Larimore Section: T Total: **99,920**To Even: **100,000**

Exam Date:04/23/2018

Alliance Valley Bean, LLC
 3729 Elevator Road
 Larimore , ND
 County: Grand Forks

Examiner: 2

Status	Section	Bin Number	Bin Type	Base Point	Diameter or Bu/Ft (Irreg).		Side wall	Add for Hopper	Ded. for Obst.	Effective Depth	Add for Peak	Depth for Capac.	Bushels per Foot	Base Pack%	Bushel Capacity with Pack
					Length	Width									

Facility: Sharon

Section: Bar

Added	Bar	032	Peaked	eave at side wall	16.000	0.000	0.000	15.00	2.50	0.00	17.500	1.000	18.5	161.6	5.80	3,163
Added	Bar	033	Peaked	eave at side wall	16.000	0.000	0.000	15.00	2.50	0.00	17.500	1.000	18.5	161.6	5.80	3,163
Added	Bar	041	Peaked	eave at side wall	16.000	0.000	0.000	20.00	2.50	0.00	22.500	1.000	23.5	161.6	5.80	4,018
Added	Bar	042	Peaked	eave at side wall	16.000	0.000	0.000	20.00	2.50	0.00	22.500	1.000	23.5	161.6	5.80	4,018
Added	Bar	043	Peaked	eave at side wall	16.000	0.000	0.000	20.00	2.50	0.00	22.500	1.000	23.5	161.6	5.80	4,018
Added	Bar	044	Peaked	eave at side wall	16.000	0.000	0.000	20.00	2.50	0.00	22.500	1.000	23.5	161.6	5.80	4,018
Added	Bar	045	Peaked	eave at side wall	16.000	0.000	0.000	20.00	2.50	0.00	22.500	1.000	23.5	161.6	5.80	4,018
Added	Bar	046	Peaked	eave at side wall	16.000	0.000	0.000	20.00	2.50	0.00	22.500	1.000	23.5	161.6	5.80	4,018

Bin count: 8

Facility: Sharon Section: Bar Total: **30,434**

To Even: **31,000**

Section: EDI

Added	EDI	503	Quonset	eave at side wall	0.000	99.00	40.00	14.00	0.00	0.00	14.000	0.000	14.0	2899.7	10.0	44,656
Added	EDI	601	Quonset	eave at side wall	0.000	99.00	40.00	10.00	0.00	0.00	10.000	0.000	10.0	3045.1	10.0	33,497

Bin count: 2

Facility: Sharon Section: EDI Total: **78,153**

To Even: **79,000**

Section: S

S	001	Peaked	eave at side wall	16.000	0.000	0.000	20.00	2.00	0.00	22.000	1.000	23.0	161.6	5.80	3,933
---	-----	--------	-------------------	--------	-------	-------	-------	------	------	--------	-------	------	-------	------	-------

Client ID: 4016

NDPSC Bin Capacity Chart

06/28/2018 12:22:57 PM

Exam Date:04/23/2018

Alliance Valley Bean, LLC
3729 Elevator Road
Larimore, ND
County: Grand Forks

Page: 4

Examiner: 2

Status	Section	Bin Number	Bin Type	Base Point	Diameter or Bu/Ft (Irreg.)	Length	Width	Side wall	Add for Hopper	Ded. for Obst.	Effective Depth	Add for Peak	Depth for Capac.	Bushels per Foot	Base Pack%	Bushel Capacity with Pack
--------	---------	------------	----------	------------	-------------------------------	--------	-------	--------------	----------------------	----------------------	--------------------	--------------------	------------------------	------------------------	---------------	------------------------------

Bin count: 1

Facility: Sharon Section: S Total: 3,933

To Even: 4,000

Overall Licensed Bin Capacity for:

Alliance Valley Bean, LLC

Bin count: 34

Licensed Capacity:

(includes pack)

644,339 Bu.

Licensed Capacity (to even):

(includes pack and section totals are rounded up to next highest 1000)

647,000 Bu.

Alliance Valley Bean #0416
Edinburg ND
Receiving Station
#503
PH 06-28-18

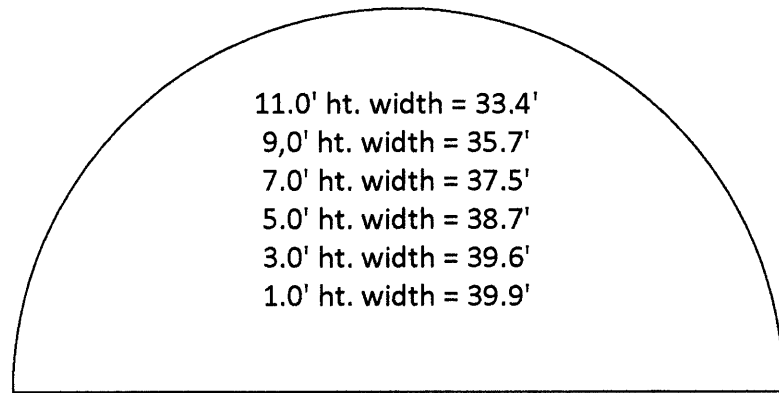

Inside 99.0'L x 40'W
Grain wall ht. door area 8.0'
Sidewall liner and north end
top of screen 15.25'
Bttm center overhead rafter
to floor 20.0'
Brace rod brackets top of to
floor sidewall 6.0' – back
wall 8.0'

Quonset located $\frac{3}{4}$ mile
south on hwy 32 – west side
of road

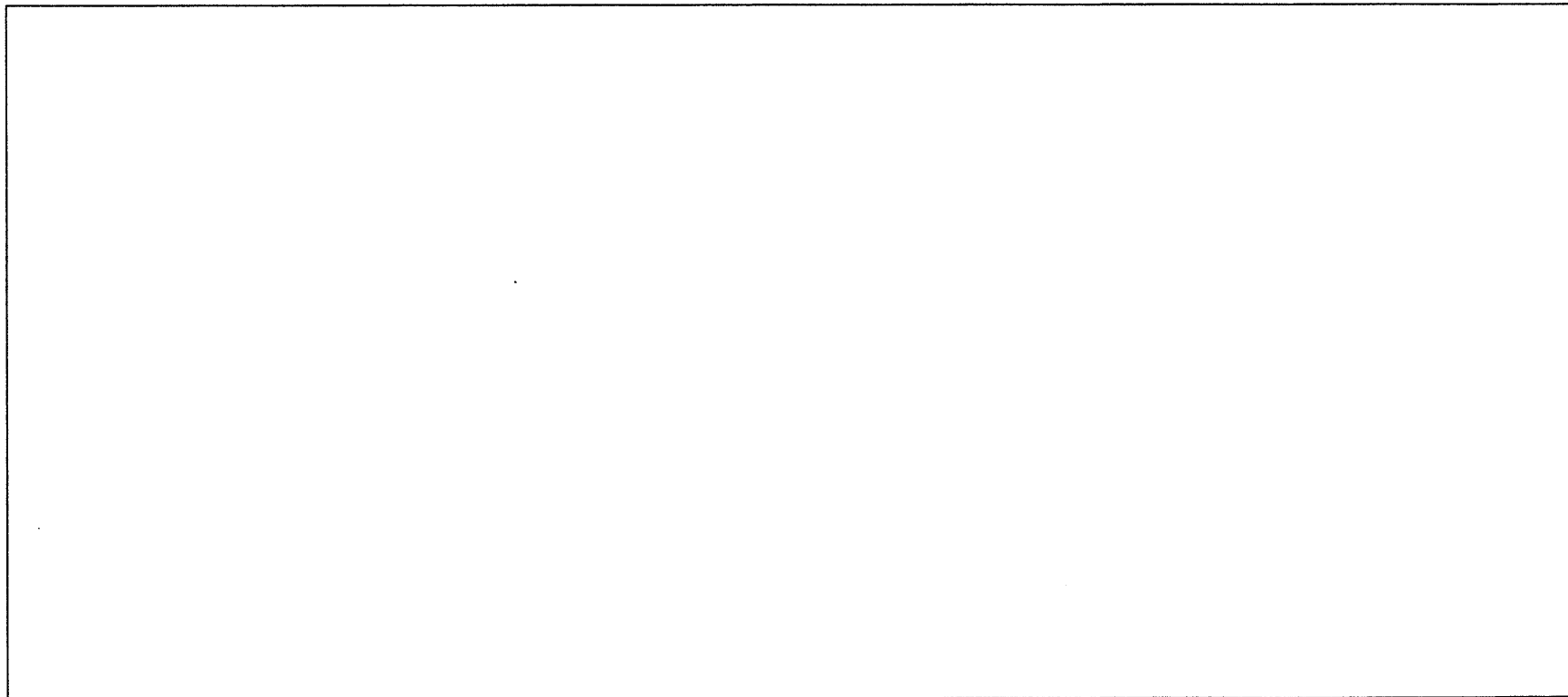

Alliance Valley Bean #0416
Edinburg ND
Section EDI #601
PH 06/28/18

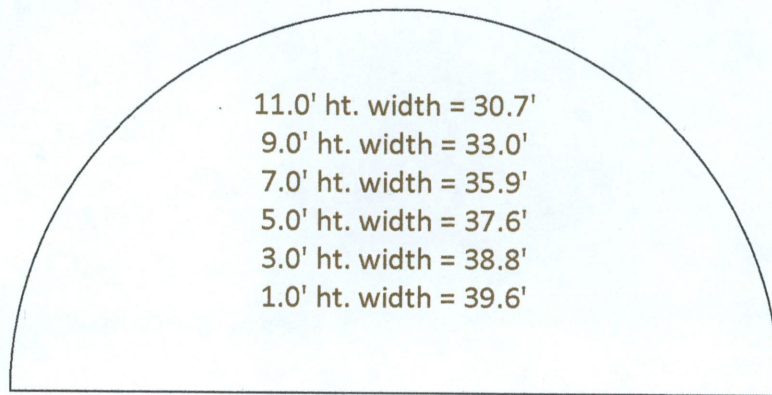

Inside 99.3'L x 40.0'W
Sidewall bolt row to floor 6.0'
Top of vertical sidewall brace
to floor 9.75'
Overhead horizontal brace
off center on each side top
of to floor 15.0'
Bttm overhead center
u-trough to floor 19.0'

Section E Jim's quonset is
east of 2 located 2 blocks
east of main elevator south
side of street

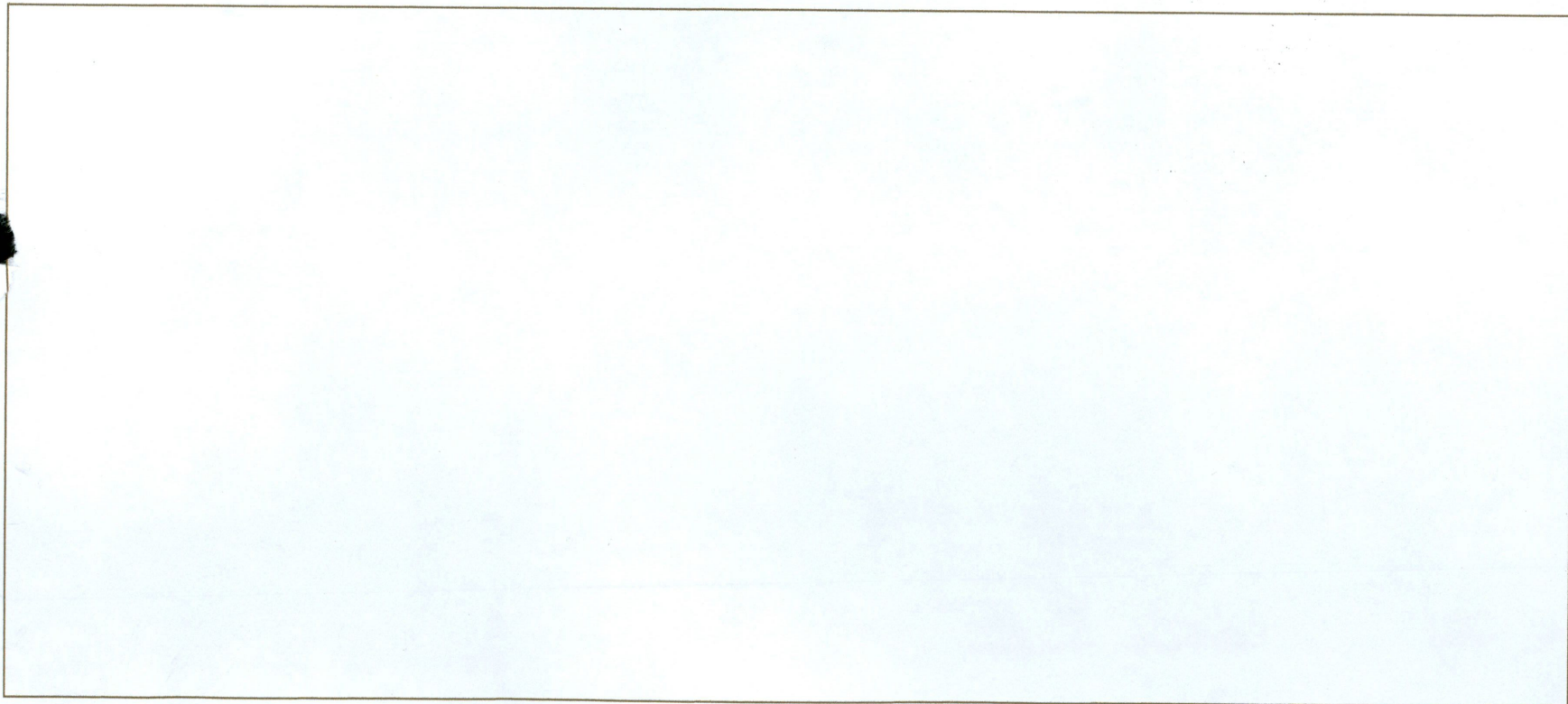

2012-01-04 11:52

17019938273

DAVE RAMSEY / PENNY EMAIL: EDBGFARSCO@POLAR.COMM.COM
 701-993-8421
 STEVE / SAM

EDINBURG FARMERS ELEV. CO.
 EDINBURG N.D.

Jan 04 12 10:16a

Edinburg Farmers Elev

17019938273

P.1

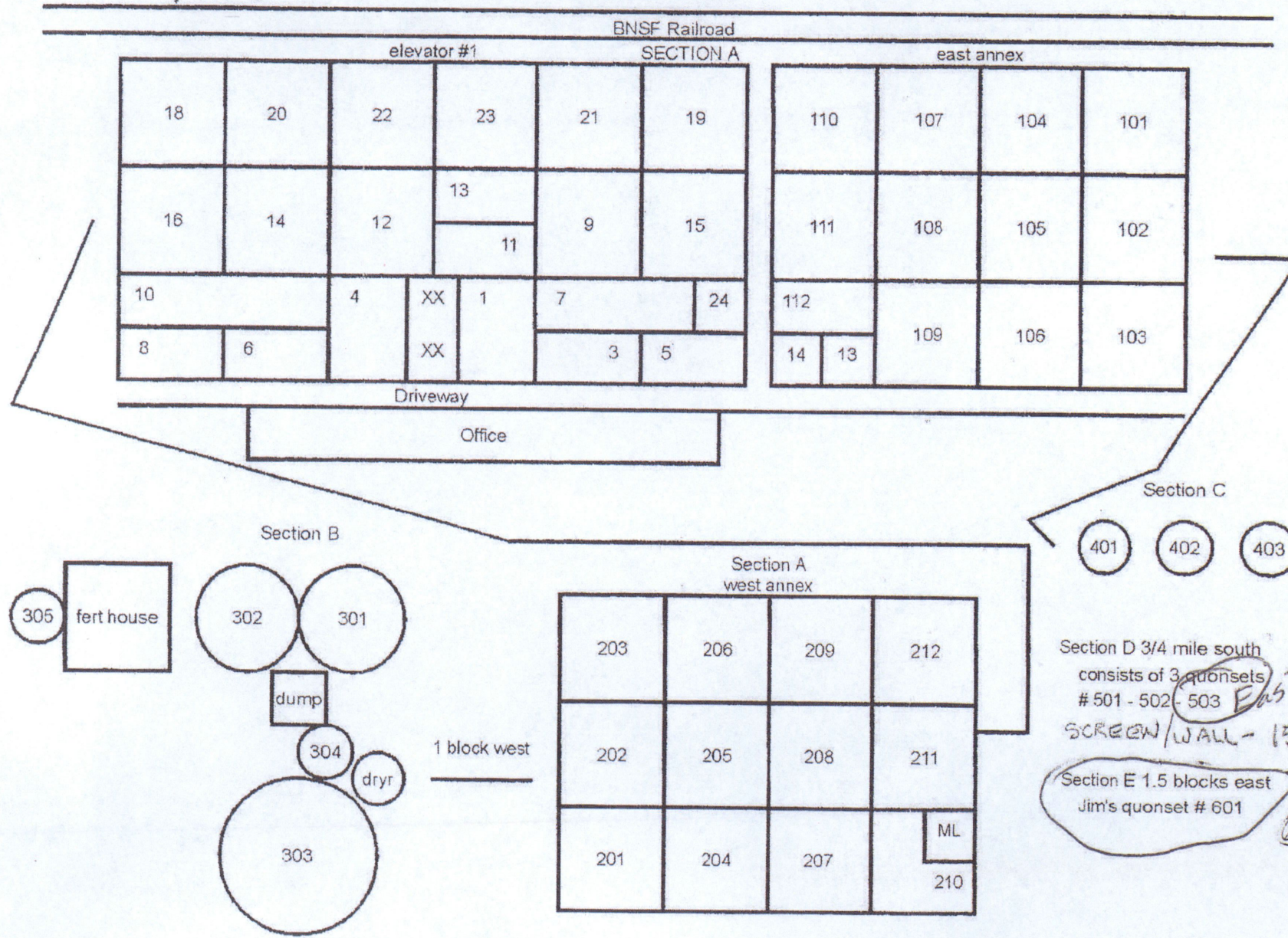

Section D 3/4 mile south
 consists of 3 quonsets
 # 501 - 502 - 503 *East quonset*
 SCREEN/WALL - 15.2
 Section E 1.5 blocks east
 Jim's quonset # 601 *(601)*