

Client ID: 3292

NDPSC Bin Capacity Chart

10/12/2017 10:03:57 AM

Exam Date:09/11/2017

Examiner: 2

Legume Matrix, LLC
PO Box 1028
Jamestown , ND
County:

Page: 1

Status	Section	Bin Number	Bin Type	Base Point	Diameter or Bu/Ft (Irreg).		Side wall	Add for Hopper	Ded. for Obst.	Effective Depth	Add for Peak	Depth for Capac.	Bushels per Foot	Base Pack%	Bushel Capacity with Pack
					Length	Width									

Facility: Jamestown

Section: A

A	001	Peaked	16.000	0.000	0.000	20.00	2.35	0.00	22.350	1.000	23.4	161.6	5.80	4,000
A	002	Peaked	16.000	0.000	0.000	20.00	2.35	0.00	22.350	1.000	23.4	161.6	5.80	4,000
A	003	Peaked	16.000	0.000	0.000	20.00	2.35	0.00	22.350	1.000	23.4	161.6	5.80	4,000
A	004	Peaked	16.000	0.000	0.000	20.00	2.35	0.00	22.350	1.000	23.4	161.6	5.80	4,000
A	005	Peaked	16.000	0.000	0.000	16.00	2.33	0.00	18.333	1.000	19.3	161.6	5.80	3,300
A	006	Peaked	16.000	0.000	0.000	16.00	2.33	0.00	18.333	1.000	19.3	161.6	5.80	3,300
A	007	Peaked	16.000	0.000	0.000	16.00	2.33	0.00	18.333	1.000	19.3	161.6	5.80	3,300
A	008	Peaked	16.000	0.000	0.000	20.00	2.35	0.00	22.350	1.000	23.4	161.6	5.80	4,000
A	016	Peaked	33.900	0.000	0.000	23.60	0.00	0.00	23.600	2.000	25.6	725.6	9.80	20,395
A	017	Peaked	33.900	0.000	0.000	23.60	0.00	0.00	23.600	2.000	25.6	725.6	9.80	20,395
A	100	Flat	0.000	30.00	26.00	4.000	0.00	0.00	4.000	0.000	4.0	627.0	9.20	2,739

Bin count: 11

Facility: Jamestown Section: A Total: 73,429

To Even: 74,000

Section: B

B	022	Peaked	16.000	0.000	0.000	25.00	2.35	0.00	27.350	1.000	28.4	161.6	5.80	4,855
B	023	Peaked	16.000	0.000	0.000	25.00	2.35	0.00	27.350	1.000	28.4	161.6	5.80	4,855
B	024	Peaked	16.000	0.000	0.000	25.00	2.35	0.00	27.350	1.000	28.4	161.6	5.80	4,855
B	026	Peaked	36.000	0.000	0.000	21.00	0.00	0.00	21.000	2.200	23.2	818.2	10.0	20,880
B	027	Peaked	36.000	0.000	0.000	21.00	0.00	0.00	21.000	2.200	23.2	818.2	10.0	20,880
B	028	Peaked	36.000	0.000	0.000	21.00	0.00	0.00	21.000	2.200	23.2	818.2	10.0	20,880

Exam Date:09/11/2017

Examiner: 2

Legume Matrix, LLC
 PO Box 1028
 Jamestown , ND
 County:

Status	Section	Bin Number	Bin Type	Base Point	Diameter or Bu/Ft (Irreg.)	Length	Width	Side wall	Add for Hopper	Ded. for Obst.	Effective Depth	Add for Peak	Depth for Capac.	Bushels per Foot	Base Pack%	Bushel Capacity with Pack
--------	---------	------------	----------	------------	-------------------------------	--------	-------	--------------	----------------------	----------------------	--------------------	--------------------	------------------------	------------------------	---------------	------------------------------

Facility: Jamestown

Section: B

B	029	Peaked			36.000	0.000	0.000	24.67	0.00	0.00	24.670	2.200	26.9	818.2	10.0	24,211
B	030	Peaked			36.000	0.000	0.000	24.67	0.00	0.00	24.670	2.200	26.9	818.2	10.0	24,211
B	031	Peaked			36.000	0.000	0.000	24.67	0.00	0.00	24.670	2.200	26.9	818.2	10.0	24,211
B	032	Peaked			36.000	0.000	0.000	24.67	0.00	0.00	24.670	2.200	26.9	818.2	10.0	24,211
B	033	Peaked			16.000	0.000	0.000	25.00	2.35	0.00	27.350	1.000	28.4	161.6	5.80	4,855
B	034	Peaked			16.000	0.000	0.000	25.00	2.35	0.00	27.350	1.000	28.4	161.6	5.80	4,855
B	035	Peaked			16.000	0.000	0.000	25.00	2.35	0.00	27.350	1.000	28.4	161.6	5.80	4,855
B	036	Peaked			36.000	0.000	0.000	28.33	0.00	0.00	28.330	2.200	30.5	818.2	10.0	27,451
B	041	Peaked			16.000	0.000	0.000	25.00	2.35	0.00	27.350	1.000	28.4	161.6	5.80	4,855
B	042	Peaked			16.000	0.000	0.000	25.00	2.35	0.00	27.350	1.000	28.4	161.6	5.80	4,855

Bin count: 16

Facility: Jamestown Section: B Total: 225,775

To Even: 226,000

Overall Licensed Bin Capacity for:

Legume Matrix, LLC

Bin count: 27

Licensed Capacity:
(includes pack)

299,204 Bu.

Licensed Capacity (to even):
(includes pack and section totals are rounded up to next highest 1000)

300,000 Bu.

Legume Matrix
Jamestown, ND
Section A

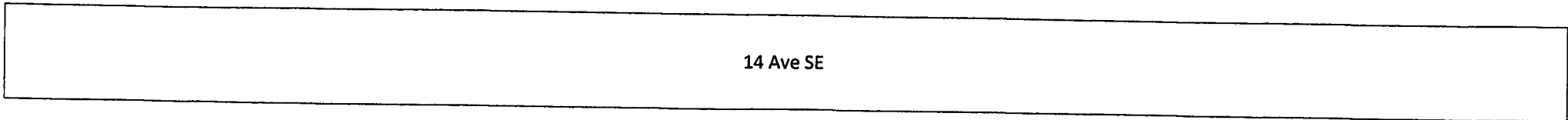
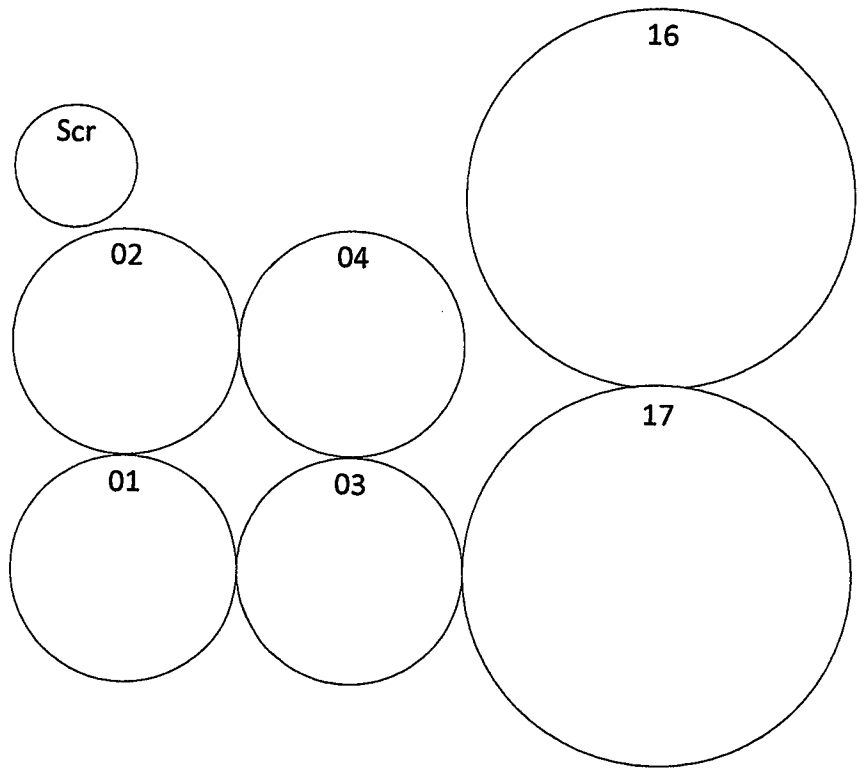
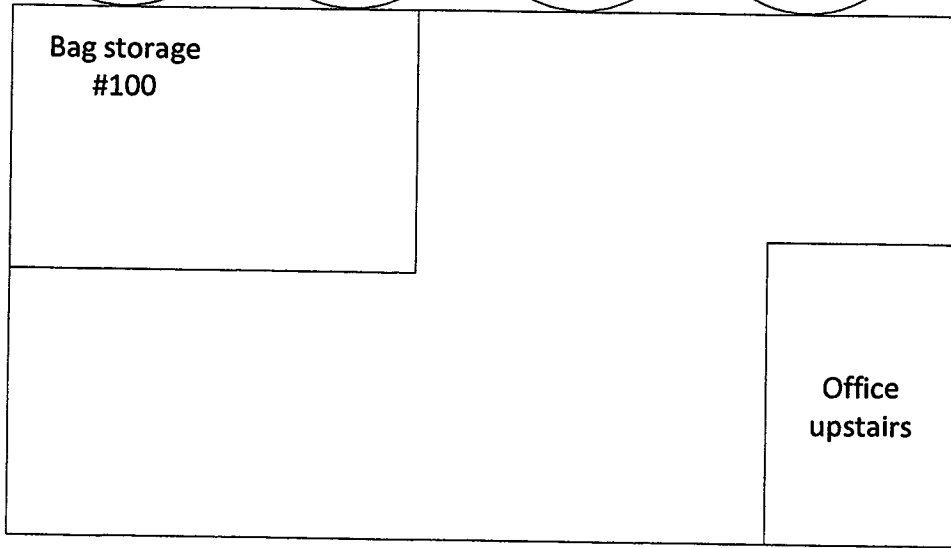
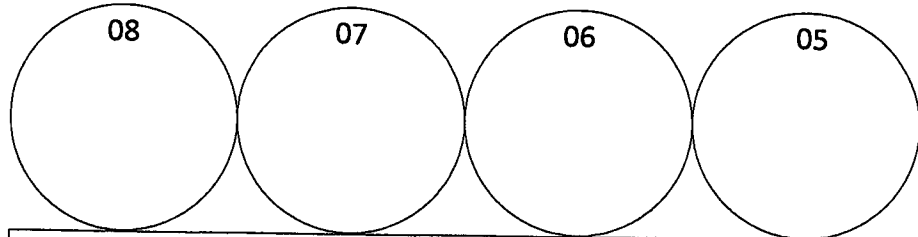
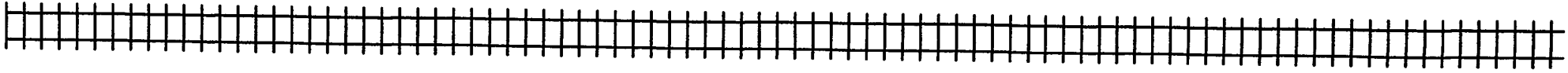

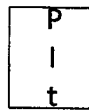
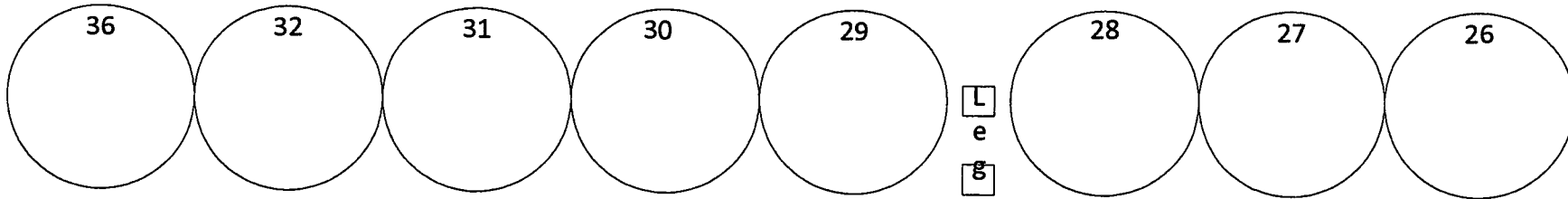
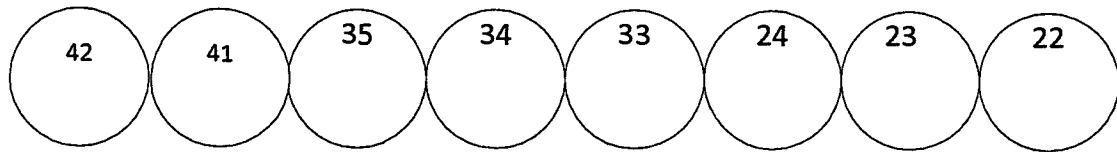

Legume Matrix
Jamestown, ND
Section B

East on 10th St SE
&
SE on 18th Ave SE

THESE ARE ALL NOT LICENSED AND USED FOR SEED OR SCREENINGS

