

Client ID: 2943

NDPSC Bin Capacity Chart

08/09/2012 08:28:32 AM

Exam Date:08/09/2012

St. Hilaire Seed Company, Inc.

Page: 5

Examiner: 1

~~PO Box 85~~
St. Hilaire, MN
County:

Status	Section	Bin Number	Bin Type	Base Point	Diameter or Bu/Ft (Irreg.)	Length	Width	Side wall	Add for Hopper	Ded. for Obst.	Effective Depth	Add for Peak	Depth for Capac.	Bushels per Foot	Base Pack%	Bushel Capacity with Pack
--------	---------	------------	----------	------------	----------------------------	--------	-------	-----------	----------------	----------------	-----------------	--------------	------------------	------------------	------------	---------------------------

Facility: Hamilton

Section: B



B	001	Peaked	top of sidewall		23.900	0.000	0.000	16.00	0.00	0.00	16.000	1.400	17.4	360.6	7.80	6,763
B	002	Peaked	top of sidewall		23.900	0.000	0.000	16.00	0.00	0.00	16.000	1.400	17.4	360.6	7.80	6,763
B	003	Peaked	top of sidewall		23.900	0.000	0.000	16.00	0.00	0.00	16.000	1.400	17.4	360.6	7.80	6,763
B	004	Peaked	top of sidewall		23.900	0.000	0.000	16.00	0.00	0.00	16.000	1.400	17.4	360.6	7.80	6,763
B	005	Peaked	top of sidewall		23.900	0.000	0.000	17.50	0.00	0.00	17.500	1.400	18.9	360.6	7.80	7,347
B	006	Peaked	top of sidewall		23.900	0.000	0.000	17.50	0.00	0.00	17.500	1.400	18.9	360.6	7.80	7,347
B	007	Peaked	top of sidewall		23.900	0.000	0.000	17.50	0.00	0.00	17.500	1.400	18.9	360.6	7.80	7,347
B	008	Peaked	top of sidewall		23.900	0.000	0.000	16.00	0.00	0.00	16.000	1.400	17.4	360.6	7.80	6,763
B	009	Peaked	top of sidewall		23.900	0.000	0.000	16.00	0.00	0.00	16.000	1.400	17.4	360.6	7.80	6,763
B	010	Peaked	top of sidewall		23.900	0.000	0.000	16.00	0.00	0.00	16.000	1.400	17.4	360.6	7.80	6,763
B	011	Peaked	top of sidewall		23.900	0.000	0.000	16.00	0.00	0.00	16.000	1.400	17.4	360.6	7.80	6,763
B	012	Peaked	top of sidewall		23.900	0.000	0.000	16.00	0.00	0.00	16.000	1.400	17.4	360.6	7.80	6,763
B	013	Peaked	top of sidewall		23.900	0.000	0.000	14.75	0.00	0.00	14.750	1.400	16.2	360.6	7.80	6,298
B	014	Peaked	top of sidewall		23.900	0.000	0.000	16.00	0.00	0.00	16.000	1.400	17.4	360.6	7.80	6,763
B	016	Peaked	eave at top of sidewall		16.000	0.000	0.000	20.00	2.00	0.00	22.000	1.000	23.0	161.6	5.80	3,933
B	017	Peaked	eave at top of sidewall		16.000	0.000	0.000	20.00	2.00	0.00	22.000	1.000	23.0	161.6	5.80	3,933
B	018	Peaked	eave at top of sidewall		16.000	0.000	0.000	20.00	2.00	0.00	22.000	1.000	23.0	161.6	5.80	3,933
B	019	Peaked	eave at top of sidewall		16.000	0.000	0.000	20.00	2.00	0.00	22.000	1.000	23.0	161.6	5.80	3,933
B	020	Peaked	eave at top of sidewall		16.000	0.000	0.000	20.00	2.00	0.00	22.000	1.000	23.0	161.6	5.80	3,933
B	021	Peaked	eave at top of sidewall		16.000	0.000	0.000	20.00	2.00	0.00	22.000	1.000	23.0	161.6	5.80	3,933
B	100	Flat	grain wall ht. 7.5' bttm drag		0.000	58.70	139.2	9.250	0.00	0.00	9.250	0.000	9.3	6568.4	10.0	67,195

NO

Client ID: 2943

NDPSC Bin Capacity Chart

08/09/2012 08:28:32 AM

Exam Date: 08/09/2012

~~St. Hilaire Seed Company, Inc.~~

Page: 6

Examiner: 1

~~PO Box 85~~

~~St. Hilaire, MN~~

County:

Status	Section	Bin Number	Bin Type	Base Point	Diameter or Bu/Ft (Irreg.)	Length	Width	Side wall	Add for Hopper	Ded. for Obst.	Effective Depth	Add for Peak	Depth for Capac.	Bushels per Foot	Base Pack%	Bushel Capacity with Pack
--------	---------	------------	----------	------------	-------------------------------	--------	-------	--------------	----------------------	----------------------	--------------------	--------------------	------------------------	------------------------	---------------	------------------------------

Bin count: 21

Facility: Hamilton Section: B Total: 186,762

To Even: 187,000

Overall Licensed Bin Capacity for:	Licensed Capacity:	1,850,488 Bu.
St. Hilaire Seed Company, Inc.	(includes pack)	
Bin count: 49	Licensed Capacity (to even):	1,853,000 Bu.
	(includes pack and section totals are rounded up to next highest 1000)	

TOTAL 119,567 bu



ST. HILAIRE SEED CO. INC.

Hamilton Receiving site located 7 miles east of Glaston- 1 mile north - 1/2 mile east

Section B

Licensed by St. Hilaire
 hopper tanks 101 thru 108
 flat warehouse #100

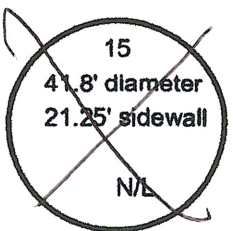
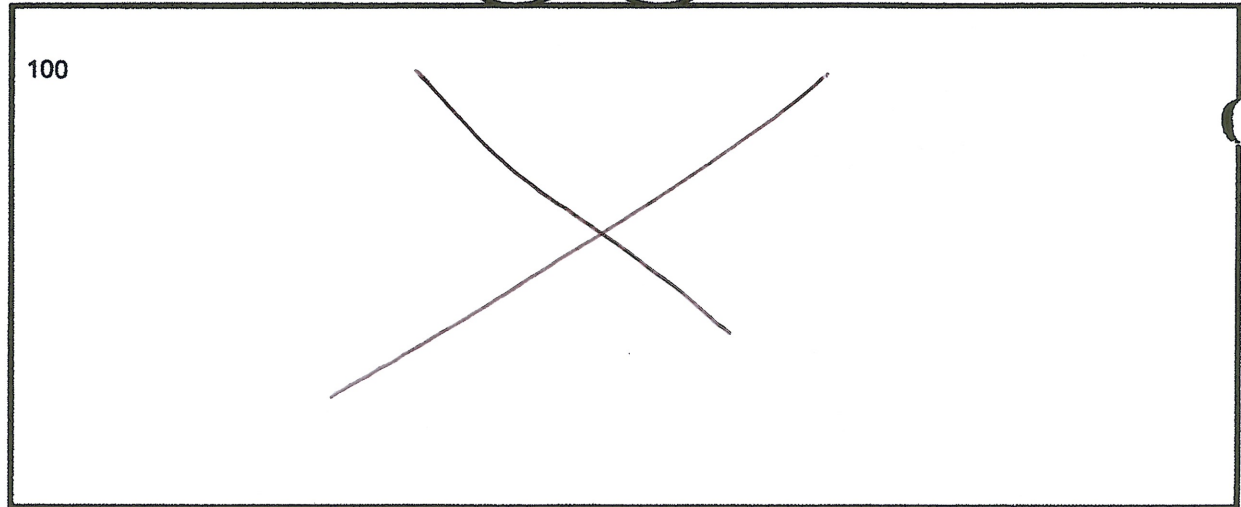
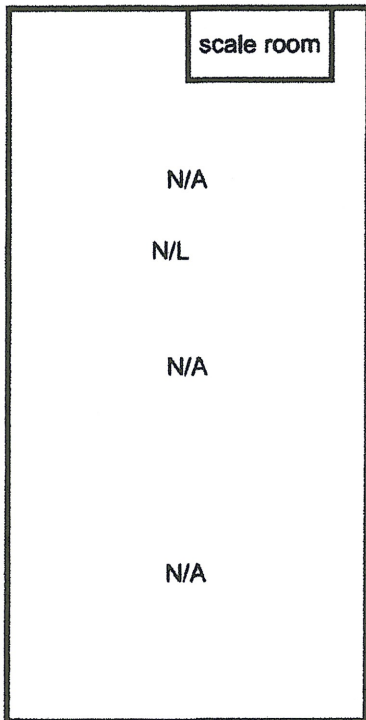
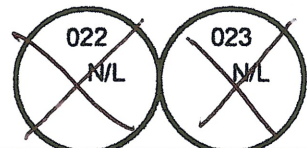
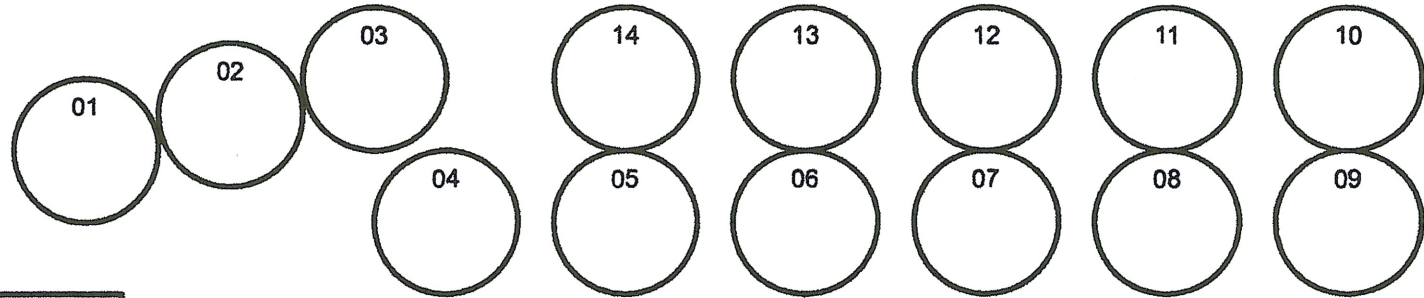

Flat 100- 58.7' W x 139.2' L
 grain wall ht. 7.5'
 bottom center drag to floor 18.75'
 rafters & main sidewall beam 20' on center

tanks #1-2-3-4-8-9-10-11-12-14-- 23.9' diameter, 16' sidewall -6,763 bu. capacity
 tanks #5-6-7 -- 23.9' diameter , 17.5' sidewall - 7,347 bu. capacity
 tank # 13 - 23.9' diameter, 14.75' sidewall - 6,298 bu. capacity
 Hopper tanks- 16' dia - 20' sidewall - 6' hopper

