



UTILITIES CO.

A Division of MDU Resources Group, Inc.

400 North Fourth Street

Bismarck, ND 58501

(701) 222-7900

October 5, 2016

Executive Secretary  
North Dakota Public Service Commission  
State Capitol – Department 408  
600 East Boulevard Avenue  
Bismarck, ND 58505-0480

RE: Case No. PU-16-618  
Application for Permanent Authority to  
Extend Service to Philip Porter at  
Dawson, North Dakota

Montana-Dakota Utilities Co. (Montana Dakota), a Division of MDU Resources Group, Inc., herewith respectfully submits an original and one copy of an Application for Permanent Authority to extend electric service to Philip Porter at a location in the NE ¼ of Section 15, Township 139N, Range 72W, Kidder County, North Dakota.

Please acknowledge receipt by stamping or initialing the duplicate copy of this letter attached hereto and returning the same in the enclosed self-addressed, stamped envelope.

Sincerely,

A handwritten signature in purple ink that reads 'Tamie A. Aberle'.

Tamie A. Aberle  
Director of Regulatory Affairs

Enclosures

cc/enc.

KEM Electric Cooperative, Inc.  
Doug Wiseman – Bismarck Office

**BEFORE THE PUBLIC SERVICE COMMISSION  
OF THE STATE OF NORTH DAKOTA**

In the Matter of the Application )  
of MONTANA-DAKOTA UTILITIES CO., )  
a Division of MDU Resources Group, )  
Inc., for an Order and Certificate to )  
Extend Service to Philip Porter )  
at Dawson, North Dakota )

Case No. PU-16-618

**APPLICATION FOR PERMANENT AUTHORITY**

MONTANA-DAKOTA UTILITIES CO., for its Application to the Public Service Commission of North Dakota, respectfully alleges:

I.

The full name of Applicant is Montana-Dakota Utilities Co., a Division of MDU Resources Group, Inc., and the post office address of its principal office is 400 North Fourth Street, Bismarck, North Dakota 58501. Applicant is a public utility subject to the jurisdiction of and regulation by the Public Service Commission of North Dakota, under Title 49, N.D.C.C., as amended. MDU Resources Group, Inc.'s Certificate of Incorporation is incorporated herein by reference, and the Commission is requested to take official notice of the same.

II.

This Application is made pursuant to the provisions of Chapter 49-03, N.D.C.C., as amended, and the Rules of Practice and Procedure promulgated by the Commission.

III.

Application has been requested by Philip Porter, hereinafter referred to as "Customer," to provide electric service to him at a point located in the NE ¼ of Section 15,

Township 139N, Range 72W, Kidder County, North Dakota as shown on the map attached hereto, marked Exhibit A, and made a part hereof by reference. Customer will need electric service in October 2016. Correspondence to the Customer should be directed to:

Philip Porter  
220 SW 5<sup>th</sup> Ave  
Steele, ND 58482

IV.

The service required by Customer at said location is three phase service, and the length of the extension will be approximately 1175 feet, as shown by Exhibit A. The location of the proposed service is within the economic service area of Applicant and service will be extended under the provisions of the rules and regulations applicable thereto. It is Applicant's public utility obligation to furnish the requested service, and the public convenience and necessity requires, and will be served by, Applicant furnishing the requested service to this Customer at said location. The Temporary Authority Permit is attached as Exhibit B.

V.

Submitted as Exhibit C with this Application is an Appearance by Customer herein, in which Customer states to the Commission that he desires electric service from Applicant as a public utility subject to the jurisdiction of, and regulation by, this Commission. In said Appearance, Customer also waives Notice of Opportunity for Hearing and Notice of Hearing upon this Application, or a hearing thereon, and requests the Commission to issue an Order and Certificate of Public Convenience and Necessity authorizing this requested and needed service.



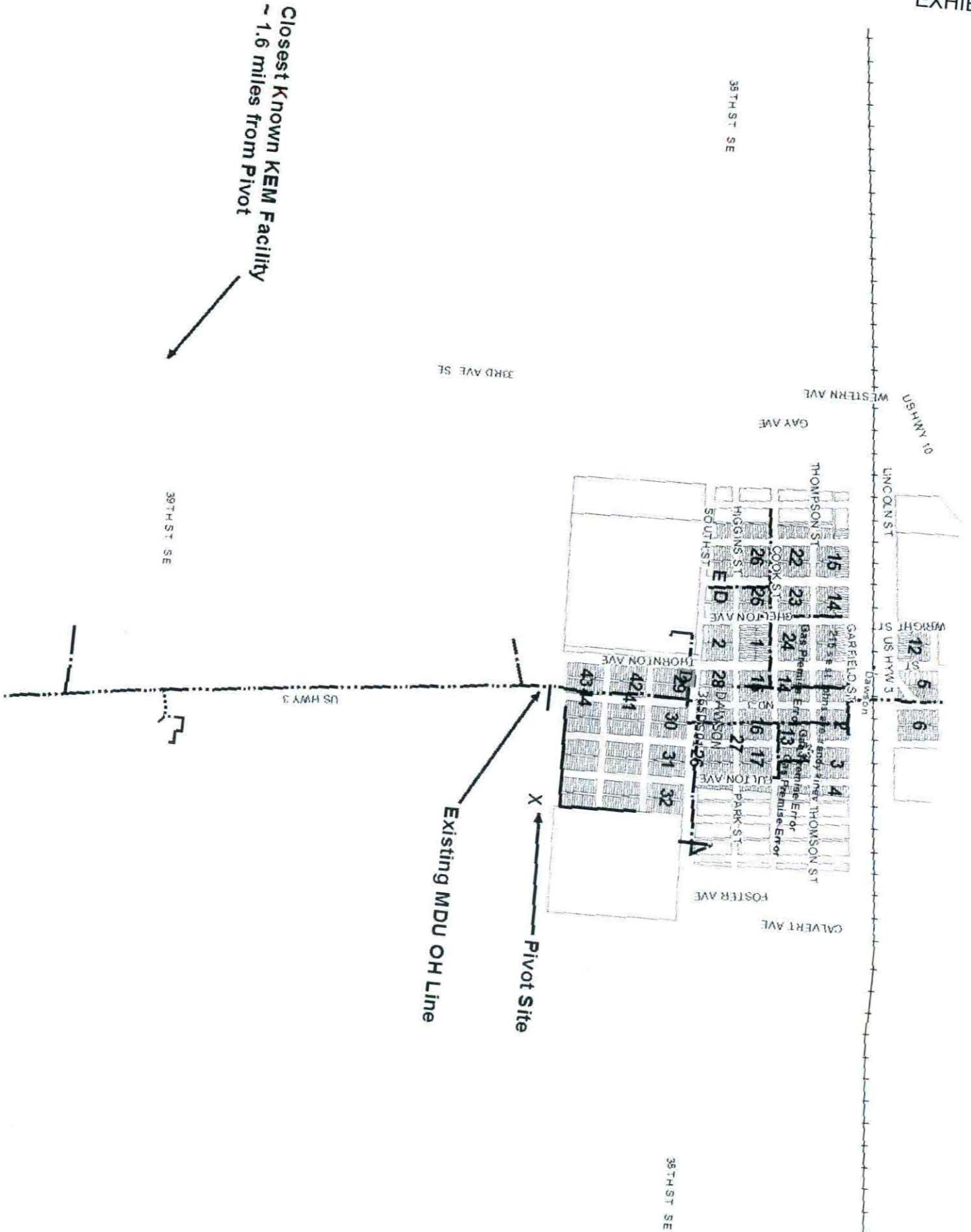

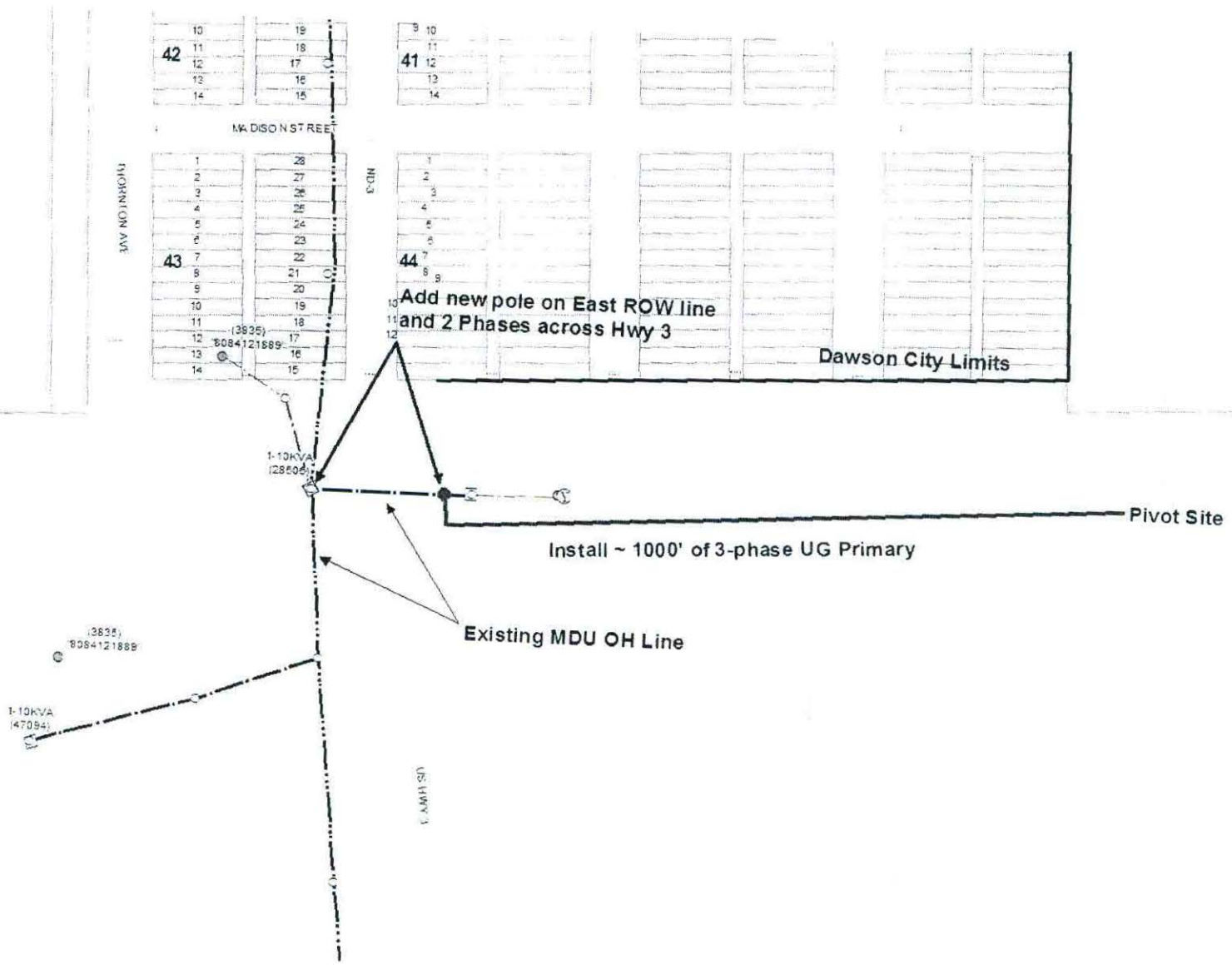



**TEMPORARY AUTHORITY PERMIT**  
 NORTH DAKOTA PUBLIC SERVICE COMMISSION  
 PUBLIC UTILITIES  
 SFN 50560 (6-96)

F EXHIBIT B  
 AL

ND Public Service Commission

Date 08/25/16	Time 12:00	<input type="checkbox"/> a.m. <input checked="" type="checkbox"/> p.m.	Name of Utility Montana-Dakota Utilities Co.	Telephone Number 701 224-5837
Name of Person Calling Doug Wiseman			Name of Coop Serving KEM	
Name of Customer Philip Porter		Location Sec NE15 Twp 139N R 72W		
Address SOUTH OF DAWSON, ND			County KIDDER	
City DAWSON			State ND	Zip Code 58428
Name of Nearest City DAWSON			Distance to the City 200 FEET SOUTH OF CITY LIMITS	
When will service be extended? SEPTEMBER 2016		Type of Service <input type="checkbox"/> Residence <input type="checkbox"/> Storage <input type="checkbox"/> Grain Bin <input checked="" type="checkbox"/> Other <u>IRRIGATION PIVOT</u>		
Extension Length to Most Economical Point of Service Utility: 1175 feet Coop: est.1.5 miles		Extension <input type="checkbox"/> Overhead <input checked="" type="checkbox"/> Underground		
Has customer signed request for service? <input checked="" type="checkbox"/> Yes <input type="checkbox"/> No		Will cooperative protest application? <input type="checkbox"/> Yes <input type="checkbox"/> No		
Name of Person Contacted (PSC Use) <i>D. Franklund/C. Baumgartner via e-mail on</i>		Date of Contact (PSC Use) 08/26/2016 at 1:55 pm no response as of	Time (PSC Use) <input type="checkbox"/> a.m. <input type="checkbox"/> p.m. 09/29/2016	
Estimated Cost of Extension \$29,500		Estimated Revenue \$2,500 ANNUAL		
Under what rate filed with the Public Service Commission will customer be served? RATE 25				
Will extension cross over coop lines? <input type="checkbox"/> Yes <input checked="" type="checkbox"/> No		Will extension cross over railroad tracks? <input type="checkbox"/> Yes <input checked="" type="checkbox"/> No		
Temporary Authority Authorized By <input type="checkbox"/> Telephone <input type="checkbox"/> Letter		Date Authorized 9-30-2016		
Authorized By (Name of Commissioner) <i>[Signature]</i>				

Extension must be made from most economical point of service.

**Comments:**

WE WILL ADD 2 PHASES TO EXISTING 1-PHASE SPAN ACROSS HWY 3 TO NEW POLE SET ON EAST HWY 3 ROW LINE, THEN TRANSITION TO 3-PHASE UG PRIMARY RUNNING EAST FOR ~1000 FEET TO PADMOUNT TRANSFORMER SUPPLYING 3-PHASE 480 VOLT SERVICE TO PIVOT.

THE CUSTOMER, PHILIP PORTER WILL CONTRIBUTE \$24,500 TOWARDS COST OF CONSTRUCTION...ESTIMATED CONSTRUCTION COST LESS 2 YEAR REVENUE.

*Note: E-mail was sent to the Co-Managers of KEM listed above on 8/26/2016 and as of 9/29/2016 have not received a response. I called the office at KEM on Friday, 9/23/2016 and talked to Dawn and she asked me to forward the e-mail to her and she would get it to them and ask them to respond. No response has been received as of today 9/30/2016. Geri PSC Public Utilities Division*

BEFORE THE PUBLIC SERVICE COMMISSION  
OF THE STATE OF NORTH DAKOTA

In the Matter of the Application of  
Montana-Dakota Utilities Co.,  
a Division of MDU Resources Group, Inc.

Case No. \_\_\_\_\_

**APPEARANCE BY CUSTOMER**

Phillip Porter

---

hereinafter referred to as "Customer", hereby makes a voluntary appearance in this matter and states the following to the Commission:

I.

That he (it) desires electric service from Montana-Dakota Utilities Co. as a public utility subject to the jurisdiction of, and regulation by, this Commission, and has requested said public utility to provide him (it) with immediate electric service at the point located as stated in the Application herein.

That customer further states that he (it) is in need of and has demanded immediate service at said location for the reasons set forth in the Application herein. Customer waives notice of opportunity for hearing and notice of hearing upon said Application, or a hearing thereon, and requests the Commission to issue an Order and Certificate of Public Convenience and Necessity authorizing this requested and needed service, and that provisions be made therein authorizing extension of immediate service.

II.

That all the allegations of the Application herein are true and correct.

WHEREFORE, the undersigned, being the Customer involved herein, prays for the entry of an Order and Certificate of Public Convenience and Necessity by the Commission, authorizing the Applicant to immediately extend the requested and needed service to Customer at said location, subject to such appropriate and proper conditions to be appended to and made a part of such Temporary Order and Certificate as the Commission may determine, said Temporary Order and Certificate to become final as may be set forth in the conditions appended thereto; and for such other and further relief as may be proper in the premises.

Dated: 8-18-16

  
\_\_\_\_\_  
(Customer)