

Brian R. Bjella
100 West Broadway, Suite 250
P.O. Box 2798
Bismarck, ND 58502-2798
701.223.6585
bbjella@crowleyfleck.com

October 9, 2017

Mr. Darrell Nitschke
Executive Director
North Dakota Public Service Commission
600 E. Boulevard, Dept. 408
Bismarck, ND 58505-0480



Dear Mr. Nitschke:

In re: Cenex Pipeline, LLC
Case No. PU-17-097
Late Filed Exhibit No. 22
Our File No. 020836-000001

Enclosed for filing are 11 copies of Late Filed Exhibit No. 22 –Type and Location of Mainline Valves for the above matter. Also being filed is a Certificate of Service relating to the report.

Very truly yours,

A handwritten signature in blue ink, appearing to be "BR Bjella", written over a horizontal line.

Brian R. Bjella

bw
enc.
cc: Administrative Judge Timothy J. Dawson (w/enc)
Derrick Braaten (w/enc)
Zachary Pelham (w/enc)
Kevin Pranis (w/enc)

86 **PU-17-97** Filed: 10/9/2017 Pages: 7
Late filed Exhibit 22 - Type and location of mainline valves

**STATE OF NORTH DAKOTA
PUBLIC SERVICE COMMISSION**

**Cenex Pipeline, LLC
10" Refined Fuels Pipeline – Williams, Mountrail, Ward
Siting Application**

PU-17-097

CERTIFICATE OF SERVICE

I hereby certify that on October 9, 2017, the following document:

1. Late Filed Exhibit No. 22 – Type and Location of Mainline Valves

was served via U.S. mail and e-mail upon the following:

Derrick Braaten
Baumstark Braaten Law Partners
109 North 4th St., Suite 100
Bismarck, ND 58501-4003
derrick@baumstarkbraaten.com

Zachary Pelham
Special Assistant Attorney General
PO Box 400
Bismarck, ND 58502-0400
On behalf of the PSC
zep@pearce-durick.com

Timothy J. Dawson
Administrative Law Judge
Office of Administrative Hearings
2911 North 4th Street, Suite 303
Bismarck, ND 58503
tjdawson@nd.gov

Kevin Pranis
Laborers District Council
81 E. Little Canada Road
St. Paul, MN 55117
kpranis@liunagroc.com

Dated this 9th day of October, 2017.

CROWLEY FLECK PLLP
Attorneys for Cenex Pipeline, LLC
100 West Broadway, Suite 250
P.O. Box 2798
Bismarck, North Dakota 58502
(701) 223-6586

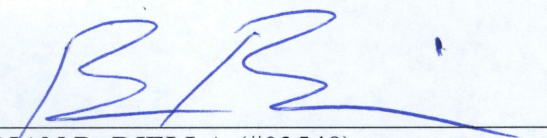
By 
BRIAN R. BJELLA (#03549)

Cenex Pipeline, LLC
Cenex Pipeline Replacement Sidney, MT to Minot, ND

Block Valve ID #	County	Type	Section	Township	Range	Lat.	Long.
1	Ward	Manual Block Valve	20	T155N	R83W	48° 13' 39.986" N	-101° 22' 1.967" W
2	Ward	Motor Operated Valve	1	T154N	R85W	48° 11' 9.870" N	-101° 33' 18.299" W
3	Mountrail	Manual Block and Check Valve	29	T155N	R88W	48° 12' 45.835" N	-102° 1' 47.781" W
4	Mountrail	Manual Block Valve	30	T155N	R89W	48° 13' 3.390" N	-102° 9' 38.408" W
5	Mountrail	Manual Block and Check Valve	28	T155N	R91W	48° 12' 41.568" N	-102° 23' 45.715" W
6	Mountrail	Motor Operated Valve	32	T155N	R91W	48° 12' 38.477" N	-102° 25' 5.288" W
7	Mountrail	Manual Block and Check Valve	35	T155N	R94W	48° 12' 39.275" N	-102° 43' 42.009" W
8	Mountrail	Motor Operated Valve	17	T155N	R94W	48° 14' 27.842" N	-102° 48' 14.796" W
9	Williams	Manual Block and Check Valve	32	T156N	R96W	48° 17' 31.299" N	-103° 2' 48.419" W
10	Williams	Motor Operated Valve	28	T156N	R97W	48° 17' 57.430" N	-103° 9' 10.611" W
11	Williams	Manual Block and Check Valve	5	T155N	R100W	48° 16' 48.122" N	-103° 33' 44.604" W
12	Williams	Motor Operated Valve	6	T155N	R100W	48° 16' 13.991" N	-103° 35' 44.030" W
13	Williams	Manual Block Valve	6	T154N	R102W	48° 11' 5.156" N	-103° 50' 31.394" W

Cenex Pipeline, LLC Cenex Pipeline Replacement Sidney, MT to Minot, ND

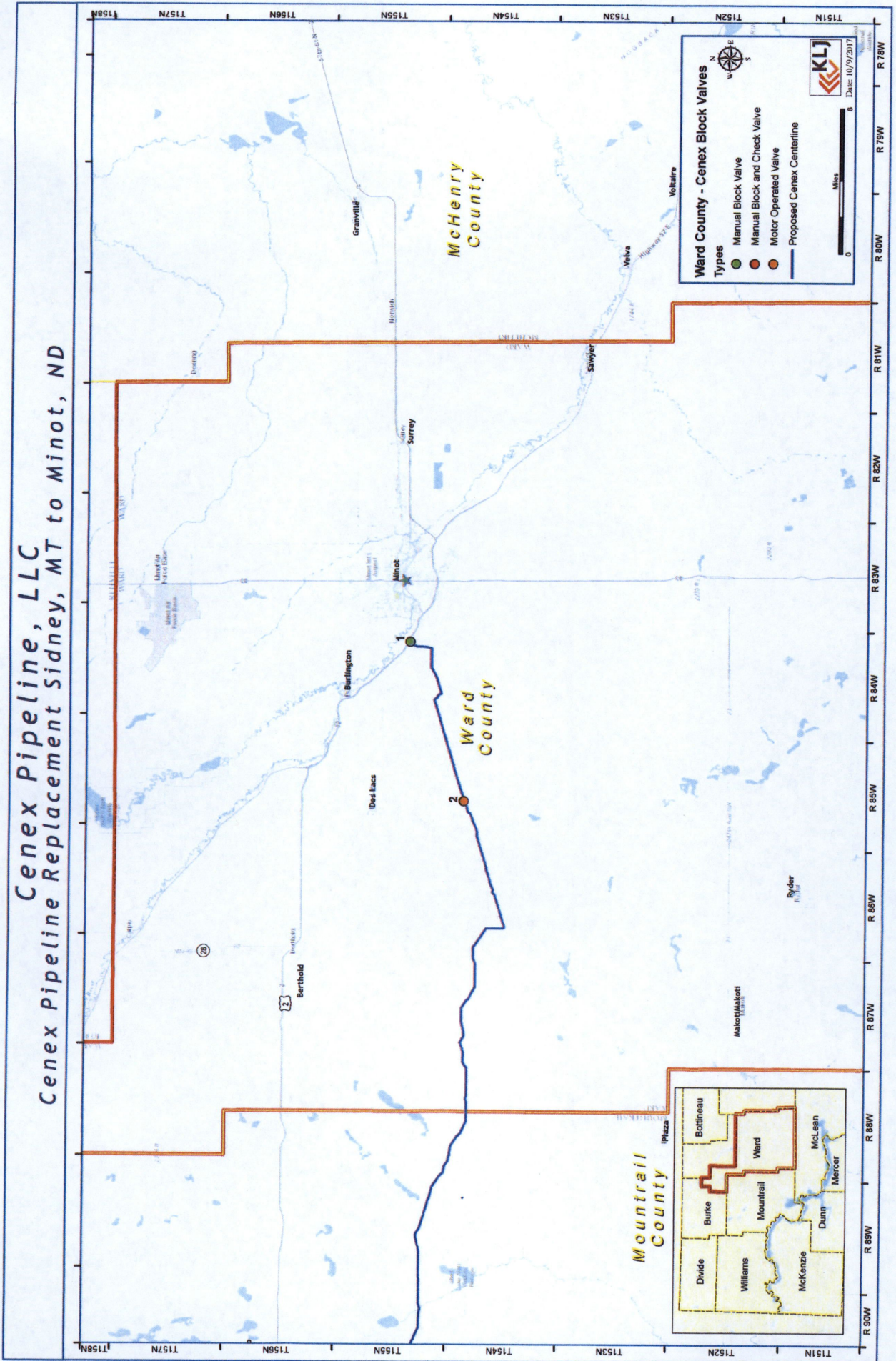

Ward County - Cenex Block Valves

Types

- Manual Block Valve
- Manual Block and Check Valve
- Motor Operated Valve
- Proposed Cenex Centerline

Scale: 0 to 8 Miles
Date: 10/9/2017
Logo: KLI



Cenex Pipeline, LLC Cenex Pipeline Replacement Sidney, MT to Minot, ND

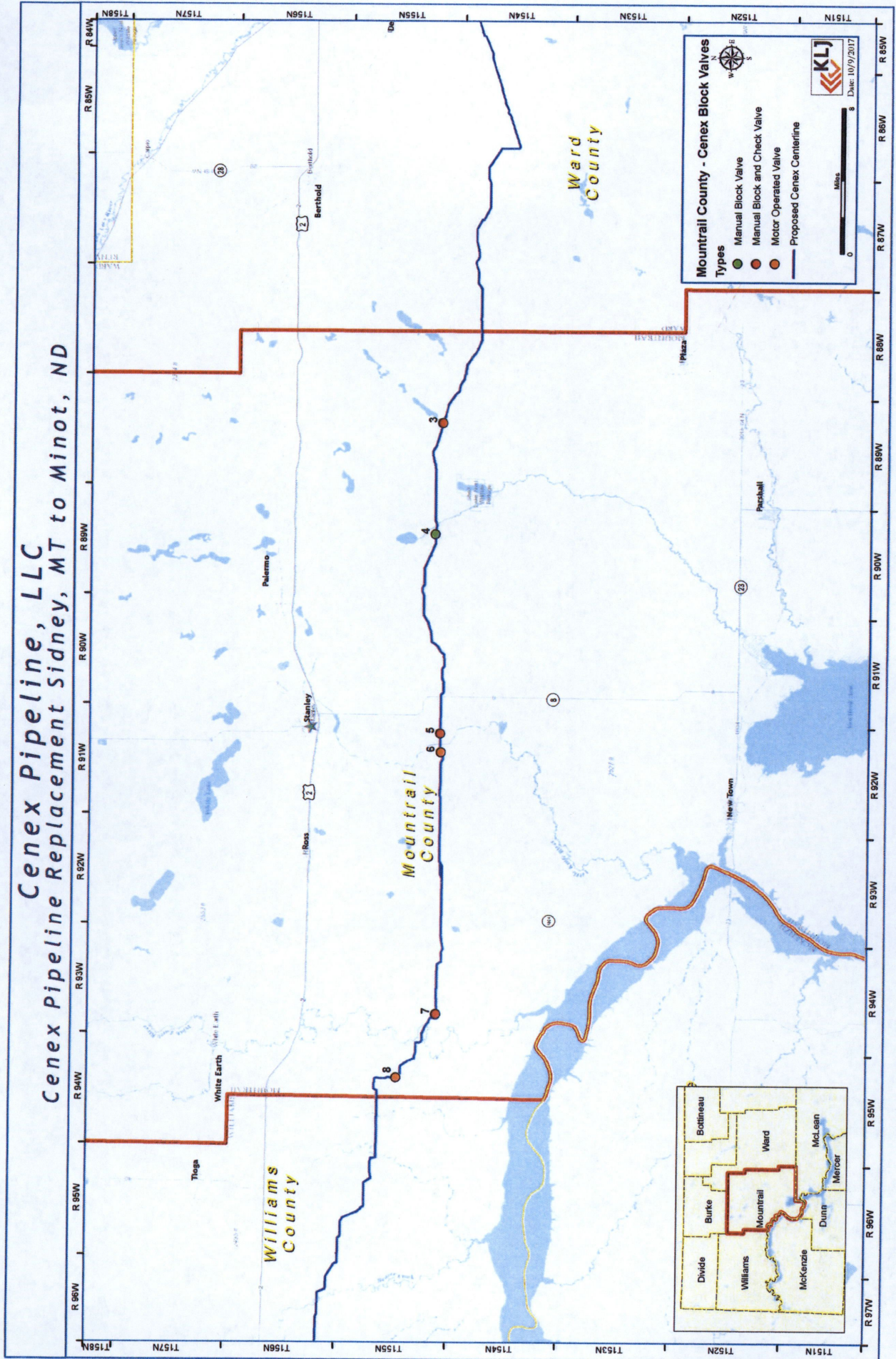

Cenex Pipeline, LLC Cenex Pipeline Replacement Sidney, MT to Minot, ND

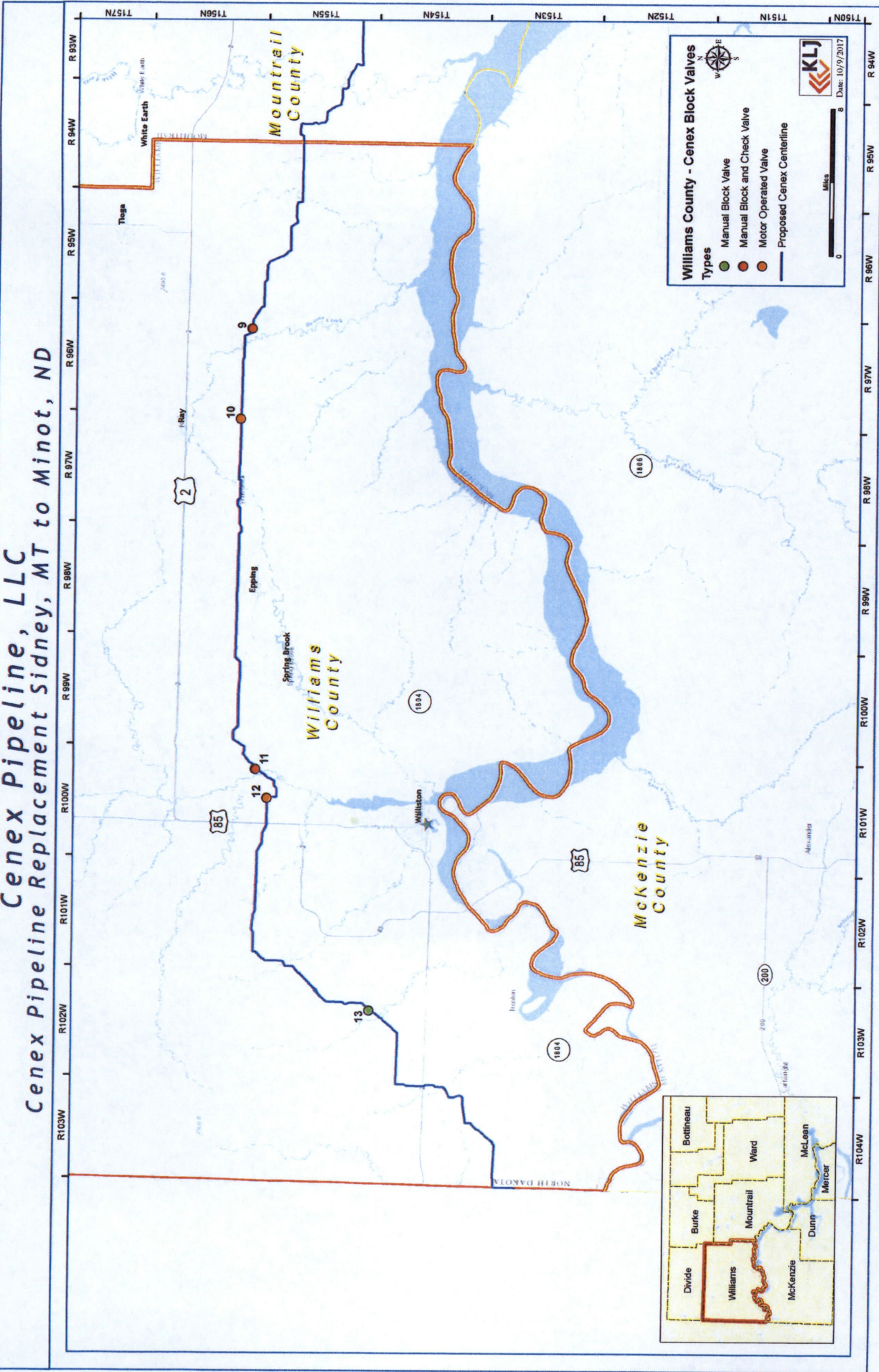

Williams County - Cenex Block Valves

Types

- Manual Block Valve
- Manual Block and Check Valve
- Motor Operated Valve
- Proposed Cenex Centerline

Scale: 0 to 1 Miles

North Arrow: N, S, E, W

KLJ
Date: 10/9/2017

