

PERMIT NO. \_\_\_\_\_

**WHEELOCK TOWNSHIP ROAD**  
**CROSSING PERMIT**

The Wheelock Township board, or its representatives, hereby grants permission to Cenex Pipeline, LLC whose address is PO Box 909, Laurel, MT 59044 (Applicant) to bore (place or bore) a ten-inch pipeline under the TOWNSHIP road driving surface and across the drainage ditches and right-of-way located between the following Township and Range sections:

*\*See attached "Exhibit A" for additional crossing details*

Applicant shall be responsible to leave site in the same condition as before crossing was made and repair any damages resulting from crossing.

Applicant shall install pipeline markers on each side of roadways and/or County right-of-way at each crossing site.

**Please notify the Wheelock Township Chairman and Clerk when work will start and finish at 701-568-3646 (Tom Daniel) & 701-859-5431 (Alvina Skogen). The contractor MUST have a copy of the approved permit and the cross section on site at all times.**

Cenex Pipeline, LLC  
Applicant

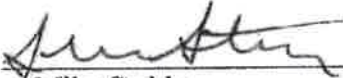
By:   
Mike Stahly

Date: 1/17/18

Phone: 406-628-5209

Wheelock Township

By:   
Tom Daniel (Chairman)

Date: 2-8-18

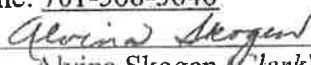
Phone: 701-568-3646  
By:   
Alvina Skogen (Clerk)

Date: Feb. 8, 2018

Phone: 701-859-5431



4585 Coleman Street  
 Bismarck, ND 58503-0431  
 406-447-3346

**"Exhibit A"**

**Cenex Pipeline, LLC  
 Wheelock Township Crossing Locations  
 Williams County**

Crossing ID	Township Name	Township	Range	Section	Location	Trench/Bore	Lat.	Long.
ND-TWP-WL-01	Wheelock	T156N	R 98W	32	121ST AVE	Bore	48° 17' 54.974" N	103° 18' 11.531" W
ND-TWP-WL-02	Wheelock	T156N	R 98W	25	61ST ST	Bore	48° 17' 56.263" N	103° 13' 31.128" W
ND-TWP-WL-03	Wheelock	T156N	R 98W	25	117TH AVE	Bore	48° 17' 59.341" N	103° 12' 59.173" W
ND-SEC-WILL-11	Wheelock	T156N	R 98W	33	SECTION LINE CROSSING	Trench	48° 17' 48.787" N	103° 16' 52.919" W
ND-SEC-WILL-12	Wheelock	T156N	R 98W	36	SECTION LINE CROSSING	Bore	48° 17' 54.662" N	103° 14' 17.036" W



# Cenex Road Crossings



**Township**  
T156N R 98W  
Wheelock

**State**  
North Dakota

**County**  
Williams

Proposed Centerline

Block Valves

Crossing Type

Township Roads

Section Lines



Date: 1/11/2018

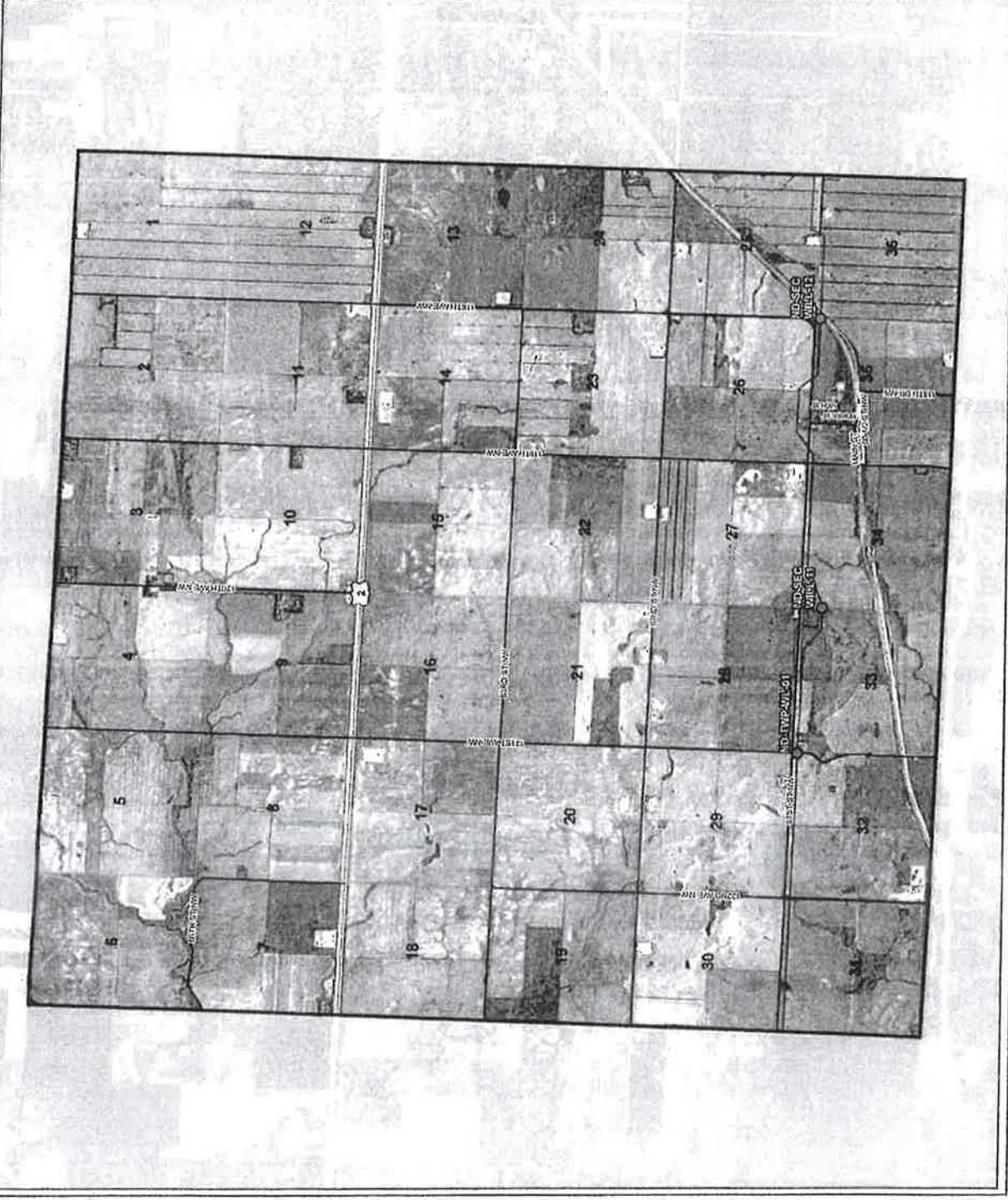



1505 South 30th Avenue  
Moorhead, MN 56560-5146  
218 287 0300  
KLJENG.COM

April 20, 2018

Wheelock Township  
Attn: Tom Daniel  
6449 120th Ave. NW  
Ray, ND 58849

Re: Cenex Pipeline LLC

Dear Mr. Daniel

I've enclosed a revised crossing location table "Exhibit A" and included an updated crossing map of Wheelock Township reflecting the additional township crossing at 117<sup>th</sup> Ave NW that we had discussed over the phone on Wednesday, April 18<sup>th</sup>.

I've also included the executed permit between Wheelock Township and Cenex Pipeline, LLC that was signed a few months ago. Please let me know if there is anything additional that we need to provide your Township due to the added crossing location of 117<sup>th</sup> Ave NW.

If you have any questions, please feel free to contact me.

Sincerely,

A handwritten signature in cursive script that reads "Kelsey Erickson". The ink is dark and the signature is fluid and legible.

Kelsey Erickson

KLJ Right of Way Services  
701-241-2304 (office)  
701-388-4476 (cell)  
kelsey.erickson@kljeng.com





1505 South 30th Avenue  
Moorhead, MN 56560-5146  
218 287 0300  
KLJENG.COM

April 24, 2018

Wheelock Township  
Attn: Tom Daniel  
6449 120th Ave. NW  
Ray, ND 58849

Re: Cenex Pipeline LLC

Dear Mr. Daniel

I've enclosed a revised crossing location table "Exhibit A" and included an updated crossing map of Wheelock Township reflecting the additional township crossing at 61<sup>st</sup> St NW that we had discussed over the phone on Monday, April 24<sup>th</sup>.

Please let me know if there is anything additional that we need to provide your Township due to the added crossing location of 61<sup>st</sup> St NW.

If you have any questions, please feel free to contact me.

Sincerely,

A handwritten signature in cursive script that reads "Kelsey Erickson".

Kelsey Erickson

KLJ Right of Way Services  
701-241-2304 (office)  
701-388-4476 (cell)  
kelsey.erickson@kljeng.com



4585 Coleman Street  
 Bismarck, ND 58503-0431  
 406-447-3346

**"Exhibit A"**

***Cenex Pipeline, LLC  
 Wheelock Township Crossing Locations  
 Williams County***

Crossing ID	Township Name	Township	Range	Section	Location	Trench/Bore	Lat.	Long.
ND-TWP-WL-01	Wheelock	T156N	R 98W	32	121ST AVE	Bore	48° 17' 54.974" N	103° 18' 11.531" W
ND-SEC-WILL-11	Wheelock	T156N	R 98W	33	SECTION LINE CROSSING	Trench	48° 17' 48.787" N	103° 16' 52.919" W
ND-SEC-WILL-12	Wheelock	T156N	R 98W	36	SECTION LINE CROSSING	Trench	48° 17' 54.662" N	103° 14' 17.036" W



# Cenex Road Crossings



## Township

T156N R 98W  
Wheelock

## State

North Dakota

## County

Williams

Proposed Centerline



Block Valves

## Crossing Type



Township Roads



County Roads



State Roads



Section Lines

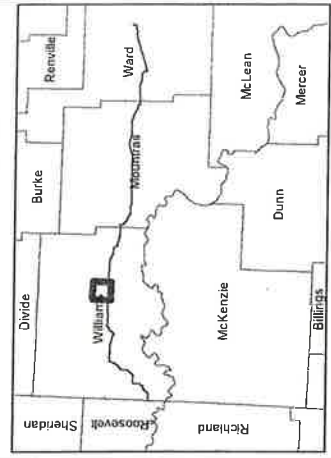

Date: 4/24/2018

